

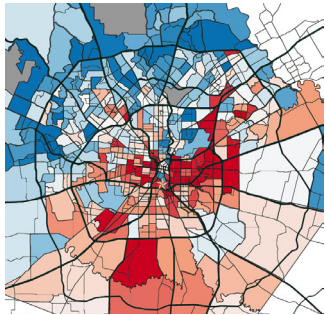

## Southside San Antonio Wellness District and Stroke Rehabilitation Clinic

A community-focused, outdoor-oriented, vibrant space for stroke rehabilitation that will be a critical anchor for attracting much-needed medical and wellness services in southside San Antonio.

### Health Inequity in Southside San Antonio



Southside San Antonio suffers from a morbidity rate significantly higher than wealthier northern San Antonio, with southside residents having 10-15 fewer years of life expectancy than areas a few miles away.



### Lack of Nearby Medical Services

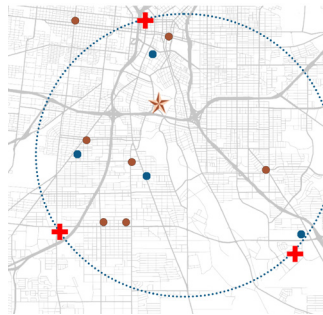

Despite urban density and proximity to downtown, southside residents have no immediate access to medical services, pharmacies, or nutritional resources.

-  Site
-  Grocery
-  Pharmacy





- Patient Private
- Public Space
- Patient Function
- Staff Function

- A Technology Integration
- B Carer Work and Relax Space
- C Private Balcony

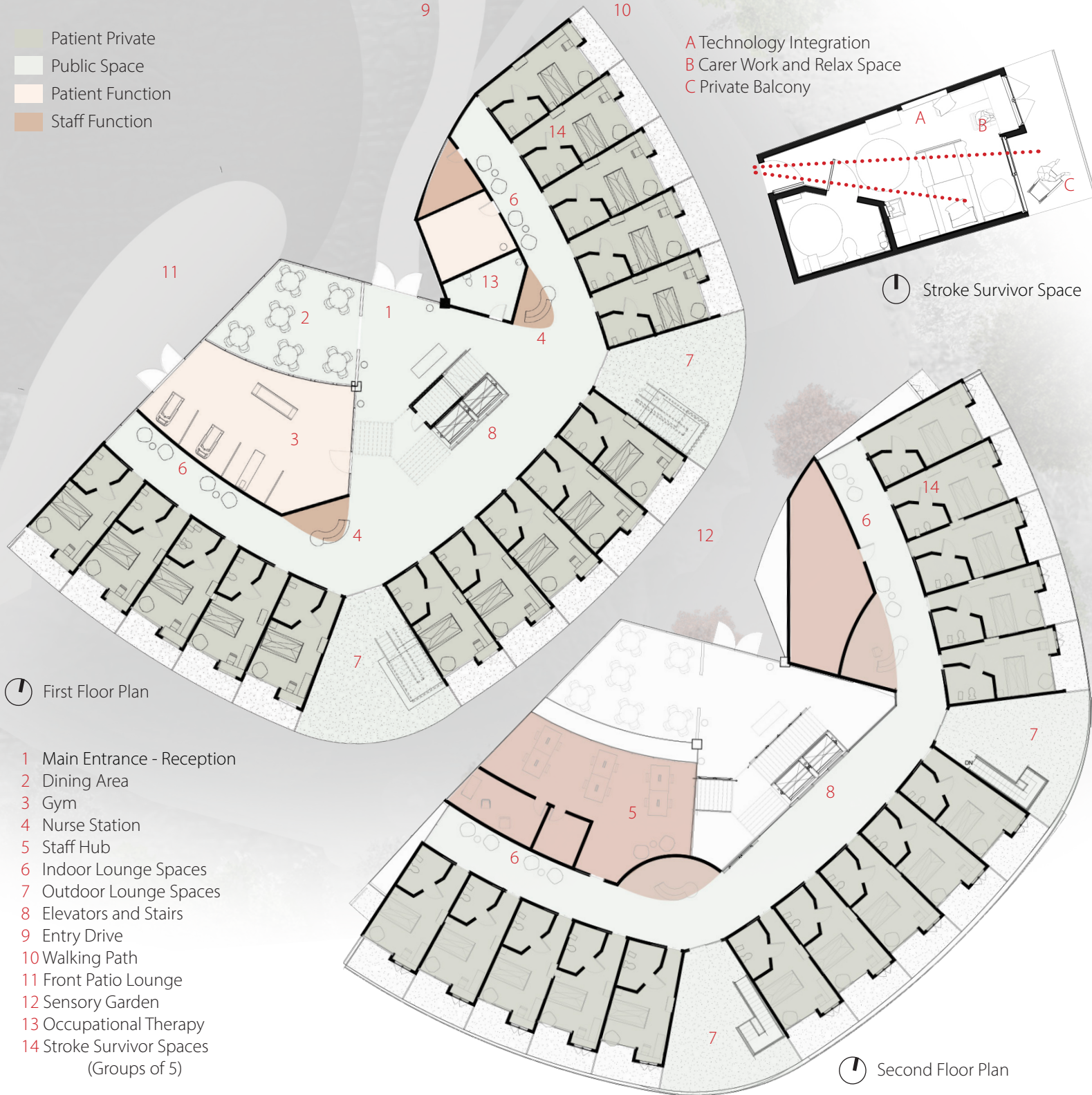



### Form Focused on Optimized Walking Distance and Views

Research shows that shorter distances between patient rooms and therapy or dining increases patient independence and leads to shorter recover times.

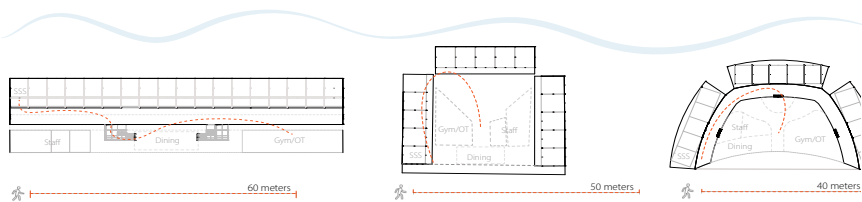

### Roof Connects to Natural Rhythms and Wayfinding

A timber and tensil frame roof provide diffuse light and shading from intense sun. Shadow play from the lattice pattern help patients connect to natural circadian rhythms while the slits between the fins highlight the main circulation paths from the entrance to the sensory garden in the back.

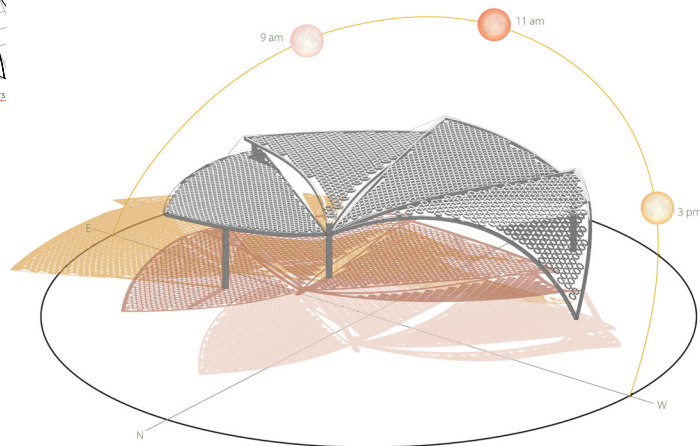

South Texas  
Patterns



Native  
Woods

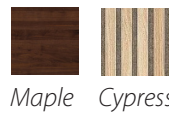

Organic  
Colors



Stroke Survivor Space Section





## From Linear to Organic, A New Wellness District

Between the city grid on the west and the river on the east, the site transitions sharp lines into graceful curves. Harmony Helath is an anchor for a wellness district comprised of medical offices, a community center, new trails, a grocery store, a new hotel

- A Spring Fed Pond
- B Public Green Space and Walking Trails
- C San Antonio Riverwalk (existing)
- D Rehab Clinic Private Driveway
- E New Grocery Store
- F Adapted Community Outreach Center
- G Adapted Medical Offices and Retail
- H New Hotel
- I Hotel Parking
- J Retail and Office Parking

- Adapted existing buildings
- New buildings
- Public grounds with trails
- Office and patient parking

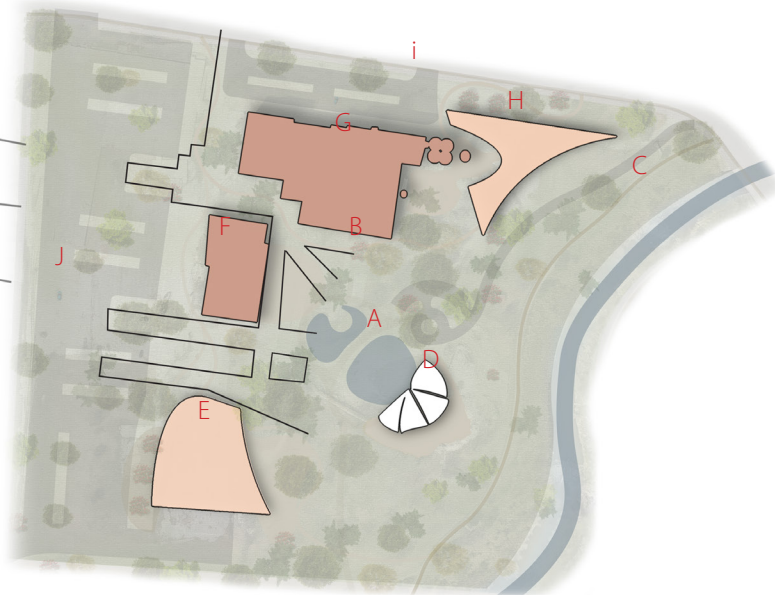

Site Map 



D Stroke Rehabilitation Clinic



E New Grocery Store



H New Hotel