

www.LoadedLegacy.com

The Hedgehog

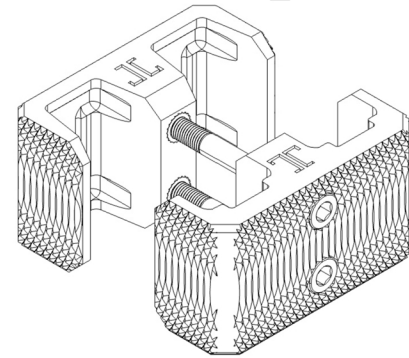

Package Contents:

- 1x** Coupler Rear Plate*
- 1x** Coupler Front Plate
- 2x** M6x1x60mm Screws
- 1x** 5mm Allen Key

**The rear plate contains threaded inserts*

EXPORT NOTICE: This item is controlled for export under the Export Administration Regulations (EAR) as listed on the Commerce Control List (CCL). These regulations include export restrictions and licensing requirements. As a condition of receiving goods, technical data, and/or services from Loaded Legacy, you, our customer, acknowledge that the export, re-export, or transfer—whether directly or indirectly—of these goods, technical data, and/or services in violation of U.S. law is strictly prohibited. Customers acquiring controlled goods, technical data, and/or services from Loaded Legacy are responsible for obtaining any necessary U.S. or other governmental authorization to ensure compliance with applicable export laws.

SAFETY NOTICE:

Practice standard firearm safety while assembling, handling, and operating The Hedgehog. Regularly inspect your firearm, Hedgehog, and magazines.

Compatibility:

- PMAG 30, 40, 10/30 AR/M4 (5.56)
 - Gen M2, M3, MOE, Window
- PMAG 30 AR 300 B (.300 BLK)
 - Gen M3
- PMAG 40 AR/M4
 - Gen M3
- MFT EXD 30 AR/M4
 - Window
- TMAG 30 AR/M4
 - M3

Step 1:

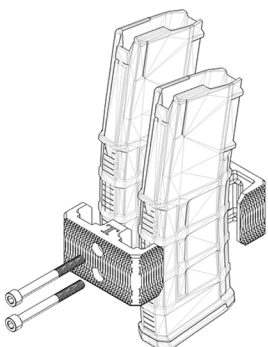

When assembling the coupler, position the magazine on the **left** **higher** than the magazine on the right. Magazines like PMAGS will fit into place on the notches of the coupler front plate. This offset will prevent you from possibly blocking the ejection port from spent casings.

Step 2:

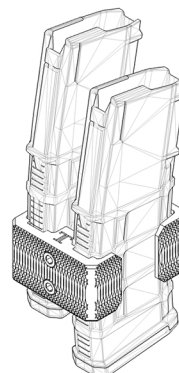

Once the two halves have been set in place, start tightening the screws until the magazines are secured in place.

CAUTION: Overtightening the screws will damage the coupler and magazines.