



CASEMENT SYSTEM

CORTIZO has designed more than 50 exclusive systems of windows, façades, composite panel, solar protection systems and balustrade. This commitment to innovation allows us to offer high value added products, maximizing energy efficiency, thermal and acoustic insulation and resistance to atmospheric agents.

INNOVATION

TECHNOLOGY

QUALITY

EFFICIENCY

GUARANTEE

SUSTAINABILITY

AESTHETIC

FUNCTIONALITY

DESIGN

COMFORT

R+D+I

CASEMENT SYSTEM

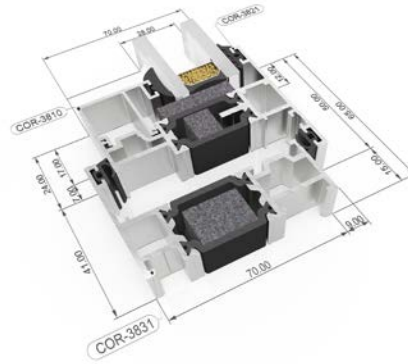

Hinged window system with thermal break and a slim sideline of just 65 mm, which allows a great brightness inside the room. With a modern aesthetic of straight lines, it has profiles tailored for residential and commercial projects, and both for new build and renovation. This system also stands out for its ease in fabrication and assembly, offering excellent performance in thermal and acoustic tests.

- It has an excellent energy efficiency: window transmittance from 1,0 (W/m²K)*
- Noise protection: up to 45 dB acoustic reduction.
- Maximum tightness: CLASS E1200, which means during 75 minutes, total affluent of 450 liters and wind velocity of 161 km/h, there's no water intake.

CATEGORIES ACHIEVED AT TEST CENTRE*

Air permeability	CLASS 4 (máxima)
Water tightness	CLASS E1200
Wind resistance	CE 2400

OPENING POSSIBILITIES

Practicable, oscilo-batiente y abatible.

*CONSULT TYPOLOGY, DIMENSION AND GLASS.



RESISTANCE TO ATMOSPHERIC AGENTS [CORTIZO COMFORT]

All of CORTIZO's enclosing systems are tested in the Test Laboratory at the Technological Center to guarantee the best performance in watertightness, air permeability and wind loads, endorsed by the maximum results in its test qualifications.

THERMAL INSULATION [CORTIZO ENERGY EFFICIENCY]

Nowadays energy efficiency in buildings is a demand made, both by the architects, as by the final customer aware of the importance of saving on heating costs and air conditioner. CORTIZO meets such challenge with systems for every climatic area with a high insulation coefficient to ensure the comfort in the residence.

ACOUSTIC INSULATION [CORTIZO SILENCE]

In order to transform the residence into a private space, intimate and free of pollution outdoor acoustics, CORTIZO has designed its enclosing systems with all the latest technological developments necessary to ensure indoors peace and relax.

UNLIMITED COLOUR RANGE [CORTIZO COLOURS]

The whole RAL colour chart in powder coating, exclusive powder coating, metallic, textured, wood effect, more than 100 finishes in anodized. Aluminum on the outside and wood in the inside, two-coloured finishes... An unlimited offer to create a colour harmony at home. Quality labels in every process: QUALICOAT, SEA-SIDE, QUALIDECO and QUALANOD.

AVANT-GARDE AESTHETICS [CORTIZO DESIGN]

We create tailor-made windows and façades for every project. Creativity to answer aesthetically and functionally to each demand. Aesthetic answers to the technical needs. Creativity at the service of habitable environments.

ENCLOSURES FOR LIFE [CORTIZO DURABILITY]

Aluminum is the most durable, long-standing and resistant material of those used in enclosures. Aluminum has the strength and a durability of the things that last a whole lifetime.

SUSTAINABLE SPIRIT [CORTIZO SUSTAINABILITY]

Respect for the environment is CORTIZO'S commitment. Using innocuous raw materials and products in all our manufacturing process and the limitless possibility of aluminum recycling, allows us to remove any creation of waste and environmental risks.



FOR MORE INFORMATION
VISIT OUR WEB
www.cortizo.com



System / Sistema

› CASEMENT

ARCHITECTURAL ALUMINIUM AND PVC SYSTEMS
SISTEMAS DE ALUMINIO Y PVC PARA LA ARQUITECTURA

System / Sistema

› CASEMENT



CONTEMPORARY ENCLOSURES
CERRAMIENTOS CONTEMPORÁNEOS







Sample tested by / Muestra ensayada por
ALUMINIOS CORTIZO S.A.U.



Transmittance / Transmitancia

$U_w \geq 1,0$ (W/m²K)

Consult typology, dimensions and glass.
Consultar tipología, dimensión y vidrio.

CTE - Apto para zonas climáticas*: α A B C D E

*En función de la transmitancia del vidrio.

Accoustic insulation / Aislamiento acústico

Maximum glazing **44 mm**
Máximo acristalamiento
Maximum accoustic insulation **Rw = 45 dB**
Máximo aislamiento acústico

Sections / Secciones **Profile thickness / Espesor perfilería**

Frame / Marco 70 mm Window / Ventana 1,6 mm
Sash / Hoja 70 mm

Polyamide strip length **32 mm**
Longitud varilla poliamida

Finishes / Acabados

Possibility of dual colour / Posibilidad bicolor
Colour powder coating (RAL, mottled & rough) / Lacado colores (RAL, moteados y rugosos)
Wood effect powder coating / Lacado imitación madera
Anti-bacterial powder coating / Lacado antibacteriano
Anodized / Anodizado

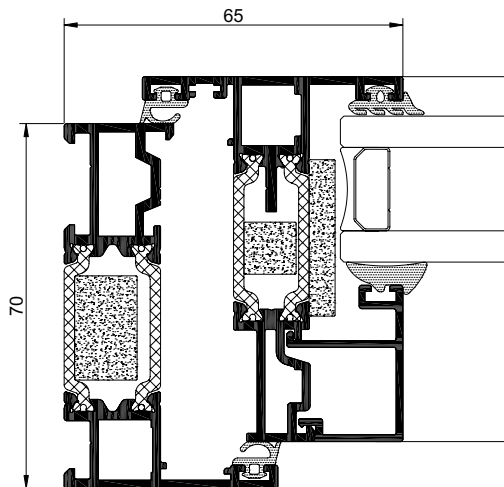

Categories achieved at test centre

Categorías alcanzadas en banco de ensayos

Air permeability / Permeabilidad al aire
(BS EN 12207:2000): Class / Clase 4

Water tightness / Estanqueidad al agua
(BS EN 12208:2000): Class / Clase E1200

Wind resistance / Resistencia al viento
(BS EN 12210:2000): Class / Clase CE 2400

Reference test 1.438 x 1.355 m, 1 sash + 1 fixed.
Ensayo de referencia ventana 1,438 x 1,355 m, 1 hoja + 1 fijo.

Security test / Ensayo de seguridad

(PAS 24:2016): Apt / Apto **PAS24**

Reference test 1.438 x 1.330 m, 1 sash + 1 fixed.
Ensayo de referencia ventana 1,438 x 1,330 m, 1 hoja + 1 fijo.

Opening possibilities

Posibilidades de apertura

Open out: side hung and top hung.

Apertura exterior: practicable a la inglesa y proyectante a la inglesa.

Maximum dimensions/sash

Dimensiones máximas/hoja

SLIM SASH HOJA REDUCIDA	SIDE HUNG PRACTICABLE	TOP HUNG PROYECTANTE
Width / Ancho (L)	700 mm	1200 mm
Height / Alto (H)	1300 mm	1300 mm

HEAVY DUTY SASH HOJA GRANDES CARGAS	SIDE HUNG PRACTICABLE	TOP HUNG PROYECTANTE
Width / Ancho (L)	750 mm	1800 mm
Height / Alto (H)	1750 mm	1800 mm

Consult maximum weight and dimensions in accordance to typology.
Consultar peso y dimensiones máximas según tipología.

Maximum weight/sash

Peso máximo/hoja

	SIDE HUNG PRACTICABLE	TOP HUNG PROYECTANTE
SLIM SASH HOJA REDUCIDA	35 Kg	50 Kg
HEAVY DUTY SASH HOJA GRANDES CARGAS	42 Kg	100 Kg



Diego Piñeiro Janeiro
R&D Manager / Director de I+D+i