

Ultralok[®] Tooth System

Ultralok® Point and Adapter Selection Instructions

Proper selection of the points and adapters to match the machine and application is very important for maximum performance. The ESCO Specifications Catalog is designed to make the selection quick and easy. Just follow the simple instructions below. If you have any questions, please contact your ESCO representative.

Adapter Selection

Adapters cannot be easily changed so careful evaluation of the machine and application are important.

The information needed is lip thickness, ramp angle, straight, spade or semi spade lip (refer to illustrations below), machine make and model, and application. Do not make assumptions on the lip dimensions based on the machine. Many times the lip may be a custom size or has been replaced with a size different from the factory original. For bolt-on adapters the hole spacing is critical and needs to be accurately measured on the lip.

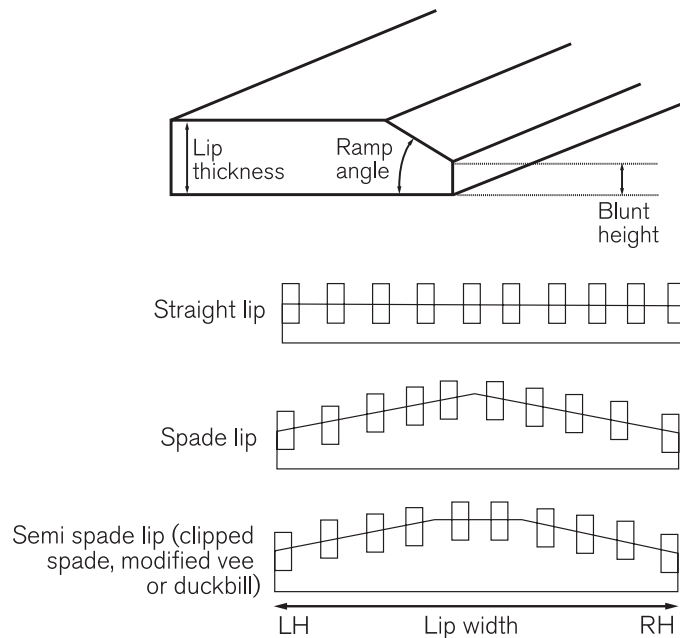

First, find the machine make and model listed in the Nose Sizes Recommendation Chart. Then select the nose size for the machine and application (STD/HD or XHD). To assist in the application type there are definitions on the next page.

Once the nose size is determined, go to the appropriate section and find the page listing parts in that nose size. Using the lip dimensional information, determine which adapter(s) will fit. Then select the style that closely matches the application needs. Note that adapters are listed by category (Excavator, Loader, Misc.).

To help with selection, general purpose (STD/HD) wheel loader applications typically use flush mount (Type 1) adapters. Heavy-duty and Extreme-Duty (XHD) applications for wheel loaders typically use 1-1/2 top leg (Type 4 or 5). Two leg (Type 10) are used only in hot slag or extreme abrasion. For many of the loader adapters there are left and right versions for spade or duckbill lips. These are designated with an "L" or "R" after the adapter shank prefix (i.e. 1810L-U45 and 1810R-U45). Excavators typically use 1/2 bottom leg (Type 8) adapters for all applications. For general purpose applications in the smaller nose sizes there are 1 1/4 bottom leg (Type 7) adapters available. In the "Machine Type" column for each adapter pattern number is the specific make and model or machine type the given adapter pattern number is typically used on.

The last thing to determine is the number of adapters needed for a given lip width. If you are not sure of the number of positions the bucket should have, a good rule of thumb is to have spacing of 1 1/2 adapter widths between adapters for excavator applications, and 2 1/2 adapter widths for loader applications. Remember, the reason for points and adapters is to help the machine dig (penetration), but too many positions can reduce penetration. Wear protection is secondary. The more adapters the less lip wear. If the calculation for the number of adapters does not come out even, take these into consideration for choosing to go with one more or one less adapter.

Point Selection

When selecting a tooth shape there are several key areas to look at. Also, what tooth style was previously used and did it perform satisfactorily. Even if it was not an ESCO design, it can give an indication of a style to match or a style to avoid.

Consider the loading, penetration, abrasion, and impact needs. These can be based on application, machine make and model, and the material to be handled. Then go to the page listing the size of points to match the nose size selected. The Ultralok® locking device is an integral part of each Ultralok point. Each point has a description of its performance characteristics (penetration, abrasion, rock, chisel, etc.). Following is a functional description of the Ultralok point shapes.

Ultralok Point Shapes Recommendations

- **S** – Standard point, general purpose shape for use on both excavators and wheel loaders. Designed to wear sharp to maintain penetration, and features a center rib for greater strength. An excellent choice for general purpose applications.
- **C** – Chisel point, primarily for use on excavators. The design provides good penetration and extra wear metal in tough applications. The heavy-duty rib and unique tear-drop relief in the bottom keep the point sharp throughout its wear life.
- **H** – Heavy point, for extremely abrasive applications and is primarily designed excavators. Additional wear metal provides for long point life. The heavy-duty rib and unique tear-drop relief in the bottom help to maintain sharpness as the point wears.
- **P** – Pick point, is for extremely hard to penetrate materials, and is primarily designed for excavators but can be used on wheel loaders when conditions warrant it. Ribs on both the top and bottom provide strength and allow the point to stay sharp throughout its wear life.
- **T** – Twin pick point, is for maximum performance in hard to penetrate materials. The unique configuration minimizes the chance of rocks becoming wedged between the tines. The twin pick shape is designed to be used in corner positions in conjunction with the P style point to cut clearance for the buckets' sides. Each corner can be switched with the opposite corner to maximize wear life.
- **F** – Flared point, is for general pupose digging, clean-up and applications where a continuous edge may be used. The wide blade maximizes bucket capacity and is an excellent choice for trench bottoms and foundations excavations.
- **AP** – Abrasion-Penetration point, is a heavy-duty penetration point for wheel loaders with added wear metal for highly abrasive applications. The beveled tip design ensures sharpness, and the top center rib helps maintain the sharpness as the point wears. A wear shoe is integrated into the bottom to provide long life.
- **A** – Heavy-Abrasion point, is design for optimum wear on wheel loaders working in extreme abrasion applications. The point tip is beveled and the top contoured panel ensures excellent material flow into the bucket. A bottom wear shoe runs the whole length of the point for maximum wear life and ensures a smooth floor to minimize the chance of tire damage.

Point and Adapter Numbering System

The last two numbers in each adapter pattern number signify the nose size. The same number is used in the equivalent size of point. The letters which follow the size number indicate the specific point shape.

Component	Ultralok® Pattern No.
Adapter	1810- U45
Point	U45AP

It is not important to memorize adapter pattern numbers, but it is helpful to know the third number to the left of the nose size indicates the type of adapter. Following are some examples.

- Weld-on adapters have an “8” three digits to the left of the nose size. For example: 833-U20, 1837A-U40, 1852-U55.
- Bolt-on adapters have a “7” three digits to the left of the nose size. For example: 8705-U25, 3766A-U30, 5722-U35.

Application Definition

- **GP / STD (General Purpose / Standard Duty)** – Light, loose, well-shot material such as dirt, clay, sand, gravel (not cemented), shot or friable coal or shale. Puts very little load on the equipment and uses minimum machine power.
- **HD (Heavy Duty)** – Medium to heavy, shot material (not tight or large slabs), such as rocky overburden or ore, unshot lens or partings of cemented material of rock which will easily break up into manageable sizes when excavated. Requires a moderate amount of machine power but at times can apply high loads on the equipment.
- **XHD (Extra Heavy or Severe Duty, Rock Application)** – Heavy ore or unshot rock, tight or slabby shot rock that requires maximum or near maximum machine power to break out. Such applications usually cause the machine to rock during the digging cycle, and many times is accompanied by smoke where the tooth engages the material. Puts maximum loads on the equipment during most of the operation.

Ultralok® Tooth System U20

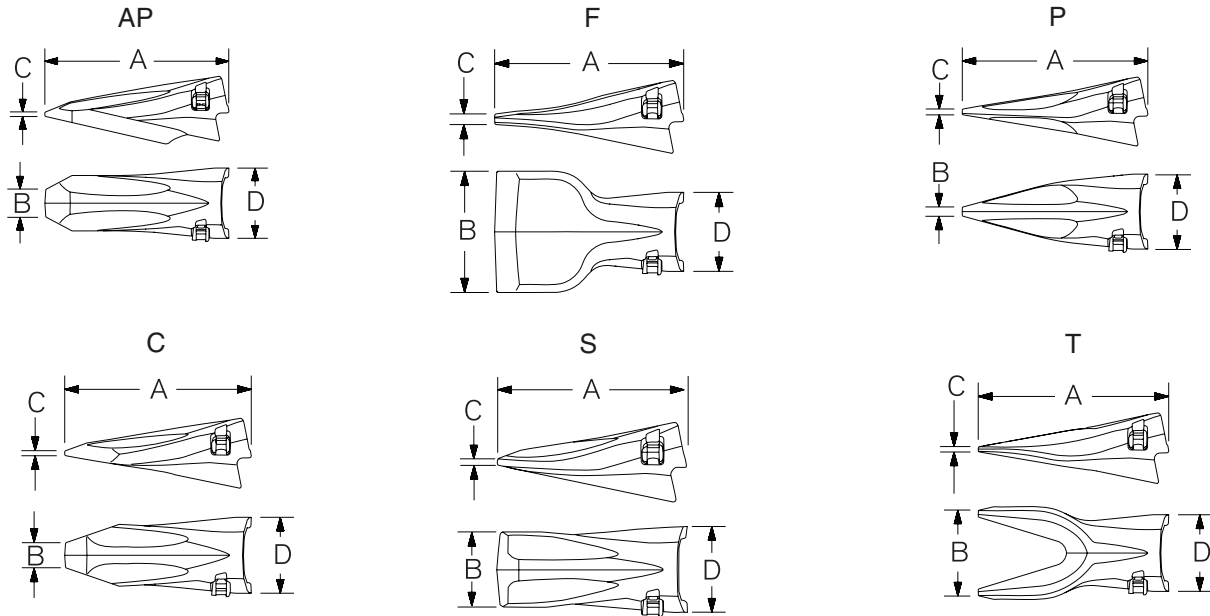

U20 Points

PART ID	DESCRIPTION	A	B	C	D	WEIGHT kg/lb
		LENGTH mm/in	BIT WIDTH mm/in	BIT THICKNESS mm/in	WIDTH AT EARS mm/in	
U20AP	Abrasion Penetration	200 / 7.86	35 / 1.37	5 / .22	78 / 3.07	2.7 / 5.9
U20F	Flare	176 / 6.92	114 / 4.50	11 / .43	78 / 3.07	2.4 / 5.3
U20P	Pick	202 / 7.94	10 / .40	7 / .27	78 / 3.07	1.7 / 3.9
U20C	Chisel	191 / 7.52	27 / 1.06	10 / .39	78 / 3.07	2.0 / 4.4
U20S	Standard	176 / 6.93	69 / 2.71	7 / .29	78 / 3.07	2.0 / 4.4
U20T	Twin Pick	202 / 7.93	93 / 3.67	7 / .26	78 / 3.07	2.1 / 4.6

U20 Weld-on Nose

PART ID	DESCRIPTION	A	B	C	WEIGHT kg/lb
		WIDTH mm/in	HEIGHT mm/in	J-GROOVE mm/in	
WN-U20	Weldon Nose	90 / 3.54	86 / 3.39	21 / .83	2.7 / 6.0

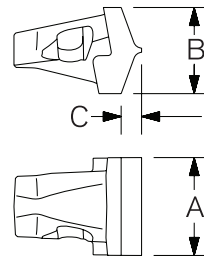

Ultralok® Tooth System U20

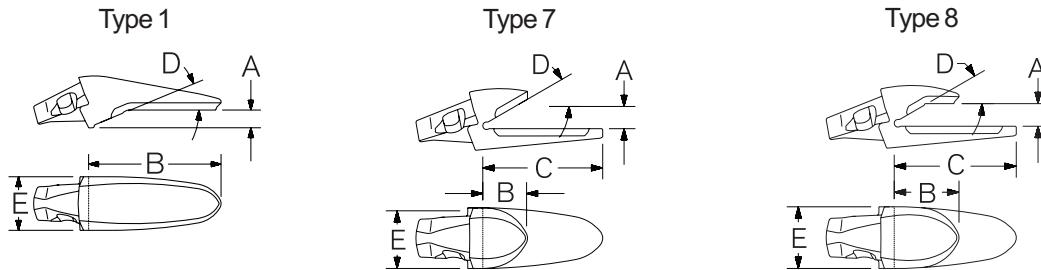

U20 Adapters

PART ID	TYPE	DESCRIPTION	A LIP THICKNESS mm/in	B TOP LEG mm/in	C BOTTOM LEG mm/in	D RAMP ANGLE deg	E ADAPTER WIDTH mm/in	NOSE ANGLE deg	WEIGHT kg/lb	MACHINE TYPE
Excavator										
5854-U20	8	1-1/2 Bottom Leg	25 / 1.00	79 / 3.12	165 / 6.50	30	75 / 2.95	10	3.8 / 8.4	EXC
833-U20	7	Bottom Leg	25 / 1.00	42 / 1.67	130 / 5.12	30	75 / 2.95	10	3.2 / 7.2	EXC
Wheel Loader										
8802-U20	1	Flushmount	20 / 0.75 and 25 / 1.00	175 / 6.89	N/A	25	75 / 2.95	15	5.1 / 11.2	FEL
Misc										
3895-U20	1	Flushmount	N/A	105 / 4.15 or 113 / 4.44	N/A	0	75 / 2.95	30 or 10	3.9 / 8.7	Reversible Auger or Clamshell

Ultralok Tooth System U25

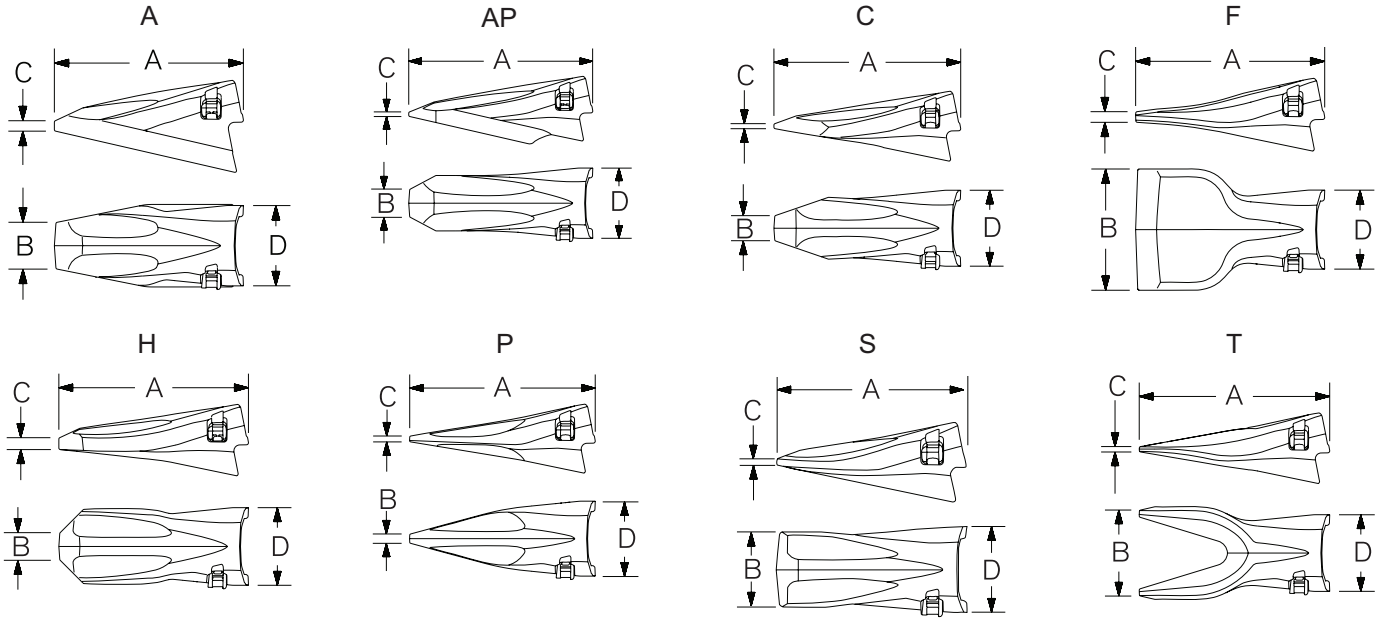

U25 Points

PART ID	DESCRIPTION	A	B	C	D	WEIGHT kg/lb
		LENGTH mm/in	BIT WIDTH mm/in	BIT THICKNESS mm/in	WIDTH AT EARS mm/in	
U25A	Abrasion	219 / 8.60	55 / 2.15	13 / .50	93 / 3.67	5.8 / 12.7
U25AP	Abrasion Penetration	242 / 9.51	52 / 2.04	16 / .62	93 / 3.67	4.8 / 10.7
U25C	Chisel	229 / 9.00	31 / 1.20	10 / .38	93 / 3.67	3.4 / 7.5
U25F	Flare	210 / 8.25	127 / 4.99	12 / .47	93 / 3.67	4.1 / 8.9
U25H	Heavy	227 / 8.94	32 / 1.25	14 / .54	93 / 3.67	4.1 / 9.0
U25P	Pick	224 / 8.80	12 / .46	6 / .25	93 / 3.67	2.9 / 6.3
U25S	Standard	211 / 8.29	82 / 3.22	8 / .33	93 / 3.67	3.4 / 7.5
U25T	Twin Pick	224 / 8.80	112 / 4.43	8 / .31	93 / 3.67	3.3 / 7.2

Weld-on Nose

PART ID	DESCRIPTION	A	B	C	WEIGHT kg/lb
		WIDTH mm/in	HEIGHT mm/in	J-GROOVE mm/in	
WN-U25	Weldon Nose	90 / 3.54	86 / 3.39	21 / .83	2.7 / 6.0

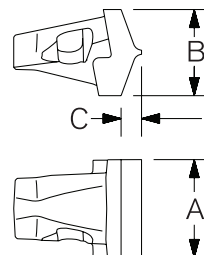

Ultralok Tooth System U25

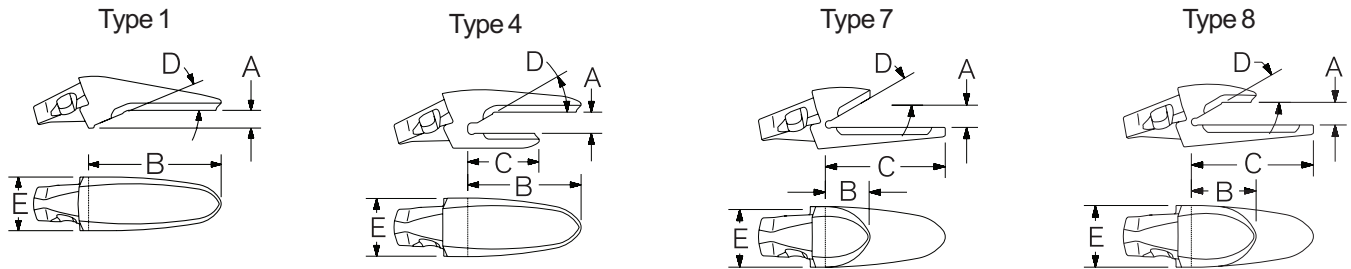

U25 Adapters

PART ID	TYPE	DESCRIPTION	A	B	C	D	E	NOSE	WEIGHT kg/lb	MACHINE TYPE
			LIP THICKNESS mm/in	TOP LEG mm/in	BOTTOM LEG mm/in	RAMP ANGLE deg	ADAPTER WIDTH mm/in	ANGLE deg		
Excavator										
3870-U25	7	Bottom Leg	30 / 1.25	53 / 2.08	159 / 6.26	30	90 / 3.54	10	4.8 / 10.6	EXC
5854-U25	8	1-1/2 Bottom Leg	25 / 1.00	95 / 3.74	190 / 7.48	30	90 / 3.54	10	6.3 / 13.8	EXC
5849-U25	8	1-1/2 Bottom Leg	30 / 1.25	95 / 3.74	190 / 7.48	30	90 / 3.54	10	6.2 / 13.6	EXC
Wheel Loader										
8803-U25	1	Flushmount	30 / 1.25 and 35 / 1.50	199 / 7.83	N/A	25	90 / 3.54	15	7.6 / 16.8	FEL
3808-U25	4	1-1/2 Top Leg	35 / 1.25	178 / 7.01	89 / 3.50	30	90 / 3.54	15	6.0 / 13.2	FEL
Misc										
3895-U25	1	Flushmount	N/A	143 / 5.62 or 144 / 5.65	N/A	N/A	90 / 3.54	30 or 10	6.7 / 14.8	Clamshell/ Auger

Ultralok Tooth System U30

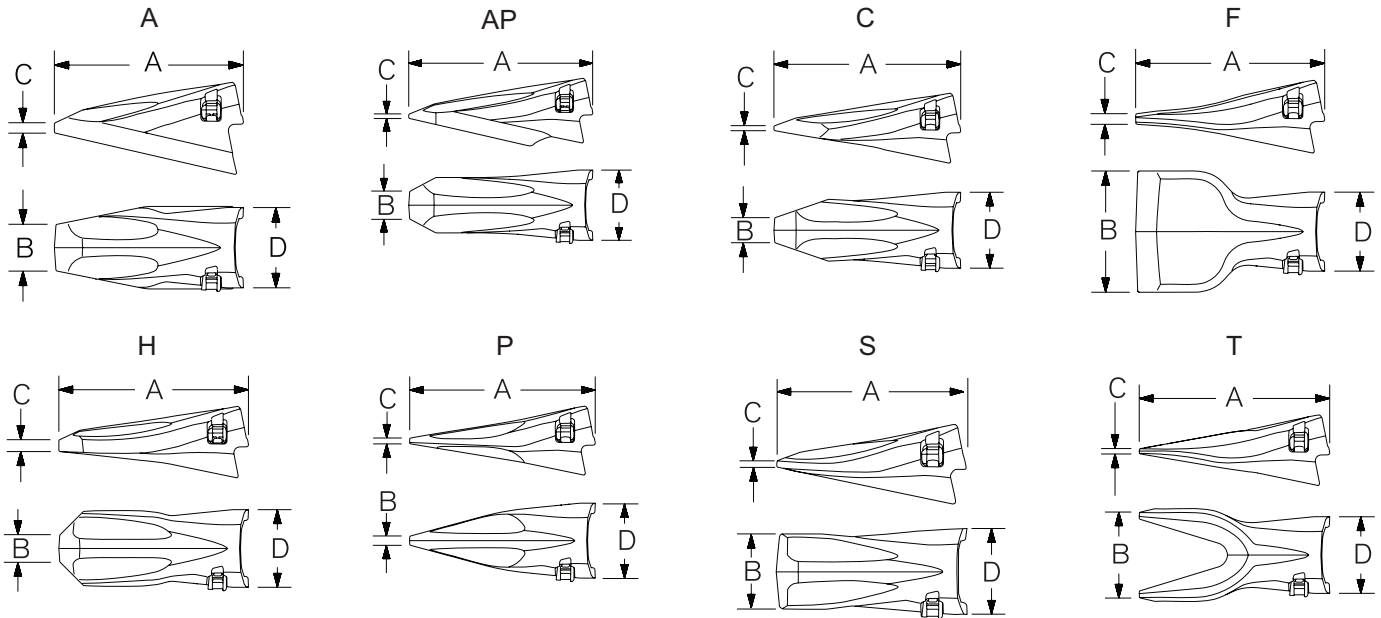

U30 Points

PART ID	DESCRIPTION	A	B	C	D	WEIGHT kg/lb
		LENGTH mm/in	BIT WIDTH mm/in	BIT THICKNESS mm/in	OUTSIDE BOX WIDTH mm/in	
U30A	Abrasion	251 / 9.88	60 / 2.36	11 / 0.43	105 / 4.15	8.4 / 18.5
U30AP	Abrasion Penetration	275 / 10.85	42 / 1.67	7 / 0.26	105 / 4.15	7.1 / 15.6
U30C	Chisel	259 / 10.20	36 / 1.41	9 / 0.34	105 / 4.15	5.0 / 11.0
U30F	Flare	259 / 10.20	152 / 5.98	14 / 0.53	105 / 4.15	6.5 / 14.3
U30H	Heavy	257 / 10.12	36 / 1.42	16 / .61	105 / 4.15	5.8 / 12.8
U30P	Pick	274 / 10.77	14 / .56	9 / 0.36	105 / 4.15	4.1 / 9.1
U30S	Standard	240 / 9.45	91 / 3.59	10 / 0.39	105 / 4.15	5.0 / 11.0
U30T	Twin Pick	274 / 10.78	125 / 4.91	7 / 0.26	105 / 4.15	5.2 / 11.4

Weld-on Nose

PART ID	DESCRIPTION	A	B	C	WEIGHT kg/lb
		WIDTH mm/in	HEIGHT mm/in	J-GROOVE mm/in	
WN-U30	Weldon Nose	102 / 4.01	97 / 3.83	24 / .94	3.9 / 8.6

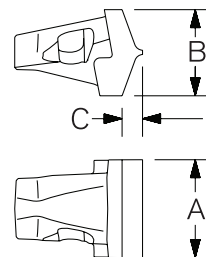

Ultralok Tooth System U30

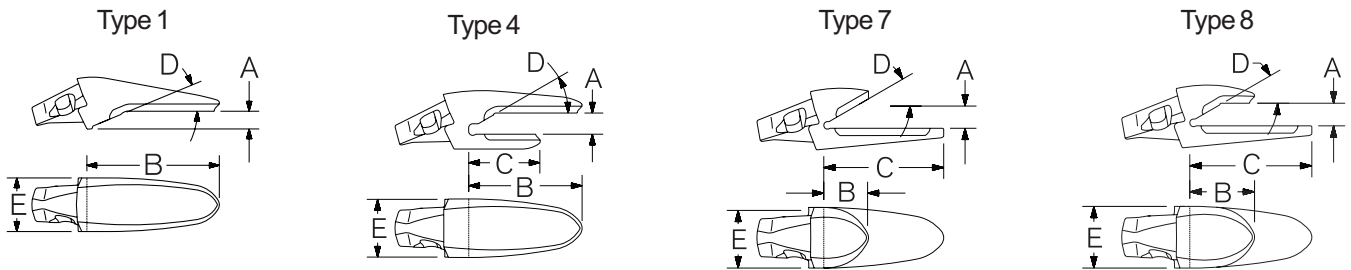

U30 Adapters

PART ID	TYPE	DESCRIPTION	A	B	C	D	E	NOSE	WEIGHT	MACHINE
			LIP THICKNESS	TOP LEG	BOTTOM LEG	RAMP ANGLE	ADAPTER WIDTH	ANGLE		
			mm/in	mm/in	mm/in	deg	mm/in	deg	kg/lb	TYPE
Excavator										
5849-U30	8	1-1/2 Bottom Leg	30 / 1.25	118 / 4.66	214 / 8.43	30	102 / 4.01	10	9.0 / 19.8	EXC
5850-U30	8	1-1/2 Bottom Leg	40 / 1.5	116 / 4.56	212 / 8.34	30	102 / 4.01	10	8.7 / 19.2	EXC
3871A-U30	7	Bottom Leg	35 / 1.38	54 / 2.14	190 / 7.48	30	102 / 4.01	10	6.7 / 14.7	EXC
3881B-U30	8	1-1/2 Bottom Leg	35 / 1.38	116 / 4.56	212 / 8.34	30	102 / 4.01	10	8.8 / 19.4	EXC
Wheel Loader										
802A-U30	4	1-1/2 Top Leg	40 / 1.50	197 / 7.76	97 / 3.82	30	102 / 4.01	15	9.3 / 20.6	FEL
8831-U30	1	Flushmount	40 / 1.50 and 45 / 1.75	241 / 9.49	N/A	22.5-25	102 / 4.01	15	8.9 / 19.7	FEL
8833-U30	4	1-1/2 Top Leg	40 / 1.5	197 / 7.77	97 / 3.83	22.5-25	102 / 4.01	15	9.2 / 20.2	FEL

Ultralok Tooth System U35

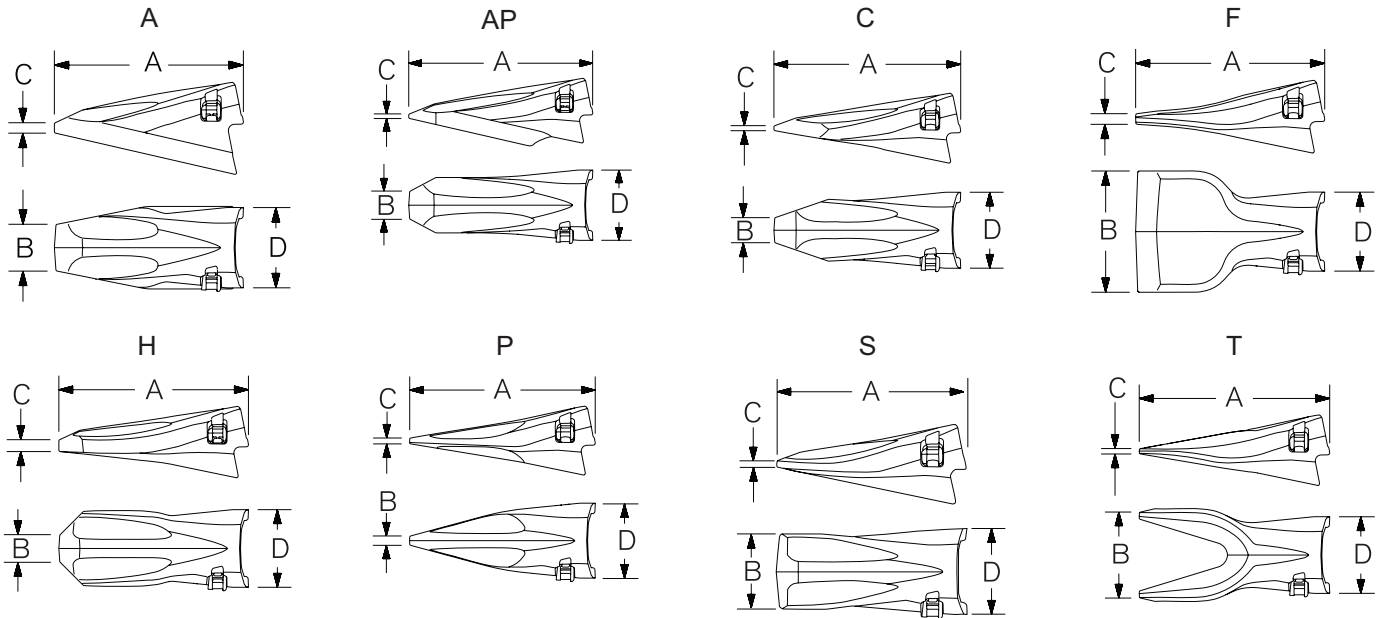

U35 Points

PART ID	DESCRIPTION	A	B	C	D	WEIGHT kg/lb
		LENGTH mm/in	BIT WIDTH mm/in	BIT THICKNESS mm/in	WIDTH AT EARS mm/in	
U35A	Abrasion	279 / 10.98	69 / 2.72	15 / 0.59	119 / 4.67	12.0 / 26.5
U35AP	Abrasion Penetration	298 / 11.73	48 / 1.89	8 / 0.31	119 / 4.67	10.1 / 22.2
U35C	Chisel	291 / 11.46	40 / 1.58	8 / 0.32	119 / 4.67	7.0 / 15.5
U35F	Flare	287 / 11.28	178 / 7.00	16 / 0.63	119 / 4.67	9.3 / 20.4
U35H	Heavy	289 / 11.40	41 / 1.60	18 / .70	119 / 4.67	8.4 / 18.6
U35P	Pick	298 / 11.71	16 / 0.62	10 / 0.40	119 / 4.67	5.7 / 12.5
U35S	Standard	265 / 10.41	102 / 4.03	11 / 0.43	119 / 4.67	7.0 / 15.3
U35T	Twin Pick	298 / 11.72	143 / 5.62	8 / 0.30	119 / 4.67	7.0 / 15.5

Weld-on Nose

PART ID	DESCRIPTION	A	B	C	WEIGHT kg/lb
		WIDTH mm/in	HEIGHT mm/in	J-GROOVE mm/in	
WN-U35	Weldon Nose	Future Availability			

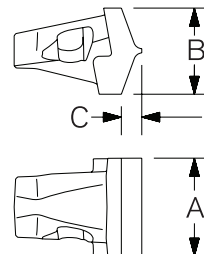

Ultralok Tooth System U35

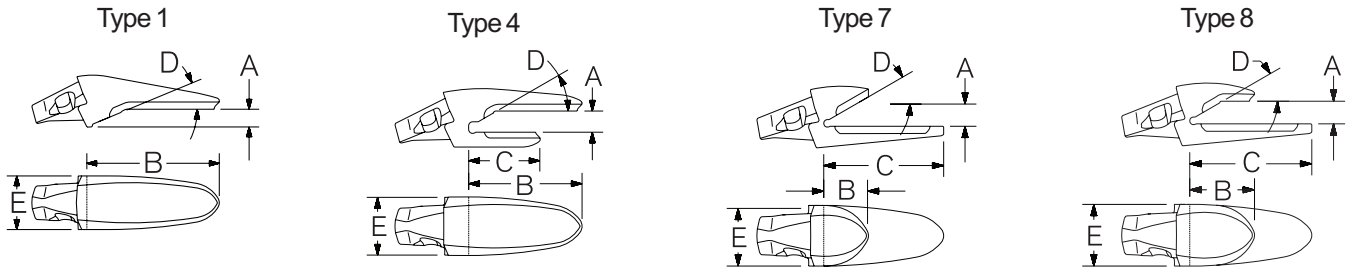

U35 Adapters

PART ID	TYPE	DESCRIPTION	A	B	C	D	E	NOSE	WEIGHT	MACHINE
			LIP THICKNESS mm/in	TOP LEG mm/in	BOTTOM LEG mm/in	RAMP ANGLE deg	ADAPTER WIDTH mm/in	ANGLE deg		
Excavator										
5855-U35	8	1-1/2 Bottom Leg	40 / 1.50	127 / 5.00	235 / 9.25	30	115 / 4.53	10	11.9 / 26.3	EXC
3872A-U35	7	Bottom Leg	40 / 1.50	65 / 2.55	216 / 8.50	30	115 / 4.53	10	10.7 / 23.5	EXC
3810B-U35	8	1-1/2 Bottom Leg	45 / 1.75	127 / 5.00	235 / 9.25	30	115 / 4.53	10	12.2 / 27.0	EXC
Wheel Loader										
8833-U35	4	1-1/2 Top Leg	40 / 1.50	217 / 8.52	108 / 4.27	22.5-25	115 / 4.53	15	12.6 / 27.8	FEL
8831-U35	1	Flushmount	40 / 1.50 and 45 / 1.75	252 / 9.94	N/A	22.5-25	115 / 4.53	15	12.2 / 26.9	FEL
Miscellaneous										
3802-U35	1	Flushmount	N/A	310 / 12.19	N/A	N/A	115 / 4.53	15	13.7 / 30.2	Clamshell

Ultralok Tooth System U40

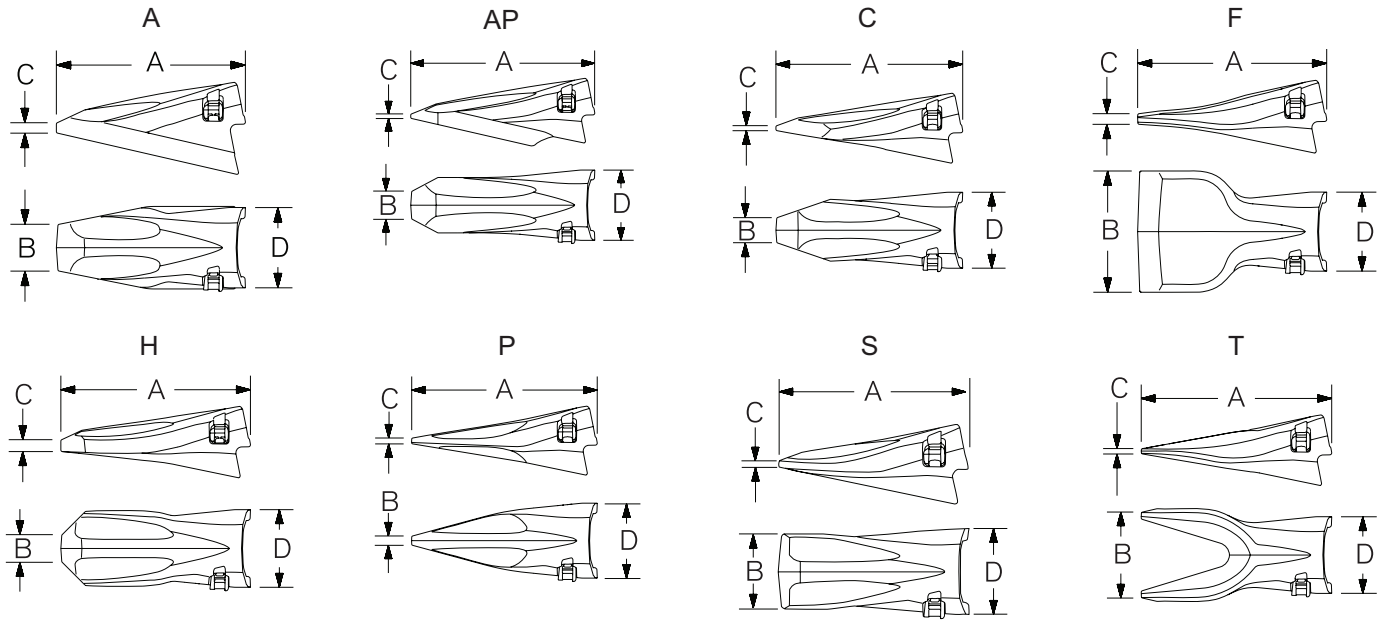

U40 Points

PART ID	DESCRIPTION	A	B	C	D	WEIGHT kg/lb
		LENGTH mm/in	BIT WIDTH mm/in	BIT THICKNESS mm/in	WIDTH AT EARS mm/in	
U40A	Abrasion	314 / 12.35	78 / 3.08	15 / 0.58	134 / 5.26	17.0 / 37.5
U40AP	Abrasion Penetration	344 / 13.53	60 / 2.36	12 / 0.48	134 / 5.26	14.3 / 31.5
U40C	Chisel	328 / 12.91	45 / 1.78	9 / 0.36	134 / 5.26	10.0 / 22.0
U40F	Flare	316 / 12.45	203 / 7.99	18 / 0.70	134 / 5.26	13.0 / 28.6
U40H	Heavy	326 / 12.84	46 / 1.80	20 / .77	134 / 5.26	12.1 / 26.6
U40P	Pick	335 / 13.20	18 / 0.70	11 / 0.45	134 / 5.26	8.1 / 17.8
U40S	Standard	294 / 11.56	122 / 4.81	12 / 0.48	134 / 5.26	9.9 / 21.8
U40T	Twin Pick	334 / 13.16	161 / 6.34	10 / 0.41	134 / 5.26	9.9 / 22.0

Weld-on Nose

PART ID	DESCRIPTION	A	B	C	WEIGHT kg/lb
		WIDTH mm/in	HEIGHT mm/in	J-GROOVE mm/in	
WN-U40	Weldon Nose	Future Availability			

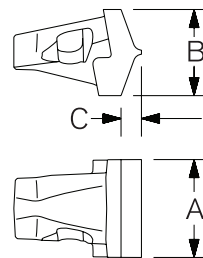

Ultralok Tooth System U40

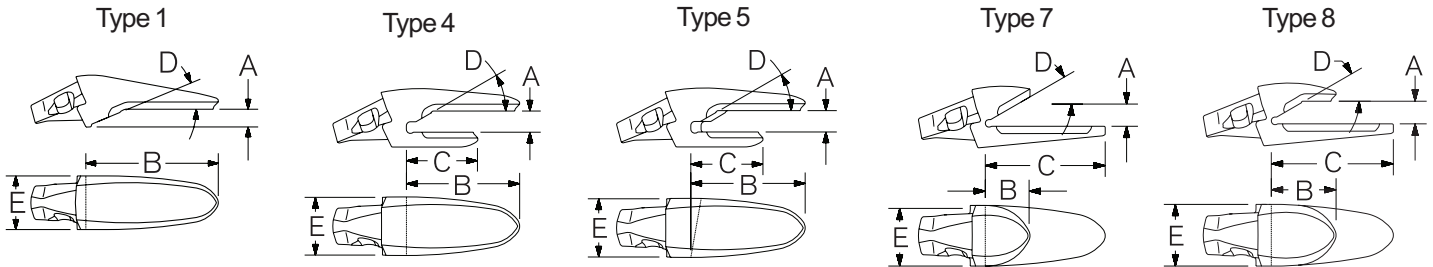

U40 Adapters

PART ID	TYPE	DESCRIPTION	A	B	C	D	E	NOSE	WEIGHT	MACHINE
			LIP THICKNESS mm/in	TOP LEG mm/in	BOTTOM LEG mm/in	RAMP ANGLE deg	ADAPTER WIDTH mm/in	ANGLE deg		
Excavator										
5856-U40	8	1-1/2 Bottom Leg	50 / 2.00	145 / 5.71	264 / 10.39	30	129 / 5.08	10	17.1 / 37.6	EXC
3882B-U40	7	Bottom Leg	40 / 1.57	146 / 5.73	264 / 10.37	30	129 / 5.08	10	17.0 / 37.6	EXC
3810B-U40	8	1-1/2 Bottom Leg	45 / 1.77	145 / 5.71	264 / 10.39	30	129.508	10	17.9 / 39.5	EXC
Wheel Loader										
1812LA-U40	5	1-1/2 Top Leg Spade	50 / 2.00	248 / 9.76	124 / 4.9	30	129 / 5.08	15	18.9 / 41.7	FEL
1812RA-U40	5	1-1/2 Top Leg Spade	50 / 2.00	248 / 9.76	124 / 4.9	30	129 / 5.08	15	18.9 / 41.7	FEL
1837A-U40	4	1-1/2 Top Leg	50 / 2.00	248 / 9.76	124 / 4.9	30	129 / 5.08	15	18.0 / 39.8	FEL
3892-U40	1	Flushmount	50 / 2.00	298 / 11.73	n/a	22.5-25	129 / 5.08	15	18.1 / 39.8	FEL

Ultralok Tooth System U45

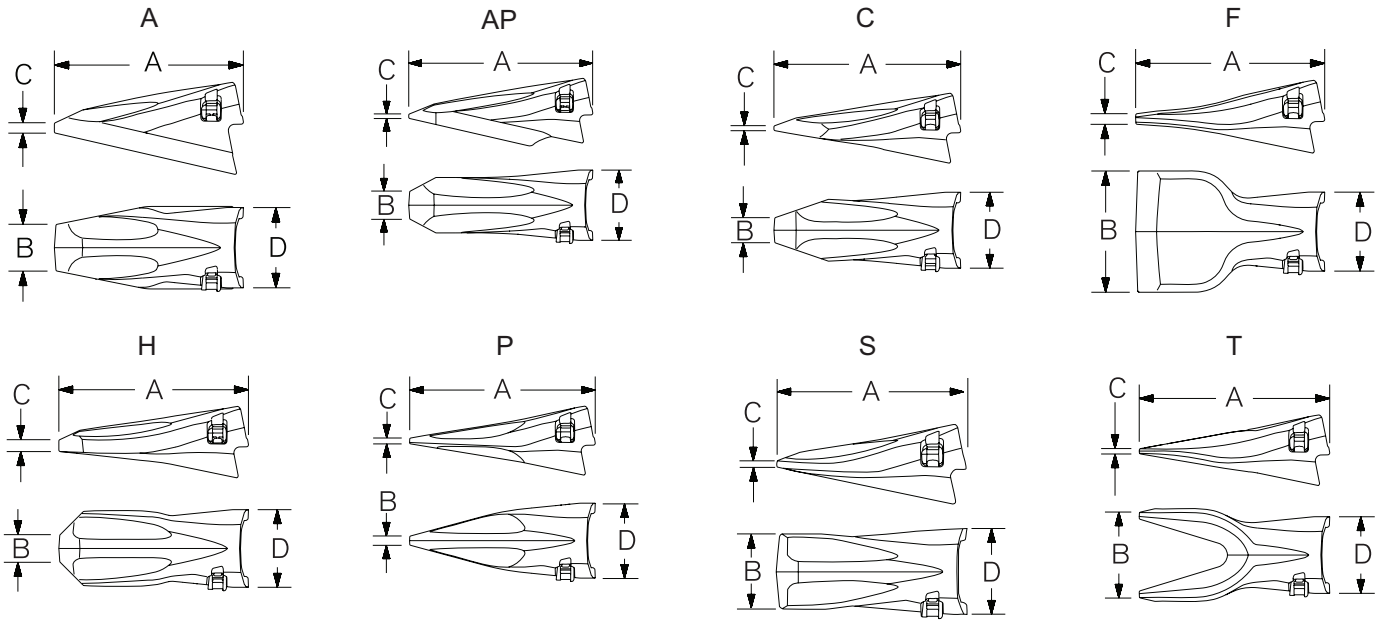

U45 Points

PART ID	DESCRIPTION	A	B	C	D	WEIGHT kg/lb
		LENGTH mm/in	BIT WIDTH mm/in	BIT THICKNESS mm/in	OUTSIDE BOX WIDTH mm/in	
U45A	Abrasion	351 / 13.81	87 / 3.42	19 / 0.76	149 / 5.87	24 / 53
U45AP	Abrasion Penetration	390 / 15.36	58 / 2.26	10 / 0.39	149 / 5.87	20 / 44
U45C	Chisel	366 / 14.41	50 / 1.98	10 / 0.39	149 / 5.87	14 / 31
U45F	Flare	356 / 14.03	228 / 8.99	20 / 0.79	149 / 5.87	18 / 41
U45H	Heavy	364 / 14.33	51 / 2.01	22 / .86	149 / 5.87	17 / 37
U45P	Pick	369 / 14.53	19 / 0.73	12 / 0.46	149 / 5.87	11 / 25
U45S	Standard	328 / 12.93	129 / 5.07	13 / 0.52	149 / 5.87	14 / 30
U45T	Twin Pick	370 / 14.55	180 / 7.09	11 / 0.42	149 / 5.87	14 / 30

Weld-on Nose

PART ID	DESCRIPTION	A	B	C	WEIGHT kg/lb
		WIDTH mm/in	HEIGHT mm/in	J-GROOVE mm/in	
WN-U45	Weldon Nose	144/5.67	138/5.42	33/1.28	11.0/24.2

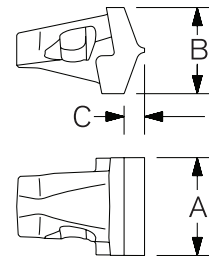

Ultralok Tooth System U45

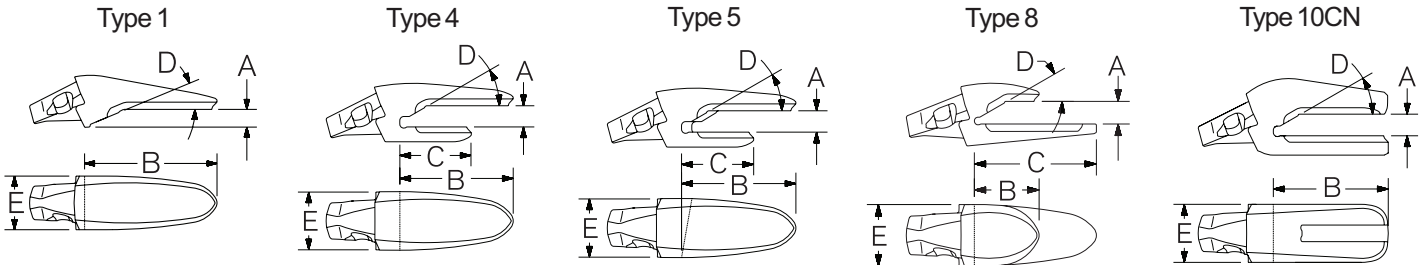

U45 Adapters

PART ID	TYPE	DESCRIPTION	A	B	C	D	E	NOSE	WEIGHT	MACHINE
			LIP THICKNESS mm/in	TOP LEG mm/in	BOTTOM LEG mm/in	RAMP ANGLE deg	ADAPTER WIDTH mm/in	ANGLE deg		
Excavator										
5856-U45	8	1-1/2 Bottom Leg	50 / 2.00	151 / 5.96	285 / 11.22	30	144 / 5.67	10	23 / 50	EXC
3811A-U45	8	1-1/2 Bottom Leg	60 / 2.25	151 / 5.94	285 / 11.22	30	144 / 5.67	10	22.4 / 49.3	EXC
3810B-U45	8	1-1/2 Bottom Leg	45 / 1.75	151 / 5.95	285 / 11.22	30	144 / 5.67	10	21.7 / 47.9	EXC
Wheel Loader										
1812L-U45	5	1-1/2 Top Leg Spade	50 / 2.00	283 / 11.15	179 / 7.03	30	144 / 5.67	15	28 / 62	Loadmaster
1812R-U45	5	1-1/2 Top Leg Spade	50 / 2.00	283 / 11.15	179 / 7.03	30	144 / 5.67	15	28 / 62	Loadmaster
1837A-U45	4	1-1/2 Top Leg	50 / 2.00	283 / 11.15	179 / 7.03	30	144 / 5.67	15	27 / 60	Loadmaster
8854-U45	10CN	Straddle Leg	50 / 2.00	283 / 11.15	285 / 11.22	30	144 / 5.67	15	41 / 90	Loadmaster
1810-U45	4	1-1/2 Top Leg	50 / 2.00	283 / 11.15	179 / 7.03	22.5-25	144 / 5.67	15	27.6 / 61.0	FEL
1810R-U45	5	1-1/2 Top Leg Spade	50 / 2.00	283 / 11.15	179 / 7.03	22.5-25	144 / 5.67	15	27.8 / 61.2	FEL
1810L-U45	5	1-1/2 Top Leg Spade	50 / 2.00	283 / 11.15	179 / 7.03	22.5-25	144 / 5.67	15	27.8 / 61.2	FEL
1836-U45	1	Flushmount	50 / 2.00	323 / 12.71	N/A	25-30	144 / 5.67	15	22.4 / 49.4	FEL

Ultralok Tooth System U55

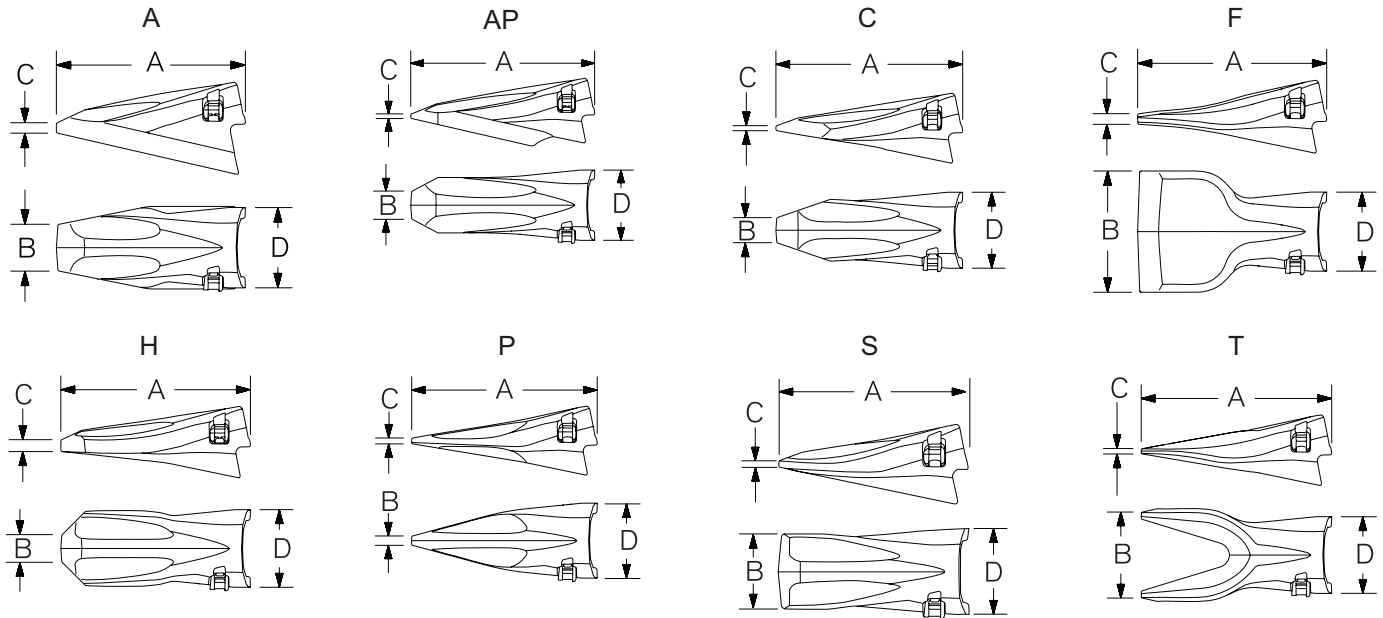

U55 Points

PART ID	DESCRIPTION	A	B	C	D	WEIGHT kg/lb
		LENGTH mm/in	BIT WIDTH mm/in	BIT THICKNESS mm/in	WIDTH AT EARS mm/in	
U55A	Abrasion	397 / 15.62	98 / 3.86	21 / .82	169 / 6.66	35.0 / 77.2
U55AP	Abrasion Penetration	442 / 17.41	67 / 2.64	11 / .42	169 / 6.66	29.7 / 65.5
U55C	Chisel	415 / 16.34	57 / 2.24	11 / .42	169 / 6.66	20.6 / 45.4
U55F	Flare	397 / 15.63	254 / 9.99	22 / .88	169 / 6.66	26.1 / 57.5
U55H	Heavy	413 / 16.25	58 / 2.28	22 / .87	169 / 6.66	24.5 / 55.0
U55P	Pick	420 / 16.52	22 / .85	14 / .54	169 / 6.66	16.5 / 36.6
U55S	Standard	372 / 14.65	155 / 6.08	16 / .63	169 / 6.66	20.5 / 44.9
U55T	Twin Pick	419 / 16.50	204 / 8.05	13 / .51	169 / 6.66	20.0 / 44.1

Weld-on Nose

PART ID	DESCRIPTION	A	B	C	WEIGHT kg/lb
		WIDTH mm/in	HEIGHT mm/in	J-GROOVE mm/in	
WN-U55	Weldon Nose	Future Availability			

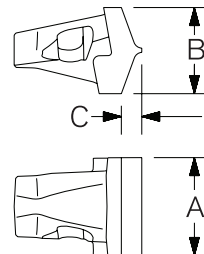

Ultralok Tooth System U55

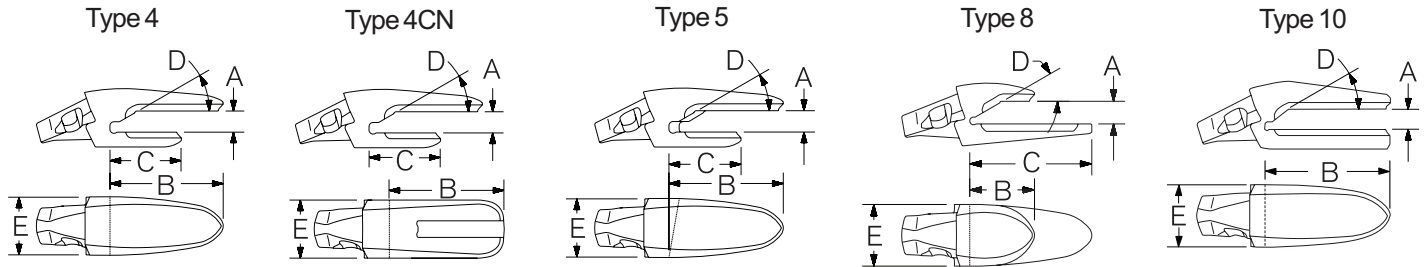

U55 Adapters

PART ID	TYPE	DESCRIPTION	A	B	C	D	E	NOSE	WEIGHT	MACHINE
			LIP THICKNESS mm/in	TOP LEG mm/in	BOTTOM LEG mm/in	RAMP ANGLE deg	ADAPTER WIDTH mm/in	ANGLE deg		
Excavator										
5857A-U55	8	1-1/2 Bottom Leg	65 / 2.50	164 / 6.45	302 / 11.88	30	163 / 6.44	10	32.3 / 71.3	EXC
8801A-U55	8	1-1/2 Bottom Leg								
3811A-U55	8	1-1/2 Bottom Leg	60 / 2.38	164 / 6.45	302 / 11.88	30	163 / 6.44	10	32.5 / 71.6	EXC
3858A-U55	8	1-1/2 Bottom Leg	70 / 2.75	164 / 6.45	302 / 11.88	30	163 / 6.44	10	31.8 / 70.1	EXC
Wheel Loader										
4831A-U55	10	2 Leg	50 / 2.00	330 / 12.99	330 / 12.99	38	163 / 6.44	15	43.0 / 94.8	Hot Slag
1852-U55	1	Flushmount	60 / 2.38 and 65 / 2.50	331 / 13.02	N/A	30	163 / 6.44	15	32.5 / 71.7	FEL (Straight or Spade)
8813A-U55	4	1-1/2 Top Leg	65 / 2.50	321 / 12.63	196 / 7.70	22.5-25	163 / 6.44	15	34.6 / 76.2	Loadmaster
8813LA-U55	5	1-1/2 Top Leg	65 / 2.50	321 / 12.65	196 / 7.71	22.5-25	163 / 6.44	15	33.2 / 73.1	Loadmaster
8813RA-U55	5	1-1/2 Top Leg	65 / 2.50	321 / 12.65	196 / 7.71	22.5-25	163 / 6.44	15	33.2 / 73.1	Loadmaster
5870A-U55	4CN	1-1/2 Top Leg Straddle	65 / 2.50	318 / 12.52	131 / 5.17	22.5-25	163 / 6.44	15	36.2 / 79.6	Loadmaster