

Royal Prefab introducing
Container homes designs





Design 1

26.1 m²



Design 2

26.1 m²

One 20ft container can fit 1 units, one 40HQ container can fit 3 units.

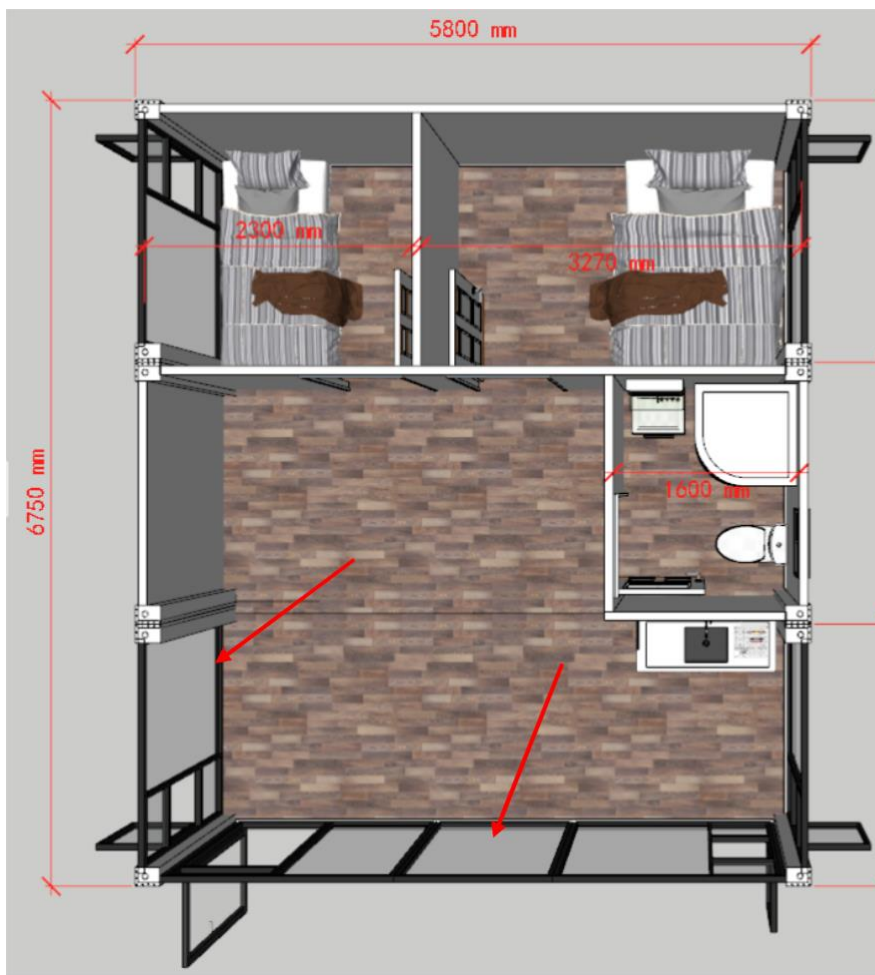

Design 3

37.665m²

The difference is big glass

Design 4

37.665m²

One 40HQ container can fit 2 units.

Design 3 and design 4
can add or remove terrace





Design 5
65.25m²



Design 6
65.25m²

One 40HQ container can fit 1 unit.

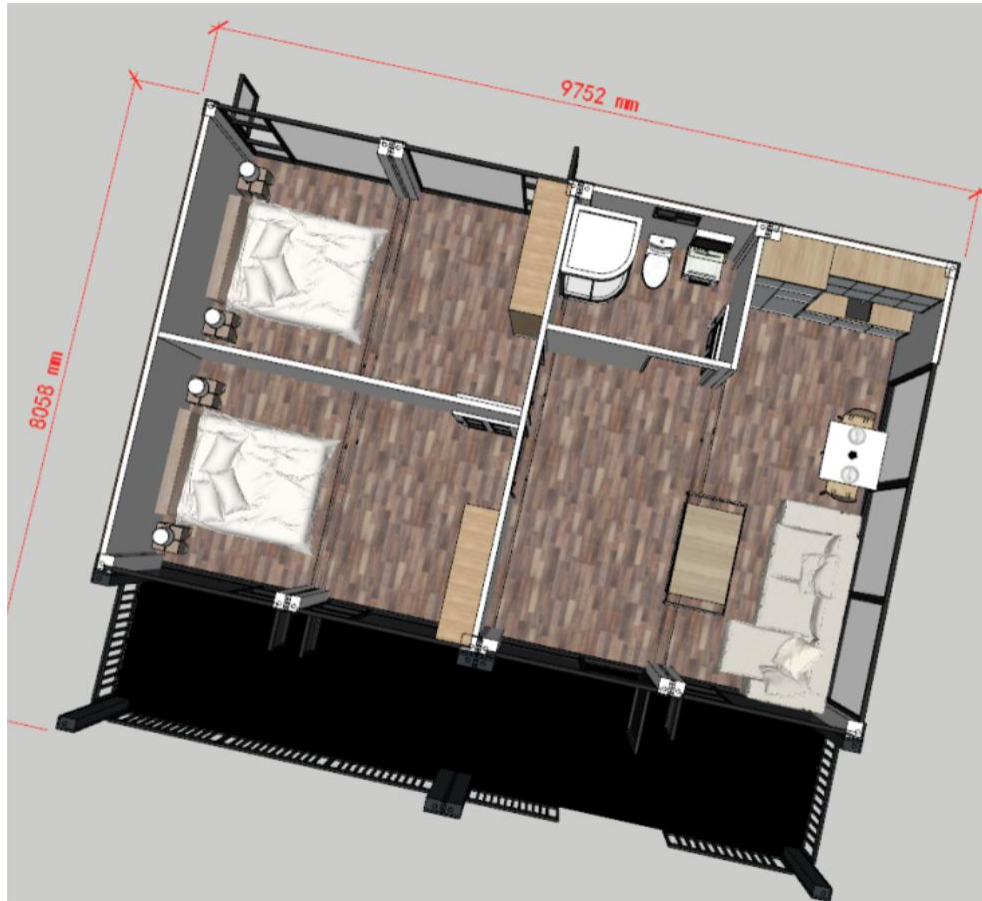

Design 7
78.58m²

One 40HQ container can fit 1 unit.

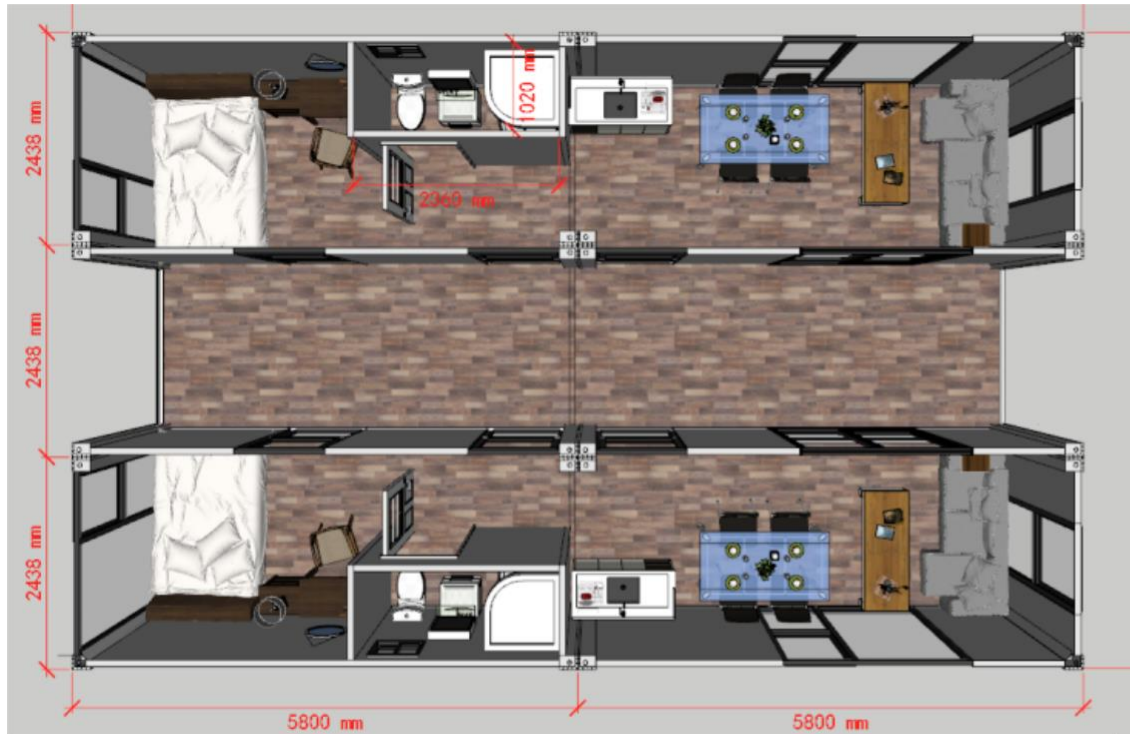

Design 8
84.84m²



One 40HQ container can fit 1 unit.



Design 9
104.4m²



Design 10
65.25m²



One 40HQ container can fit 1 unit.

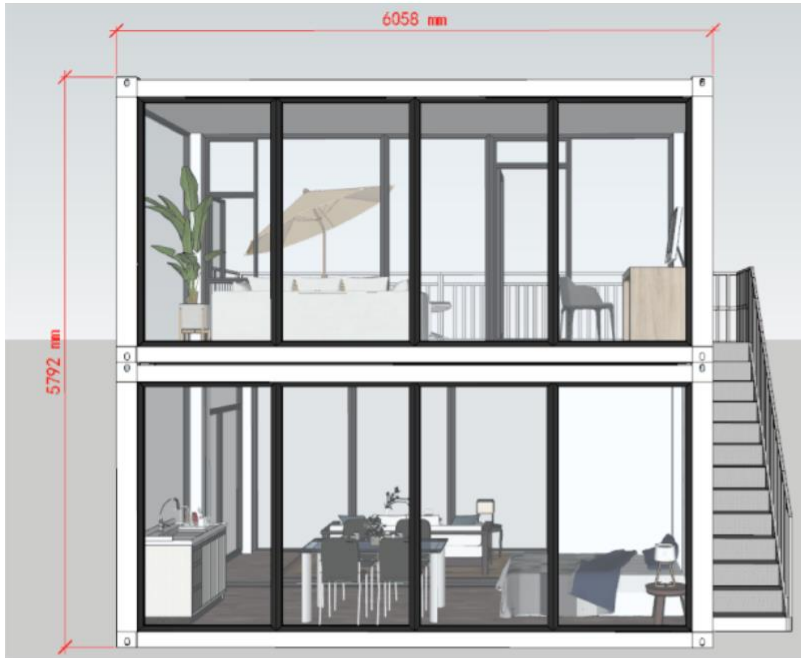

Design 11
44.31m²

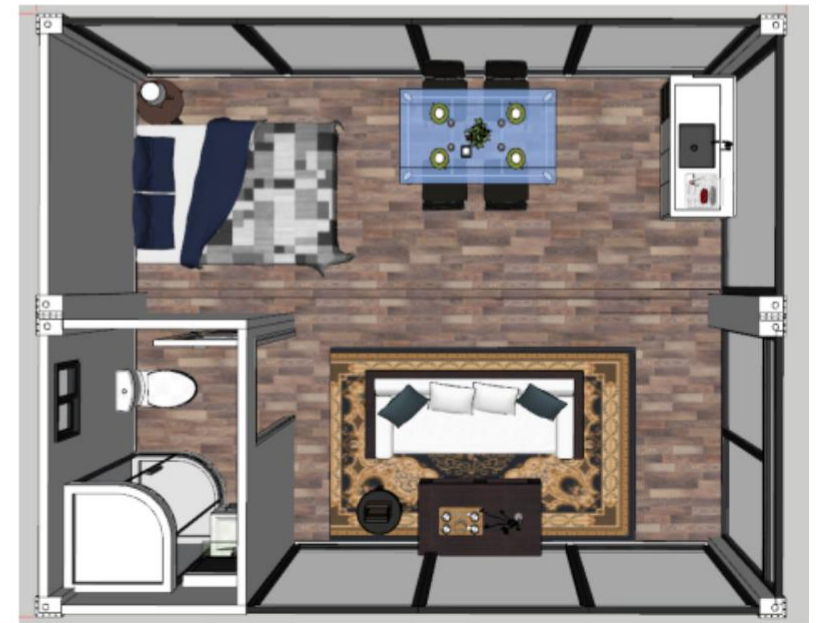



Design 12
52.2m²





Coffee shop

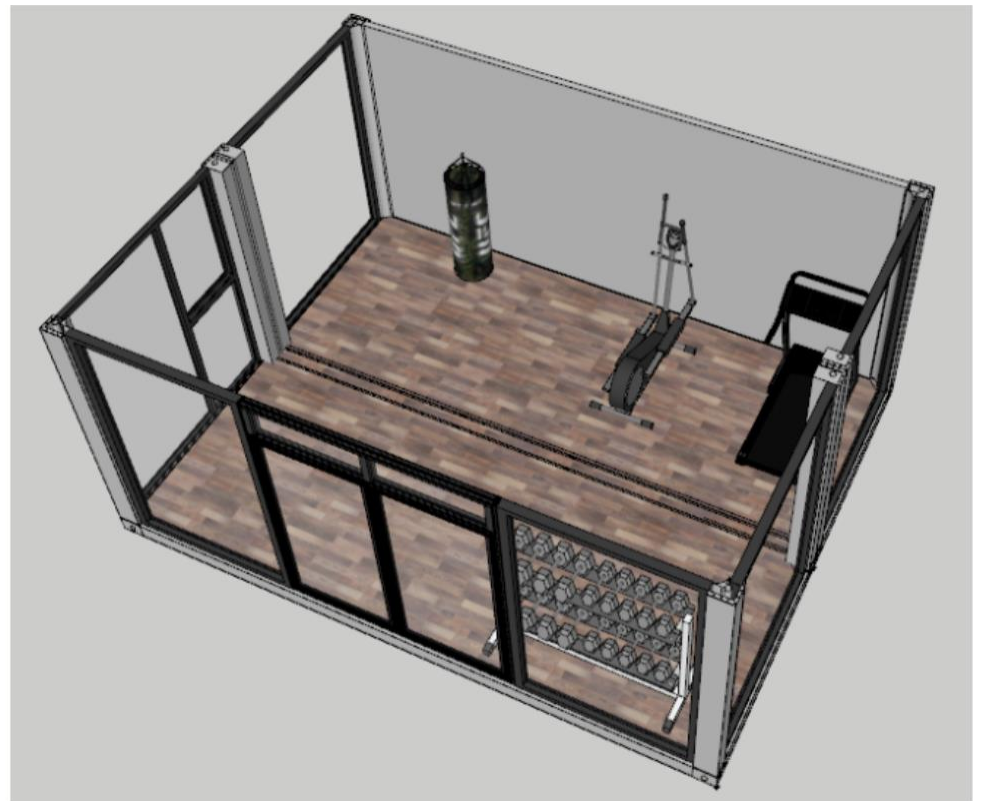

Gym

One 20ft container can fit 2 units, one 40HQ container can fit 6 units.



Store



Hotel



office
24 containers
339.37m²





Coffee shop
12 containers
169.68m²

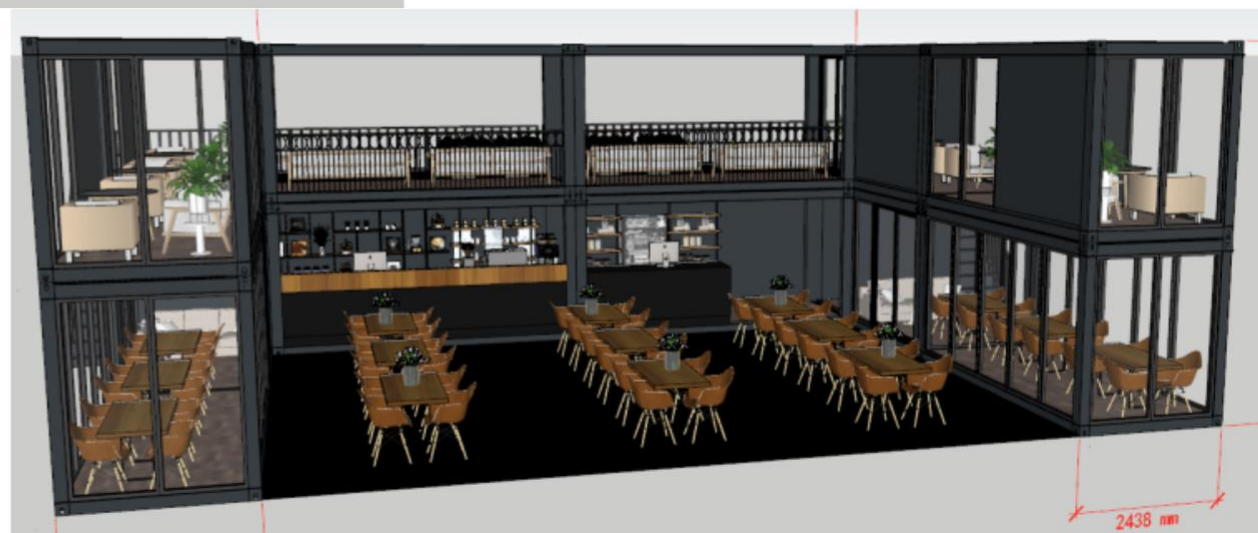

Optional frame color



RAL 9016
Traffic white
(Standard color)

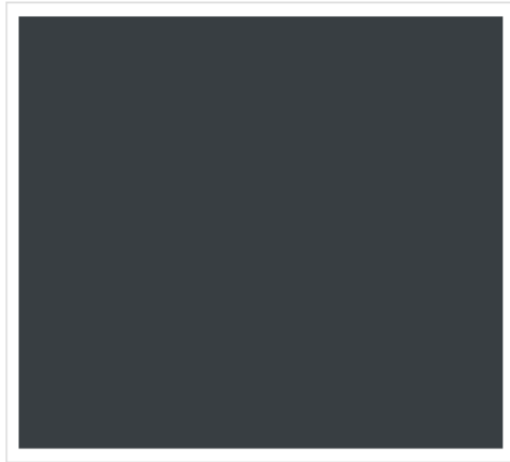

RAL 7016
Anthracite grey

75USD/UNIT for color chagement



RAL 2009
Traffic
orange

75USD/UNIT for color chagement



RAL 1001
Brown beige
75USD/UNIT for color chagement



Frame color

Optional frame color



RAL 5005

Signal blue

75USD/UNIT for color chagement



RAL 5013

Cobalt blue

75USD/UNIT for color chagement



RAL 5023

Distant blue

75USD/UNIT for color chagement



Optional Wall panel surface



RAL 9016
Traffic white
(standard color)

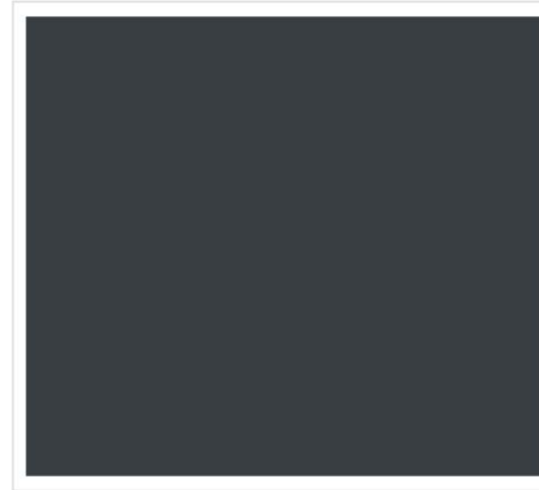

RAL 7016 Anthracite
grey



Optional exterior wall cladding 3.5mm WPC wall cladding

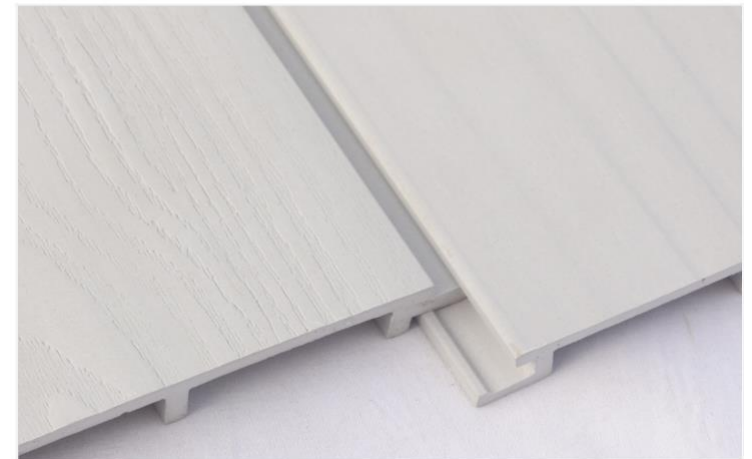
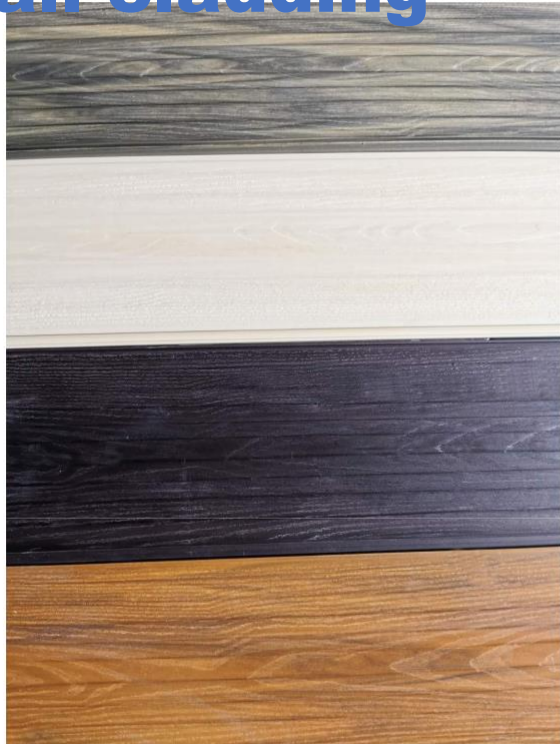

Optional exterior wall cladding

100mm EPS board

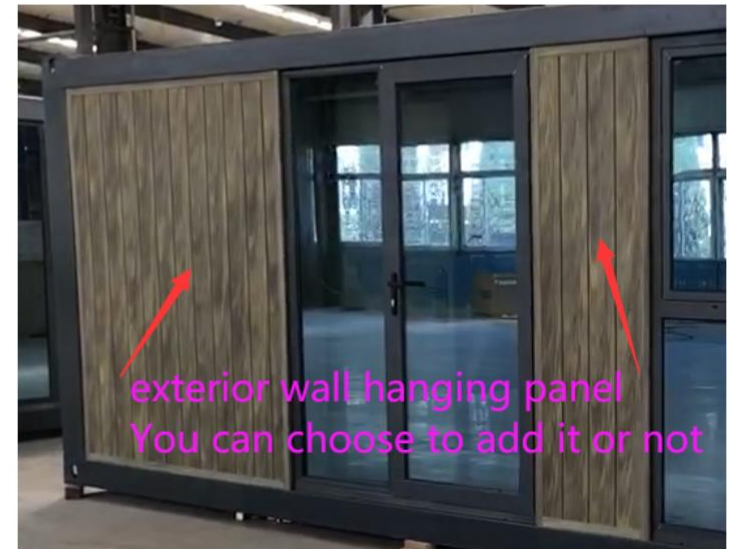
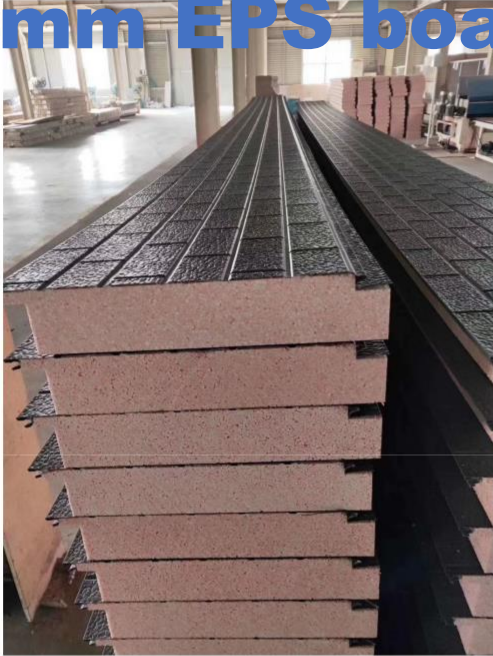

Selective colors for floor 4mm thickness SPC floor



Selective Color

Interior wall cladding

8mm thickness PVC wall cladding

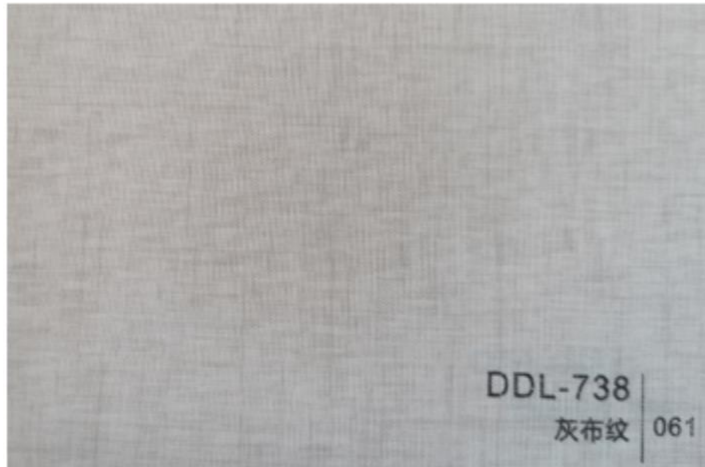
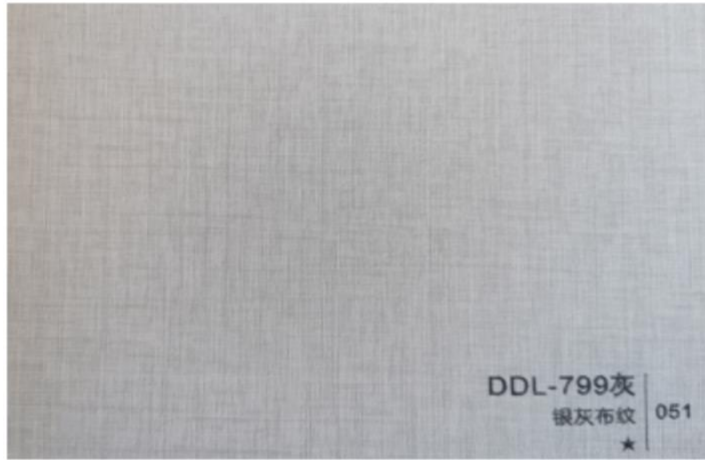

Cloth pattern

You can choose
to add it or not

