



## MINING CLAIM FILING INFORMATION 2018-19

### NEW CLAIM FILING:

#### BLM

File a **copy** of your Notice of Location of Mining Claim including a map showing the location along with the fees within 90 days of the date of location of the claim.

#### PLACER CLAIMS

Pay a \$155 maintenance fee, plus the \$37 location fee, plus the \$20 processing fee, for every 20 acres or portion thereof. As an example, for a new 20 acre claim BLM fees would be \$212.

#### LODE - MILL SITE - TUNNEL SITE CLAIMS

Pay a \$155 maintenance fee, plus the \$37 location fee, plus the \$20 processing fee for a total of \$212.

#### COUNTY RECORDER

Record the **original** Notice of Location of Mining Claim including a map showing the location along with the fees within 90 days of the date of location of the claim.

#### RECORDING FEES - NEW CLAIMS

Pay fees of **\$14** for the first page of document and **\$3** for each additional page, including map.

**NEW FOR 2018! Affordable Housing Tax** - The State now requires all county recorder offices to collect a **\$75** Affordable Housing and Jobs Tax on their behalf and transmit the funds to them. Your documents will be returned to you **unrecorded** if you do not include the tax in your payment of recording fees.

#### FORMS

Get forms here:

##### Notice of Location Placer

<http://www.plumascounty.us/DocumentCenter/View/12315>

##### Notice of Intent to Hold

<http://www.plumascounty.us/DocumentCenter/View/11227>

##### Affidavit of Assessment/

##### Proof of Labor

<http://www.plumascounty.us/DocumentCenter/View/10625>

#### Plumas County Recorder

520 Main Street Room 102

Quincy, CA 95971

Phone: (530)-283-6218

#### Bureau of Land Management

Information Access Center, California State Office

2800 Cottage Way, Ste. W-1623

Sacramento, CA 95825

Phone: (916)-978-4400

# MAP EXAMPLE

Where possible, placer claims are to be located by legal subdivision, such as the E1/2NE1/4NE1/4, Section 2, Township 10 South, Range 21 East, Mount Diablo Meridian (30 U.S.C. § 35 and 43 CFR 3832, Subparts A and B). An individual may claim a placer claim with a maximum size of 20 acres (see Figure 2). An association of two locators may locate 40 acres, and three may locate 60 acres, etc. The maximum area of an association placer claim permitted by law is 160 acres for eight or more persons.

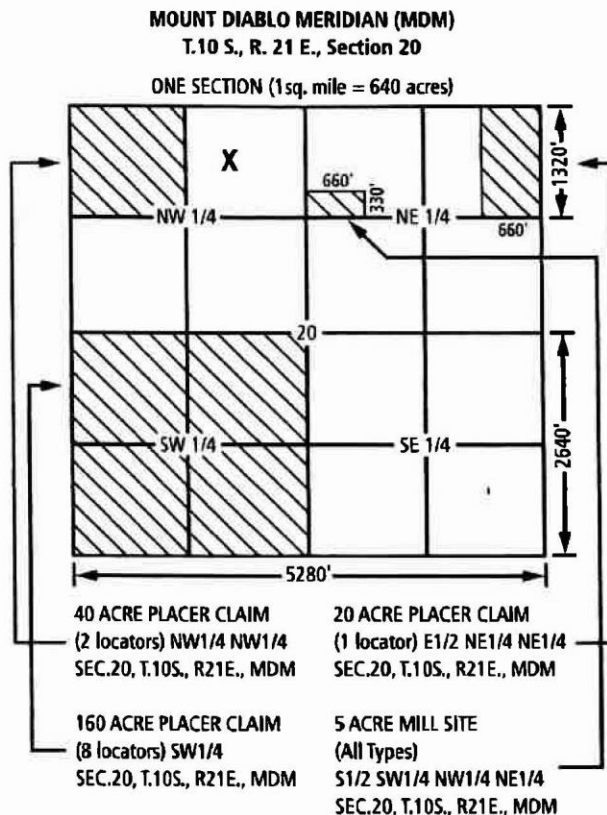

Drawing of a section of land showing different sizes of placer mining claims and a mill site. The legal description method is based on the Public Land Survey System.

## ANNUAL MAINTENANCE FEES

The Bureau of Land Management issued a rule that changes the way placer mining claim maintenance fees are assessed. The rule implements the Consolidated Appropriations Act of 2012 which requires the BLM to collect maintenance fees for placer mining claims based on the total acreage contained in the claim, rather than by the claim.

| If...                              | Then...  | Due  |
|------------------------------------|--|--|
| You have a placer mining claim     | You pay \$155 for every 20 acres or portion thereof.   | Sept. 1, 2018.   |
| You have a Small Miners Waiver     | You are not affected by the new rule. Please see instructions below for filing a Small Miners Waiver.  | Sept. 1, 2018.   |
| You file a new placer mining claim | You pay \$212 for each new location and you pay \$155 for every 20 acres or portion thereof up to 160 acres maximum. For example: A 20 acre claim = \$367 (\$212 + \$155). A 40 acre claim = \$522 (\$212 + \$155+\$155). All new locations must pay \$212, plus \$155 for every 20 acres or portion thereof, even if your "location date" on your form is August 31st of the current year. Claims will expire the next day if you do not file on time. File by September 1st of the current year, pay the Maintenance Fee of \$155 for every 20 acres or portion thereof to the Sacramento Office or turn in the Small Miners Waiver. The Notice of Intent to Hold (NOI) and \$10 per mining claim/site processing fee is due to the BLM Sacramento Office by December 30, 2018, or you may file the NOI earlier. | Upon filing<br><i>(within 90 days from date of location)</i> |

### DUE ON OR BEFORE SEPTEMBER 1, 2018

Pay the 2018 Maintenance Fee of \$155 per lode claim. For placer claims only, pay \$155 per every 20 acres or portion thereof, on or before September 1, 2018. For example: The 2018 maintenance fee payment on an 80 acre placer claim is \$580 but if the placer claim contains 80.25 acres you pay \$735.

**OR**

### QUALIFYING FOR THE 2017 SMALL MINER'S WAIVER

You may qualify for a Small Miner's Waiver if **all owners** listed on the small miner's waiver **own ten or fewer claims and/or sites nationwide**. All claims, mill and tunnel sites must be listed on the Small Miner's Waiver. The Small Miner's Waiver must contain the **original signatures (in blue ink) of all owners**. If an agent signs for the owners, a notarized designation of the agent, signed by all owners, must be on file with the BLM or be submitted with the waiver. An agent signing the waiver for more than one owner, must (i.e. 5 claimants requires 5 signatures by the agent).

File a 2018 Maintenance Fee Waiver Certification with the BLM, Form 3830-2 (commonly referred to as a Small Miner's Waiver) on or before September 1, 2018. There is **no charge** for filing a Small Miner's Waiver. The county recorder does not record this document.

**No curable notices will be issued, or extra time allowed for insufficient 2018 Maintenance Fee payments.**

#### **AND**

Because you file the 2018 Small Miner's Waiver, you must **ALSO** file the following ON OR BEFORE DECEMBER 30, 2018:

For placer and lode claims listed on the Small Miner's Waiver, you must file a 2018 **Affidavit of Assessment Work/Proof of Labor** along with the **\$10 processing fee** per claim, with the BLM. For mill or tunnel sites listed on the Small Miner's Waiver, you must file a 2018 Notice of Intent to Hold or, write on the Small Miner's Waiver that it serves as a Notice of Intent to Hold for the mill or tunnel site listed on the waiver and include the **\$10 processing fee** per site to BLM.

**BLM highly recommends that you file your Affidavit of Assessment Work and/or the Notice of Intent to Hold at the same time you file your 2018 Small Miner's Waiver.**

***IMPORTANT REMINDER: For those who filed a Small Miner's Waiver last year (by September 1, 2017), you must file your 2018 Affidavit of Assessment Work on or before December 30, 2018, regardless of whether you pay the \$155 Maintenance Fee for 2018.***

#### **BE ALERT! FILING REQUIREMENTS ARE SUBJECT TO CHANGE!**

As an owner of mining claims, YOU ARE RESPONSIBLE for keeping yourself informed of the changes in the filing requirements and the mining laws. It is suggested that you contact the BLM office periodically to stay up to date. Visit the website at <https://www.blm.gov/programs/energy-and-minerals/mining-and-minerals/about/california> . To check the status of mining claims go to <https://reports.blm.gov/content/lr2000/about/> .

#### **BLM FORMS**

Call (916) 978-4400 to obtain or download at:

#### **Maintenance Fee Waiver Forms and Maintenance Fee Payment Forms for Claims**

**[https://www.blm.gov/sites/blm.gov/files/3830-002\\_0.pdf](https://www.blm.gov/sites/blm.gov/files/3830-002_0.pdf)**

#### **Maintenance Fee Waiver Certification**

**[https://www.blm.gov/sites/blm.gov/files/3830-002\\_0.pdf](https://www.blm.gov/sites/blm.gov/files/3830-002_0.pdf)**

The Maintenance Fee Waiver Certification Form is MANDATORY. There is no charge for filing a Small Miner's Waiver.

## MAINTENANCE FEE SCHEDULE - BLM

| ACREAGE OF CLAIM      | FEE TO PAY BLM |
|-----------------------|----------------|
| 1 through 20 Acres    | \$155          |
| 21 through 40 Acres   | \$310          |
| 42 through 60 Acres   | \$465          |
| 61 through 80 Acres   | \$620          |
| 81 through 100 Acres  | \$775          |
| 101 through 120 Acres | \$930          |
| 121 through 140 Acres | \$1,085        |
| 141 through 160 Acres | \$1,240        |

### **WHERE TO FILE:**

Bureau of Land Management  
Information Access Center  
California State Office 2800 Cottage Way, Ste. W-1623  
Sacramento, CA 95825  
(916) 978-4400

### **WHERE TO RECORD:**

Plumas County Recorder  
520 Main Street Room 102  
Quincy, CA 95971  
(530)-283-6218

### **County Recorder Office Forms - Download at:**

#### **Assessment Work/Proof of Labor**

<http://www.plumascounty.us/DocumentCenter/View/10625>

#### **Notice of Intent to Hold**

<http://www.plumascounty.us/DocumentCenter/View/11227>

In addition to filing with the BLM, record a 2018 Affidavit of Assessment Work (Proof of Labor form) or Notice of Intent to Hold with the County Recorder's office.

NOTE: If you paid the MAINTENANCE FEE rather than filing a SMALL MINER'S WAIVER, indicate on your county recording that you have paid the 2018 Maintenance Fee to the BLM and the date on which you paid.

If you would like a date stamped copy of your recorded document, provide the copy and a self-addressed, stamped envelope and your copy will be returned to you promptly.

**RECORDING FEES**

Pay fees of **\$14** for the first page of document and **\$3** for each additional page.

**NEW FOR 2018! Affordable Housing Tax** - The State now requires all county recorder offices to collect a **\$75** Affordable Housing and Jobs Tax on their behalf and transmit the funds to them. Your documents will be returned to you **unrecorded** if you do not include the tax in your payment of recording fees.

Per Local Ordinance, property taxes due must be paid **prior to recording your document**. Your tax payment and document may be mailed together, but please provide separate checks for payment of taxes and payment of recording fees.

**Plumas County Clerk-Recorder**  
**Street Room 102**  
**Quincy CA 95971**  
**(530) 283-6218**

**Plumas County Tax Collector 520 Main**  
**PO Box 176**  
**Quincy CA 95971**  
**(530) 283-6260**

*THIS FILING AND RECORDING INFORMATION PROVIDED BY THE BUREAU OF LAND MANAGEMENT, CALIFORNIA STATE OFFICE, AND WAS PRINTED AS A COURTESY OF THE PLUMAS COUNTY RECORDER'S OFFICE. FOR ADDITIONAL CLAIM INFORMATION CONTACT THE BLM.*

01-01-2018