

**WBT** LLC

PERFORMANCE CABLETRAY™

# PERFORMANCE CABLETRAY™

What exactly is performance cabletray? Look no further.

WBT was created to offer the best in cable management products to the market today. WBT's industry leaders reviewed every tray construction, hardware bracket and splice solution, asking, how can we make it better, easier and faster to install?

We often make the point that WBT solves installation problems that many didn't even know they had. We are a company of 'firsts'. We manufacture the best, most robustly constructed products in today's market. We ship faster and we service our customers to a level that few companies do today, with unparalleled leadtimes and customer service.

Our premise is simple. A higher quality 'PERFORMANCE' cabletray, 100% manufactured in the U.S., utilizing 100% domestic recycled steel, with minimized environmental impact finishes. WBT offers better cabling support, opportunities for LEED submittal documentation, and engineering support. Our Shaped Wire (*Patented*) constructions are documented to decrease pressure/strain on high performance cabling up to 65%.

Today, a majority of the industry trends towards cheap tray constructions with thinner, weaker wires, and leadtimes measured in weeks, not days. Most don't even make their own products. Instead, it's farmed out to be contract manufactured by others. This is not the WBT business model.

WBT is a company designed and created with a sole purpose, to provide the BEST in mesh cabletray, while supporting you and your customers with the most innovative and creative products in the market, period.

Welcome to WBT, where we are shaping the future in cabletray. Browse through our catalog and see the results of almost 45 years of combined mesh experience, new ideas and fresh approaches to your needs.



# SHAPED CROSSWIRE

All wire tray manufacturers utilize round wire in the construction of their trays. Today, unfortunately, the trend is towards smaller, cheaper, lighter gauge constructions. The problem is that high performance cabling installed in the tray today has evolved several generations.

A round crosswire supporting a round cable offers very little surface area support. When you add additional cables, the weight creates a pressure point/strain on the cables within the tray. What WBT has pioneered is a design utilizing shaped crosswires, which increases the support of your critical cabling.

WBT's shaped crosswires eliminate cable stress by increasing the support of the cabling, yet still offers the same functionality of wire tray to cut and configure, and utilizes the same splicing and mounting hardware.

WBT does offer the full round wire configuration, if preferred, or for industrial or electrical applications where you're not facing the same performance issues, or where inserts are being utilized.

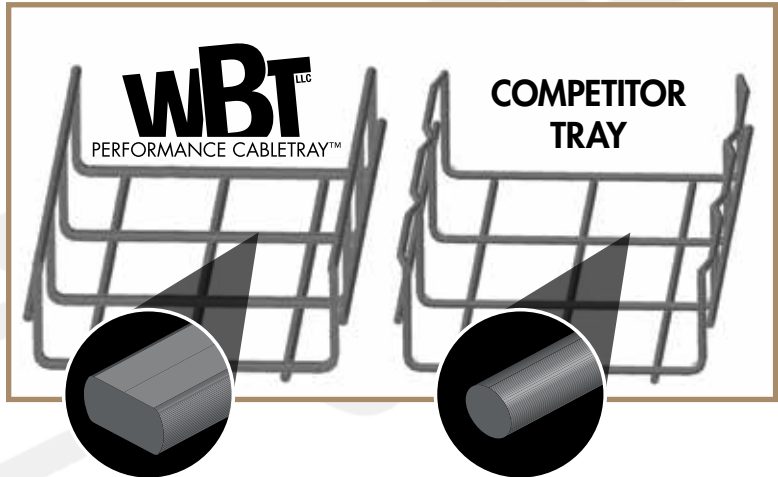

## CABLE PRESSURE REDUCTION

CONTACT AREA SQUARE INCH	FLAT LOAD LBS.	WIRE PRESSURE PSI	BENDING STRAIN INCHES	CONTACT AREA SQUARE INCH	ROUND LOAD LBS.	WIRE PRESSURE PSI	BENDING STRAIN MICROINCHES	DECREASE IN STRAIN FLAT VS. ROUND
.03125	.1291	4.1	18	.00781	.1291	16.5	24	<b>33.3%</b>
.03125	.1876	6.0	27	.00781	.1876	24.0	44	<b>63.0%</b>
.03125	.2507	8.0	38	.00781	.2507	32.1	61	<b>60.5%</b>
.03125	.3168	10.1	51	.00781	.3168	40.6	74	<b>45.1%</b>
.03125	1.1023	35.3	113	.00781	1.1023	141.1	187	<b>65.5%</b>

\* Please contact WBT for our independent study testing round versus WBT's shaped wire constructions.

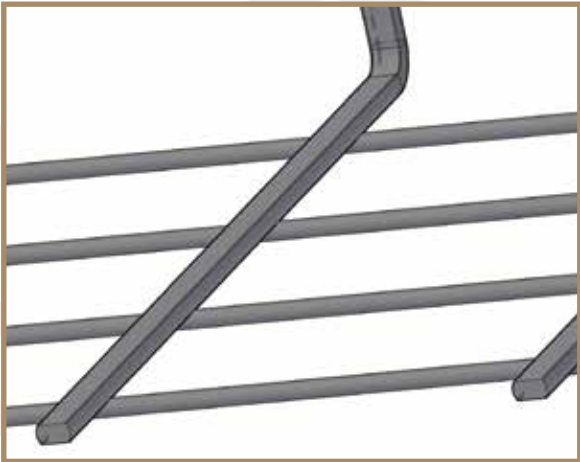
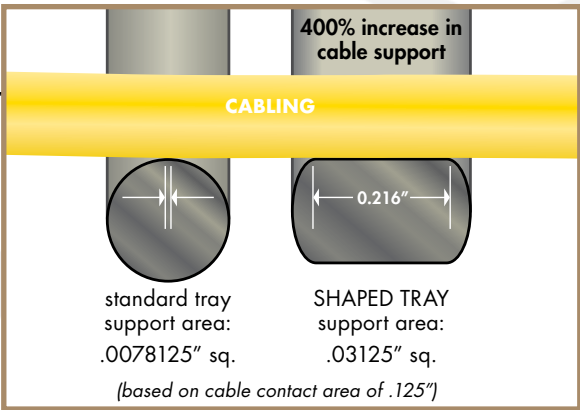

## OUR SHAPED WIRE OFFERS:

- A Minimum 400% Increase in Cabling Support
- Up To 65% Reduction in Cabling Pressure/Strain (see table)\*
- 100% Domestic Recycled Content
- 100% Domestic Manufactured Tray
- Cuts, Configures and Splices the Same
- No Premium over Competitors 'Old Round Crosswire'

# INNOVATIONS FROM WBT

WBT is always looking for ways to help customers reduce costs and labor, while keeping our products at the leading edge of the marketplace. Our newest innovations include:

WBT PreForm, WBT NoSplice and WBT's Configurator

## WBT PreForm PATENTED

Preformed radius/tee/intersections that saves installation time and labor. No field cutting or configuration, simply install as you would a straight section. Maintains UL classification for fitting.

## WBT NoSplice PATENT PENDING

We've redesigned our most popular support hardware for double duty: tray support and splice point. No more butt splicing each section juncture. Maintains UL classification for fitting.

## UL CLASSIFIED PAINTED TRAY

If you prefer a painted tray, no problem. Most manufacturers require you to remove the paint at the splicing points to complete an electrical ground (for UL and cUL classifications). **All of WBT's tray sections are UL Classified when they leave the factory. There is no labor and time in field removal of the paint.** Simply splice the trays as you would any galvanized sections, and you're compliant.

WBT offers black, white and pewter as standard colors. Other custom colors are available with minimal leadtimes.

## T-WELD ON ALL TRAY CONFIGURATIONS

WBT provides a T-Weld edgewire on all of its tray configurations. This product design provides protection for both the installer and the cabling from any sharp points within the tray. (excludes stainless constructions)

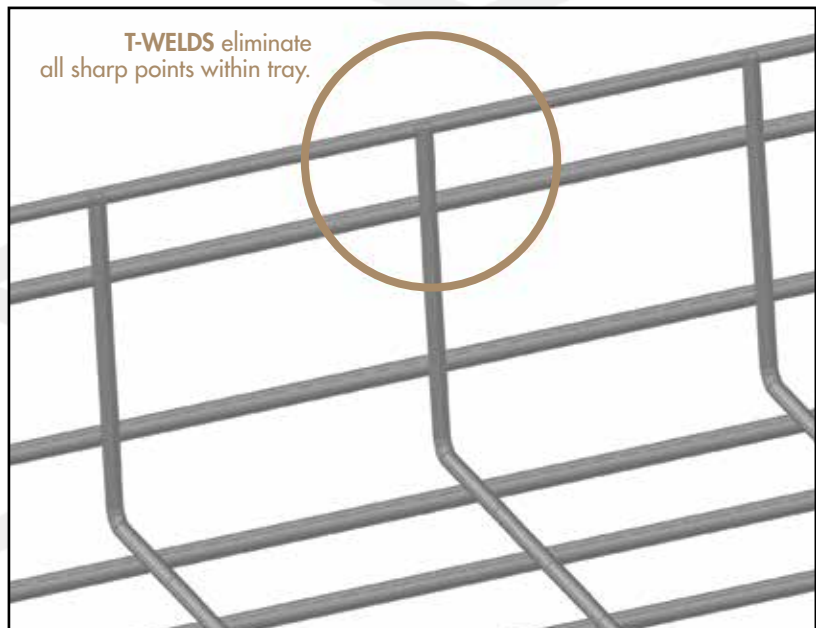







## WBT GREEN POINTS

- Utilizing 100% domestic recycled steel content in the manufacturing of our trays
- MillCerts are available to document recycled content for possible LEED credits/certification
- No post production chemical cleaning and plating (*a huge environmental impact*)
- WBT utilizes kraft packaging (*no bleaching white*). Packaging and strapping are recyclable





WBT trays are available in a wide variety of finishes to meet the environmental or aesthetic requirements of your installations. Use the chart below to find the finish suffix that will meet your needs.

Finish codes: WBT2x4 BL = Tray Depth x Width x Finish  
 Notate finish code when ordering trays and fittings.

Suffix	Finish	Specifications	Use	UL/cUL
no suffix required	Pre-Galvanized Finish applied before fabrication	ASTM A641	Limited industrial & interior applications recommended	 on sizes below when spliced as recommended
<b>ZP</b>	Electro Zinc Plating	ASTM B633	Controlled interior applications	 on sizes below when spliced as recommended
<b>PW</b>	Pewter Powder Coated Finish applied after fabrication	N/A	Controlled interior applications	 on sizes below when spliced as recommended
<b>BL</b>	Black Powder Coated Finish applied after fabrication	N/A	Controlled interior applications	 on sizes below when spliced as recommended
<b>WH</b>	White Powder Coated Finish applied after fabrication	N/A	Controlled interior applications	 on sizes below when spliced as recommended
<b>CUSTOM</b> See WBT for suffix	Custom Powder Coated Finish applied after fabrication	N/A	Controlled interior applications	 on sizes below when spliced as recommended
<b>304L &amp; 316L</b>	304L Stainless Steel & 316L Stainless Steel	ASTM A580	Food preparation, wash-down areas, highly corrosive applications & marine environments	

## UL CLASSIFIED & cUL CLASSIFIED ON PAINTED TRAY

WBT offers powder coated tray that is UL Classified and cUL Classified as an equipment ground conductor. No field removal of the paint is required.

	2" depth	4" depth	6" depth	8" depth
	ROUND / SHAPED	ROUND / SHAPED	ROUND / SHAPED	ROUND / SHAPED
	<b>*WBT2x4 S</b>	WBT4X6 / WBT4x6 S	WBT6X8 / WBT6x8 S	WBT8X8 / WBT8x8 S
	WBT2x6 / WBT2x6 S	WBT4X8 / WBT4x8 S	WBT6X12 / WBT6x12 S	WBT8X12 / WBT8x12 S
	WBT2x8 / WBT2x8 S	WBT4X12 / WBT4x12 S	WBT6X16 / WBT6x16 S	WBT8X16 / WBT8x16 S
	WBT2x12 / WBT2x12 S	WBT4X16 / WBT4x16 S	WBT6X18 / WBT6x18 S	WBT8X18 / WBT8x18 S
	WBT2X16 / WBT2x16 S	WBT4X18 / WBT4x18 S	WBT6X20 / WBT6x20 S	WBT8X20 / WBT8x20 S
	WBT2X18 / WBT2x18 S	WBT4X20 / WBT4x20 S	WBT6X22 / WBT6x22 S	
	WBT2X20 / WBT2x20 S	WBT4x24 / WBT4x24 S	WBT6X24 / WBT6x24 S	
	WBT2X24 / WBT2x24 S			

**\*WBT is the only manufacturer that provides a UL Classified 2x4 tray construction, WBT2x4 S**

## 2" DEEP TRAY



SHAPED PART NUMBER	ROUND PART NUMBER	WIDTH	WT. per pc.	FILL*	LOAD lbs/ft	SPLICE quantity
WBT2X4 S	WBT2X4	4"	7 lbs	108	45	2
WBT2X6 S	WBT2X6	6"	9 lbs	163	50	4
WBT2X8 S	WBT2X8	8"	10.5 lbs	218	52	4
WBT2X12 S	WBT2X12	12"	12 lbs	326	58	4
WBT2X16 S	WBT2X16	16"	15 lbs	439	70	4
WBT2X18 S	WBT2X18	18"	23 lbs	495	70	4
WBT2X20 S	WBT2X20	20"	25 lbs	550	73	5
WBT2X22 S	WBT2X22	22"	27 lbs	600	73	5
WBT2X24 S	WBT2X24	24"	31 lbs	660	75	5
WBT2X26 S	WBT2X26	26"	33 lbs	671	73	6
WBT2X28 S	WBT2X28	28"	35 lbs	723	73	6
WBT2X30 S	WBT2X30	30"	38 lbs	826	70	6
WBT2X32 S	WBT2X32	32"	39 lbs	881	70	6
WBT2X34 S	WBT2X34	34"	41 lbs	894	CONSULT WBT FOR FACTORY SPECIFICATIONS	
WBT2X36 S	WBT2X36	36"	42 lbs	947		
WBT2X38 S	WBT2X38	38"	44 lbs	1000		
WBT2X40 S	WBT2X40	40"	45 lbs	1052		

Finished tray length is 118 3/16"

\*Fill is a theoretical calculation based on a .22" diameter cable and a 50% fill.

## 4" DEEP TRAY



SHAPED PART NUMBER	ROUND PART NUMBER	WIDTH	WT. per pc.	FILL*	LOAD lbs/ft	SPLICE quantity
WBT4X4 S	WBT4X4	4"	12 lbs	205	49	4
WBT4X6 S	WBT4X6	6"	13 lbs	310	49	5
WBT4X8 S	WBT4X8	8"	15 lbs	416	78	6
WBT4X12 S	WBT4X12	12"	23 lbs	621	78	6
WBT4X16 S	WBT4X16	16"	27 lbs	837	108	7
WBT4X18 S	WBT4X18	18"	29 lbs	942	116	7
WBT4X20 S	WBT4X20	20"	31 lbs	1047	116	7
WBT4X22 S	WBT4X22	22"	33 lbs	1152	116	8
WBT4X24 S	WBT4X24	24"	35 lbs	1257	116	8
WBT4X28 S	WBT4X28	28"	39 lbs	1460	108	9
WBT4X30 S	WBT4X30	30"	41 lbs	1578	CONSULT WBT FOR FACTORY SPECIFICATIONS	
WBT4X32 S	WBT4X32	32"	42 lbs	1684		
WBT4X34 S	WBT4X34	34"	44 lbs	1789		
WBT4X36 S	WBT4X36	36"	45 lbs	1894		

Finished tray length is 118 3/16"

\*Fill is a theoretical calculation based on a .22" diameter cable and a 50% fill.

## HOW MANY SPLICE KITS DO YOU NEED?

### FORMULA

$$\# \text{ of pieces of tray} \times A \div 50$$

A = splice quantity found in chart

(Formula above equals number of 50 pack boxes to order)

## 6" DEEP TRAY



SHAPED PART NUMBER	ROUND PART NUMBER	WIDTH	WT. per pc.	FILL*	LOAD lbs/ft	SPLICE quantity
WBT6X8 S	WBT6X8	8"	23 lbs	623	116	6
WBT6X12 S	WBT6X12	12"	27 lbs	931	123	6
WBT6X16 S	WBT6X16	16"	31 lbs	1255	123	7
WBT6X18 S	WBT6X18	18"	33 lbs	1413	127	7
WBT6X20 S	WBT6X20	20"	35 lbs	1571	127	7
WBT6X22 S	WBT6X22	22"	37 lbs	1728	127	8
WBT6X24 S	WBT6X24	24"	39 lbs	1886	150	8

Finished tray length is 118 3/16"

\*Fill is a theoretical calculation based on a .22" diameter cable and a 50% fill.

## TRAY AVAILABLE IN 8, 10 & 12" DEPTH

**KEY:** WBT depthXwidth crosswire finish

(example: **WBT 4X18 S BL** = 4" deep X 18" wide Shaped Black)

DEPTH	WIDTH	CROSSWIRE	FINISH
2"-12"	2"-40"	S for shaped crosswire Blank for round crosswire	Blank for PreGalv ZP for Electro Zinc Plate PW/BL/WH for Standard Powder CUSTOM for Custom Powder (See WBT for suffix) 304L/316L Stainless

## CUSTOM TRAY

WBT can fabricate various custom configurations. Please contact the factory for details.

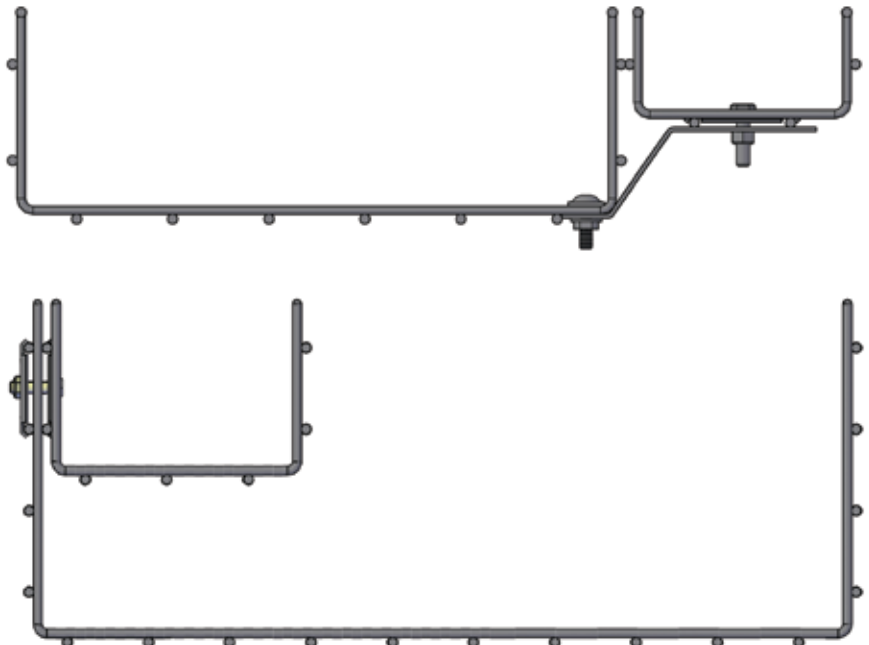
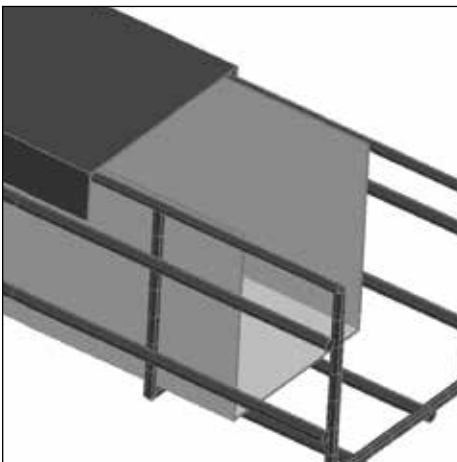

STANDARD FINISH:  | AVAILABLE IN FINISHES: **BL**, **WH**, **PW**, **CUSTOM**, **ZP**

\*WBT's fill rate is based on the NEC allowable fill of 50%. The NEC rule states that the cable cross section areas together may not exceed 50% of the tray area (width x depth = fill). Cables will almost completely fill the tray when reaching the 50% fill rate due to empty space between round cables and how the cables are installed.

## NEW Fittings for Tray Radius, Tee and Intersections

WBT PreForm is a time and cost effective solution to pathway tees, intersections, and radius bends, **no cutting... no configuring**. WBT PreForm simply attaches at the Intersection, Tee, or juncture when you want a radius bend. The sections are manufactured precisely to the trays being utilized, so it's a clean engineered solution. Vertical surfaces from tray to tray keep cables properly routed to avoid any excessive bends.

Installation of WBT PreForm can take installation configurations from hours to a few minutes. Labor and time savings can exceed 90%+ versus traditional cutting and splicing, all while avoiding sharp protrusions by less trained technicians.

WBT PreForm and Fittings allow you to retrofit to any installed tray pathway, and it doesn't lock you into a single sourced supplier with proprietary sections and solutions.

WBT PreForm sections ship in the flat for easy and quick installation, so no excessive transportation costs or likelihood of damage. Most can simply be shipped UPS to the jobsite.

- **NOW AVAILABLE:** Covers for PreForm. They work in conjunction with standard tray covers to provide full protection for pathway runs. Standard cover is aluminum, but also available in steel.
- **NEW:** PreForm now offers Reducer's both for tray, but also other junctures. Need a Tee configuration for 18" wide tray with a 12" tap... no issues.
- PreForm sides are available in white or black finish.
- **NEW:** WBT Transition. Allows for quick and engineered vertical transitions. Formed tray is bendable and field configurable. Splices to standard WBT tray.

**KEY:** WBT-juncture-depth X width finish  
(example: **WBT-R90-4X18 PG** = Radius 4" deep X 18" wide Pre-Galvanized finish)

JUNCTURE	DEPTH	WIDTH	MATERIAL
R45 - 45° Radius R90 - 90° Radius T - Tee I - Intersection	2"-6"	4"-30"	Steel Bottom with Flame Retardent Polymer Sides

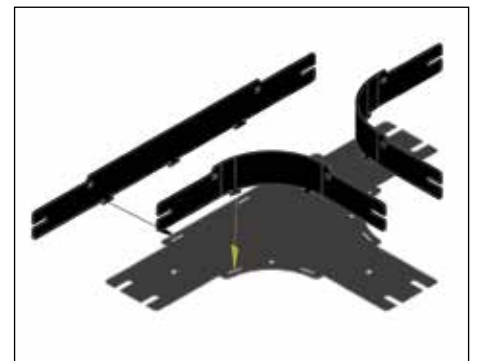

## TIME SAVINGS CHART

CONFIGURATION	TRAY	TRADITIONAL CONFIGURATION	WBT PreForm	TIME SAVINGS (%)
RADIUS	2x8	7 minutes	1 minute	85%
RADIUS	4x12	20 minutes	2 minutes	90%
TEE (CORNER SPLICE)	4x12	8 minutes 45 seconds	2 minutes 30 seconds	70%
TEE (RADIUS)	4x18	10 minutes	2 minutes 30 seconds	74%
INTERSECTION	6x24	29 minutes	4 minutes 45 seconds	83%



RADIUS

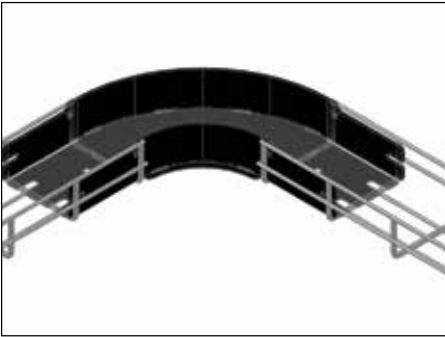

TEE

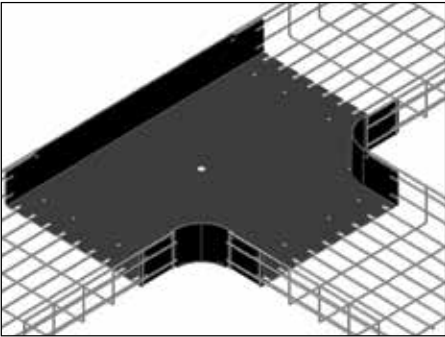

INTERSECTION

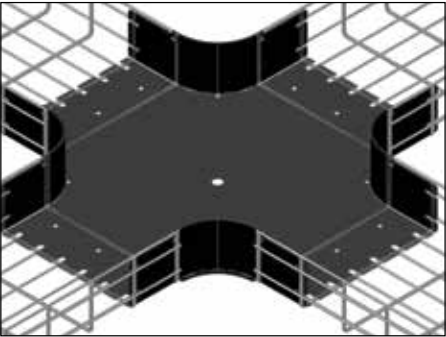

RADIUS COVER

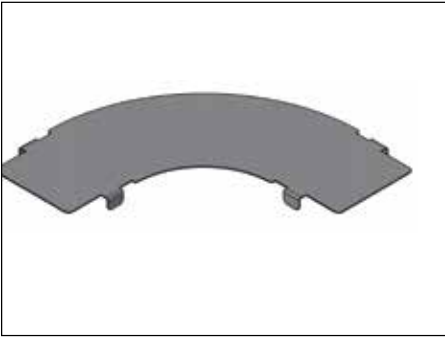

TEE COVER

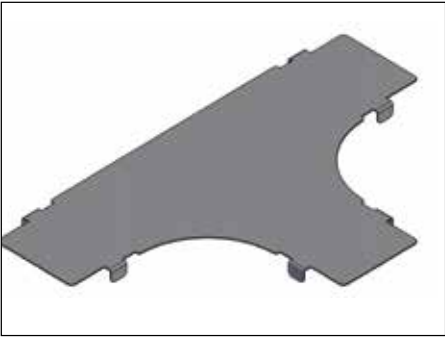

INTERSECTION COVER

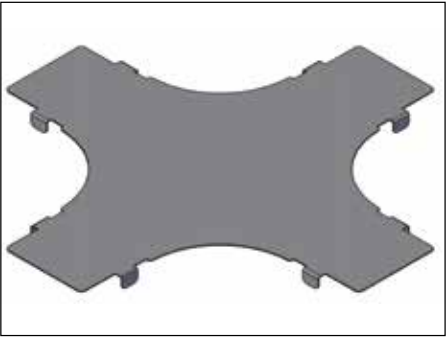

TRAY REDUCER

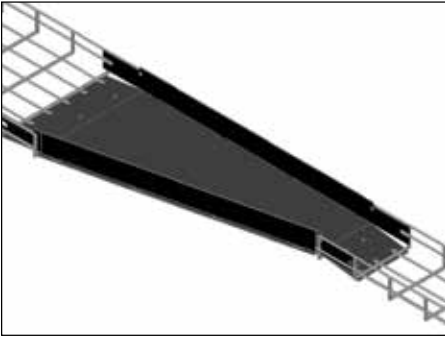

TEE REDUCER

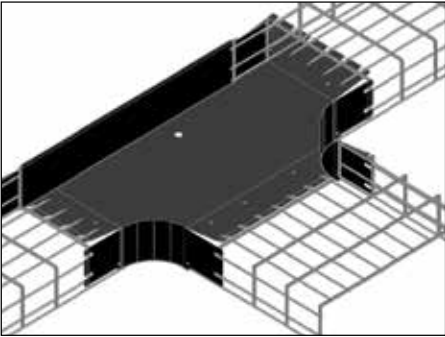

INTERSECTION REDUCER

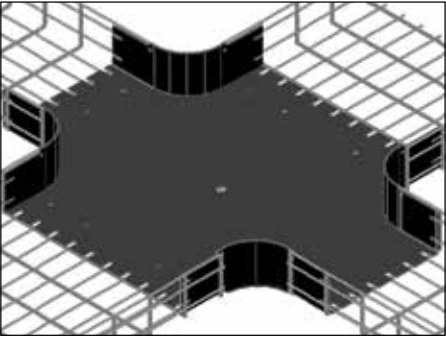

TRANSITION

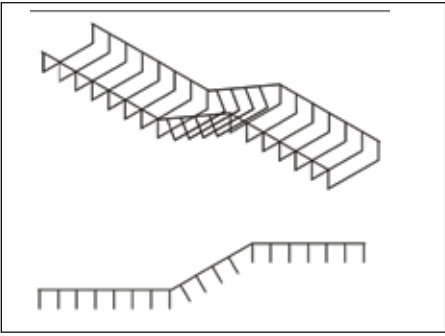
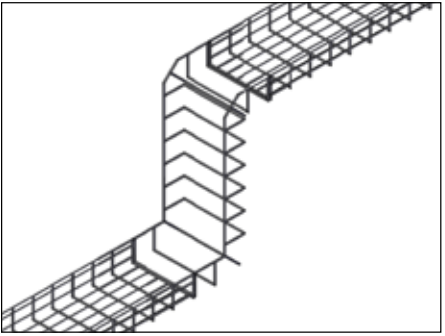

WBT Supports Eliminate Splice Hardware

Splice hardware? We don't need no stinking hardware.

Every installer is used to butt splicing tray sections together, whether using nut/bolt or other ornate hardware, every 10 feet. This is in addition to the tray supports and attachment methods.

WBT has redesigned its most popular supports so they now pull double duty: tray support AND splice point.

With WBT NoSplice, simply lay the tray ends into the support, and a single hold down does everything. No tedious multiple splice hardware at each juncture.

Saves time, saves hardware, and saves money.



SEE PAGE 12  
FOR ORDERING  
INFORMATION

TIME SAVINGS CHART

TRAY WIDTH	SPLICE QUANTITY	TRADITIONAL SPLICE	WBT NO SPLICE	TIME SAVINGS (%)	MATERIAL COST SAVINGS
2X12	4	75 seconds	10 seconds	86%	\$2.55
4X12	6	135 seconds	10 seconds	93%	\$3.83
4X18	7	160 seconds	20 seconds	87%	\$4.46
4X24	8	180 seconds	20 seconds	89%	\$5.10



## SPLICE KIT

PART NUMBER	DESCRIPTION	WT. per box	QUANTITY per box
SPLICE KIT	3 piece staked bolt/washer and nut combination used to splice straight sections and fittings.	5 lbs	50 sets

STANDARD FINISH: ZINC PLATED | AVAILABLE IN FINISH: **BL**



## BAR SPLICE

PART NUMBER	DESCRIPTION	WT. per box	QUANTITY per box
BAR SPLICE	Slotted bar 11-15/16" long used to splice straight sections and fittings.	14 lbs	50 each

STANDARD FINISH: ZINC PLATED | AVAILABLE IN FINISHES: **BL**, **WG**, **PW**, **CUSTOM**  
\*SPLICE KIT SOLD SEPARATELY.

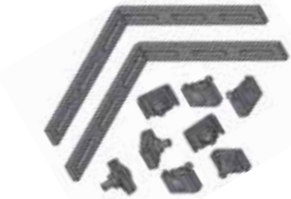

## CORNER SPLICE

PART NUMBER	DESCRIPTION	WT. per box	QUANTITY per box
CORNER SPLICE	Kit used to splice fittings. Each kit includes two 90 degree splice bars and 8 sets of the splice kit.	1 lbs	1 kit

STANDARD FINISH: ZINC PLATED | AVAILABLE IN FINISHES: **BL**, **WG**, **PW**, **CUSTOM**

## WASHER SUPPORT

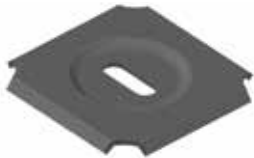

PART NUMBER	DESCRIPTION	WT. per box	QUANTITY per box
WASHER SUPPORT	2" square washer used as a hold down method or fitting splice.	6 lbs	50 each

STANDARD FINISH: ZINC PLATED | AVAILABLE IN FINISHES: **BL**, **WG**, **PW**, **CUSTOM**  
\*1/4" BOLT AND NUT SOLD SEPARATELY.

## 1/4" BOLT & NUT



PART NUMBER	DESCRIPTION	WT. per box	QUANTITY per box
1/4 BOLT & NUT	1/4" Carriage Bolt & Finned Nut used with Washer Support.	1.6 lbs	50 each

STANDARD FINISH: ZINC PLATED | AVAILABLE IN FINISHES: **BL**

## WASHER SUPT PLUS



PART NUMBER	DESCRIPTION	WT. per box	QUANTITY per box
WASHER SUPT PLUS	1/4" Bolt & Nut & Washer Support. Used as a hold down method.	6.6 lbs	50 each

STANDARD FINISH: ZINC PLATED | AVAILABLE IN FINISHES: **BL**

## SHELF SUPPORT



PART NUMBER	DESCRIPTION	WT. per pc.	QUANTITY per box
SHELF SUPT 4	Shelf/Wall support for 4" wide tray.	0.4 lbs	1 each
SHELF SUPT 6	Shelf/Wall support for 6" wide tray.	0.5 lbs	1 each
SHELF SUPT 8	Shelf/Wall support for 8" wide tray.	0.6 lbs	1 each
SHELF SUPT 12	Shelf/Wall support for 12" wide tray.	1.2 lbs	1 each
SHELF SUPT 16	Shelf/Wall support for 16" wide tray.	1.7 lbs	1 each
SHELF SUPT 18	Shelf/Wall support for 18" wide tray.	1.9 lbs	1 each
SHELF SUPT 20	Shelf/Wall support for 20" wide tray.	2.6 lbs	1 each
SHELF SUPT 24	Shelf/Wall support for 24" wide tray.	3.2 lbs	1 each

STANDARD FINISH:  | AVAILABLE IN FINISHES: **BL**, **WH**, **PW**, **CUSTOM**

## L BRACKET



PART NUMBER	DESCRIPTION	WT. per pc.	QUANTITY per box
L BRACKET 4	Wall L bracket for 4" wide tray.	0.7 lbs	1 each
L BRACKET 6	Wall L bracket for 6" wide tray.	0.8 lbs	1 each
L BRACKET 8	Wall L bracket for 8" wide tray.	0.9 lbs	1 each
L BRACKET 12	Wall L bracket for 12" wide tray.	1.4 lbs	1 each
L BRACKET 16	Wall L bracket for 16" wide tray.	1.5 lbs	1 each
L BRACKET 18	Wall L bracket for 18" wide tray.	1.7 lbs	1 each
L BRACKET 20	Wall L bracket for 20" wide tray.	2.1 lbs	1 each
L BRACKET 24	Wall L bracket for 24" wide tray.	2.3 lbs	1 each

STANDARD FINISH:  | AVAILABLE IN FINISHES: **BL**, **WH**, **PW**, **CUSTOM**

## C BRACKET



PART NUMBER	DESCRIPTION	WT. per pc.	QUANTITY per box
C BRACKET 4	Wall/Ceiling C bracket for 4" wide tray.	1.2 lbs	1 each
C BRACKET 8	Wall/Ceiling C bracket for 8" wide tray.	1.5 lbs	1 each
C BRACKET 12	Wall/Ceiling C bracket for 12" wide tray.	2 lbs	1 each
C BRACKET 18	Wall/Ceiling C bracket for 18" wide tray.	2.7 lbs	1 each

STANDARD FINISH:  | AVAILABLE IN FINISHES: **BL**, **WH**, **PW**, **CUSTOM**

## TRAPEZE SUPPORTS



PART NUMBER	DESCRIPTION	WT. per pc.	QUANTITY per box
TRAP SUPT	Trapeze style side support attaches to the side of the tray; suggested for tray sizes 16" wide & smaller.	9 lbs	50pcs/ box

STANDARD FINISH:  | AVAILABLE IN FINISHES: **BL**, **WH**, **PW**, **CUSTOM**

\*ACCEPTS UP TO 3/8" THREADED ROD & SMALLER.

### TRAPEZE SUPPORTS

- No polymer grommets required to hold threaded rod in place
- Able to support two individual sections of tray
- Works with splice hardware at tray junctions

 = PRE-GALVANIZED FINISH

## CENTER SUPPORTS



PART NUMBER	DESCRIPTION	WT. per pc.	QUANTITY per box
CENTER SUPT 4	Center Support for 4" wide tray.	1.6 lbs	1 each
CENTER SUPT 6	Center Support for 6" wide tray.	1.8 lbs	1 each
CENTER SUPT 8	Center Support for 8" wide tray.	2 lbs	1 each
CENTER SUPT 12	Center Support for 12" wide tray.	2.7 lbs	1 each
CENTER SUPT 16	Center Support for 16" wide tray.	3.3 lbs	1 each
CENTER SUPT 18	Center Support for 18" wide tray.	3.4 lbs	1 each
CENTER SUPT 20	Center Support for 20" wide tray.	3.8 lbs	1 each
CENTER SUPT 24	Center Support for 24" wide tray.	4.4 lbs	1 each

STANDARD FINISH: ZINC PLATED | AVAILABLE IN FINISHES: **BL**, **WH**, **PW**, **CUSTOM**, **SS**

\*ACCEPTS UP TO 1/2" THREADED ROD & SMALLER.

## WBT NoSplice™ CENTER SUPPORTS



PART NUMBER	DESCRIPTION	WT. per pc.	QUANTITY per box
NS CENTER SUPT 6	NoSplice Center Support for 6" wide tray.	1.8 lbs	1 each
NS CENTER SUPT 8	NoSplice Center Support for 8" wide tray.	2 lbs	1 each
NS CENTER SUPT 12	NoSplice Center Support for 12" wide tray.	2.7 lbs	1 each
NS CENTER SUPT 16	NoSplice Center Support for 16" wide tray.	3.3 lbs	1 each
NS CENTER SUPT 18	NoSplice Center Support for 18" wide tray.	3.4 lbs	1 each
NS CENTER SUPT 20	NoSplice Center Support for 20" wide tray.	3.8 lbs	1 each
NS CENTER SUPT 24	NoSplice Center Support for 24" wide tray.	4.4 lbs	1 each

STANDARD FINISH: | AVAILABLE IN FINISHES: **BL**, **WH**, **PW**, **CUSTOM**

\*SPICE HARDWARE INCLUDED. ACCEPTS UP TO 1/2" THREADED ROD & SMALLER.

## CEILING SUPPORTS



PART NUMBER	DESCRIPTION	WT. per pc.	QUANTITY per box
CEILING SUPT 12	Profile style support for 12" wide tray & smaller.	1.1 lbs	1 each
CEILING SUPT 16	Profile style support for 16" wide tray.	1.5 lbs	1 each
CEILING SUPT 18	Profile style support for 18" wide tray.	1.6 lbs	1 each
CEILING SUPT 20	Profile style support for 20" wide tray.	1.9 lbs	1 each
CEILING SUPT 24	Profile style support for 24" wide tray.	1.9 lbs	1 each

STANDARD FINISH: | AVAILABLE IN FINISHES: **BL**, **WH**, **PW**, **CUSTOM**, **SS**

## WBT NoSplice™ CEILING SUPPORTS



PART NUMBER	DESCRIPTION	WT. per pc.	QUANTITY per box
NS CEILING SUPT 12	Ceiling support for 12" wide tray & smaller.	1 lbs	1 each
NS CEILING SUPT 16	Ceiling support for 16" wide tray.	1.2 lbs	1 each
NS CEILING SUPT 18	Ceiling support for 18" wide tray.	1.4 lbs	1 each
NS CEILING SUPT 20	Ceiling support for 20" wide tray.	1.6 lbs	1 each
NS CEILING SUPT 24	Ceiling support for 24" wide tray.	1.9 lbs	1 each

WORKS IN BOTH NoSplice APPLICATIONS, AS WELL AS TRADITIONAL CEILING SUPPORT

STANDARD FINISH: | AVAILABLE IN FINISHES: **BL**, **WH**, **PW**, **CUSTOM**

\*SPICE HARDWARE INCLUDED. ACCEPTS UP TO 1/2" THREADED ROD & SMALLER.



= PRE-GALVANIZED FINISH



## RADIUS EXIT



PART NUMBER	DESCRIPTION	WT. per pc.	QUANTITY per box
RADIUS EXIT	Radius Exit allows cables to exit over the side of 4/6" deep tray.	3.5 lbs	1 each

STANDARD FINISH: **BL** AVAILABLE FINISHES: **WH**, **PW**, **CUSTOM**, **SS**  
 \*INSTALLATION HARDWARE INCLUDED.

## RADIUS DOWN



PART NUMBER	DESCRIPTION	WT. per pc.	QUANTITY per box
RADIUS DOWN 4	Radius Down with side panels for increased cable protection. Vertical funnel is 4" width. Allows connection between both trays.	2.5 lbs	1 each
RADIUS DOWN 6	Radius Down with side panels for increased cable protection. Vertical funnel is 6" width. Allows connection between both trays.	3.75 lbs	1 each
RADIUS DOWN 12	Radius Down with side panels for increased cable protection. Vertical funnel is 12" width. Allows connection between both trays.	7.5 lbs	1 each

STANDARD FINISH: **BL** AVAILABLE FINISHES: **WH**, **PW**, **CUSTOM**, **SS**  
 \*WASHER SUPT PLUS SOLD SEPARATELY.



## VERTICAL DOWN



PART NUMBER	DESCRIPTION	WT. per pc.	QUANTITY per box
VERTICAL DOWN	Use the vertical down when dropping cables from the end or the side of tray. Dropout width is 8".	1.5 lbs	1 each

STANDARD FINISH: ZINC PLATED  
 AVAILABLE FINISHES: **BL**, **WH**, **PW**, **CUSTOM**, **SS**



## RACK ATTACHMENT



PART NUMBER	DESCRIPTION	WT. per pc.	QUANTITY per box
RACK ATTACHMENT	Attaches tray directly to the top of a standard rack.	1 lb	1 kit

STANDARD FINISH: ZINC PLATED | AVAILABLE FINISH: **BL**, **WH**, **PW**, **CUSTOM**, **SS**

## CABLE DROPOUT

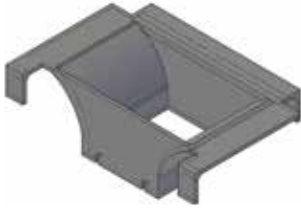

PART NUMBER	DESCRIPTION	WT. per pc.	QUANTITY per box
CABLE DROPOUT	Cable Dropout within the tray to protect bend radius. Can be stacked for multiple dropouts.	.03 lbs	1 each

STANDARD FINISH: **BL**

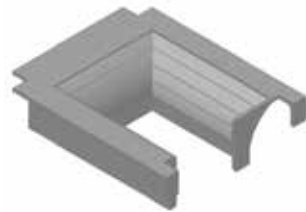
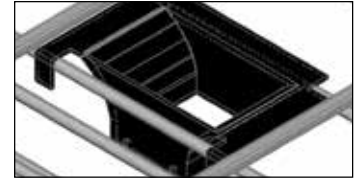
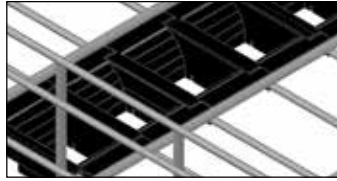

PART NUMBER	DESCRIPTION	WT. per pc.	QUANTITY per box
CABLE DROPOUT 4X4	4" x 4" cable dropout within the tray to protect bend radius. Can be stacked for multiple dropouts.	.03 lbs	1 each

STANDARD FINISH: **BL**

## CABINET SUPPORT



PART NUMBER	DESCRIPTION	WT. per pc.	QUANTITY per box
WBTUS4	Independent cabinet support 4" H x 22" W.	1.9 lbs	1 each
WBTUS6	Independent cabinet support 6" H x 22" W.	2.1 lbs	1 each
WBTUS8	Independent cabinet support 8" H x 22" W.	2.4 lbs	1 each

STANDARD FINISH:  | AVAILABLE IN FINISHES: **BL**, **WH**, **PW**, **CUSTOM**, **SS**

\*ADDITIONAL HARDWARE SOLD SEPARATELY.

## FLOOR SUPPORT



PART NUMBER	DESCRIPTION	WT. per pc.	QUANTITY per box
FLOOR SUPT __X__	Cabinet/Underfloor support for tray.	1-3 lb	1 each

STANDARD FINISH: 

AVAILABLE IN FINISHES: **BL**, **WH**, **PW**, **CUSTOM**, **SS**

\*ADDITIONAL HARDWARE SOLD SEPARATELY.

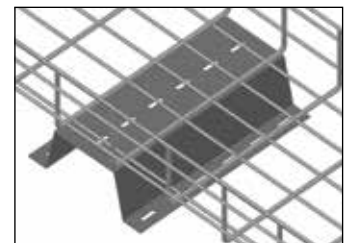

**KEY:** FLOOR SUPT depthXwidth finish

(example: **FLOOR SUPT 4X18 BL** = 4" deep X 18" wide, black powder coat)

DEPTH	WIDTH	FINISH
2", 4", 6"	4"-30"	PW/BL/WH for Standard Powder Custom for Custom Powder

 = PRE-GALVANIZED FINISH

## Z BRACKET



PART NUMBER	DESCRIPTION	WT. per pc.	QUANTITY per box
Z BRACKET ____	Support for wall, underfloor or cabinet installation.	1-3 lb	1 each

STANDARD FINISH:

AVAILABLE IN FINISHES: **BL**, **WH**, **PW**, **CUSTOM**, **SS**

\*ADDITIONAL HARDWARE SOLD SEPARATELY.

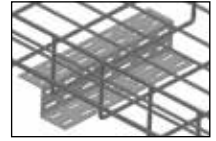
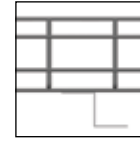

**KEY: Z BRACKET** width finish

(example: **Z BRACKET 12 WH** = 12" wide, white powder coat)

WIDTH	FINISH
4"-24"	PW/BL/WH for Standard Powder CPC for Custom Powder

## TERMINATION SUPPORT

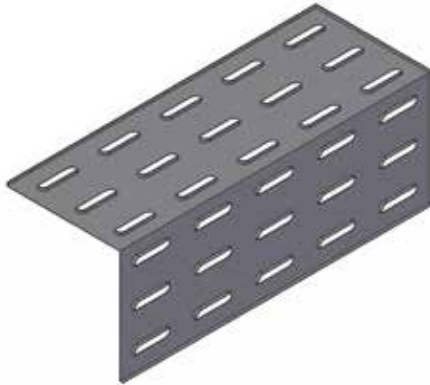

PART NUMBER	DESCRIPTION	WT. per pc.	QUANTITY per box
TERM SUPPORT 6	Wall termination for 6" wide tray.	0.75 lb	1 each
TERM SUPPORT 8	Wall termination for 8" wide tray.	1 lb	1 each
TERM SUPPORT 12	Wall termination for 12" wide tray.	1.2 lbs	1 each
TERM SUPPORT 16	Wall termination for 16" wide tray.	1.4 lbs	1 each
TERM SUPPORT 18	Wall termination for 18" wide tray.	1.6 lbs	1 each
TERM SUPPORT 20	Wall termination for 20" wide tray.	1.75 lbs	1 each
TERM SUPPORT 24	Wall termination for 24" wide tray.	2 lbs	1 each

STANDARD FINISH:

AVAILABLE IN FINISHES: **BL**, **WH**, **PW**, **CUSTOM**, **SS**

Custom widths available.

\*ADDITIONAL HARDWARE SOLD SEPARATELY.

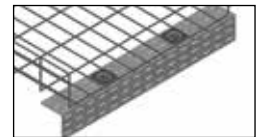

## WALL MOUNT SUPPORT



PART NUMBER	DESCRIPTION	WT. per pc.	QUANTITY per box
WALL SUPT	Wall support for mounting 4" wide tray.	5 oz	1 each

STANDARD FINISH:

AVAILABLE IN FINISHES: **BL**, **WH**, **CUSTOM**, **SS**

## BLIND END

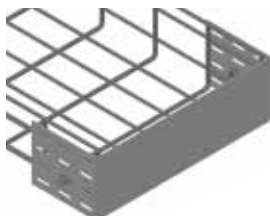

PART NUMBER	DESCRIPTION	WT. per pc.	QUANTITY per box
BLIND END __X__	A solid barrier at tray section end.	1-3 lbs	1 each

STANDARD FINISH:

AVAILABLE IN FINISHES: **BL**, **WH**, **PW**, **CUSTOM**, **SS**

\*ADDITIONAL HARDWARE SOLD SEPARATELY.



= PRE-GALVANIZED FINISH

CONDUIT ATTACHMENT



PART NUMBER	DESCRIPTION	WT. per pc.	QUANTITY per box
CONDUIT ATTACHMENT 3	Conduit to tray attachment. Available versions punched in 3/4", 1" and 1 1/2", or all punched same size.	1.5 lbs	1 each

STANDARD FINISH: 

AVAILABLE IN FINISHES: **BL**, **WH**, **PW**, **CUSTOM**, **SS**

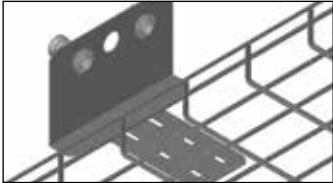

ELECTRICAL BOX

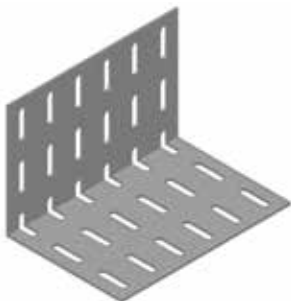

PART NUMBER	DESCRIPTION	WT. per pc.	QUANTITY per box
WBTELECTRICALBOX	Box to tray attachment.	0.75 lb	1 each

STANDARD FINISH: 

AVAILABLE IN FINISHES: **BL**, **WH**, **PW**, **CUSTOM**, **SS**

\*ADDITIONAL HARDWARE SOLD SEPARATELY.

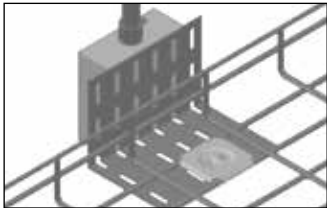

GROUND BOLT



PART NUMBER	DESCRIPTION	WT. per pc.	QUANTITY per box
GROUND BOLT	Ground bolt/lug to secure ground wire to tray sections.	1 lb	1 each

Conductive copper for ground/bond

LABEL CLIP



PART NUMBER	DESCRIPTION	WT. per pc.	QUANTITY per box
LABEL CLIP	Label Clip attachment for all sizes of tray.	0.1 lb	2 each

Polymer construction

CUTTING TOOL



PART NUMBER	DESCRIPTION	WT. per pc.	QUANTITY per box
CUTTING TOOL	Manual offset angled cutting tool with a 24" leveraged handle.	6 lbs	1 each

 = PRE-GALVANIZED FINISH

## FITTING ATTACHMENT

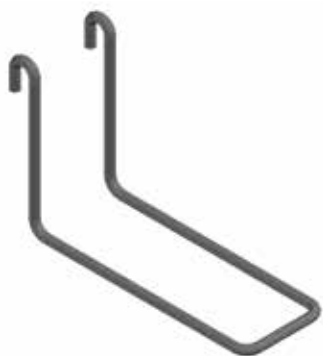

PART NUMBER	DESCRIPTION	WT. per pc.	QUANTITY per box
FITTING ATTACHMENT 2	Use the fitting attachment 2 to fill the gap in 2" tray when creating fittings.	1 lb	1 each
FITTING ATTACHMENT 4/6	Use the fitting attachment 4/6 to fill the gap in 4" or 6" tray when creating fittings.	1 lb	1 each

STANDARD FINISH: 

AVAILABLE IN FINISHES: **BL**, **WH**, **PW**, **CUSTOM**, **SS**

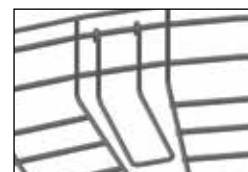

## SIDECAR



PART NUMBER	DESCRIPTION	WT. per pc.	QUANTITY per box
SIDE CAR 2	Additional cable support 2" deep.	0.5 lb	1 each
SIDE CAR 4	Additional cable support 4" deep.	0.5 lb	1 each

STANDARD FINISH: 

AVAILABLE IN FINISHES: **BL**, **WH**, **PW**, **CUSTOM**, **SS**

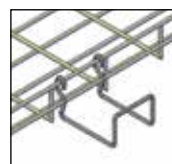

## CABLE GUIDE

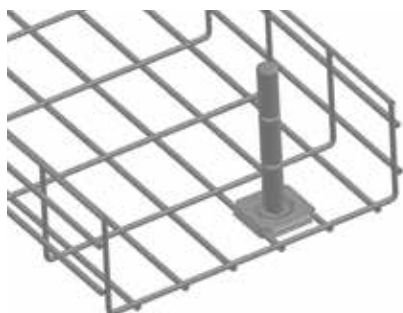

PART NUMBER	DESCRIPTION	WT. per pc.	QUANTITY per box
CABLE GUIDE	The cable guide is used to maintain cable bend radius when routing or pulling cables through fittings. It can also be used as a divider for straight sections as well as fittings.	1 lb	1 each

Polymer construction

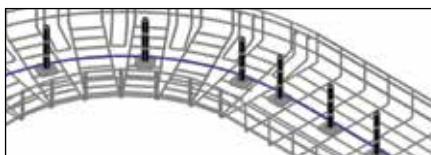

## LADDER RACK CLIP

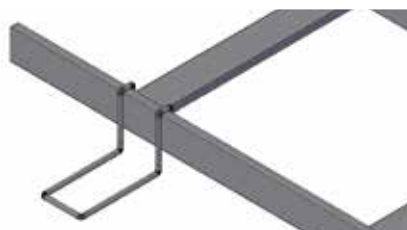

PART NUMBER	DESCRIPTION	WT. per pc.	QUANTITY per box
LADDER RACK CLIP	Pressure mounted bracket to install 4" width tray to existing ladder rack.	1 lb	1 each

STANDARD FINISH: 

AVAILABLE IN FINISHES: **BL**, **WH**, **PW**, **CUSTOM**

\*INSTALLATION HARDWARE INCLUDED.





## WBTFORM

### Non metallic solutions

WBT is proud to introduce WBTFORM, a new system for utilizing flame retardant polymer for use in creating tray inserts and covers. WBTFORM allows you to configure the material as a tray liner or insert, with the option of a flat bottom, or prescored to the tray depth for coverage of the bottom and sides.

WBTFORM can even be utilized to envelop the entire tray, providing bottom, side and cover protection. WBTFORM is easily configurable into a variety of solutions from the simple to creative.

WBTFORM is:

- **UL 94V-0 Flame Class Rating.**
- **RoHS compliant.**
- **Non-hydroscopic (moisture absorption <0.1%).**
- **Temperature range to 115°C/239°F.**
- **Easily field configurable.**
- **Can be prescored at the factory for specific applications.**
- **Available in black, white, red, blue, yellow, green or any custom color\*.**

### WBTFORM



PART NUMBER	DESCRIPTION	WT. per pc.	QUANTITY per box
WBTFORM04	Polymer bottom insert for 4" wide tray 10' long.	0.5 lb	1 each
WBTFORM06	Polymer bottom insert for 6" wide tray 10' long.	0.65 lb	1 each
WBTFORM08	Polymer bottom insert for 8" wide tray 10' long.	0.75 lb	1 each
WBTFORM12	Polymer bottom insert for 12" wide tray 10' long.	1 lb	1 each
WBTFORM16	Polymer bottom insert for 16" wide tray 10' long.	1.25 lbs	1 each
WBTFORM18	Polymer bottom insert for 18" wide tray 10' long.	1.5 lbs	1 each
WBTFORM20	Polymer bottom insert for 20" wide tray 10' long.	1.75 lbs	1 each
WBTFORM24	Polymer bottom insert for 24" wide tray 10' long.	2.25 lbs	1 each

**\*WBTFORM parts are supplied as one continuous roll, up to 250'.**

STANDARD FINISH: **BL** AVAILABLE IN FINISHES: **WH, CUSTOM\***

### WBTFORM WITH SIDES



**KEY:** WBTFORM $\text{depth} \times \text{width}$  (example: **WBTFORM2X12** = 2" deep X 12" wide tray)

PART NUMBER	DESCRIPTION	WT. per pc.	QUANTITY per box
WBTFORM__X__	Polymer bottom insert with sides for specific tray depth and width 10' long.	1 lb	1 each

**\*WBTFORM parts are supplied as one continuous roll, up to 250'.**

STANDARD FINISH: **BL** AVAILABLE IN FINISHES: **WH, CUSTOM\***



NOTE: Always check with local building/codes enforcement to insure WBTForm is allowed and approved for installation environment

\*Subject to minimum order

WBT for Fiber

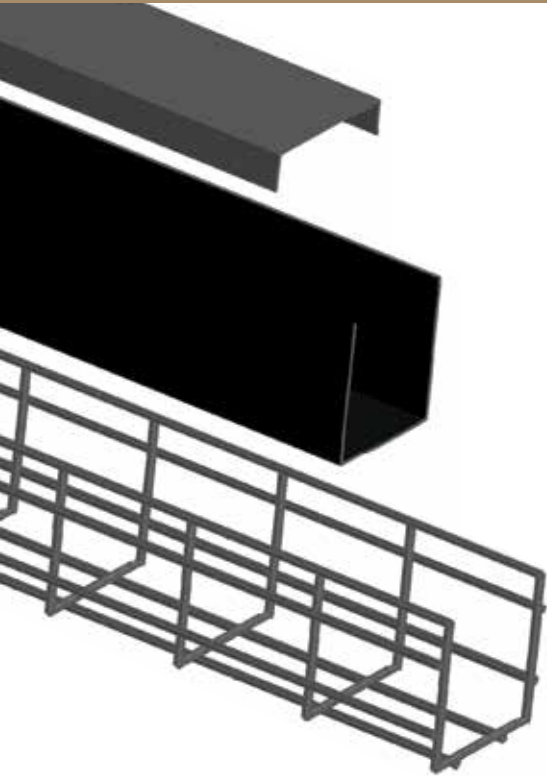

Utilizing the proprietary WBTFORM material along with traditional tray and our newly designed covers, WBT has configured a solution to the high price of polymer fiber tray management.

WBTFORM provides a solid surface (*bottom and sides*) to support optical fibers. Traditional tray sections can be configured into curves and spillouts (*our new cable dropout*), while the newly designed WBT covers simply snap into place. No oversized covers or attachment hardware. The solution provides maximum flexibility and protection for cabling.

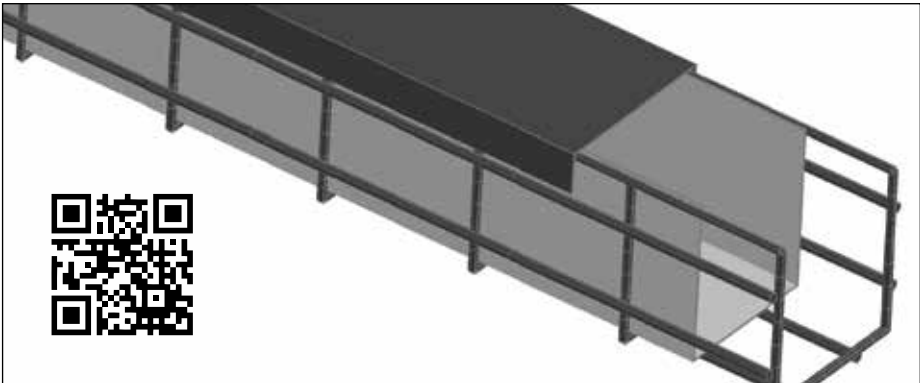

COVERS

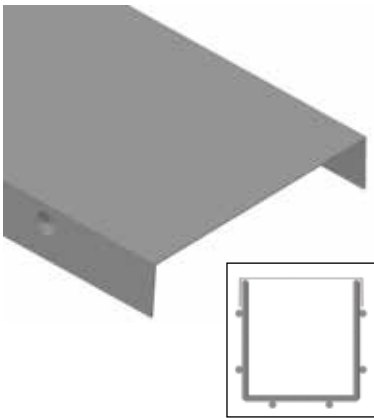

PART NUMBER	DESCRIPTION	WT. per pc.	LENGTH
COVER4	Metal cover for 4" wide tray galvanized.	3 lbs	5'
COVER6	Metal cover for 6" wide tray galvanized.	3.5 lbs	5'
COVER8	Metal cover for 8" wide tray galvanized.	4.5 lbs	5'
COVER12	Metal cover for 12" wide tray galvanized.	6 lbs	5'
COVER16	Metal cover for 16" wide tray galvanized.	8 lbs	5'
COVER18	Metal cover for 18" wide tray galvanized.	8.5 lbs	5'
COVER20	Metal cover for 20" wide tray galvanized.	9.5 lbs	5'
COVER24	Metal cover for 24" wide tray galvanized.	11 lbs	5'

STANDARD FINISH: | AVAILABLE IN FINISHES: **BL**, **WH**, **PW**, **CUSTOM**

STEEL INSERTS



PART NUMBER	DESCRIPTION	WT. per pc.	LENGTH
INSERT__X__	Solid insert with sides used with corresponding tray, galvanized.	varies	5'

STANDARD FINISH: | AVAILABLE IN FINISHES: **BL**, **WH**, **PW**, **CUSTOM**

\*WASHER SUPT PLUS SOLD SEPARATELY.

## INSERTS



PART NUMBER	DESCRIPTION	WT. per pc.	LENGTH
INSERT4	Solid insert used with 4" wide tray galvanized.	3.5 lbs	5'
INSERT6	Solid insert used with 6" wide tray galvanized.	5 lbs	5'
INSERT8	Solid insert used with 8" wide tray galvanized.	7 lbs	5'
INSERT12	Solid insert used with 12" wide tray galvanized.	11 lbs	5'
INSERT16	Solid insert used with 16" wide tray galvanized.	13.5 lbs	5'
INSERT18	Solid insert used with 18" wide tray galvanized.	16.5 lbs	5'
INSERT20	Solid insert used with 20" wide tray galvanized.	18 lbs	5'
INSERT24	Solid insert used with 24" wide tray galvanized.	20 lbs	5'

STANDARD FINISH:  | AVAILABLE IN FINISHES: **BL**, **WH**, **PW**, **CUSTOM**

\*WASHER SUPT PLUS SOLD SEPARATELY.

## DIVIDERS



PART NUMBER	DESCRIPTION	WT. per pc.	LENGTH
DIVIDER2	Divider used with 2" deep tray galvanized.	2 lbs	5'
DIVIDER4	Divider used with 4" deep tray galvanized.	5 lbs	5'
DIVIDER6	Divider used with 6" deep tray galvanized.	7.5 lbs	5'
DIVIDER8	Divider used with 8" deep tray galvanized.	10 lbs	5'

STANDARD FINISH:  | AVAILABLE IN FINISHES: **BL**, **WH**, **PW**, **CUSTOM**

\*WASHER SUPT PLUS SOLD SEPARATELY.

## FLEX DIVIDERS

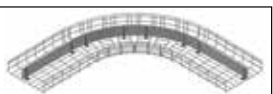
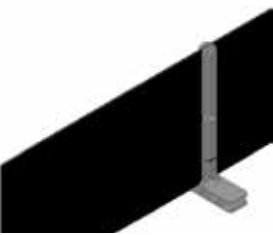

PART NUMBER	DESCRIPTION	WT. per pc.	LENGTH
FLEX DIVIDER 2	4" perforated divider clip (2" to be removed by snapping off) along with 2" high x 10" long flexible polymer divider wall. Includes 4 divider posts.	1.5 lbs	10'
FLEX DIVIDER 4	4" perforated divider clip, along with 4" x 10" long flexible polymer divider wall. Includes 4 divider posts.	3 lbs	10'
FLEX DIVIDER 6	4" perforated divider clip, along with 6" x 10" long flexible polymer divider wall. Includes 4 divider posts.	4.5 lbs	10'

\*Divider polymer parts are supplied as one continuous roll, up to 250'.

• Polymer Divider is UL 94V-0 Flame Class Rating.

STANDARD FINISH: **BL** AVAILABLE IN FINISHES: **WH**

## DIVIDER POST



PART NUMBER	DESCRIPTION	WT. per pc.	QUANTITY per box
DIVIDER POST	4" high polymer snap on divider post for 2", 4", or 6" divider. 2" may be snapped off for use with 2" tray.	.5 lbs	1 each

STANDARD FINISH: **BL** AVAILABLE IN FINISHES: **WH**

 = PRE-GALVANIZED FINISH

## SUPPORT

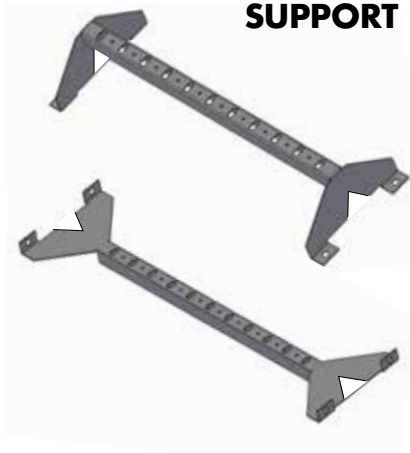

PART NUMBER	DESCRIPTION	WT. per pc.	QUANTITY per box
WBTUS4	Independent Underfloor support 4" H x 22" W.	1.9 lbs	1 each
WBTUS6	Independent Underfloor support 6" H x 22" W.	2.1 lbs	1 each
WBTUS8	Independent Underfloor support 8" H x 22" W.	2.4 lbs	1 each
WBTUS10	Independent Underfloor support 10" H x 22" W.	3.0 lbs	1 each
WBTUS12	Independent Underfloor support 12" H x 22" W.	3.5 lbs	1 each
WBTUS14	Independent Underfloor support 14" H x 22" W.	4.1 lbs	1 each
WBTUS16	Independent Underfloor support 16" H x 22" W.	4.7 lbs	1 each
WBTUS18	Independent Underfloor support 18" H x 22" W.	5.3 lbs	1 each

STANDARD FINISH: | AVAILABLE IN FINISHES: **BL**, **WH**, **PW**, **CUSTOM**

## MULTI-TIER SUPPORT



PART NUMBER	DESCRIPTION	WT. per pc.	QUANTITY per box
MULTI-TIER	Independent support structure for multiple tray layers. Support is two vertical and one horizontal support, and two attachment kits (U bolt and backer plate).	4 lbs	1 each

STANDARD FINISH: | AVAILABLE IN FINISHES: **BL**, **WH**, **PW**, **CUSTOM**

## UNDERFLOOR FITTING



PART NUMBER	DESCRIPTION	WT. per pc.	QUANTITY per box
WBTUFITTING	Intersection fitting kit used with WBT0x24x2.	3 lbs	1 kit

STANDARD FINISH:   
 AVAILABLE IN FINISHES: **BL**, **WH**, **PW**, **CUSTOM**



## GROUND/HOLD DOWN



PART NUMBER	DESCRIPTION	WT. per box	QUANTITY per box
GROUND SPLICE	Ground/hold down method used with underfloor tray.	7 lbs	50 sets

STANDARD FINISH: | AVAILABLE IN FINISHES: **BL**

### PEDESTAL CLAMP



PART NUMBER	DESCRIPTION	WT. per box	QUANTITY per box
PEDESTAL CLAMP	Underfloor support clamp.	0.5 lbs	1 each

STANDARD FINISH:



### PEDESTAL KIT



PART NUMBER	DESCRIPTION	WT. per box	QUANTITY per box
PEDESTAL KIT	Underfloor support kit. Includes 2 pedestal clamps, profile support and hardware.	3 lbs	1 each

STANDARD FINISH:

### FLOOR SUPPORT



PART NUMBER	DESCRIPTION	WT. per pc.	QUANTITY per box
FLOOR SUPT _X_	Cabinet/Underfloor support for tray.	1-3 lb	1 each

STANDARD FINISH: | AVAILABLE IN FINISHES: **BL**, **WH**, **PW**, **CUSTOM**  
 \*WASHER SUPT PLUS SOLD SEPARATELY.  
**SEE PART NUMBER KEY ON PAGE 14**



### UNDERFLOOR C BRACKET



PART NUMBER	DESCRIPTION	WT. per box	QUANTITY per box
WBTU6C	Multi-tier C bracket used to support 2nd tier of 6" wide tray underfloor.	2 lbs	1 each
WBTU12C	Multi-tier C bracket used to support 2nd tier of 12" wide tray underfloor.	4 lbs	1 each

STANDARD FINISH: | AVAILABLE IN FINISHES: **BL**, **WH**, **PW**, **CUSTOM**

### VERTICAL UP

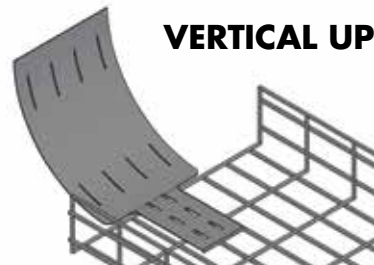

PART NUMBER	DESCRIPTION	WT. per box	QUANTITY per box
VERTICAL UP	The Vertical Up is used when transitioning cabling up from a raised computer floor.	1.75 lbs	1 each

STANDARD FINISH: | AVAILABLE IN FINISHES: **BL**, **WH**, **PW**, **CUSTOM**



# STAINLESS STEEL

In addition to our standard galvanized, zinc plated, and powder coated tray, WBT also offers a Stainless Steel solution tray and supports for industrial applications such as solar projects, food processing plants, marine applications, and other locations that will be exposed to moisture and/or corrosive environments. WBT's Stainless Steel option is available on many of our products and holds a minimal lead time. Contact a WBT representative today to learn more!

STAINLESS STEEL IS AVAILABLE ON:

- **Tray**
- **Splice Kits**
- **Washer Supports**
- **Bar Splice**
- **Corner Splice**
- **Mounting Accessories**



## APPLICATIONS FOR WBT

Whatever your project details, WBT has a solution (standard or custom) to meet your leadtimes and budgets, and to exceed your expectations.

### WBT INDUSTRY FIRSTS

- WBT Shaped wire (patented) for increased support and minimized cable strain
- WBT PreForm saves installation time and labor, while providing a better engineered install
- WBT NoSplice eliminates the need for additional materials/labor. Splice and support in one step
- **NEW** WBT flex divider allows faster installs and the ability to navigate pathway turns
- **NEW** WBT Transition for vertical elevation changes without the need to cut and configure
- WBTForm provides a solid flame-rated polymer insert for bottom and sides
- **NEW** WBTForm colors allows tray and form to match an unlimited combination of environments
- UL Classified painted tray means no need to remove paint at splice points to ground/bond
- UL Classified 2x4S tray is the only industry UL Classified 2x4 tray. No additional grounding
- Green PreGalv finish
- Cable Dropout for pathway bottom cable exits, available in 2x4 and 4x4
- Sidecar allows for secondary pathway outside of main tray

### COMMUNICATIONS/DATACOM



- Largest number/variety of trays and UL certified solutions
- Shaped tray for increased cabling support
- Industry best leadtimes on shipments and specials
- UL Classified on all painted tray colors

### INDUSTRIAL/ELECTRICAL



- Full offering of solutions to install tray in any industrial environment
- Higher loading capabilities allow for higher quantities and heavier cables
- Stainless steel tray, mounting accessories and splicing hardware for outdoor, caustic environments, food preparation and marine/offshore
- Custom tray configurations and solutions for unique environments
- Full inventory of trays and support products for quick ship capabilities

### MARINE/OFFSHORE



- WBT offers Stainless Steel tray, mounting accessories and splicing hardware for marine/offshore
- Hot Dipped tray sections for severe/outdoor installation environments
- Shaped tray offers higher load capabilities than competitive round/round constructions



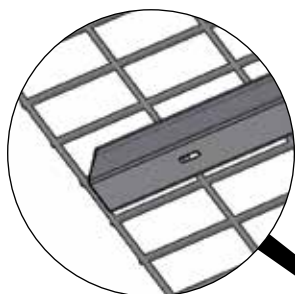

**DIVIDER**  
PAGE 20



**RADIUS DOWN**  
PAGE 13

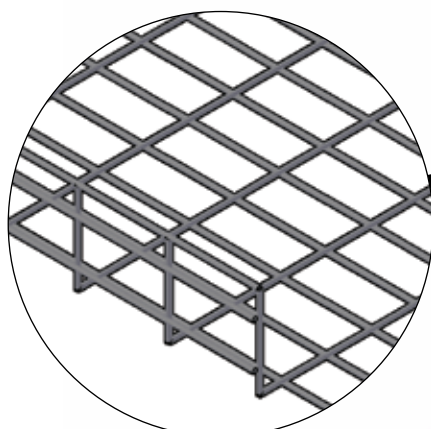

**WBT TRAY**  
PAGE 5

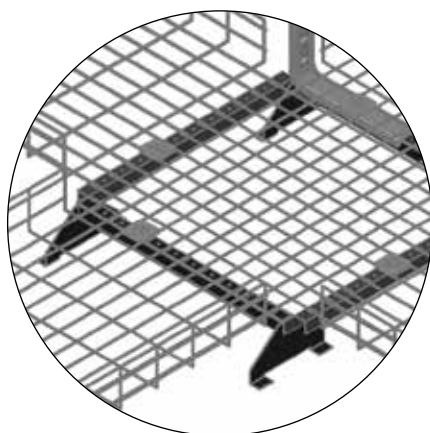

**WBT-U ACCESSORIES**  
PAGE 21

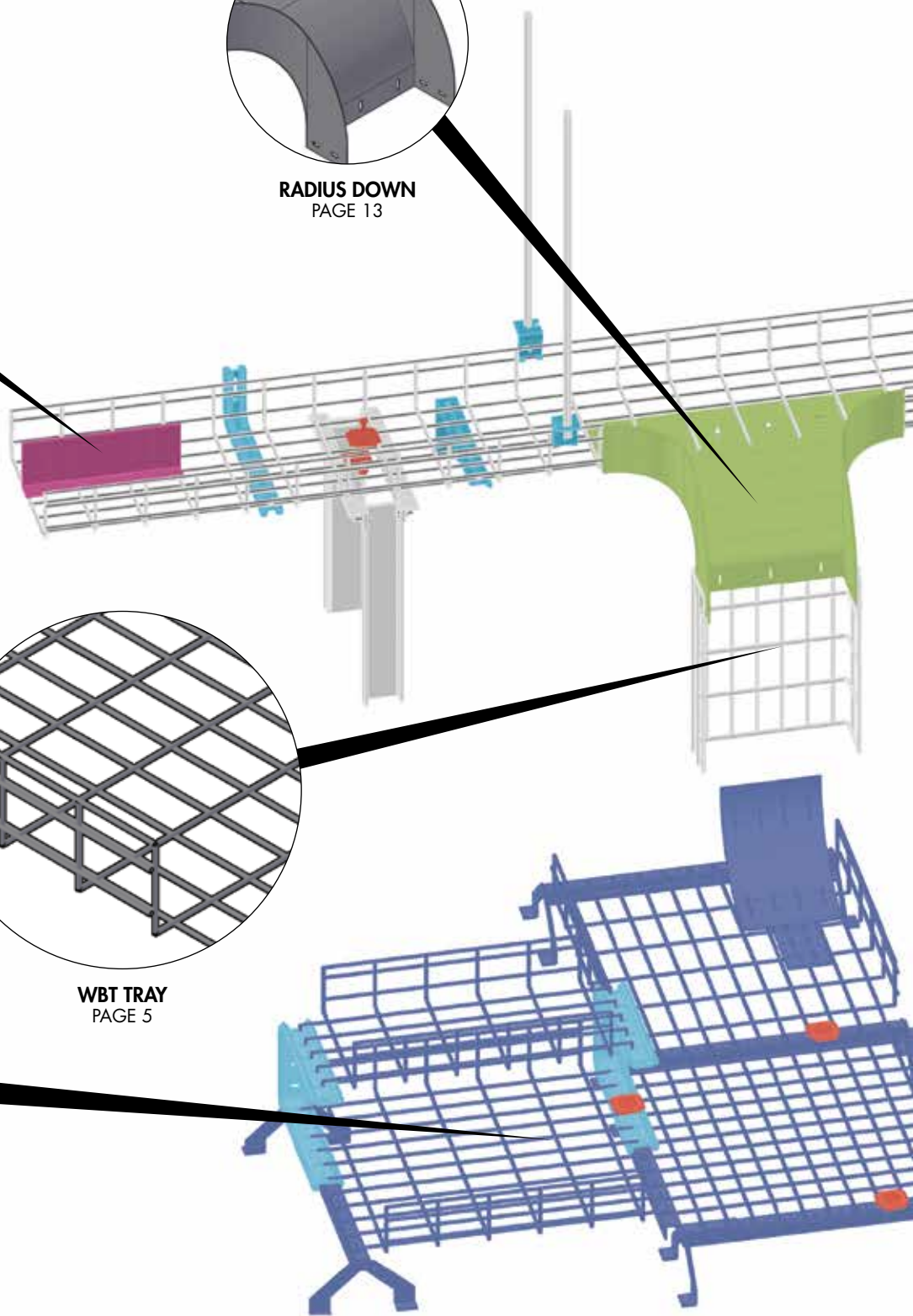

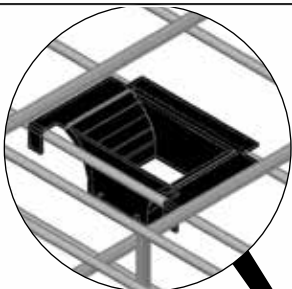

**CABLE DROPOUT**  
PAGE 14

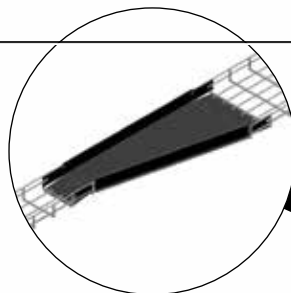

**PreForm TRAY REDUCE & COVER**  
PAGE 8

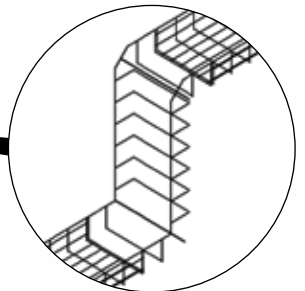

**PreForm TRANSITION**  
PAGE 8

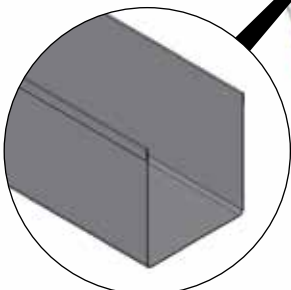

**STEEL INSERT**  
PAGE 19

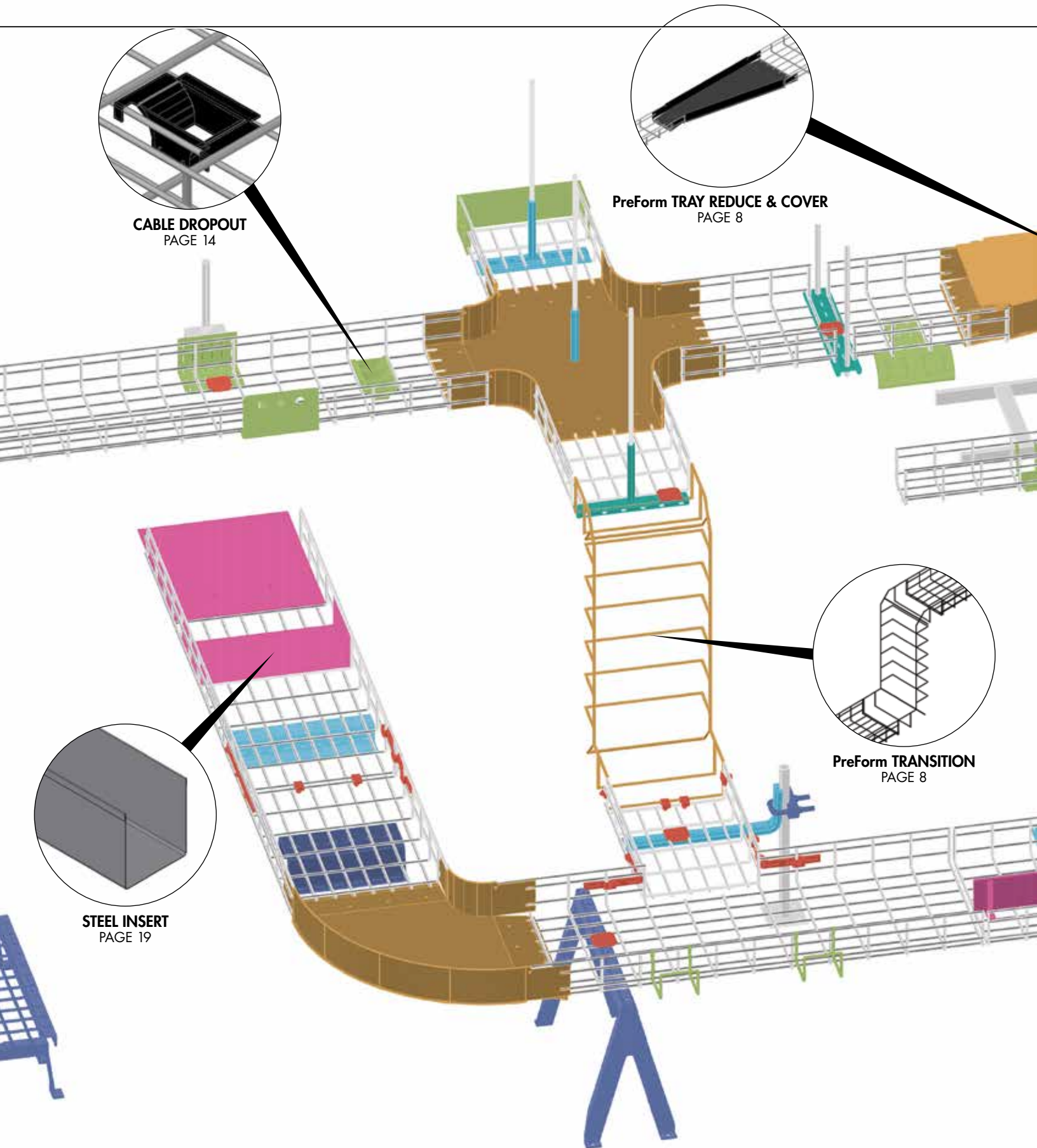

## PARTS CATEGORY KEY

**WBT PreForm**

PAGE 7

**WBT NoSplice**

PAGE 9

**SPLICING**

PAGE 10

**SUPPORTS**

PAGE 11

**ACCESSORIES**

PAGE 13

**WBT For Fiber**

PAGE 19

**WBT-U ACCESSORIES**

PAGE 21

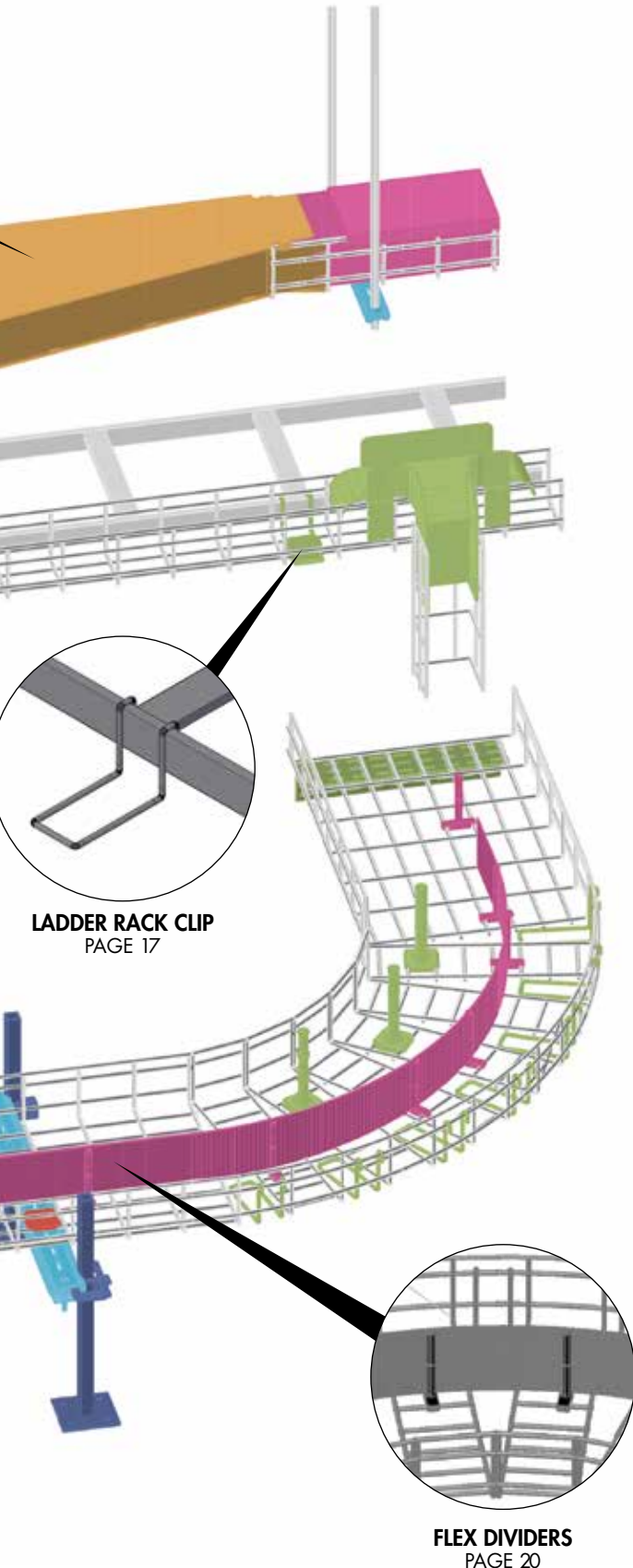

**LADDER RACK CLIP**  
PAGE 17

**FLEX DIVIDERS**  
PAGE 20



## WBT offers unrivaled Customer Support. Our services include the following:

- Installation assistance
- Free BOM from your drawings or blueprints
- Bid Specification Documents
- Engineering Drawings
- Design Assistance
- Custom Fabricated parts for your specific installation needs

## CONTACT US

Email us: [sales@WBTray.com](mailto:sales@WBTray.com)

Call us toll free: **888.4WB.TRAY** (888.492.8729)

Call us locally: **618.918.3821**

Fax us: **618.918.3825**

## VISIT US ONLINE: **WWW.WBTRAY.COM**

WBT gives you access to a bevy of valuable online tools and forms such as cut sheets, CSI specs, technical specs, certified test reports & more.

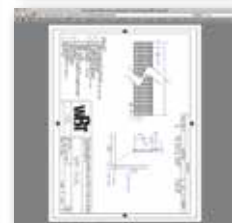
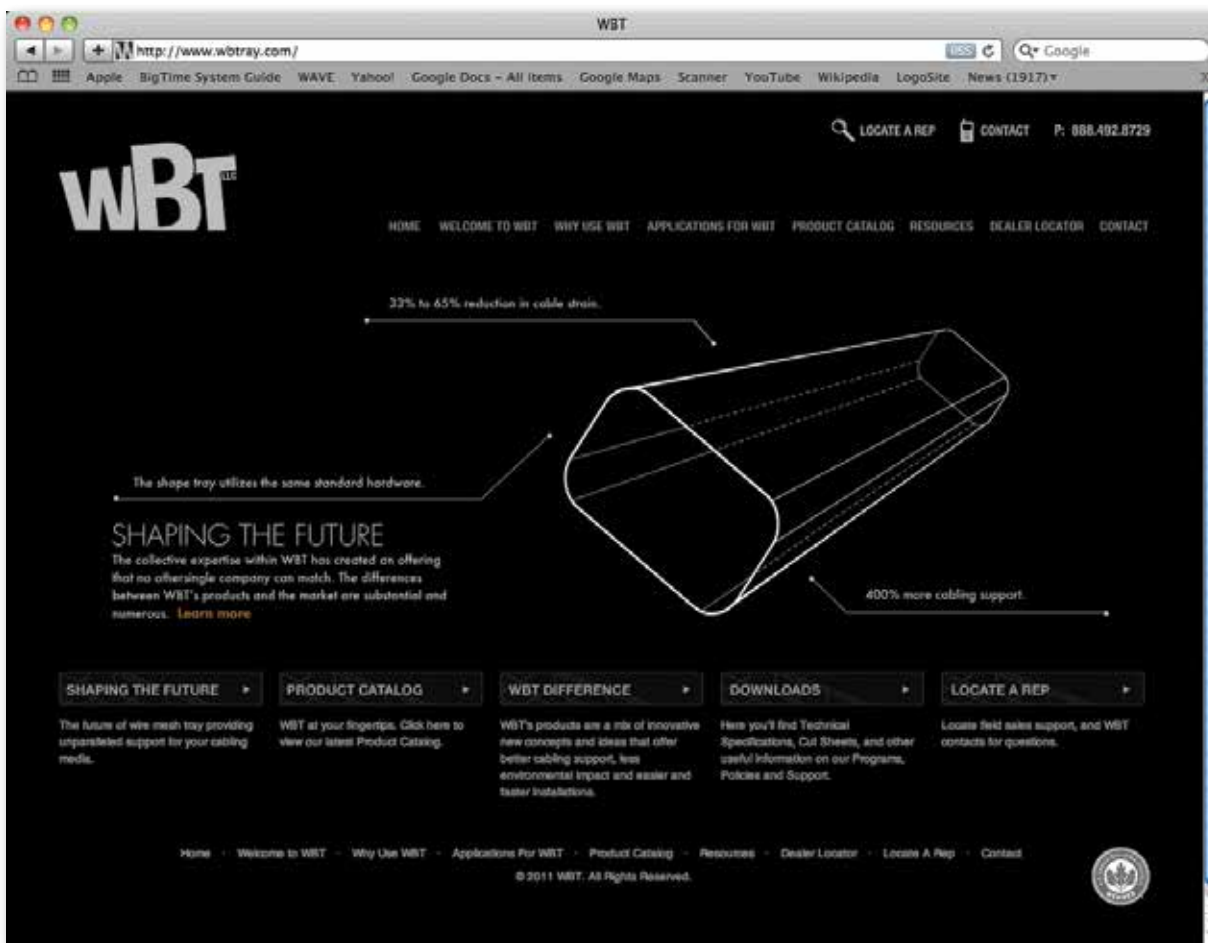

As part of a process of ongoing innovation, WBT reserves the right to change specifications without prior notice. This includes changes in product dimensions, materials and finish material/processes and product availability. Please consult WBT for any questions.

It is acknowledged that all Trade Marks, Product Data, Logos, etc. used within this catalog are the sole and exclusive property of WBT LLC.



PERFORMANCE CABLETRAY™

115 Harting Drive | Centralia, IL 62801 | 888.4WB.TRAY | WBTRAY.COM

