

# BASP

## SLURRY SOLUTIONS



SS HI-CHROME  
SUBMERSIBLE PUMPS

MODEL	Discharge Size in. / mm	Max HP	Max Amps 460V - 60Hz
SS-3/5	3" / 75 mm	5HP	8.4
SS-4/8	4" / 100mm	8HP	11.4
SS-6/12	6" / 150 mm	12HP	16.1
SS-6/15	6" / 150mm	15HP	18.2
SS-8/20	8" / 200 mm	20HP	24.9
SS-8/30	8" / 200 mm	30HP	34.7
SS-8/40	8" / 200 mm	40HP	48
SS-8/50	8" / 200 mm	50HP	58

SPECIFICATIONS	
Shaft Seals	Double Mechanical, Silicon-Carbide
Bearings	Dual-Ball Bearing
Motor	4-Pole w/ Thermal Overload, 208/230/460/575v
Double Mech. Seals	SC/SC - TC/SC
Cooling	Top Discharge for partial-submersion cooling
Coating Finish	Primer w/ Epoxy Paint
Max Particle Size	1.2"
pH Range	5-12
Impeller Type	Multi-Vane, Semi-Open
Max Fluid Temp. (F)	105 °F
Max Submergence Depth	65 Feet
Max Start Cycles per Hour	15



MATERIALS OF CONSTRUCTION			
Outer Casing	ASTMA-48	Shaft	403 Stainless Steel
Stator Casing	ASTMA-48	Hardware	304 Stainless Steel
Impeller	28% Hi-Chrome Iron	O-Rings	Nitrile Rubber
Wear Plate	28% Hi-Chrome Iron	Double Mech. Seals	SC/SC - TC/SC
Agitator	28% Hi-Chrome Iron	Cable Type	SOOW

# BASP

## SLURRY SOLUTIONS



SS HI-CHROME  
SUBMERSIBLE PUMPS

### Applications:

Electric submersible slurry & sand pump - 28% hi-chrome.  
Designed for portable and abrasive applications

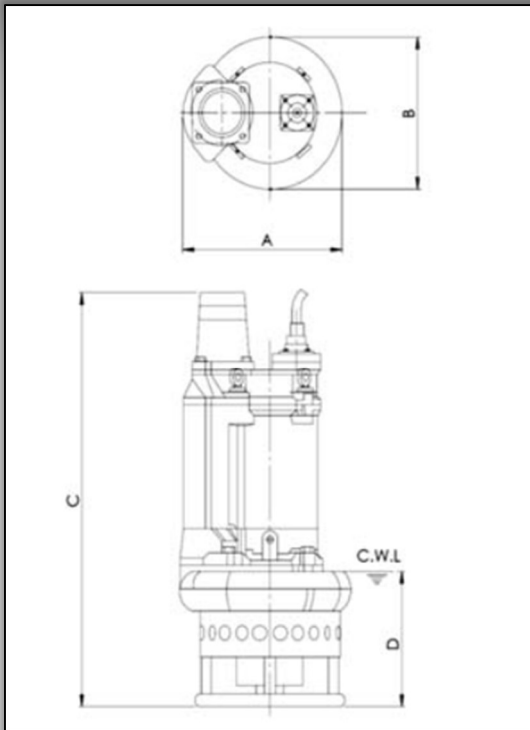

MODEL	A	B	C	D*	WEIGHT (LBS)
SS3-5	13.8"	12.8"	32.2"	9.9"	262
SS4-8	16.4"	14.7"	33.3"	9.9"	332
SS6-12	17.1"	16.0"	35.0"	9.9"	403
SS6-15	17.1"	16.0"	36.5"	9.9"	462
SS8-20	19.1"	18.0"	44.2"	11.6"	612
SS8-30	22.8"	20.8"	49.0"	13.0"	955
SS8-40	24.5"	21.4"	54.3"	17.0"	1,179
SS8-50	24.5"	21.4"	54.3"	17.0"	1,234

\*Lowest Operational Suction Level

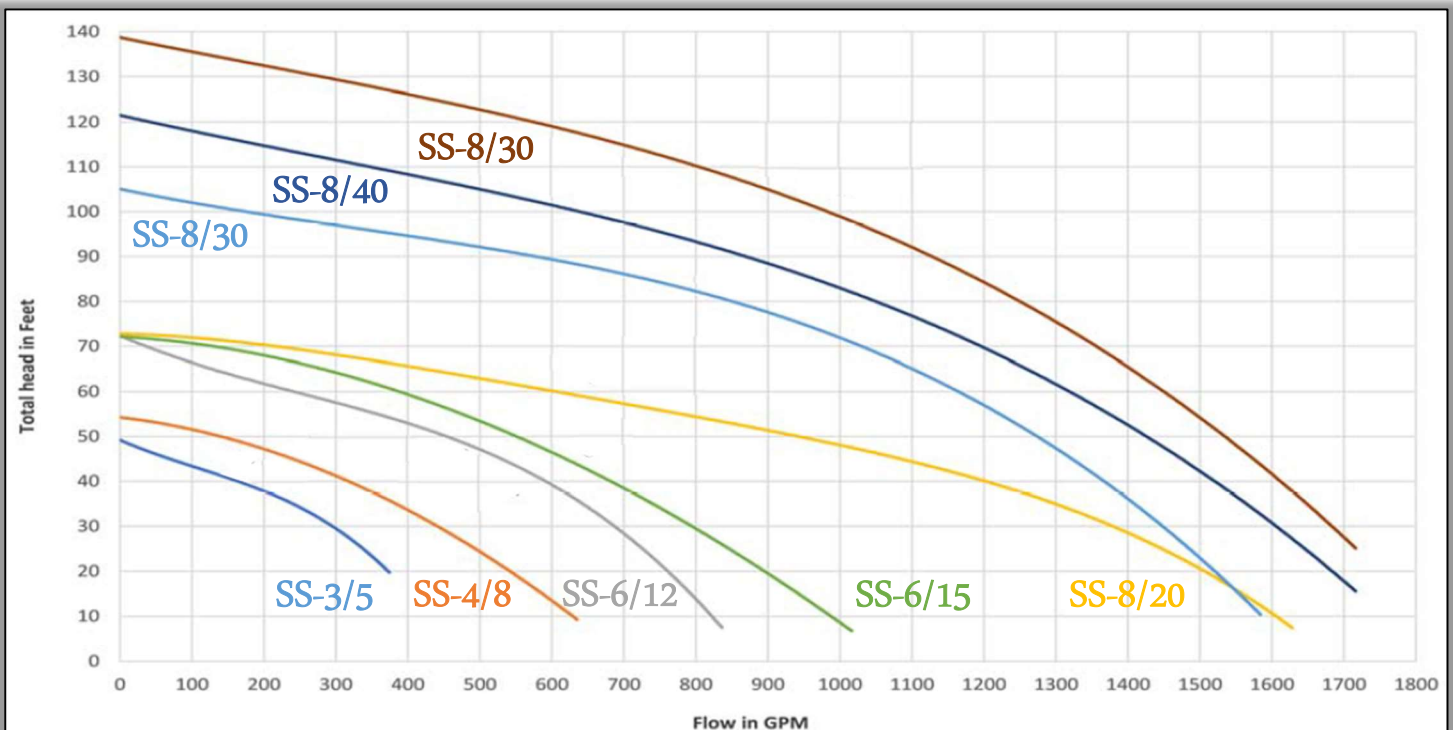

Performance Curve based on Clean Water at 68° F with 1.0 SG. Please Correct for Other conditions