

BASP

SLURRY PUMPS

Horizontal Lined Severe Duty Slurry Pumps

Series: "DT" "DP" "DR"

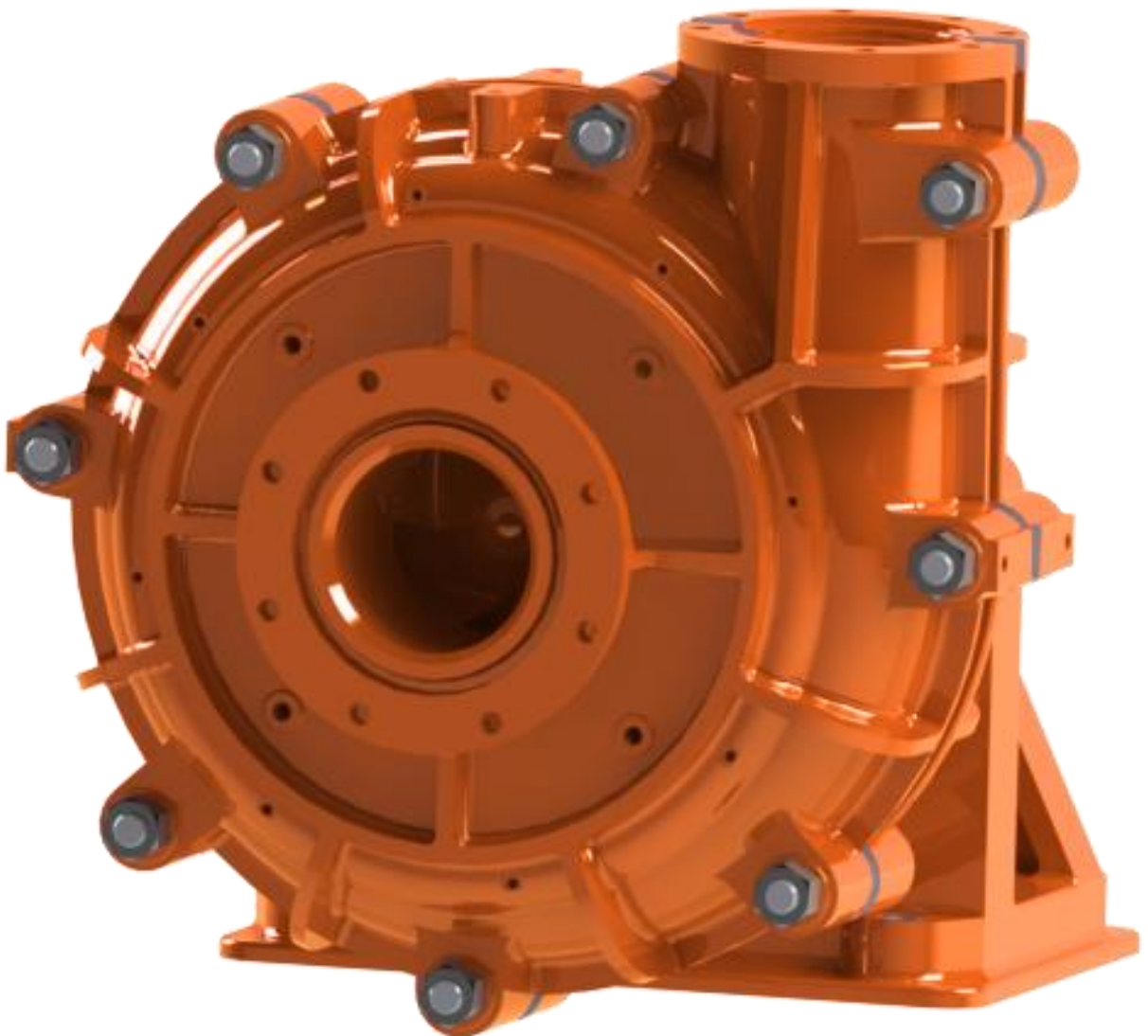

www.baspconsulting.com

“DT” Series

“DT” pumps are designed for a wide band of slurry applications. They are generally used for slurries containing high concentrations of erosive solids and where a robust heavy-duty pump is required.

Series “DT” Attributes:

Horizontal, centrifugal, single stage, lined, split case, end-suction pump

- **Discharge Diameters** 1” to 18” (25mm to 450mm)
- **Heads through** 240ft (73m)
- **Flow Rates through** 20,000 USGPM (4542 m3h)
- **Casing Pressure MWP Metal Lined** 300psi (20.7 bar)
- **Casing Pressure MWP Elastomer Lined** 100psi (6.9 bar)
- **Temperature Limitation Rubber Lined** 150° F (65°C)
- **Temperature Limitation Hypalon or Butyl Lined** 220° F (104°C)
- **Temperature Limitation Metal Lined** 250° F (120°C)
- **Standard Hardness** 600-650BHN (59.8 Rc) Metal Lined
- **pH range from** 1-14

Sealing Options:

- Dynamic Seal – No flush water
- Dynamic Seal – Extremely low flush rate
- Static Stuffing Box – Full flush rate
- Static Stuffing Box – Low flush rate
- Mechanical Seal

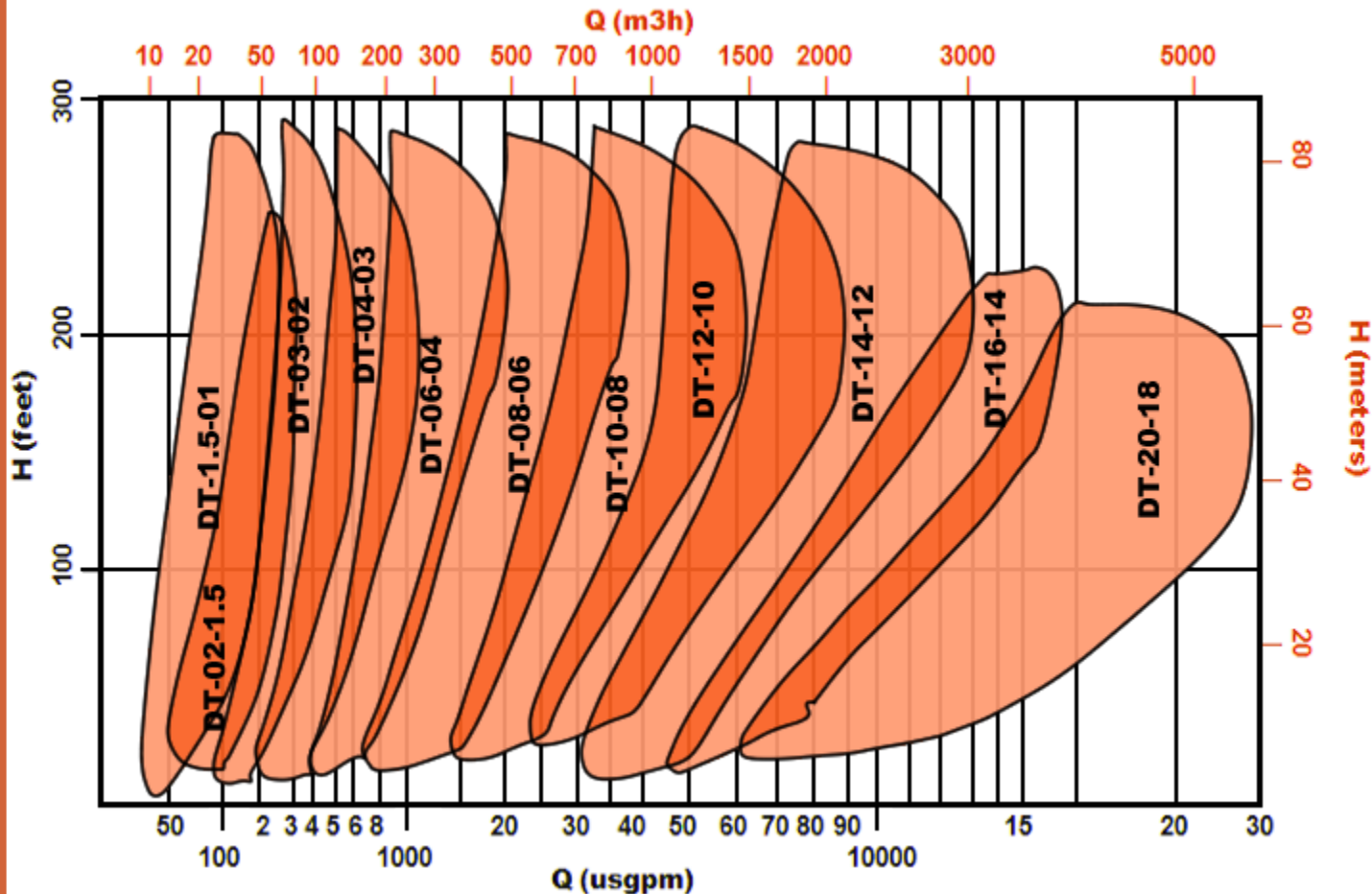

“DR” Series

“DR” pumps are designed for a wide range of erosive and/or corrosive applications. They are generally used for slurries containing medium concentrations of erosive solids and where a heavy-duty pump is required.

Currently only Models DR-10-08, and DR-12-10 are available with elastomer liners.

Series “DR” Attributes:

Horizontal, centrifugal, single stage, lined, split case, end-suction pump

- Discharge Diameters 3” to 18” (75mm to 450mm)
- Heads through 180ft (55m)
- Flow Rates through 24,000 USGPM (5500 m3h)
- Casing Pressure MWP Metal Lined 150psi (10.3 bar)
- Casing Pressure MWP Elastomer Lined 100psi (6.9 bar)
- Temperature Limitation Metal Lined 250° F (120° C)
- Temperature Limitation Rubber Lined 150° F (65° C)
- Temperature Limitation Hypalon or Butyl Lined 220° F (104° C)
- Standard Hardness Metal Lined 600-650BHN (59.8 Rc)
- pH range from 1-14

Sealing Options:

- Dynamic Seal – No flush water
- Dynamic Seal – Extremely low flush rate
- Static Stuffing Box – Full flush rate
- Static Stuffing Box – Low flush rate
- Mechanical Seal

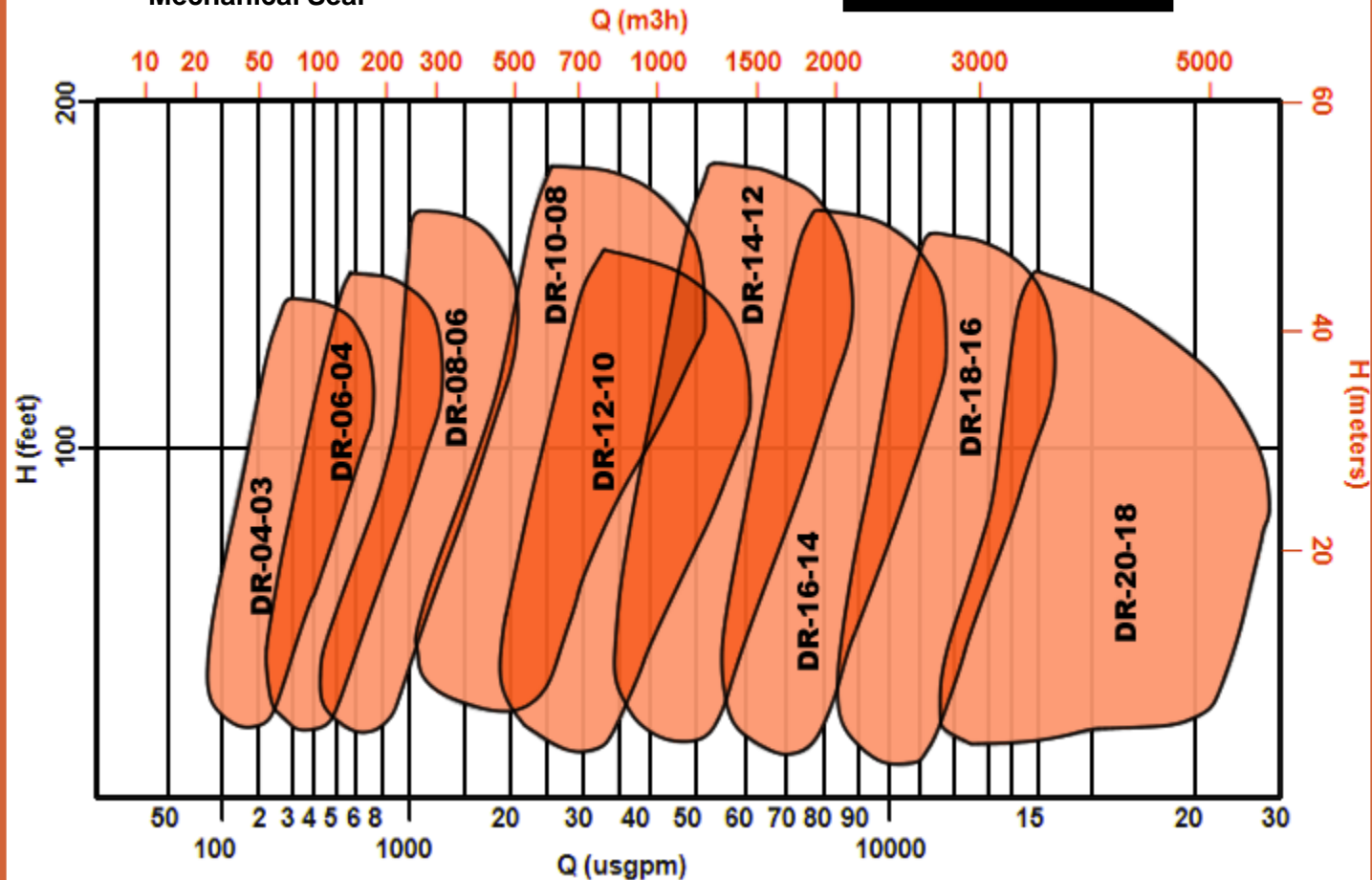

BASP "DP" Series

"DP" pumps are extremely robust, large, slow speed pumps that are designed with extra abrasive resistant material to deal with your worst applications.

"DP" pumps are designed for high pressure applications and can train as many as 5 pumps in series.

"DP" pumps are only available with metal liners and impeller.

Series "DP" Attributes:

Horizontal, centrifugal, single stage, lined, split case, end-suction pump

- **Discharge Diameters** 1" to 4" (25mm to 100mm)
- **Heads through** 325ft (100m)
- **Flow Rates through** 4,000 usgpm (900 m3h)
- **Casing Pressure MWP** 500psi (35 bar) Metal Lined
- **Temperature Limitation** 250° F (120° C) Metal Lined
- **Standard Hardness** 600-650BHN (59.8 Rc) Metal Lined
- **pH range from** 1-14

Sealing Options:

- Dynamic Seal – No flush water
- Dynamic Seal – Extremely low flush rate
- Static Stuffing Box – Full flush rate
- Static Stuffing Box – Low flush rate
- Mechanical Seal

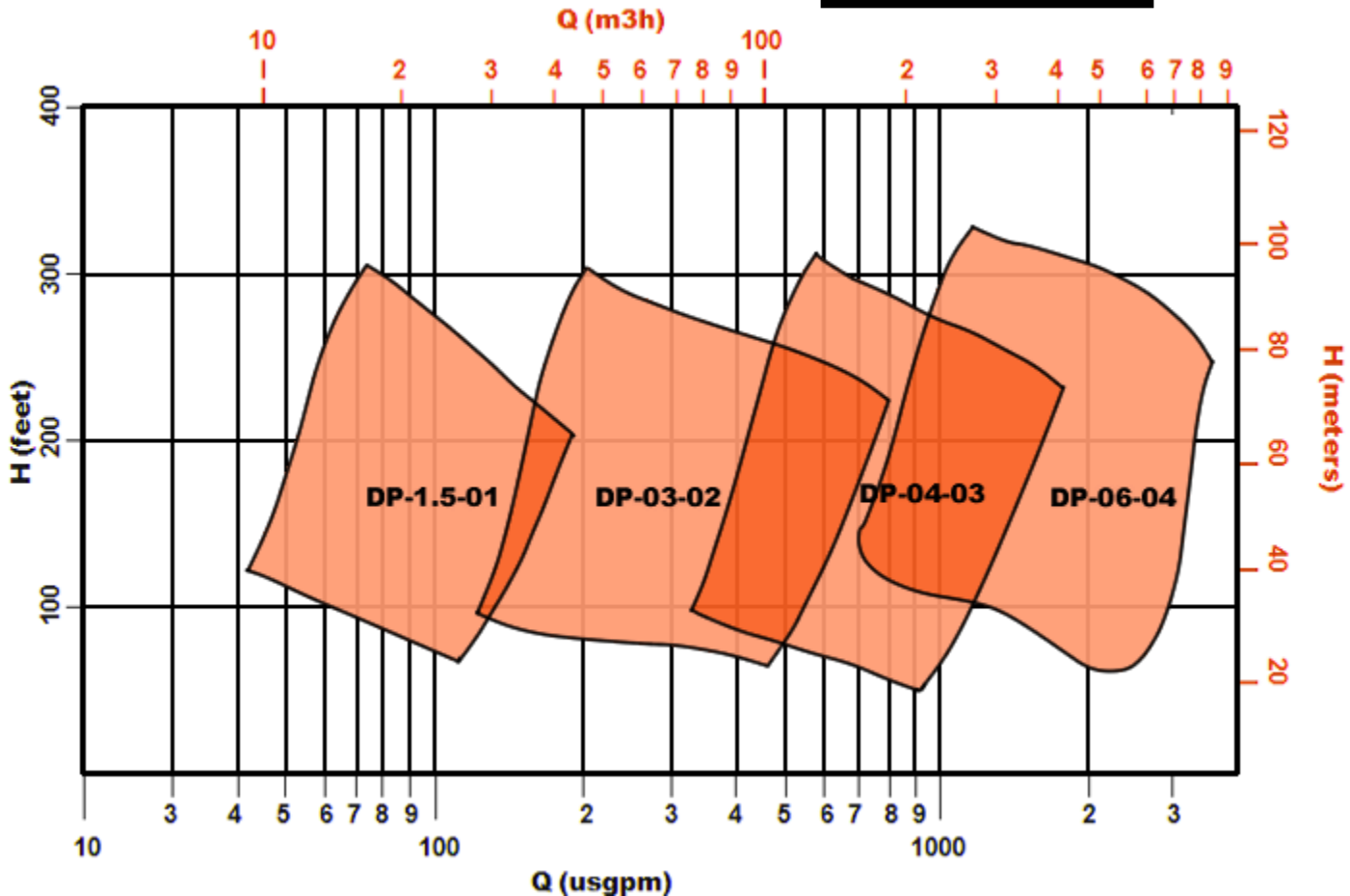

TYPICAL BEARING ASSEMBLY PARTS

Frames: XB XC XD XE XF XG

Multiple Domestic and Overseas Bearing Options Available. Timken Used as Standard.

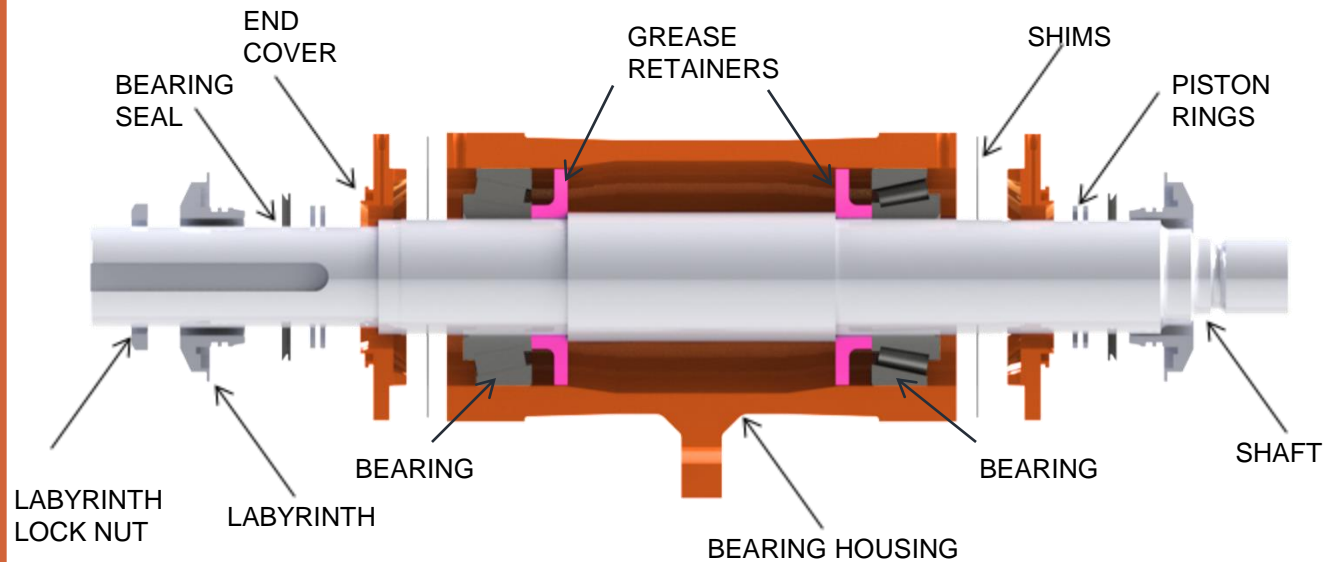

TYPICAL BEARING ASSEMBLY PARTS

Frames: CC DD EE FF GG XS XR XT

Multiple Domestic and Overseas Bearing Options Available. Timken Used as Standard.

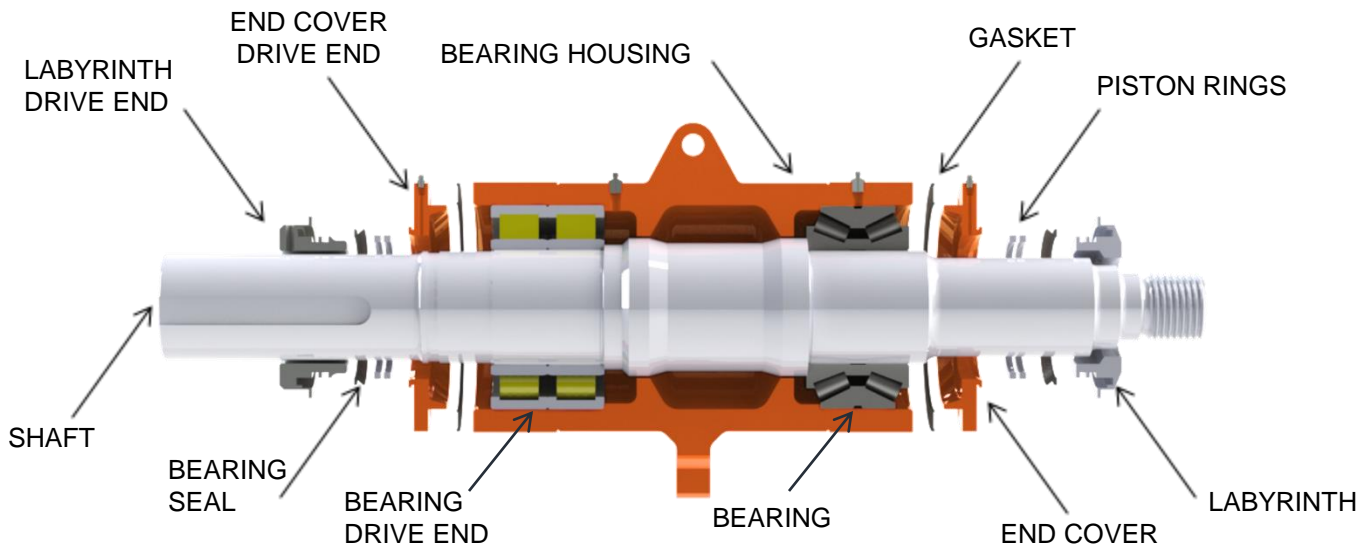

TYPICAL FRAME ASSEMBLY PARTS

(VARIATIONS OCCUR BETWEEN MODELS)

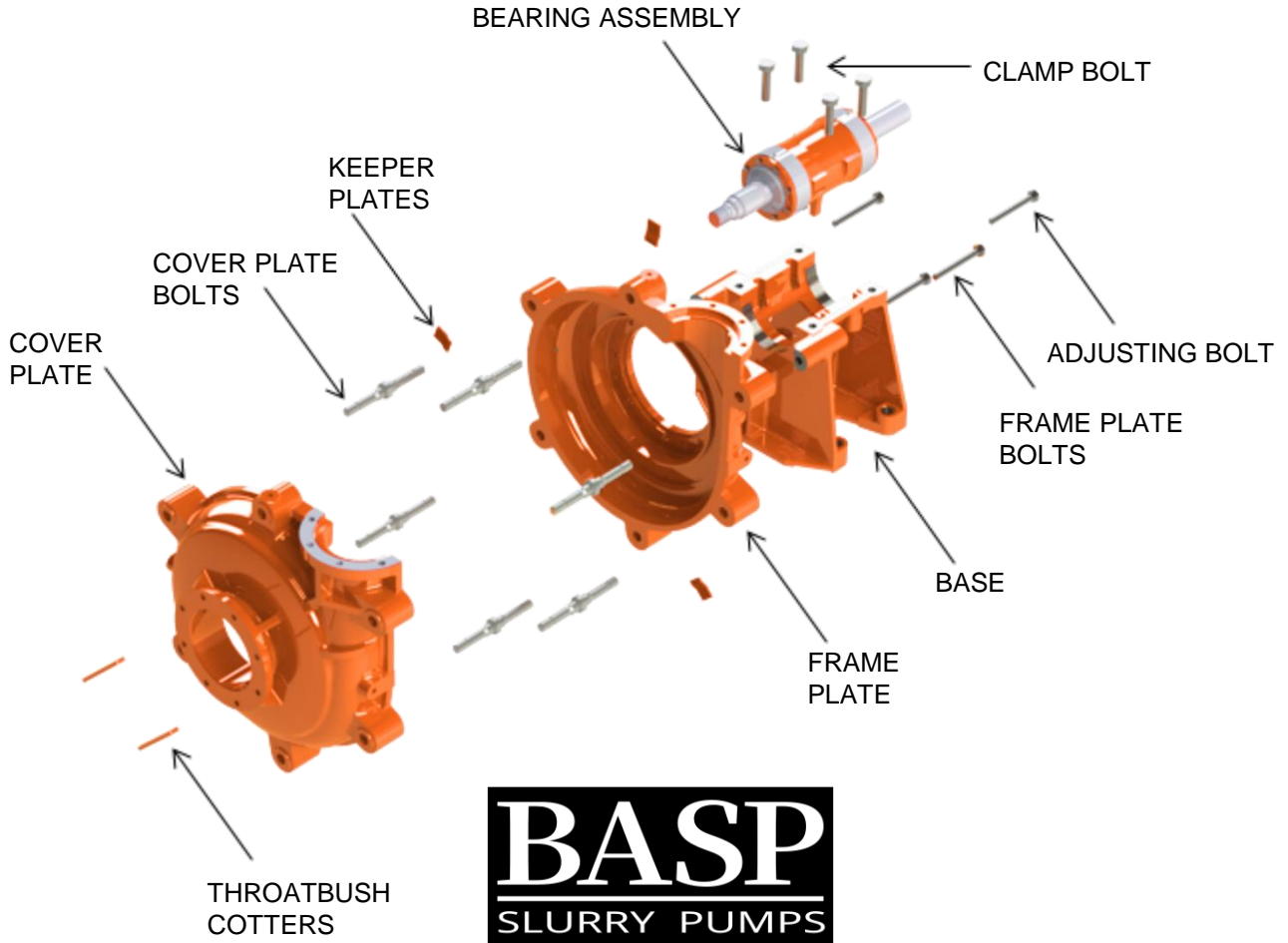

TYPICAL STUFFING BOX ASSEMBLY PARTS

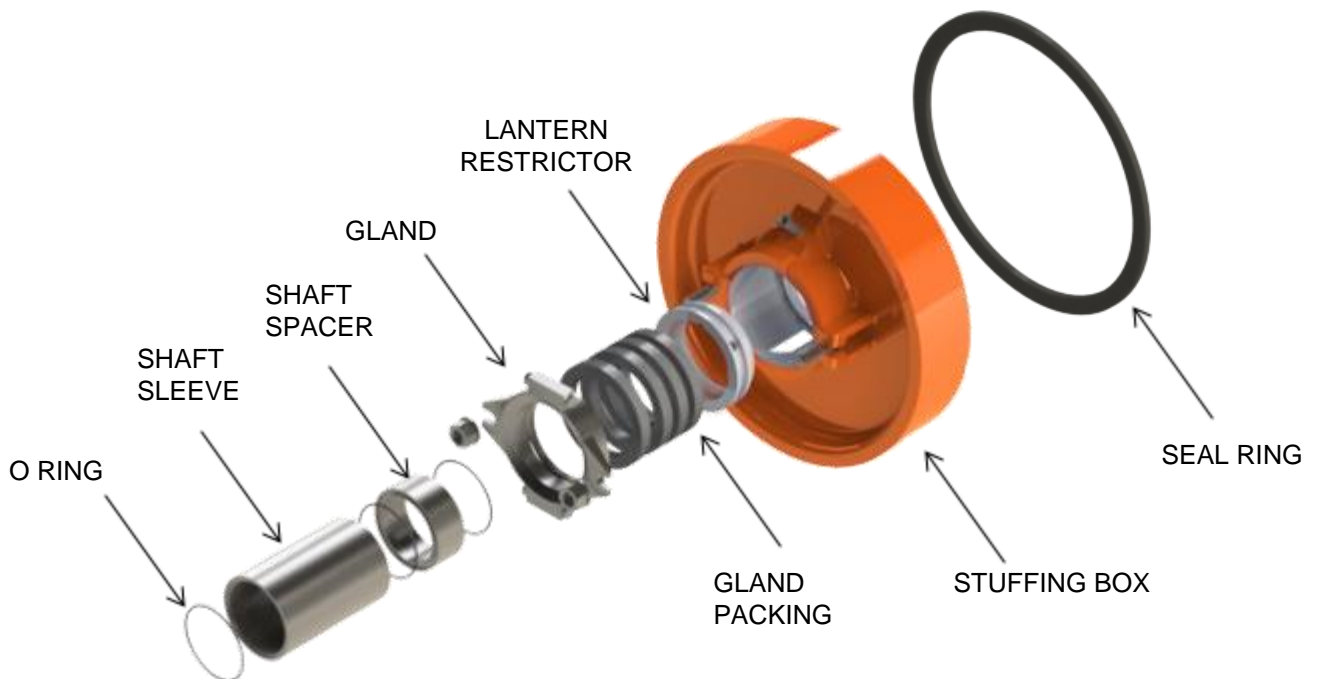

TYPICAL DYNAMIC SEAL ASSEMBLY PARTS

GREASE LUBRICATED

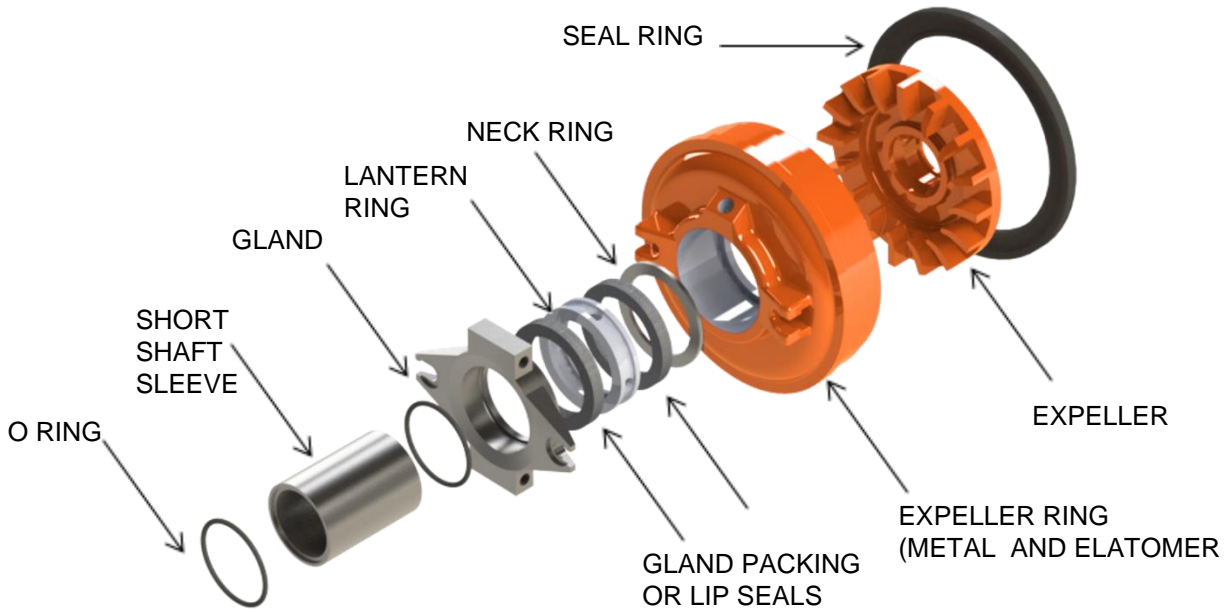

TYPICAL DYNAMIC SEAL ASSEMBLY PARTS

LOW FLOW - WATER ASSISTED

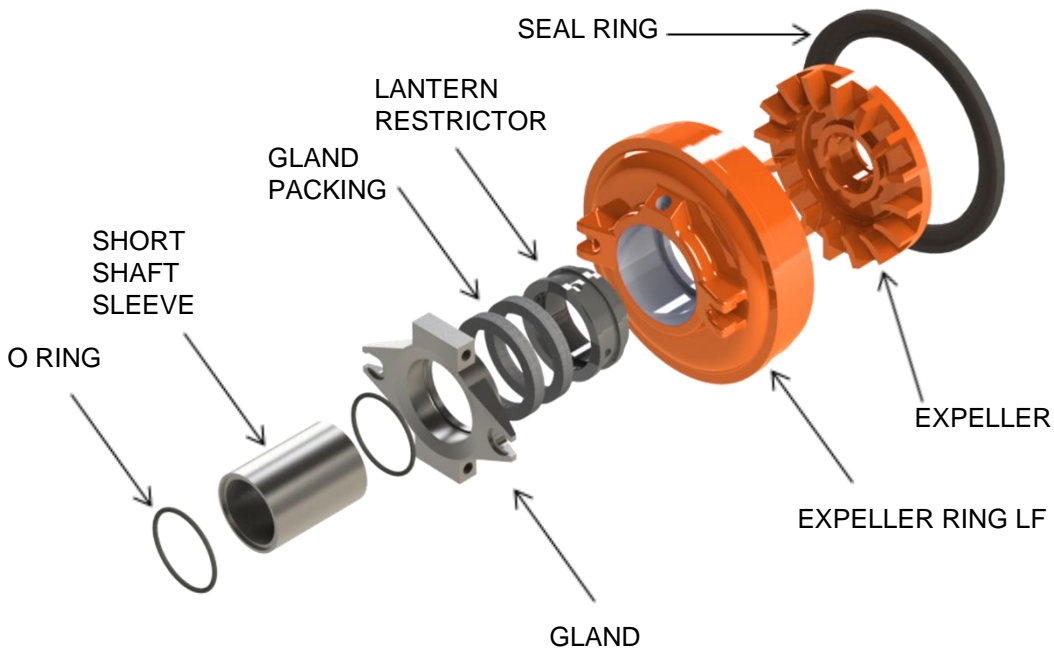

TYPICAL MECHANICAL SEAL ASSEMBLY PARTS

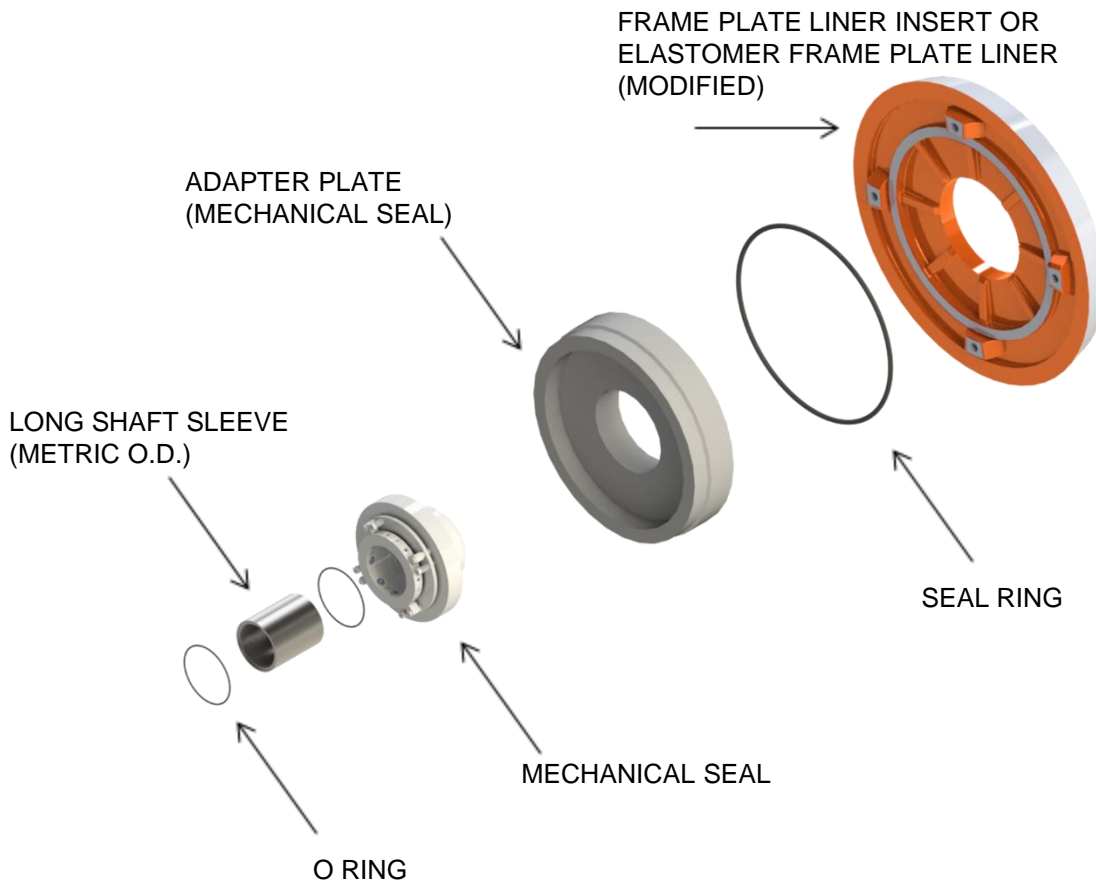

PLEASE NOTE FOR ALL SEALING ARRANGEMENTS:

NOT ALL SHAFT SLEEVE STACKUPS ARE SHOWN. PLEASE CONTACT US FOR ALL OPTIONS.

SEALING ARRANGEMENTS, LUBRICATION AND SEALING PLANS ARE NOT SHOWN.

ADDITIONAL TYPES OF MECHANICAL SEALS AND ARRANGEMENTS ARE AVAILABLE

ALL STUFFING BOX AND DYNAMIC SEALS INCORPORATE 316 STAINLESS STEEL CERAMIC COATED SHAFT SLEEVES AND 316SS GLANDS AS STANDARD

TYPICAL METAL WET END ASSEMBLY PARTS

(VARIATIONS OCCUR BETWEEN MODELS)

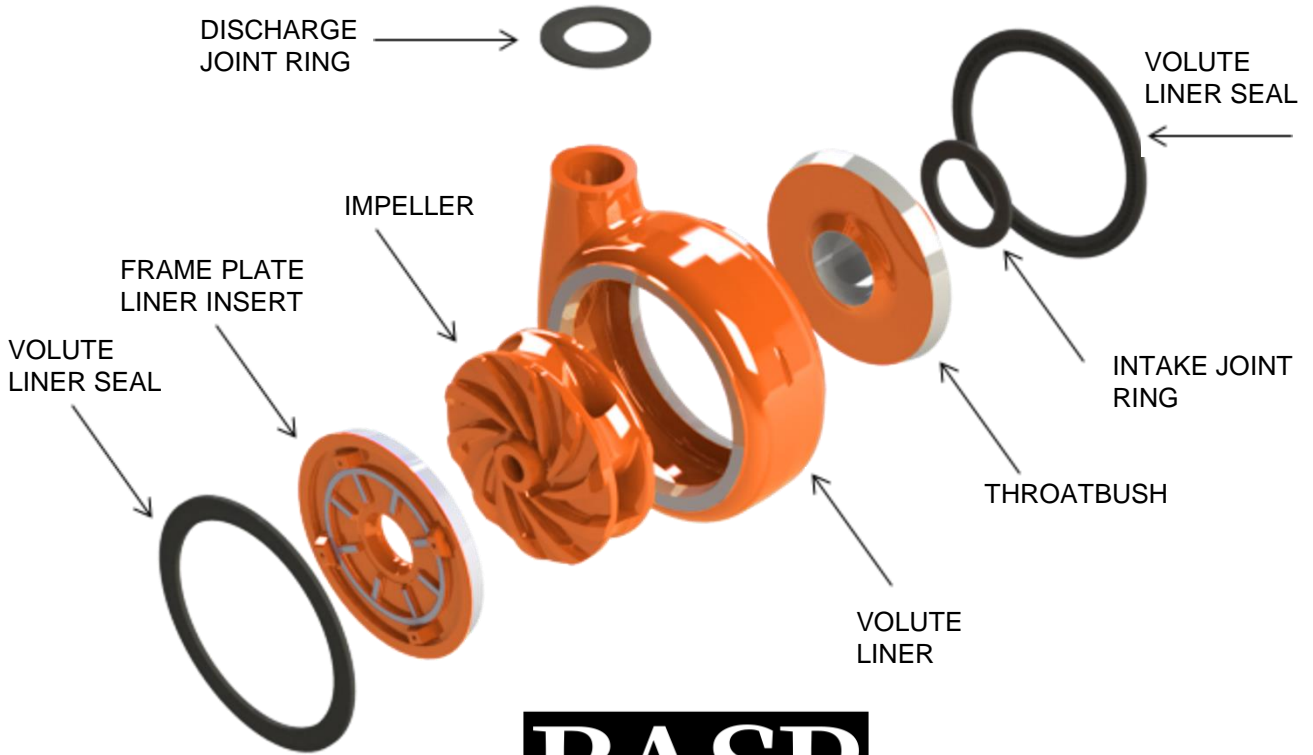

TYPICAL ELASTOMER WET END ASSEMBLY PARTS

(VARIATIONS OCCUR BETWEEN MODELS)

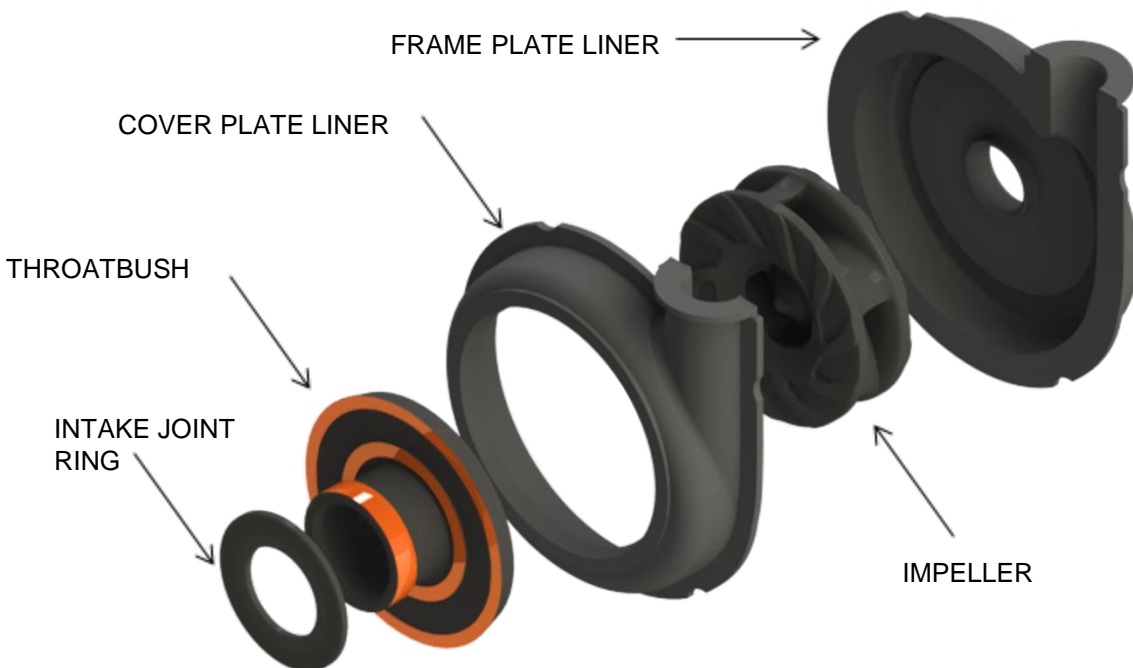

MAXIMUM POWER PER BEARING ASSEMBLY

This guide is to ensure that you do not over-power your Bearing Assembly. This chart is designed for powering the Bearing Assembly with a V-Belt Drive.

For Direct Drive or Direct Drive via a Gear Reducer these values can be multiplied by 1.5.



<u>Shaft Dia.</u>		<u>Max Power</u>	
<u>Frame Size</u>	<u>Drive End MM</u>	<u>Max HP</u>	<u>Max kW</u>
XB	28	20	14.9
XC	42	40	29.8
CC	45	74	55.2
XD	65	80	59.7
DD	60	148	110.4
XE	80	161	120.1
EE	85	302	225.2
XR	85	402	299.8
XF	100	349	260.2
FF	120	570	425
XS	120	751	560
XG	140	805	600.3
GG	150	1207	900.1
XT	150	1609	1199.8

BASP HYDRAULIC CONSULTING INC. DOES NOT REPRESENT AND IS NOT IN ANY WAY AFFILIATED WITH WEIR MINERALS®. ALL NAMES, NUMBERS, SYMBOLS AND DESCRIPTIONS ARE USED FOR REFERENCE PURPOSE ONLY AND DO NOT IMPLY THAT ANY PART OR PUMP LISTED IS THE PRODUCT OF WEIR MINERALS®.