



EP
Let's grow together

ES12-12ES/ES12-25DM Electric Stacker 1.2t

- Electric Stacker With Smallest Working Space Needed
- Innovative Design of Low Energy Consumption and High Reliability
- Long & Aside Tiller Design Makes Operations Safe and Convenient

EP EQUIPMENT CO.,LTD
www.paleciaki.info

CE

FEATURE

Performance

- Robust Structure;
- Highly specialized drive and hydraulic system ensure excellent driving performance and high reliability.
- Low-noise and durable hydraulic unit, high quality cylinder as well as hose ensure high reliability of hydraulic system.
- AMP connector and durable electric wires greatly reduce malfunctions of components.
- Straddle Chassis option offers stability of high stack operation.



Safety

- Safety hydraulic design prevents mast from falling down abruptly when oil pipes cut off.
- Belly button prevents truck from hitting operator.
- By simply pressing emergency disconnect, power supply will be immediately interrupted.
- Multi lifting limited switch ensures travel safety.
- Truck automatically switches to low speed mode, when lifting height is higher than setting height.
- Anti-rolling back braking device ensures trucks don't roll back on ramps.

Operation

- Ergonomic tiller head for effortless and comfortable operations.
- Tiller with long arm for smooth steering.
- Compact chassis design offers smallest turning radius needed.
- Side operating ensures excellent visibility.
- On-board Charger.

Maintenance

- Maintenance-free Battery.
- Battery display indicator with hour meter, reminds operator of charging on time (optional).
- Easy Maintenance — detachable rear panel.
- Self-Diagnostics signal on the digital display allows easy trouble-shooting.
- Easy Access of Hand Set.
- Low-voltage Cut-off Protection.

Electric Stacker 1.2t

ES12-12ES/ES12-25DM

Distinguishing mark						
1.1	Manufacturer				EP	EP
1.2	Model designation				ES12-12ES	ES12-25DM
1.3	Drive unit				electrics	electrics
1.4	Operator type				pedestrian	pedestrian
1.5	rated capacity	Q	kg		1200	1200
1.6	Load center distance	c	mm		600	600
1.8	Load distance, centre of drive axle to fork	x	mm		795	845
1.9	Wheelbase	y	mm		1240	1290
Weight						
2.1	Service weight (include battery)		kg		661	676
2.2	Axle loading, laden driving side/loading side		kg		845/1016	837/1039
2.3	Axle loading, unladen driving side/loading side		kg		536/125	549 / 127
Types,Chassis						
3.1	Tyre type Driving wheels/Loading wheels				PU/ PU	PU/ PU
3.2	Tyre size, driving wheels (diameter×width)		mm		Ø210×70	Ø210×70
3.3	Tyre size, loading wheels (diameter×width)		mm		Ø80×60	Ø100×50
3.4	Tyre size, caster wheels (diameter×width)		mm		Ø130×55	Ø100×50
3.5	Wheels, number driving, caster/loading (x=drive wheels)		mm		1x +1/4	1x +1/4
3.6	Track width, front, driving side	b ₁₀	mm		533	533
3.7	Track width, rear, loading side	b ₁₁	mm		400	1060/1160/ 1260 /1360
Dimensions						
4.1	Tilt of mast/fork carriage forward/backward	α/ β	°			
4.2	Height, mast lowered	h ₁	mm		2052	2083
4.3	Free lift	h ₂	mm			
4.4	Lift height	h ₃	mm		2930	2930
4.5	Height, mast extended	h ₄	mm		3487	3895
4.6	Initial lift	h ₅	mm			
4.9	Height drawbar in driving position min./max.	h ₁₄	mm		860/ 1200	860/ 1200
4.10	Height of wheel arms	h ₈	mm			
4.15	Lowered height	h ₁₃	mm		88	60
4.19	Overall length	l ₁	mm		1740	1650
4.20	Length to face of forks	l ₂	mm		590	580
4.21	Overall width	b ₁ / b ₂	mm		800	1135/1235/ 1335 /1435
4.22	Fork dimensions	s/ e/ l	mm		60/ 170/ 1150	35/ 100/ 1070
4.24	Fork carriage width	b ₃	mm		680	800
4.25	Outside width of the forks	b ₅	mm		570	200~765
4.26	Distance between wheel arms	b ₄	mm			100
4.31	Ground clearance, laden, below mast	m ₁	mm			
4.32	Ground clearance, center of wheelbase	m ₂	mm		30	40
4.34.1	Aisle width for pallets 1000 × 1200 crossways	Ast	mm		2225	2255
4.34.2	Aisle width for pallets 800 × 1200 lengthways	Ast	mm		2150	2180
4.35	Turning radius	Wa	mm		1408	1404
Performance data						
5.1	Travel speed, laden/ unladen		km/ h		4/4.5	4/4.5
5.2	Lifting speed, laden/ unladen		m/ s		0.12/0.22	0.12/0.22
5.3	Lowering speed, laden/ unladen		m/ s		0.12/0.11	0.12/0.11
5.8	Max. gradeability, laden/unladen		%		3/10	3/10
5.10	Service brake type				Electromagnetic	Electromagnetic
Electric-engine						
6.1	Drive motor rating S2 60 min		kW		0.65	0.65
6.2	Lift motor rating at S3 15%		kW		2.2	2.2
6.3	The maximum allowed size battery		mm		325x180x230	325x180x230
6.4	Battery voltage/nominal capacity K20		V/ Ah		2x12/105	2x12/105
6.5	Battery weight		kg		2x30	2x30
Addition data						
8.1	Type of drive unit				DC	DC
10.5	Steering type				Mechanical	Mechanical
10.7	Sound pressure level at the driver's ear		dB(A)		74	74

1.The parameters in the table are of the standard model. For more information, please contact us.

2.The parameters are subject to change without notice.

ES12-12ES/ES12-25DM

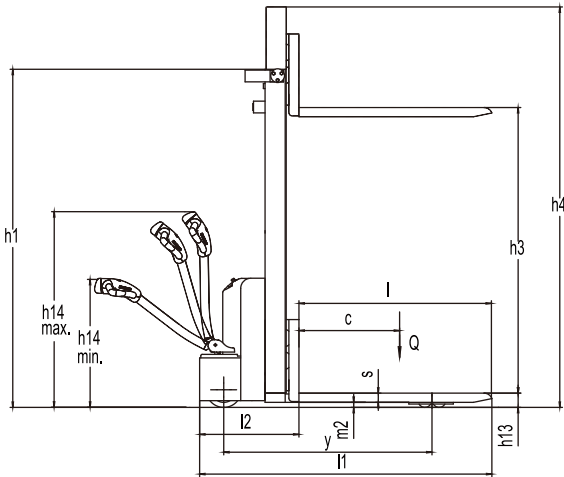

ES12-12ES

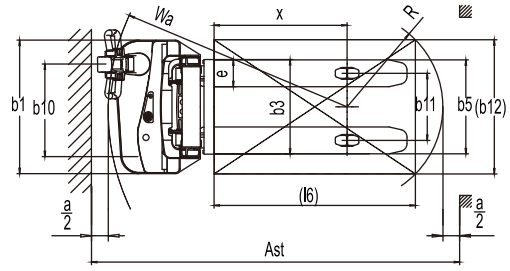

ES12-25DM

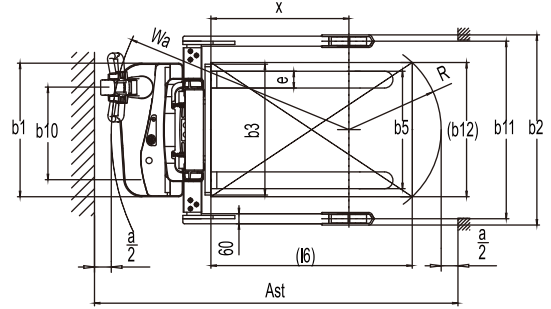

RATED CAPACITIES GRAPH

ES12-12ES/ES12-25DM

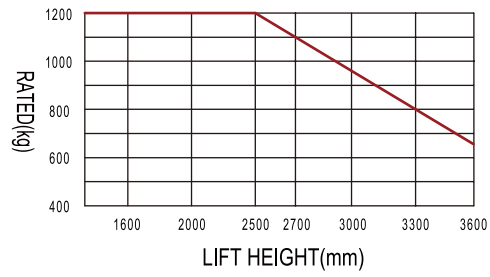

Mast Option

ES12-12ES

mast types	Lift h3+h13 (mm)	Lowered mast height h1 (mm)	Free lift h2 (mm)	Extended mast height h4 (mm)
Duplex ZT	1205	1575	1120	1575
	1405	1775	1320	1775
	1605	1975	1520	1975
	1705	2075	1705	2075
	2515	1802	—	3021
	2715	1902	—	3221
	3015	2052	—	3521
	3315	2202	—	3821
	3615	2352	—	4121

ES12-25DM

mast types	Lift h3+h13 (mm)	Lowered mast height h1 (mm)	Free lift h2 (mm)	Extended mast height h4 (mm)
Duplex ZT	1160	1600	1110	1600
	1360	1800	1310	1800
	1560	2000	1510	2000
	1660	2100	1610	2100
	2470	1833	—	3395
	2670	1933	—	3595
	2970	2083	—	3895
	3270	2233	—	4195
	3570	2383	—	4495