

# FISH BODY IMPLANT

## Series F1500

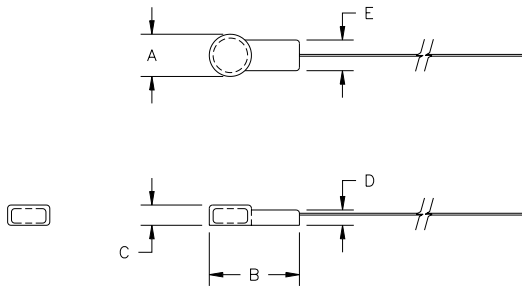

### Technical Specifications

Transmitter type:	Crystal controlled 2-stage
Calibration tolerance:	± 2.5kHz
Frequency stability:	± 2.5kHz, -20°C to 40°C
Pulse rate and width:	Typical on time 20ms, off time 1.1-2.0sec (controlled by astable circuit)
Pulse rate variation:	5%/volt, ± 20% for temperatures -20°C to +40°C
Battery:	Silver Oxide
Activation:	By removing magnet
Encapsulation:	Electrical resin, water-proof, specific gravity: 1.12

MODEL	BATTERY	BATTERY CAPACITY (days)			DIMENSIONS (mm)					WEIGHT (grams)	PRICE GROUP
		30 ppm*	40 ppm	55 ppm	A	B	C	D	E		
F1510	1.5V 379	34	20	14	7	18	3	4	9	1.0	A
F1520	377	58	34	25	8	19	4	4	9	1.3	A
F1530	392	94	55	40	9	20	5	4	9	1.7	A
F1540	394	164	96	70	11	22	5	4	9	2.0	A
F1550	393	158	93	68	9	20	7	4	9	2.2	A
F1560	389	198	116	85	13	24	5	4	9	2.5	A
F1570	386	257 <sup>+</sup>	150	110	13	24	6	4	9	3.1	A
F1580	357HC	441 <sup>+</sup>	258	189	13	24	7	4	9	3.6	A

\* 15 ms pulse width

<sup>+</sup> Factors other than battery capacity may reduce life.

Warranty life is 50% of battery capacity.