

### Technical Specifications

Transmitter type:	Crystal controlled 2-stage (“B” suffix denotes 3-stage)
Calibration tolerance:	±2.5kHz
Frequency stability:	±2.5kHz, -20°C to +40°C
Pulse rate and width:	Typical on time 20ms, off time 1100ms (controlled by uC)
Pulse rate variation:	0.01%/volt, ±0.01% for temperatures -20°C to +40°C
Battery:	Lithium
Activation:	By removing magnet
Encapsulation:	Electrical resin, water-proof, specific gravity: 1.12

MODEL	BATTERY	BATTERY CAPACITY (days)			DIMENSIONS (mm)			WEIGHT (grams)	PRICE GROUP
		35 ppm*	40 ppm	55 ppm	A	B	C		
F1810	3.5V 10-12	110	73	56	12	30	12	7.5	E
F1815	10-18	250	182	140	12	36	12	8.0	E
F1820	10-25	362	264	202	12	43	12	9.5	E
F1830	10-35	500	365	280	12	54	12	11	E
F1835 <sup>+</sup>	1/2AA	897	654	502	17	44	15	14	B
F1835B <sup>+</sup>	1/2AA	366	249	185	17	48	15	16	B
F1840 <sup>+</sup>	2/3AA	1078	787	603	17	52	15	20	B
F1840B <sup>+</sup>	2/3AA	440	300	222	17	56	15	22	B
F1845 <sup>+</sup>	2/3A	1510	1102	845	19	52	15	24	B
F1845B <sup>+</sup>	2/3A	616	420	311	19	56	15	26	B
F1850 <sup>+</sup>	AA	1941	1416	1086	17	70	15	25	B
F1850B <sup>+</sup>	AA	792	540	400	17	72	15	27	B
F1855B <sup>+</sup>	C		4 YR	3 YR	32	74	17	87	C
F1860 <sup>+</sup>	D		12 YR	10 YR	38	85	17	162	C
F1860B <sup>+</sup>	D		10 YR	8 YR	38	85	17	162	C

\*15 ms pulse width

<sup>+</sup>Bottle shape optional

All models available with high accuracy temperature option, order as F18xxT.

Warranty life is 50% of battery capacity, maximum of two years.

470 First Ave. NW • Isanti, MN 55040  
763.444.9267 • fax:763.444.9384 • sales@atstrack.com • www.atstrack.com

# FISH IMPLANT

## Triton Series F1800C Coded

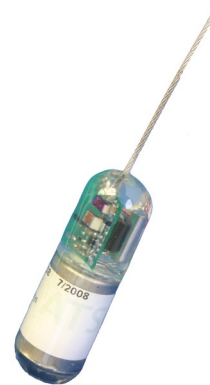
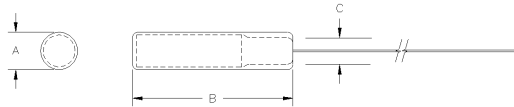

### Technical Specifications

Transmitter type:	Crystal controlled 2-stage
Calibration tolerance:	±2.5kHz
Frequency stability:	±2.5kHz, -20°C to 40°C
Pulse rate and width:	Typical pulse train 20, 5, 5 ms (controlled by uC)
Pulse rate variation:	0.01%/volt, ±0.01% for temperatures -20°C to 40°C
Battery:	Lithium
Activation:	By removing magnet
Encapsulation:	Electrical resin, water-proof, specific gravity: 1.12

MODEL	BATTERY	BATTERY CAPACITY (days)*		DIMENSIONS (mm)			WEIGHT (grams)	PRICE GROUP
		12 ppm	30 ppm	A	B	C		
	3.5V							
F1810C	10-12	180-240	79-102	12	30	12	7.5	E
F1815C	10-18	450-599	199-254	12	36	12	8	E
F1820C	10-25	652-868	288-368	12	43	12	9.5	E
F1830C	10-35	901-1198	397-508	12	54	12	11	E
F1835C <sup>+</sup>	1/2AA	1615-2149	712-910	17	44	15	14	B
F1840C <sup>+</sup>	2/3AA	2143-2851	945-1208	17	52	15	20	B

\*Life is dependent on code choices

<sup>+</sup>Bottle shape optional

Warranty life is 50% of battery capacity, maximum of two years.

470 First Ave. NW • Isanti, MN 55040  
763.444.9267 • fax:763.444.9384 • sales@atstrack.com • www.atstrack.com