

## Carlson Settings and Setup

1. Select new drawing and the following New Drawing Wizard will pop-up

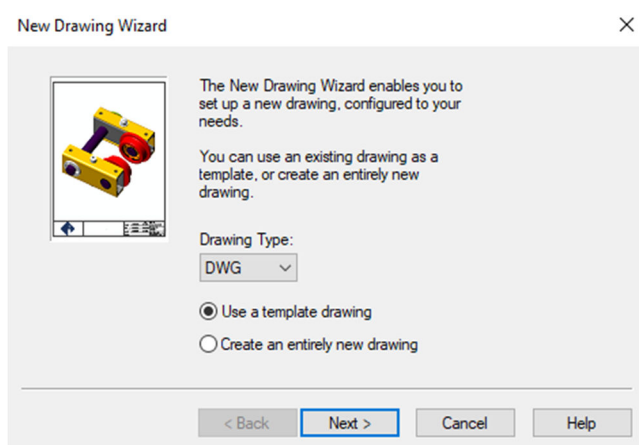

Figure 1 Template Setting

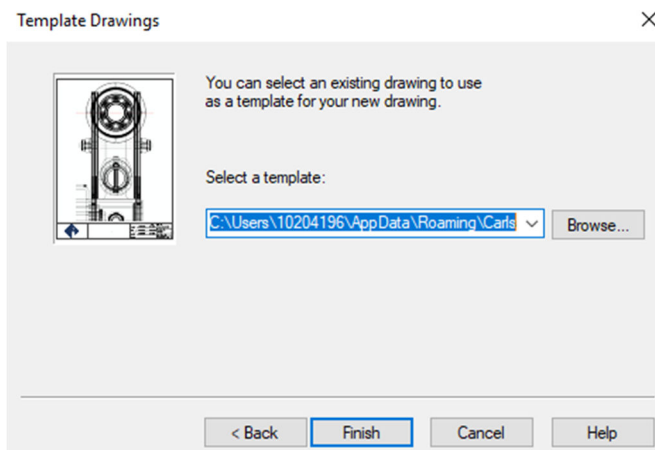

Figure 2 Template Selection

(This can later be turned off in settings)

(recommend using the Carlson default unless you have a specific template)

2. See the CS Overview video to assist with becoming familiar with the Carlson menus and toolbars.
- 3.
4. To find the appropriate software download, enter or cut and past the Carlson serial number in the appropriate field. This serial number is provided by Geosymmetrics (your Carlson Software Dealer) or, by Kevin Bishop, Carlson Software Regional Sales Director or, Carlson Software directly. See figure 1.

5. Select the Download button located under the top item labeled “Carlson 20XX\_64bit.exe” See figure 2. As long as the latest Carlson 20xx will be installed there is no reason to download the patches. (see item description for each download to learn more information)
6. Once this executable file has been downloaded click on this file which is most likely located in the “download” file folder on your C: drive.
7. This will launch the Carlson installation wizard.
8. During the installation process a dialog box will appear, click on “Install” and when prompted to select which CAD engine to use unless you specifically have paid for an AutoCAD™ version of Carlson Software, the installation will default to IntelliCAD 11.xx or 12.xx – use which one has (recommended) in parenthesis. See Figure 3.