



## **ADDENDUM**

# 02 | 190402

---

**21<sup>st</sup> Century Cyber Charter School**

Building Renovations: 1245 Wrights Lane

**M/M Architects Project:** 18-21stC-02

**Date of Meeting:** 02 April, 2019

The original Project Manuals and Drawings dated 18 March, 2019 for the project noted above, are amended as noted in this Addendum No. 02.

Receipt of this Addendum shall be acknowledged by inserting its number and date in the space provided on the Bid Form.

This Addendum consists of 04 Pages and all attachments listed.

### **CLARIFICATIONS:**

- 02.01 Refer to Specification Section 01 12 00 MULTIPLE CONTRACT SUMMARY and highlight:
- “Cutting and Patching: Provided under each contract for its own work.” Each prime contract is responsible for cutting and patching, leaving the surface ready for finish (such as flooring or paint).
- 02.02 Refer to Sheets AD1.1 and A1.1: Door x112 should be shown as existing on the plans.
- 02.03 Refer to notes below regarding Door x181, to be incorporated as part of Alternate 08A.
- 02.04 The existing roof was installed by R. Titter Roofing in Aston, PA. There is no current warranty. Cutting and patching must be performed in accordance with the manufacturer’s standard details.
- 02.05 Refer to Sheets A6.1 and A6.2 and CLARIFY:
- “EXISTING V.I.F.” refers to an existing ceiling to remain, and the height must be verified.
- “MATCH EXISTING” refers to a new ceiling that is to be installed at the original ceiling height.

### **SPECIFICATIONS:**

- 02.06 Refer to Specification Section 01 12 22 MULTIPLE CONTRACT SUMMARY:
- MODIFY 1.6.A, 7a to note: “Curbs shall be provide and installed by each contract for its own work; each prime contract must provide a roofing sub-contractor to perform their own related work.”
- 02.07 ADD Specification Section 08 71 00 DOOR HARDWARE.
- 02.08 Refer to Specification Section 12 32 00 MANUFACTURED PLAM CASEWORK, 2.3 A and ADD:
- “7. Case Systems”

## **DRAWINGS:**

- 02.09 Refer to Sheet C1.0 SITE PLAN and modify the note to read: "ONE (1) FLAGPOLE WITH LIGHT; COORDINATE FINAL LOCATION WITH OWNER AND WITH EXISTING U/G ELECTRICAL."  
Relocate note to between the sidewall and the building.
- 02.10 Refer to Sheet AD1.1 DEMOLITION PLAN, SPECIFIC DEMOLITION NOTES:
- DELETE general note regarding HATCH – does not apply to this project.
- ADD note "09-04A" as "REMOVE CARPET AND BASE UNDER ALTERNATE."
- ADD note "09-14" to read "REMOVE RAMP, STAIR, AND/OR RAILS ASSOCIATED WITH THE RAISED FLOOR SYSTEM."
- 02.11 Refer to Sheet AD1.1 DEMOLITION PLAN:
- ADD note "09-04" to all perimeter (walled) rooms (i.e. along the exterior window wall). This applies to rooms with existing carpet and not to rooms such as "BREAK ROOM" and "EXERCISE".
- ADD note "09-04" to interior rooms 207.1, 207.2, and 208. These shall be base bid.
- ADD note "09-04A" to interior rooms for the removal and replacement of carpet under the alternate. This includes rooms numbered on the plan as follows: 101, 102, 103, 111, 125, 126, 127, 128, 129, 130, 131, 137, 140, 153, 154, 155, 156, 158, 159, 159.1, and 159.2.
- MODIFY "09-17" to read "09-14" in the "Data Center / Server"
- ADD note "09-02" to the following rooms:
- "Data Center / Server"
  - "Master Control Center" and "Prod. Suite". Ceiling removal to include drop ceiling/bulkhead.
  - The "OFFICE" that will become the two (2) Lactation Rooms.
  - The "COPY / MAIL ROOM"
  - The hallway that will become number Corridor 180.
  - The "STORAGE" and "OFFICE" that will become Restrooms 194 and 195.
  - The rooms and areas that will be Board Room 202 and Changing Rooms 203 and 204.
- ADD "09-14" designation at the "UP" symbol at the existing step in the "Master Control Center".
- ADD "09-14" designation east of the coat closets in the "Master Control Center".
- 02.12 Refer to Sheet AD1.2 DEMOLITION PLAN:
- ADD note "09-04" to all perimeter (walled) rooms (i.e. along the exterior window wall). This applies to rooms with existing carpet and not to rooms such as "BREAK ROOM" and "EXERCISE". This also applies for the area required to enlarge room 202 and construct rooms 203 and 204.
- ADD note "09-04" to interior rooms 162, 163, 164, and 165. These shall be base bid.
- ADD note "09-04" to interior rooms in the east extension of the building. These shall be base bid. This includes the following rooms on the floor plan: 180, 183, 184, 191, 193, 194, 195, 197, & 198.
- ADD note "09-04A" to interior rooms for the removal and replacement of carpet under the alternate. This includes rooms numbered on the plan as follows: 150, 160, 161, 170, 171, 200, and 209.
- MODIFY all notes "08-10" to read "08-01".

ADD 08-10 note to demolish existing door and frame to the "ELEC. ROOM" – under Alternate 08A.

ADD note "09-08" to "BREAK ROOM".

02.13 Refer to Sheet A1.0, GENERAL PARTITION NOTES, and ADD the following to note 5: "Walls do not need to extend higher than 16'-0" AFF; total height of walls will vary due to existing roof slope."

02.14 Refer to Sheet A1.1 FLOOR PLAN:

ADD Door labels at VESTIBULE 100.1, curtainwall CW1. Tags to be 100.1A and 100.1B.

ADD a note to relocate existing fire extinguisher / cabinet in CORRIDOR 111.

ADD P4 partition type wall infill to the two (2) removed door/frame locations in KITCHEN 124.

MODIFY Door 124 / CW2 per ASK-01.

02.15 Refer to Sheet A1.2 FLOOR PLAN:

ADD new rated door and frame "181" to ELEC room 181 – only under Alternate 08A.

ADD Room Tag to OFFICE 189.

02.16 Refer to Sheet A6.1: ADD new ceiling to WAREHOUSE 136. Note to read "MATCH EXISTING".

02.17 Refer to Sheet A6.1 and CLARIFY: The ceilings in the following rooms are "EXISTING V.I.F.": 111, 124, 127, 128, 130, 131, 133, 134, 137, and 140.

02.18 Refer to Sheet A6.2 and CLARIFY: The ceilings in the following rooms are "EXISTING V.I.F.": 170, 184, 193, 200, and 209.

02.19 Refer to Sheet A9.1 DOOR SCHEDULE – MODIFY "x181" to read "181" – only for Alternate 08A.

The door/frame will remain existing in the base bid, but must be replaced for the new hardware as part of Alternate 08A.

181	3'-0"	7'-2"	F	HM	45 MIN	HM1	HM	1	2
-----	-------	-------	---	----	--------	-----	----	---	---

02.20 Refer to Sheet A9.1 DOOR SCHEDULE

MODIFY Door Number 199 to be 100.1A and Door Number 200 to be 100.1B.

MODIFY "COMMENTS" column for Door Numbers X100.1 and X100.2 to read: "REPLACE HARDWARE AND DOOR; FRAME TO REMAIN."

MODIFY "DOOR TYPE" and "DOOR MATERIAL" to "GL" for the following door numbers: 118, 119, 120, 121, 122, 123, 124, 146, 147, 148, and 149. MODIFY "HEAD" detail to 10 for the same.

ADD the following to Door 124 COMMENTS: "PART OF THE GLASS PARTITION SYSTEM"

02.21 Refer to Sheet A10.0, ROOM FINISH SCHEDULE

ADD the following under Room Number 100:

- "REFINISH" EXIST WD. under FLOOR FINISH.

- "PATCH EXISTING WOOD, AS REQUIRED, AT REMOVED VESTIBULE" under COMMENTS.

MODIFY Ceiling comment under 136 from "EXIST" to ACT.

02.22 Refer to Sheet A10.1, FINISH FLOOR PLAN:

ADD Room Tag to VESTIBULE 100.1, OPEN OFFICE 137, and CORRIDOR 140.

MODIFY note in new front VESTIBULE to read "CPT-2"

MODIFY the note in VESTIBULE 113 and in VESTIBULE 135 to read "CPT-2" (not EXIST).

MODIFY room finish schedule on A10.0 in kind.

ADD "Provide carpet and base under Alternate" in the "COMMENTS" column under the following:  
101, 102, 103, 111, 125, 126, 127, 128, 129, 131, 137, 140, 153, 154, 155, 156, 159.1, and 159.2;  
150, 160, 161, 170, 200, and 209.

02.23 Refer to Sheet A10.2, FINISH FLOOR PLAN:

ADD note in OPEN OFFICE 209 to "Patch carpet where existing vestibule was removed. Replace full carpet tiles, when required.

## **END OF ADDENDUM 02**

Respectfully Submitted,

Christopher Peters, AIA  
Marotta/Main Architects, Inc.

### **Attachments:**

- Specification Section 08 71 00 DOOR HARDWARE
- ASK-01

**SECTION 08 71 00 - DOOR HARDWARE**

PART 1 GENERAL

1.1 SUMMARY

- A. Section Includes:
  - 1. Hardware for swinging Aluminum, Hollow Metal and Wood Door Openings.
  - 2. Field modification and preparation of existing doors and frames for new hardware being installed. Provide fillers, Dutchmen, reinforcements, and fasteners for mounting new hardware and to cover existing door/frame preparations.
  
- B. Related Sections:
  - 1. Section 01 25 13 – Product Substitution Procedures
  - 2. Section 06 20 00 – Finish Carpentry
  - 3. Section 08 11 13 – Hollow Metal Doors and Frames
  - 4. Section 08 14 16 – Flush Wood Doors
  - 5. Section 08 41 13 – Aluminum – Framed Entrances and Storefronts
  - 6. Section 26 05 19 – Low Voltage Electrical Power Conductors and Cables

1.2 REFERENCES

- A. Use the following references to properly detail, schedule, furnish and install finish hardware items.
  - 1. NFPA 80 – Standard for Fire Doors and Other Opening Protectives (2007)
  - 2. DHI Installation Guide for Doors and Hardware (1984)
  - 3. DHI Sequence and Format for the Hardware Schedule (1996)
  - 4. ANSI/BHMA A156.4 – Door Controls – Closers (2013)
  - 5. ANSI/BHMA A156.2 – Bored and preassembled Locks and Latches (2011)
  - 6. ANSI/BHMA A156.13 – Mortise Locks and Latches Series 1000 (2012)
  - 7. ANSI/BHMA A156.18 – Materials and Finishes (2012)

1.3 SUBMITTALS

- A. Schedule:
  - 1. Provide submittals in accordance with 01 33 00 – Submittal Procedures.
  - 2. Provide hardware schedule in vertical format on 8-1/2-inch by 11-inch paper or electronic format. Conform to DHI publication Sequence and Format for Hardware Schedule using Architect's door numbers and hardware set numbers.
  - 3. Provide elevation drawings for openings with electrical hardware and access control devices with each hardware schedule. Include illustration of opening, operational description, electrified hardware components, legend, approximate mounting location and size of enclosures, size and quantity of conductors, facility name and date.
  
- B. Product Data: Provide one set of manufacturer's catalog and technical data for each hardware item used, highlighting design, function, fasteners, accessories, and options to facilitate review with each hardware schedule submitted.
  
- C. Templates: Provide two sets of manufacturer's templating information for mortised and template hardware upon receipt of approved hardware schedule to the door and frame supplier(s). Include requirements for internal reinforcements required for surface mounted hardware.
  
- D. Wiring Diagrams:
  - 1. Three sets point-to-point diagrams specially developed for each opening that requires electrical hardware, with hardware delivery to jobsite. Reference elevation drawings submitted with hardware schedule using Architect's opening numbers.
  
  - 2. Three sets riser diagrams for openings requiring power supplies or access control. Include placement of power supplies, distance of wire runs from power supply, cable quantity and number and gauges of wires.
  
- E. Keying Schedule: Arrange meeting with Owner, Architect and finish hardware supplier to determine keying requirements immediately upon receipt of finish hardware schedule.

1.4 CLOSEOUT SUBMITTALS

- A. Furnish operations and maintenance manual in accordance with Section 01 78 28 – Operations and Maintenance Data and as follows:
  - 1. Furnish one copy of manual at date of Substantial Completion in a 2-1/2-inch thick binder labeled with project information, date and name and contact information for the hardware supplier.
  - 2. Include in manual:
    - a. Copy of approved hardware schedule, including door numbers and locations. Highlight fire rated door to aid in annual fire door inspection.
    - b. Copy of approved keying schedule.
    - c. Catalog data for each product.
    - d. As-installed “wiring diagrams” for each opening connected to power.
    - e. Parts list for locksets, exit devices, and door closers.
    - f. Installation templates and instructions.
    - g. Warranty information.
    - h. Name, address, and phone number of local representatives for each manufacturer.

1.5 MAINTENANCE MATERIAL SUBMITTALS

- A. Extra Materials:
  - 1. Screws and Fasteners: Fifty of each screw and fastener required for general maintenance of hinges, locks, closers, exit devices, and sealing systems.
  - 2. Deliver to Owner remaining finish hardware fasteners and special installation tools upon completion of Project.

1.6 QUALITY ASSURANCE

- A. Supplier:
  - 1. Furnish hardware from recognized supplier who has warehousing facility within 100 miles of project location, and who has actively supplied hardware for similar projects in the vicinity for a minimum of five years.
  - 2. Supplier shall employ an Architectural Hardware Consultant (AHC), as certified by Door and Hardware Institute, on staff full time to administer and supervise project.
- B. Installer: Install hardware using installers who have actively installed commercial door hardware for a minimum of five years, and are familiar with hardware installation of type required on this Project.
- C. Pre-Installation Meeting:
  - 1. Prior to installation of hardware, arrange for manufacturer’s representatives of locksets, door closers, and exit devices to hold a jobsite meeting to instruct the installing personnel on the proper installation of their products.
  - 2. Send a letter of compliance, indicating when this meeting was held, and who was in attendance, to the Architect and Owner.
- D. Fire Rated Door Openings:
  - 1. Comply with NFPA 80.
  - 2. Furnish nationally recognized testing agency label or stamp on hardware for labeled openings.
  - 3. Only labeled locks or latches or fire exit hardware can be used on fire rated openings.
  - 4. Where UL requirements conflict with Drawings or Specifications, furnish hardware conforming to the UL requirements.

1.7 DELIVERY, STORAGE, AND HANDLING

- A. Delivery:
  - 1. Jointly check in hardware, upon delivery to jobsite, against approved hardware schedule with hardware supplier. Record shortage or damage and replace or repair as necessary.

2. Deliver hardware to be installed during fabrication of doors and frames, to manufacturer.
- B. Storage:
  1. Store hardware in a secure, dry, temperature controlled room on shelving to protect against loss, theft and damage.
  2. Store items too long for shelving on pallet, off the floor.
- C. Marking and Packaging:
  1. Deliver hardware to jobsite in manufacturer's original packaging marked to correspond with approved hardware schedule with Architect's door numbers and hardware sets.
  2. Mark all locksets, exit devices, cylinders, auxiliary hardware and key switches with keyset symbol.
  3. Replace any wet or damaged packaging with new.

## 1.8 WARRANTY

- A. Furnish warranties in accordance with Section 01 78 36 – Warranties. Extended or limited warranties shall be as follows:
  1. Furnish minimum ten year factory warranty on door closers, against defects in material and workmanship, from date of substantial completion.

## PART 2 PRODUCTS

### 2.1 MANUFACTURERS

- A. The following manufacturers' were used in the hardware sets.

1. Butt Hinges	Stanley	ST
2. Continuous Hinges	Stanley	ST
3. Locks and Latchsets	Dorma	DM
4. Narrow Stile Deadlocks	AdamsRite	AR
5. Cylinders and Cores	Dorma	DM
6. Surface Closers	As Specified in Sets	
7. Exit Devices	As Specified in Sets	
8. Overhead Stop/holders	ABH/Dorma	AB/DM
9. Door Pulls	Trimco	TR
10. Flushbolts	Trimco	TR
11. Protection Plates	Trimco	TR
12. Wall/Floor Stops	Trimco	TR
13. Thresholds and Gasketing	National Guard	NA
14. Silencers	Trimco	TR
- B. Submit requests for substitution in accordance with Section 01 25 13 Product Substitution requirements and as follows:
  1. Provide catalog data with product information highlighted or bubbled to facilitate review. Product must meet or exceed level or design intended and/or function established by specified products.

### 2.2 MATERIALS

- A. Screws and Fasteners:
  1. Provide manufacturer's recommended fasteners of proper type, material and finish.
  2. Provide self-tapping screws for sweeps and stop applied weatherstripping.
  3. Utilize through-bolts for the attachment of door closers and exit devices on non-reinforced doors only. Finish: match door face.
  4. Exposed screw heads: phillips type.
- C. Hinges:
  1. Type:
    - a. Five-knuckle, full mortise, ball bearing.
    - b. Furnish heavy weight hinges on heavy doors and doors expected to have high frequency use.
  2. Quantity:

- a. One pair of hinges for all doors up to 5 feet high. Furnish one additional hinge for every 2'-6" in height or fraction thereof.
  - b. Four hinges at dutch doors up to 7'-6" in height.
3. Size:
- a. For 1-3/4-inch thick doors up to 3 feet wide: 4 ½-inches high
  - b. For 1-3/4-inch thick doors over 3 feet wide: 5-inches high
  - c. For all doors over 1-3/4-inches thick: 5-inches high
  - d. Size in width shall minimally clear door trim.
4. Application:
- a. NRP (non-removable pin) at exterior doors and reverse bevel doors with locking hardware.
  - b. Electric hinges: have sufficient number of concealed wires to accommodate electrical function of hardware. Furnish junction box and mortar shield.

5. Acceptable manufacturers and types:

Type	Stanley	McKinney
Standard Weight	FBB179	TA2714

D. Continuous Hinges:

- 1. Configuration appropriate for type, inset, and thickness of door. Coordinate with door manufacturer.
- 2. Meet UL fire label listing requirements at UL rated openings. Include fire pins as required by manufacturer.
- 3. Acceptable manufacturers and types:

Door Type	Stanley	ABH	Select
Aluminum	661HD	A110HD	SL11HD
Hollow Metal	662HD	A240HD	SL24HD

E. Door Bolts:

- 1. Flushbolts:
  - a. Manual Flushbolts: Two for inactive leaf of locked pairs of doors at non-occupied rooms.
  - b. Self-Latching Flushbolts: One pair for inactive leaf at pairs of doors where inactive leaf is not required for egress.
  - c. Automatic Flushbolts: One pair at fire rated doors, and occupied rooms required for egress.
  - d. Acceptable manufacturers and types:

Bolt/Door Type	Trimco	Burns	ABH
Manual Metal	3917	590	1855
Manual Wood	3913	591	1857
Automatic Metal	3810	7842	1860
Automatic Wood	3815	7942	1862
Self-Latching Metal	3820 x 3810	7845	1863
Self-Latching Wood	3825 x 3815	7945	1864

F. Locksets:

- 1. Cylindrical Locks:
  - a. Conform to ANSI/BHMA A156.2, Series 4000 Operational Grade 1.
  - b. Latchbolt with appropriate throw for fire rated doors and pairs of doors in accordance with manufacturers listing.
  - c. Lock functions as specified in hardware schedule.
  - d. Lever design: 15D
  - e. Backset: 2-3/4-inch
  - f. Strike single door: ANSI 4-7/8-inch with proper lip length to minimally clear trim.
  - g. Strike pair of doors: flat lip strike sized to fit flush with face of door.
  - h. Furnish wrought strike box.
  - i. Acceptable manufacturers and types:

Dorma (No Substitute)
C800 Series

2. Cylinders:

- a. Provide mortise and rim cylinders and cores from same manufacturer as locksets, for all locksets, exit devices, cylinder dogging, key switches and auxiliary hardware.
- b. Appropriate cam, tailpieces and blocking rings for proper installation



G. Keys & Keying

1. Cylinders: 7-pin, interchangeable core Dorma BB Keyway.
2. Provide final cores ZERO Bitted in Dorma BB Keyway.
3. Provide BLACK construction cores and keys during construction period. Construction control and operating keys and cores are not part of permanent keying system or furnished on same keyway (or key section) as permanent keying system.
4. Permanent Keys and Cores: Final keying of permanent cores and cutting of keys will be provided by Owner's Locksmith in accordance with keying schedule.
5. It is the responsibility of the hardware supplier to coordinate delivery of final cores and key blanks to the General Contractor.
  - a. It is the responsibility of the General Contractor to coordinate delivery of the final cores and key blanks to the OWNER'S Locksmith per the OWNER'S requirements.
6. Furnish keys in the following quantities:
  - a. 300 Key Blanks.
7. OWNER'S Locksmith will install permanent cores in locksets.
8. The General Contractor will return construction cores to Hardware Supplier.

H. Exit Devices:

1. UL-listed for fire at fire door assemblies, and UL listed for panic at non-rated door assemblies.
2. Size exit devices to proper door width and height.
3. Stainless Steel deadlocking ¾ -inch throw latch bolt.
4. LBR (less bottom rod) where scheduled to eliminate use of floor mounted strikes.
5. Cylinders for exit devices with cylinder dogging or locking trim.
6. Electrical functions as scheduled in sets. Provide power supply and power transfer from same manufacturer as electrified exit device.
7. Strike: as recommended by manufacturer.
8. Lever design: To match lockset trim.
9. Acceptable manufacturers and types:

Precision - Where Specified	Adams Rite – Where Specified
Apex 2000 Series	8800 Series

I. Surface Door Closers:

1. Conform to ANSI/BHMA A156.4 Grade 1.
2. Heavy duty high silicon aluminum alloy or cast iron body closers.
3. Furnish manufacturers recommended size, arms and configuration for door and frame application required.
4. Furnish brackets, spacers, support shoes, and plates for complete and proper installation.
5. DA (delayed-action) at toilet room doors and as scheduled.
6. Acceptable manufacturers and types:

Dorma	Yale – Where Specified	LCN – Where Specified
8600 Series	3301 Series	1460 Series

J. Overhead Door Stop:

1. Provide overhead stop or overhead stop/holder for interior doors as specified. Provide overhead stop for interior doors and at any door that swings more than 140 degrees before striking a wall, open against equipment, casework, sidelights, and/or where conditions do not allow a wall stop or a floor stop presents a tripping hazard.
2. Where overhead holders are specified provide friction type at doors without a closer and positive type at doors with a closer.
3. Acceptable manufacturers:

ABH	Dorma
1020 SL Series	700 Series

K. Door Trim:

1. Provide push plates 6 inches wide x 16 inches high x 0.050 inch thick and beveled 4 edges. Where width of door stile prevents use of 6 inches wide plate, adjust width to fit.
  - i. Cut for cylinder and cut for thumb turn when Push / Pulls are used in conjunction with deadlocks.
2. Provide pull plates 4 inches wide x 16 inches high x 0.050 inch thick, beveled 4 edges, and prepped for pull. Where width of door stile prevents use of 4 inches wide plate, adjust width to fit.
3. Acceptable manufacturers:

Trimco	Burns	Rockwood
--------	-------	----------

L. Protection Plates:

1. Where bottom rail allows, furnish 10-inch high kick plates and 10-inch high mop plates.
2. Material: 0.050-inch thick stainless steel plates with four beveled edges.
3. Countersink screw heads at wood doors.
4. Width: 1 ½ inch less door width on stop (push) side and 1-inch less door width on face (pull) side.
5. Acceptable manufacturer and types:

Trimco	Burns	Rockwood
K0050	KP	K1050

M. Door Stops:

1. Convex, cast, wall stops.
2. Furnish fastener suitable for wall condition.
3. Provide wedge type stop for doors with push/pulls.
4. Where wall stops are inappropriate provide universal dome type floor stops.
5. Acceptable manufacturers and types:

Type	Trimco	Burns	Rockwood
Wall Stop	1270CX	560	400
Wedge Stop	1298	526	487
Floor Stop	1211	521	441H

N. Thresholds and Gasketing:

1. Thresholds:

- a. Returned closed ends at openings where threshold extends beyond frame face.
- b. Bumper threshold with silicone insert where scheduled.
- c. Acceptable manufacturers and types:

Type	National Guard	Pemko
Saddle	513	271
Saddle	425	171
Bumper	896	2005

2. Gasketing:

- a. Rigid jamb weatherstip with replaceable neoprene insert.
- b. Include self-adhesive two-sided tape in addition to manufacturer’s standard fastener.
- c. Meeting-stile gasketing required at exterior pairs of doors and doors in smoke partitions.
- d. TPE adhesive fire/smoke gasketing at fire and smoke “S” labeled openings
- e. Door sweep with neoprene insert for exterior out-swing doors.
- f. Acceptable manufacturers and types:

Type	National Guard	Pemko
Rigid	137 NA	296CR
Smoke	5075	S773
Meeting Stile	115 NA	305CN
Door Sweep	200 NA	315CN

O. Silencers:

1. Grey rubber silencers with injector tool.
2. Three silencers at single doors and two silencers at pairs.
3. Acceptable manufacturers and types:

Trimco	Rockwood	Burns
1229A	608	500

2.3 KEY CONTROL

- A. Key cabinet: wall mounted with one hook for each lock or cylinder plus fifty extra hooks.
  1. One non-removable security tag and one snap-on link duplicate tag per hook.
  2. Furnish tools, instructions sheets and accessories required to complete installation.
  3. Owner/Owner’s representative will place keys in cabinet and complete index card furnished with key system.
  4. Acceptable manufacturers:

Lund	Telkee	MMF
------	--------	-----

2.4 FINISHES

- A. Conform to ANSI/BHMA A156.18.
  - 1. Butt Hinges 630 Stainless Steel
  - 2. Locks and Latches 626 Satin Chrome
  - 3. Exit Devices 630 Satin Stainless Steel
  - 4. Door Closers 689 Spray Painted Aluminum
  - 5. Pull Plates 630 Satin Stainless Steel
  - 6. Protection Plates 630 Satin Stainless Steel
  - 7. Stops and Holders 630 Satin Stainless Steel
  - 8. Thresholds/Gasket AL Anodized Mil Finished Aluminum

PART 3 EXECUTION

3.1 EXAMINATION

- A. Verify doors and frames are plumb, square, level and true and free from defects that would prevent proper installation of finish hardware.
- B. Verify power is run to doors requiring electrified hardware.
- C. Wash down masonry walls and complete painting and staining of doors and frames prior to installation of hardware.
- D. Complete finish flooring at doorways.
- E. Correct conditions that inhibit a proper installation before continuing with work.

3.2 INSTALLATION

- A. Install hardware in compliance with the DHI publication, Installation Guide for Doors and Hardware.
- B. Drill and countersink items not factory prepared for fasteners.
- C. Mount closers on room-side of corridor doors, inside of exterior doors, and stair-side of stairway doors. Use necessary arms, brackets, spacers and plates to accommodate auxiliary hardware and special applications.
- D. Install fire door assemblies to maintain clearances at door edge to frame and meeting edge of pairs of doors in compliance with NFPA 80, providing 1/8-inch clearance at the hinge edge, lock edge, head and between pairs. Provide maximum 3/4-inch undercut at door bottom. Where panic thresholds are used, undercut door to allow 1/8-inch clearance between door and threshold.
- E. Trim, cut, and notch thresholds and saddles neatly to minimally fit the profile of the door frame. Set thresholds in bed of mastic sealant, forming tight seal between threshold and surface to which set.
- F. Use only fasteners furnished by manufacturer for installation as recommended by manufacturer.
- G. Install blocking material for all wall mounted door stops at height appropriate to contact door trim.
- H. Install weather-strip prior to installation of door closers and exit devices. Do not cut or notch weather-strip.
- I. Locate electric hinges at second hinge from bottom of frame.
- J. Termination of wiring: Ensure wiring is in place and is connected for proper operation of hardware.

3.3 FIELD QUALITY CONTROL

- A. Verify doors open and close smoothly without rubbing or catching and have positive latching where scheduled. Verify fire rated doors are installed with clearances in compliance with NFPA 80.
- B. Test electrified hold open devices tied into fire alarm system to confirm release upon activation of fire alarm. Test electrified hardware and access control to verify systems operate as directed in mode of operation. Where hardware is found to be inoperable, repair or replace with new.

3.4 ADJUSTING AND CLEANING

- A. Upon substantial completion, make final adjustments to door closers and other items of hardware after balance of heating and ventilating equipment to ensure doors close and latch properly.
- B. Clean and polish all exposed hardware surfaces in accordance with manufacturer's recommended procedures.
- C. Clean or repair pencil or tool marks from adjacent surfaces damaged or soiled by work of this Section.
- D. Recycle cardboard boxes and paper products used in packaging and transport of finish hardware.

3.5 PROTECTION

- A. Remove hardware prior to painting or finishing door and frame. Wrap or mask exposed hardware that cannot be removed until date of substantial completion to avoid exposure to paint, solvents, and abuse.
- B. Repair or replace hardware damaged during construction at least two weeks prior to date of substantial completion.

3.6 SCHEDULES

- A. Should items of hardware not definitely specified be required for completion of the Work, furnish such items of type and quality comparable to adjacent hardware and appropriate for service required.
- B. Where items of hardware aren't definitely or correctly specified, are required for completion of the Work, a written statement of such omission, error, or other discrepancy to Architect, prior to date specified for receipt of bids for clarification by addendum; or, furnish such items in the type and quality established by this specification, and appropriate to the service intended.

Manufacturer List

<u>Code</u>	<u>Name</u>
AB	ABH Manufacturing Inc.
AD	Adams Rite
BY	By Others
DM	Dorma Door Controls
FL	Falcon Lock
LC	LCN Closers
NA	National Guard
PR	Precision
RO	Rockwood
ST	Stanley
TR	Trimco
YA	Yale

Finish List

**18-21<sup>st</sup>C-02 - 21<sup>st</sup> Century Cyber Charter School – Wrights Lane**

<u>Code</u>	<u>Description</u>
AL	Aluminum
AL	Aluminum (BHMA 689)
499	Polished Brass, No Lacquer (US3NL)
626	Satin Chromium Plated
628	Satin Aluminum, Clear Anodized
630	Satin Stainless Steel
689	Aluminum Painted
GREY	Grey
US26D	Chromium Plated, Dull
US32D	Stainless Steel, Dull

**Hardware Sets**

**SET #001 - Existing Offices - New Hardware**

Doors: X104, X105, X106, X107, X108, X109, X110, X117, X125, X126, X129, X138, X139, X141, X142, X143, X144, X145, X158, X159, X182, X185, X186, X189, X190, X192

3 Hinges	FBB179 4 1/2 X 4 1/2	US26D	ST
1 Entry Lockset	C853C LCC BB-KWY BLK	626	DM
1 Wall Bumper	1270CV	626	TR
1 Coat Hook	796	US26D	RO
3 Door Silencers	1229A	GREY	TR

NOTE: Prep / Modify / Repair existing door, frame AND wall to accept specified hardware.

**SET #002 - Existing Caf / Conf - New Hardware**

Doors: X183, X201, X201.1, X207.1, X207.2

3 Hinges	FBB179 4 1/2 X 4 1/2	US26D	ST
1 Passage Set	C810 LCC	626	DM
1 Wall Bumper	1270CX	626	TR
3 Door Silencers	1229A	GREY	TR

NOTE: Prep / Modify / Repair existing door, frame AND wall to accept specified hardware.

**SET #003 - Existing Storage/File/Elec - New Hdwe**

Doors: X103, X173, X176, X181.1, X196, X206

3 Hinges	FBB179 4 1/2 X 4 1/2	US26D	ST
1 Storeroom Lockset	C880C LCC BB-KWY BLK	626	DM
1 Wall Bumper	1270CX	626	TR
3 Door Silencers	1229A	GREY	TR

NOTE: Prep / Modify / Repair existing door, frame AND wall to accept specified hardware.

**SET #004 - Existing Misc Spaces - Card Access**

**18-21<sup>st</sup>C-02 - 21<sup>st</sup> Century Cyber Charter School – Wrights Lane**

Doors: X116, X161, X171, X202, X202.1, X205

3 Hinges	FBB179 4 1/2 X 4 1/2	US26D	ST
1 Storeroom Lockset	C880C LCC BB-KWY BLK	626	DM
1 Electric Strike	ELECTRIC STRIKE BY OWNER'S LOCKSMITH	630	BY
1 Closer	8616 AR SNB1	689	DM
	NOTE: REG ARM MOUNT		
1 Wall Bumper	1270CX	626	TR
1 Card Reader	CARD READER BY OWNER'S SECURITY VENDOR		BY
1 Power Supply	POWER SUPPLY BY OWNER'S SECURITY VENDOR		BY
1 Door Position Switch	DPS BY OWNER'S SECURITY VENDOR		BY
3 Door Silencers	1229A	GREY	TR

NOTE: Prep / Modify / Repair existing door, frame AND wall to accept specified hardware.  
 Operation: Door normally closed and locked. Presentation of valid credential releases electric strike allowing entry. Mechanical key by-pass. Egress always allowed.  
 Coordinate wiring and installation with GC / EC / Owner's Security Vendor / Owner's Locksmith.

**SET #005 - Existing Janitor - New Hardware**

Doors: X124.2

3 Hinges	FBB179 4 1/2 X 4 1/2 NRP	US26D	ST
1 Classroom Lockset	C870C LCC BB-KWY BLK	626	DM
1 Overhead Stop	700 Series	626	DM
1 Kick Plate	K0050 10" x 1-1/2" LDW B4E CSK	630	TR
3 Door Silencers	1229A	GREY	TR

NOTE: Prep / Modify / Repair existing door, frame AND wall to accept specified hardware.

**SET #006 - Existing Restrooms - New Hardware**

Doors: X133, X134, X174, X175

3 Hinges	FBB179 4 1/2 X 4 1/2	US26D	ST
1 Pull Plate	1018-3	630	TR
1 Closer	8616 AR BP86C SNB1	689	DM
	NOTE: REG ARM MOUNT		
1 Mop Plate	KM050 6" x 1" LDW B4E CSK	630	TR
1 Kick Plate	K0050 10" x 1-1/2" LDW B4E CSK	630	TR
1 Push Plate	1001-9	630	TR
1 Wall Bumper	1270CX	626	TR
3 Door Silencers	1229A	GREY	TR

NOTE: Prep / Modify / Repair existing door, frame AND wall to accept specified hardware.

**SET #007 - Existing Closet - New Hardware**

Doors: X197

6 Hinges	FBB179 4 1/2 X 4 1/2	US26D	ST
----------	----------------------	-------	----

**18-21<sup>st</sup>C-02 - 21<sup>st</sup> Century Cyber Charter School – Wrights Lane**

2 Door Pull	1193-1	630	TR
2 Wall Bumper	1270CX	626	TR
2 Roller Latch	1559W B-STRIKE	626	TR

NOTE: Prep / Modify / Repair existing door, frame AND wall to accept specified hardware. If existing roller latch is in working order, only replace strikes in frame head.

**SET #008 - Existing Bi-Folds - New Pulls**

Doors: X159.1, X159.2

2 Drawer Pull	562-4	630	TR
---------------	-------	-----	----

NOTE: Prep / Modify / Repair existing door, frame AND wall to accept specified hardware. Re-use bifold track hardware.

**SET #009 - Existing Studios - New Hardware**

Doors: X153, X154, X155, X156

3 Hinges	FBB179 4 1/2 X 4 1/2	US26D	ST
1 Privacy Set	C840 LCC	626	DM
1 Wall Bumper	1270CV	626	TR
1 Coat Hook	796	US26D	RO
3 Door Silencers	1229A	GREY	TR

NOTE: Prep / Modify / Repair existing door, frame AND wall to accept specified hardware.

**SET #010 - Existing Restroom - New Hardware**

Doors: X187

3 Hinges	FBB179 4 1/2 X 4 1/2	US26D	ST
1 Privacy Set	C840 LCC	626	DM
1 Mop Plate	KM050 6" x 1" LDW B4E CSK	630	TR
1 Floor Stop	1211	626	TR
1 Coat Hook	796	US26D	RO
3 Door Silencers	1229A	GREY	TR

NOTE: Prep / Modify / Repair existing door, frame AND wall to accept specified hardware.

**SET #011 - Existing Conf Room - New Push Pull**

Doors: X188

2 Push/Pull Set	1732 N-GL (VIF EXISTING PUSH BAR CENTERLINES / MTG HOLES) ALL OTHER EXISTING HARDWARE TO REMAIN	499	TR BY
-----------------	--	-----	----------

NOTE: Prep / Modify / Repair existing door, frame AND wall to accept specified hardware. See interior glass specification for alternate related to door rails & related hardware and header / sill replacement options.

**SET #012 - Existing Elect Closet - New Hardware**

**18-21<sup>st</sup>C-02 - 21<sup>st</sup> Century Cyber Charter School – Wrights Lane**

Doors: X132

6 Hinges	FBB179 4 1/2 X 4 1/2 NRP	US26D	ST
2 Flush Bolt	3917-12	626	TR
1 Storeroom Lockset	C880C LCC 5001-078 BB-KWY BLK	626	DM
2 Overhead Stop	700 Series	626	DM
	NOTE: @ Active Leaf		
2 Wall Bumper	1270CX	626	TR
1 Dustproof Strike	3910	630	TR
2 Door Silencers	1229A	GREY	TR

NOTE: Prep / Modify / Repair existing door, frame AND wall to accept specified hardware.

SET #013 - Existing Restroom - New Hardware

Doors: X114

3 Hinges	FBB179 4 1/2 X 4 1/2	US26D	ST
1 Privacy Set	C840 LCC	626	DM
1 Closer	8616 DS BP86C SNB1	689	DM
1 Kick Plate	K0050 10" x 1-1/2" LDW B4E CSK	630	TR
1 Wall Bumper	1270CV	626	TR
1 Coat Hook	796	US26D	RO
3 Door Silencers	1229A	GREY	TR

NOTE: Prep / Modify / Repair existing door, frame AND wall to accept specified hardware.

SET #014 - Existing Vestibule - New Hardware

Doors: X113

3 Hinges	FBB179 4 1/2 X 4 1/2	US26D	ST
1 Pull Plate	1018-3	630	TR
1 Closer	3301 SN-134	689	YA
1 Kick Plate	K0050 10" x 1-1/2" LDW B4E CSK	630	TR
1 Push Plate	1001-3	630	TR
1 Wall Bumper	1270CX	626	TR
3 Door Silencers	1229A	GREY	TR

NOTE: Prep / Modify / Repair existing door, frame AND wall to accept specified hardware.

SET #015 - Existing Corridor - Card Access

Doors: X130, X200

3 Hinges	FBB179 4 1/2 X 4 1/2 NRP	US26D	ST
1 Storeroom Lockset	C880C LCC BB-KWY BLK	626	DM
1 Electric Strike	ELECTRIC STRIKE BY OWNER'S LOCKSMITH	630	BY
1 Closer	1461 REG/PA TBWMS	AL	LC
1 Kick Plate	K0050 10" x 1-1/2" LDW B4E CSK	630	TR
1 Wall Bumper	1270CX	626	TR
1 Card Reader	CARD READER BY OWNER'S SECURITY		BY



**18-21<sup>st</sup>C-02 - 21<sup>st</sup> Century Cyber Charter School – Wrights Lane**

	VENDOR		
1 Power Supply	POWER SUPPLY BY OWNER'S SECURITY		BY
	VENDOR		
1 Door Position Switch	DPS BY OWNER'S SECURITY VENDOR		BY
3 Door Silencers	1229A	GREY	TR

NOTE: Prep / Modify / Repair existing door, frame AND wall to accept specified hardware.  
 Operation: Door normally closed and locked. Presentation of valid credential releases electric strike allowing entry. Mechanical key by-pass. Egress always allowed.  
 Coordinate wiring and installation with GC / EC / Owner's Security Vendor / Owner's Locksmith.

**SET #016 - Electrical Rm, File Room**

Doors: 181, 198

3 Hinges	FBB179 4 1/2 X 4 1/2 NRP	US26D	ST
1 Exit Device	FL 2103 X 4903D SNB	630	PR
1 SFIC Rim Cyl. Housing	87 Series (Tailpiece As Req'd) BB KWY BLK	626	DM
1 Closer	8616 ARP SNB1	689	DM
	NOTE: PA MOUNT		
1 Kick Plate	K0050 10" x 1-1/2" LDW B4E CSK	630	TR
1 Wall Bumper	1270CX	626	TR
1 Gasketing	2525 B @ Head & Jambs		NA

**SET #017 - Existing Corridor - Access Control**

Doors: X180.1

3 Hinges	FBB179 4 1/2 X 4 1/2 NRP	US26D	ST
1 Exit Device	25-R-L-NL x 510L-NL QUANTUM SNB	US32D	FL
1 SFIC Rim Cyl. Housing	87 Series (Tailpiece As Req'd) BB KWY BLK	626	DM
1 Electric Strike	ELECTRIC STRIKE BY OWNER'S LOCKSMITH	630	BY
1 Closer	8616 DS BP86C SNB1	689	DM
1 Kick Plate	K0050 10" x 1-1/2" LDW B4E CSK	630	TR
1 Card Reader	CARD READER BY OWNER'S SECURITY		BY
	VENDOR		
1 Power Supply	POWER SUPPLY BY OWNER'S SECURITY		BY
	VENDOR		
1 Door Position Switch	DPS BY OWNER'S SECURITY VENDOR		BY
3 Door Silencers	1229A	GREY	TR

NOTE: Prep / Modify / Repair existing door, frame AND wall to accept specified hardware.  
 Operation: Door normally closed and locked. Presentation of valid credential releases electric strike allowing entry. Mechanical key by-pass. Egress always allowed.  
 Coordinate wiring and installation with GC / EC / Owner's Security Vendor / Owner's Locksmith.

**SET #018 - Existing Corridor - New Hardware**

Doors: X160

3 Hinges	FBB179 4 1/2 X 4 1/2	US26D	ST
1 Exit Device	25-R-L-BE x 510L-BE QUANTUM SNB	US32D	FL

**18-21<sup>st</sup>C-02 - 21<sup>st</sup> Century Cyber Charter School – Wrights Lane**

1 Closer	8616 AR BP86C SNB1	689	DM
1 Kick Plate	K0050 10" x 1-1/2" LDW B4E CSK	630	TR
1 Floor Stop	1211	626	TR
1 Gasketing	2525 B @ Head & Jambs		NA

NOTE: Prep / Modify / Repair existing door, frame AND wall to accept specified hardware.

**SET #019 - New Offices - Glass Door / Frame**

Doors: 118, 119, 120, 121, 122, 123, 146, 147, 148, 149

1 Interchangeable Core	77 - BB KWY	626	DM
	NOTE: PROVIDE BLK TEMP CONST CORE		
1 Wall Bumper	1270CX	626	TR
	BALANCE OF HARDWARE BY INTERIOR GLASS DOOR MFR.		BY

**SET #020 - Studio / Changing**

Doors: 162, 163, 164, 165, 203, 204

3 Hinges	FBB179 4 1/2 X 4 1/2	US26D	ST
1 Privacy Set	C840 LCC	626	DM
1 Wall Bumper	1270CV	626	TR
1 Coat Hook	796	US26D	RO
3 Door Silencers	1229A	GREY	TR

**SET #021 - New Office Passage / Closet**

Doors: 186.1, 186.2

3 Hinges	FBB179 4 1/2 X 4 1/2	US26D	ST
1 Passage Set	C810 LCC	626	DM
1 Overhead Stop	700 Series	626	DM
	NOTE: @ Door 186.1		
1 Wall Bumper	1270CX	626	TR
	NOTE: @ Door 186.2		
3 Door Silencers	1229A	GREY	TR

**SET #022 - New Office - Conf**

Doors: 186.3

3 Hinges	FBB179 4 1/2 X 4 1/2	US26D	ST
1 Entry Lockset	C853C LCC BB-KWY BLK	626	DM
1 Floor Stop	1211	626	TR
3 Door Silencers	1229A	GREY	TR

**SET #023 - New Restrooms / Lactation**

Doors: 194, 195, 115.1, 115.2

3 Hinges	FBB179 4 1/2 X 4 1/2	US26D	ST
1 Privacy Set	C840 LCC	626	DM

**18-21<sup>st</sup>C-02 - 21<sup>st</sup> Century Cyber Charter School – Wrights Lane**

1 Closer	8616 AR SNB1	689	DM
	NOTE: REG ARM MOUNT		
1 Mop Plate	KM050 6" x 1" LDW B4E CSK	630	TR
1 Kick Plate	K0050 10" x 1-1/2" LDW B4E CSK	630	TR
1 Wall Bumper	1270CV	626	TR
1 Coat Hook	796	US26D	RO
3 Door Silencers	1229A	GREY	TR

**SET #024 - Training - Access Control**

Doors: 151, 151.1, 151.2

3 Hinges	FBB179 4 1/2 X 4 1/2 NRP	US26D	ST
1 Storeroom Lockset	C880C LCC BB-KWY BLK	626	DM
1 Electric Strike	ELECTRIC STRIKE BY OWNER'S LOCKSMITH	630	BY
1 Closer	8616 ARP SNB1	689	DM
	NOTE: PA MOUNT		
1 Kick Plate	K0050 10" x 1-1/2" LDW B4E CSK	630	TR
1 Wall Bumper	1270CX	626	TR
1 Card Reader	CARD READER BY OWNER'S SECURITY VENDOR		BY
1 Power Supply	POWER SUPPLY BY OWNER'S SECURITY VENDOR		BY
1 Door Position Switch	DPS BY OWNER'S SECURITY VENDOR		BY
3 Door Silencers	1229A	GREY	TR

NOTE: Verify electric strike product number with Owner's Locksmith for door and / frame preparation requirements. Operation: Door normally closed and locked. Presentation of valid credential releases electric strike allowing entry. Mechanical key by-pass. Egress always allowed.  
Coordinate wiring and installation with GC / EC / Owner's Security Vendor / Owner's Locksmith.

**SET #025 - Server - Access Control**

Doors: 136.1

3 Hinges	FBB179 4 1/2 X 4 1/2	US26D	ST
1 Storeroom Lockset	C880C LCC BB-KWY BLK	626	DM
1 Electric Strike	ELECTRIC STRIKE BY OWNER'S LOCKSMITH	630	BY
1 Closer	8616 AR SNB1	689	DM
	NOTE: REG ARM MOUNT		
1 Kick Plate	K0050 10" x 1-1/2" LDW B4E CSK	630	TR
1 Wall Bumper	1270CX	626	TR
1 Card Reader	CARD READER BY OWNER'S SECURITY VENDOR		BY
1 Door Position Switch	DPS BY OWNER'S SECURITY VENDOR		BY
3 Door Silencers	1229A	GREY	TR

NOTE: Verify electric strike product number with Owner's Locksmith for door and / frame preparation requirements. Operation: Door normally closed and locked. Presentation of valid credential releases electric strike allowing entry. Mechanical key by-pass. Egress always allowed.  
Coordinate wiring and installation with GC / EC / Owner's Security Vendor / Owner's Locksmith.

**18-21<sup>st</sup>C-02 - 21<sup>st</sup> Century Cyber Charter School – Wrights Lane**

SET #026 - Warehouse - Access Control

Doors: 136

5 Hinges	FBB179 4 1/2 X 4 1/2	US26D	ST
1 Electric Hinge	CEFBB179-66 4 1/2 X 4 1/2	US26D	ST
2 Flush Bolt	3917-12	626	TR
1 Storeroom Lockset	C880C LCC BB-KWY BLK	626	DM
1 Electric Strike	ELECTRIC STRIKE BY OWNER'S LOCKSMITH	630	BY
1 Closer	8616 ISH SNB1	689	DM
	NOTE: @ Active Leaf		
2 Kick Plate	K0050 10" x 1" LDW B4E CSK	630	TR
1 Wall Bumper	1270CX	626	TR
1 Card Reader	CARD READER BY OWNER'S SECURITY VENDOR		BY
1 Power Supply	POWER SUPPLY BY OWNER'S SECURITY VENDOR		BY
2 Door Position Switch	DPS BY OWNER'S SECURITY VENDOR		BY
1 Dustproof Strike	3910	630	TR
2 Door Silencers	1229A	GREY	TR

NOTE: Verify electric strike product number with Owner's Locksmith for door and / frame preparation requirements. Operation: Door normally closed and locked. Presentation of valid credential releases electric strike allowing entry. Mechanical key by-pass. Egress always allowed. Coordinate wiring and installation with GC / EC / Owner's Security Vendor / Owner's Locksmith.

SET #027 - Receiving - Access Control

Doors: 135

5 Hinges	FBB179 4 1/2 X 4 1/2 NRP	US26D	ST
1 Electric Hinge	CEFBB179-66 4 1/2 X 4 1/2	US26D	ST
2 Flush Bolt	3917-12	626	TR
1 Storeroom Lockset	C880C LCC BB-KWY BLK	626	DM
1 Electric Strike	ELECTRIC STRIKE BY OWNER'S LOCKSMITH	630	BY
1 Closer	8616 ARP SNB1	689	DM
	NOTE: @ Active Leaf (PA MOUNT)		
2 Kick Plate	K0050 10" x 1" LDW B4E CSK	630	TR
2 Wall Bumper / Floor Stop	1270CX / 1211 As Req'd	626	TR
1 Card Reader	CARD READER BY OWNER'S SECURITY VENDOR		BY
1 Power Supply	POWER SUPPLY BY OWNER'S SECURITY VENDOR		BY
2 Door Position Switch	DPS BY OWNER'S SECURITY VENDOR		BY
1 Dustproof Strike	3910	630	TR
1 Gasketing	2525 B @ Head & Jambs		NA

NOTE: Verify electric strike product number with Owner's Locksmith for door and / frame preparation requirements. Operation: Door normally closed and locked. Presentation of valid credential releases electric strike allowing entry. Mechanical key by-pass. Egress always allowed. Coordinate wiring and installation with GC / EC / Owner's Security Vendor / Owner's Locksmith.

**18-21<sup>st</sup>C-02 - 21<sup>st</sup> Century Cyber Charter School – Wrights Lane**

SET #028 - Open Space

Doors: x112

6 Hinges	FBB179 4 1/2 X 4 1/2	US26D	ST
2 Pull Plate	1018-3	630	TR
2 Closer	8616 AR SNB1	689	DM
NOTE: RA MOUNT			
2 Kick Plate	K0050 10" x 1" LDW B4E CSK	630	TR
2 Push Plate	1001-3	630	TR
2 Wall Bumper	1270CX	626	TR
2 Door Silencers	1229A	GREY	TR

NOTE: Prep / Modify / Repair existing door, frame AND wall to accept specified hardware.

SET #029 - Existing Ext Caf - Access Ctrl

Doors: X201.2

1 Deadlatch	4530 Series - VIF Reqd Backset	628	AD
1 SFIC Mortise Cylinder Housing	96 / 97 As Reqd - 01 BB KWY BLK	626	DM
1 Electric Strike	ELECTRIC STRIKE BY OWNER'S LOCKSMITH	630	BY
1 Closer	8616 ISJ (DP86 / BP86 As Reqd)	689	DM
NOTE: TOP JAMB MOUNT			
1 Card Reader	CARD READER BY OWNER'S SECURITY VENDOR		BY
1 Power Supply	POWER SUPPLY BY OWNER'S SECURITY VENDOR		BY
1 Door Position Switch	DPS BY OWNER'S SECURITY VENDOR		BY
1 Paddle Operator	4591 Series	628	AD
1 Gasketing	2525 B @ Head & Jambs		NA
1 Door Sweep	201 NA		NA
1 --	ALL OTHER EXISTING HARDWARE TO REMAIN		BY

NOTE: Prep / Modify / Repair existing door, frame AND wall to accept specified hardware.

Operation: Door normally closed and locked. Presentation of valid credential releases electric strike allowing entry. Mechanical key by-pass. Egress always allowed.

Coordinate wiring and installation with GC / EC / Owner's Security Vendor / Owner's Locksmith.

SET #030 - Existing Ext Corr 160 - Access Ctrl

Doors: X180

1 Exit Device	8801 EL x Voltage As Reqd	628	AD
1 SFIC Rim Cyl. Housing	87 Series (Tailpiece As Reqd) BB KWY BLK	626	DM
1 Door Pull	1191-1 N	630	TR
1 Closer	8616 ISJ (DP86 / BP86 As Reqd)	689	DM
NOTE: TOP JAMB MOUNT			
1 Card Reader	CARD READER BY OWNER'S SECURITY VENDOR		BY
1 Power Supply	POWER SUPPLY BY OWNER'S SECURITY		BY

**18-21<sup>st</sup>C-02 - 21<sup>st</sup> Century Cyber Charter School – Wrights Lane**

	VENDOR		
1 Door Position Switch	DPS BY OWNER'S SECURITY VENDOR		BY
1 Gasketing	2525 B @ Head & Jambs		NA
1 Door Sweep	201 NA		NA
1 --	ALL OTHER EXISTING HARDWARE TO REMAIN		BY

NOTE: Prep / Modify / Repair existing door, frame AND wall to accept specified hardware.  
 Operation: Door normally closed and locked. Presentation of valid credential releases electric latch of exit device allowing entry. Mechanical key by-pass. Egress always allowed. Coordinate wiring and installation with GC / EC / Owner's Security Vendor / Owner's Locksmith.  
 VIF existing power transfer / door loop operates as intended.

**SET #031 - Existing Exit Only**

Doors: X113.1, X209

1 Exit Device	2401 SNB (4)	630	PR
2 Dummy Cylinder	91 Length & Collar As Reqd	626	DM
1 Closer	8616 S-IS(J) BP86 / DP 86 As Reqd	689	DM
	NOTE: TOP JAMB MOUNT		
1 Door Position Switch	DPS BY OWNER'S SECURITY VENDOR		BY
1 Gasketing	2525 B @ Head & Jambs		NA
1 Door Sweep	201 NA		NA
1 --	ALL OTHER EXISTING HARDWARE TO REMAIN		BY

NOTE: Prep / Modify / Repair existing door, frame AND wall to accept specified hardware. Remove existing push / pull bar. Install dummy cylinders in existing deadlock. Coordinate wiring with Owner's Security Vendor.

**SET #032 - Vestibule 100.1 - New Door / Exist Frame**

Doors: X100.1

1 Continuous Hinge	661 HD UL	AL	ST
1 Exit Device	2403	630	PR
1 SFIC Rim Cyl. Housing	87 Series (Tailpiece As Reqd) BB KWY BLK	626	DM
1 Electric Strike	ELECTRIC STRIKE BY OWNER'S LOCKSMITH	630	BY
1 Door Pull	1191-4J N	630	TR
1 Closer	8616 S-DS BSHD NFHD	689	DM
1 Card Reader	CARD READER BY OWNER'S SECURITY VENDOR		BY
1 Power Supply	POWER SUPPLY BY OWNER'S SECURITY VENDOR		BY
1 Door Position Switch	DPS BY OWNER'S SECURITY VENDOR		BY
1 Gasketing	2525 B @ Head & Jambs		NA
1 Door Sweep	201 NA		NA

NOTE: Prep / Modify / Repair existing frame to accept specified hardware. Coordinate hardware with aluminum door supplier.  
 Operation: Door normally closed and locked. Presentation of valid credential releases electric strike allowing entry. Mechanical key by-pass. Egress always allowed.

**18-21<sup>st</sup>C-02 - 21<sup>st</sup> Century Cyber Charter School – Wrights Lane**

Coordinate wiring and installation with GC / EC / Owner's Security Vendor / Owner's Locksmith.

**SET #033 - Vestibule 100.1 - New Door / Exist Frame**

Doors: X100.2

1	Continuous Hinge	661 HD UL	AL	ST
1	Exit Device	2401 SNB (4)	630	PR
1	Closer	8616 S-DS BSHD NFHD	689	DM
1	Door Position Switch	DPS BY OWNER'S SECURITY VENDOR		BY
1	Gasketing	2525 B @ Head & Jambs		NA
1	Door Sweep	201 NA		NA

NOTE: Prep / Modify / Repair existing frame to accept specified hardware. Coordinate hardware with aluminum door supplier.

Coordinate wiring and installation with GC / EC / Owner's Security Vendor.

**SET #034 - Main Entrance - New Door / Frame**

Doors: 100.1A

1	Continuous Hinge	661 HD UL	AL	ST
1	Exit Device	2403	630	PR
1	SFIC Rim Cyl. Housing	87 Series (Tailpiece As Req'd) BB KQY BLK	626	DM
1	Door Pull	1191-4J N	630	TR
1	Closer	8616 SPA BSHD NFHD	689	DM
1	Overhead Stop	1020 SL Series	US32D	AB
1	Door Position Switch	DPS BY OWNER'S SECURITY VENDOR		BY
1	Door Sweep	201 NA		NA
1	Threshold	896 N	AL	NA

NOTE: Balance of seals by door / frame manufacturer. Coordinate hardware with aluminum door supplier.

Coordinate wiring and installation with GC / EC / Owner's Security Vendor.

**SET #035 - Main Entrance - New Door / Frame**

Doors: 100.1B

1	Continuous Hinge	661 HD UL	AL	ST
1	Exit Device	2401 SNB (4)	630	PR
1	Closer	8616 SPA BSHD NFHD	689	DM
1	Overhead Stop	1020 SL Series	US32D	AB
1	Door Position Switch	DPS BY OWNER'S SECURITY VENDOR		BY
1	Door Sweep	201 NA		NA
1	Threshold	896 N	AL	NA

NOTE: Balance of seals by door / frame manufacturer. Coordinate hardware with aluminum door supplier.

Coordinate wiring and installation with GC / EC / Owner's Security Vendor.

END OF SECTION 08 71 00



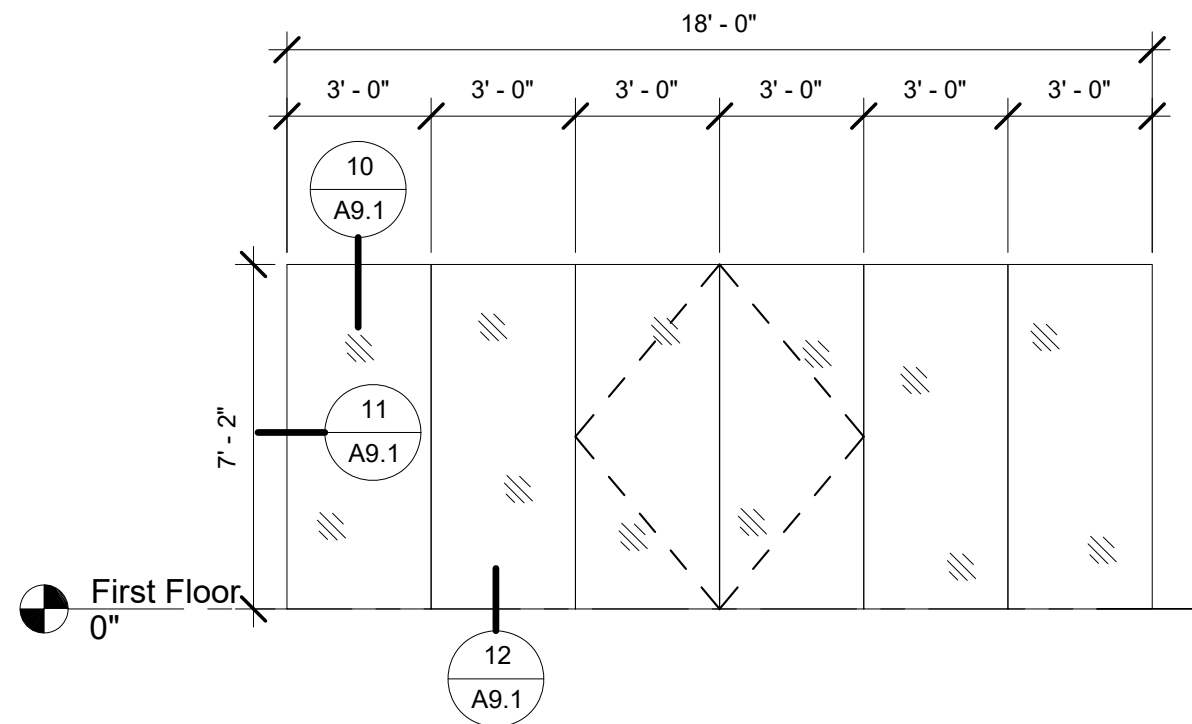
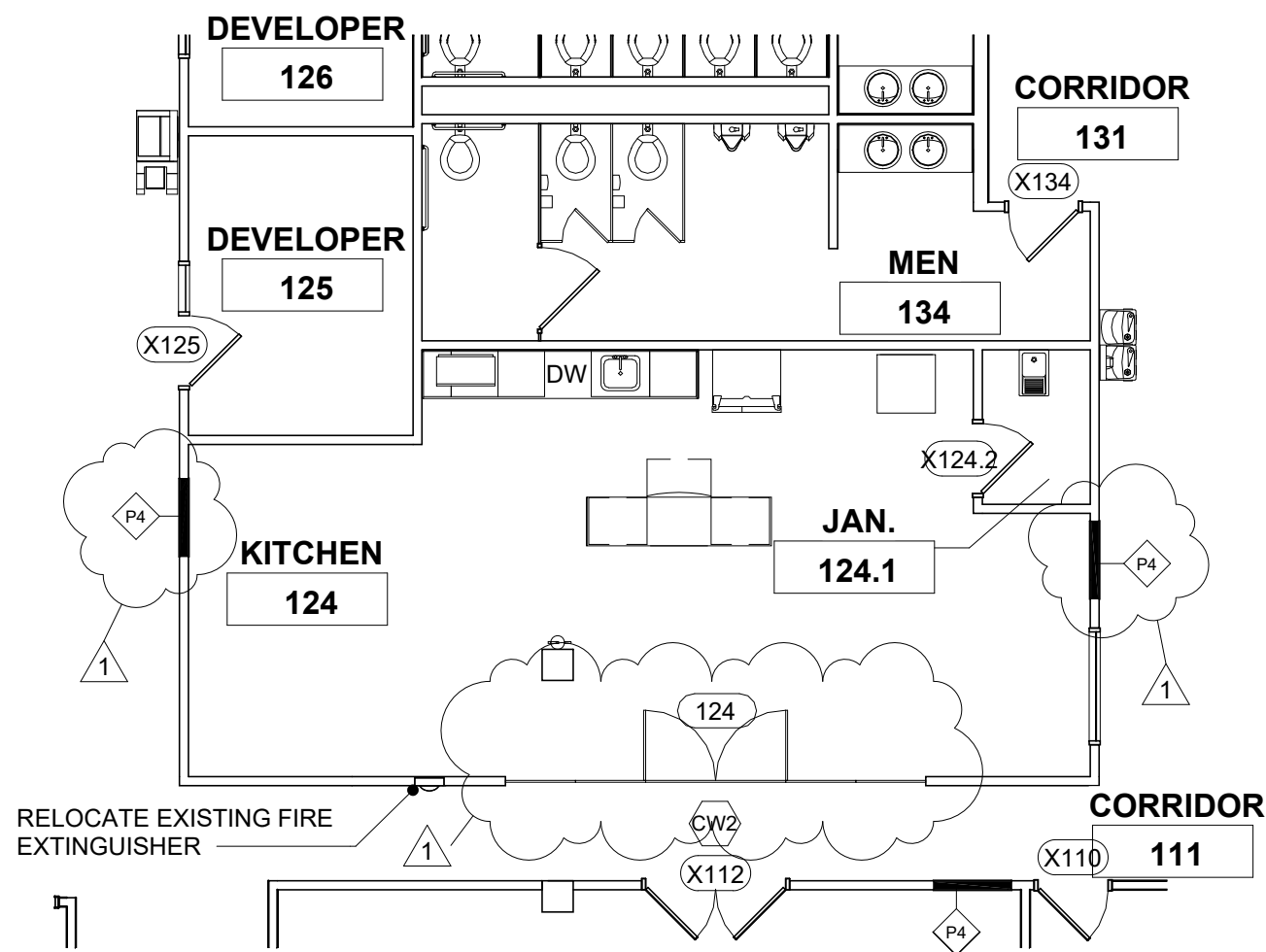

**1 FLOOR PLAN - AREA A**  
ASK-01 1/8" = 1'-0"

**2 CURTAINWALL ELEVATION**  
ASK-01 1/4" = 1'-0"

SKETCH SHEET REFERENCE DWG. NUMBER: 1/A1.1; 9/A9.1

RENOVATIONS TO  
1245 WRIGHTS LANE  
21st CENTURY CYBER CHARTER  
SCHOOL  
1245 WRIGHTS LANE  
WEST CHESTER, PA

THIS DRAWING IS THE PROPERTY OF THE ARCHITECT. IT MAY NOT BE PRODUCED IN ANY FORM WITHOUT WRITTEN PERMISSION.

DRAWN BY: Author

DATE: 04/02/19

SHEET TITLE:  
**FLOOR PLAN - AREA A**

SHEET NUMBER:  
**ASK-01**