



## LTZ1 - Rental Car Pickup at Geneva Airport

Maps and Driving Directions to La Tzoumaz  
Underground Parking & Access at the Résidence Laforêt  
& Shopping en route – supermarkets near to the Autoroutes

This guide can also be downloaded from the website  
[‘www.laforet35.ch’](http://www.laforet35.ch)

(LTZ1 V.20 – 1.1.20)

*Satnav / Goggle Earth (Entrance to Underground Car Park at:)*

Latitude: 46° 8' 35.92" North (46.14331111°)  
Longitude: 7° 14' 10.42" East (7.23611111°)

Via Michelin: 'La Tzoumaz / Telecabine'  
(then 200 metres past telecabine, on left)

*All diagrams, maps and guidance provided without liability and may change subsequent to publication.*

## Geneva Airport Arrivals: Hire Car Pickup & Trains

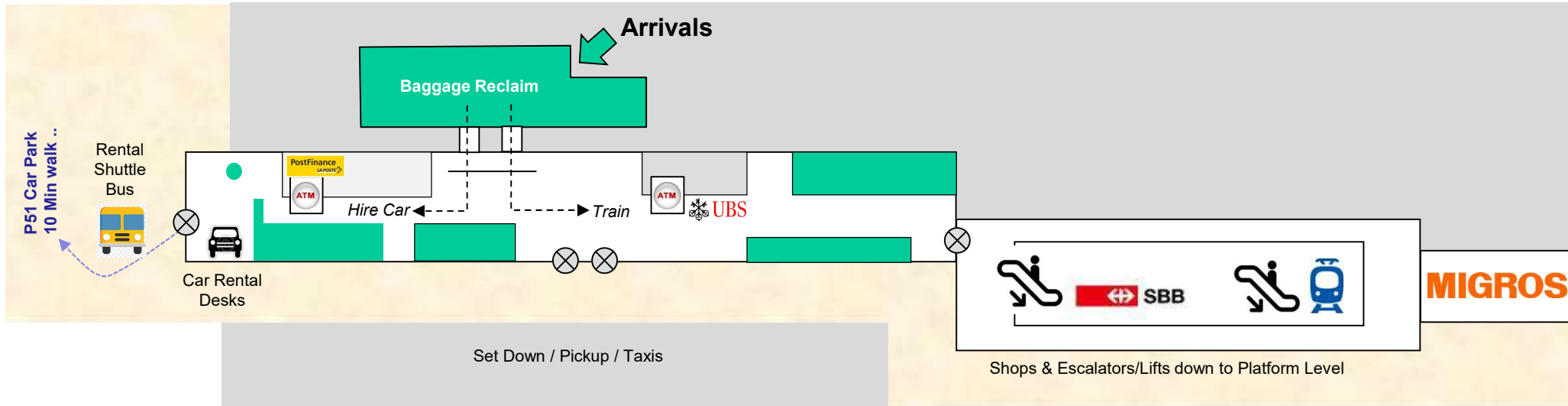

For trains: Turn *left* out of the Arrivals gate. Walk along the hall to the end, then through the revolving doors, down the escalator. The SBB train ticket office is then on your right. If you have a ticket, go down the escalator onto the platform for the train to Lausanne/Brig.



Normally, you'll be on the inter-city train to Brig, via Geneva, Lausanne and Montreux. You'll usually change to a local train at either Martigny or Sion. Look at [www.sbb.ch](http://www.sbb.ch) for timetable information. An advance 'Supersaver' ticket will be a lot cheaper, but as in the UK, is only valid for a specific train time.

The route is *from* 'Geneve Aeroport' to 'La Tzoumaz (tele.)' usually with a train change at Martigny; a short walk up to the téléphérique in Riddes, and change to the PostBus in Iséables. Download LTZ3 for more information.



If it's Sunday, and you need to shop, the Migros at the end of the second concourse is one of the few supermarkets that will be open. Most supermarkets and superstores close on Sundays in Switzerland.



If you need cash, there are UBS ATMs (left) towards the train station.

## Walking to Swiss Car Hire Pickup/Return in P51



Swiss Car Rentals in P51: If you don't have a lot of luggage, you may prefer to walk between the Car Rental desks in the terminal and the pickup garage in T51, as it's only 10 minutes on foot.

Go past the Shuttle Bus Stop and cross the road, then walk along the front of the office buildings. Note the location of the small self-service petrol station in front of the second building. When returning the car, this is the last place where you can fill up (although it's obviously pricey, given the location).

Note the layout of the entrance to the car hire building – when you return the car, you drive into the building through the same entrance, keeping to the right, take a ticket from the machine, drive on 10 metres and insert the ticket back into a second machine (go figure). This gives you access to the car hire ground floor.



## Swiss Car Hire Pickup/Return in P51





Car Hire Pickup is on the ground floor, opposite the viewer.

After pickup, you exit where it says 'STOP' by the railings, turn right (the way the white car is going) and then 'hug' the car park building around to the right, onto the bridge behind the viewer. See next page.

Note the layout of the entrance to the car hire building for when you return – when you return the car, you drive into the building through the entrance on the right (under the P51 sign), keeping to the right lane (right of the traffic cone in the photo), take a ticket from the machine, drive on 10 metres and insert the ticket back into a second machine (go figure). This gives you access to the car hire ground floor.

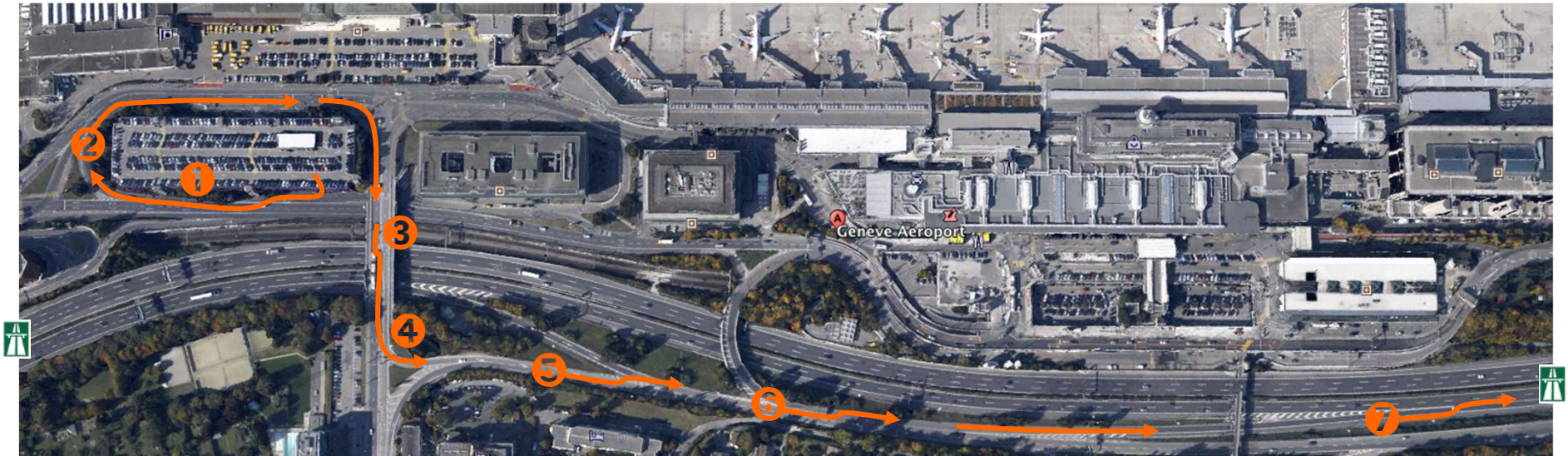
Escaping from T51: getting onto the Autoroute → Lausanne & Gt.St.Bernard  [note: autoroutes signed in green]



1. Exit Car Hire – KEEP RIGHT – IMMEDIATELY RIGHT
2. Go 180° 'round the car hire building.  RIGHT AT TRAFFIC LIGHTS
3. Across bridge FILTER LEFT and in 50m there is a left lane to **Lausanne** - STOP
4. TAKE LEFT TURN (against oncoming traffic) to '**Lausanne – Aéroport** - Palexpo Arena'
5. KEEP LEFT & Filter Left
6. KEEP LEFT & Filter Left
7. KEEP LEFT & Join Autoroute to **Lausanne**
8. Then follow Autoroute Signs to **Gt.St.Bernard** until **Martigny**
9. At Martigny follow Autoroute to **Brig** (See next page)
10. Exit Autoroute at **Jct.24 Riddes**



From Airport: Follow **E62-A1-A9** Autoroute  Signs to **Gd.St.Bernard** until Martigny.

At Martigny keep left on autoroute to **Brig** continue 10 Kms to exit **No.24** →

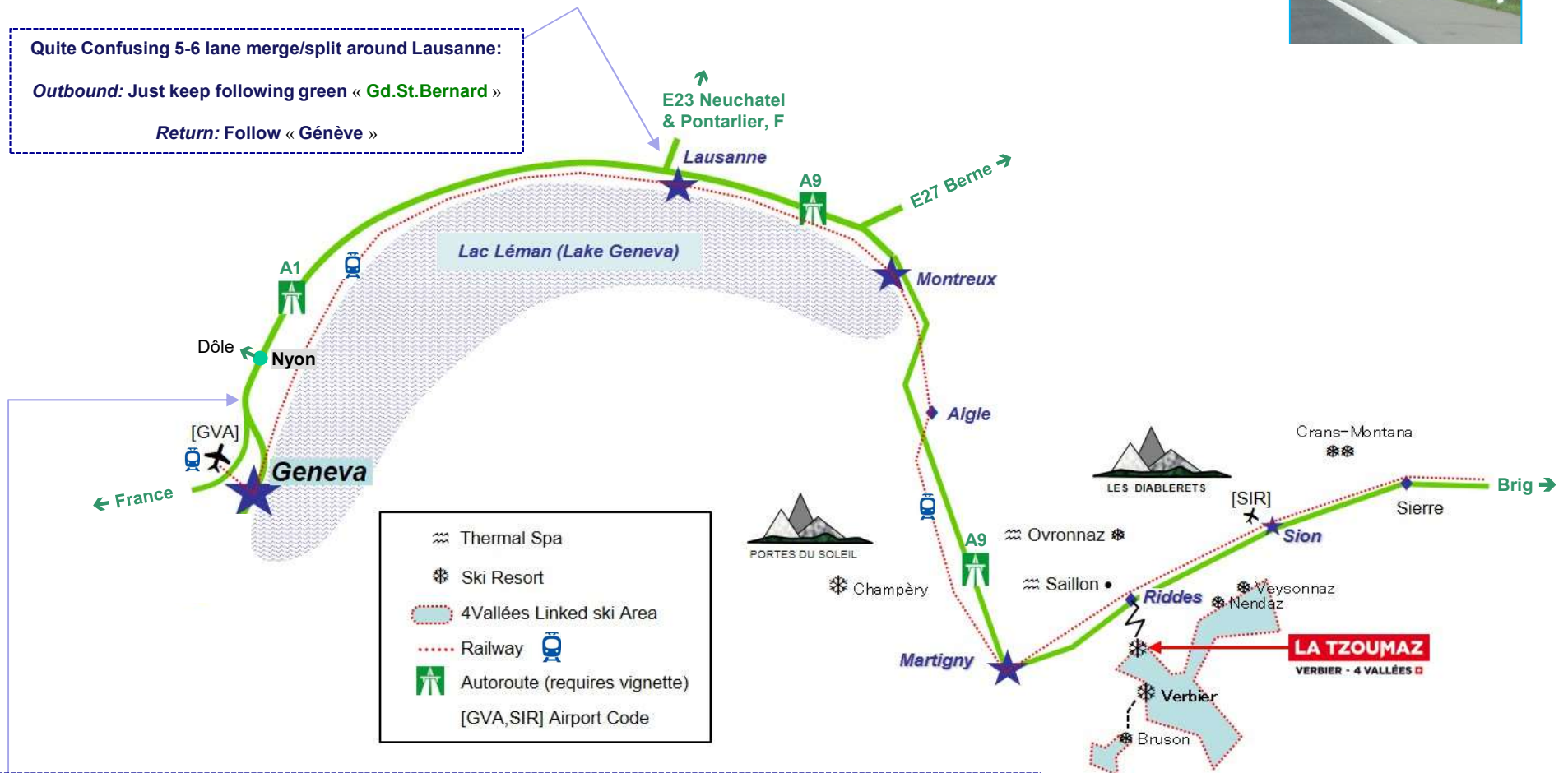

**Return: approaching Geneva -**

On E62 to France, follow the «Aéroport/Palexpo» road, to the right.  
 Go underneath the Palexpo building which spans the Autoroute and when under it take right slip road to «aéroport»  
 Look for «voiture de location» car rental lane on gantry & follow. Takes past the front of the terminal building and drop-off areas.  
 Self-service fuel pumps on right on ground floor of building before the T51 car park. If you miss these or rental return keep right and circle back.

## SHOPPING EN ROUTE AROUND LAKE GENEVA

The village supermarket is well-stocked and quite large, but if you want a wider choice of products and prices about 15% less than up the mountain, you may want to shop en route. The best place for this is the Co-op Superstore at Aubonne [2].

If it's late in the evening, you can pick up basics at most service stations (relais), such as the Relais de Lavaux, just past Lausanne [A].

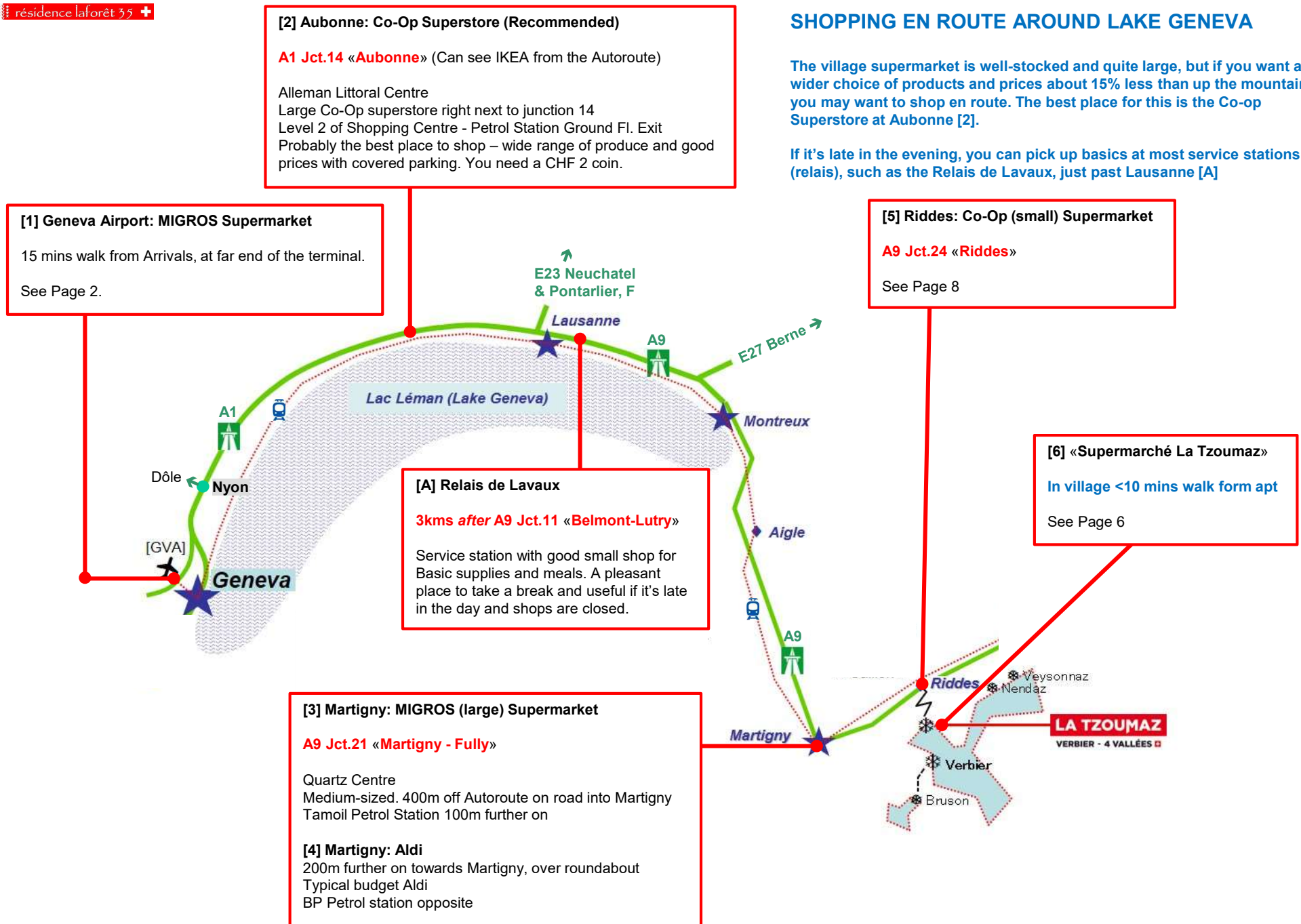

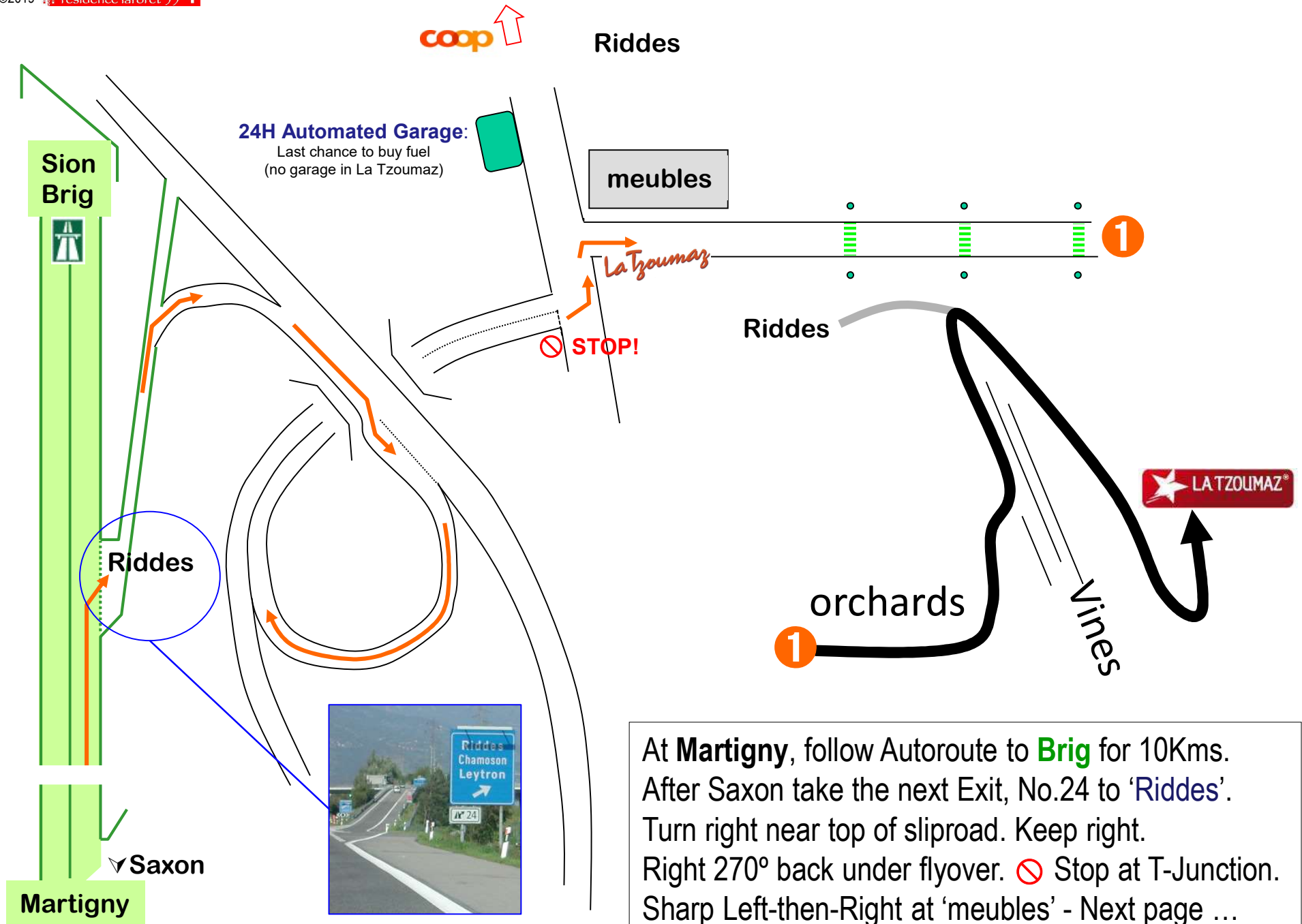

At **Martigny**, follow Autoroute to **Brig** for 10Kms. After Saxon take the next Exit, No.24 to '**Riddes**'. Turn right near top of sliproad. Keep right. Right 270° back under flyover. **STOP** at T-Junction. Sharp Left-then-Right at '**meubles**' - Next page ...



## Riddes: Location of

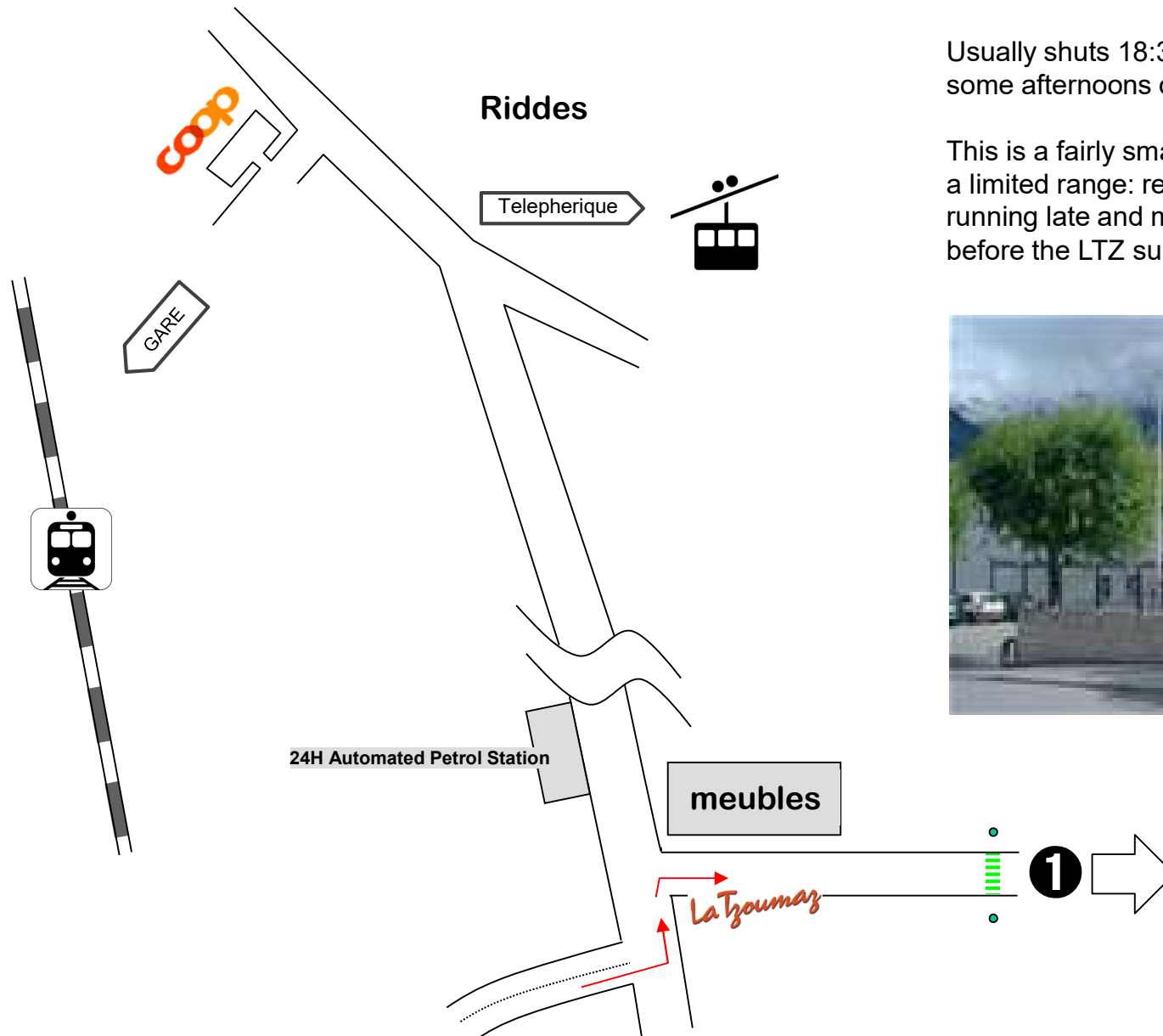

Usually shuts 18:30 and all-day Sunday and some afternoons outside holiday weeks.

This is a fairly small village supermarket with a limited range: recommended it if you're running late and may not get to La Tzoumaz before the LTZ supermarket closes.



Look out for a white sign on the right:

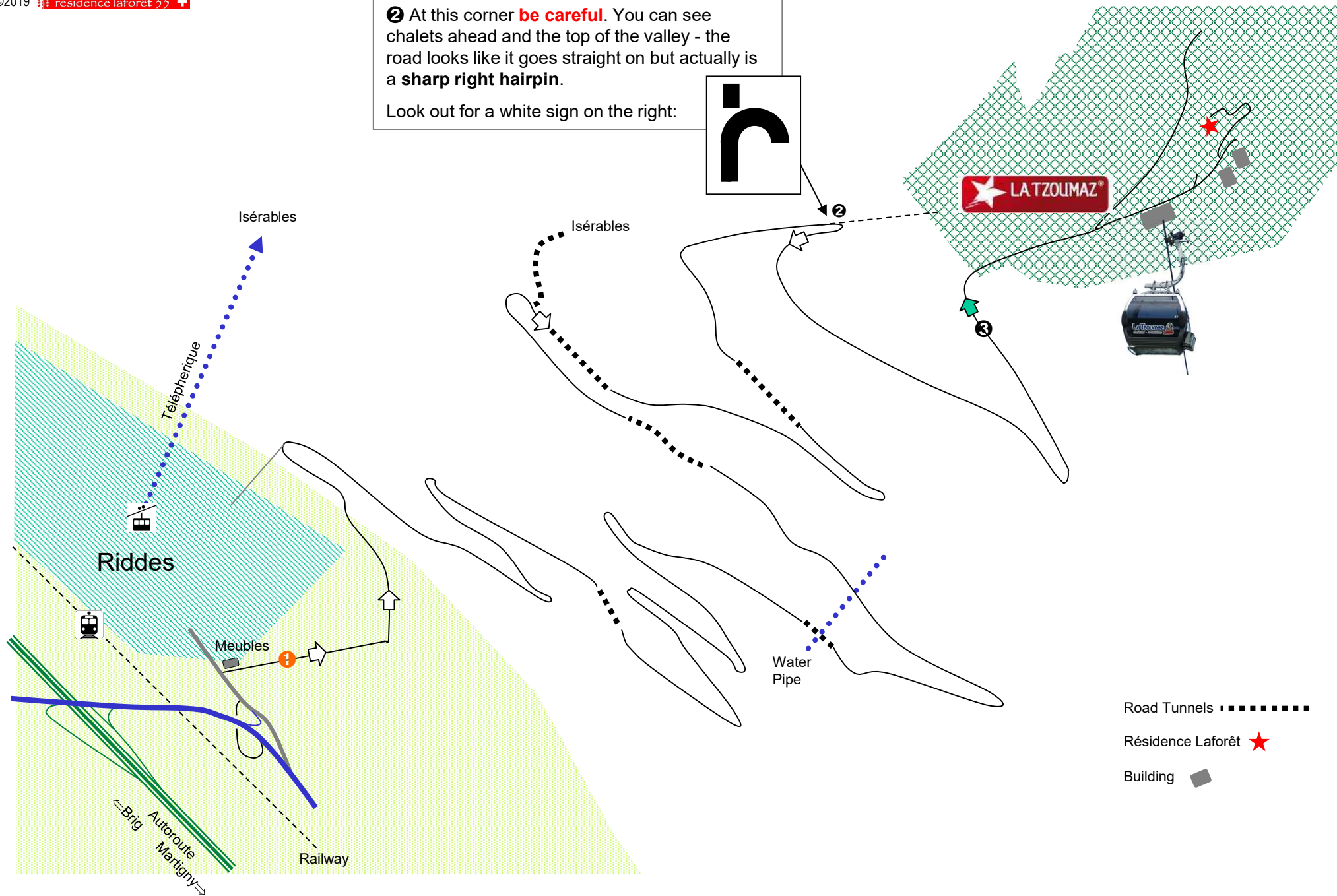
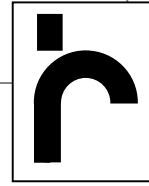

Road Tunnels ■■■■■■■■

Résidence Laforêt ★

Building 



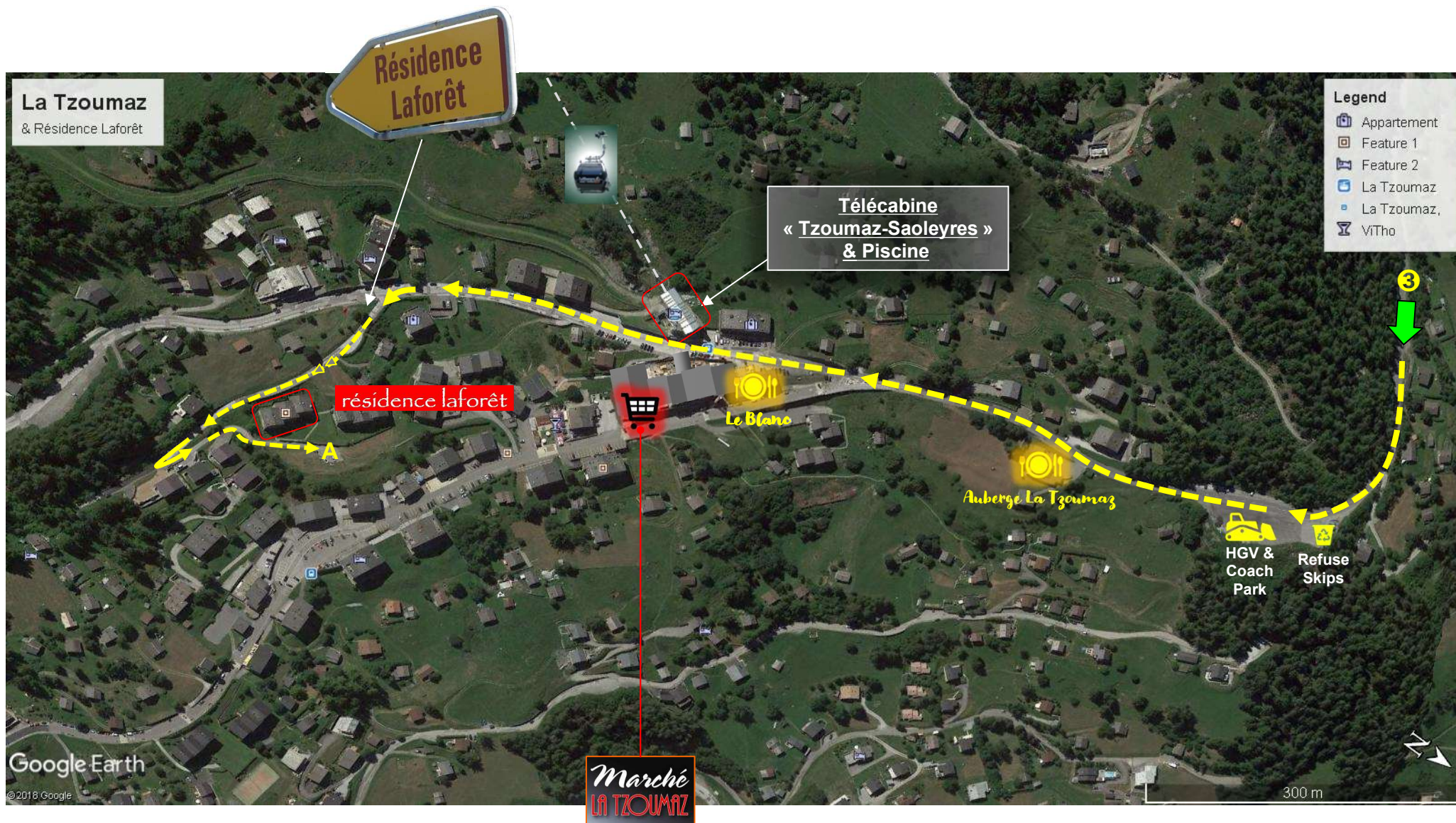



## If Arriving with NO KEYS

- ❶ Stop car outside main entrance if closed, otherwise
  - ❷ Walk through pedestrian door (not locked)
  - ❸ Walk over to Switch on column opposite, left
  - ❹ Press to open garage door
  - ❺ Drive in. Turn left. Park in Bay 35 on right
  - ❻ Go up to apartment via lift to 3<sup>rd</sup>. floor
- Key Safe is outside door: enter code  
Large key opens apartment  
See next sheets for other facilities keys etc.

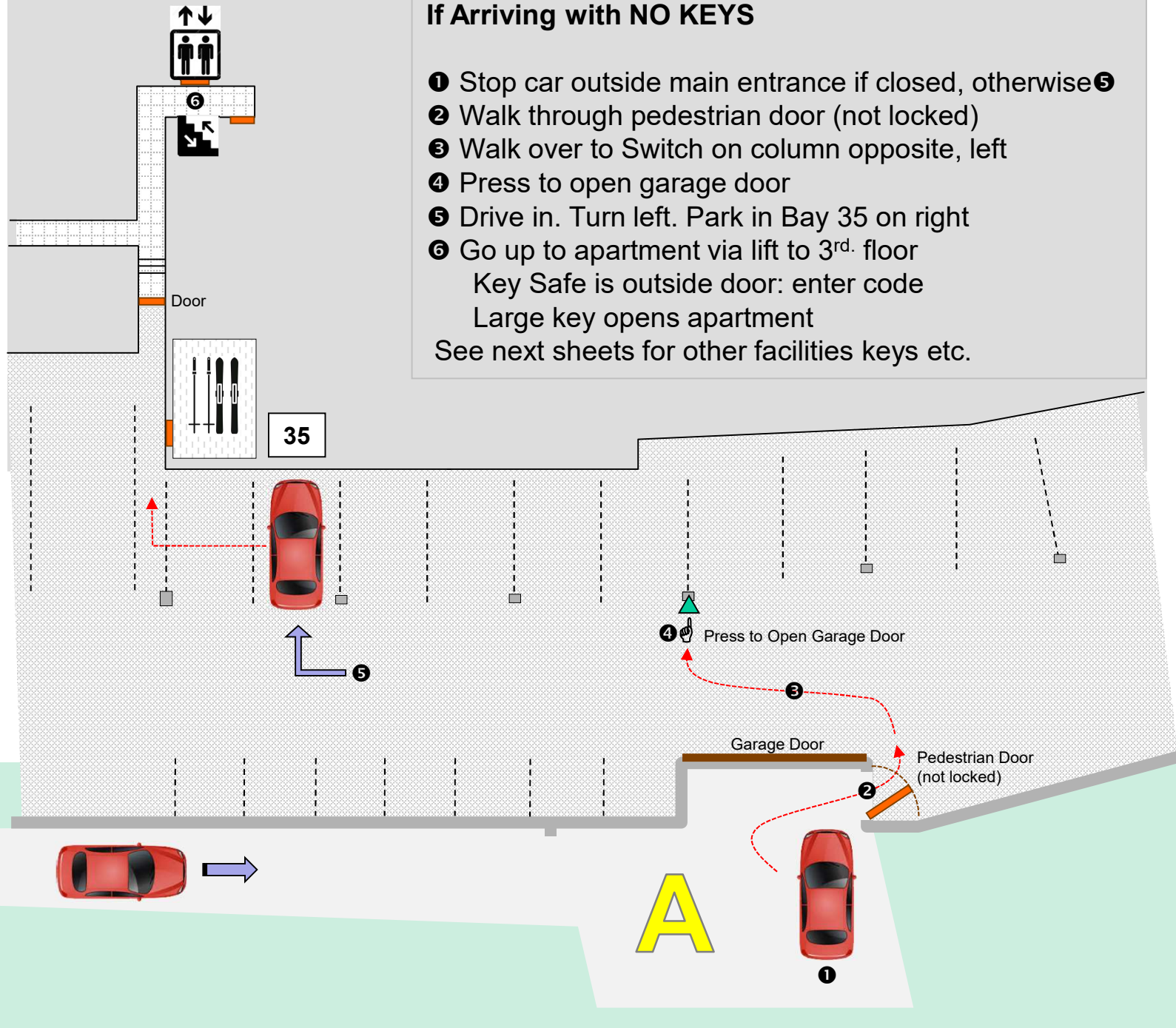

## If Arriving WITH KEYS

- ❶ Open Garage Door using switch on outside wall
- ❺ Drive in. Turn left. Park in Bay 35 on right\*
- ❻ Go up to apartment via lift to 3<sup>rd</sup> floor

\*If someone else is parked there, park somewhere else, leave a note on your car and on the offender's car. Note on last page.

(When Driving out, press button ❷ on pillar)

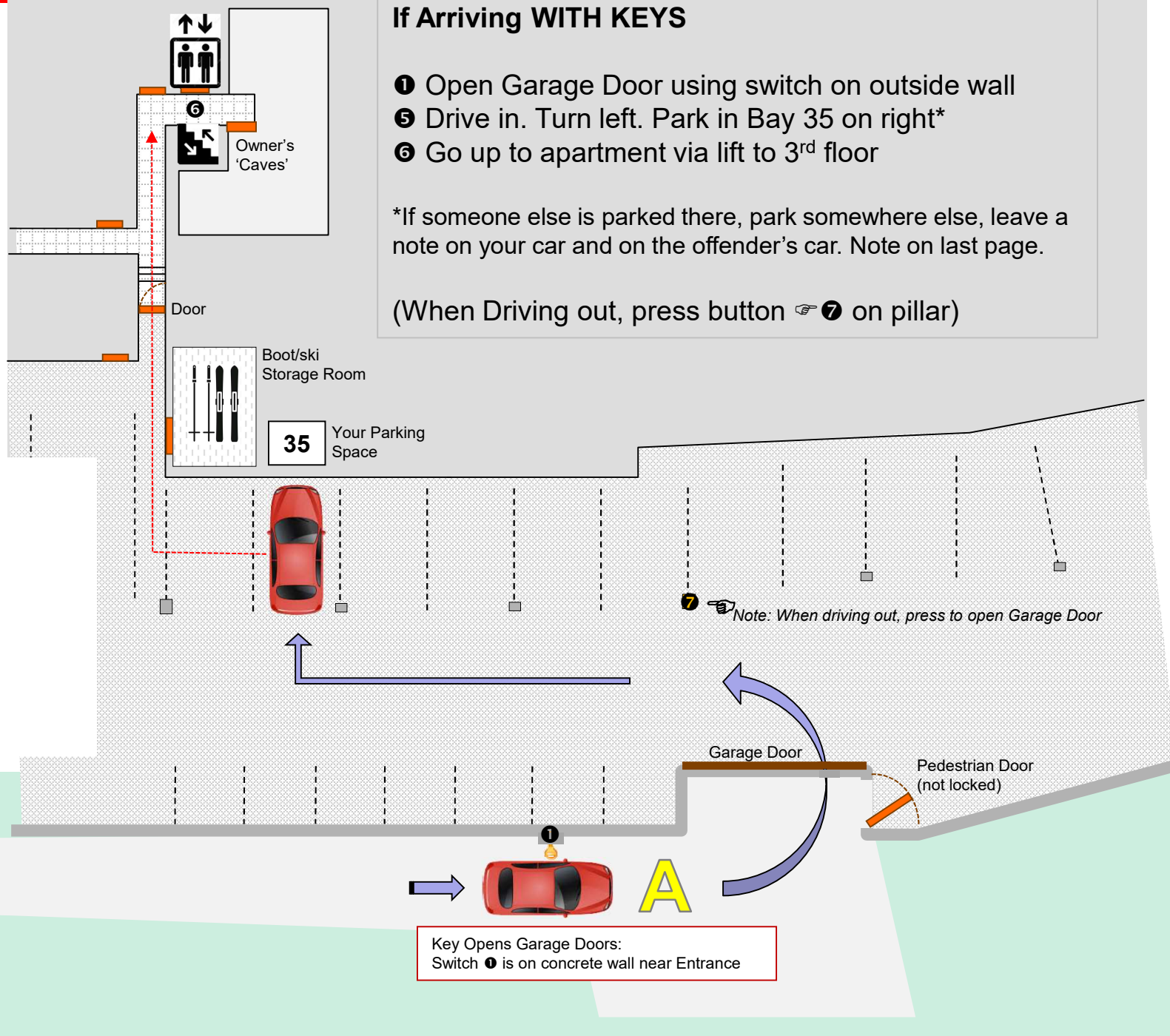

## WHAT THE KEYS GIVE YOU ACCESS TO

- ❶ Opens Garage Door using switch on outside wall
- ❷ Ski/Boot Room Storage – Always LOCK this door
- ❸ Laundry
- ❹ Apartment 35
- ❺ Owners 'cave' storage area\*

- ❻ Small Key Opens Owner's cage No.35 then  
★Padlock Code = '????'

To exit parking press ❷ on pillar

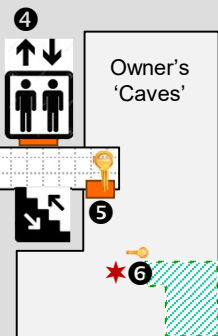

Cage 35

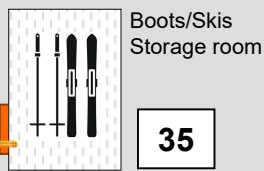

Larger Key Opens

- ❶ Garage Door from Outside
- ❷ Ski+Boot Room
- ❸ Laundry
- ❹ Apartment
- ❺ Cave in basement\*

Manually open the garage door using switch on pillar opposite the entrance ❷

Smaller key opens Cage 35 Door ❻\*

Press to Open Garage Door

FYI Sauna – Last door on left  
Access & Use instructions in yellow folder In apartment  
Needd Sauna Code + 4x CHF 1 Coins

Pedestrian Door (not locked)

Garage Door

Key Opens Garage Doors:  
Switch is on concrete wall near Entrance



Sauna

To Télécabine



To Centre







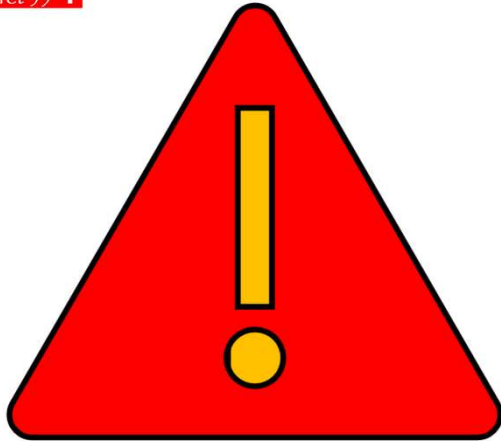

## Attention!

**Unfortunately this parking space is reserved for apt 35 and is in use this week - please move your vehicle. Thank you.**

Malheureusement, cet espace de stationnement est réservé à l'apt 35 et est utilisé cette semaine. Veuillez déplacer votre véhicule. Merci.



### Desolé - excuses

**We are in Apt. 35 - someone else has parked their car in our space. Naturally, we will move this car if it is in your way. Please just come to the apartment, or text us on the following number:**

.....

Excuses - Nous sommes dans Apt. 35 et quelqu'un d'autre a garé sa voiture dans notre espace. Naturellement, nous déplacerons cette voiture si elle vous gêne. S'il vous plaît venez à l'appartement ou envoyez-nous un texto au numéro suivant:

