

Light Industrial Building Units

X Reserved Units (Unavailable)

Type A
(Bldgs. 01 & 02)
12 Units (54' x 30')

Type B
(Bldgs. 03 - 12)
48 Units (40' x 28')

Project Total
12 Buildings
60 Units

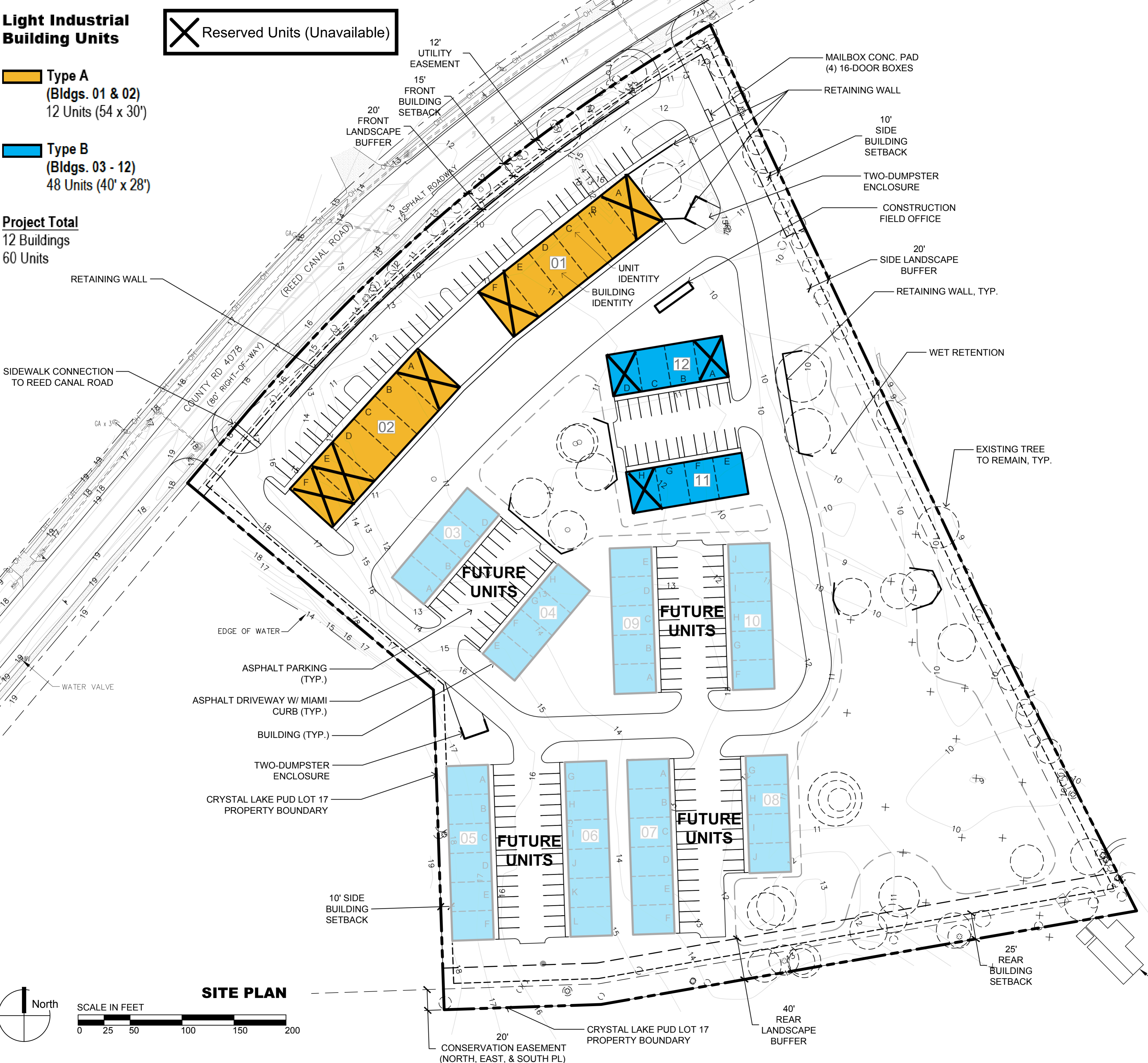

SITE PLAN

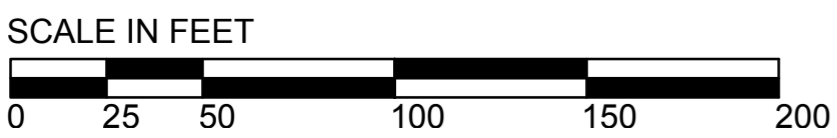
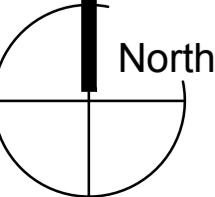

20' CONSERVATION EASEMENT (NORTH, EAST, & SOUTH PL)

CRYSTAL LAKE PUD LOT 17 PROPERTY BOUNDARY

40' REAR LANDSCAPE BUFFER

25' REAR BUILDING SETBACK