

NOTES:

1. ALL DIMENSIONS ARE TO THE BACK OF CURB UNLESS OTHERWISE STATED.
2. ALL SIDEWALKS SHALL HAVE A CROSS SLOPE OF NO GREATER THAN 2.0%.

FIRE LANE NOTES:

- STRIPING - THE TOP FACE OF ROAD CURBS SHALL BE PAINTED UTILIZING RED TRAFFIC PAINT.
- A. IF NO CURBS ARE PRESENT, A SIX INCH (6") WIDE STRIPE PAINTED OF TRAFFIC RED PAINT SHALL BE PAINTED ON THE DRIVING SURFACE TO SHOW THE BOUNDARIES OF THE LANE.
- B. THE WORDS "NO PARKING FIRE LANE" SHALL BE SPACED AT A MAXIMUM OF 25 FEET APART, ALONG THE LENGTH OF THE FIRE LANES. SEE ILLUSTRATION BELOW.

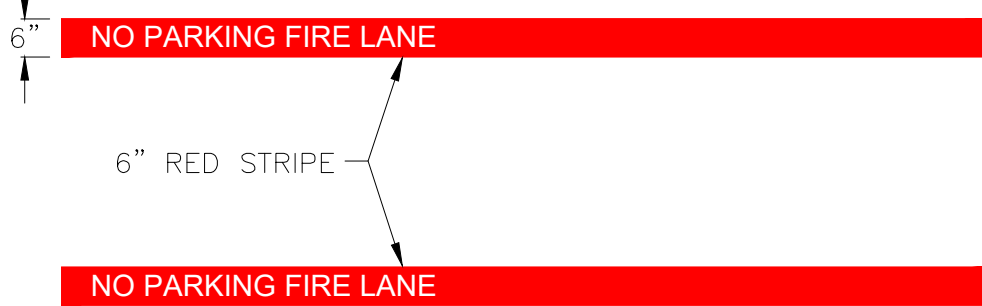

1 FIRE LANE DETAIL
N.T.S.

FLEXIBLE PAVEMENTS		
PAVEMENT MATERIAL	HEAVY	LIGHT
TYPE "D" HMAC	3"	2"
AGGREGATE BASE	12"	8"
LIME STABILIZED SUBGRADE	8"	8"

RIGID PAVEMENTS		
PAVEMENT MATERIAL	HEAVY	LIGHT
PORTLAND CEMENT CONCRETE	6"	-
LIME STABILIZED SUBGRADE	8"	-

NOTE:

1. ALL PAVEMENT CONSTRUCTION SHALL BE PERFORMED IN ACCORDANCE TO THE "SUBSURFACE EXPLORATION, FOUNDATION AND PAVEMENT RECOMMENDATIONS PROPOSED LOCKHART CONDOMINIUM ESTATES", BY TERRADYNE ENGINEERING, INC., DATED MARCH 27, 2023.
2. ALL PAVEMENT SECTIONS SHOWN ON THE ABOVE TABLE SHALL SUPERCEDE ANY STANDARD DETAILS WITH RESPECT TO DEPTH OF MATERIALS ASSOCIATED WITH THIS PROJECT.
3. THE SUBGRADE SOILS SHOULD BE TESTED FOR SOLUBLE SULPHATE CONTENT PRIOR TO INSTALLATION OF THE LIME.

2 TYPICAL PAVEMENT SECTIONS

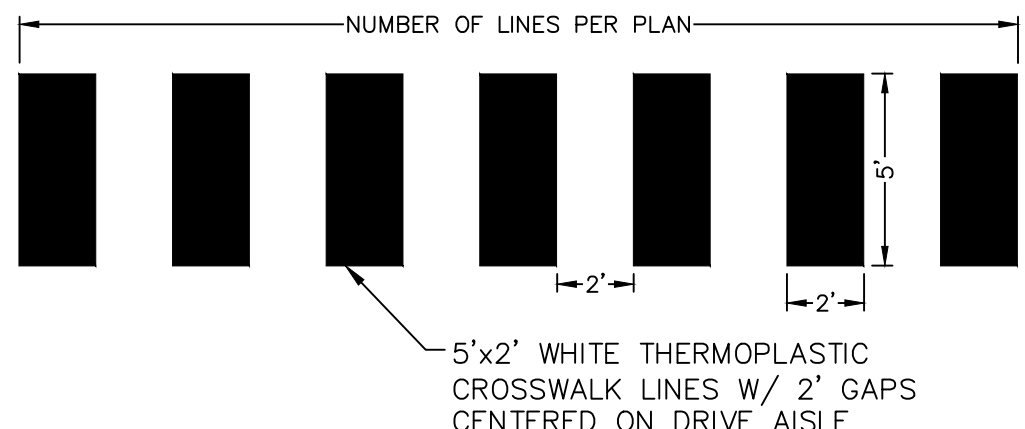

3 CROSS WALK MARKINGS

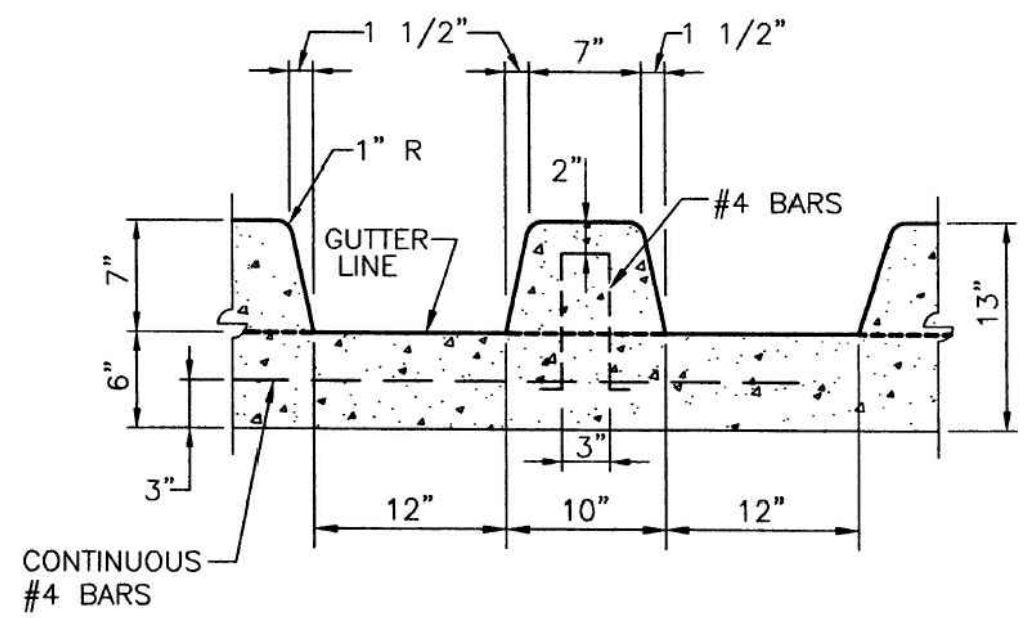

4 SAW TOOTH CURB
N.T.S.

LEGEND

- PROPERTY BOUNDARY
- P.U.E. PUBLIC UTILITY EASEMENT
- B.L. BUILDING LINE
- PROPOSED FIRE LANE
- EDGE OF EXISTING PAVEMENT
- OE OVERHEAD POWER LINE
- SD STORM DRAIN
- W WATER LINE
- WW WASTEWATER LINE
- PROPOSED FIRE HYDRANT
- A.D.A. RAMPS
- A.D.A. PARKING
- TRANSFORMER
- WATER METER
- WATER VALVE
- WASTEWATER MANHOLE
- CLEAN OUT
- BENCHMARK
- O.P.R.C.C.T. OFFICIAL PUBLIC RECORDS OF COMAL COUNTY, TEXAS
- M.P.R.C.C.T. MAP AND PLAT RECORDS OF COMAL COUNTY, TEXAS
- HEAVY DUTY ASPHALT PAVEMENT
- LIGHT DUTY ASPHALT PAVEMENT
- HEAVY DUTY CONCRETE PAVEMENT

KEY NOTES

- 1 CATCH CURB (SEE SHEET C4.1)
- 2 SPILL CURB (SEE SHEET C4.1)
- 3 4" MOUNTABLE CURB (SEE SHEET C4.1)
- 4 5' LONG CURB TRANSITION
- 5 4' CONC. SIDEWALK (SEE SHEET C4.1)
- 6 LIGHT DUTY FLEX PAVEMENT ±85 SY
- 7 HEAVY DUTY FLEX PAVEMENT ±815 SY
- 8 HEAVY DUTY RIGID PAVEMENT ±704 SY
- 9 ROCK RIP-RAP
- 10 PROP. MANHOLE ON EXIST. WWTR LINE
- 11 PROP. MASTER WATER METER & CONNECTION TO EXIST. WATER LINE
- 12 PROP. DETENTION BASIN (SEE SHEET C6.2)
- 13 DRAINAGE SWALE
- 14 PEDESTRIAN CROSS WALK (SEE DETAIL 3) WITH ADA RAMPS
- 15 24" STORM CULVERT (SEE SHEET C6.0)
- 16 8" WATER SERVICE LINE (SEE SHEET C7.0)
- 17 8" WASTEWATER LINE (SEE SHEET C7.0)
- 18 MAILBOX PAD (SEE SHEET C4.1)
- 19 SAWTOOTH CURB
- 20 CONCRETE LINED DIVERSION CHANNEL
- 21 5' CONCRETE SIDEWALK PER TxDOT
- 22 4' SIDEWALK DRAINS (5)
- 23 PROPOSED FIRE HYDRANT
- 24 12" HDPE STORM DRAIN (SEE SHEET C6.0)
- 25 STOP SIGN
- 26 133 LF CONCRETE VALLEY GUTTER (SEE SHEET C4.1)
- 27 TURF REINFORCING MAT
- 28 TYPE B TxDOT PED RAIL (SEE SHEET C4.1)
- # PARKING COUNT

THE LOCATION OF ALL EXISTING UNDERGROUND UTILITIES ARE SHOWN IN APPROXIMATE LOCATIONS ONLY. THE CONTRACTOR SHALL DETERMINE THE EXACT LOCATION OF ALL EXISTING UTILITIES BEFORE COMMENCING WORK. THE CONTRACTOR WILL AGREE TO BE FULLY RESPONSIBLE FOR ANY AND ALL DAMAGES WHICH MIGHT BE INCURRED BY THEIR FAILURE TO EXACTLY LOCATE AND PRESERVE ANY AND ALL UNDERGROUND UTILITIES, STRUCTURES OR FACILITIES. CONTRACTOR SHALL NOTIFY ENGINEER OF ANY DISCREPANCIES 24- HOURS PRIOR TO COMMENCING CONSTRUCTION.

290 S. CASTELL AVE., STE. 100
NEW BRAUNFELS, TX 78130
TBPELS FIRM F-10961
TBPELS FIRM 1053600

HMT
ENGINEERING & SURVEYING

CHRISTOPHER P. VAN HERDE
93047
LICENSED PROFESSIONAL ENGINEER
Chris Van Heerde, P.E.

07/28/2025

**OVERALL SITE PLAN &
DIMENSIONAL CONTROL**
GREENWOOD BOUTIQUE
CONDOMINIUM ESTATES

NO.	REVISION	DESCRIPTION	DATE

DATE: **JULY 2025**
DRAWN BY: **JMM**
DESIGNED BY: **RCD**
REVIEWED BY: **CWH**

HMT PROJECT NO.:
460.001

SHEET
C4.0