

# SPRAGUE

LINCOLN COUNTY WASHINGTON  
REDUCED 1917  
CL. Thompson Comm. Eng.  
REVISED JUNE 1943  
CLARENCE E. SIMPSON ENGINEERS  
SPokane, Washington

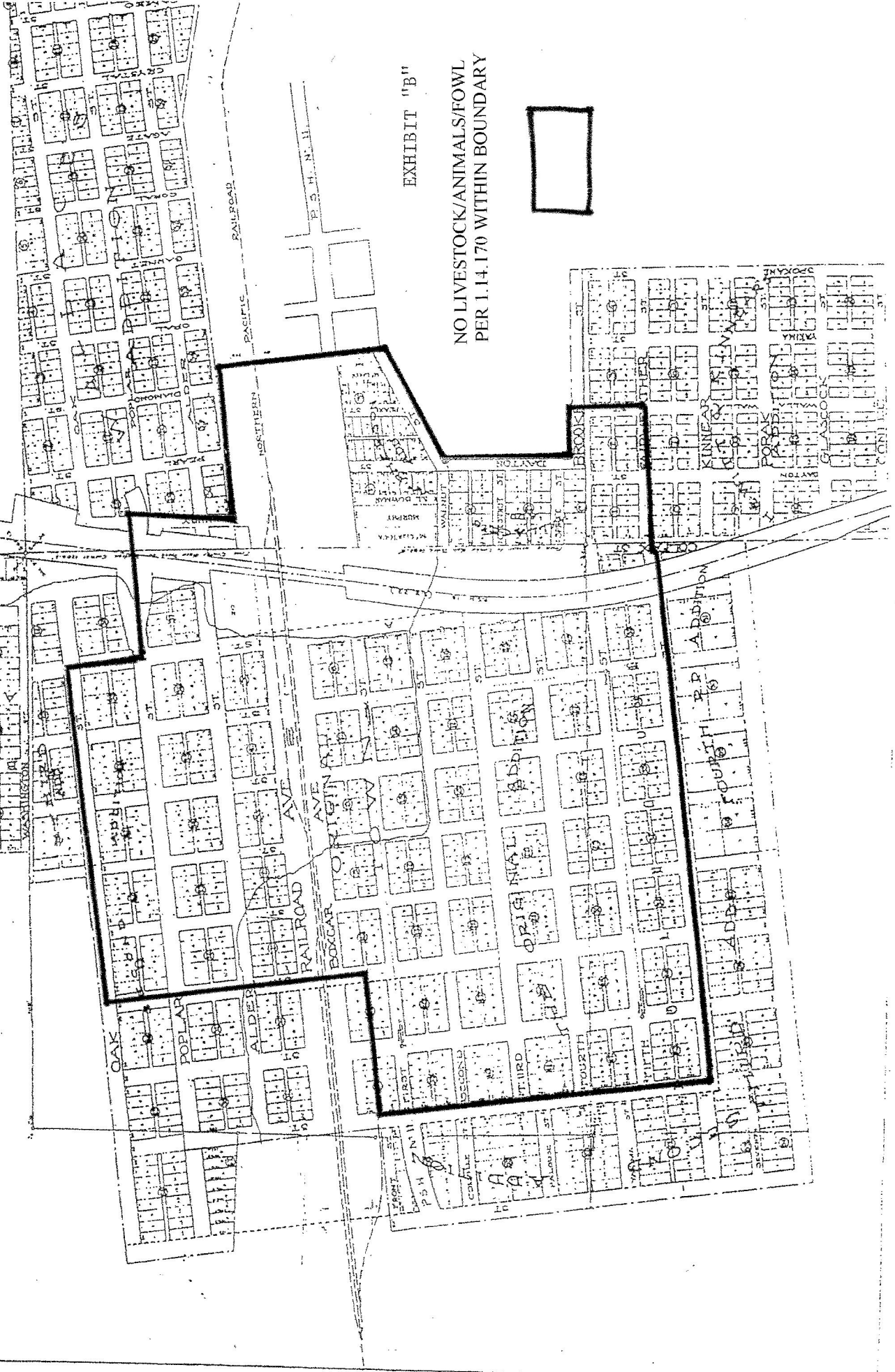

EXHIBIT "B"  
NO LIVESTOCK/ANIMALS/FOWL  
PER I. 14.170 WITHIN BOUNDARY

