

# 1-5/8" POWER DIVIDERS (available in 2:1, 3:1, and 4:1)

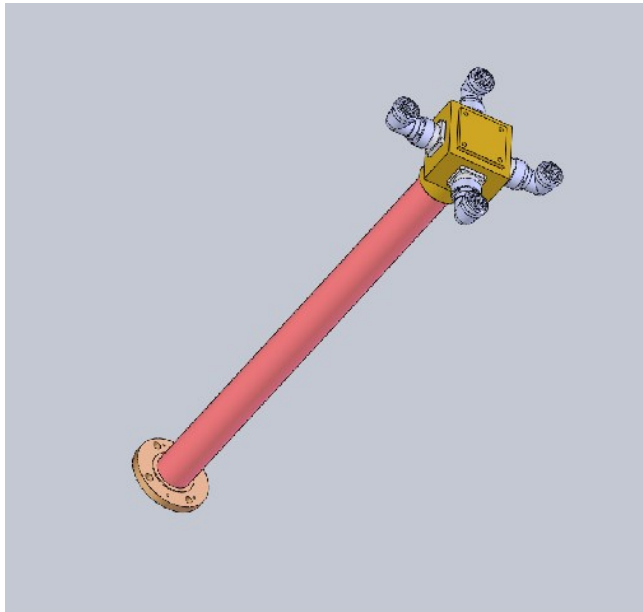

P-Cube Power Dividers are constructed of copper and aluminum and are pressure tight, so are suitable for outside installations. The output ports can rotate 360° for optimal interface with feed lines. This is combined with low VSWR, typically 1.04:1.

## FEATURES

- Copper inners / Aluminum outers
- Pressure-tight to 15 PSIG
- Available in 2:1, 3:1, and 4:1 configurations
- Low VSWR over entire band
- High power
- Variable output flange angle

## SPECIFICATIONS

<b>INPUT PORT:</b>	1-5/8" EIA (Female)
<b>INPUT Z<sub>0</sub></b>	50 ohms
<b>RETURN LOSS:</b>	30 dB minimum
<b>PHASE BALANCE:</b>	Equal ± 2°
<b>AMPLITUDE BALANCE:</b>	Equal ± .1 dB

## PART NUMBERS

## A

## INPUT POWER

FM	UHF	OUTPUTS	FM	UHF	FM	UHF
CQ215-002	CQ216-002	2	60"	24"	4 kW	2 kW
CQ215-003	CQ216-003	3	60"	24"	6 kW	3 kW
CQ215-004	CQ216-004	4	60"	24"	8 kW	4 kW

