

95PR2865

NRE
1-10-96



BUILDING-STRUCTURE INVENTORY FORM

NYS OFFICE OF PARKS, RECREATION
& HISTORIC PRESERVATION
DIVISION FOR HISTORIC PRESERVATION
(518) 474-0479

FOR OFFICE USE ONLY
UNIQUE SITE NO. 07901.000037
QUAD _____
SERIES _____
NEG. NO. _____

YOUR NAME: Sallie Sypher DATE: 12/11/95
121 Main Street
YOUR ADDRESS: Brewster NY 10509 TELEPHONE: (914) 278-7209
ORGANIZATION (if any): Putnam County Historian's Office

IDENTIFICATION

1. BUILDING NAME(S): Belden House and Farm Buildings
2. COUNTY: Putnam TOWN/CITY: Carmel VILLAGE: --
3. STREET LOCATION: NW of intersection of US 6 and Belden Road
4. OWNERSHIP: a. public ☒ b. private ☐ NYC Dept. of Environmental Protec-
5. PRESENT OWNER: New York City ADDRESS: tion, 465 Columbus Ave., Katonah
6. USE: Original: Home and farm Present: office (first floor) NY 10595
7. ACCESSIBILITY TO PUBLIC: Exterior visible from public road: Yes ☒ No ☐
Interior accessible: Explain first floor office accessible to
those applying for fishing permits

DESCRIPTION

8. BUILDING MATERIAL: a. clapboard ☒ b. stone ☐ c. brick ☐ d. board and batten ☐
e. cobblestone ☐ f. shingles ☐ g. stucco ☐ other: _____
9. STRUCTURAL SYSTEM: a. wood frame with interlocking joints ☐
(if known) b. wood frame with light members ☐
c. masonry load bearing walls ☐
d. metal (explain) _____
e. other _____
10. CONDITION: a. excellent ☐ b. good ☐ c. fair ☒ d. deteriorated ☐
11. INTEGRITY: a. original site ☒ b. moved ☐ if so, when? _____
c. list major alterations and dates (if known): _____

House probably incorporates elements of late 18th century farmhouse. (Beldens are shown on this site on 1788 Erskine-Dewitt map.) Large farmhouse probably constructed in 1830s or 1840s. In 1870s, roof was raised and house was expanded & embellished in
12. PHOTO: vernacular Gothic Revival style. 13. MAP:

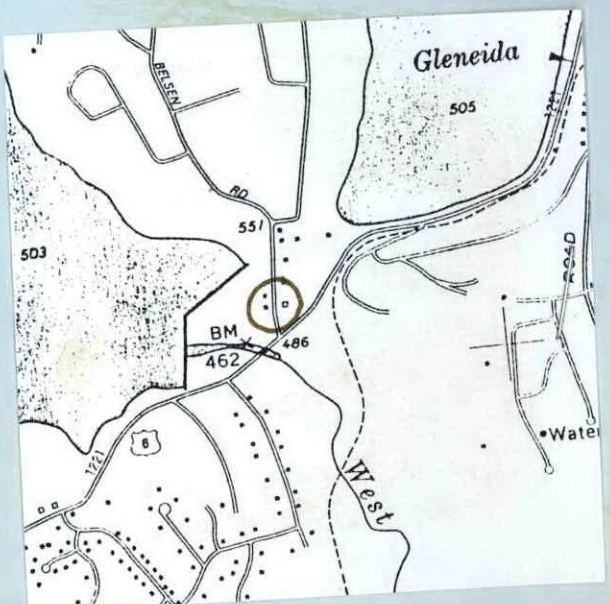

14. THREATS TO BUILDING: a. none known ☐ b. zoning ☐ c. roads ☐
 d. developers ☐ e. deterioration ☒
 f. other: NYC cannot maintain house and property. Roof, which was
15. RELATED OUTBUILDINGS AND PROPERTY: leaking, is now covered by tarpaulin.
 a. barn ☒ b. carriage house ☒ c. garage ☐
 d. privy ☐ e. shed ☒ f. greenhouse ☐
 g. shop ☐ h. gardens ☐ ice house ☒
 i. landscape features: lawn to road at front
 j. other: NYC West Branch Reservoir on one side
16. SURROUNDINGS OF THE BUILDING (check more than one if necessary):
 a. open land ☒ b. woodland ☒
 c. scattered buildings ☐
 d. densely built-up ☐ e. commercial ☐
 f. industrial ☐ g. residential ☒
 h. other: reservoir
17. INTERRELATIONSHIP OF BUILDING AND SURROUNDINGS:
 (Indicate if building or structure is in an historic district) Belden farm site includes a barn, carriage house, ice house and shed in addition to the main house. It is a complete farmstead, a rarity in Putnam County. The site, adjacent to the West Branch Reservoir, is a picturesque entrance to the hamlet of Carmel.
18. OTHER NOTABLE FEATURES OF BUILDING AND SITE (including interior features if known):
 The house is a fine example of a vernacular farmhouse "modernized" in the Gothic Revival style. The Gothic Revival influence can be seen in the steeply pitched roof, pointed arches on windows and doors, cross gables, verge boards (gable trim), and bay windows. The interior is more elaborate with marble fireplaces (of different colored marble), fancy millwork and fine plaster embellishments.
 The interior is in good condition.

SIGNIFICANCE

19. DATE OF INITIAL CONSTRUCTION: probably late 18th century

ARCHITECT: _____

BUILDER: _____

20. HISTORICAL AND ARCHITECTURAL IMPORTANCE:

The farm site was home to some of Carmel's most prominent citizens from before the Revolution until the family left the area. Thomas Belden was the first of the family in Carmel, arriving from Connecticut sometime before 1762. He was a land agent for the Philipse family, who held the entire Highland Patent (Putnam County) from the Crown. Thomas was one of two commissioners who divided land among the heirs of Philip Philipse in 1771 and was an executor of the will of Adolph Philipse, one of Philip's sons. Sometime before 1762, he leased his farm from Philip Philipse, and its site, where the Belden house now stands, shows on Revolutionary War Erskine-Dewitt maps. (continued on next page)

21. SOURCES: See below

22. THEME:



Historical and Architectural Importance - 2

Amos Belden (1764-1830) succeeded his uncle Thomas as agent of the Philippses and tenant on the farm which he bought from Frederick Philipse in 1804. When he succeeded his uncle as agent is not known, but Amos was working for the Philippses by 1802 when he was collecting rents for them and assisting in a resurvey of one of their lots. Amos was active in Carmel's town affairs since its incorporation in 1795 as school commissioner and inspector, pound keeper, and pathmaster, positions that were seen as civic duties.

That he was a substantial citizen is clear from the record. He is listed as an attorney in the court roll of 1813 and, along with Samuel Gouverneur of Philipstown and others, was an incorporator of the Philipstown Turnpike in 1815, the most ambitious enterprise in Putnam County in its day. Amos and his sons were frequently successful plaintiffs in the Court of Common Pleas after 1813, gaining judgments in their favor for unredeemed promissory notes that they held from many prominent citizens.

Amos and his wife, Elizabeth Isaac of Bedford, New York, had eleven children, many of whom died without issue. One of the sons, G. Mortimer Belden (1826-1873) was later owner of the house and was one of Carmel's leading citizens. In 1860, he was a founder and warden of the Episcopal Church in Lake Mahopac. In 1864, when the Board of Supervisors auctioned \$75,000 in bonds, Mortimer Belden bought them all. He was the first president of the Putnam County National Bank from 1865 to 1869 and was one of two "chief donors" of the newly formed Carmel Library Association, of which he was a director. Mortimer was responsible for the modernization in the popular Gothic style, giving what had been a simple, vernacular farm house an appearance more in keeping with his position in society.

When Mortimer died, the house stayed in the family of his widow Isabella Best and was later sold to the City of New York as part of the watershed of the West Branch. In the late 19th century, it was lived in by Thomas and Jennie Manning. Thomas Manning was employed by the NYC Department of Public Works and had charge of Boyd's Reservoir and those in the Town of Southeast. In recent years, the house has been used by the NYC Department of Water Supply as an office to which the public goes to be issued permits to fish in the City's reservoirs.



Bibliography

Pelletreau, William S. *History of Putnam County, New York*.
Philadelphia: W. W. Preston & Co. 1886

Erskine-DeWitt Map (1778), Number J-2, New-York Historical Society

"Map of Putnam County, New-York" by R.E. O'Conner, 1854.

"Town of Carmel" in Beers, F.W. *Atlas of New-York and Vicinity*. New
York: F.W. Beers, A.D. Ellis & G.G. Soule. 1867.

"Map of Putnam County, New York" by Thomas Reed. Carmel, 1876.

Early Settlers of New York State: their Ancestors and Descendents, II.
Edited by Janet Wethy Foley. Baltimore: Genealogical Publishing Co.
1993.

Office of the Putnam County Clerk
Deeds
Mortgages

Office of the Putnam County Historian
Records of the Court of Common Pleas, Series 13
Records of the Court of Oyer and Terminer, Series 18
Judgments, Series 45
Records of the Supreme Court, Series 47

Genealogical files of Carmel Town Historian

Belden House



Belden House before its Gothic Revival transformation



Outbuildings: ice house right behind spruce; unidentified building on left



1 Carriage house north of main house



1 Barn across Belden Road, east of main house

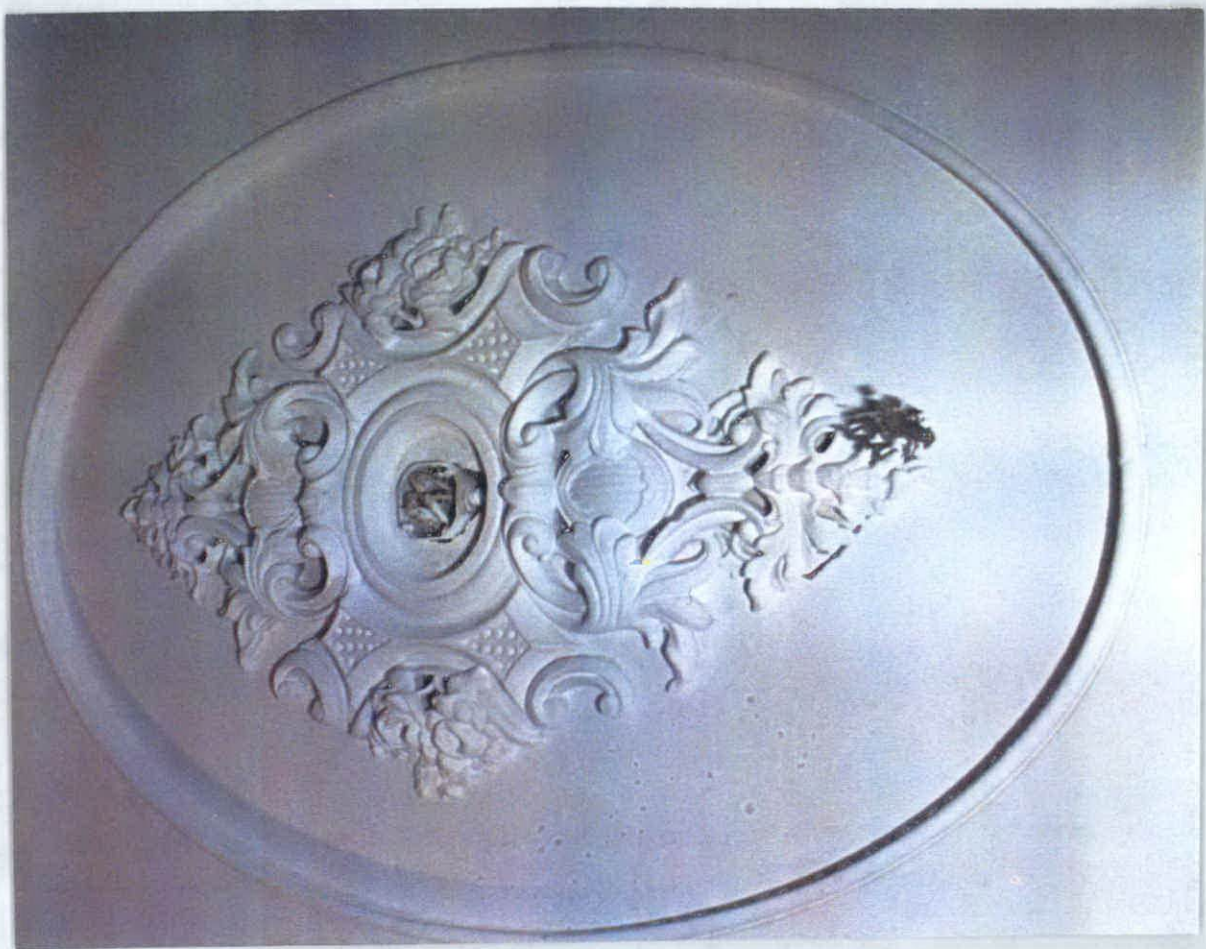



STATE/NATIONAL REGISTERS OF HISTORIC PLACES ELIGIBILITY COMMENTS

PROJECT REF: 95PR2865

DATE: January 10, 1996

PROPERTY: Belden House and Farm

USN: 07901.000037

ADDRESS: US 6 and Belden Road

MCD: Carmel

COUNTY: Putnam

I. ☐ Property is individually listed on SR/NR:

Name of listing: _____

☐ Property is a contributing component of a SR/NR district:

Name of district: _____

II. ☒ Property meets eligibility criteria.

☐ Property contributes to a district which appears to meet eligibility criteria. Pre SRB: ☒ Post SRB: _____

SRB date

Criteria for Inclusion in the National Register:

- A. ☐ Associated with events that have made a significant contribution to the broad patterns of our history;
- B. ☐ Associated with the lives of persons significant in our past;
- C. ☒ Embodies the distinctive characteristics of a type, period or method of construction; or represents the work of a master; or possess high artistic values; or represents a significant and distinguishable entity whose components may lack individual distinction;
- D. ☐ Have yielded, or may be likely to yield information important in prehistory or history.

STATEMENT OF SIGNIFICANCE:

The Belden House and Farm is both architecturally and historically significant. The property includes the main house, a barn, carriage house, ice house, and shed. Historically the property is significant due to its association with the Belden family, a family that played an important role in the history of the Town of Carmel. Architecturally the property is an intact example of a complete farmstead, a rarity in the area. The main house is an outstanding intact example of the Gothic Revival style of architecture. The main house, first constructed in the 1830s or 1840s, was remodeled in the 1870s. The roof was raised and house was expanded and embellished with Gothic Revival details. The house is a centered gable form with a steeply pitched roof, steep cross gables and a prominent central cross gable. The gables are decorated with wooden scrollwork vergeboards with Gothic motifs. It is a two story building with wood siding and a one-story porch, arched dormers, a Tudor entranceway, segmental arched windows on the first story, an oriel window beneath the central cross gable, and

rectangular two over two windows with articulated mullions on the second story. The interior is elaborate and possesses several marble fireplaces, fancy millwork, and fine plaster embellishments.

Any questions concerning this eligibility should be directed to Victor J. DiSanto, Ph.D. at (518)237-8643 ext. 291.