

# 1717 EAST DONALD DRIVE

PHOENIX, ARIZONA 85024



TTR INDUSTRIAL PARK  
7TH STREET & DEER VALLEY DRIVE

AVAILABLE NOVEMBER

**FOR LEASE**

12,480 SQUARE FEET

\$1.50 NNN

**Todd Hamilton**

Managing Partner/Designated Broker

602.909.8759

todd@citywidecre.com

2122 East Highland Avenue, Suite 225

Phoenix, Arizona 85016

602.313.1000 • citywidecre.com

**Chad Kirkorsky**

Partner

480.330.2824

chad@citywidecre.com

**citywide**  
COMMERCIAL REAL ESTATE

All information furnished is from sources deemed reliable. No representation is made as to the accuracy thereof and it is submitted subject to errors, omissions, changes, or withdrawal without notice and to any special listings conditions, including the rate and manner of payment of commissions for particular offerings imposed by principals or agreed to by the company, the terms of which are available to interested principals or brokers. All dimensions are approximate. Owner and/or Broker make no representations expressed or implied as to the accuracy of floor plan/site plan dimensions.

# FLOORPLAN DETAILS

## BUILD-OUT OPTION

- 1,419 Square Foot Office Area
- 2 Offices, Reception, Break Room, Conference Room, 2 Restrooms

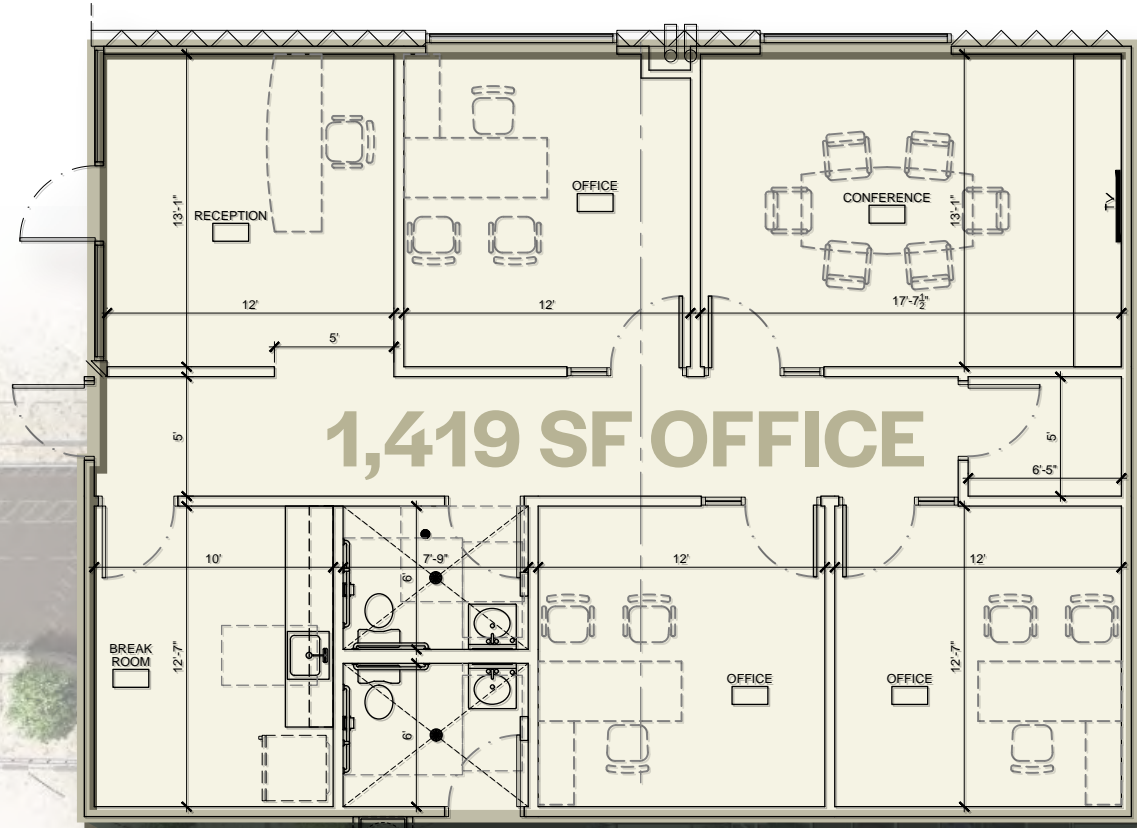

WH



# PROPERTY SUMMARY

## SITE FEATURES

- Fully Insulated Warehouse
- Clear Span Construction
- 8,761 & 3,544 Square Foot Yards
- 2 Entrances, Donald Drive & 17th Place



39,287 SF  
TOTAL LOT SIZE



12,480 SF  
BUILDING SIZE



800 AMP  
120/240 VOLT  
3 PHASE



20' CLEAR  
HEIGHT



3 - 12' X 14' GRADE  
LEVEL DOORS



2 SECURED  
PAVED YARDS



A-1, CITY OF PHOENIX  
ZONING

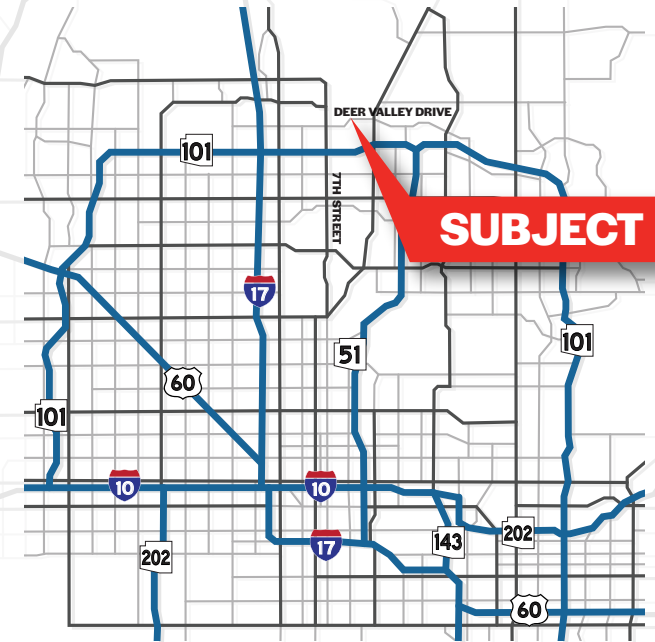

## AREA AMENITIES

- Qualified Opportunity Zone
- Only 15 Minutes from TSMC
- Easy Access to Loop 101, I-17, & 51 Freeways
- Minutes from Deer Valley Airport
- Numerous Restaurants & Shopping Centers Nearby

## FOR MORE INFORMATION

### Chad Kirkorsky

Partner  
480.330.2824  
chad@citywidecre.com

### Todd Hamilton

Managing Partner/Designated Broker  
602.909.8759  
todd@citywidecre.com