

FOR LEASE

1413 EAST JACKSON STREET
PHOENIX, ARIZONA 85034



18,253 SQUARE FEET

\$0.85 PER SQUARE FOOT, MODIFIED GROSS

12' x 14' Grade Level Door

Two - 10' x 10' Truckwell Loading Positions

250 Amps, Single Phase Power

A-2 Zoning, City of Phoenix

HVAC Office, Evap Warehouse

Open Office, 2 Restrooms, Break Area

Nick DePaul

Vice President

480.414.3818

nick@citywidecre.com

Todd Hamilton, SIOR, CCIM

Managing Partner/Designated Broker

602.909.8759

todd@citywidecre.com

citywide
COMMERCIAL REAL ESTATE

2122 EAST HIGHLAND AVENUE, SUITE 225 • PHOENIX, ARIZONA 85016 • 602.313.1000 • CITYWIDECRE.COM

All information furnished is from sources deemed reliable. No representation is made as to the accuracy thereof and it is submitted subject to errors, omissions, changes, or withdrawal without notice and to any special listings conditions, including the rate and manner of payment of commissions for particular offerings imposed by principals or agreed to by the company, the terms of which are available to interested principals or brokers. All dimensions are approximate. Owner and/or Broker make no representations expressed or implied as to the accuracy of floor plan/site plan dimensions.

FOR LEASE

1413 EAST JACKSON STREET
PHOENIX, ARIZONA 85034

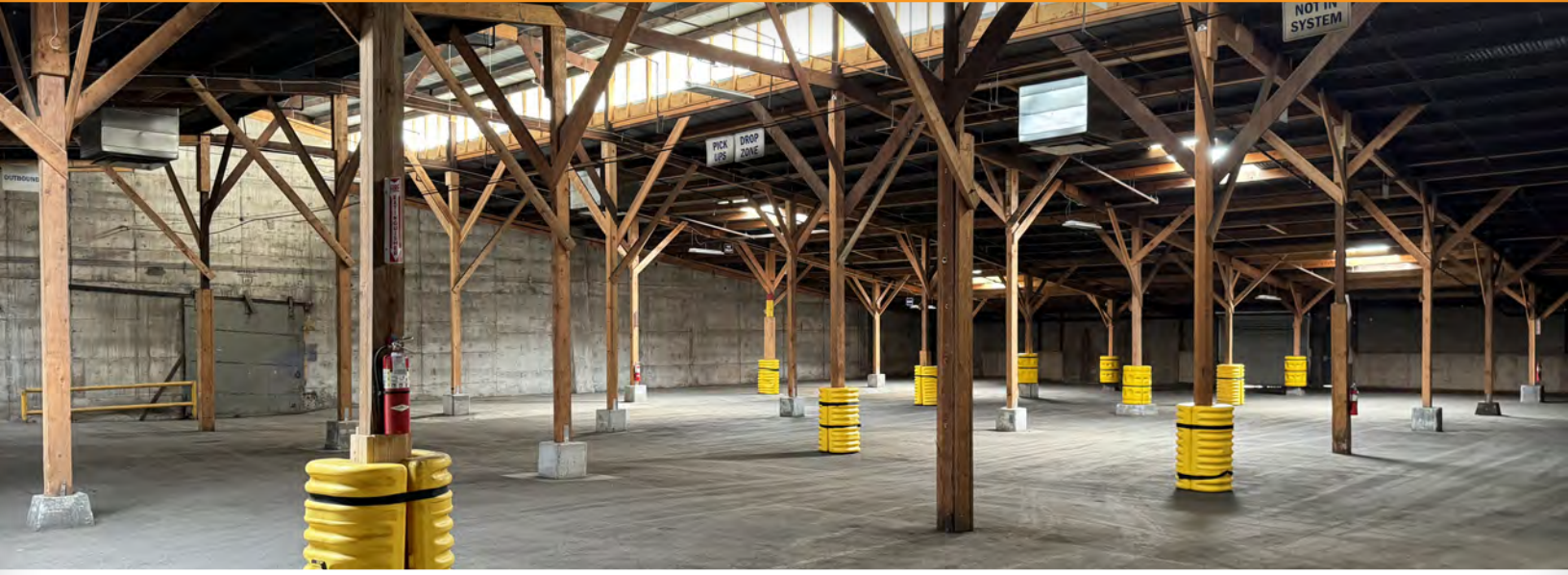

Nick DePaul
Vice President
480.414.3818
nick@citywidecre.com

Todd Hamilton, SIOR, CCIM
Managing Partner/Designated Broker
602.909.8759
todd@citywidecre.com

citywide
COMMERCIAL REAL ESTATE

2122 EAST HIGHLAND AVENUE, SUITE 225 • PHOENIX, ARIZONA 85016 • 602.313.1000 • CITYWIDECRE.COM

FOR LEASE

1413 EAST JACKSON STREET
PHOENIX, ARIZONA 85034

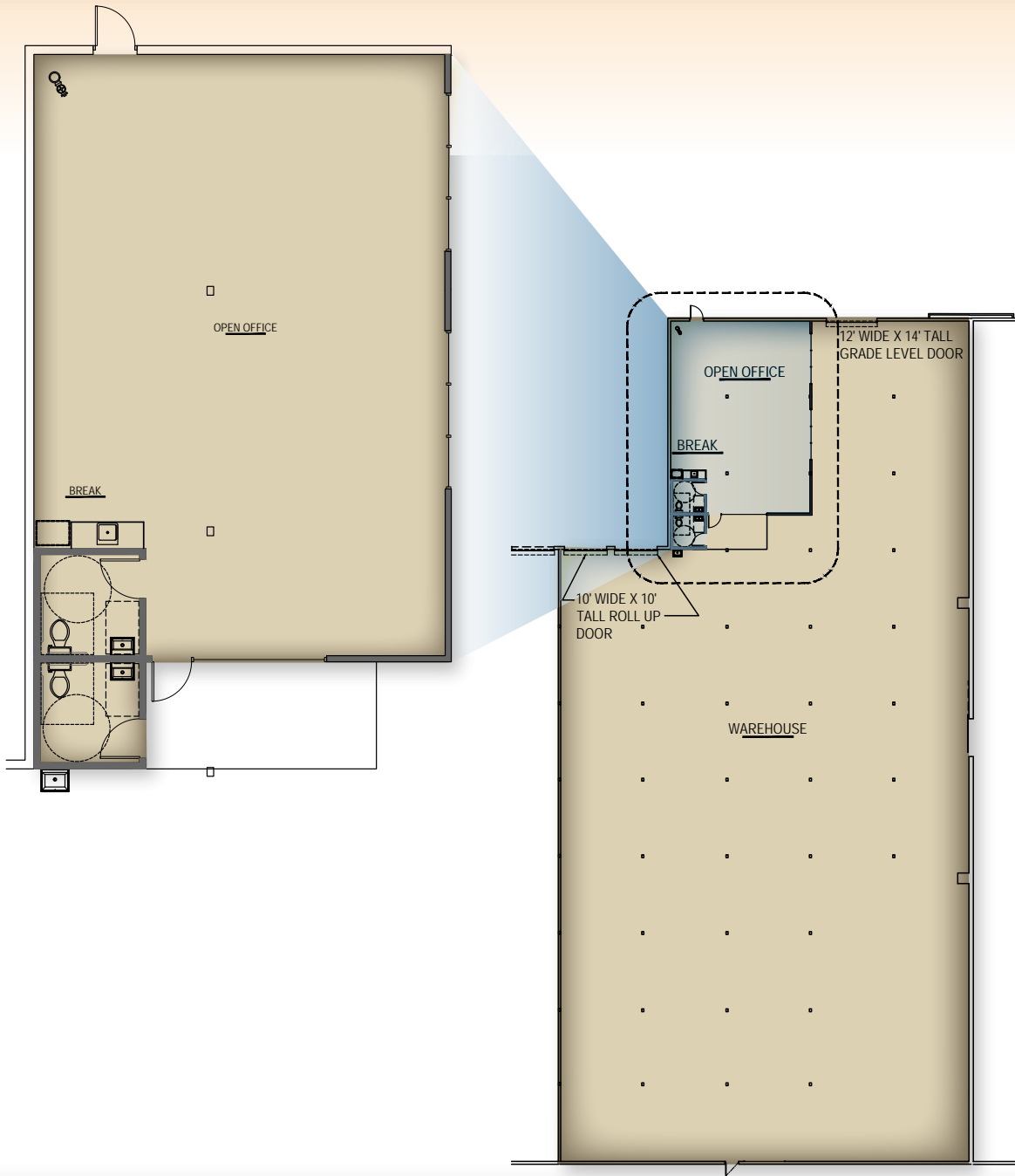

Nick DePaul

Vice President

480.414.3818

nick@citywidecre.com

Todd Hamilton, SIOR, CCIM

Managing Partner/Designated Broker

602.909.8759

todd@citywidecre.com

citywide
COMMERCIAL REAL ESTATE

2122 EAST HIGHLAND AVENUE, SUITE 225 • PHOENIX, ARIZONA 85016 • 602.313.1000 • CITYWIDECRE.COM