

FOR SALE OR LEASE



1612 EAST SOUTHERN AVENUE
PHOENIX, ARIZONA 85040

PROPERTY OVERVIEW

- \$800,000 Sales Price (\$166/Square Foot)
- \$13 per Square Foot Lease Rate, NNN
- +/- 4,814 Square Feet
- Built in 1955
- C-2 Zoning
- 2 New HVAC Units
- 14 Parking Spaces, Additional Parking in Secured Rear Yard
- Owner/User, Potential Seller Carryback

This freestanding building is a great owner user opportunity. The space is currently divided into two suites, although devising wall can be removed back to the original floorplan. The building includes two restrooms, a shower, storage room, back office, rear large metal double security doors, front glass double doors, additonal single door at front entrance. Great street visibility, busy intersection with high foot traffic and major anchors in the same intersection.

2122 East Highland Avenue, Suite 225 • Phoenix, Arizona 85016 • 602.313.1000 • citywidecre.com

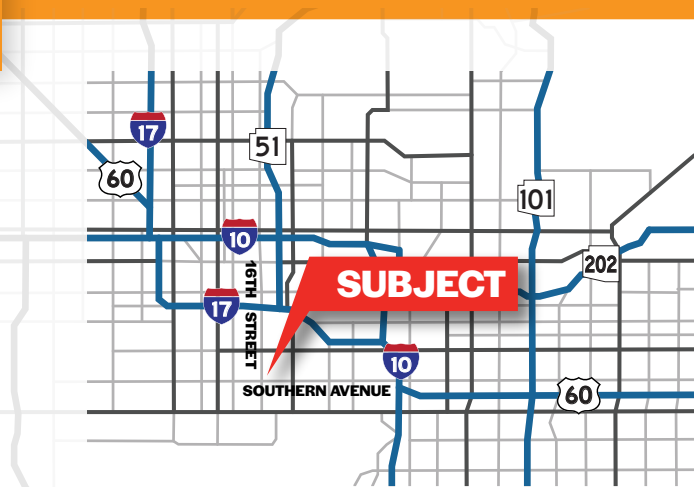

Tanya Tucker

Sales & Leasing

520.272.0012

tanya@citywidecre.com

All information furnished is from sources deemed reliable. No representation is made as to the accuracy thereof and it is submitted subject to errors, omissions, changes, or withdrawal without notice and to any special listings conditions, including the rate and manner of payment of commissions for particular offerings imposed by principals or agreed to by the company, the terms of which are available to interested principals or brokers. All dimensions are approximate. Owner and/or Broker make no representations expressed or implied as to the accuracy of floor plan/site plan dimensions.

citywide
COMMERCIAL REAL ESTATE

FOR SALE OR LEASE



FOR MORE INFORMATION

Tanya Tucker

Sales & Leasing
520.272.0012
tanya@citywidecre.com

2122 East Highland Avenue, Suite 225
Phoenix, Arizona 85016
602.313.1000 • citywidecre.com