

2950 NORTH 30TH AVENUE PHOENIX, ARIZONA 85017

AVAILABILITY OVERVIEW

Lease Rate	\$1.05 SF/month (MG)
Available SF	5,500 SF
Loading	12' x 10' Garage Door
Clear Height	14 ft
Power	3 Phase Heavy
Cooling	Evaporative
Zoning	A-2

PROPERTY HIGHLIGHTS

- Private Fenced Yard
- Open Reception/Showroom
- 4 Private Offices



Adam Shteir

Partner
602.769.0521
adam@citywidecre.com

Jack Scanlan

Associate Broker
602.672.4546
jack@citywidecre.com

2122 East Highland Avenue, Suite 225, Phoenix, AZ 85016 • 602.313.1000 • citywidecre.com

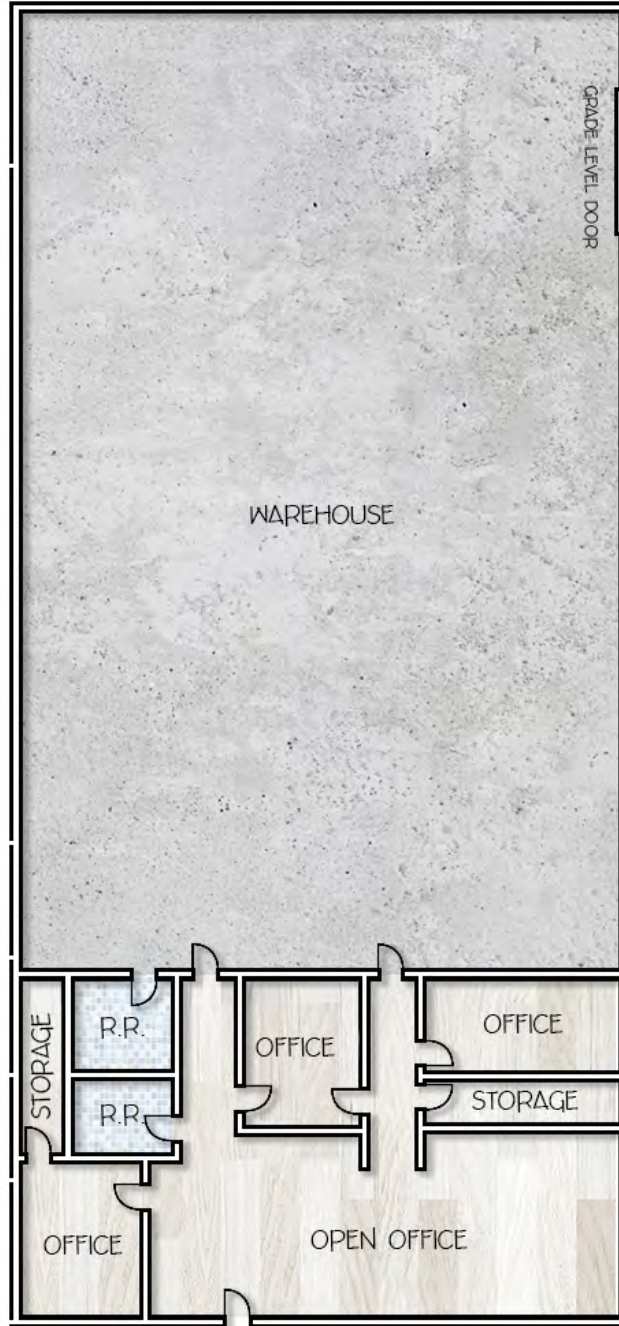

Adam Shteir

Partner
602.769.0521
adam@citywidecre.com

Jack Scanlan

Associate Broker
602.672.4546
jack@citywidecre.com

2122 East Highland Avenue, Suite 225, Phoenix, AZ 85016 • 602.313.1000 • citywidecre.com