

FOR LEASE

426-430 NORTH DYSART ROAD

GOODYEAR, ARIZONA 85338



AVAILABILITY OVERVIEW:

| | |
|--------------------|------------------------------------|
| AVAILABLE SUITES: | 918 SF - 1,275 SF |
| LEASE RATE: | \$1.68 SF/MONTH, MG |
| ZONING: | C-2 |
| POWER: | 100 AMP, 3 PHASE |
| CLEAR HEIGHT: | 15' |
| WAREHOUSE COOLING: | EVAPORATIVE COOLED |
| LOADING: | 10'x12' GRADE LEVEL DOORS |
| FEATURES: | BUILT IN 2018, EASY ACCESS TO I-10 |

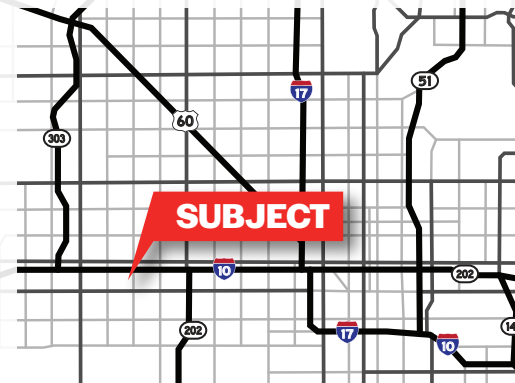

KEN SCHAWL

SALES & LEASING

623.326.3755

ken@citywidecre.com

CITYWIDE COMMERCIAL REAL ESTATE

2122 EAST HIGHLAND AVENUE, SUITE 225 • PHOENIX, ARIZONA 85016

*All information furnished is from sources deemed reliable. No representation is made as to the accuracy thereof and it is submitted subject to errors, omissions, changes, or withdrawal without notice and to any special listings conditions, including the rate and manner of payment of commissions for particular offerings imposed by principals or agreed to by the company, the terms of which are available to interested principals or brokers. All dimensions are approximate. Owner and/or Broker make no representations expressed or implied as to the accuracy of floor plan/site plan dimensions.

citywide
COMMERCIAL REAL ESTATE

FOR LEASE

426-430 NORTH DYSART ROAD
GOODYEAR, ARIZONA 85338

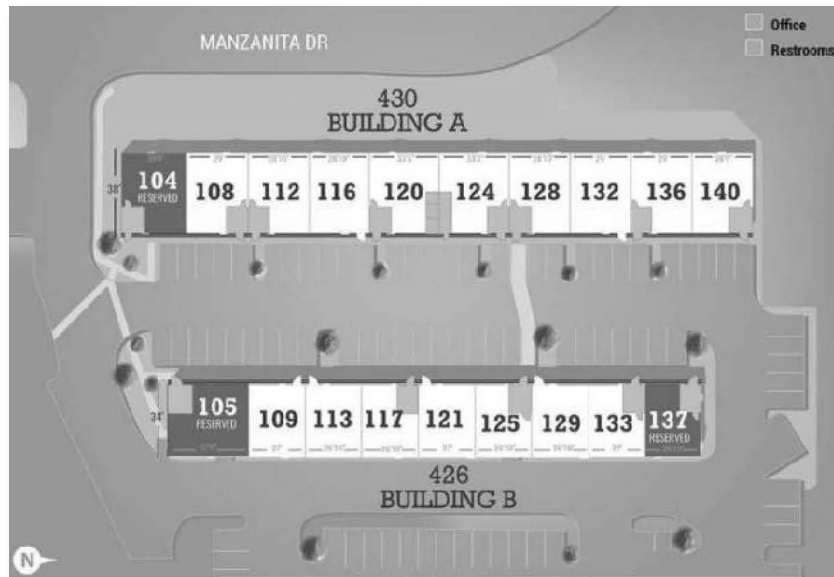

KEN SCHAWL
SALES & LEASING
623.326.3755
ken@citywidecre.com

CITYWIDE COMMERCIAL REAL ESTATE
2122 EAST HIGHLAND AVENUE, SUITE 225 • PHOENIX, ARIZONA 85016

*All information furnished is from sources deemed reliable. No representation is made as to the accuracy thereof and it is submitted subject to errors, omissions, changes, or withdrawal without notice and to any special listings conditions, including the rate and manner of payment of commissions for particular offerings imposed by principals or agreed to by the company, the terms of which are available to interested principals or brokers. All dimensions are approximate. Owner and/or Broker make no representations expressed or implied as to the accuracy of floor plan/site plan dimensions.

citywide
COMMERCIAL REAL ESTATE