



AGENDA

LENAWEE COUNTY ROAD COMMISSION 2017 TOWNSHIP ANNUAL MEETING

I. Welcome

1. Introductions
2. 2016 Maintenance Cost
3. 2016 Project Cost Report
4. Past years Project Map 2009 to 2016
5. Engineering Update
6. 2017 Township Projects List from Foreman

Blissfield Township - 35

2016 Local Maintenance

Work Description	Amount Spent
Culvert Inspection	\$1,008.28
Traffic Count	\$344.28
Soil Erosion	\$9,740.16
Foreman Patrol	\$11,030.08
Dust Control	\$1,354.54
Shoulder Maintenance	\$210.88
Tree and Brush Removal	\$170.50
Drainage and Ditching	\$1,686.31
Grass and Weed control	\$2,126.96
Winter Maintenance Operation	\$14,584.16
Winter Maintenance Patrol	\$918.02
Traffic Signs	\$1,492.88
Pavement Marking	\$806.40
Scraping	\$514.57
Shoulder Removal	\$175.17
Asphalt Paving	\$2,631.71
Cold Patching	\$2,258.15
Total	\$51,053.05

Salt Brine Order

2015		2016		2017		2018	
Order	Township	Order	Township	Order	Township	Order	Township
1	34-Palmyra	1	15-Tecumseh	1	25-Ridgeway	1	33-Madison
2	22-Rome	2	12-Cambridge	2	35-Blissfield	2	24-Raisin
3	31-Hudson	3	32-Dover	3	11-Woodstock	3	42-Seneca
4	23-Adrian	4	36-Deerfield	4	13-Franklin	4	23-Adrian
5	42-Seneca	5	21-Rollin	5	41-Medina	5	31-Hudson
6	24-Raisin	6	14 - Clinton	6	44-Ogden	6	22-Rome
7	33-Madison	7	43-Fairfield	7	16-Macon	7	34-Palmyra
8	16-Macon	8	34-Palmyra	8	15-Tecumseh	8	25-Ridgeway
9	44-Ogden	9	22-Rome	9	12-Cambridge	9	35-Blissfield
10	41-Medina	10	25-Ridgeway	10	32-Dover	10	11-Woodstock
11	13-Franklin	11	23-Adrian	11	36-Deerfield	11	13-Franklin
12	11-Woodstock	12	42-Seneca	12	21-Rollin	12	41-Medina
13	35-Blissfield	13	24-Raisin	13	14 - Clinton	13	44-Ogden
14	25-Ridgeway	14	33-Madison	14	43-Fairfield	14	16-Macon
15	43-Fairfield	15	16-Macon	15	34-Palmyra	15	15-Tecumseh
16	14 - Clinton	16	44-Ogden	16	22-Rome	16	12-Cambridge
17	21-Rollin	17	41-Medina	17	31-Hudson	17	32-Dover
18	36-Deerfield	18	13-Franklin	18	23-Adrian	18	36-Deerfield
19	32-Dover	19	11-Woodstock	19	42-Seneca	19	21-Rollin
20	12-Cambridge	20	35-Blissfield	20	24-Raisin	20	14 - Clinton
21	15-Tecumseh	21	31-Hudson	21	33-Madison	21	43-Fairfield

TOTALS

 2nd Application of Brine

 May
 June
 July
 August

Blissfield Township 2016 Billing Summary

Project Number	Project Description	Est.	Contract Amount	Date	Invoice No.	Invoice Amount	Received	Balance
163501	Iffland Rd	3000	248,006.80	04/20/16	Advance		(86,802.38)	(86,802.38)
	Bradley to Twp Line & Blissfield to Bradley Asphalt Overlay	3150		08/03/16	100093	13,919.65		(72,882.73)
				08/17/16	100163	26,653.11		(46,229.62)
				10/18/16	100277	259.99		(45,969.63)
				11/16/16	100320	177,156.45		131,186.82
				11/23/16			(131,186.82)	0.00
				12/14/16	100361	3,117.37		3,117.37
				12/30/16			(3,117.37)	0.00
PROJECT SUMMARY			<u>248,006.80</u>			<u>221,106.57</u>	<u>(221,106.57)</u>	<u>0.00</u>
163502	Garno Rd	3193	84,136.70	07/20/16	Advance		(29,447.85)	(29,447.85)
	Wellsville to Blissfield Asphalt Overlay			08/17/16	100164	14,938.69		(14,509.16)
				10/18/16	100278	137.18		(14,371.98)
				11/16/16	100321	66,240.38		51,868.40
				11/23/16			(51,868.40)	0.00
				12/14/16	100362	395.10		395.10
				12/30/16			(395.10)	0.00
PROJECT SUMMARY			<u>84,136.70</u>			<u>81,711.35</u>	<u>(81,711.35)</u>	<u>0.00</u>
TOTALS FOR 2016 PROJECTS			<u>332,143.50</u>			<u>302,817.92</u>	<u>(302,817.92)</u>	<u>0.00</u>

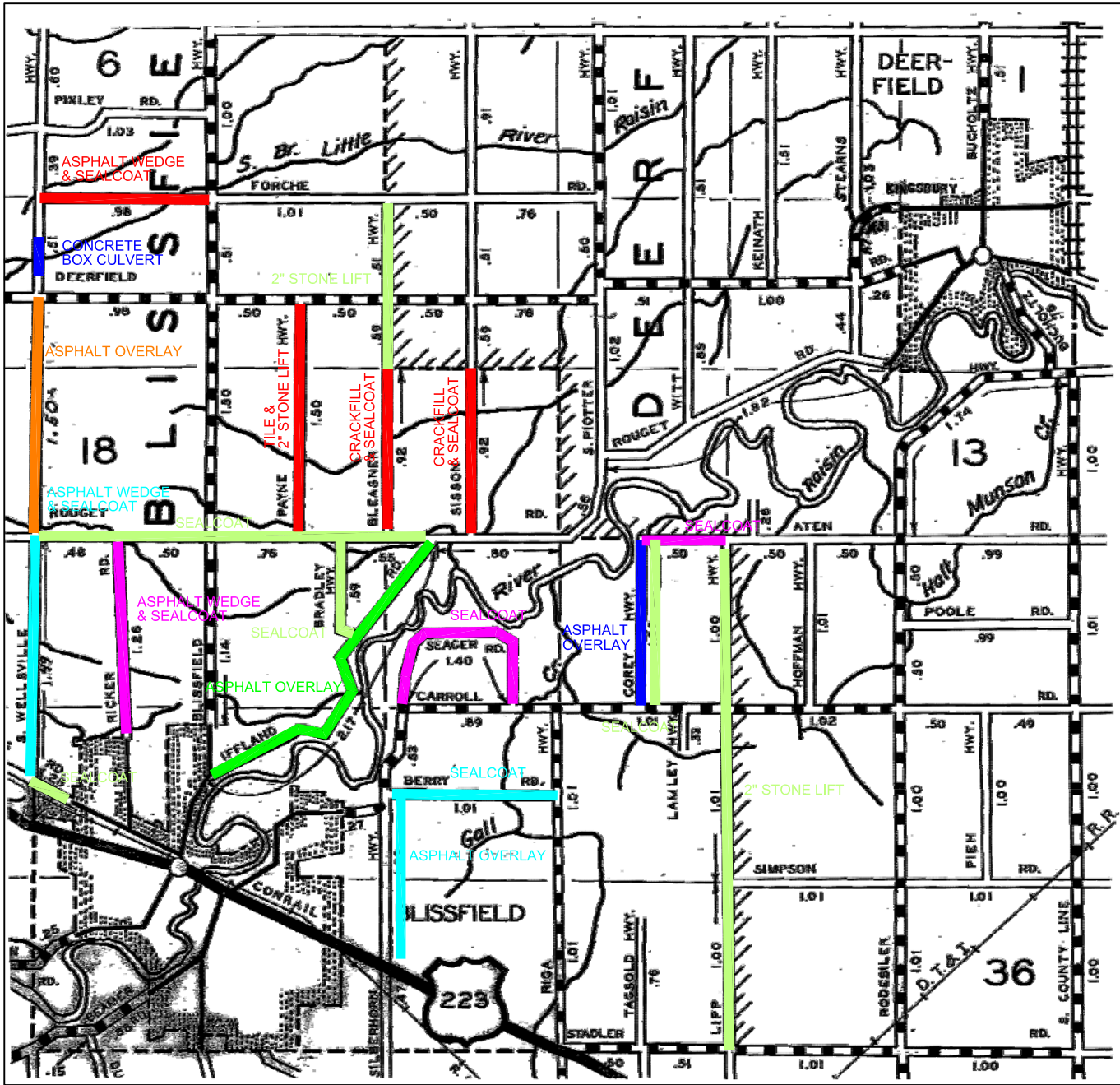

BLISSFIELD TOWNSHIP ROAD SURFACE PROJECTS 2010 TO 2016

2010

2011

2012

2013

2014

2015

2016

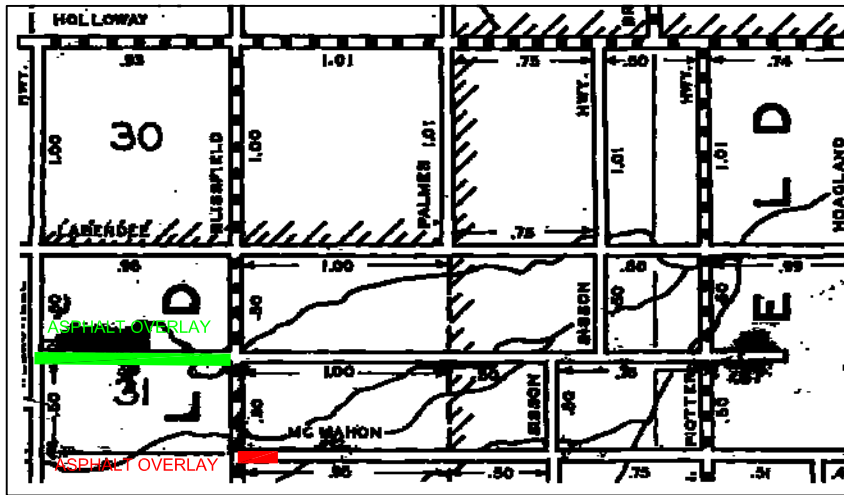

BLISSFIELD TOWNSHIP ROAD SURFACE PROJECTS 2010 TO 2016

TOWNSHIP PROJECT HISTORY
(actual dollars spent)

TOWNSHIP	2007	2008	2009	2010	2011	2012	2013	2014	2015	2016
WOODSTOCK	\$165,912	\$82,793	\$49,211	\$110,439	\$156,512	\$194,053	\$201,736	\$149,367	\$186,269	\$127,912
CAMBRIDGE	\$29,549	\$21,800	\$107,908	\$195,954	\$195,885	\$229,083	\$320,537	\$106,744	\$535,792	\$540,785
FRANKLIN	\$133,470	\$147,323	\$171,094	\$15,466	\$110,395	\$111,629	\$115,686	\$138,941	\$139,828	\$222,496
CLINTON	\$128,792	\$115,355	\$17,723	\$178,042	\$52,068	\$27,171	\$70,606	\$75,397	\$118,928	\$93,567
TECUMSEH	\$43,750	\$75,859	\$81,604	\$30,004	\$55,795	\$123,988	\$144,329	\$168,985	\$75,312	\$57,128
MACON	\$53,854	\$53,579	\$84,016	\$144,742	\$142,333	\$128,897	\$133,324	\$73,615	\$116,348	\$74,940
ROLLIN	\$234,818	\$140,493	\$177,573	\$36,083	\$56,874	\$55,429	\$61,638	\$149,332	\$141,312	\$117,506
ROME	\$60,255	\$45,359	\$45,211	\$117,578	\$73,449	\$66,980	\$81,752	\$72,864	\$139,689	\$77,633
ADRIAN	\$115,989	\$438,884	\$156,217	\$125,326	\$137,353	\$170,433	\$88,338	\$56,375	\$72,669	\$771,341
RAISIN	\$0	\$2,239	\$177,701	\$88,696	\$69,753	\$67,655	\$0	\$194,250	\$375,398	\$476,102
RIDGEWAY	\$61,316	\$140,709	\$312,543	\$374,079	\$241,376	\$86,994	\$210,783	\$116,804	\$236,572	\$346,483
HUDSON	\$120,979	\$174,680	\$108,257	\$103,722	\$77,668	\$70,712	\$80,744	\$119,780	\$111,054	\$92,184
DOVER	\$101,430	\$106,614	\$87,229	\$123,801	\$57,075	\$88,171	\$100,880	\$75,110	\$133,380	\$82,734
MADISON	\$88,133	\$273,574	\$244,275	\$211,326	\$203,446	\$285,951	\$243,504	\$294,068	\$202,729	\$198,643
PALMYRA	\$97,938	\$73,279	\$47,692	\$93,808	\$86,984	\$61,742	\$115,902	\$67,039	\$28,014	\$105,032
BLISSFIELD	\$227,913	\$92,575	\$140,282	\$324,818	\$173,933	\$65,456	\$76,118	\$154,310	\$162,986	\$302,818
DEERFIELD	\$166,179	\$130,442	\$66,068	\$84,647	\$159,686	\$180,422	\$221,524	\$226,656	\$145,526	\$106,637
MEDINA	\$210,627	\$132,729	\$56,161	\$128,974	\$395,976	\$53,463	\$104,474	\$150,545	\$212,805	\$238,450
SENECA	\$76,991	\$84,544	\$87,687	\$12,780	\$114,834	\$52,597	\$67,460	\$58,705	\$163,692	\$51,627
FAIRFIELD	\$94,625	\$32,378	\$41,020	\$145,002	\$137,757	\$195,633	\$98,807	\$182,459	\$122,420	\$164,448
OGDEN	\$96,558	\$158,898	\$124,591	\$145,183	\$223,346	\$119,070	\$132,504	\$217,375	\$116,621	\$155,289
RIGA	\$37,627	\$97,771	\$57,494	\$84,899	\$144,507	\$169,883	\$144,015	\$165,074	\$182,300	\$120,414
TOTAL	\$2,346,704	\$2,621,877	\$2,441,558	\$2,875,369	\$3,067,002	\$2,605,409	\$2,814,661	\$3,013,794	\$3,719,643	\$4,524,168

TOWNSHIP PROJECT HISTORY
(actual dollars spent)

TOWNSHIP	10 YEAR AVG / YEAR	10 YEAR AVG / MILE PER YEAR	RANKING BY 10 YEAR AVG \$/MILE/YEAR	TOTAL SINCE 1988	CURRENT LOCAL MILEAGE	SUBDIVISION MILEAGE ONLY	RANKING BY TOTAL MILES	POPULATION by Act 51 (2010 census)	RANKING BY POPULATION
WOODSTOCK	\$142,420	\$2,901	11	\$3,098,314	49.09	6.72	9	2,765	7
CAMBRIDGE	\$228,404	\$3,797	5	\$5,144,846	60.16	18.47	4	4,816	4
FRANKLIN	\$130,633	\$2,242	15	\$3,210,522	58.27	3.38	6	3,174	5
CLINTON	\$87,765	\$3,550	8	\$1,719,940	24.72	1.31	21	1,268	16
TECUMSEH	\$85,675	\$4,147	4	\$2,303,047	20.66	6.48	22	1,972	9
MACON	\$100,565	\$2,567	13	\$2,239,475	39.17	0.21	18	1,486	13
ROLLIN	\$117,106	\$2,422	14	\$2,779,096	48.36	8.74	12	2,968	6
ROME	\$78,077	\$1,666	21	\$2,588,231	46.86	0.00	13	1,791	10
ADRIAN	\$213,292	\$3,594	6	\$4,175,039	59.35	16.67	5	6,035	3
RAISIN	\$145,179	\$2,180	16	\$3,227,711	66.60	18.65	2	7,559	2
RIDGEWAY	\$212,766	\$4,668	3	\$3,145,277	45.58	0.21	14	956	20
HUDSON	\$105,978	\$2,946	10	\$2,569,852	35.97	0.15	19	1,325	15
DOVER	\$95,642	\$1,977	18	\$2,234,964	48.38	0.00	11	1,662	12
MADISON	\$224,565	\$5,392	2	\$4,507,020	41.65	11.99	16	8,621	1
PALMYRA	\$77,743	\$1,712	20	\$2,692,838	45.42	0.61	15	2,084	8
BLISSFIELD	\$172,121	\$6,080	1	\$3,001,352	28.31	0.00	20	633	22
DEERFIELD	\$148,779	\$3,582	7	\$3,347,227	41.53	0.00	17	670	21
MEDINA	\$168,420	\$3,298	9	\$3,382,220	51.07	1.24	8	1,090	18
SENECA	\$77,092	\$1,593	22	\$1,684,156	48.40	0.63	10	1,230	17
FAIRFIELD	\$121,455	\$1,994	17	\$3,622,682	60.90	4.34	3	1,764	11
OGDEN	\$148,943	\$2,668	12	\$3,509,236	55.83	0.18	7	973	19
RIGA	\$120,399	\$1,783	19	\$3,026,772	67.52	0.22	1	1,406	14
TOTAL	\$3,003,018	\$2,877		\$67,209,816	1,043.80	100.20		56,247	

LENAWEE COUNTY

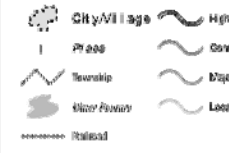
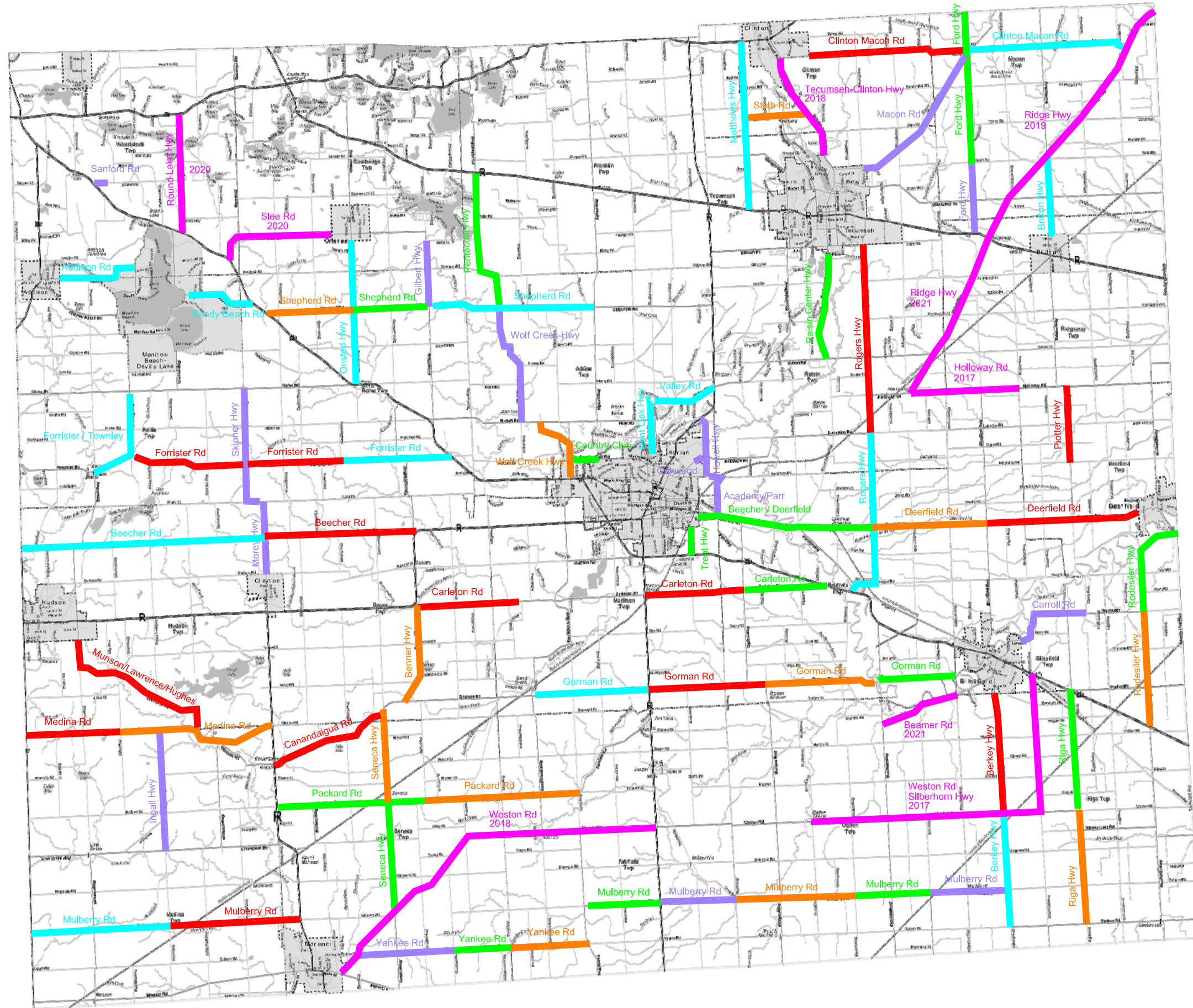

2017

2018

2019

2020

2021

Federal Aid



Prepared by: J. Stroup
Michigan Center for Geographic Information
Department of Information Technology
Copyright © September 2007

For more information:
Web: www.michigan.gov/gis
Phone: 517.273.7810



2017

PROJECT LOCATION

DESCRIPTION OF WORK

MILEAGE

Asphalt			
Ford Hwy	M-50 to Smith	185 lb Asphalt Overlay, Culverts	1.87
Yankee Rd	Weston to Camburn	FDR and Asphalt Ovarlay	2.51
Carroll Rd / Silberhorn	Remaining to Village	185 lb Asphalt Overlay	1.75
Sanford Rd	US-223 to Salt Well	220 lb Asphalt Overlay	0.26
Oakwood Rd	Howell to City	185 lb Asphalt Overlay	0.29
Seal Coat			
Howell Hwy	Academey to M-52	Crackfill, Wedges & Seal Coat, Fog Seal	1.59
Parr Hwy / Academy	City Limits to Ogden Hwy	Crackfill, Wedges & Seal Coat, Fog Seal	2.54
Mulberry Rd	Berkey to Loar	FDR & Seal Coat, Fog Seal	2.00
Wolfcreek Hwy	Hunt to Shepherd	Crackfill, Wedges & Seal Coat, Fog Seal	3.30
Morey Hwy	Plank to Village	Crackfill, Wedges & Seal Coat, Fog Seal	1.93
Macon Hwy	City Limits to Clinton Macon	Crackfill, Wedges & Seal Coat, Fog Seal	4.49
Skinner Hwy	Plank to Rome	Crackfill, Wedges & Seal Coat, Fog Seal	3.00
Gilbert Hwy	Reed to Shepherd	Crackfill & Seal Coat, Fog Seal	1.73
Gravel			
Ingall Hwy	Medina to Lime Creek	Shoulder Removal, Tile and 4" Gravel	3.19
Mulberry Rd	M-52 to Treat	Shoulder Removal, Tile and 4" Gravel	2.02

2018

PROJECT LOCATION**DESCRIPTION OF WORK****MILEAGE****Asphalt**

Ford Hwy	Clinton Macon to Smith	185 lb Asphalt Overlay	3.00
Raisin Center Hwy	City to Sutton	185 lb Asphalt Overlay	3.04
Country Club	City to Wolf Creek	185 lb Asphalt Overlay	0.78
Treat Hwy	US-223 to City Limits	Mill and 220 lb Asphalt Overlay	0.75
Seneca Hwy	Weston to Packard	185 lb Asphalt Overlay	2.96
Yankee Rd	Camburn to Terry	FDR and Asphalt Ovarlay	1.51

Seal Coat

Riga Hwy	US-223 to Weston	Crackfill, Wedges & Seal Coat, Fog Seal	3.16
Pentecost Hwy	M-50 to Shepherd	Crackfill, Wedges & Seal Coat, Fog Seal	3.64
Rodesiler Hwy	Village of Deerfield to Carroll	Crackfill, Wedges & Seal Coat, Fog Seal	2.74
Deerfield Rd/Beecher Rd	City Limits to Rogers	Crackfill & Seal Coat, Fog Seal	4.22
Packard Rd	M-156 to Tuttle	Crackfill, Wedges & Seal Coat, Fog Seal	3.76
Mulberry Rd	Loar to Neuroth	FDR & Seal Coat, Fog Seal	1.99

Gravel

Ford Hwy	Clinton Macon to County Line	2" Gravel	1.01
Gorman Rd	Crockett to Village	2" 411 Limestone	2.23
Mulberry Rd	M-52 to Lyons	2" Gravel	2.01
Carleton Rd	US-223 to Ogden Hwy	2" 411 Limestone	2.17
Shepherd Rd	Gilbert to Onsted	2" Gravel	2.01

Total

2019

PROJECT LOCATION

DESCRIPTION OF WORK

MILEAGE

Asphalt			
Staib Rd	Matthews to Tecumseh Clinton	185 lb Asphalt Overlay	1.67
Wolf Creek Hwy	US-223 to Hunt	185 lb Asphalt Overlay	2.00
Yankee Rd	Terry to Lyons	FDR and Asphalt Ovarlay	2.09
Seneca Hwy	Packard to Gorman	185 lb Asphalt Overlay	2.16
Benner Hwy	M-34 to Gorman Rd	185 lb Asphalt Overlay	2.61
Seal Coat			
Riga Hwy	Weston to Yankee	Crackfill, Wedges & Seal Coat, Fog Seal	3.01
Rodesiler Hwy	Carroll to US-223	Crackfill & Seal Coat, Fog Seal	3.04
Deerfield Rd	Rogers to Blissfield	Crackfill & Seal Coat, Fog Seal	2.98
Gorman Rd	Hodges to Crockett	Crackfill & Seal Coat, Fog Seal	2.94
Packard Rd	Tuttle to Fairfield	Crackfill, Wedges & Seal Coat, Fog Seal	4.33
Medina Rd	M-156 to Dillon	Crackfill, Wedges & Seal Coat, Fog Seal	2.53
Mulberry Rd	Neuroth to Treat Hwy	FDR & Seal Coat, Fog Seal	3.15
Gravel			
Shepherd Rd	Onsted to US-223	2" Gravel	2.34

Total

2020

PROJECT LOCATION**DESCRIPTION OF WORK****MILEAGE****Asphalt**

Berkey Hwy	Vill of Blissfield to Weston	185 lb Asphalt Overlay	3.18
Carleton Rd	M-52 to Ogden	185 lb Asphalt Overlay	2.61
Forrister Rd	Skinner to Wilkinson	FDR and Asphalt Ovarlay	2.51
Canandaigua Rd	M-156 to Seneca Hwy	185 lb Asphalt Overlay	3.32

Seal Coat

Deerfield Rd	Blissfield to Village Limits	Crackfill, Wedges & Seal Coat, Fog Seal	4.03
Gorman Rd	M-52 to Hodges	Crackfill & Seal Coat, Fog Seal	3.17
Clinton Macon Rd	Village to Ford	Crackfill & Seal Coat, Fog Seal	4.71
Rogers Hwy	Russell to Laberdee	Crackfill & Seal Coat, Fog Seal	5.00
Medina Rd	Dillon to US-127	Crackfill, Wedges & Seal Coat, Fog Seal	2.53
Beecher Rd	M-34 to Morey	Crackfill & Seal Coat, Fog Seal	4.13
Munson/Lawrence/Hughes	City to Medina	Crackfill, Wedges & Seal Coat, Fog Seal	5.18

Gravel

Mulberry Rd	M-156 to Ingall	2" Gravel	3.00
Piotter Hwy	Holloway to McMahan	2" 411 Limestone	2.01
Carleton Rd	Benner to End	2" Gravel	2.50
Forrister Rd	Skinner to Posey Lake	2" Gravel	1.54

Total

	PROJECT LOCATION	DESCRIPTION OF WORK	MILEAGE	
2021	Asphalt			
	Berkey Hwy	Weston to Yankee	185 lb Asphalt Overlay	2.99
	Forrister Rd	Wilkinson to US-223	FDR and Asphalt Ovarlay	2.95
	Britton Hwy	Kniffin to Ridge	185 lb Asphalt Overlay	2.32
	Sandy Beach	US-223 to Round Lake Hwy	185 lb Asphalt Overlay	1.90
	Seal Coat			
	Bent Oak and Valley	City to M-52	Crackfill & Seal Coat, Fog Seal	3.06
	Gorman Rd	M-52 to Sand Creek Hwy	Crackfill & Seal Coat, Fog Seal	3.09
	Onsted Hwy / Stoddard	US-223 to Village of Onsted	Crackfill & Seal Coat, Fog Seal	4.08
	Clinton Macon Rd	Ridge to Ford	Crackfill & Seal Coat, Fog Seal	4.41
	Rogers Hwy	Laberde to US-223	Crackfill & Seal Coat, Fog Seal	4.92
	Beecher Rd	Morey to US-127	Crackfill & Seal Coat, Fog Seal	6.53
	Forrister / Townley	Rollin to Manitou	Crackfill & Seal Coat, Fog Seal	4.36
	Matthews Hwy	M-50 to US-12	Crackfill & Seal Coat, Fog Seal	4.48
	Shepherd Rd	Gilbert to Tipton	Crackfill & Seal Coat, Fog Seal	4.48
Addison Rd	Devils Lake Hwy to Village Limits	Crackfill & Seal Coat, Fog Seal	2.37	
Gravel				
Mulberry Rd	Ingall to US-127	2" Gravel	3.68	

Total

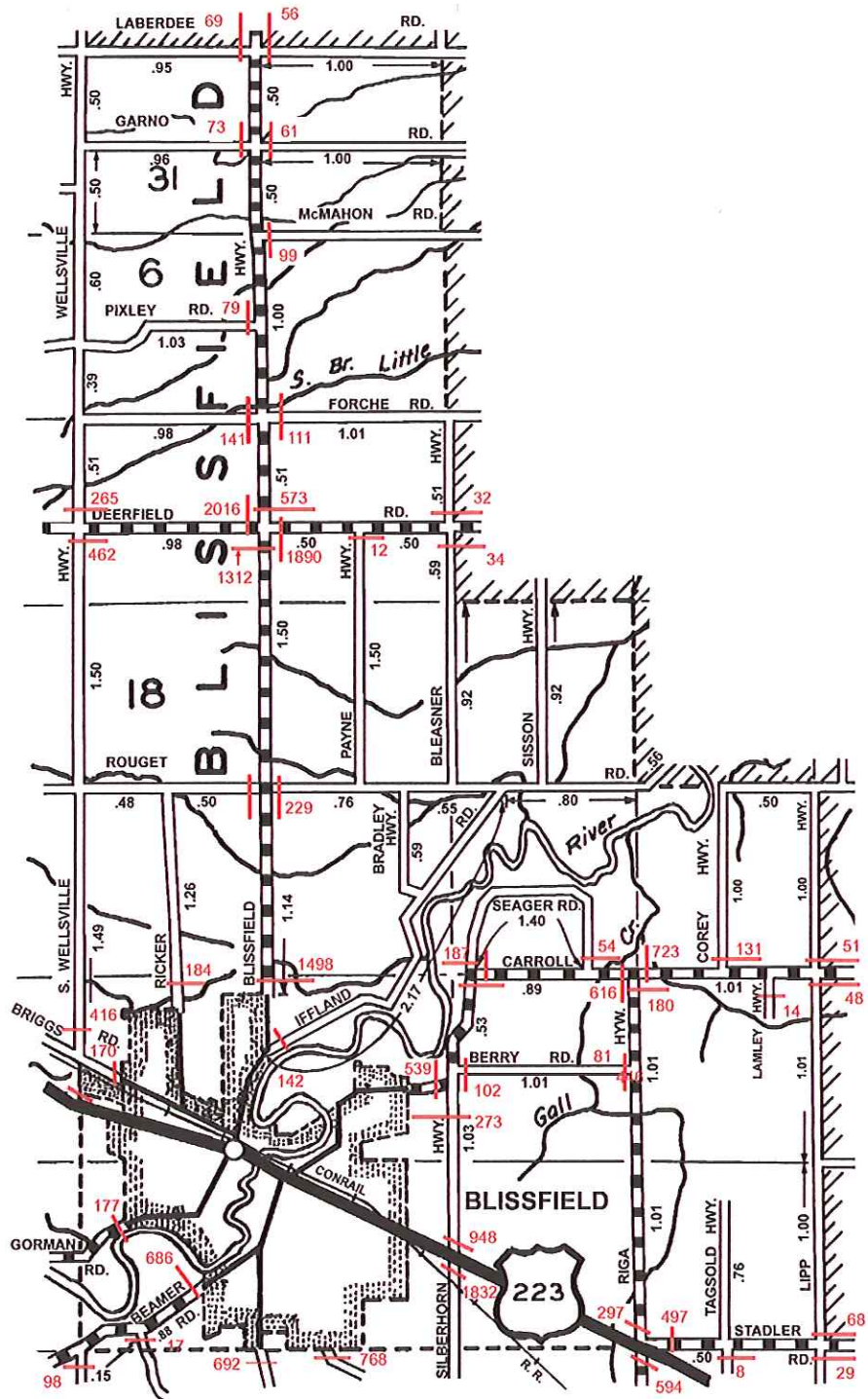

2016 Traffic Counts

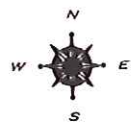

POLITICAL MILEAGE		
TOWNSHIP	PRIMARY	LOCAL
BLISSFIELD	12.99	24.39
DEERFIELD	18.38	24.88
TOTAL	31.37	49.27

PRIMARY ROAD SYSTEM IS 31.37 MILE
 LOCAL ROAD SYSTEM IS 49.27 MILE

LEGEND

- COUNTY LINE
- CORPORATE LIMITS
- STATE TRUNKLINE
- COUNTY PRIMARY
- COUNTY LOCAL
- ADJACENT COUNTY
- CITY OR VILLAGE STREET

- 1 PASER RATING
- 2 PASER RATING
- 3 PASER RATING
- 4 PASER RATING
- 5 PASER RATING
- 6 PASER RATING
- 7 PASER RATING
- 8, 9, 10 PASER RATING

- COUNTY LINE
- CORPORATE LIMITS
- STATE TRUNKLINE
- COUNTY PRIMARY
- COUNTY LOCAL
- ADJACENT COUNTY
- CITY OR VILLAGE STREET

PRIMARY ROAD SYSTEM IS 18.51 MILE

LOCAL ROAD SYSTEM IS 60.03 MILE

I HEREBY CERTIFY THAT THE ROAD SHOWN HEREON BY SYMBOL OR IN RED AS PRIMARY ROADS AND THOSE SHOWN HEREIN BY SYMBOL OR IN GREEN AS LOCAL ROAD ARE IN USE AND ARE UNDER THE JURISDICTION OF THE COUNTY ROAD COMMISSION.

CHAIRMAN _____ DATE _____

POLITICAL MILEAGE

TOWNSHIP	PRIMARY	LOCAL
BLISSFIELD	1.00	3.91
DEERFIELD	4.02	16.65
RIDGEWAY	13.49	39.47
TOTAL	18.51	60.03

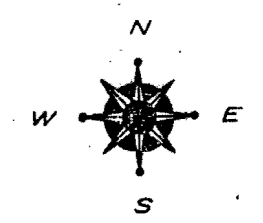

SCALE 0 1 MI.
One Inch Equals 3000 Ft

SHEET 71

Prepared by

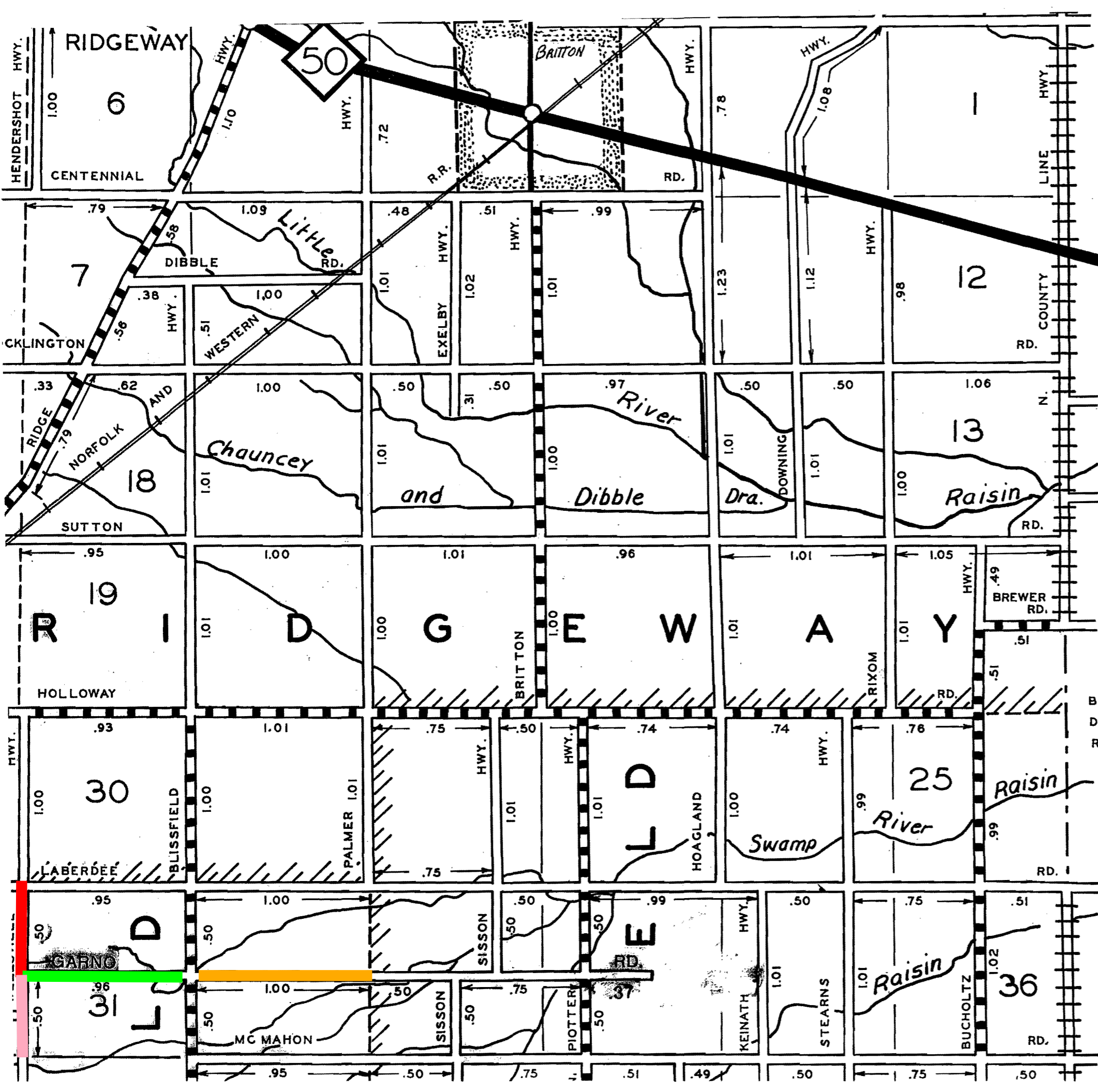

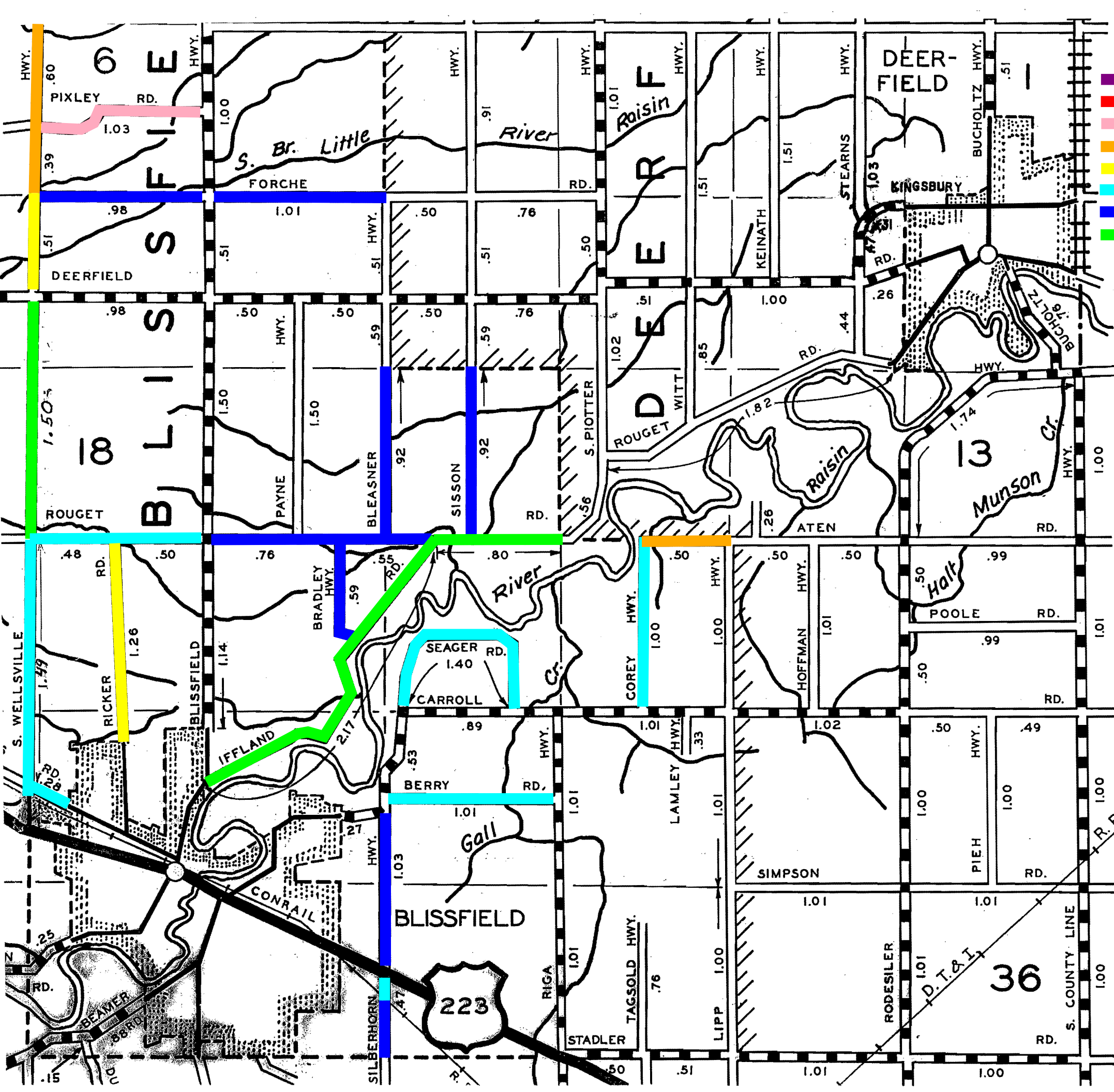

- 1 PASER RATING
- 2 PASER RATING
- 3 PASER RATING
- 4 PASER RATING
- 5 PASER RATING
- 6 PASER RATING
- 7 PASER RATING
- 8, 9, 10 PASER RATING

- LEGEND
- COUNTY LINE
 - CORPORATE LIMITS
 - STATE TRUNKLINE
 - COUNTY PRIMARY
 - COUNTY LOCAL
 - ADJACENT COUNTY
 - CITY OR VILLAGE STREET

2016 RATING DATA

PRIMARY ROAD SYSTEM IS 31.37 MILES
 LOCAL ROAD SYSTEM IS 49.27 MILES

I HEREBY CERTIFY THAT THE ROADS SHOWN HEREON BY SYMBOL OR IN RED AS PRIMARY ROADS AND THOSE SHOWN HEREON BY SYMBOL OR IN GREEN AS LOCAL ROADS ARE IN USE AND ARE UNDER THE JURISDICTION OF THE COUNTY ROAD COMMISSION.

POLITICAL MILEAGE

TOWNSHIP	PRIMARY	LOCAL
BLISSFIELD	<u>12.99</u>	<u>24.39</u>
DEERFIELD	<u>18.38</u>	<u>24.88</u>
TOTAL	<u>31.37</u>	<u>49.27</u>

CHAIRMAN _____ DATE _____

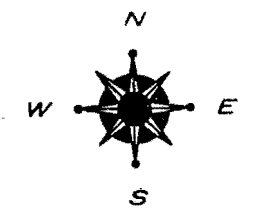

SCALE 0 1/2 1 MILE
 One Inch Equals 3000 Ft.

SHEET 85

Prepared by
 LENAWEE CO.-46 T.7S R.5E.

Blissfield Township Local Pavement Condition

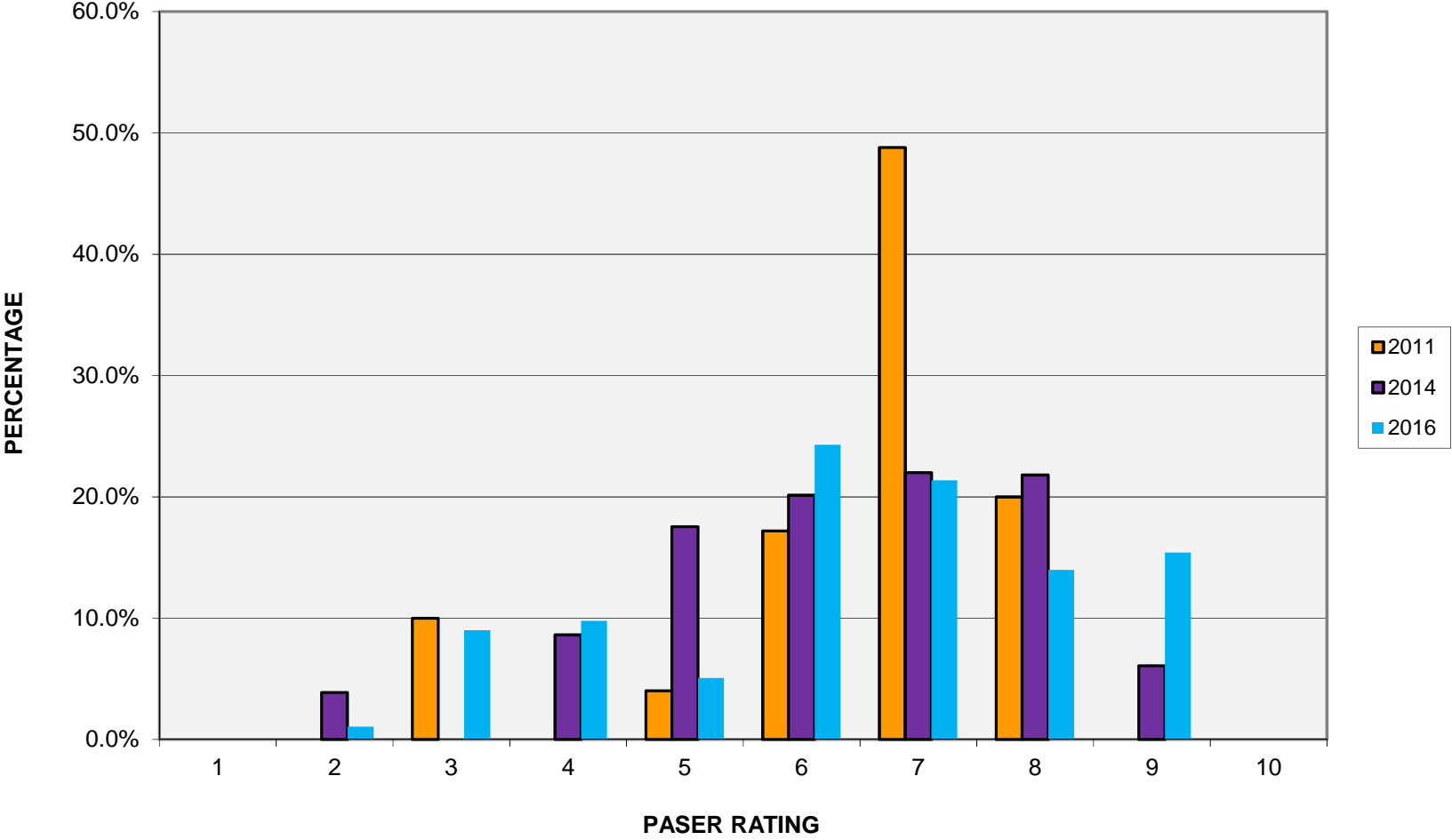

- COUNTY LINE
- CORPORATE LIMITS
- STATE TRUNKLINE
- COUNTY PRIMARY
- COUNTY LOCAL
- ADJACENT COUNTY
- CITY OR VILLAGE STREET

PRIMARY ROAD SYSTEM IS 18.51 MILE
 LOCAL ROAD SYSTEM IS 60.03 MILE

I HEREBY CERTIFY THAT THE ROAD SHOWN HEREON BY SYMBOL OR IN RED AS PRIMARY ROADS AND THOSE SHOWN HEREIN BY SYMBOL OR IN GREEN AS LOCAL ROAD ARE IN USE AND ARE UNDER THE JURISDICTION OF THE COUNTY ROAD COMMISSION.

CHAIRMAN _____ DATE _____

POLITICAL MILEAGE

TOWNSHIP	PRIMARY	LOCAL
BLISSFIELD	1.00	3.91
DEERFIELD	4.02	16.65
RIDGEWAY	13.49	39.47
TOTAL	18.51	60.03

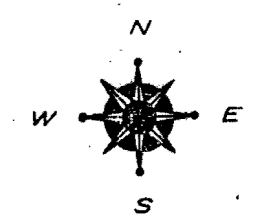

SCALE 0 1 MI.
 One Inch Equals 3000 Ft

SHEET 71

Prepared by

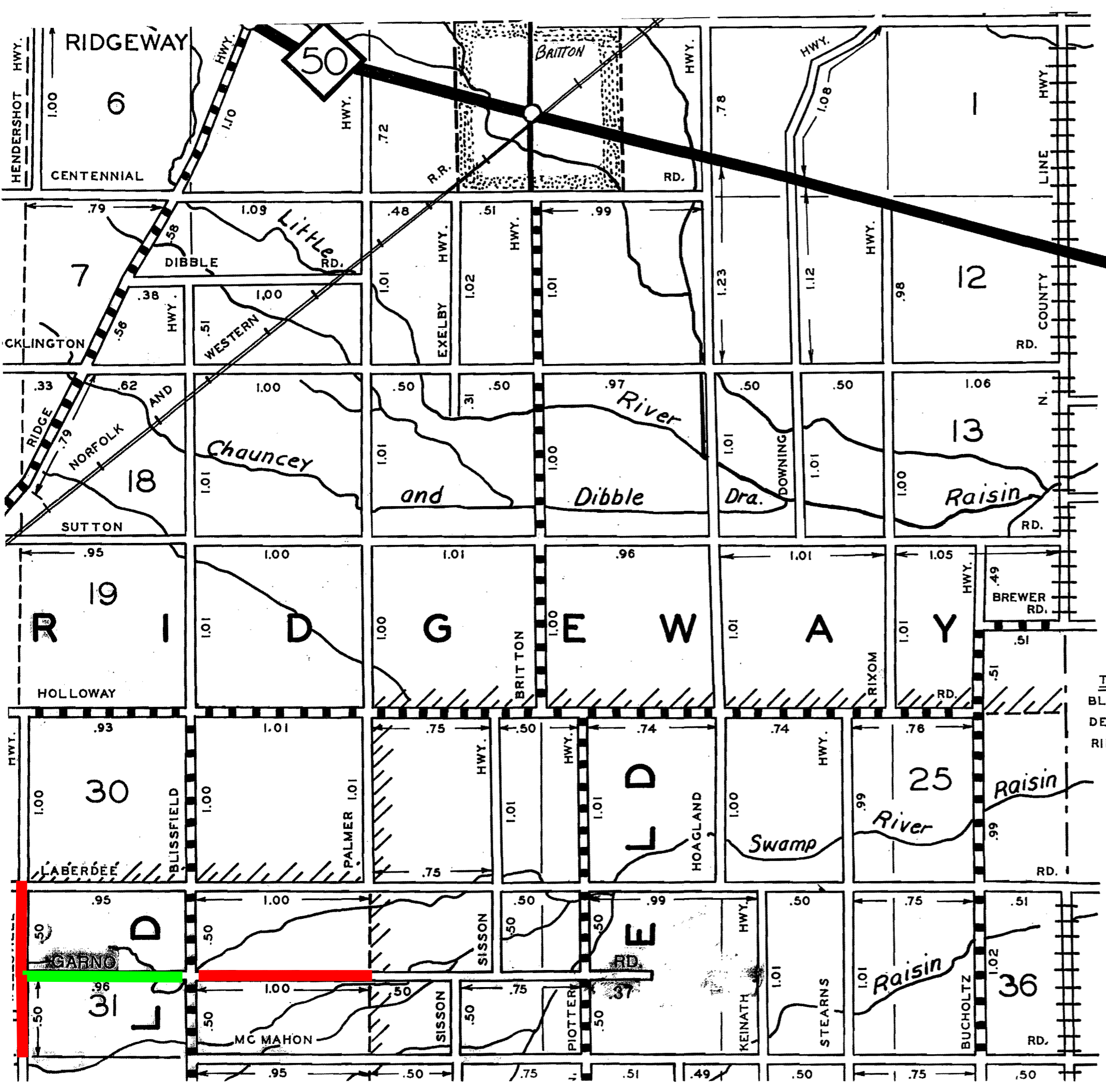

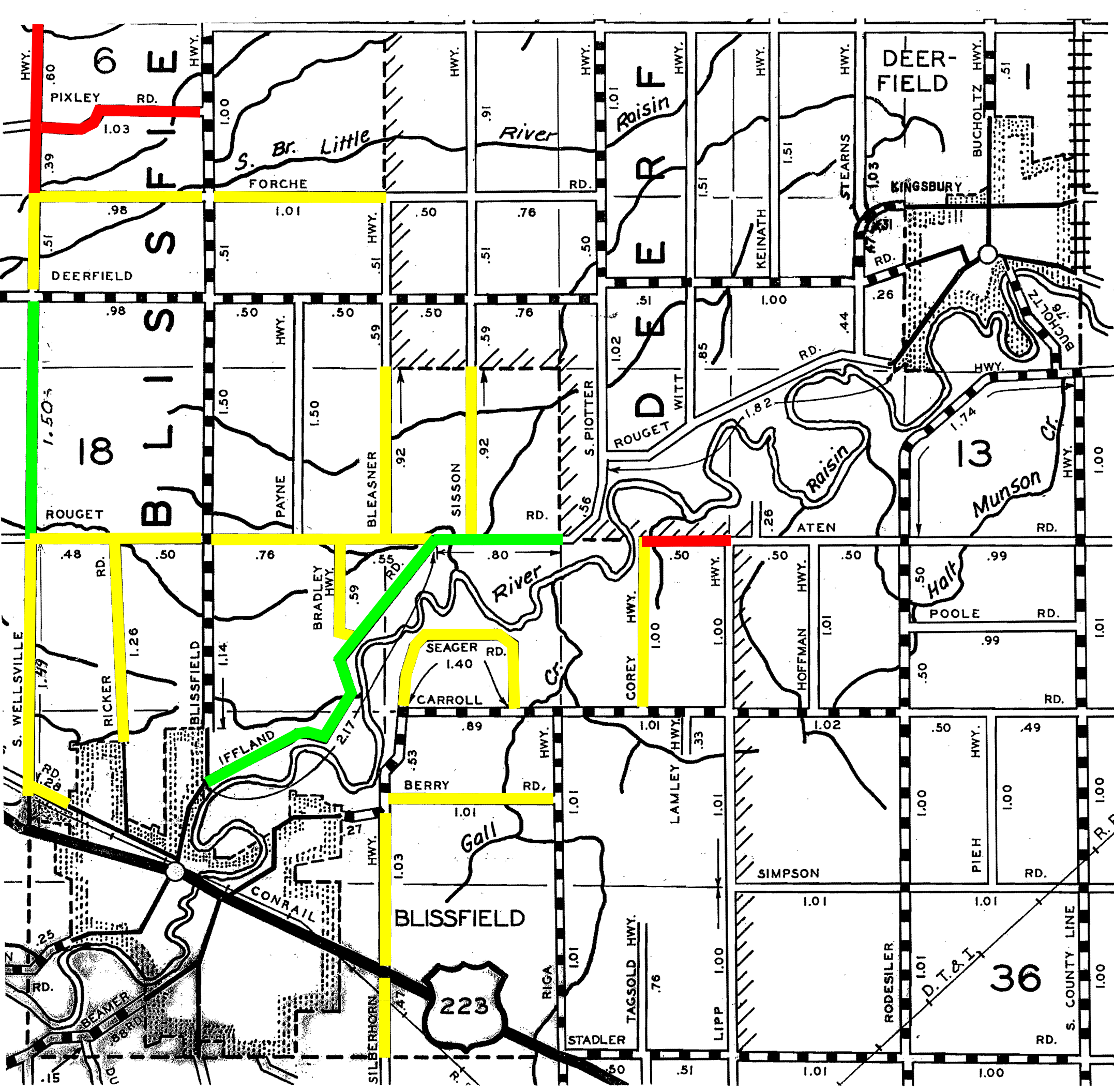

LEGEND

- COUNTY LINE
- CORPORATE LIMITS
- STATE TRUNKLINE
- COUNTY PRIMARY
- COUNTY LOCAL
- AJACENT COUNTY
- CITY OR VILLAGE STREET

PRIMARY ROAD SYSTEM IS 31.37 MILES

LOCAL ROAD SYSTEM IS 49.27 MILES

I HEREBY CERTIFY THAT THE ROADS SHOWN HEREON BY SYMBOL OR IN RED AS PRIMARY ROADS AND THOSE SHOWN HEREON BY SYMBOL OR IN GREEN AS LOCAL ROADS ARE IN USE AND ARE UNDER THE JURISDICTION OF THE COUNTY ROAD COMMISSION.

TOWNSHIP	POLITICAL MILEAGE	
	PRIMARY	LOCAL
BLISSFIELD	12.99	24.39
DEERFIELD	18.38	24.88
TOTAL	31.37	49.27

2016 RATING DATA

- 1-4 PASER RATING (Poor)
- 5-7 PASER RATING (Fair)
- 8-10 PASER RATING (Good)

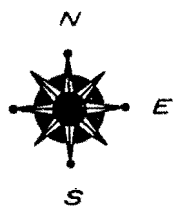

SCALE 0 1 MILE
One Inch Equals 3000 Ft.

SHEET 85

Prepared by
LENAWEE CO.-46 T.7S R.5E.

Blissfield Township - Local Roads 2016 Pavement Condition

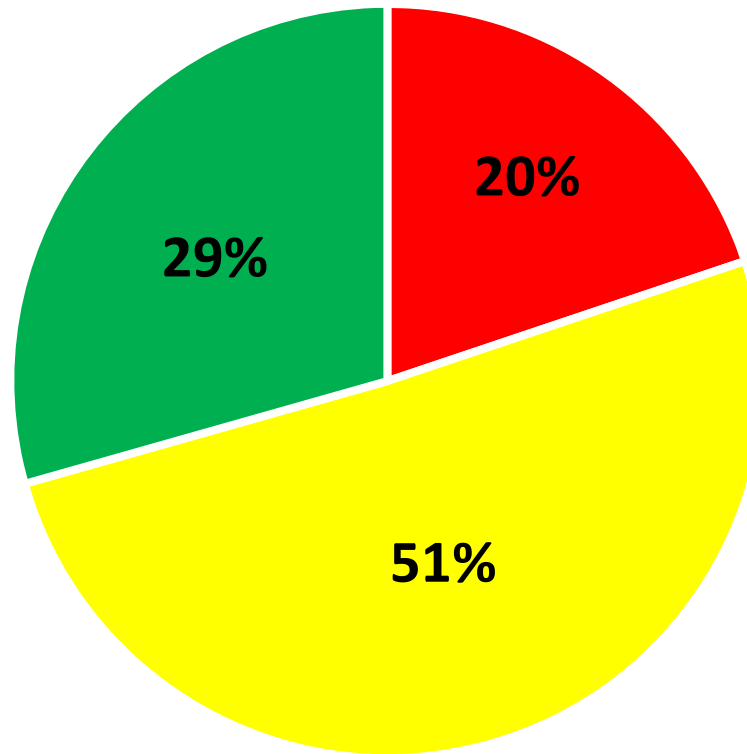

■ Poor

■ Fair

■ Good

Blissfield Township - Local Roads
2014 Pavement Condition

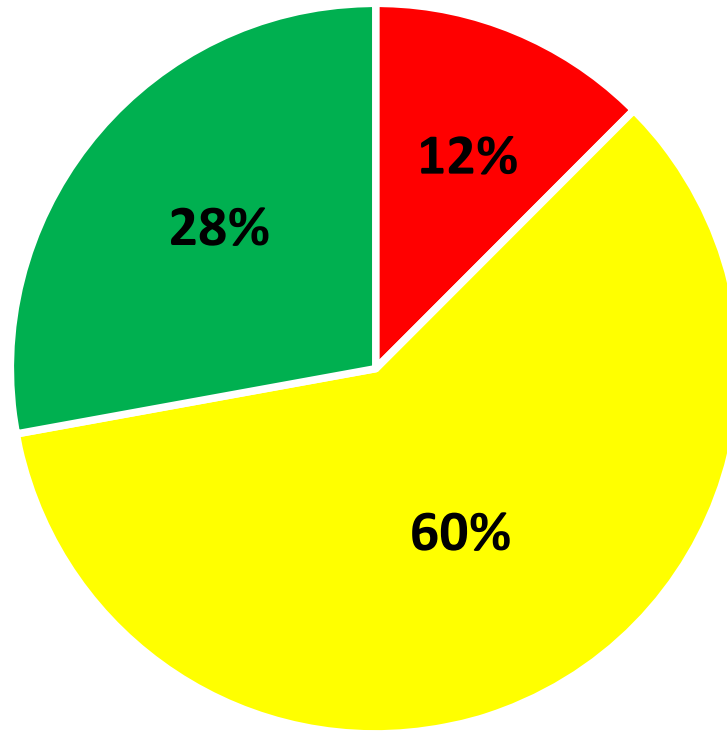

- Poor
- Fair
- Good

Blissfield Township - Local Roads 2011 Pavement Condition

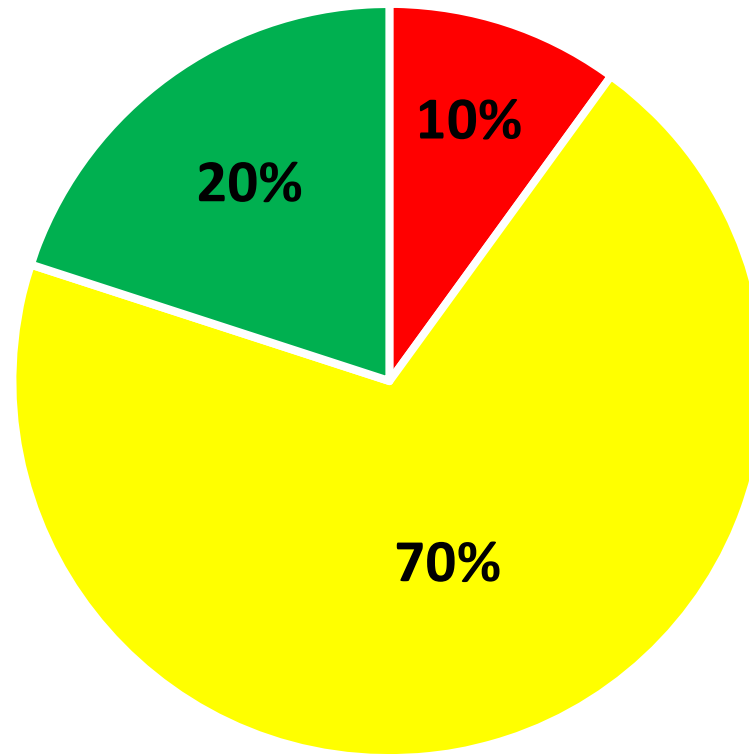

■ Poor

■ Fair

■ Good

Blissfield Township
Local Road Pavement
2016 Condition Cost Summary

Paser Rating	Improvement Type	Miles	Cost per Mile	Total
10		0.00	\$0	\$0
9		3.86	\$0	\$0
8		3.50	\$0	\$0
7	Crackseal	5.35	\$10,000	\$53,500
6	Sealcoat	6.09	\$20,000	\$121,800
5	Wedge & Sealcoat	1.27	\$30,000	\$38,100
4	2" Overlay	2.45	\$120,000	\$294,000
3	3" Overlay	2.25	\$200,000	\$450,000
2	FDR and 3.5" Asphalt	0.27	\$400,000	\$108,000
1	Reconstruction	0.00	\$600,000	\$0
Total Paved Roads		25.04		\$1,065,400
Total Roads in Township		28.31		
Gravel Roads	4" Gravel / Drainage	3.27	\$50,000	\$163,500
Total Cost to Improve all Township Roads				\$1,228,900
Improvement costs (Paved Roads) based upon 2016 Rating Data =				\$1,065,400
Improvement costs (Paved Roads) based upon 2014 Rating Data =				\$934,800
Cost increase from 2014 to 2016 using same dollars per mile =				\$130,600

Blissfield Township
Local Road Pavement
2014 Condition Cost Summary

Paser Rating	Improvement Type	Miles	Cost per Mile	Total
10		0.00	\$0	\$0
9		1.52	\$0	\$0
8		5.46	\$0	\$0
7	Crackseal	5.51	\$10,000	\$55,100
6	Sealcoat	5.04	\$20,000	\$100,800
5	Wedge & Sealcoat	4.39	\$30,000	\$131,700
4	2" Overlay	2.16	\$120,000	\$259,200
3	3" Overlay	0.00	\$200,000	\$0
2	FDR and 3.5" Asphalt	0.97	\$400,000	\$388,000
1	Reconstruction	0.00	\$600,000	\$0
Total Paved Roads		25.05		\$934,800
		28.31		
Gravel Roads	4" Gravel / Drainage	3.26	\$50,000	\$163,000
Total Cost to Improve all Township Roads				\$1,097,800
Improvement costs (Paved Roads) based upon 2014 Rating Data =				\$934,800
Improvement costs (Paved Roads) based upon 2011 Rating Data =				\$738,000
Cost increase from 2011 to 2014 using same dollars per mile =				\$196,800

Blissfield Township
Local Road Pavement
2011 Condition Cost Summary

Paser Rating	Improvement Type	Miles	Cost per Mile	Total
8, 9, 10		5.0	\$0	\$0
7	Crackseal	12.2	\$10,000	\$122,000
6	Sealcoat	4.3	\$20,000	\$86,000
5	Wedge & Sealcoat	1.0	\$30,000	\$30,000
4	2" Overlay	0.0	\$120,000	\$0
3	3" Overlay	2.5	\$200,000	\$500,000
2	FDR and 3.5" Asphalt	0.0	\$400,000	\$0
1	Reconstruction	0.0	\$600,000	\$0
Total Paved Roads		25.0		\$738,000
		28.31		
Gravel Roads	4" Limestone / Drainage	3.31	\$50,000	\$165,500
Total Cost to Improve all Township Roads				<u>\$903,500</u>



BLISSFIELD TWP

Project proposal

ASPHALT OVERLAY, W/UNDERSEAL

- Aten rd, Corey to end of pavement
- Garno rd, Blissfield to east twp line

CRACK FILL, SEALCOAT W/FOG SEAL

- Silberhorn hwy, 223 to Carroll
- Pixley rd, wellsville to Blissfield
- Wellsville hwy, Deerfield to Rouget (split with palmyra)

CULVERTS

- Ricker hwy, 3 large culverts, start at Rouget.