

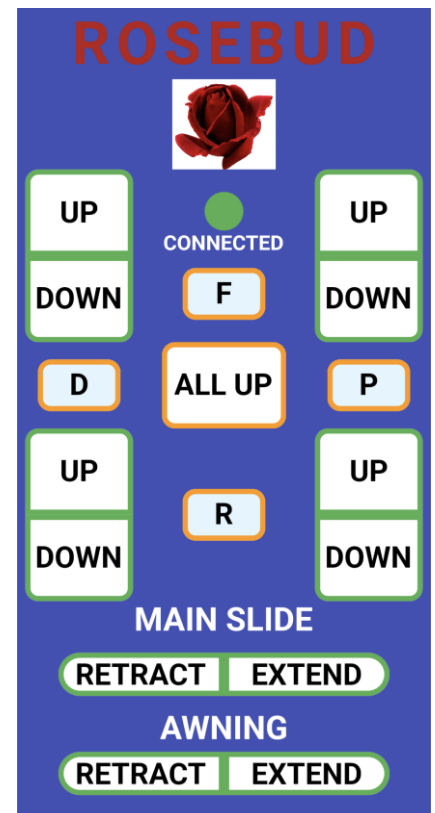

# ROSEBUD



- Direct plugin replacement for KwiKee Level Best Controller
- Uses Android or Apple Phone/Tablet for wireless remote control
- Controls KwiKee hydraulic levelers
- Simple Dash Panel
- Controls Living room slide (manual controls still work)
- Controls Main Awning (manual controls still work)



ROSEBUD Slide / Awning Harness

ROSEBUD Bluetooth Radio  
BLE 4.0



KwiKee Hydraulics

KwiKee Power Connector

ROSEBUD Dash Panel

## **DANGER**

**Do not use ROSEBUD when laying under the coach. Serious injury or death could occur if there is a hydraulic failure!**



ROSEBUD Dash Panel

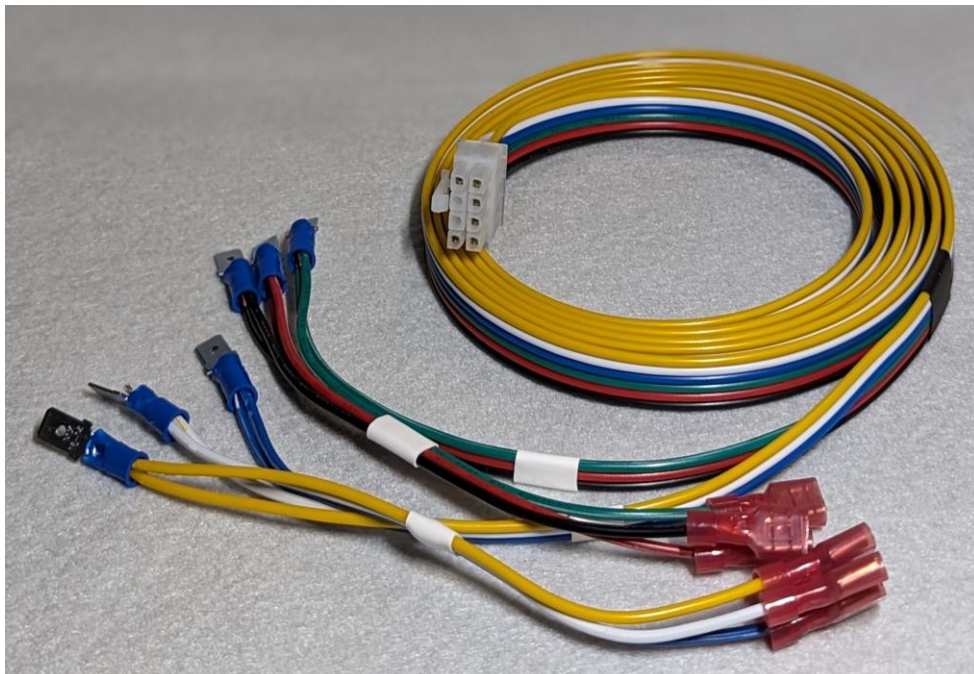

ROSEBUD Slide / Awning Cable



# HARDWARE INSTALLATION

1



**Remove 4 screws from Level  
Best Dash Panel**

2



**Lift out panel and remove  
the 2 connectors**

3



**Install ROSEBUD dash panel  
(switch OFF)**

4



- **Lift dash**
- **Install ROSEBUD connectors**
- **Position ROSEBUD control box on dash surface**

**5**



**Remove 6 screws on panel  
with slide/awning  
switches**

**6**



**Fish slide/awning cable  
from switch panel to  
ROSEBUD**

# 6

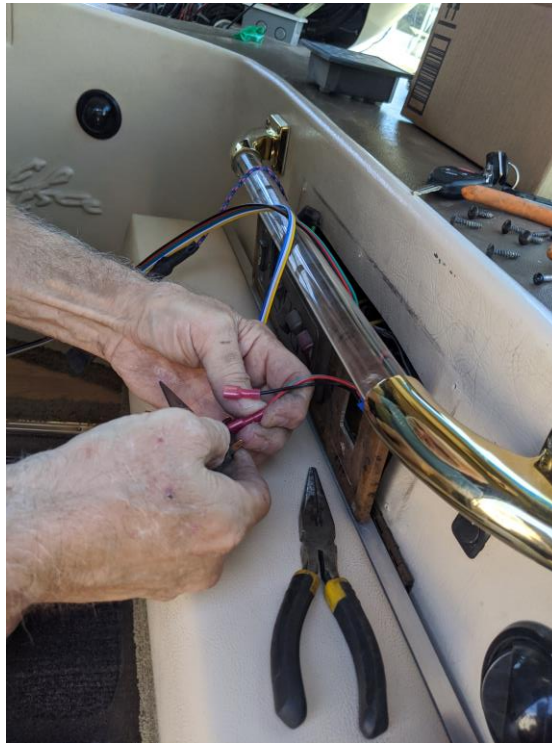

- **Connect cable to slide and awning switches**
- **Install ROSEBUD connector**
- **Reinstall switch panel 6 screws**

Slide / Awning Cable		
PIN		
1	Black	Slide Extend
2	Green	Slide Retract
3	Blue	Awning Extend
4	Yellow	Awning Retract
5	Red	Slide Common
6	NC	
7	NC	
8	White	Awning Common



# ROSEBUD APPLICATION INSTALLATION

For Android Users:

- Go to the Google Play Store
- Search for ROSEBUD App
- Install ROSEBUD



For Apple Users:

- Go to the APPLE APP Store
- Search for ROSEBUD LC App
- Install ROSEBUD LC





# ROSEBUD APP FIRST TIME CONNECTION

1



**Turn ON ROSEBUD Dash  
Power Switch**

2

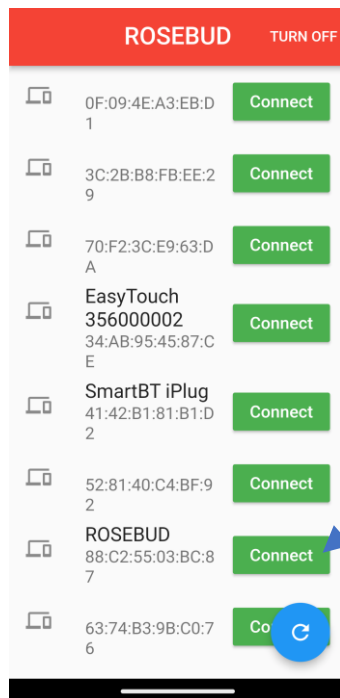

Select

**Open the ROSEBUD APP  
And select the ROSEBUD  
Device**

3

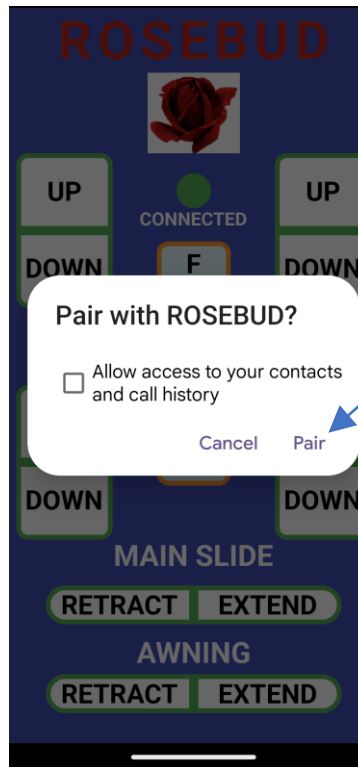

Select "Pair"

Select "Pair"

4

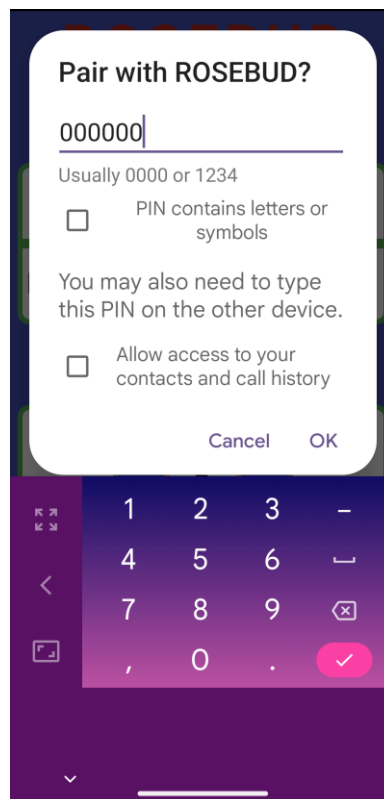

**Input 000000 as the PIN  
(SIX ZEROS)  
And then select OK**

5

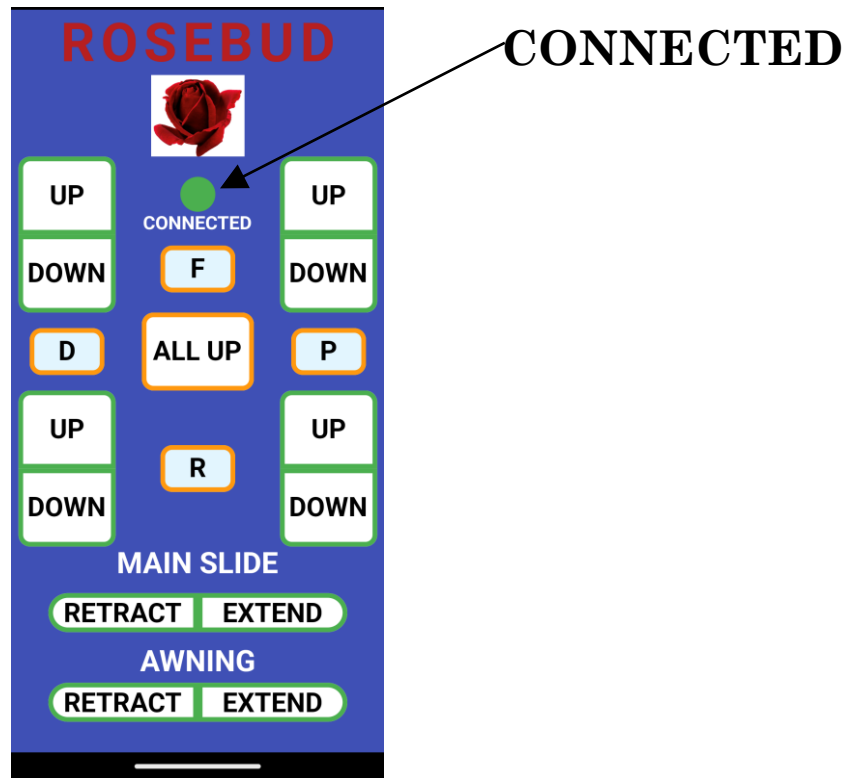

**The Connected Light will now  
be Green**

## **CONGRATULATIONS**

**Your phone/tablet is now paired with ROSEBUD.**

**Now each time you open the APP you will only  
need select ROSEBUD from the list of BlueTooth  
devices.**

# ROSEBUD OPERATION

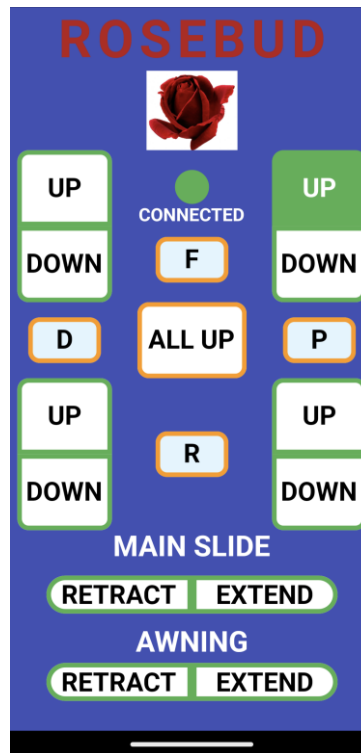

Right Front will  
Go UP

Operation of your jacks, slide and awning is now just a matter of using the APP buttons to activate the function.

When any button is pushed, the background color turns GREEN. The function is active until you release the button.

## DANGER

**Do not use ROSEBUD when laying under the coach. Serious injury or death could occur if there is a hydraulic failure!**



# Dual Mode Operation

Dual mode operation allows you to Extend (DOWN) and Retract (UP) jacks in pairs. The KwiKee controller only allowed you to Extend (DOWN) jacks in pairs. Use of this mode simplifies the leveling process and can significantly reduce the amount of stress created by the leveling process on the motor home chassis.

Dual mode is entered by tapping the F (Front), P (Passenger), R (Rear) or D (Driver) button on the keypad. The button will turn orange indicating you are in dual mode on that pair of jacks. Additionally, on the jacks that are not operating, the UP/DOWN buttons background color turns gray.

Either set of UP/DOWN buttons for the pair of jacks selected can be used to raise or lower the pair of jacks.

After use, tap the selected F, P, R or D button to exit dual mode. You must exit the current dual mode in order to use individual UP/DOWN buttons or to select a different dual mode position.

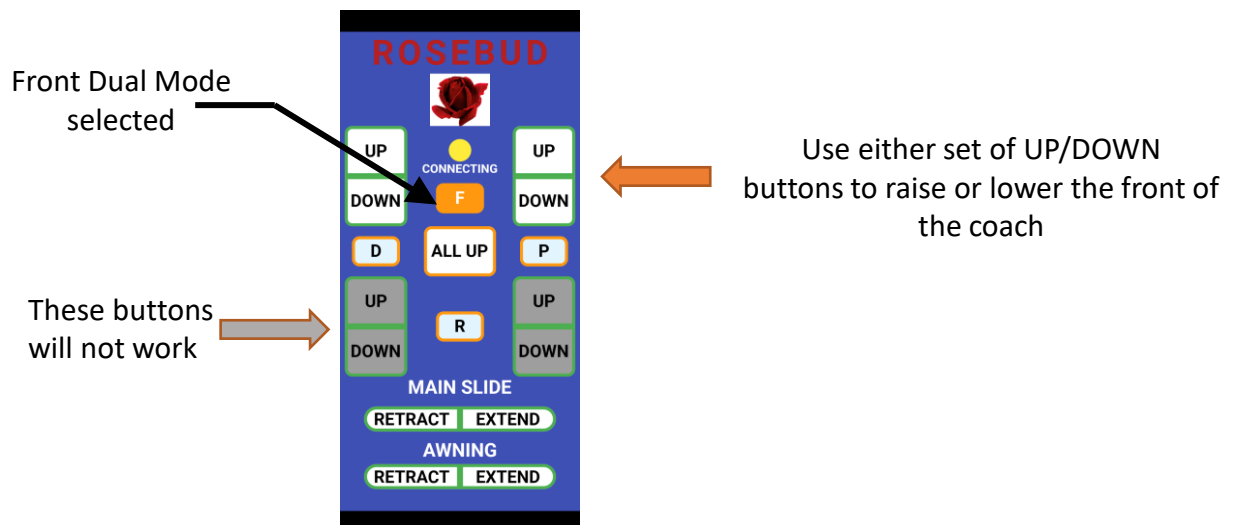

Example of dual mode for the FRONT jacks

ROSEBUD is designed and manufactured by



ROSEBUD RV SYSTEMS LLC.

For technical support contact:  
[alan@rosebudrvsystems.com](mailto:alan@rosebudrvsystems.com)