

FRONT VIEW

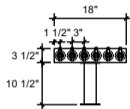

brushed ss

(just a representation of this,
may not look exactly like the rendering)

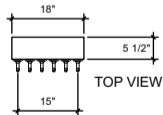
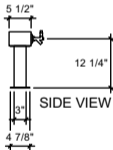

TC-6

T-Head Tower
18" x 3-1/2" x 5-1/2" 304 ss taper
head with (1) 3" ss tube with 4-7/8
ranges
brushed ss
6 products on 3" centers
cold blocked and glycol ready
304 ss faucets and screw in shanks