

FRONT VIEW

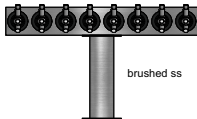

brushed ss

(just a representation of this,
may not look exactly like the rendering)

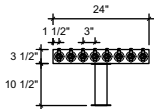

TC-8-24

T-Head Tower

24" x 3-1/2" x 5-1/2" 304 ss taper

head with (1) 3" ss tube with 4-7/8

inches

brushed ss

8 products on 3" centers

cold blocked and glycol ready

304 ss faucets and screw in shanks

