

### FRONT VIEW

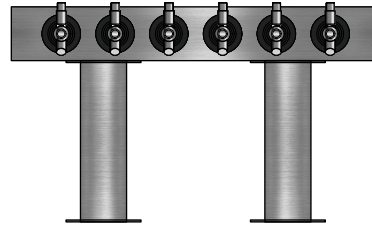

(just a representation of this,  
may not look exactly like the rendering)

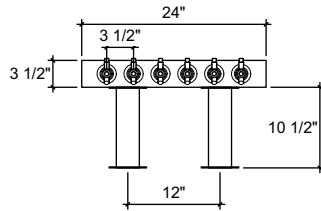

#### TTC-6

double pedestal T-Head Tower  
24" x 3-1/2" x 5-1/2" 304 ss taper  
head with (2) 3" ss tubes with 4-7/8  
flanges  
brushed ss  
6 products on 4" centers  
cold blocked and glycol ready  
304 ss faucets and screw in shanks

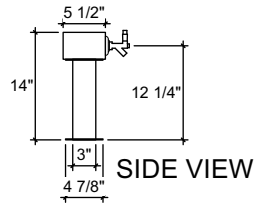

### SIDE VIEW

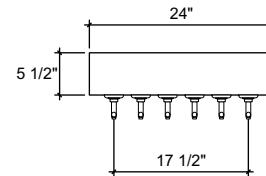

### TOP VIEW