

FRONT VIEW

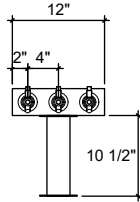

brushed ss

(just a representation of this,
may not look exactly like the rendering)

SIDE VIEW

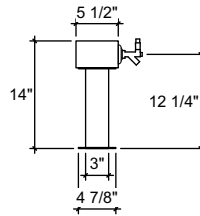

SQ-TC-3

Square T-head tower
12" x 3-1/2" x 5-1/2" 304 ss taper
head with
(1) 3" ss square tube leg with square
4-7/8" flange
brushed ss
3 products on 4" centers
cold blocked and glycol ready
304 ss faucets and screw in shanks

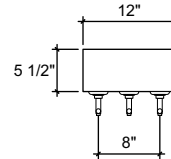

TOP VIEW