

Contact our experts
support@raynic.com

CR1005

Extra Large Digital Calendar Clock With Thermometer
THE BEST CHOICE FOR YOUR HOME

[Http://www.raynic.com](http://www.raynic.com)



Version 1.1

Chapter 1 LOCATION OF CONTROLS

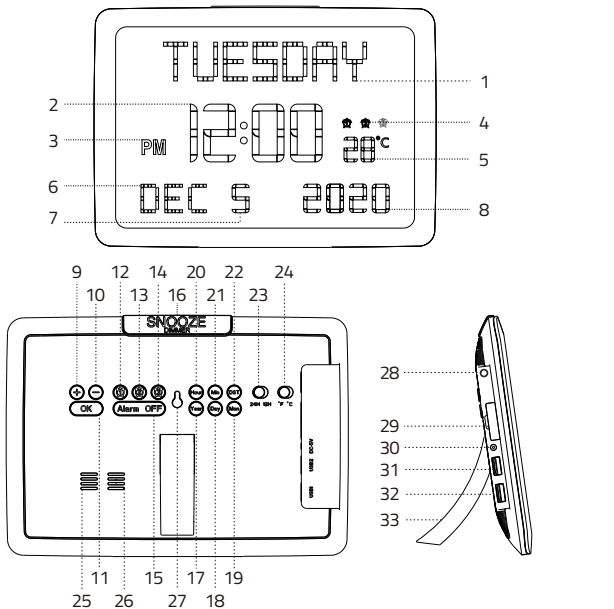

- | | | |
|--|--------------------------------|--------------------|
| 1. WEEK DISPLAY | 2. TIME DISPLAY | 3. AM/PM INDICATOR |
| 4. ALARM 1 / ALARM 2 / ALARM 3 INDICATOR | 5. TEMPERATURE DISPLAY | |
| 6. MONTH DISPLAY | 7. DATE DISPLAY | 8. YEAR DISPLAY |
| 9. NEXT BUTTON | 10. PREV BUTTON | 11. SAVE BUTTON |
| 12. ALARM 1 BUTTON | 13. ALARM 2 BUTTON | 14. ALARM3 BUTTON |
| 15. ALARM OFF BUTTON | 16. SNOOZE / DIMMER BUTTON | |
| 17. YEAR BUTTON | 18. DAY BUTTON | 19. MONTH BUTTON |
| 20. HOUR BUTTON | 21. MINUTE BUTTON | 22. DST BUTTON |
| 23. 24 HOUR / 12 HUOR SWITCH BUTTON | | |
| 24. FAHRENHEIT / CELSIUS SWITCH BUTTON | | |
| 25. SPEAKER | 26. HEAT EMISSION HOLE | 27. HANGING HOLE |
| 28. TEMPERATURE INDUCTOR | 29. BACKUP BATTERY COMPARTMENT | |
| 30. DC POWER INPUT INTERFACE | 31. USB OUTPUT CHARGER | |
| 32. USB OUTPUT CHARGER | 33. BRACKET | |

Chapter 2 INSTALLATION

How to Install Clock on wall with mounting rackets

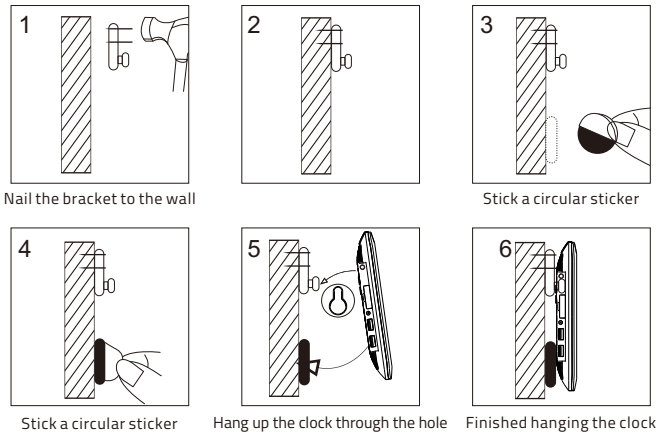

How to Install Clock with Support Brackets

Just follow these two steps to make your clock stand firmly:

Step 1: The top, bottom, left and right points of the bracket should be pressed into the groove completely (see picture 1 below).

Please note: Be sure to press all four points into the groove.

Step 2: After the four points are pressed into the groove, then slide the bracket up (see picture 2 below).

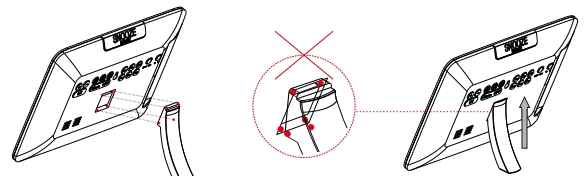

When you can hear the "Ka" sound, it means the installation is successful! Otherwise, please reinstall.

Chapter 3 POWERING ON

1. Install the CR2032 battery into the backup battery compartment.
The battery only saves the time and settings in case of power outage.
2. Plug in power adapter. The device will turn on and the display will show as below.

Chapter 4 TIME SETTING

1. Press once **Hour** to maintain **12:00** hour time flashing.
2. Press **+** to increase hour. Press **-** to reduce hour.
3. When you finish the hour adjustment. Press **OK** to confirm the hour setting.
4. **12:00** Minute time start flashing.
5. Press **+** to increase minute. Press **-** to reduce minute.
6. When you finish the minute adjustment. Press **OK** to save all of above settings.

- Note. 1. If you want to set minute directly. Just press **Min**.
2. Hold press **+** **-** to adjust automatically.

TIME FORMAT SWITCH

If you want to switch 24hour/12hour. Just slide  .

- 03 -

Chapter 5 YEAR/MONTH/DAY SETTING

1. Press once **Year** to maintain **2020** year flashing.
2. Press **+** to increase year. Press **-** to reduce year.
3. When you finish the year adjustment. Press **OK** to save the setting.
4. Press once **Mon** to maintain month **DEC** flashing.
Other setting is same as <2><3>.
5. Press **Day** to maintain date **5** flashing.
Other setting is same as <2><3>.

Chapter 6 ALARM SETTING

1. Press **Alarm**, The display shows default time **6:00**.
2. Press **Hour** to set alarm hour. **6:00** hour time start flashing. Press **+** **-** to adjust hour. Press **OK** to confirm.
3. **6:00** White minute start flashing. Press **Min** to adjust minute. Press **OK** to confirm.
4. The display shows **VOL-10**, Press **+** **-** to adjust alarm volume. Press **OK** to confirm.
5. The display shows **MON-SUN**, Press **+** **-** to adjust alarm period range. MON - SUN / MON- FRI / SAT - SUN. Press **OK** to save all of above settings.

- 04 -







Chapter 7 TURN OFF ALARM

Temporarily turn off alarm

When the Alarm sounds, you can do either way:

- A) Press **SNOOZE** to temporarily turn the alarm off for 9 minutes, then it will alarm again for each next 9 minutes.
- B) Press **ALARM OFF** to turn the alarm off for 24 hours.
You will see the alarm indicator is still on, indicating the alarm setting is still active and will sound again after 24 hours.

Cancel the alarms

- C) To cancel all the three alarms, hold press **ALARM OFF**.
All of alarms will be canceled.  alarm indicator don't show on the display.
- D) To separately cancel any of the alarms, Press  or  or  Then press **ALARM OFF**. The indicator light of your selected alarm ( or  or ) will be turn off. means the alarm has been canceled successfully.

Chapter 8 DIMMER

Repeatedly press **DIMMER** to adjust the brightness of display.

Adjust from the dimmest level to the brightest level as below:
DIMMER 1 → DIMMER 2 → DIMMER 3 → DIMMER 4 → DIMMER 5.

- 05 -

Chapter 9 TEMPERATURE

TEMPERATURE FORMAT SWITCH

If you want to switch Fahrenheit / Celsius. Just slide  .

IMPORTANT REMINDER

1. It may take 1 minute for the temperature sensor to complete the initialization.
2. Accuracy of thermometer is 1 degree Celsius.
3. There might be 1-3 degrees Celsius deviation within normal limits due to unstable air flow and room heating.

Chapter 10 USB CHARGING

Plug USB charging cable into device and phone or tablet.
Device can charge both phones or tablets at the same time.
The maximum charge current is 1 Ampere.

Chapter 11 USB CHARGING

For Temporary Time Storage Only, Cannot replace AC POWER.
Install 1 piece of CR2032 coin cell to the proper terminals in the battery compartment.

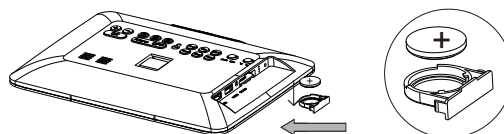

Chapter 11 DST SWITCH

Press once **DST**. An hour will be added to the current time. Press again to turn off DST.

- 06 -