

How do I measure?

Whether it's designing your dream kitchen from scratch or remodeling an existing one, the best-designed plans start with the right steps. Here are some great tips for accurate measurement and space planning. Use these measurement guidelines for a more accurate design.

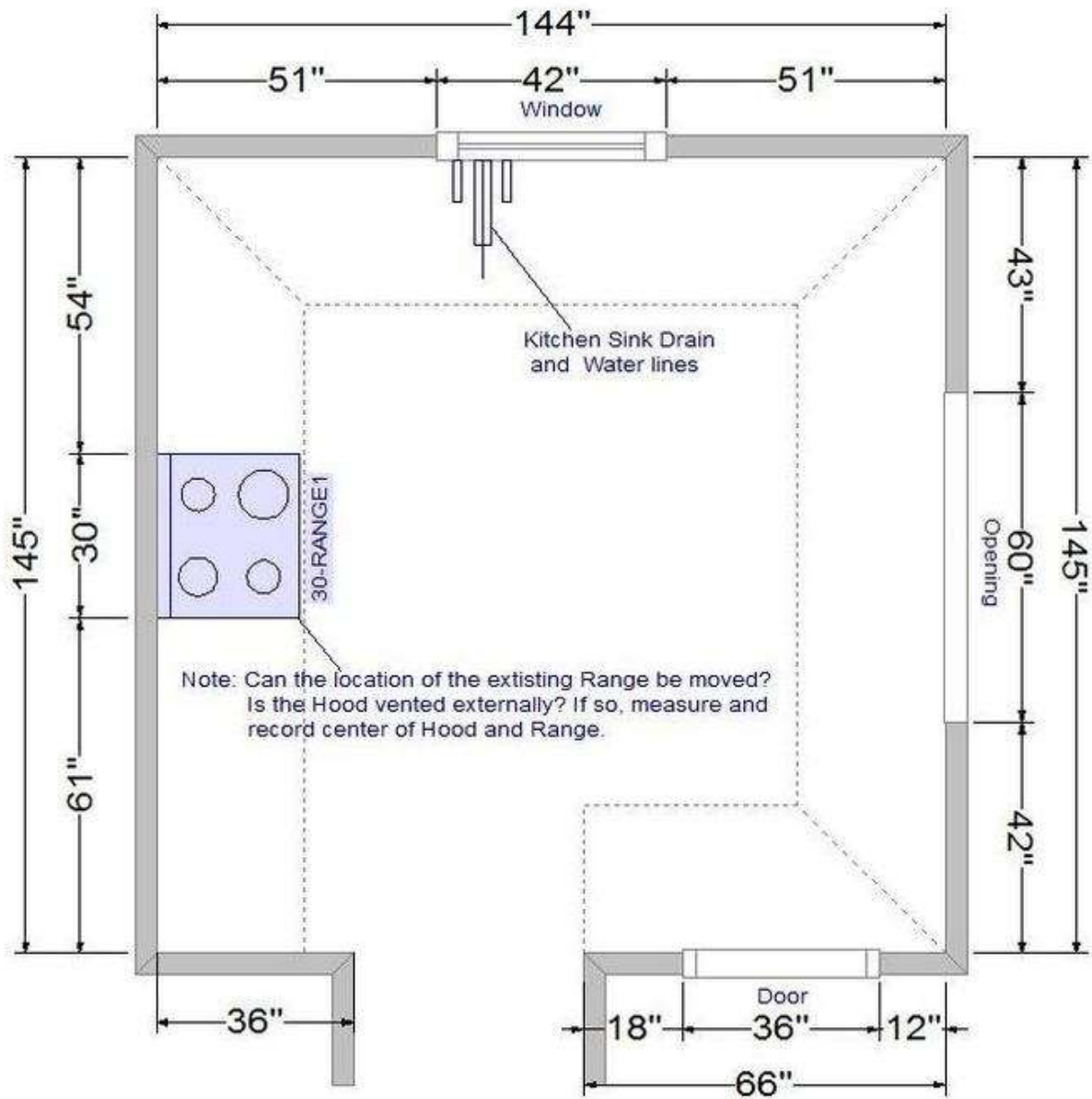

1. Begin by measuring the room from wall to wall. (It will record all measurements in INCHES.
(Example 110 ", not 9 ' 2 ").
 2. Make a rough sketch of the shape of the room. Represent every wall, door, window, and any projections or recessed areas. This plan does NOT need to be 'to scale'. Print a grid or do it by hand. Only precision counts, not talent! Measure each section of
 3. the wall and mark it on the drawing. (A wall section is from a corner to a door or window.) Measure each window and door and write down. NOTE: Windows and doors are measured from the outside edge to the outside edge of the casing or trim.
- Four.** Add up all the dimensions of each wall and verify that the total is equal to the total dimension of the wall indicated in the table. (If not, measure again!)
5. Locate the center line of the sink by measuring from a corner of the wall. Record this dimension on your preliminary drawing.

On a separate grid, take horizontal measurements of where the cabinets will be installed. See the example below:

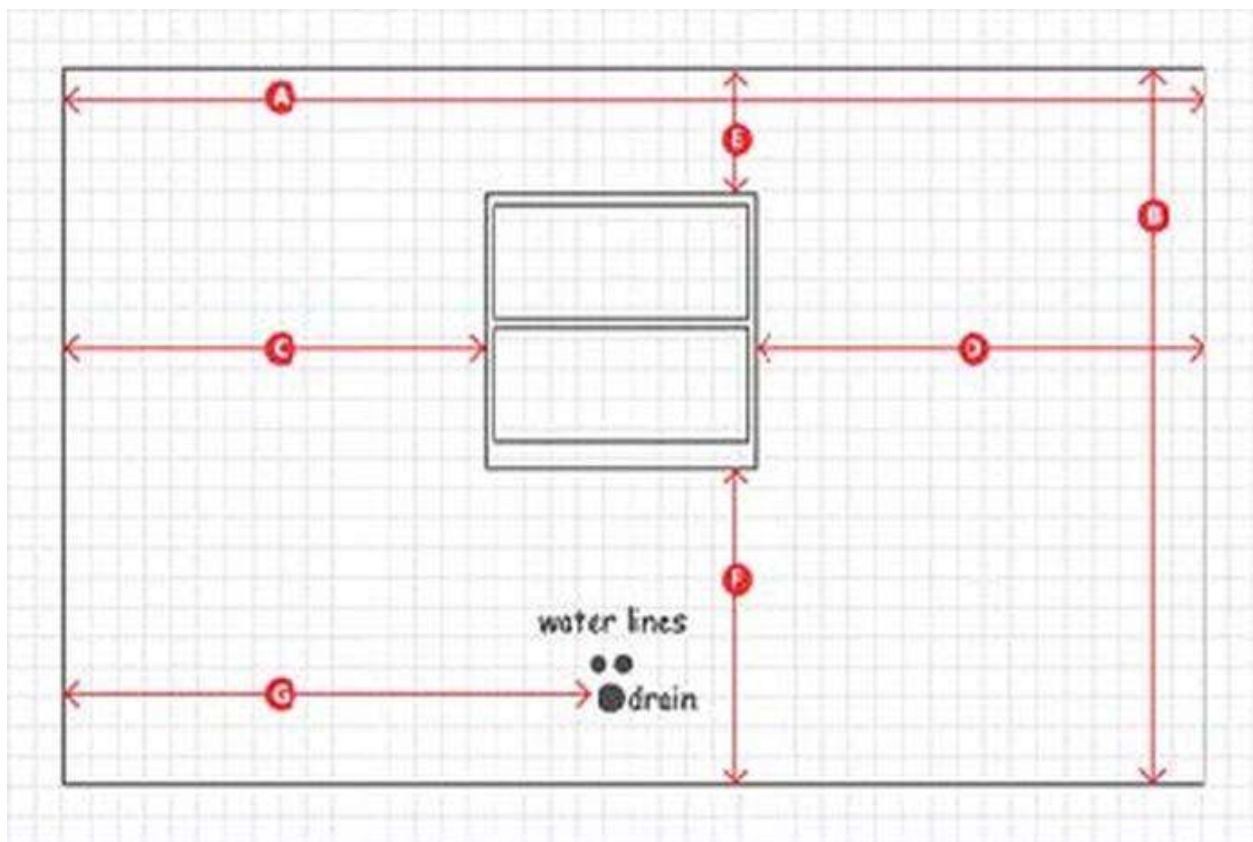

- A. Measure the entire wall from left to right.
- B. Measure from the ceiling to the floor. (Indicate if you have soffits)
- C and D. Measure horizontal wall spaces between doors, windows, wall openings, etc.

E and F. Measure vertical wall gaps above and below windows, above doors. G. Measure from a corner of the wall to the center of the sink drain and water lines.