

933

安裝說明書

Installation Introduction

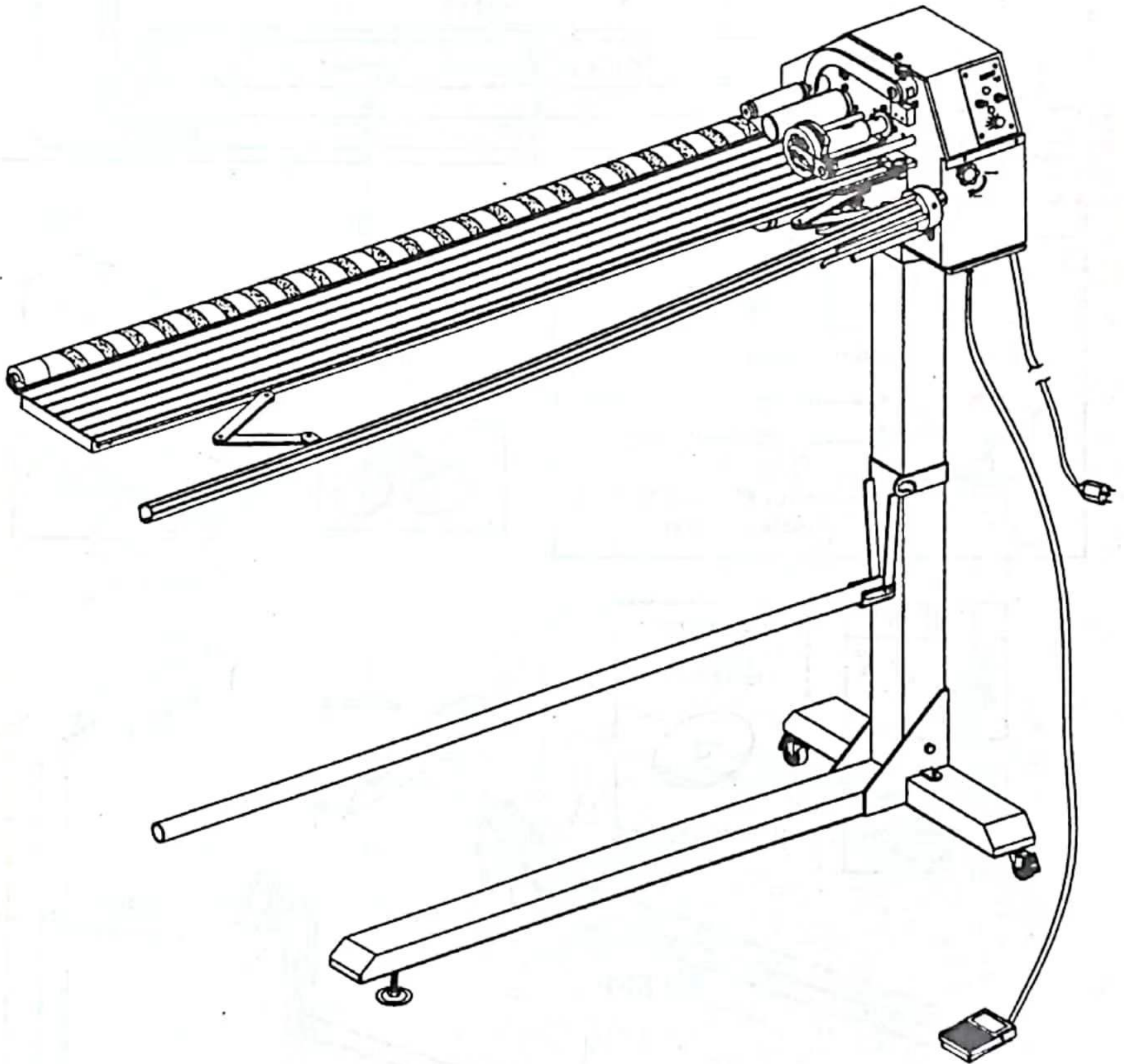



# ◎ 工具及相關零件 Tool kits & parts

## ◎ 包裝盒內位置標示 The position in the box

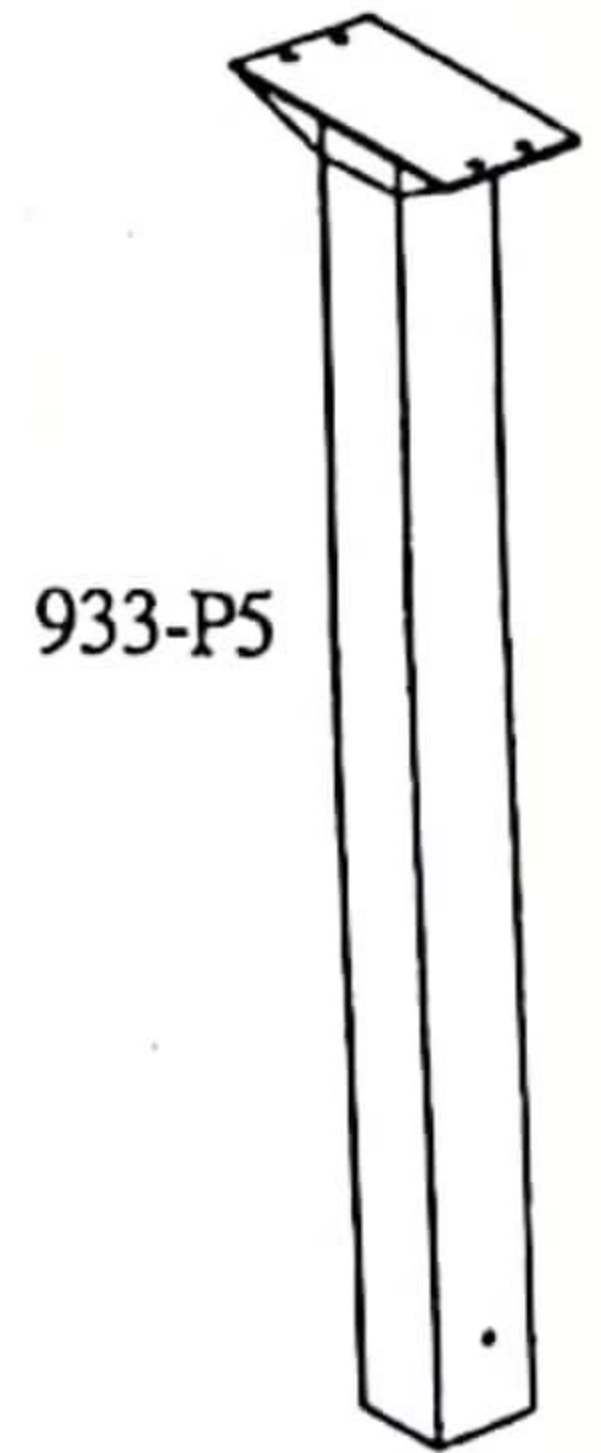
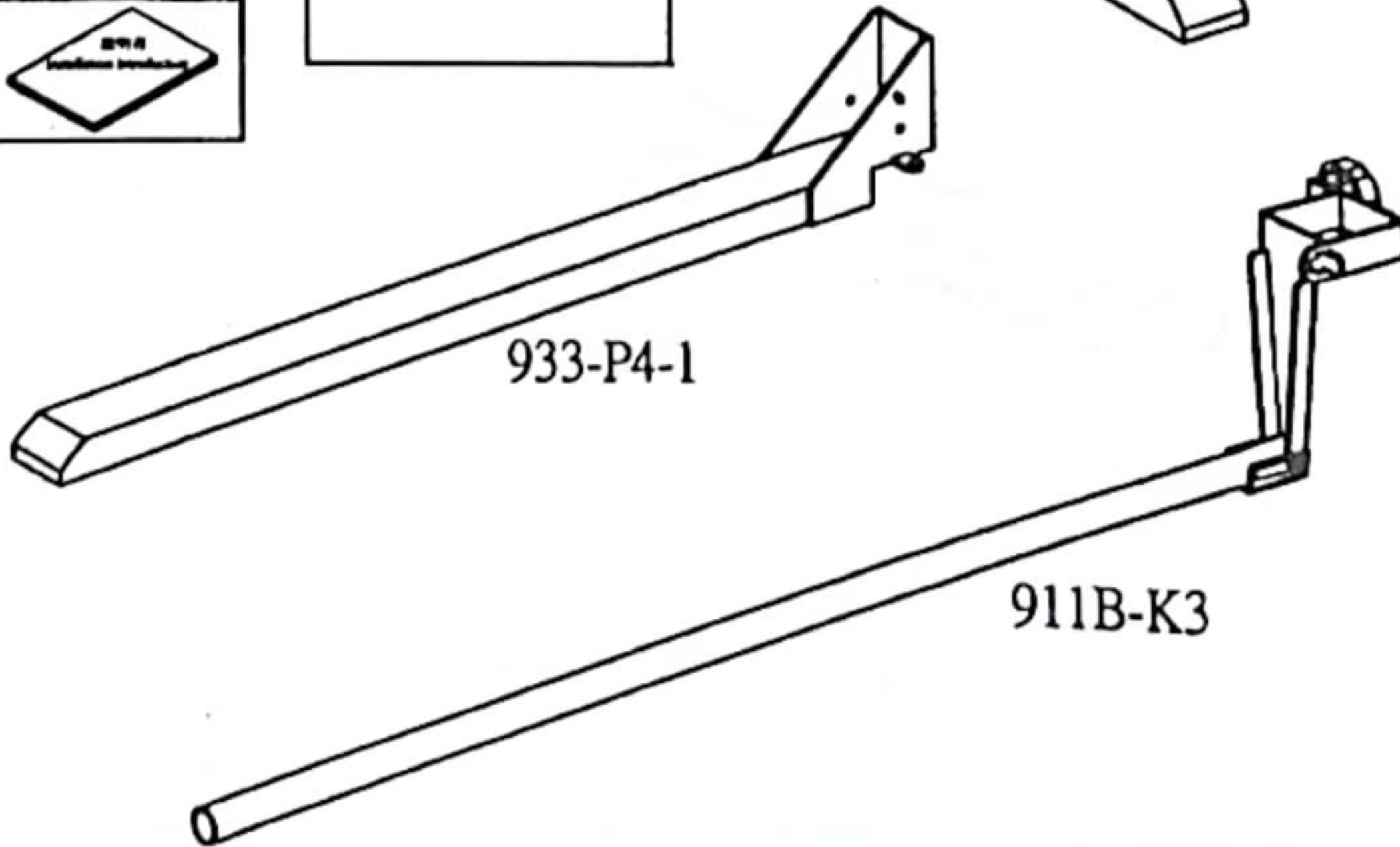
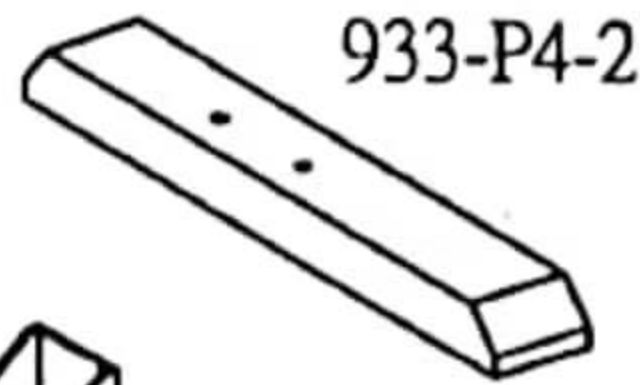
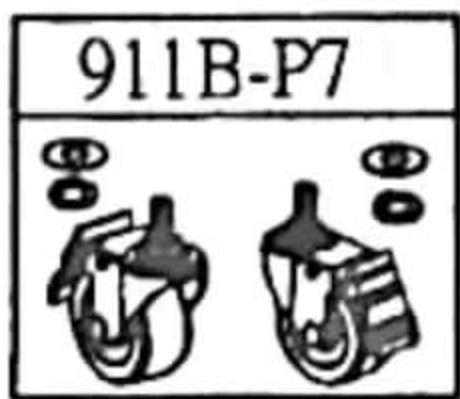
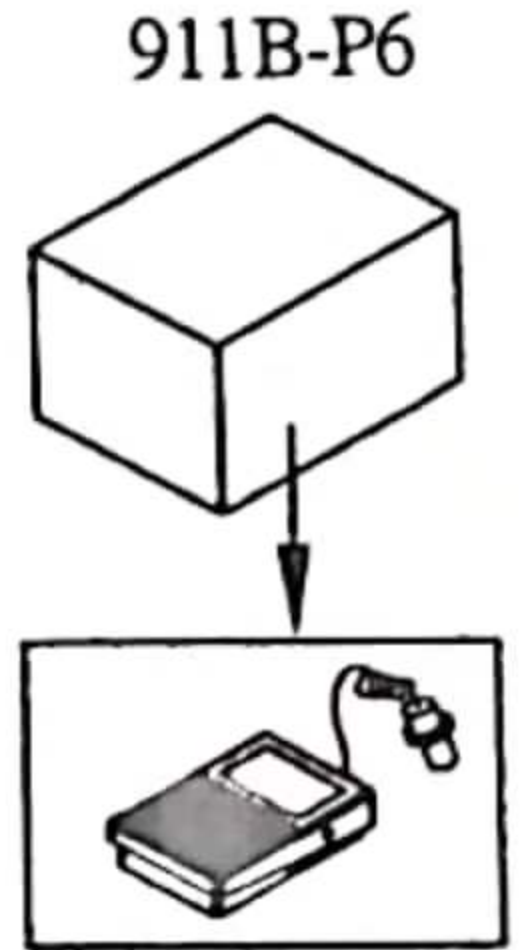
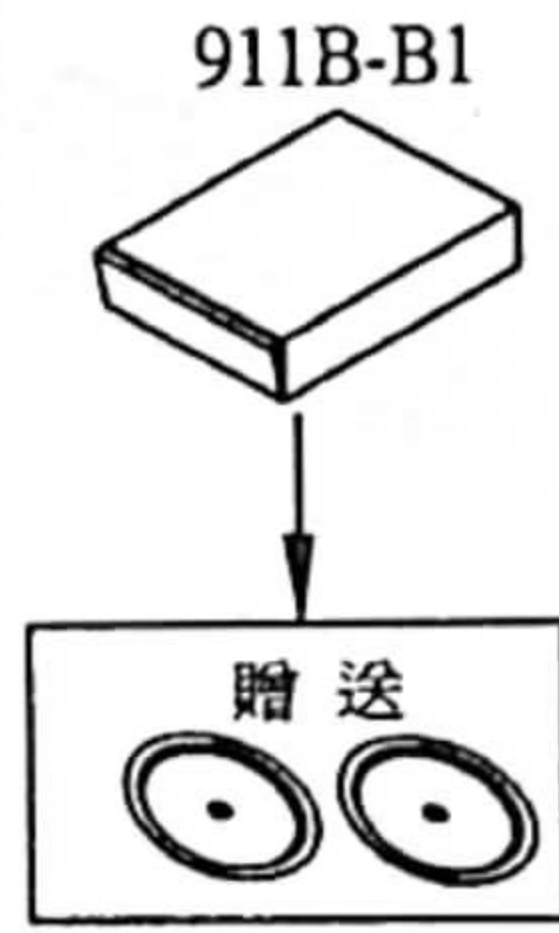
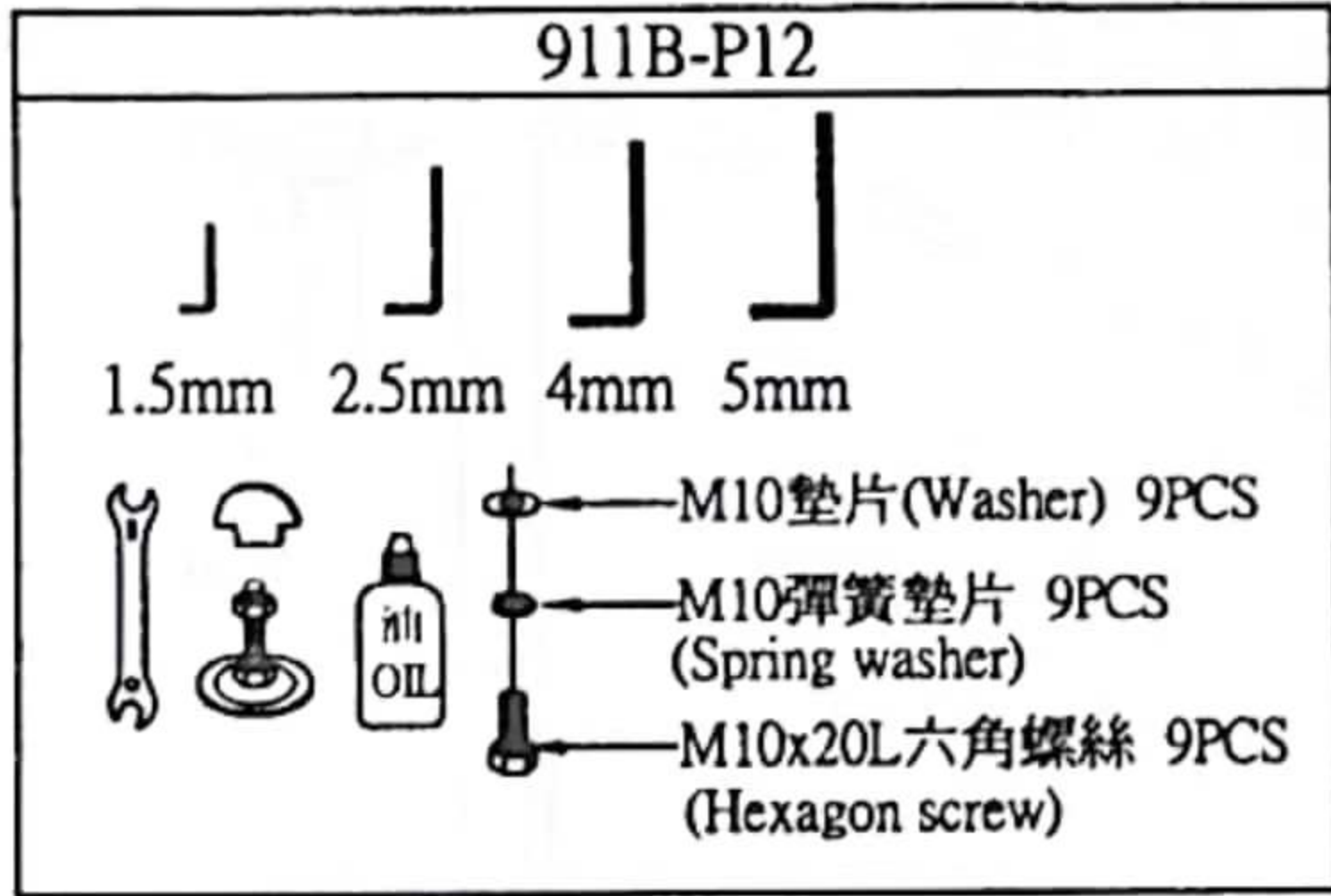
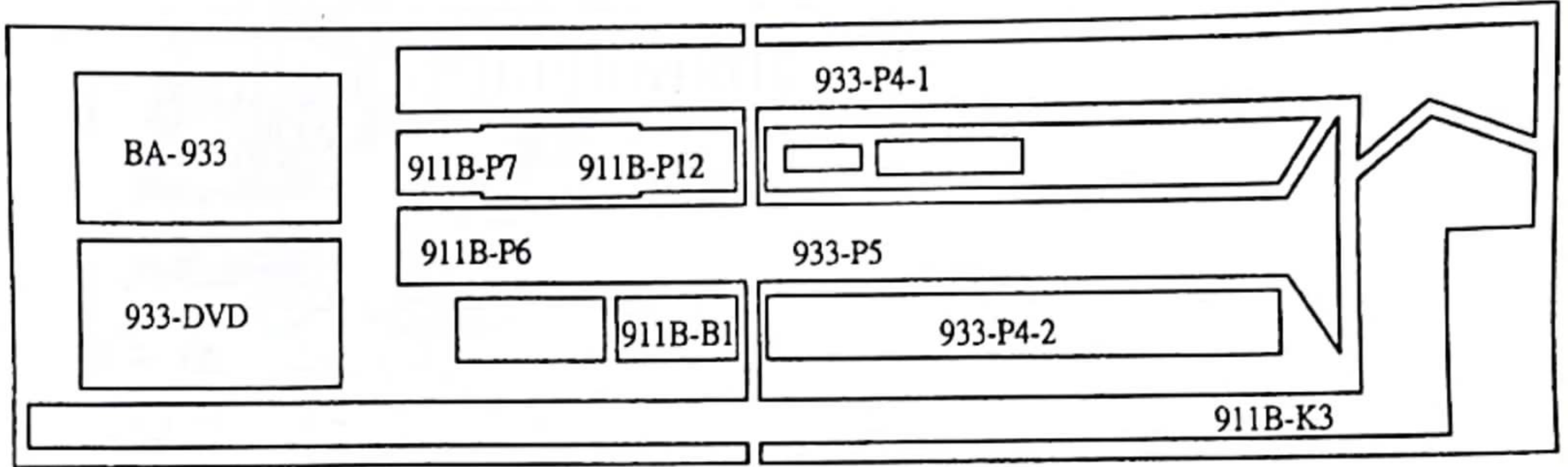



# 組 合 圖

## ASSEMBLING CHART

◎ 包裝盒內位置標示 The position in the box

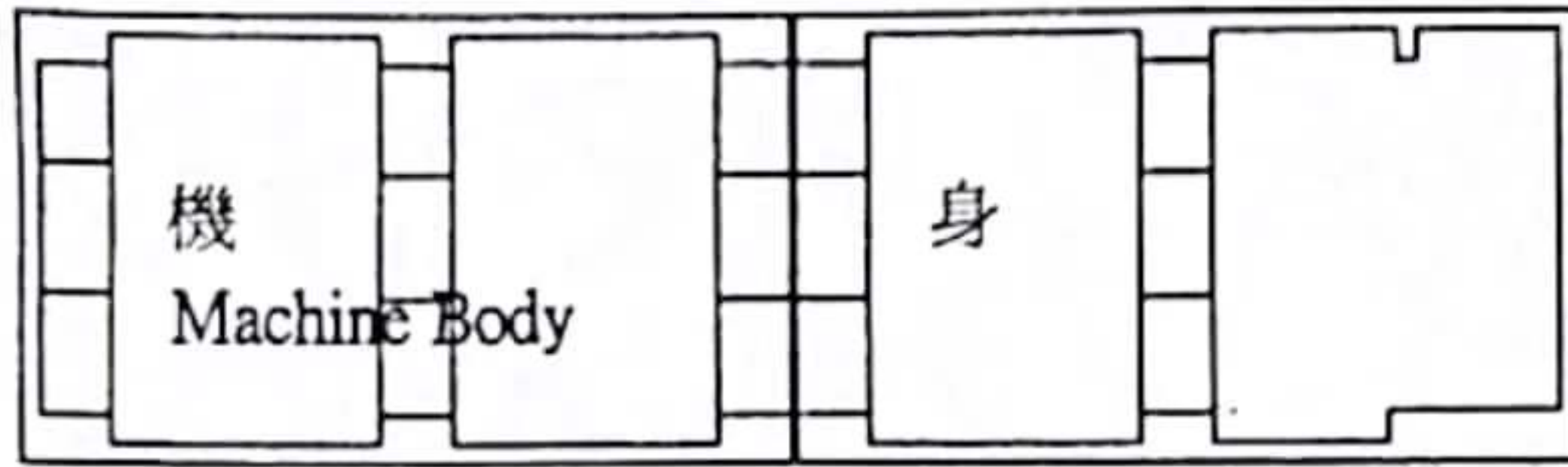

安裝輪子，用手即可。  
Install the wheels by using your hands only.

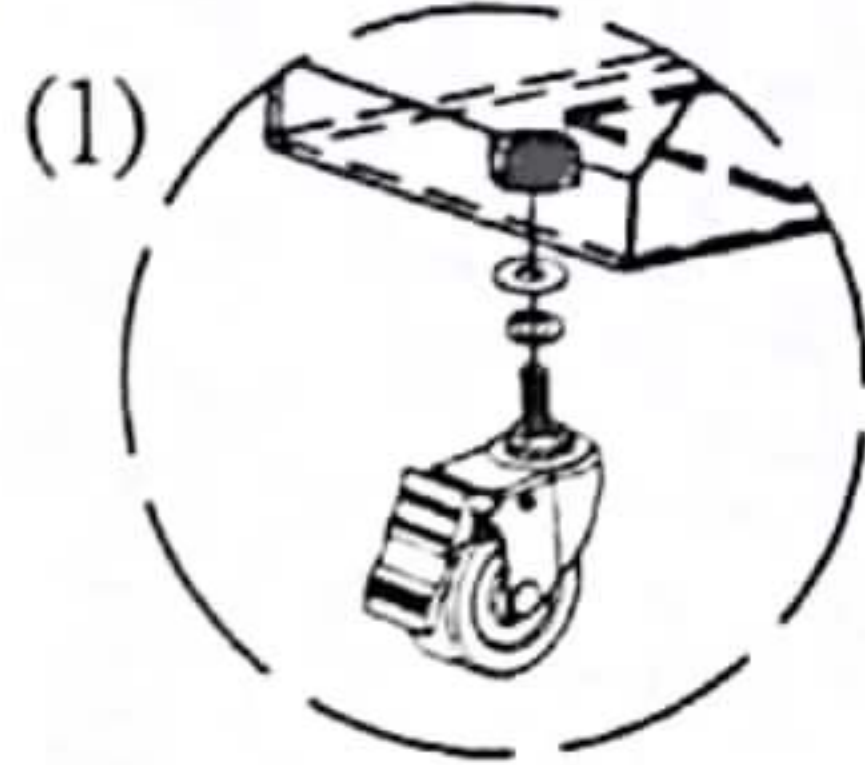

按順序將零件裝上。  
Assemble the parts in order.

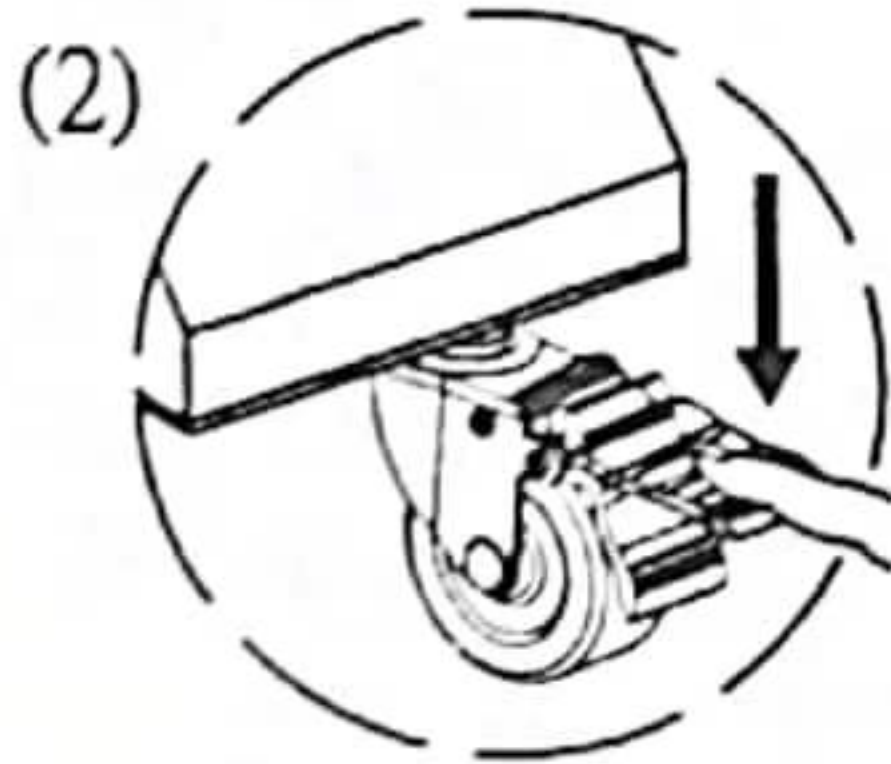

先煞車。  
Step on the brake.

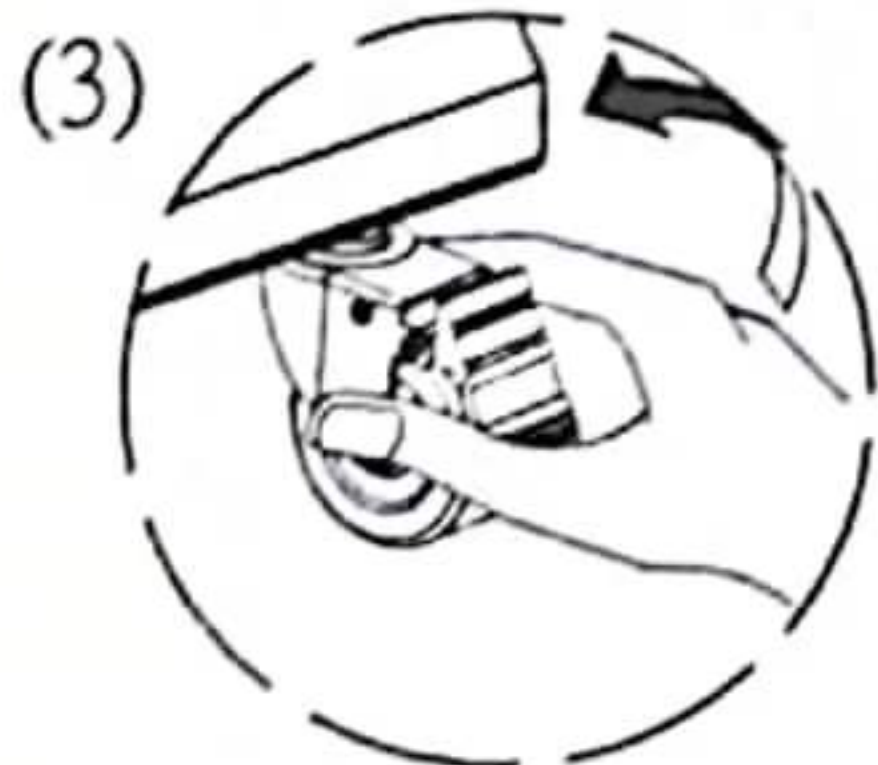

再用手鎖緊輪子。  
Fasten the wheels by hand.

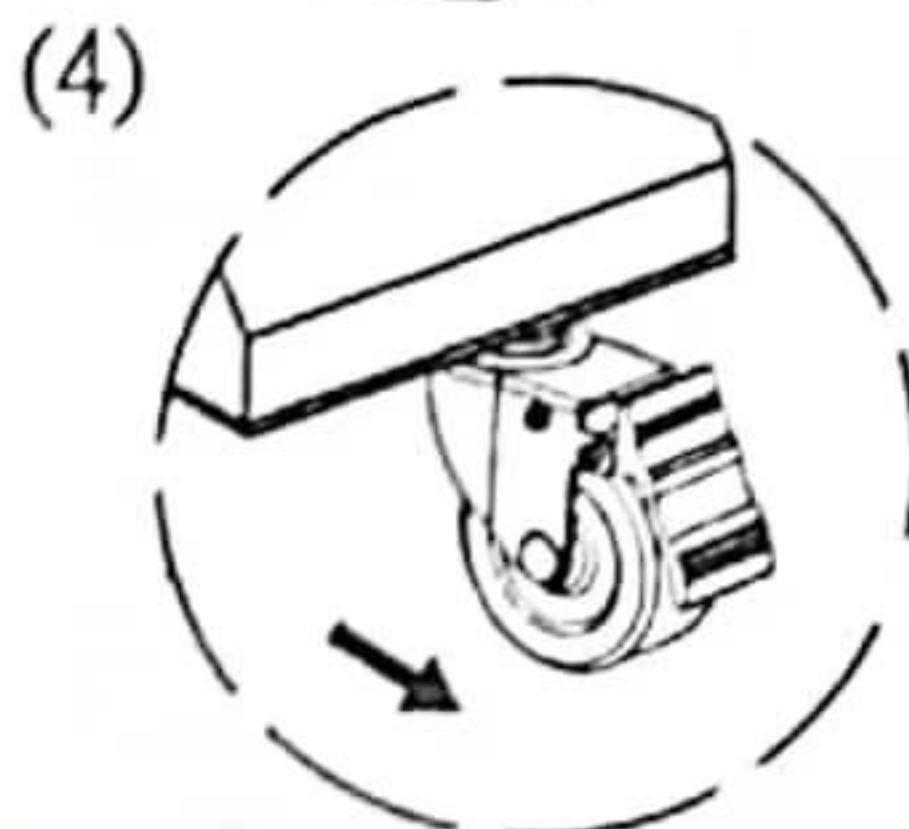

鎖緊後，輪子的方向必須朝外。  
After fastened please turn all the wheels outside.

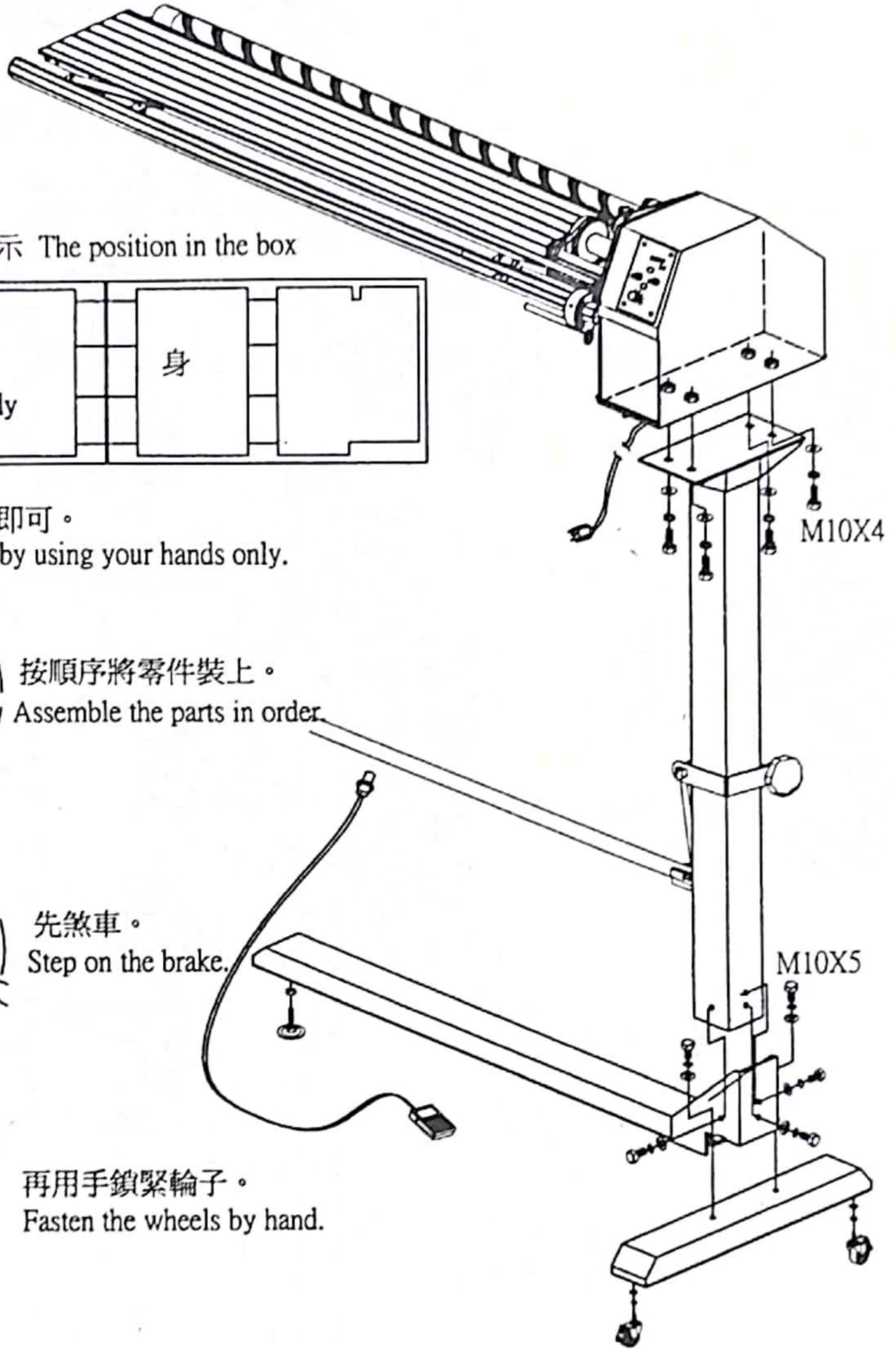



## 開機注意事項

Attention to turn on the machine.

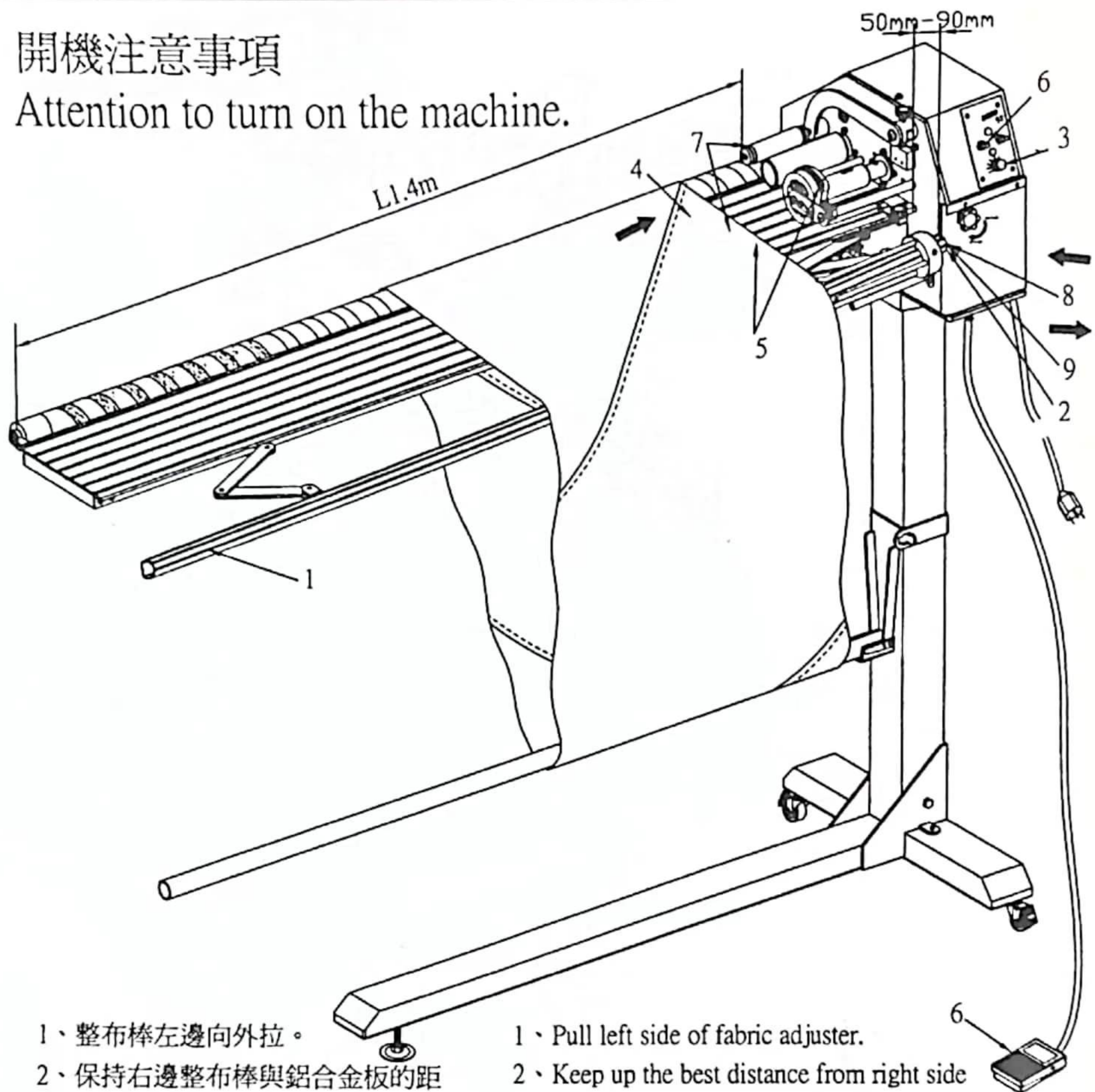

- 1、整布棒左邊向外拉。
- 2、保持右邊整布棒與鋁合金板的距離為50mm~90mm為最佳。
- 3、請先將速度調整於40-50之間再將電源開啓，並先以手動控制。
- 4、將布拉進機身。
- 5、布與刀輪對齊。
- 6、手動開關，配合腳踏板控制。
- 7、布先裁半圈(約20cm)，再捲入捲布筒。
- 8、若布進入太慢時，可將整布棒右側向內推進10mm，再將布繞一圈，若布再不進入再往內慢慢推進。
- 9、若布進入太快時，請將整布棒右側向外拉出10mm。

- 1、Pull left side of fabric adjuster.
- 2、Keep up the best distance from right side of fabric adjuster to aluminum board is 50mm~90mm.
- 3、Please make sure the speed is at 40-50 before turn on. And control advance by manual.
- 4、Put one piece of fabric into the machine body.
- 5、Please make sure fabric and blades are parallel.
- 6、Manual switch operate with foot pedal.
- 7、Cut the fabric about 20cm then rolled onto the fabric reel.
- 8、If the fabric enters slowly please push the fabric adjuster 10mm. Then roll the fabric again. If the fabric still can't enter please try to push the adjuster little by little.
- 9、If the fabric enters too fast please pull the fabric adjuster 10mm.



## 45度橫條平織布裁切法。

45° twill woven fabrics cut method.



圖1  
Figure 1

圖2  
Figure 2

圖3  
Figure 3

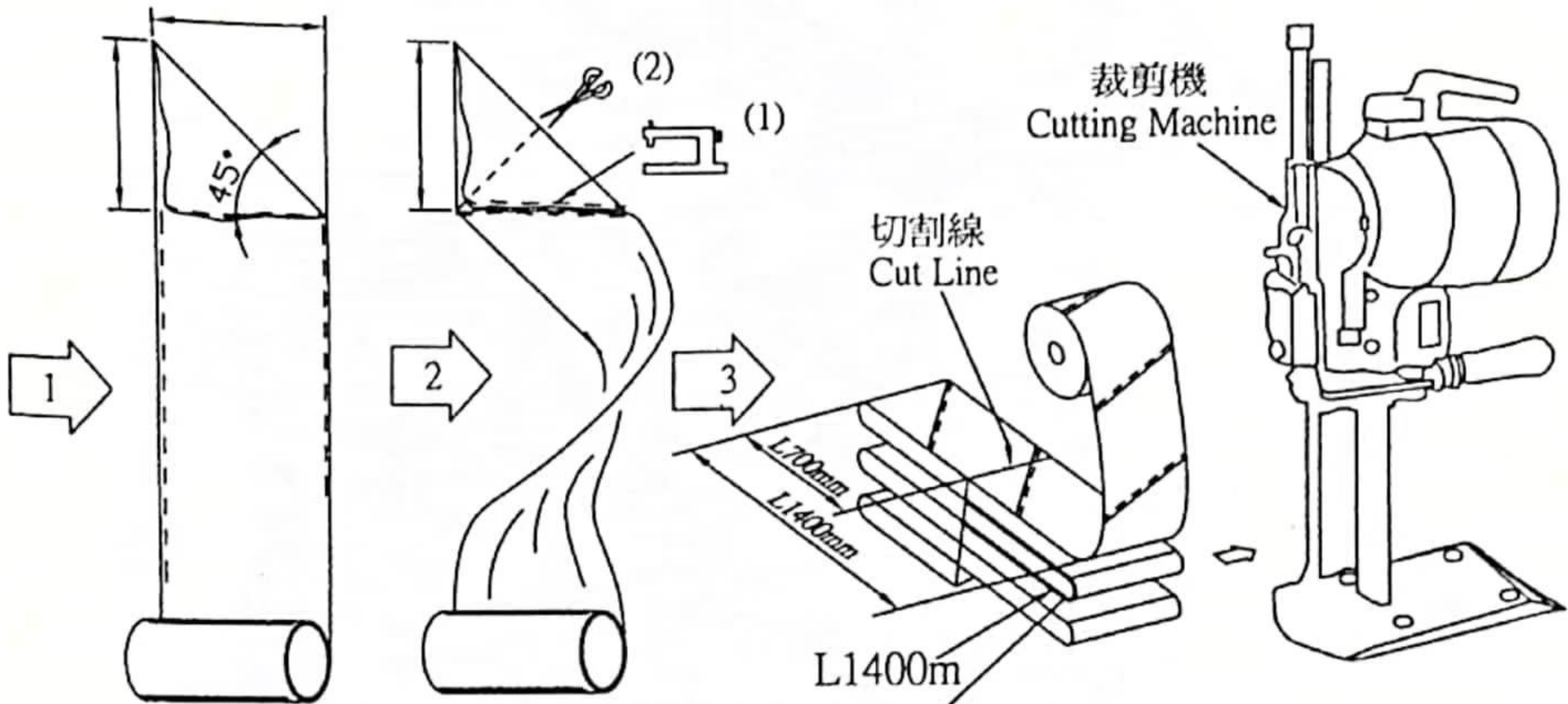

圖4  
Figure 4

A、準備布匹。 Prepare fabric.

B、依圖1沿著虛線折成45度。 Fold up the dotted line into 45°.

C、(1)完成B步驟後縫合箭頭指向的虛線。(2)縫合後剪掉虛線上的三角形。

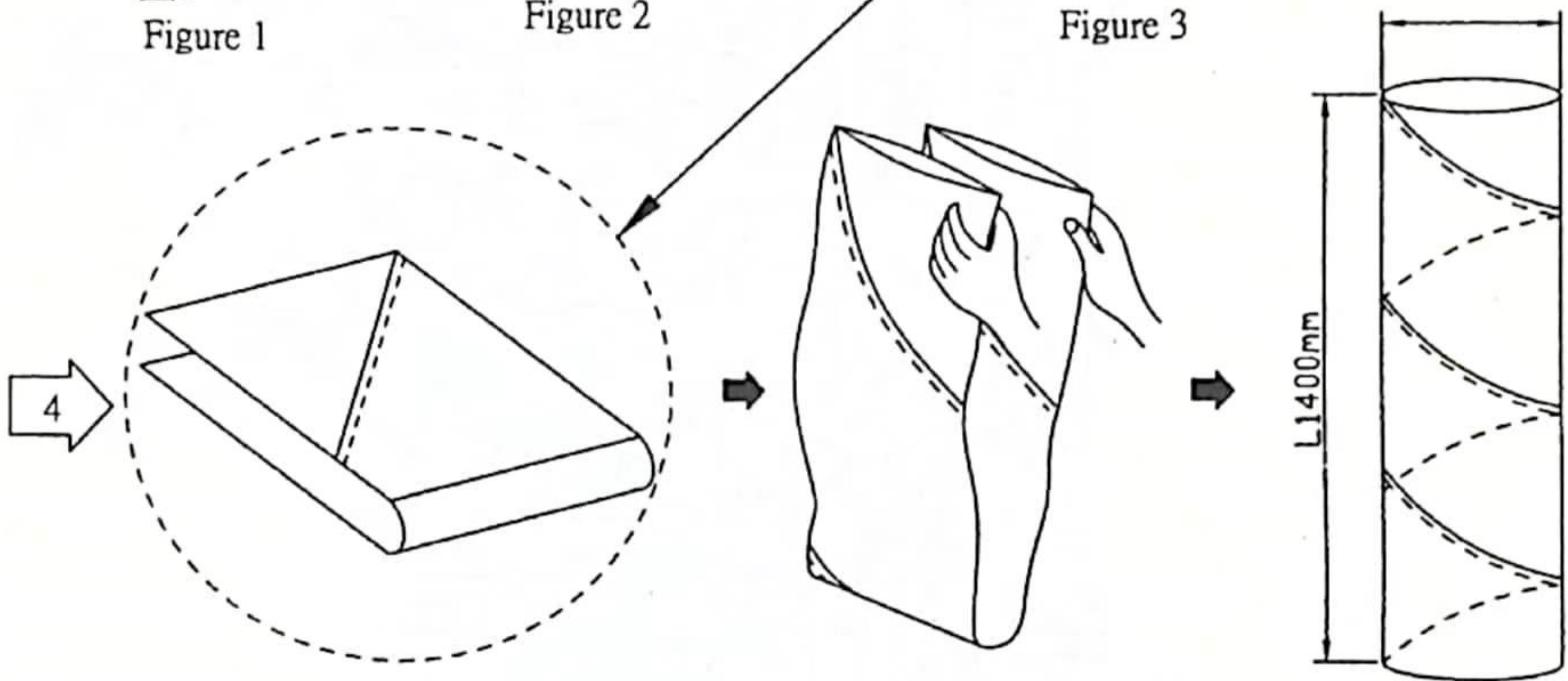
(1)Complete the step B;stitch up the dotted line which pointed by an arrowhead.

(2)After stitched up then cut the triangle form above the dotted line which pointed by a scissors.

D、將布條以每1400mm對折，用材切機從布條中間切斷如圖3，即成為圖4等長的圓筒布條。

Fold up the strip of cloth in every 1400 mm then use the machine to cut the line from the middle of cloth showed as figure 3 then it will become same length in every cylinder of cloth.







# 933零件分析圖表 933 Parts Diagram

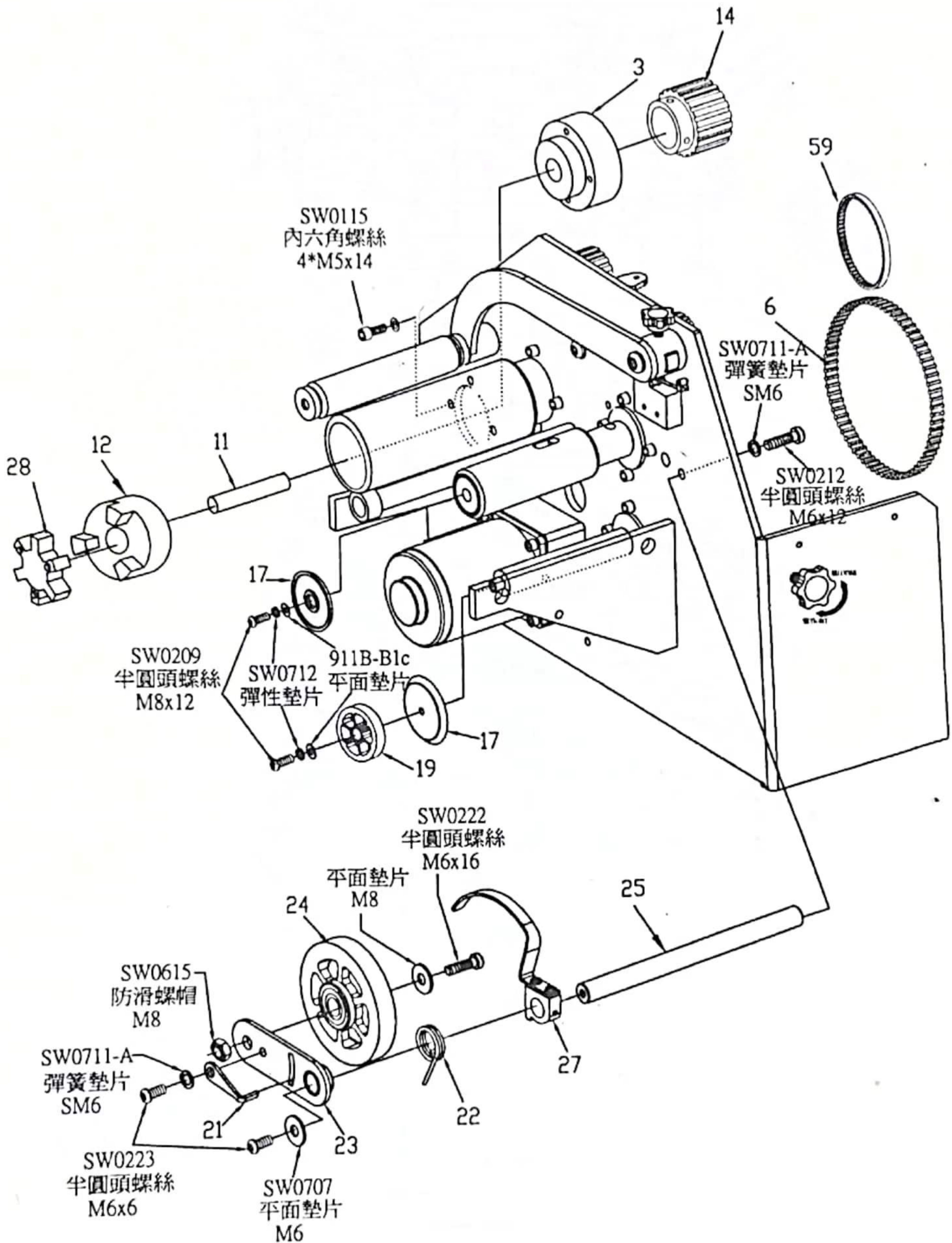



# 933零件分析圖表

## 933 Parts Diagram

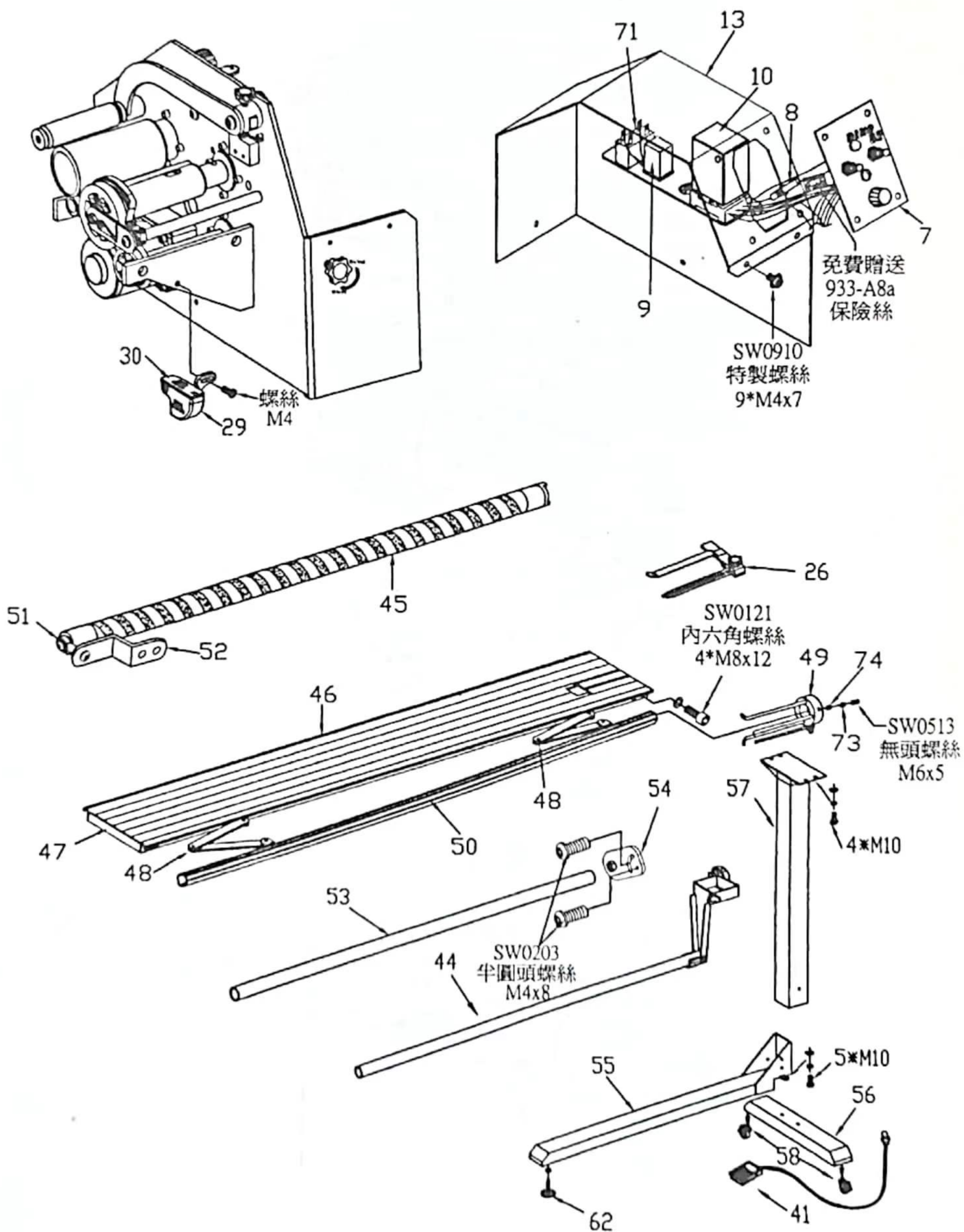



# 933零件分析圖表

## 933 Parts Diagram

| 序號<br>Ref.No. | 物料編號<br>Part.No. | 名稱<br>Description              | 單位用量<br>Amt.Req. |
|---------------|------------------|--------------------------------|------------------|
| 1             | 911B-A1          | 齒輪軸心 Gear Axle                 | 2                |
| 2             | 911B-A2a         | 培林齒輪1543 Gear's Bearing 1543   | 3                |
| 3             | 911B-A3          | 培林座 Bearing Seat               | 4                |
| 4             | 911B-A4b         | 下刀架齒輪1544 Gear's Bearing 1544  | 1                |
| 5             | 933-A5           | 皮帶調節座 Belt Adjuster Seat       | 1                |
| 6             | 933-A6-1         | 皮帶 Timing Belt 310DXL          | 1                |
| 7             | 933-A7           | 面板 Control Panel               | 1                |
| 8             | 933-A8a          | 玻璃保險絲 Fuse                     | 1                |
| 9             | 911B-A9          | 繼電器 Relay 3.5Ux60Wx5G          | 1                |
| 10            | 911B-A10a        | 馬達控制器SS22 Speed Controller     | 1                |
| 11            | 911B-A4a         | 齒輪棒 Gear Stick                 | 1                |
| 12            | 911B-M1d         | 三角連接頭(有洞) Three Feet Connector | 1                |
| 13            | 933-AD           | 外蓋 Casing                      | 1                |
| 14            | 933-F            | 齒輪21齒 Gear's Bearing 21        | 1                |
| 15            | 911B-A2          | 鎖螺絲齒輪1542 Screw's Gear 1542    | 1                |
| 16            | 933-H            | 馬達用齒輪 Motor's Gear             | 1                |
| 17            | 911B-B1          | 刀片組 Knives Set                 | 2                |
| 18            | 911B-B03         | 上刀架 Upper Knife Holder         | 1                |
| 19            | 933-B3           | 刀墊 Knife Cushion               | 1                |
| 20            | 911B-B4          | 下刀架 Lower Knife Holder         | 1                |
| 21            | 933-C3c          | 壓布輪配件C Roller's accessory C    | 1                |
| 22            | 911B-C2-A        | 保護刀組用彈簧 Spring                 | 1                |
| 23            | 933-C3           | 壓布輪桿(LS121) Roller's Shaft     | 1                |
| 24            | 933-C4           | 壓布輪 Roller                     | 1                |
| 25            | 933-C5           | 保護刀組用軸心棒 Roller's Axle         | 1                |
| 26            | 911B-C6          | 調整尺 Ruler                      | 1                |
| 27            | 933-C7           | 保護刀座組 Protection Cover's Seat  | 1                |
| 28            | 911B-C8          | 六角塑膠 Hexagon Rubber            | 1                |
| 29            | 933-C9           | 油壺 Oil Container               | 1                |
| 30            | 933-C9a          | 油壺蓋 Oil Container Cover        | 1                |
| 31            | 933-A1           | 旋鈕 Knob                        | 1                |
| 32            | 911B-E1          | 錐型套環 Cone Plug                 | 2                |
| 33            | 911B-E2          | 捲布筒 Fabric Reel                | 1                |
| 34            | 911B-E4          | 捲布器軸心 Fabric Reel's Axle       | 1                |
| 35            | 911B-E5          | 錐型彈簧 Cone Spring               | 1                |
| 36            | 933-E6           | 連桿 Link Shaft                  | 1                |
| 37            | 911B-E7          | 固定扣環 Retaining Ring            | 1                |
| 38            | 933-G            | 捲布軸 Fabric Reel's Axle         | 1                |



# 933零件分析圖表

## 933 Parts Diagram

| 序號<br>Ref.No. | 物料編號<br>Part.No. | 名稱<br>Description                 | 單位用量<br>Amt.Req. |
|---------------|------------------|-----------------------------------|------------------|
| 39            | 911B-H2          | 軸 Axle                            | 1                |
| 40            | 911B-H1          | 短軸調整環 Short Axle Adjusting Ring   | 1                |
| 41            | 911B-P6          | 腳踏開關組 Pedal Switch                | 1                |
| 42            | 933-J1A          | 馬達(110V) Motor(110V)              | 1                |
|               | 933-J2A          | 馬達(220V) Motor(220V)              | 1                |
| 43            | 933-J1B          | 齒輪箱 Gear Box                      | 1                |
| 44            | 911B-K3          | 置布器 Fabric Pressure Adjuster      | 1                |
| 45            | 933-M1-N         | 滾布棒 Fabric Roller                 | 1                |
| 46            | 911B-M2          | 鋁合金板 Aluminium Board              | 1                |
| 47            | 911B-M3          | 支撐檔片 Support Plate                | 1                |
| 48            | 911B-M4          | 翅膀 Fabric Adjuster's Rod Joint    | 2                |
| 49            | 933-M5           | 整布器 Fabric Adjuster               | 1                |
| 50            | 933-M6           | 整布棒 Fabric Adjuster               | 1                |
| 51            | VC2700E-UTE02    | 魚眼軸承 Fabric Roller's Bearing      | 1                |
| 52            | 911B-M8          | 連接片 Connector Piece               | 1                |
| 53            | 911B-M9          | 整布座支撐桿 Fabric Board Supporter Rod | 1                |
| 54            | 911B-M10         | 調節片 Adjuster Piece                | 1                |
| 55            | 933-P4-1         | 腳架 P4-1 Stand                     | 1                |
| 56            | 933-P4-2         | 腳架 P4-2 Stand                     | 1                |
| 57            | 933-P5           | 腳架 P5 Stand                       | 1                |
| 58            | 911B-P7          | 腳輪 Wheel                          | 2                |
| 59            | 933-A6-2         | 皮帶 Timing Belt 6Y4x35             | 1                |
| 60            | 933-D-1          | 固定軸 Fix Axle                      | 1                |
| 61            | 933-D            | 調節桿 Adjuster Shaft                | 1                |
| 62            | 911B-P11         | 腳墊螺絲 Staff Screw                  | 1                |
| 63            | E-7              | E型墊片 E-Type Washer                | 5                |
| 64            | SUN-05           | 彈簧 Spring                         | 1                |
| 65            | 933-A-2          | 活動輪 Moving Bearing                | 1                |
| 66            | 933-A-1          | 固定輪 Fix Bearing                   | 1                |
| 67            | 933-C            | 調節輪 Adjuster Bearing              | 1                |
| 68            | 933-D-3          | 連接桿 Connector Shaft               | 1                |
| 69            | 933-T            | 透明貼標 Clear Tape                   | 1                |
| 70            | 933-AC           | 外殼 Crust                          | 1                |
| 71            | 933-A9           | 電容器 Capacitor                     | 1                |
| 72            | 911B-A16         | 微動開關 Micro Switch                 | 1                |
| 73            | 933-M5h          | 整布器用彈簧 Fabric Adjuster's Spring   | 1                |
| 74            | 911B-M5g         | 塑鋼定位Pin Colloidal Particle Pin    | 1                |



◎選購品--增高架

Optional--Height Enhancer

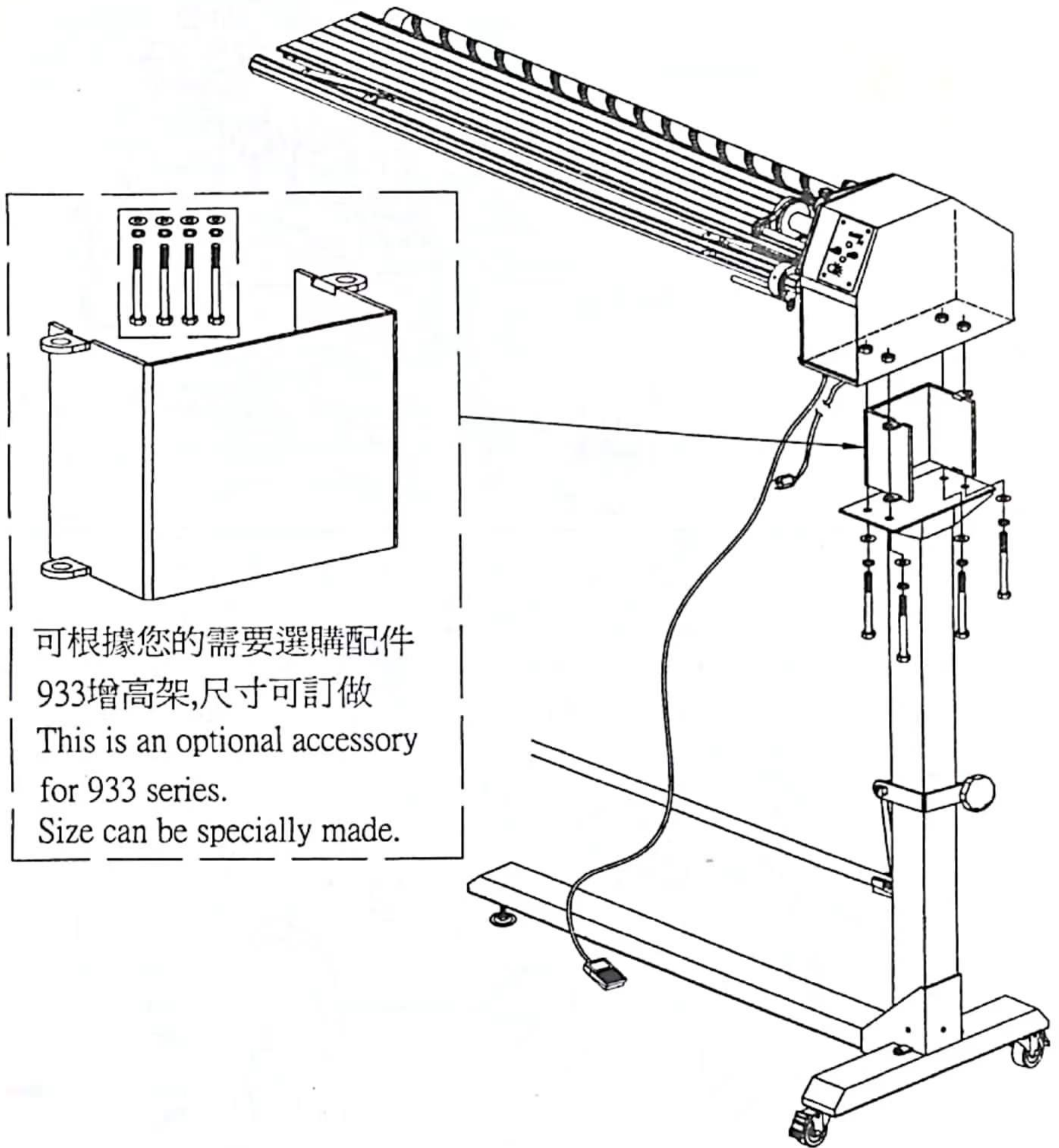



## ◎ 附錄--933上刀拆裝工具的使用方法

Appendix-A disassembles method for 933 upper knife.

1、用手推動上刀架至最頂端，使上下兩塊刀片分離，將SM-02(933上刀拆裝工具)放入孔中卡緊

1、 Push the upper knife carriage to the bottom to separate both blades.  
Put SM-02 into the hole and make sure it's lucked.

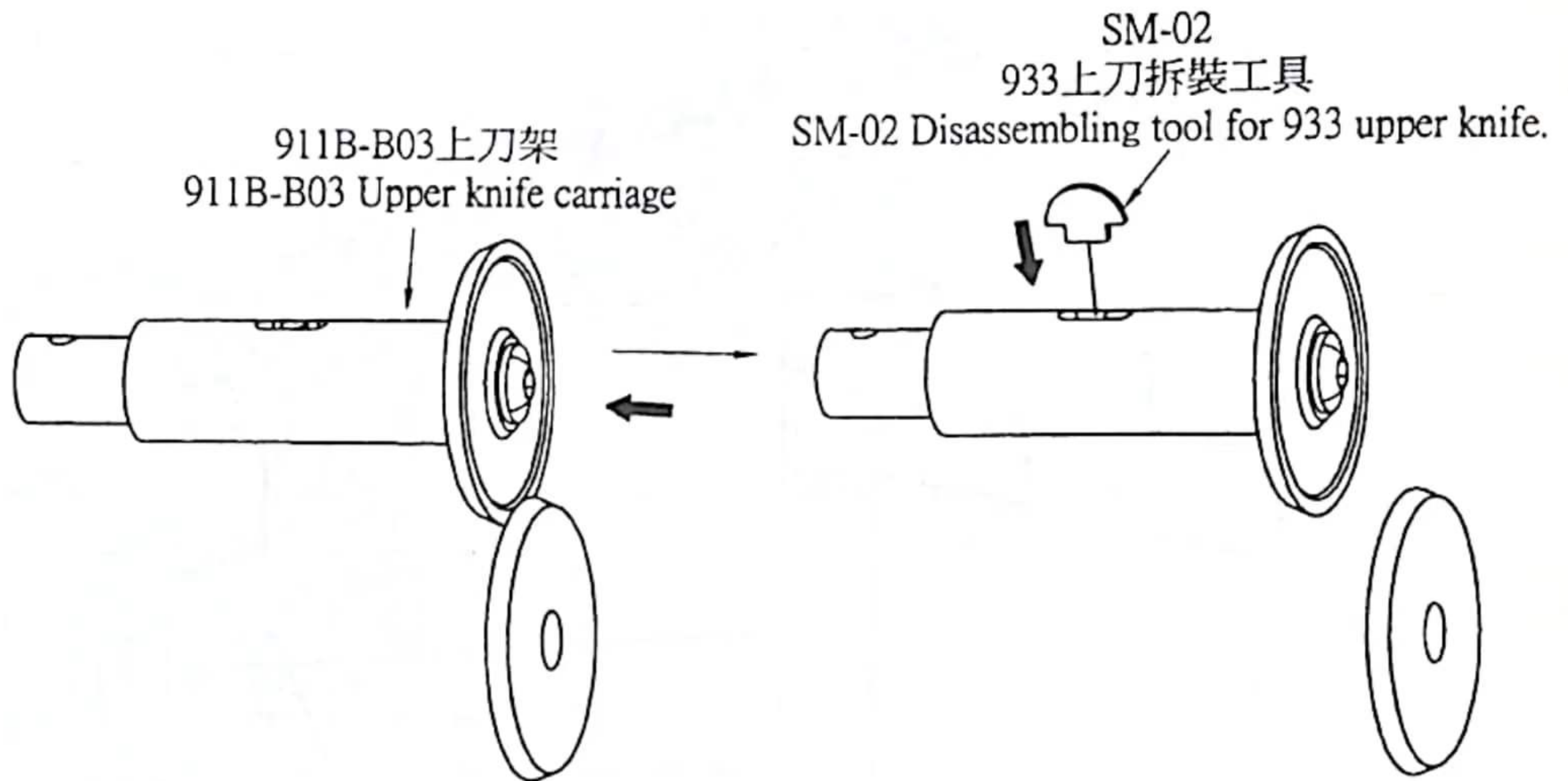

2、將十字起子套入孔中固定，再將六角扳手套入內六角螺絲，雙手用力即可鎖緊或放鬆螺絲(裝上或取下B1刀片)

2、 Insert the screw driver into the hole to fix. Use Allen Key to tighten/loosen the hexagonal bolt.(For assembling/disassembling B1 knife set)

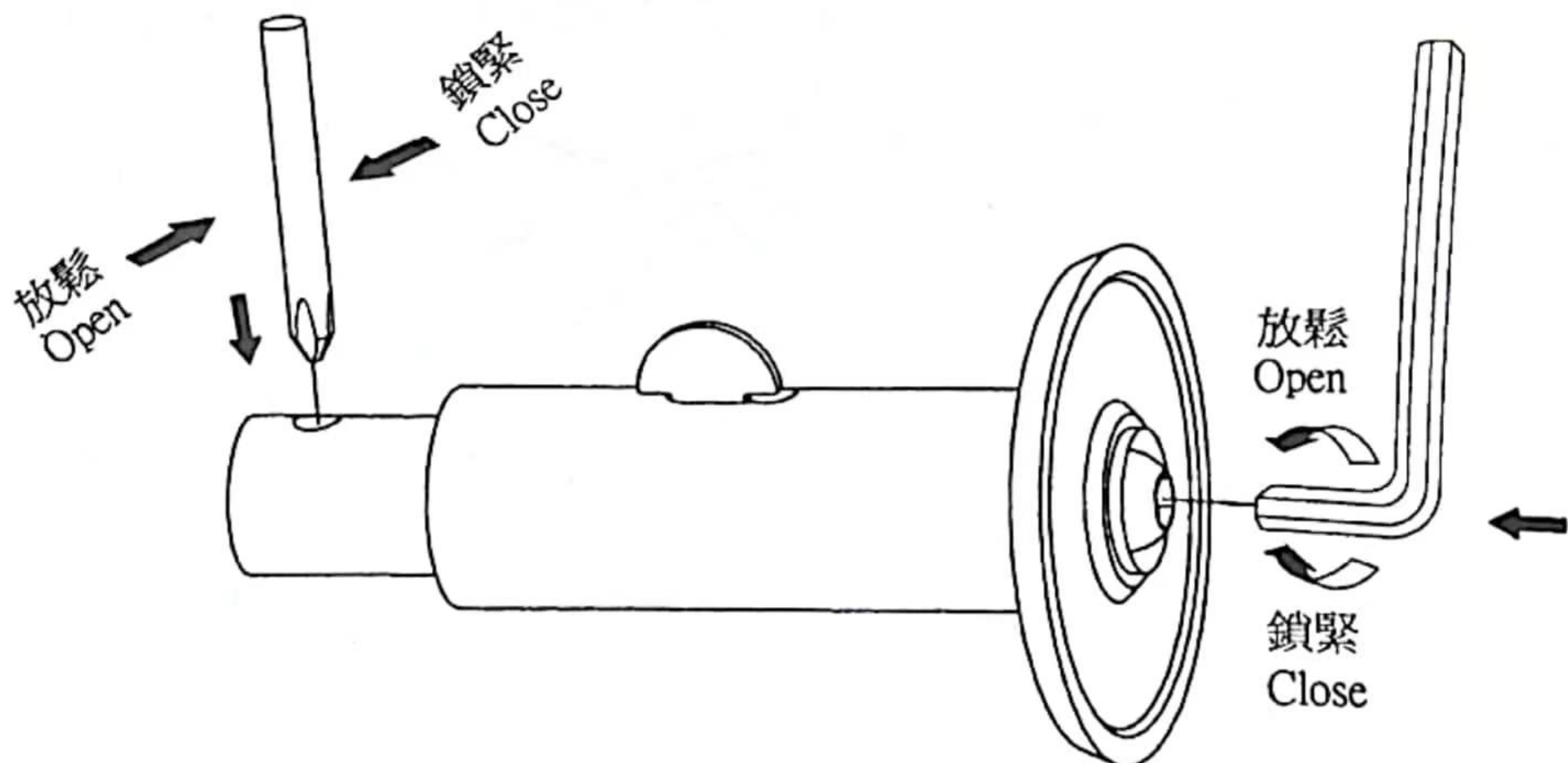



## ◎ 異常解決方法 Error Solution Method:

異常一、933調為自動時，滾布棒不動，要用手轉一下才會動？

解決：打開機殼，將馬達控制器SS22上的min（控制自動與手動）的螺絲稍往右轉一點，但不能調得太多，否則當在手動模式時也會自動的工作。

Error 一. 933-M6 doesn't work in Auto Condition but move by hand turn?

Solution: Open machine case, find speed controller SS22 and turn the "MIN" (control auto and manual) a bit right but not too much otherwise it'll work automatically in manual condition.

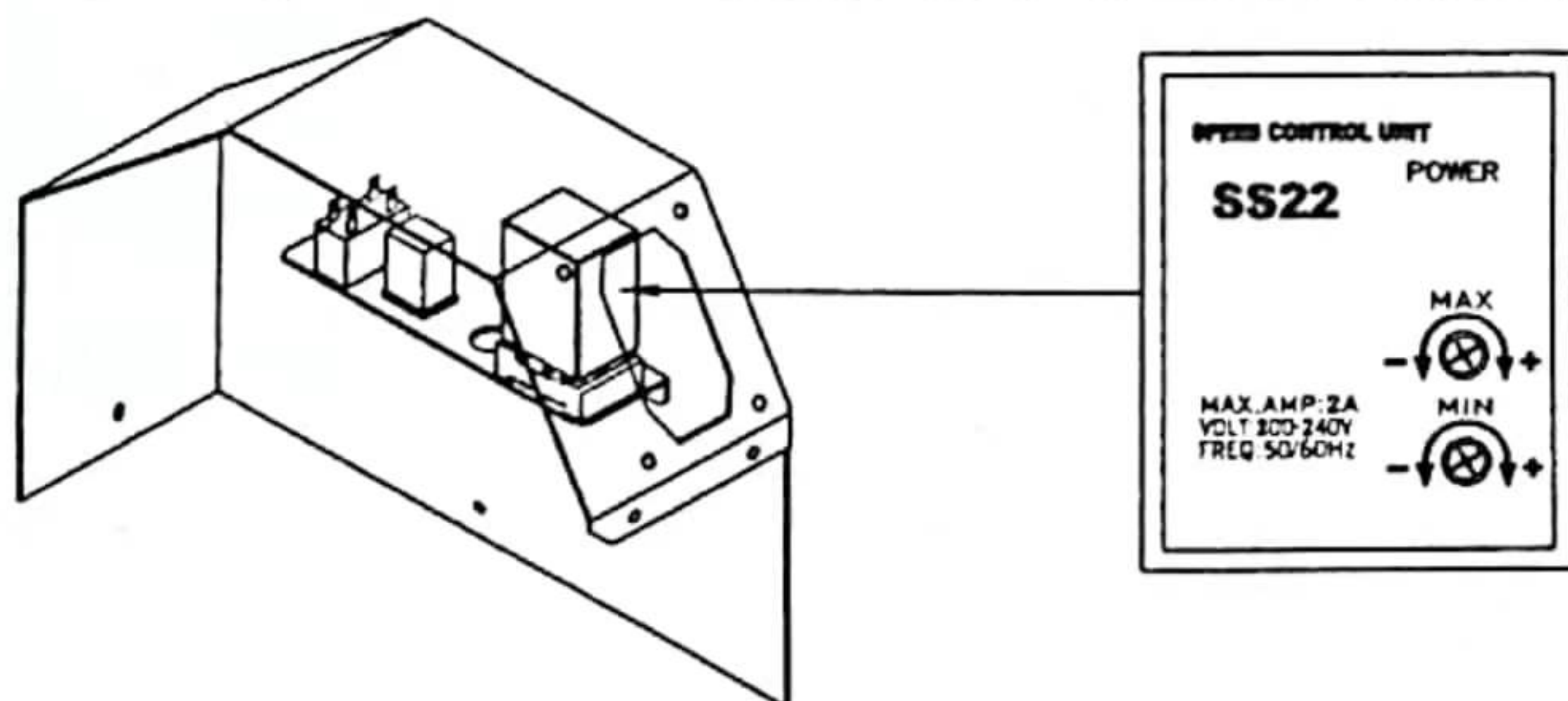

異常二、933在切布時還未頂住安全開關時就已亮黃燈不工作？

解決：此現象為安全開關彈簧被頂死，只需將安全開關的彈簧拉出即可。

Error 二. Not yet cuts but stop and yellow light on?

Solution: Problem caused when safety switch spring get stock; settle by pull out the spring.

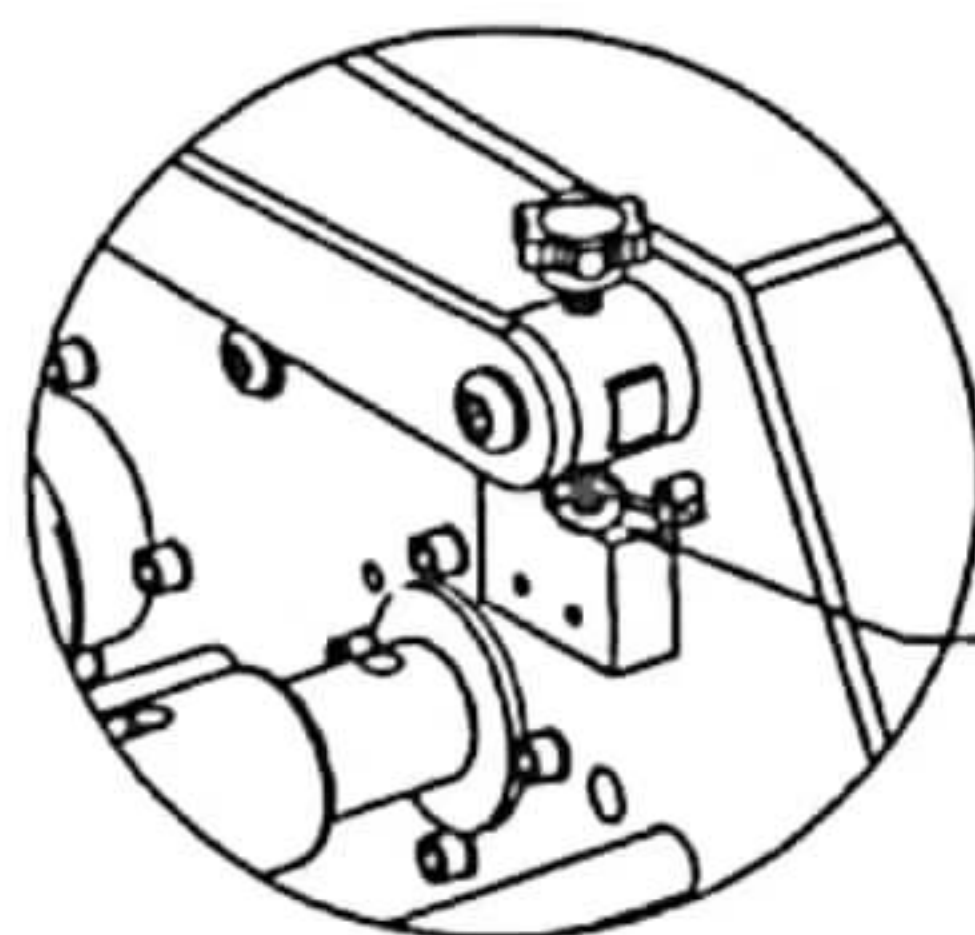

此彈簧頂死  
Spring get stuck.

## ◎ 注意事項 Point for Attention:

注意事項一、933工作一段時間後需及時給刀片加油（切記請勿加縫紉機油，需加30-40#機油）。

Attention 一. Blades needs oil after a working period (Do Not give sewing machine oil, Must give 30-40#oil).

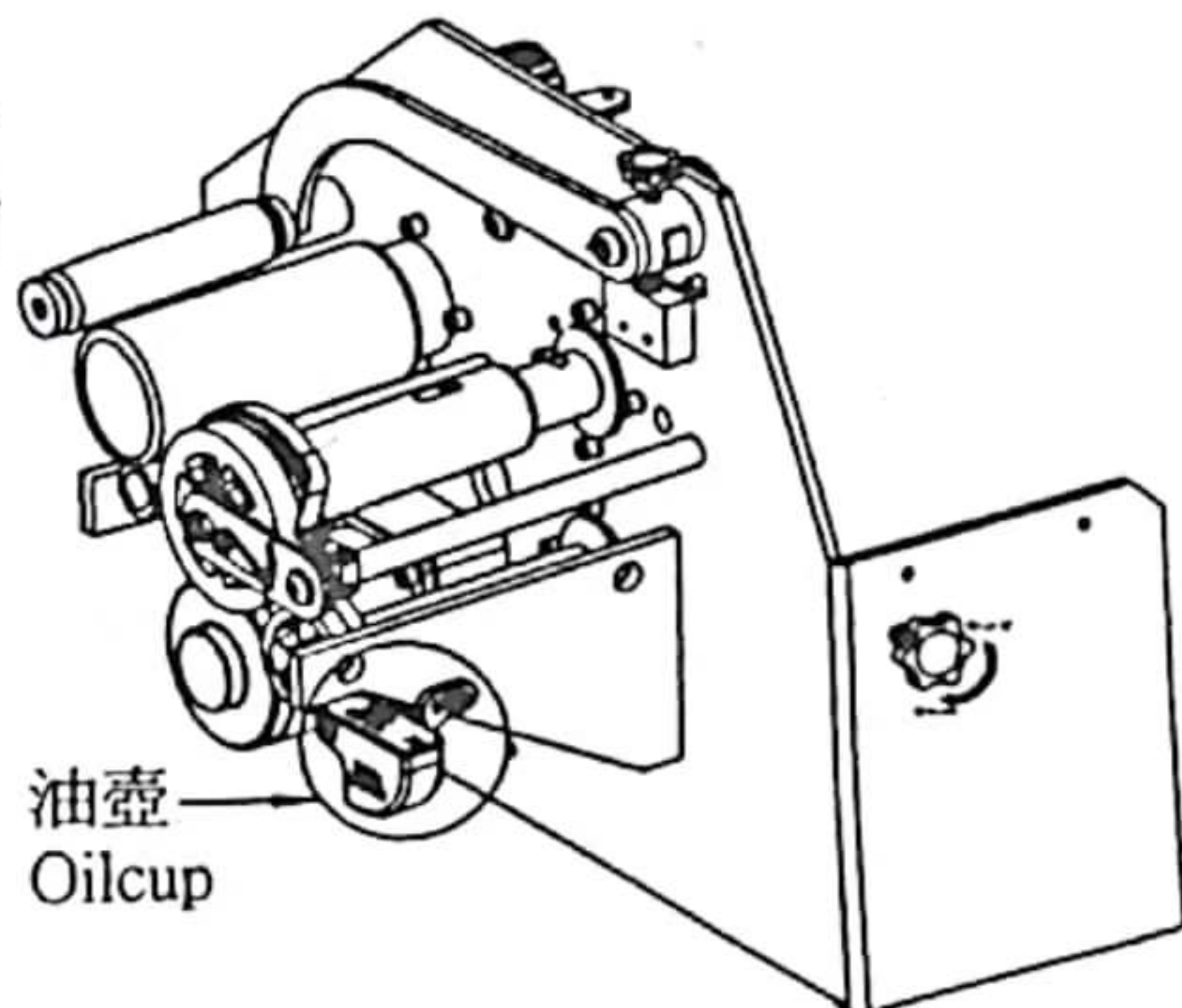

注意事項二、接933插頭的電源插座必須接地，以防止漏電。且必須在接通電源之前確認好購買機器的電壓和接通電源的電壓相符（110V或220V）。

Attention 二. 933 plug must have ground connection to prevent electric leakage. Must confirm its voltage (110V/220V) is corresponding with power source before use.