

REVISIONS	DATE

EXIST'G ELECTRICAL SCHEDULE											
AMP MAIN PANEL 150 AMP											
WIRE	K.W.	BREAKER AMPS	POLES	DESCRIPTION	CIRCUIT	CIRCUIT	DESCRIPTION	POLES	BREAKER AMPS	KW	WIRE
#10	3.4	20	2	C.U.-1- EXIST'G UNIT	1	2	DRYER	2	30	5.0	# 10
#14	*5,682	15	1	GENERAL LIGHTG.	3	4	REFRIGERATOR	1	20	1.5	# 12
#14	*	15	1	GENERAL LIGHTG.	5	6	SPARE	1	20		
#14	*	15	1	GENERAL LIGHTG.	7	8	BATH LIGHT	1	15		# 14
#12	1.5	20	1	Kitchen Sm. Appl	11	12	Kitchen Sm. Appl	2	20	1.5	# 12
#12	1.5	20	1	DISPOSAL	13	14	WATER HEATER	2	30	4.5	#10
#12	1.0	20	1	DINING Room	15	16	OUTSIDE G.F.I	1	20	1.5	# 12
#12	1.5	20	1	BATH GFI	17	18	GENERAL RECEPT	1	20	*	# 12
#6	10.0	50	2	AHU-1	19	20	GENERAL RECEPT	1	20	*	# 12
#12	1.5	20	1	WASHER	23	24	GENERAL RECEPT	1	20	*	# 12
#12	*	20	1	GENERAL RECEPT	25	26	GENERAL RECEPT	1	20	*	# 12
#12	*	20	1	GENERAL RECEPT	27	28	RANGE OVEN	2	50	3.0	# 8
#12	*	20	1	GENERAL RECEPT	29	30					
#14	*	15	1	NEW BATHROOM LIGHTG.	31	32	BATHROOM GFI	1	20	1.5	# 12
#14	*528	15	1	NEW STUDY/ EGRESS LIGHT	33	34	STUDY./ HALLWAY	1	20	*	# 12
#14	*	15	1	HALLWAY LIGHT	33	36	LAUNDRY GFI	1	20	1.5	# 12
#14	*	15	1	BATHROOM EXHAUST	35	38	SPARE	1	20	1.5	# 12
				SPARE	37	40	SPARE				

W 528 (GARAGE ENCLOSURE)	W 12,682 (EXIST'G. RESIDENCE)
GEN LIGHTS / RECEPTACLES SF X 3W /SF= W	GEN LIGHTS / RECEPTACLES SF X 3W /SF= W
EXIST'G RESIDENCE: #2317' X 3W =6,951 W	ADDITION: #899' X 3W = 2697 W
THIS SIDE: 22,000 W (EXIST'G)	THIS SIDE: 4,500 W (NEW)
22,000 W (EXIST'G)	4,500 W (NEW)
+12,682 W (EXIST'G)	+528 W (NEW)
TOTAL EXT'G.: 34,682 W	TOTAL NEW: 5,028 W
OVERALL TOTAL LOAD: 39,710 W	

1st 10 KW = 10,000 W	TOTAL 31,884 W./240V. = 133 AMPS
Remainder 28,710 @ 40% = 11,884 W	
A/C @ 100% = 10,000 W	
TOTAL 31,484 W.	New Service Load 133 A. 150 A. E.P. IS ADEQUATE FOR TOTAL LOAD

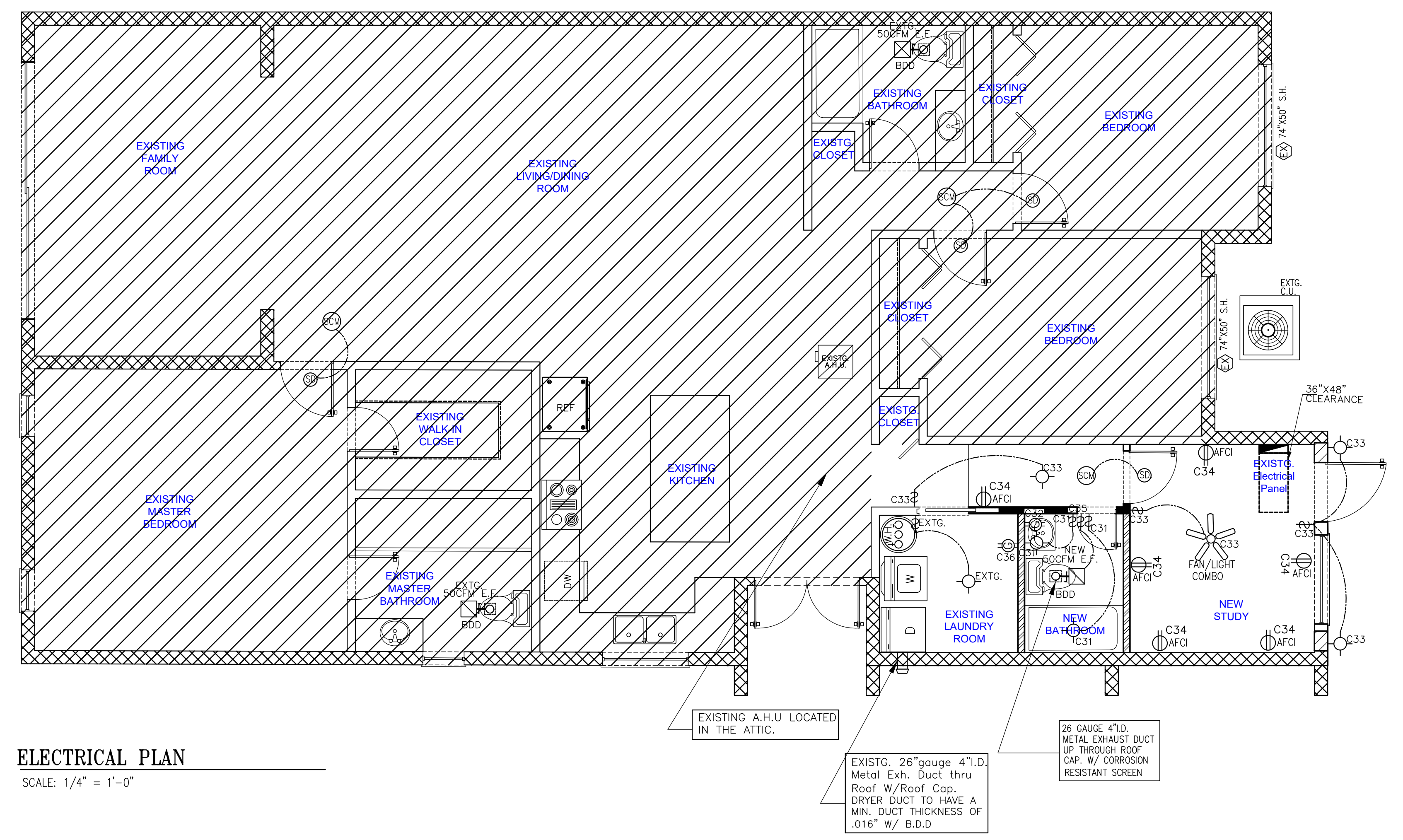

ELECTRICAL PLAN
SCALE: 1/4" = 1'-0"

Electrical PANEL
n.t.s.

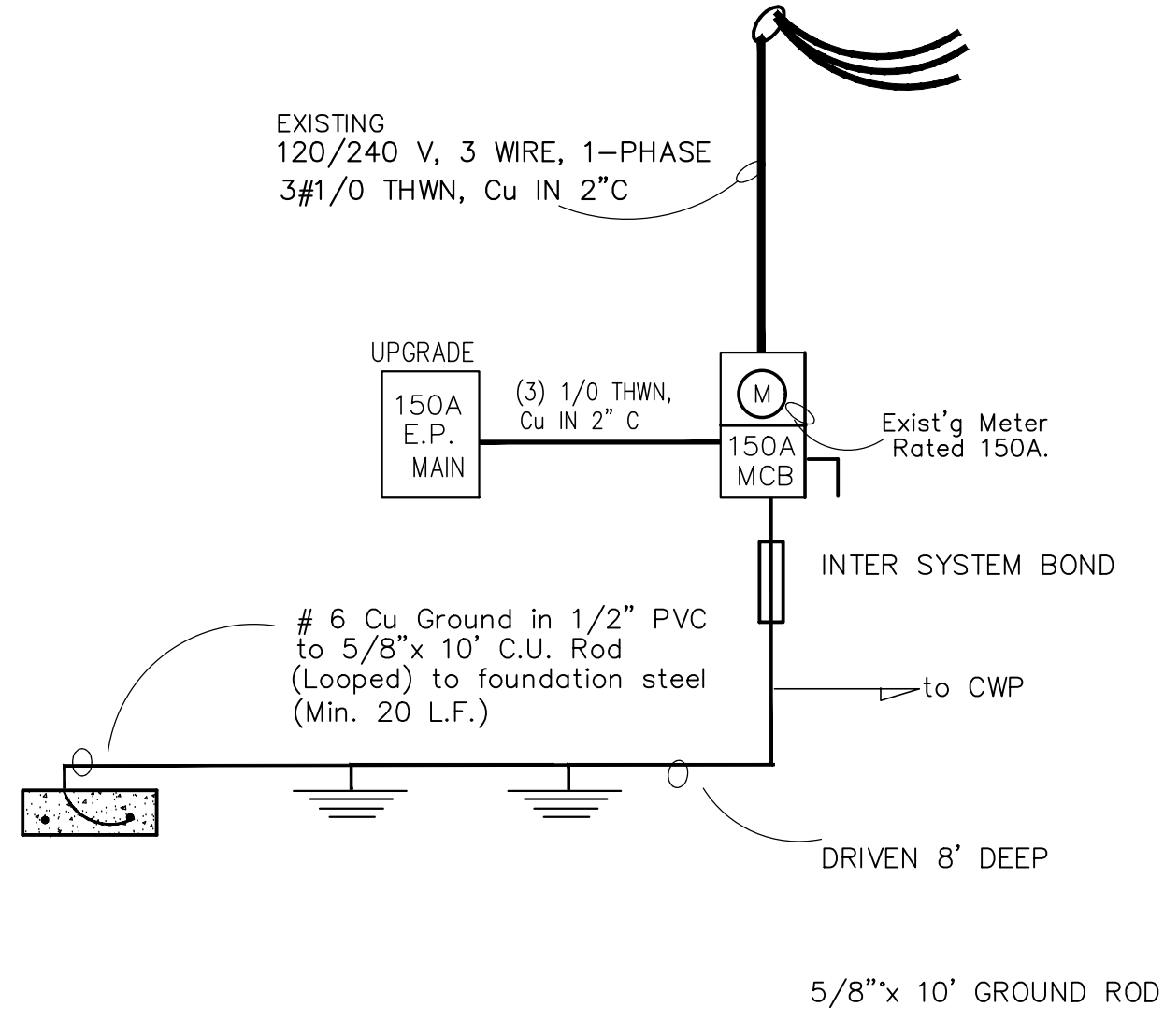
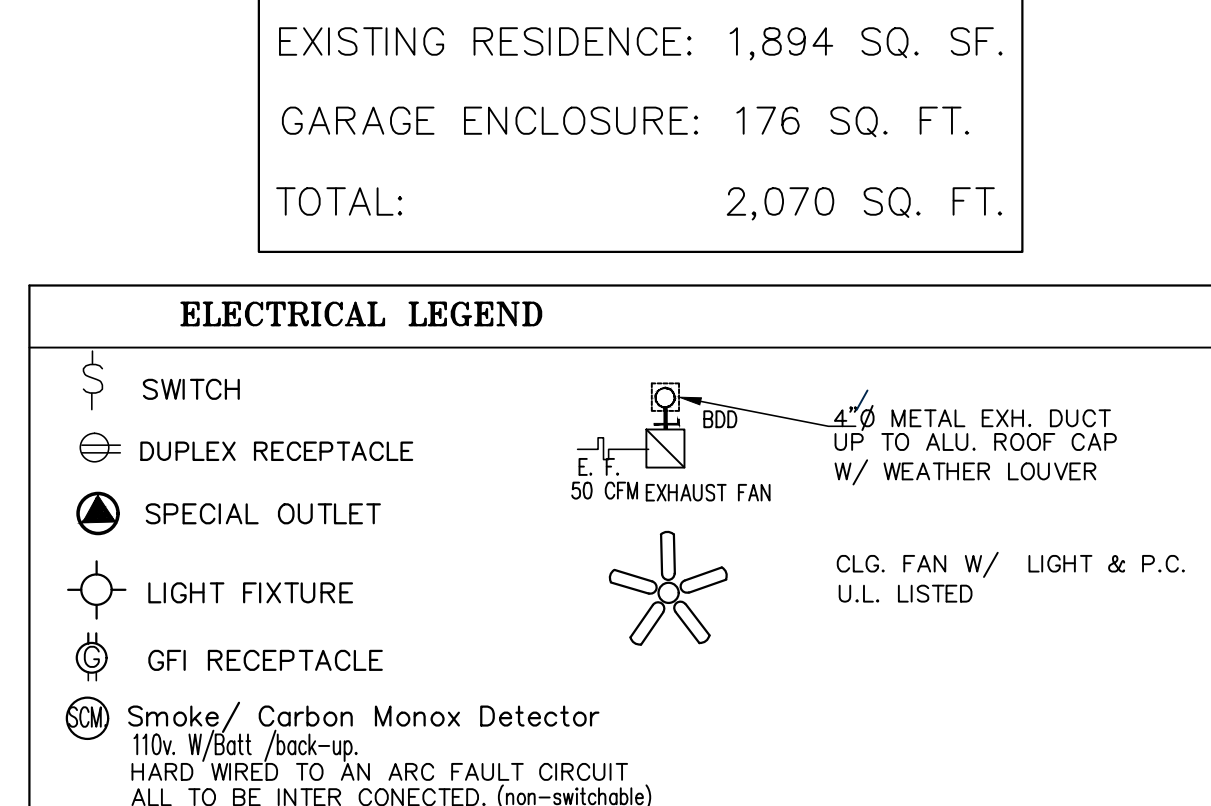
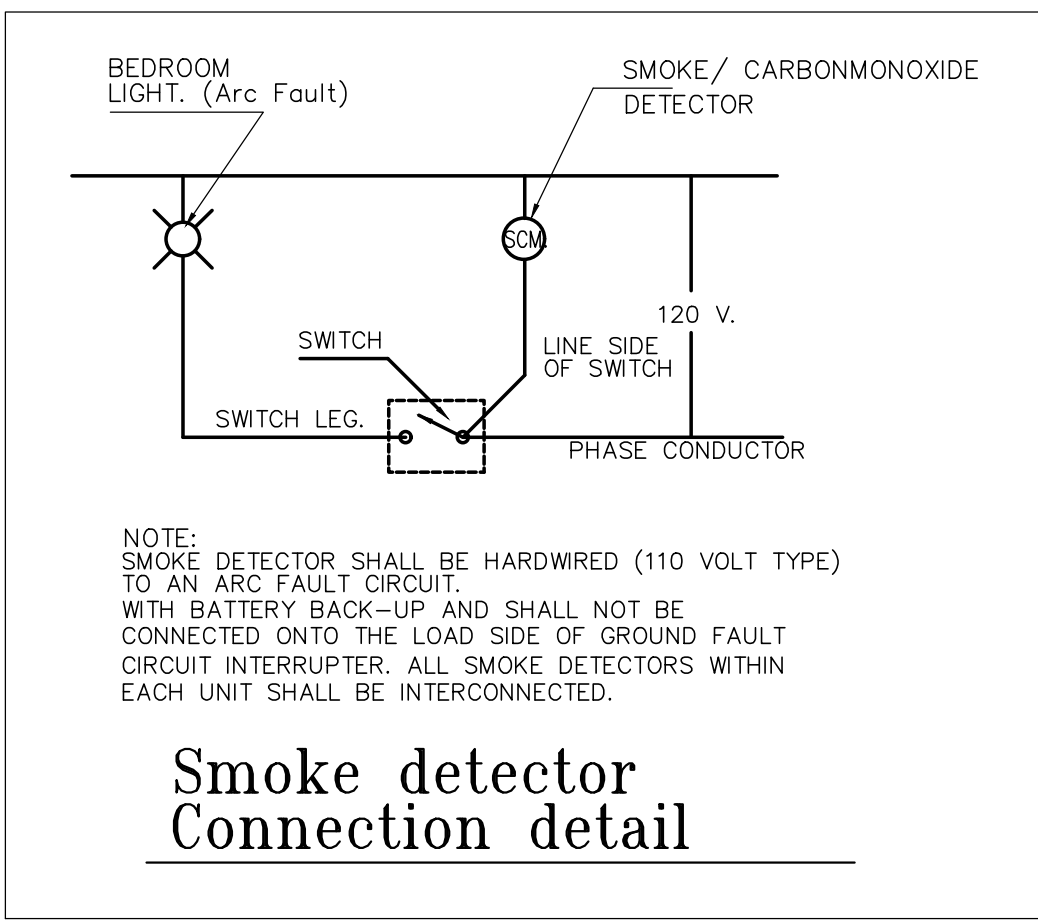

Exist'g Electrical Riser n.t.s.

RESIDENTIAL STAIRS MINIMUM 1 FT CANDLE INSIDE AND OUTSIDE STAIRS FBC R303.6

NOTE: ALL 15 & 20A. RECETACLES SHALL BE LISTED AS TAMPER PROOF

NOTE: NOT LESS THAN 90% OF THE LAMPS SHALL HAVE AN EFFICACY OF AT LEAST 45 LUMENS/W OR NOT LESS THAN 65 LUMENS/W. FBC RE R404

NOTE: ALL 120V. SINGLE PHASE-15 & 20A. CKTS NEW OR MODIFIED INSTALLED IN DWELLING UNITS -KITCHEN, DINNING, LIVING ROOMS, PARLORS, LIBRARIES, DENS BEDROOMS, SUNROOMS, REC ROOMS, CLOSETS, HALLWAYS, LAUNDRY AREAS OR SIMILAR ROOMS, SHALL BE ARC FAULT PROTECTED, PER NEC 210.12

- electrical notes:
1. ALL WORK SHALL COMPLY WITH THE LATEST EDITION ON THE "NATIONAL ELECTRICAL CODE" (NEC 2017) & THE "FLORIDA BUILDING CODE" (FBC 2020 -7TH EDITION).
 2. ALL CABLE SHALL BE COPPER UNLESS OTHERWISE NOTED AND APPROVED.
 3. NOT USED
 4. OUTDOORS UNDERGROUND CONDUITS SHALL BE SCHEDULE-40 PVC UNDER PAVED AREAS.
 5. CONTRACTOR SHALL FURNISHED ALL LABOR, MATERIALS AND EQUIP. FOR A COMPLETE ELEC. INST. IN ACCORDANCE WITH THE ELECTRICAL DRAWINGS AND APPLICABLE CODES AND REGULATIONS.
 6. ELEC. CONTRACTOR TO COORDINATE ALL OUTLET LOCATIONS WITH BLDG. AND ARCH. FIXTURES.
 7. ELCT. CONTRACTOR TO PROVIDE EMPTY CONDUITS AS REQD. FOR TELEPHONE LINES & T.V. ANTENA.
 8. ALL MOUNTING HARDWARE SHALL BE BY CONTRACTOR.
 9. ALL LIGHT FIXTURES AND FANS TO BE SELECTED BY OWNER, UNLESS OTHERWISE NOTED.

SEAL

GARAGE ENCLOSURE, BATH & STUDY ADDITION
753 ANDORRA PLACE
BOCA RATON, FL 3343

REGISTERED PROFESSIONAL ELECTRICAL ENGINEER
BUSINESS ADDRESS: 1000 S. DIXIE HIGHWAY, SUITE 3069, POMPANO BEACH, FLORIDA 33069
PHONE: 954-682-6516 FAX: 954-903-4284
EMAIL: CARLFORBES@BELLSOUTH.NET
FLORIDA STATE LICENSE NO. 20899

BEFORE SIGNING THESE PLANS, I HAVE REVIEWED THE RECORD PLANS AND SPECIFICATIONS FOR THIS PROJECT TO VERIFY THE WORK AND DESIGN SHOWN ON THESE PLANS IS IN ACCORDANCE WITH THE FLORIDA BUILDING CODE, THE FLORIDA ELECTRICAL CODE, AND ALL APPLICABLE LOCAL ORDINANCES AND REGULATIONS. I HAVE ALSO REVIEWED THE PERMITS AND RECORD PLANS FOR THIS PROJECT TO VERIFY THE WORK AND DESIGN SHOWN ON THESE PLANS IS IN ACCORDANCE WITH THE FLORIDA BUILDING CODE, THE FLORIDA ELECTRICAL CODE, AND ALL APPLICABLE LOCAL ORDINANCES AND REGULATIONS. I HAVE ALSO REVIEWED THE PERMITS AND RECORD PLANS FOR THIS PROJECT TO VERIFY THE WORK AND DESIGN SHOWN ON THESE PLANS IS IN ACCORDANCE WITH THE FLORIDA BUILDING CODE, THE FLORIDA ELECTRICAL CODE, AND ALL APPLICABLE LOCAL ORDINANCES AND REGULATIONS. I HAVE ALSO REVIEWED THE PERMITS AND RECORD PLANS FOR THIS PROJECT TO VERIFY THE WORK AND DESIGN SHOWN ON THESE PLANS IS IN ACCORDANCE WITH THE FLORIDA BUILDING CODE, THE FLORIDA ELECTRICAL CODE, AND ALL APPLICABLE LOCAL ORDINANCES AND REGULATIONS.

CARL G. FORBES PE
1000 S. DIXIE HIGHWAY
POMPANO BEACH, FLORIDA 33069
EMAIL: CARLFORBES@BELLSOUTH.NET
PHONE: 954-682-6516 FAX: 954-903-4284
FLORIDA STATE LICENSE NO. 20899

DRAWN BY:
S. DELINCE
Hollywd Florida 33024
PHONE: 786-606-5531
EMAIL: mduelosdesign01@aol.com

DATE: 10/15/21
SCALE: 1/4" = 1'-0"
OWNER: Nachum Caplan & Alyssa Cohen
PROJECT: Garage enclosure to Bath & Study Addition

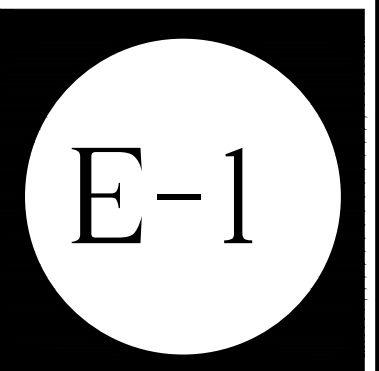

Code in Effect: 2020 FBC 7th Edition