

WATER PIPING PLAN
SCALE: 1/4" = 1'-0"

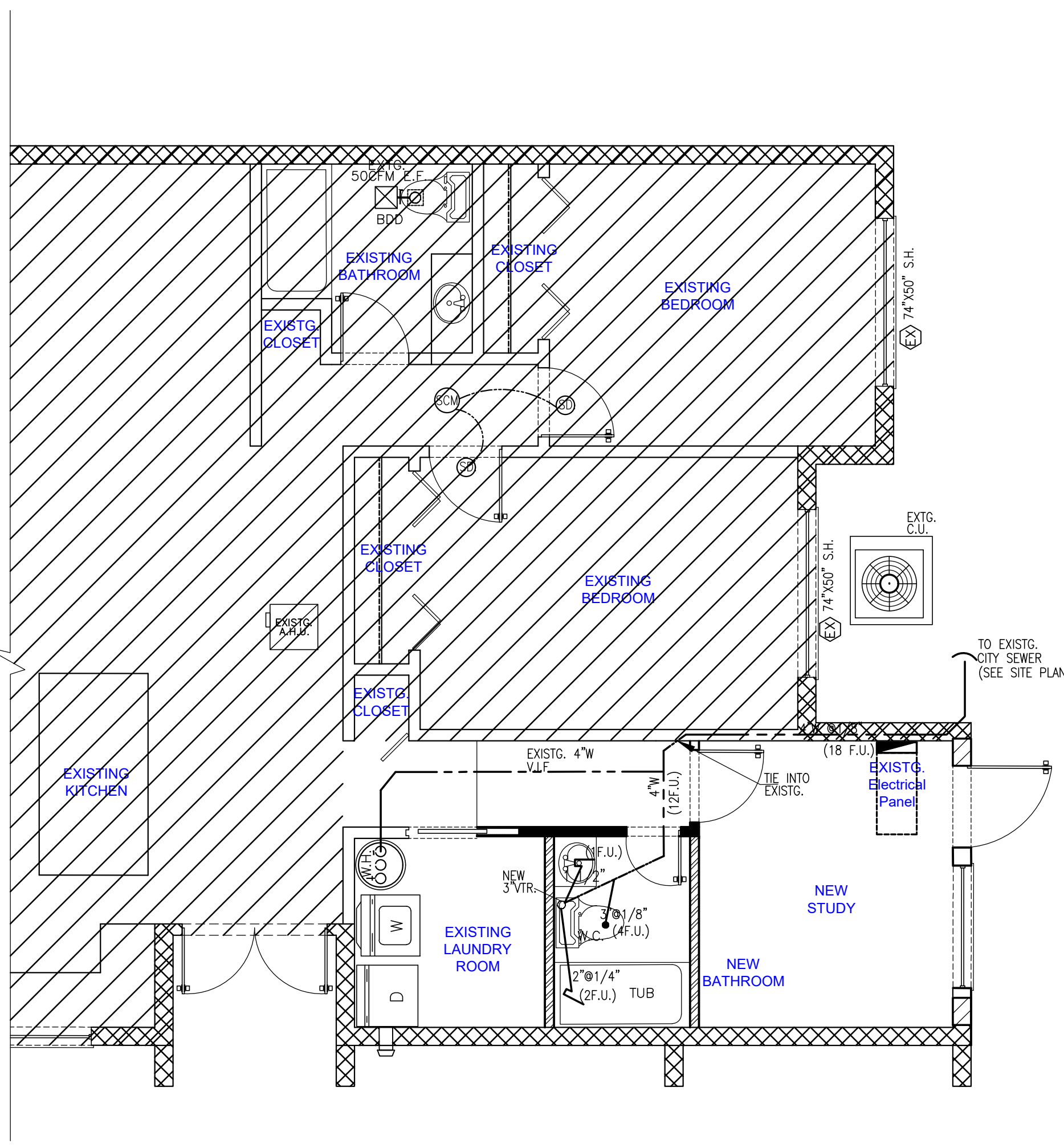

SANITARY PLUMBING PLAN
SCALE: 1/4" = 1'-0"

NOTE:
San. pipes 3" & above— slopes @ 1/8" / lin. ft.
San. pipes 2" & below— slopes @ 1/4" / lin. ft.

WATER LEGEND	
SYMBOL	DESCRIPTION
	COLD WATER PIPE
	HOT WATER PIPE
	GATE VALVE
	AIR CHAMBER
	UNDERGROUND
	T & P TEMP. & PRESSURE RELIEF VALVE

- WATER PIPING NOTES:**
- ALL WATER PIPING SHALL BE INSTALLED IN ACCORDANCE WITH THE 2020 FLORIDA BUILDING PLUMBING CODE, AND LOCAL ORDINANCES.
 - PLUMBING CONTRACTOR SHALL PAY ALL FEES, INSPECTION AND CONNECTION CHARGES REQUIRED.
 - PLUMBING CONTRACTOR SHALL GUARANTEE ALL WORK FREE OF DEFECTS IN MATERIAL AND WORKMANSHIP FOR A PERIOD OF ONE YEAR FROM DATE OF ACCEPTANCE.
 - SUBMIT SHOP DRAWINGS TO ARCHITECT FOR APPROVAL OF ALL EQUIPMENT, MATERIALS AND LAYOUTS PRIOR TO INSTALLATION.
 - OFFSET PIPING AS REQUIRED TO CLEAR BUILDING STRUCTURE, DUCTWORK, ETC. AS REQUIRED BY FIELD CONDITIONS. COORDINATE WITH ALL EXISTING AND NEW WORK.
 - PLUMBING CONTRACTOR SHALL VERIFY ALL SPACE CONDITIONS AND DIMENSIONS AT JOB SITE PRIOR TO FABRICATION AND INSTALLATION OF MATERIALS AND EQUIPMENT.
 - COORDINATE WORK WITH OTHER TRADES.
 - FURNISH AND INSTALL ALL PLUMBING FIXTURES.
 - EACH PLUMBING FIXTURE SHALL BE PROVIDED WITH AIR CHAMBERS AS PER F.B.C.
 - WHEREVER DISSIMILAR METALS ARE TO BE JOINED, A DIELECTRIC FITTING SHALL BE PROVIDED TO CONNECT BOTH TYPES OF PIPES.
 - PROVIDE ALL WATER PIPING
 - HOT & COLD WATER PIPING ABOVE FLOOR OR BELOW SLAB WITHIN BUILDING WALLS SHALL BE TYPE "L" COPPER TUBING, HARD DRAWN ABOVE GROUND, SOFT ANNEALED BELOW GROUND. ALL WATER PIPING BELOW GROUND UNDER CONCRETE SLAB SHALL BE ENCASED IN A 4" PVC SCHEDULE 40 PIPE CASING AS PER "SFCB" REQUIREMENTS. JOINTS SHALL BE MADE ON ALL COPPER PIPE ABOVE GROUND WITH 95/5 SOLDER. COLD WATER PIPES OUTSIDE THE BUILDING SHALL BE TYPE "L" COPPER PIPE HARD DRAWN. AT OWNER'S OPTION ALL WATER PIPING & FITTINGS COULD BE SUBSTITUTED FOR PVC SCHEDULE 40 WEIGHT PIPING & FITTINGS AND USED IN ACCORDANCE WITH THE "FBC". TYPE "L" COPPER FOR 2" AND UNDER, TYPE "K" COPPER FOR 2" & ABOVE. NO FITTINGS SHALL BE INSTALLED IN ALL UNDERGROUND WATER PIPING.

COLD WATER SUPPLY & PLUMBING FIXTURE SCHEDULE

DESCRIPTION	WASTE	CW	HW	FU
1-W.C.	3"	1/2"	●	4
1-LAVS	1-1/2"	1/2"	1/2"	1
1-TUB	2"	1/2"	1/2"	2
TOTAL F.U.				7 F.U. AT ADDITION

Note:
A) HORIZONTAL RUN OF H&CW SERVICE PIPE SHALL BE TRENCHED UNDER PAVED AREA & SHALL BE ENCASED IN SCHEDULE 40 PVC PIPE WITH MIN. 24" COVER. ENDS OF ENCASEMENT PIPE SHALL BE SEALED TO PREVENT EROSION.
B) PROVIDE SAND ENVELOPE 6" BELOW & ABOVE PIPE THE FULL WIDTH OF TRENCH.

- SANITARY PIPING NOTES:**
- ALL SANITARY PIPING SHALL BE INSTALLED IN ACCORDANCE WITH THE 2020 FLORIDA BUILDING CODE, STATE AND LOCAL ORDINANCES.
 - PLUMBING CONTRACTOR SHALL PAY ALL FEES, INSPECTION AND CONNECTION CHARGES REQUIRED.
 - PLUMBING CONTRACTOR SHALL GUARANTEE ALL WORK FREE OF DEFECTS IN MATERIAL AND WORKMANSHIP FOR A PERIOD OF ONE YEAR FROM DATE OF ACCEPTANCE.
 - SUBMIT SHOP DRAWINGS TO ARCHITECT FOR APPROVAL OF ALL EQUIPMENT, MATERIALS AND LAYOUTS PRIOR TO INSTALLATION.
 - OFFSET PIPING AS REQUIRED TO CLEAR BUILDING STRUCTURE, DUCTWORK, ETC. AS REQUIRED BY FIELD CONDITIONS. COORDINATE WITH ALL EXISTING AND NEW WORK.
 - PLUMBING CONTRACTOR SHALL VERIFY ALL SPACE CONDITIONS AND DIMENSIONS AT JOB SITE PRIOR TO FABRICATION AND INSTALLATION OF MATERIALS AND EQUIPMENT.
 - COORDINATE WORK WITH OTHER TRADES.
 - FURNISH AND INSTALL PLUMBING FIXTURES.
 - PROVIDE STOP VALVES FOR EACH FIXTURE.
 - WHEREVER DISSIMILAR METALS ARE TO BE JOINED, A DIELECTRIC FITTING SHALL BE PROVIDED TO CONNECT BOTH TYPES OF PIPES.
 - PROVIDE SANITARY PIPING.
 - SANITARY SOIL PIPE & FITTINGS BELOW GRADE OR FLOOR SLAB ON FILL CAN BE STANDARD WEIGHT BELL & SPIGOT CAST IRON COATED WITH TAR PITCH WITH LEAD & OKUM JOINTS OR NEOPRENE SEALS, OR CAST IRON NO HUB PIPE & FITTINGS OR PVC SCHEDULE 40 PIPE & FITTINGS. IN ACCORDANCE WITH THE "FBC".
SANITARY & VENT PIPING ABOVE FLOOR SLAB WITHIN BUILDING WALLS CAN BE CAST IRON NO HUB PIPING & FITTINGS OR PVC SCHEDULE 40 PIPING & FITTINGS. IN ACCORDANCE WITH THE "FBC".

PLUMBING LEGEND

SYMBOL	DESCRIPTION
	SANITARY PIPE
	VENT PIPE
	P TRAP
	WALL CLEANOUT
	FLUSH CLEANOUT
	VENT THRU ROOF
	UNDERGROUND

**TABLE 604.4
MAXIMUM FLOW RATES AND CONSUMPTION FOR
PLUMBING FIXTURES AND FIXTURE FITTINGS.**

PLUMBING FIXTURE OR FIXTURE FITTING	MAXIMUM FLOW RATE OR QUANTITY
Lavatory, private	1.5 gpm at 60 psi
Lavatory, public (other than metering)	0.5 gpm at 60 psi
Shower head ^a	1.5 gpm at 80 psi
Sink faucet	1.5 gpm at psi
Urinal	1.0 gallon per flushing cycle
Water closet	1.28 gallons per flushing cycle

PLUMBING CONTRACTOR TO FOLLOW TABLE 604.4 FOR COMPLYING WITH REQUIREMENTS FOR NEW FIXTURES
A WATER HAMMER ARRESTOR SHALL BE INSTALLED WHERE QUICK CLOSING VALVES ARE USED. WATER HAMMER ARRESTOR SHALL BE INSTALLED IN ACCORDANCE WITH MANUFACTURERS SPECS AND SHALL CONFORM TO ASSE 1010.

REVISIONS	DATE

SEAL

GARAGE ENCLOSURE, BATH & STUDY ADDITION
753 ANDORRA PLACE
BOCA RATON, FL 33433

BUILDING CONTRACTOR SHALL VERIFY ALL SPACE CONDITIONS AND DIMENSIONS AT JOB SITE PRIOR TO FABRICATION AND INSTALLATION OF MATERIALS AND EQUIPMENT. COORDINATE WITH ALL EXISTING AND NEW WORK. SUBMIT SHOP DRAWINGS TO ARCHITECT FOR APPROVAL OF ALL EQUIPMENT, MATERIALS AND LAYOUTS PRIOR TO INSTALLATION. OFFSET PIPING AS REQUIRED TO CLEAR BUILDING STRUCTURE, DUCTWORK, ETC. AS REQUIRED BY FIELD CONDITIONS. COORDINATE WITH ALL EXISTING AND NEW WORK. PLUMBING CONTRACTOR SHALL GUARANTEE ALL WORK FREE OF DEFECTS IN MATERIAL AND WORKMANSHIP FOR A PERIOD OF ONE YEAR FROM DATE OF ACCEPTANCE. ALL OF THE ABOVE INFORMATION IS BASED ON THE INFORMATION PROVIDED BY THE CLIENT. THE CLIENT, NOT THE ARCHITECT, IS RESPONSIBLE FOR THE ACCURACY OF THE INFORMATION PROVIDED. THE ARCHITECT SHALL NOT BE RESPONSIBLE FOR ANY ERRORS OR OMISSIONS IN THE INFORMATION PROVIDED. THE ARCHITECT SHALL NOT BE RESPONSIBLE FOR ANY DEFECTS IN THE INFORMATION PROVIDED. THE ARCHITECT SHALL NOT BE RESPONSIBLE FOR ANY DEFECTS IN THE INFORMATION PROVIDED. THE ARCHITECT SHALL NOT BE RESPONSIBLE FOR ANY DEFECTS IN THE INFORMATION PROVIDED.

CARL G. FORBES PE
1000 S. DIXIE HIGHWAY
POMPANO BEACH, FLORIDA 33069
EMAIL: CARLFORBES@BELLSOUTH.NET
PHONE: 954-682-6516 FAX: 954-903-4284
FLORIDA STATE LICENSE NO. 208699

DRAWN BY:
S. DELINCE
Hollywd Florida 33024
PHONE: 786-606-5531
EMAIL: mduelosdesign01@aol.com

DATE: 10/15/21
SCALE: **1/4" = 1'-0"**
OWNER: Nachum Caplan & Alyssa Cohen
PROJECT: Garage enclosure to Bath & Study Addition

