

OPERATIONAL CHART

When using the machine for the first time or after changing the filter, please run water through the machine for 3 minutes to eliminate carbon particles.

To make Kangen Water

Tap the
 Button



Open the water faucet.



Beauty Water
*Do not drink

To make Beauty Water

Tap the
 Button

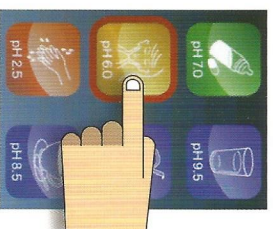

Open the water faucet.



Kangen Water
*Do not drink

To make Strong Kangen Strong Acidic

Tap the
 Button



Open the water faucet.



Strong Acidic
*Do not drink

To make Clean Water

Tap the
 Button



Open the water faucet.



Clean Water
*Do not drink

1 Installing the diverter

- Stainless Steel Diverter
- Adapter



* The power cord provided differs according to the country in which the product is intended to be used.

- Diverter with Shower
- Adapter

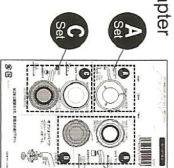
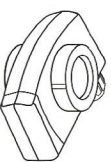

How to mount a single lever faucet

Inner screw type

In the case of the Stainless Steel Diverter

Remove the Aerator

Store the removed aerator.

Install the diverter and adapter

Use a coin to tighten the Adapter S.



<Installation example>

In the case of the Diverter with Shower

Remove the Aerator

Store the removed aerator.

Install the diverter and adapter

Use a coin to tighten the Adapter C set.



<Installation example>

Outer screw type

Only the Diverter with Shower

Remove the Aerator

Store the removed aerator.

Install the adapter and the diverter.



<Installation example>

Faucet with expanded end

Only the Diverter with Shower



Measure the D dimension, then fit the diverter (16, 17.5, 19 mm).

Install the adapter and the diverter.



<Installation example>

! If the thread diameter or thread pitch does not fit, the threads may get damaged. Make sure the thread diameter and pitch are as specified.

The faucets shown at right cannot accept the diverter.

In this case, add a dedicated faucet or install a specific diverter for the faucet. For details, contact your dealer.

With a shower	With a diverter	With a faucet
Thread diameter: 1/2" (12.7mm) Thread pitch: 1/16" (1.5mm) Adapter: 1/2" (12.7mm) or 1/4" (6.3mm)	Thread diameter: 1/2" (12.7mm) Thread pitch: 1/16" (1.5mm) Adapter: 1/2" (12.7mm) or 1/4" (6.3mm)	Thread diameter: 1/2" (12.7mm) Thread pitch: 1/16" (1.5mm) Adapter: 1/2" (12.7mm) or 1/4" (6.3mm)

Diverter: Diverter with Shower

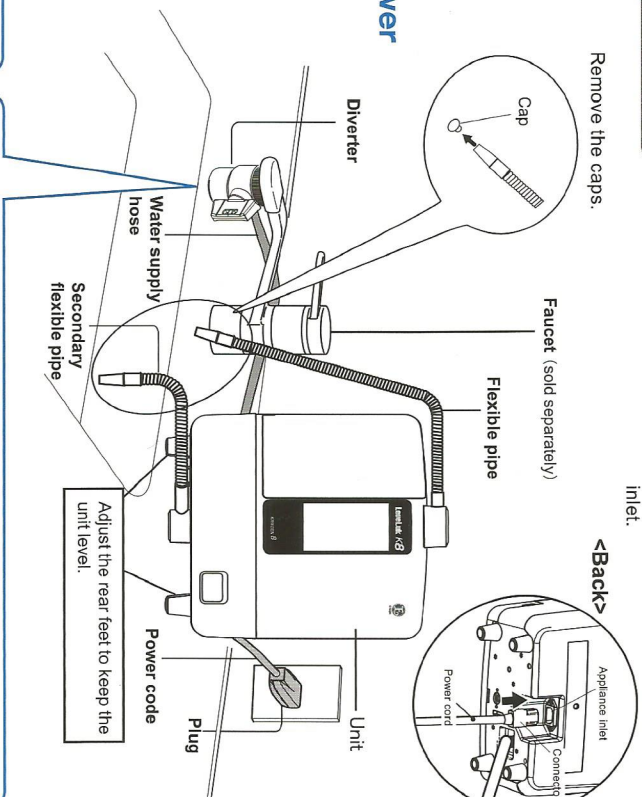
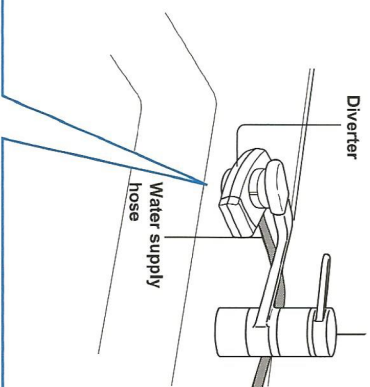

2 Setting up the Unit

Diverter: Stainless Steel Diverter

Overall diagram

Insert the connector into the appliance inlet.

Remove the caps.

Faucet (sold separately)

Flexible pipe

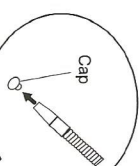

Diverter

Water supply hose

Secondary flexible pipe

Adjust the rear feet to keep the unit level.

Power cord

Plug

Unit

Cap

Appliance inlet

Connector

Power cord

<Back>

- Remove the fixing nut.
- Fit the fixing nut over the hose, and then fit the hose onto the diverter.
- Insert the hose into the branch plug and secure it by tightening the fixing nut.

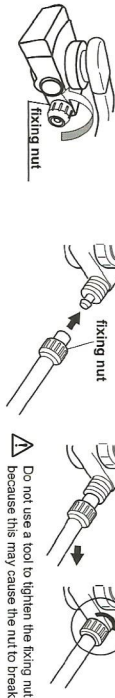

Lever

Selection lever

Tap water

Shower

Processed water position	Tap water position	Tap water position
KANGEN water, adds water, strong KANGEN water, clean water flows from the flexible pipe.	Tap water	Tap water

- Remove the fixing nut.
- Fit the fixing nut over the hose, and then fit the hose onto the diverter.
- Insert the hose into the branch plug and secure it by tightening the fixing nut.

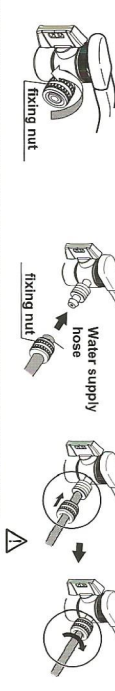

Lever

Selection lever

Tap water

Shower

Processed water position	Tap water position
KANGEN water, adds water, strong KANGEN water, clean water flows from the flexible pipe.	Tap water

Do not use a tool to tighten the fixing nut because this may cause the nut to break.