

SCALE REPRESENTATION.  
1.5 = 12"

PROJECT:YOUR PROJECT NAME	MATERIAL:HARDWOOD	PRODUCT DIMENSION:24"x24"
LOCATION:YOUR PROJECT ADDRESS	SPECIES:YOUR SPECIES	BLADE QTY:12
SUBMITTAL DATE:XX/XX/XXXX	STAIN:OPTION NOT INCLUDED	BLADE SIZE:3/4"x2"
	FINISH:OPTIONAL FINISH	BLADE SPACING:1-1/4"

1.1 Isometric

Drop In Panel Grille Series  
PRODUCT SKU:MO-12-BKB1516

PARAMOUNT  
CREATING EXQUISITE WOODWORK SINCE 1984

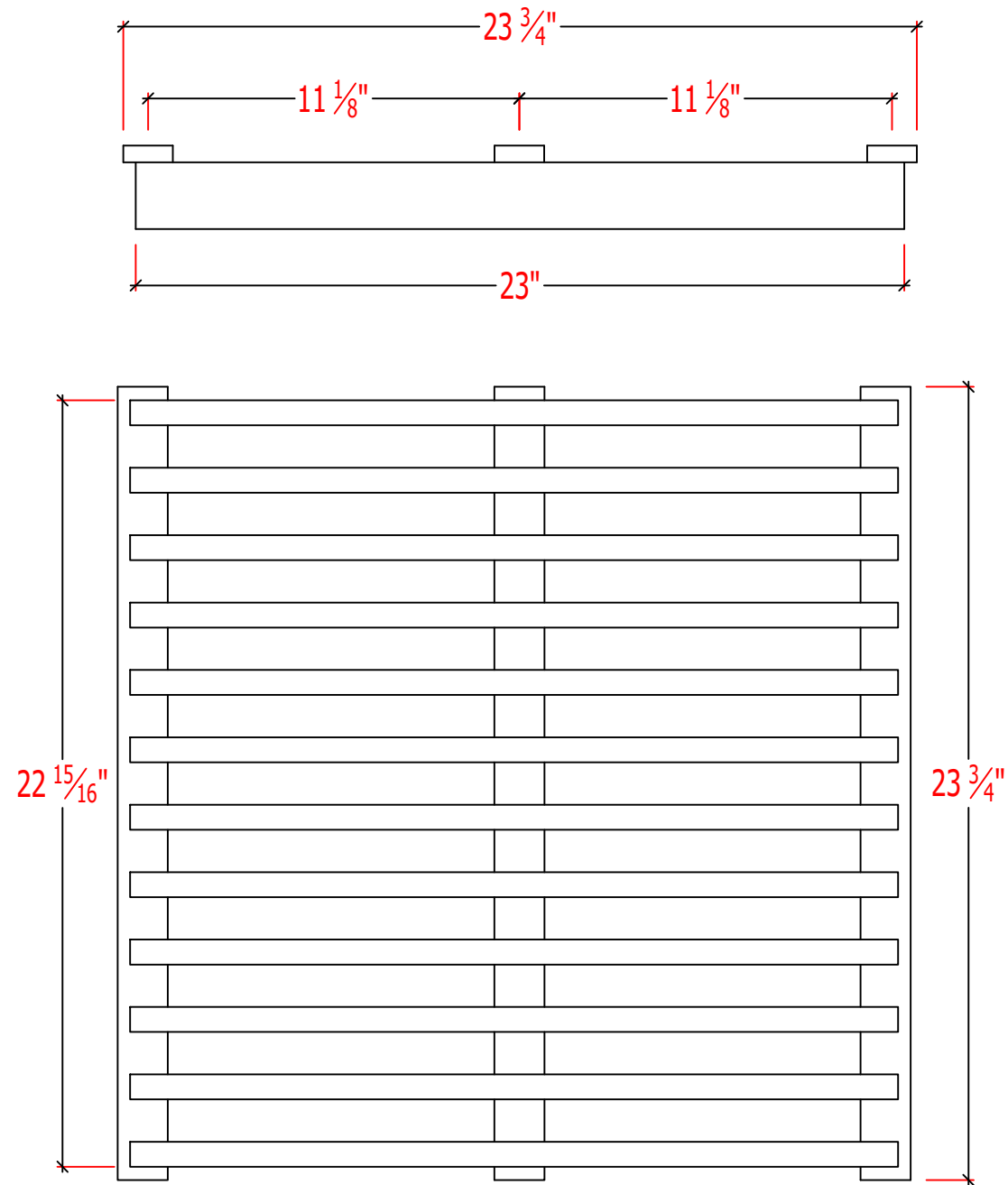

BACKER SYSTEM LAYOUT  
BACKER DIMENSIONS: 1/2" X 1 1/2" X 23-3/4"

SCALE REPRESENTATION  
1.5 = 12"

## 1.2 Backer Configuration

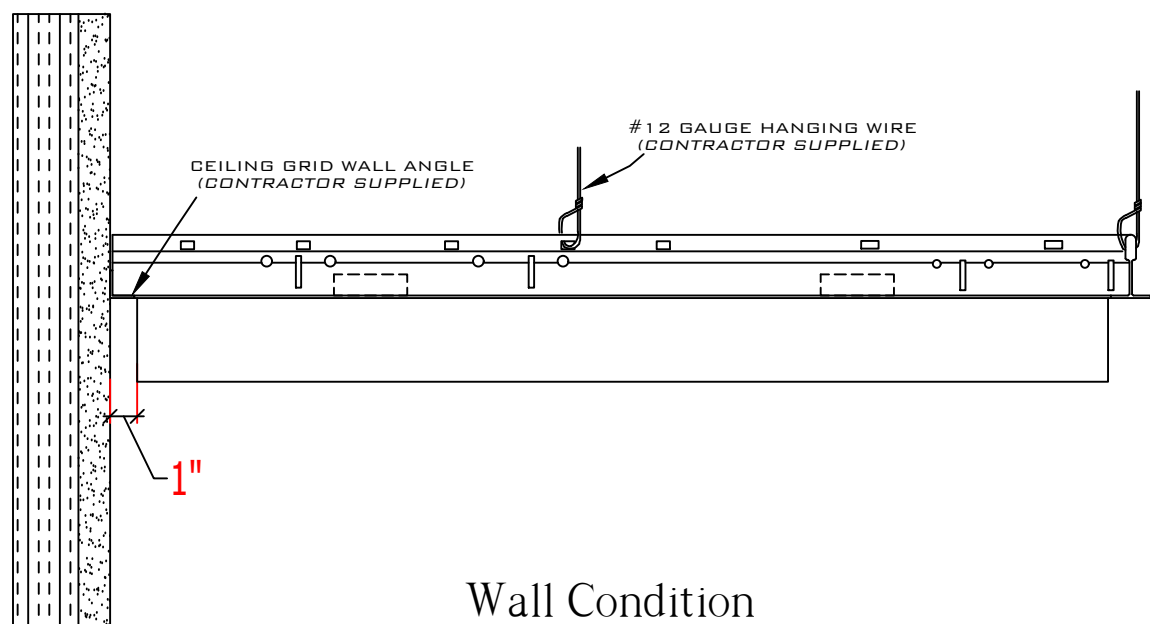
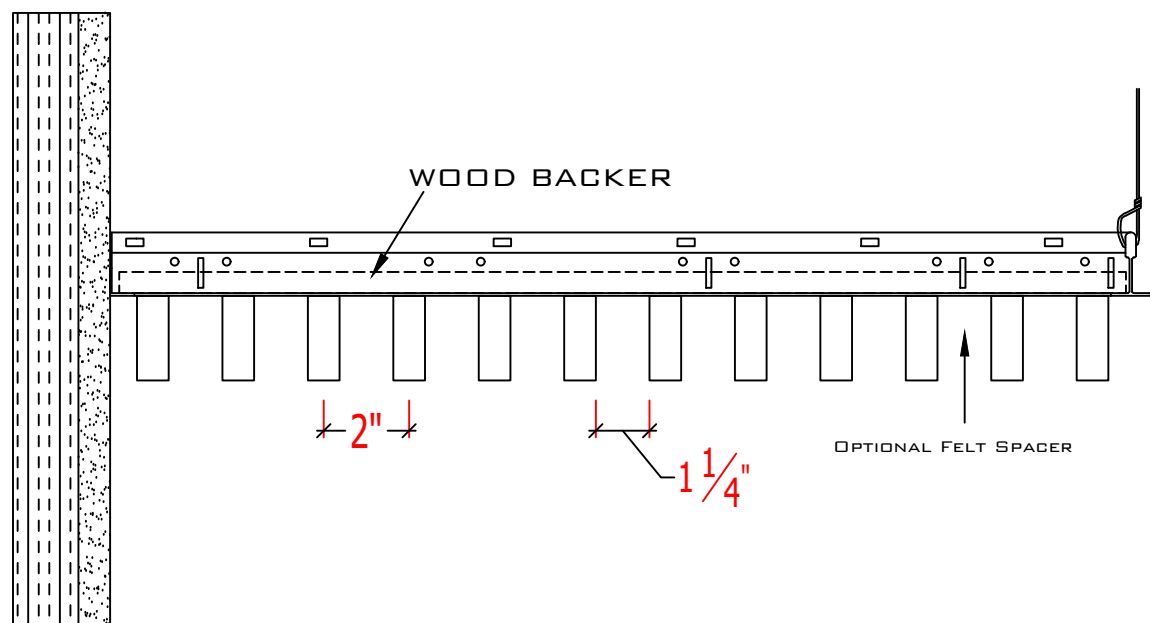

Wall Condition

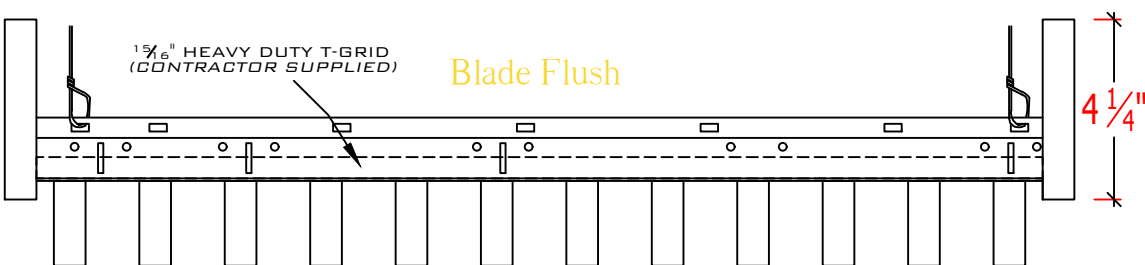
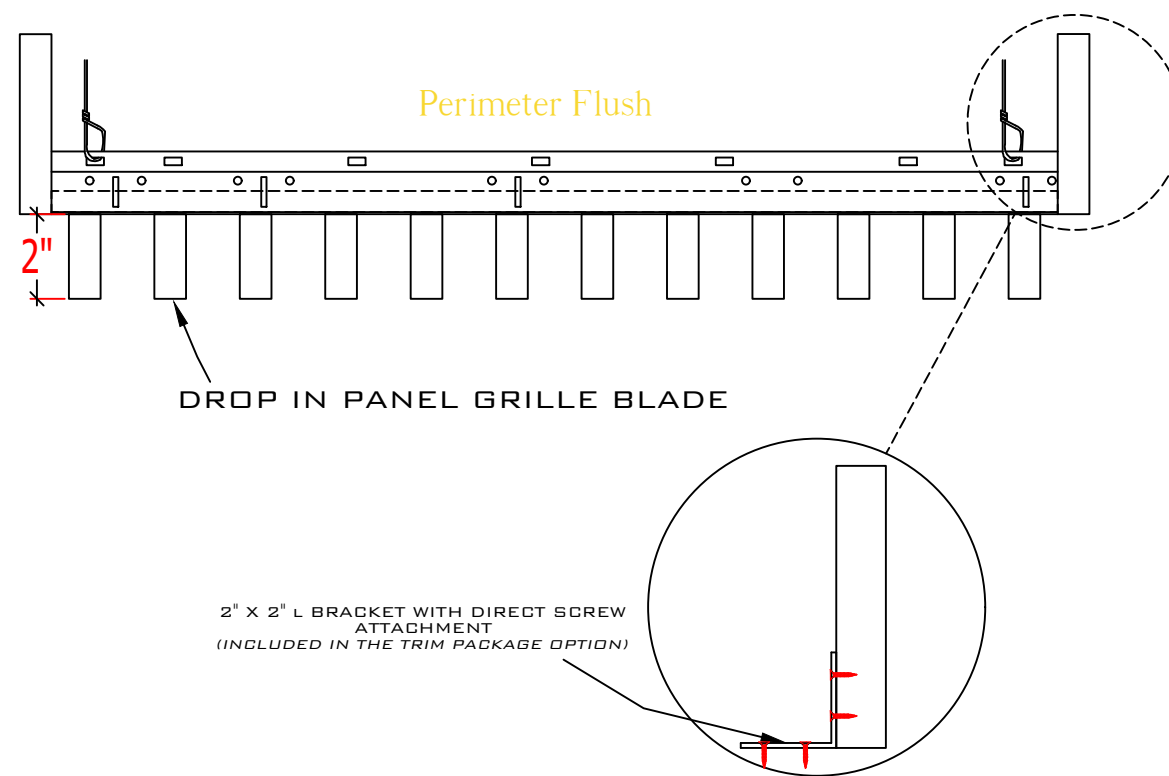

Cloud Condition

SCALE REPRESENTATION.  
1.5 = 12"

## 1.3 Elevation

Drop In Panel Grille Series

PRODUCT SKU:MO-12-BKB1516

**PARAMOUNT**  
CREATING EXQUISITE WOODWORK SINCE 1984

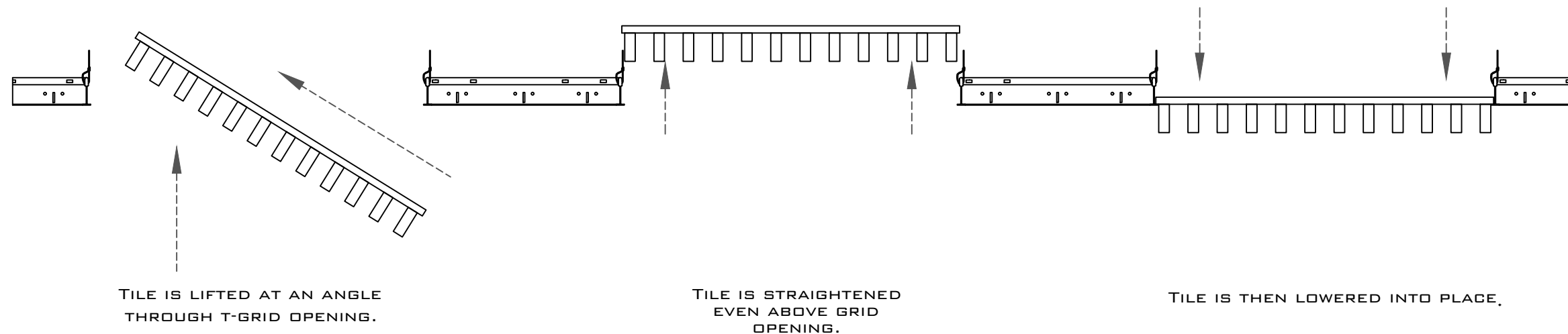

12 BLADE DROP IN PANEL GRILLE PRODUCT REPRESENTATION.  
ACTUAL BLADE HEIGHT VARIES.

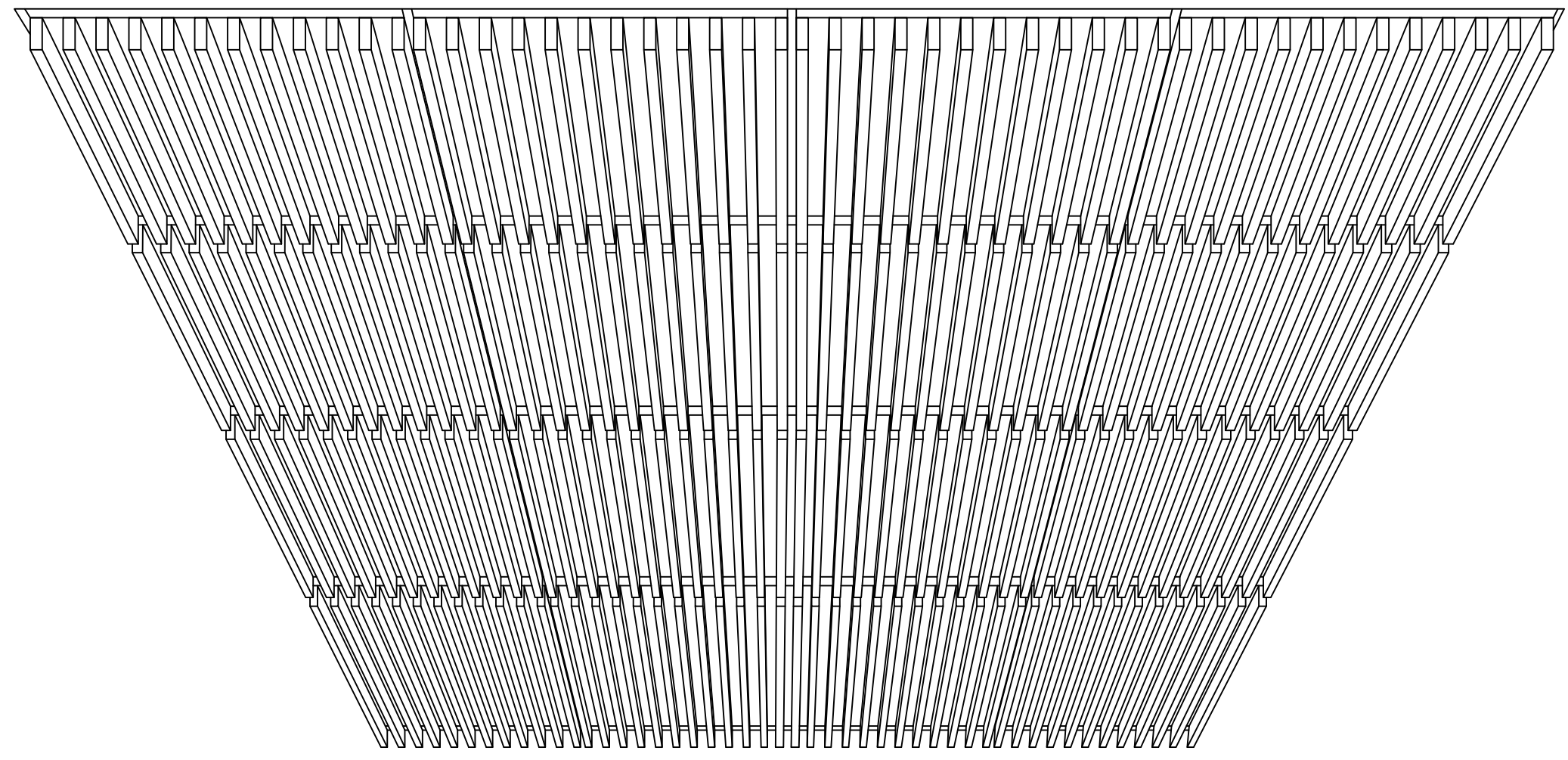

## 1.4 Installation

Supplemental Information 01

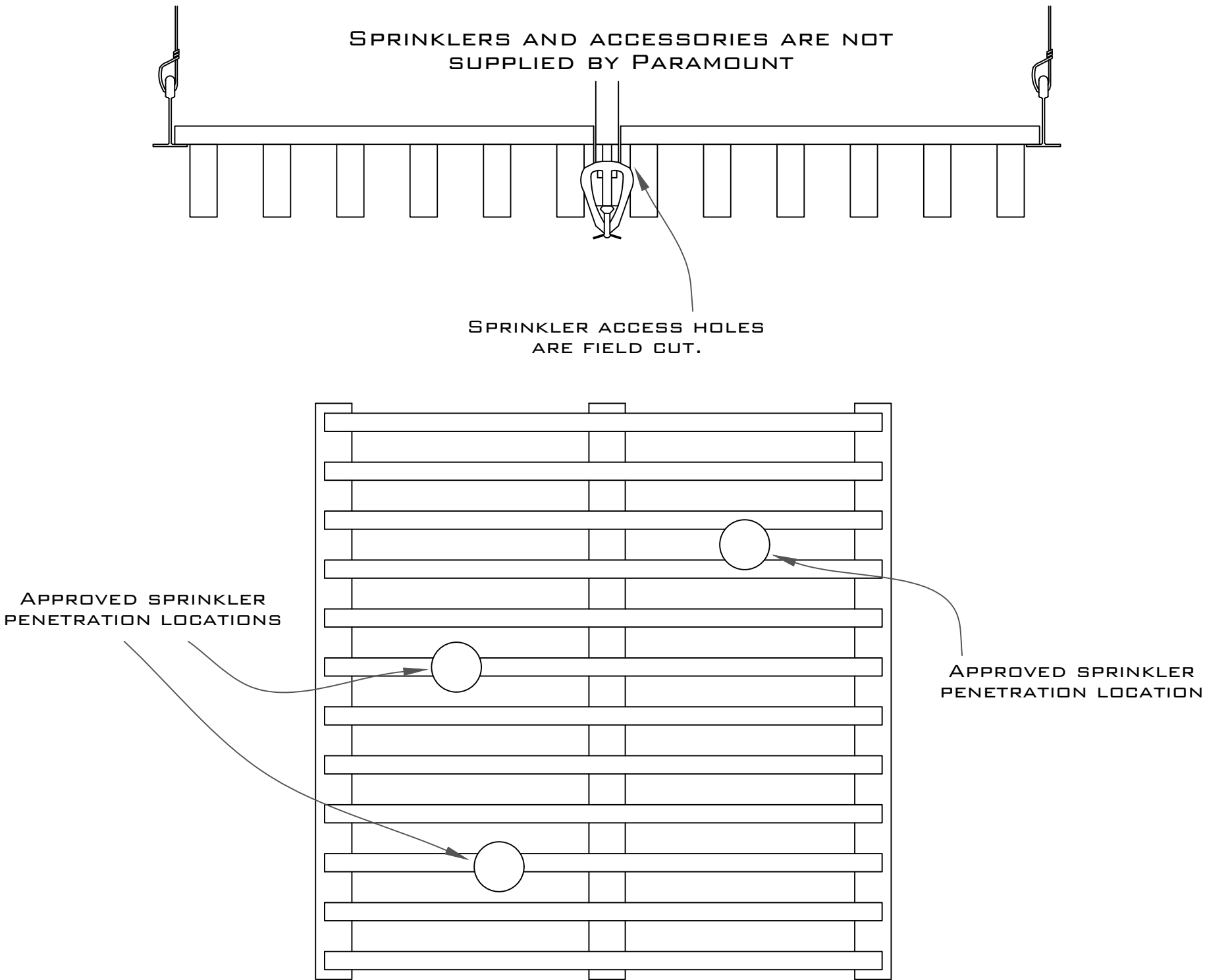

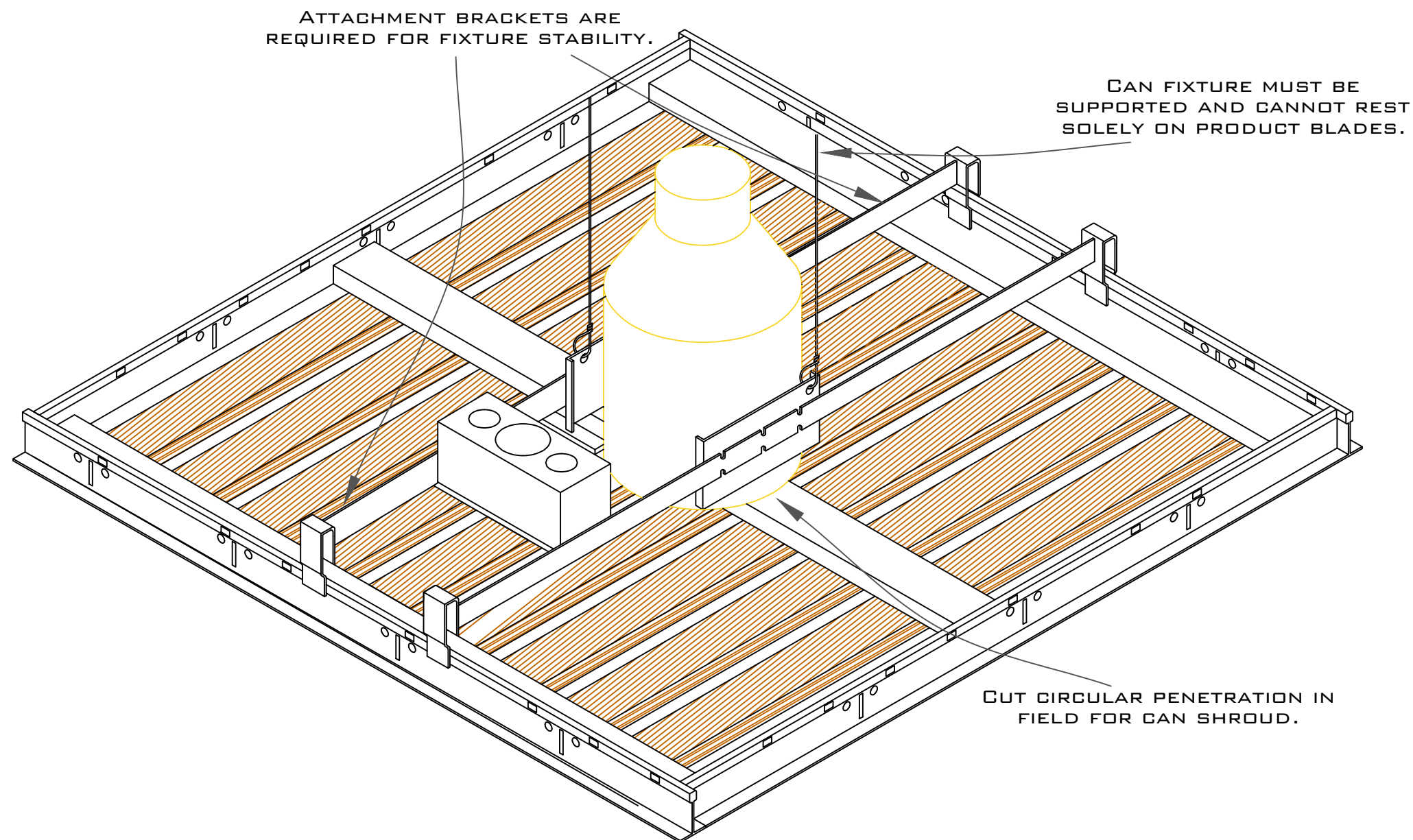

LIGHTING AND ACCESSORIES ARE NOT SUPPLIED BY PARAMOUNT

## 1.6 Standard Can Light Installation

Supplemental Information 04

**PARAMOUNT**  
CREATING EXQUISITE WOODWORK SINCE 1984

Drop In Panel Grille Series

PRODUCT SKU: MO-12-BKB1516

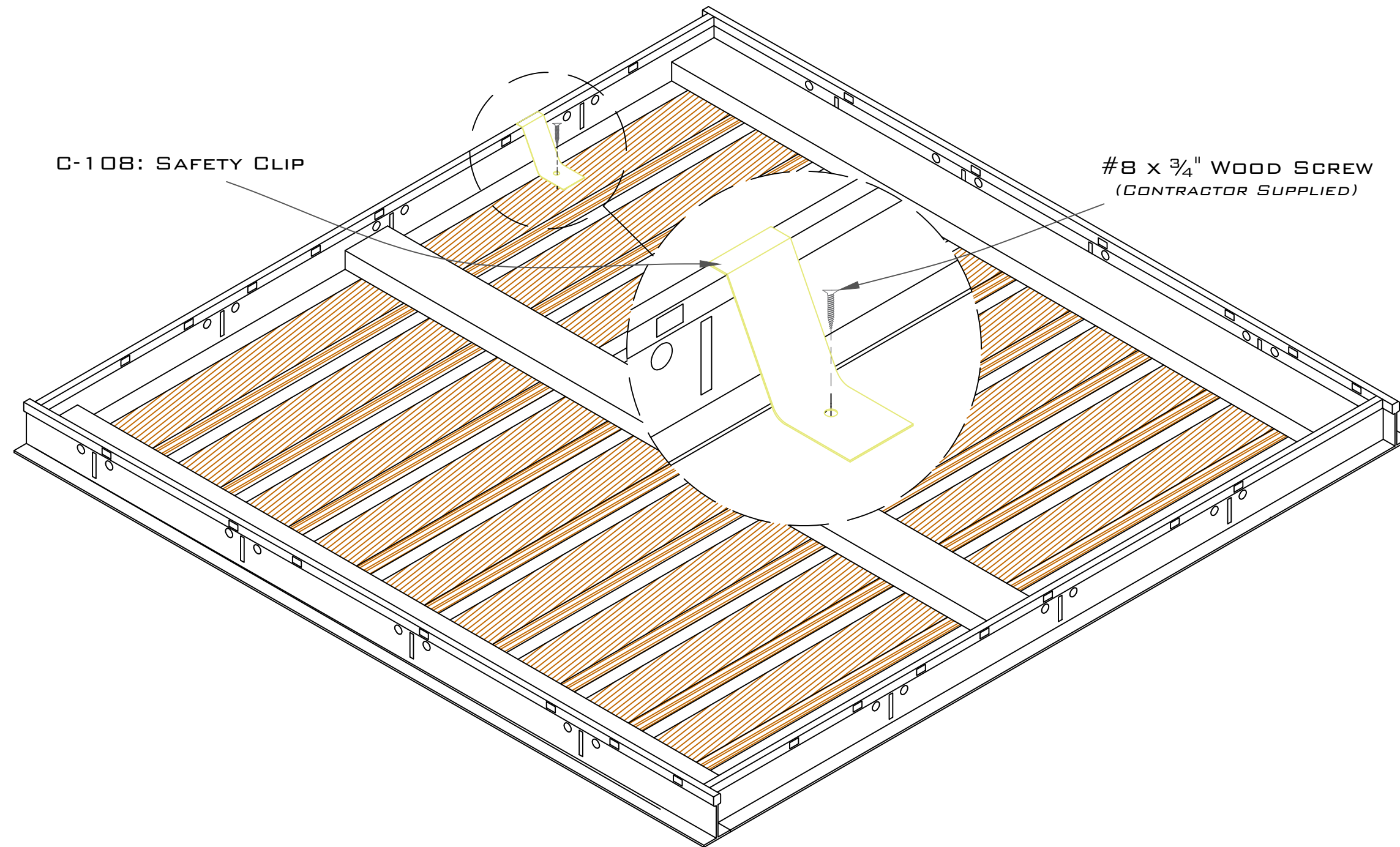

(1) CLIP PER TILE FOR  
SEISMIC STABILITY

## 1.7 C-108 Safety Clip Installation

Supplemental Information 05

**PARAMOUNT**  
CREATING EXQUISITE WOODWORK SINCE 1984

Drop In Panel Grille Series

PRODUCT SKU: MO-12-BKB1516