



Clearance Tools - In Stock, FCA Michigan

Id Number	Description	Price	Clearance 50% Off	On-Hand (MI)
87479	driven tool 90*	\$1,270.78	\$635.39	2
103691	straight driven tool	\$2,458.51	\$1,229.25	3
103804	straight driven tool	\$2,855.04	\$1,427.52	1
105455	driven tool 90*	\$2,285.48	\$1,142.74	1
121334	straight driven tool	\$1,620.74	\$810.37	3
123670	driven tool 90*	\$3,325.12	\$1,662.56	1
123774	straight driven tool	\$2,253.75	\$1,126.88	2
126308	driven tool 90*	\$4,269.58	\$2,134.79	1
126316	straight driven tool	\$1,720.24	\$860.12	3
126357	driven tool 90*	\$3,322.24	\$1,661.12	2
126398	driven tool 90*	\$3,551.51	\$1,775.75	1
126423	straight driven tool	\$1,829.82	\$914.91	1
126513	driven tool 90*	\$3,359.72	\$1,679.86	4
126555	straight driven tool	\$1,643.81	\$821.91	1

Free tool wrenches are included with all in-stock live tools!

Typenblatt
Data Sheet

Angetriebenes Werkzeug gerade
Werkzeugaufnahme HSK
straight driven tool ; tool location HSK

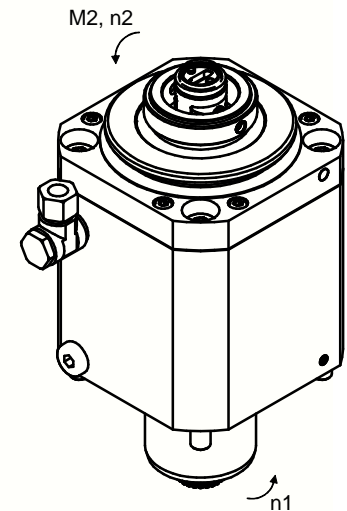
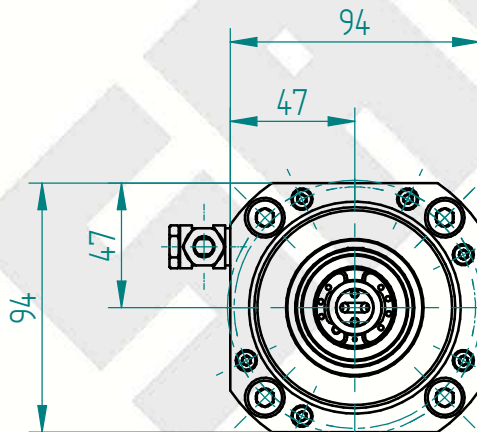
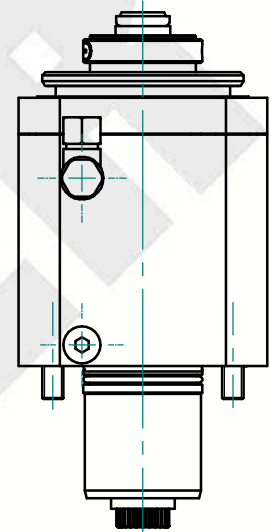
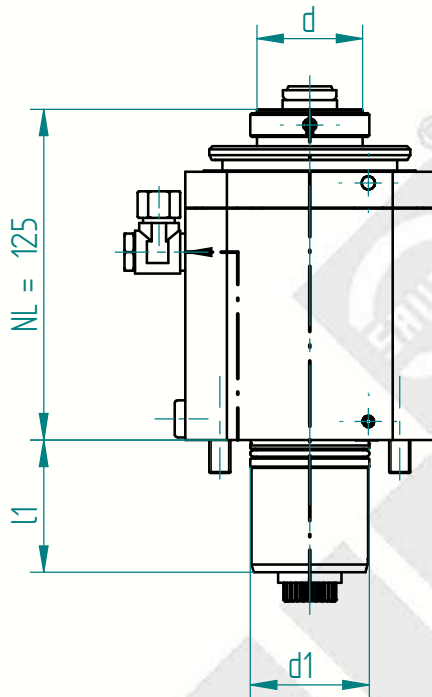
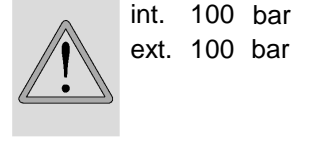
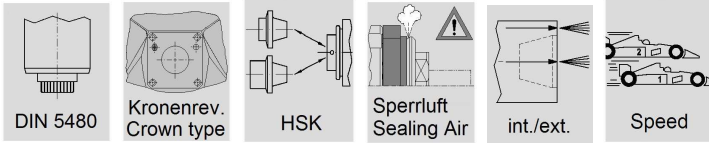

Änderungen vorbehalten. Subject to modification

Schnittstelle Revolver <i>interface tool turret</i>		Drehmoment <i>torque</i>	Drehzahl <i>tool speed</i>	Leistung <i>output</i>	Übersetzung <i>gear ratio</i>	Wkzg.Aufnahme Spannbereich <i>tool holding fixture clamping range</i>	Ausführung <i>version</i>	Bestell-Nr. <i>order N°</i>	
Schaft <i>shank</i>	Kupplung <i>coupling</i>								
d1 mm	l1 mm	M2 max Nm	n2 max 1/min	P max KW	i = n1 : n2	Spannbereich d <i>chucking capacity d</i>			
45	50.0	DIN 5480 W 20x0.8 x30x24	80.0	12000	10.0	1.00	DIN 69063 HSK - C 40	gerade <i>straight</i>	103691

Erforderliche(r) Schlüssel zur Werkzeugspannung / *necessary key(s) for tool clamping*

Inbusschlüssel / *Allen head wrench*



Typenblatt
Data Sheet

Angetriebenes Werkzeug gerade
Werkzeugaufnahme HSK
straight driven tool ; tool location HSK

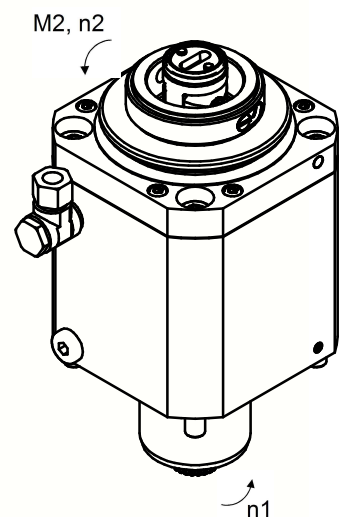
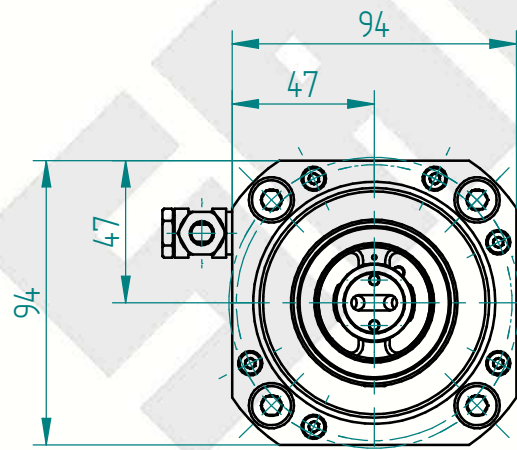
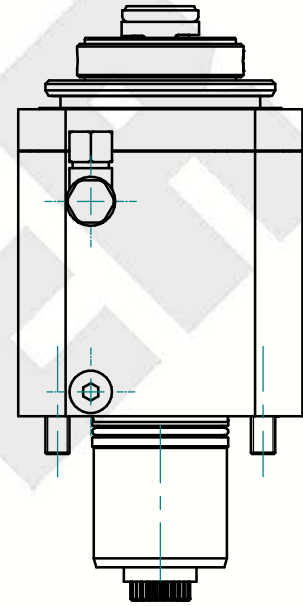
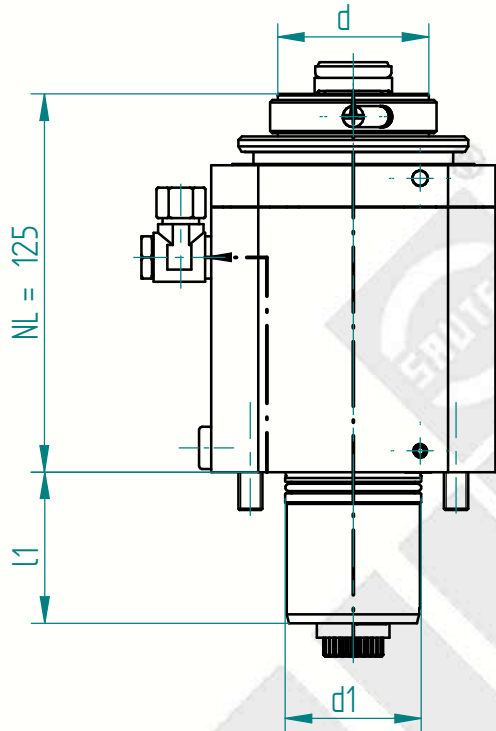
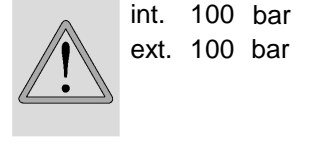
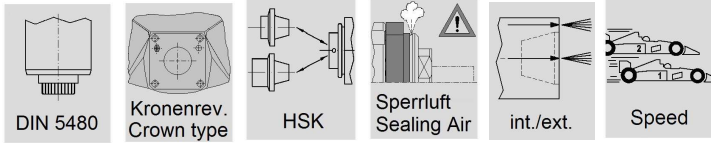

Schnittstelle Revolver <i>interface tool turret</i>		Drehmoment <i>torque</i>	Drehzahl <i>tool speed</i>	Leistung <i>output</i>	Übersetzung <i>gear ratio</i>	Wkzg.Aufnahme Spannbereich <i>tool holding fixture clamping range</i>	Ausführung <i>version</i>	Bestell-Nr. <i>order N°</i>
Schaft <i>shank</i>	Kupplung <i>coupling</i>							
d1 mm	l1 mm	M2 max Nm	n2 max 1/min	P max KW	i = n1: n2	Spannbereich d <i>chucking capacity d</i>		
45	50.0	DIN 5480 W 20x0.8 x30x24 80.0	12000	10.0	1.00	DIN 69063 HSK - C 50	gerade <i>straight</i>	103692

Erforderliche(r) Schlüssel zur Werkzeugspannung / *necessary key(s) for tool clamping*

Inbusschlüssel / *Allen head wrench*



Typenblatt
Data Sheet

Angetriebenes Werkzeug gerade Werkzeugaufnahme HSK

straight driven tool ; tool location HSK

SAUTER
Mit uns dreht die Welt!

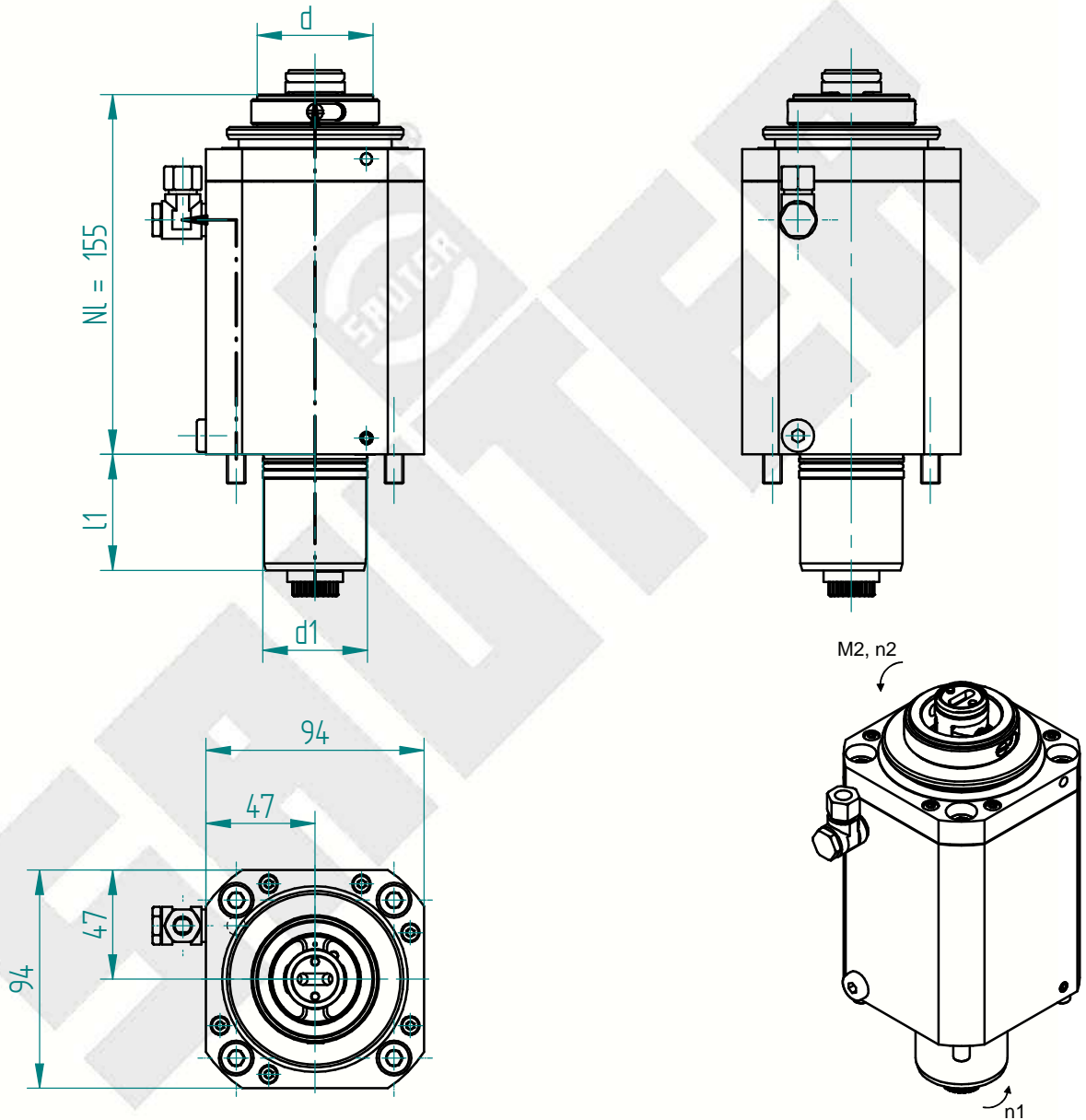
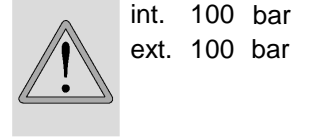
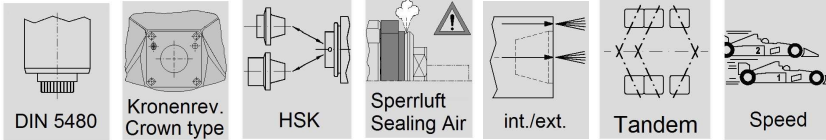

Schnittstelle Revolver interface tool turret		Drehmoment torque	Drehzahl tool speed	Leistung output	Übersetzung gear ratio	Wkzg.Aufnahme Spannbereich tool holding fixture clamping range	Ausführung version	Bestell-Nr. order N°
Schaft shank	Kupplung coupling							
d1 mm	l1 mm	M2 max Nm	n2 max 1/min	P max KW	i = n1: n2	Spannbereich d chucking capacity d		
45	50.0	DIN 5480 W 20x0.8 x30x24 80.0	10000	10.0	1.00	DIN 69063 HSK - C 50	gerade straight	103804

Erforderliche(r) Schlüssel zur Werkzeugspannung / necessary key(s) for tool clamping

Inbusschlüssel / Allen head wrench

Sauter Feinmechanik GmbH Carl-Zeiss-Straße 7 72555 Metzingen Germany
Telefon +49 7123 926 0 Telefax +49 7123 926 190 www.sauter-feinmechanik.com

Gewicht in kg:
weight in kg: 8.50



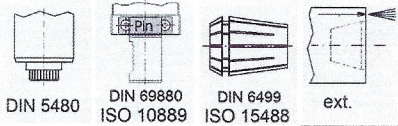

ext. 80 bar

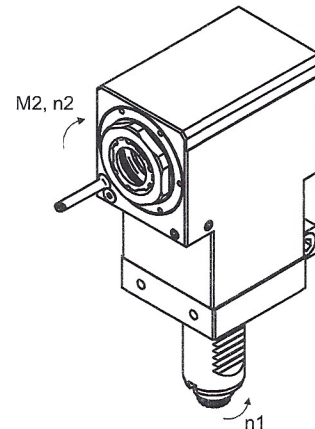
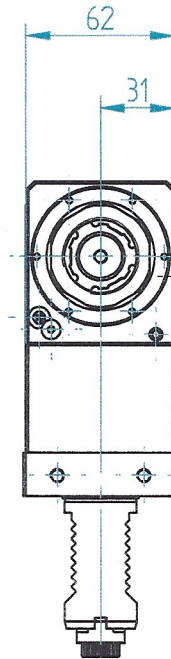
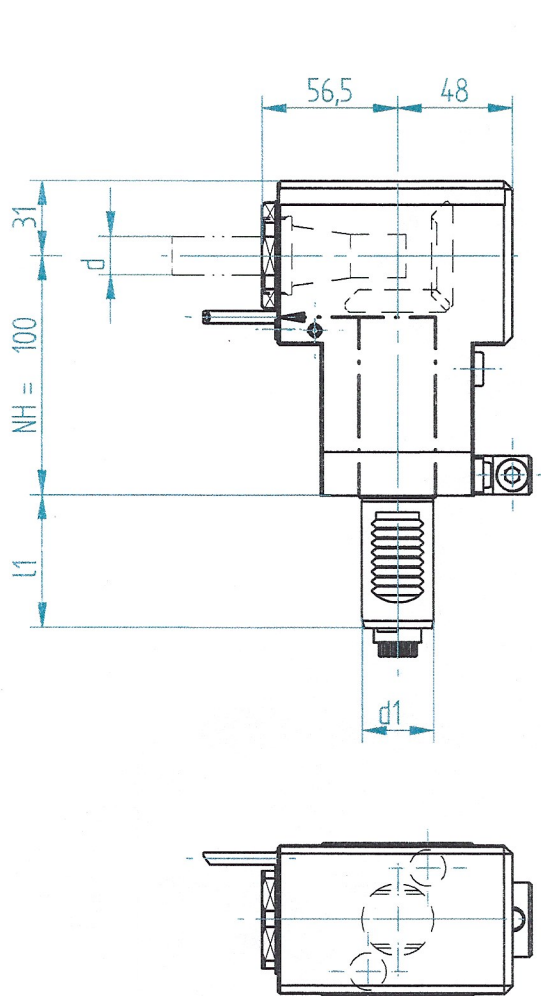

Schnittstelle Revolver interface tool turret		Drehmoment torque	Drehzahl tool speed	Leistung output	Übersetzung gear ratio	Wkzg.Aufnahme Spannbereich tool holding fixture clamping range	Ausführung version	Bestell-Nr. order N°
Schaft shank	Kupplung coupling							
d1 mm	l1 mm	M2 max Nm	n2 max 1/min	P max KW	i = n1: n2	Spannbereich d chucking capacity d		
30	55.0	32.0	7000	8.0	1.00	ISO 15488 - 25 - I 1-16	universal universal	105455

Erforderliche(r) Schlüssel zur Werkzeugspannung / necessary key(s) for tool clamping

105762



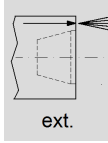
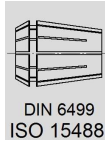
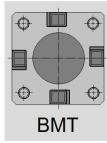

ext. 80 bar

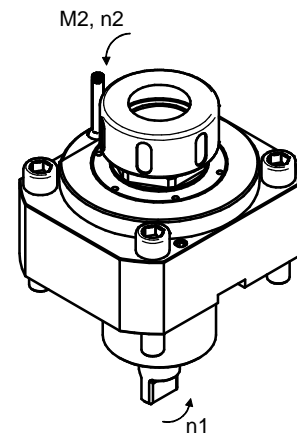
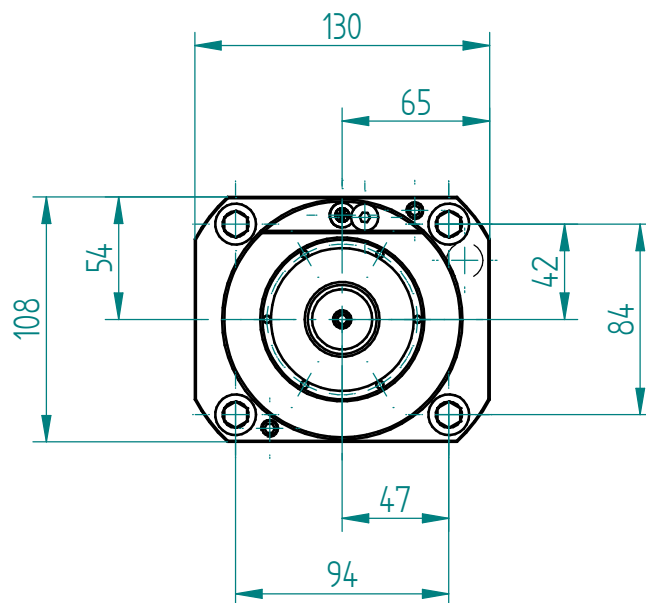
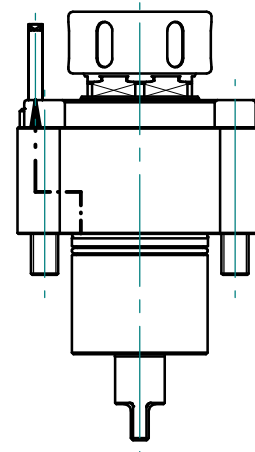
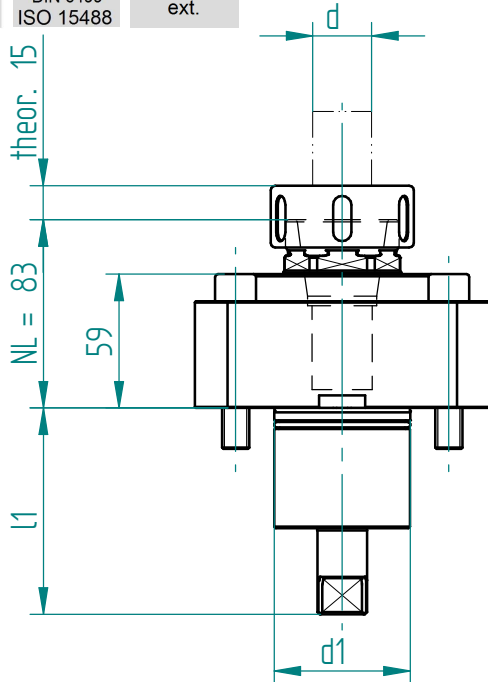

Änderungen vorbehalten. Subject to modification

Schnittstelle Revolver <i>interface tool turret</i>		Drehmoment <i>torque</i>	Drehzahl <i>tool speed</i>	Leistung <i>output</i>	Übersetzung <i>gear ratio</i>	Wkzg.Aufnahme Spannbereich <i>tool holding fixture clamping range</i>	Ausführung <i>version</i>	Bestell-Nr. <i>order N°</i>	
Schaft <i>shank</i>	Kupplung <i>coupling</i>								
d1 mm	l1 mm	M2 max Nm	n2 max 1/min	P max KW	i = n1 : n2	Spannbereich d <i>chucking capacity d</i>			
60	91.0	BMT Mori Seiki 60	100.0	6000	5.5	-1.00	ISO 15488 - 40 - A 3-26	gerade <i>straight</i>	121334

Erforderliche(r) Schlüssel zur Werkzeugspannung / *necessary key(s) for tool clamping*

122191

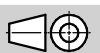

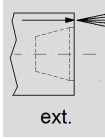
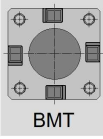

ext. 80 bar

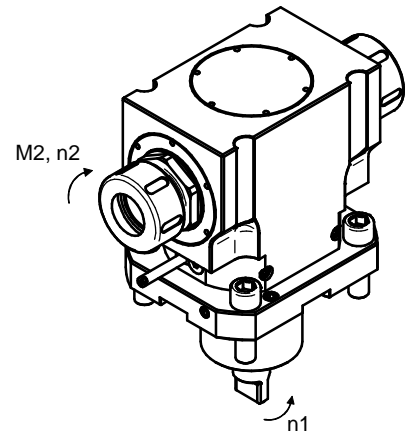
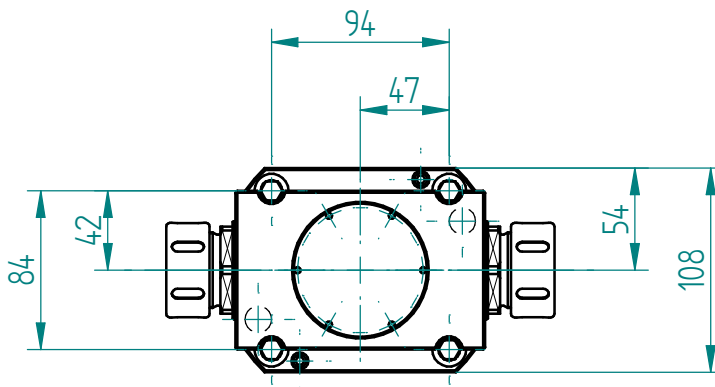
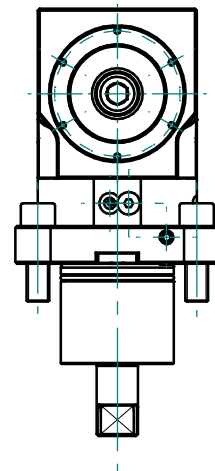
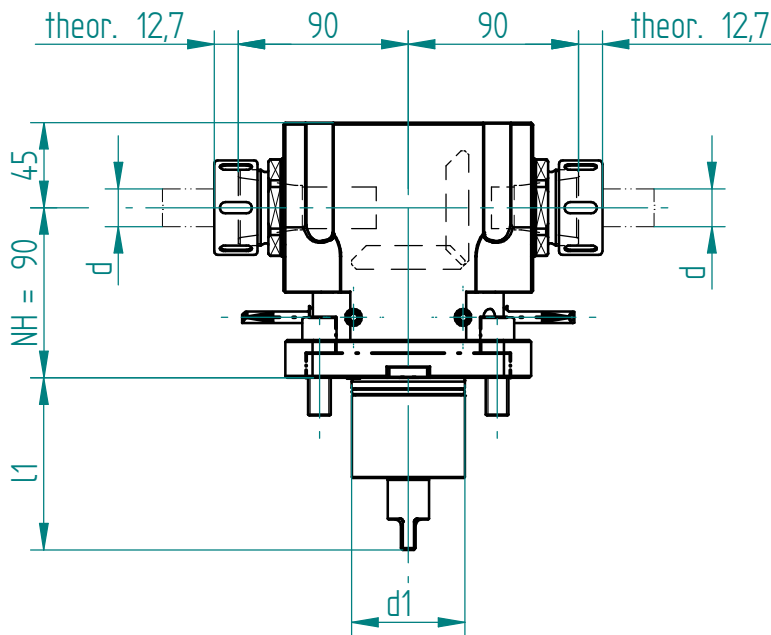

Änderungen vorbehalten. Subject to modification

Schnittstelle Revolver <i>interface tool turret</i>		Drehmoment <i>torque</i>	Drehzahl <i>tool speed</i>	Leistung <i>output</i>	Übersetzung <i>gear ratio</i>	Wkzg.Aufnahme Spannbereich <i>tool holding fixture clamping range</i>	Ausführung <i>version</i>	Bestell-Nr. <i>order N°</i>	
Schaft <i>shank</i>	Kupplung <i>coupling</i>								
d1 mm	l1 mm	M2 max Nm	n2 max 1/min	P max KW	i = n1 : n2	Spannbereich d <i>chucking capacity d</i>			
60	91.0	BMT Mori Seiki 60	100.0	6000	5.5	1.00	ISO 15488 - 32 - A 2-20	universal universal	121437

Erforderliche(r) Schlüssel zur Werkzeugspannung / *necessary key(s) for tool clamping*

122194



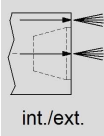
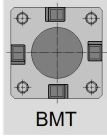

int. 80 bar
ext. 80 bar
- \diamond 50 μ m
- Dry run: 100%

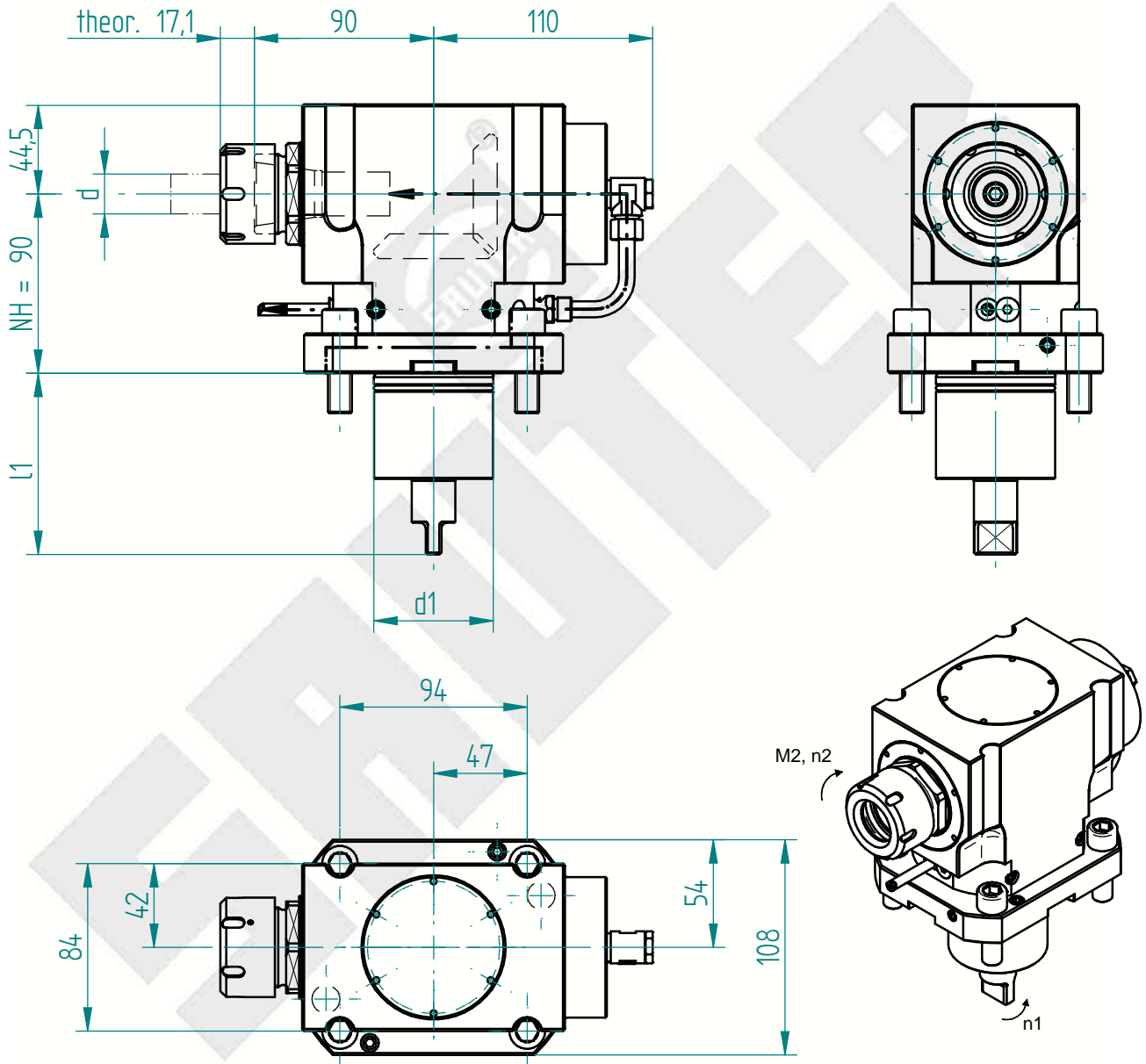

Änderungen vorbehalten. Subject to modification

Schnittstelle Revolver <i>interface tool turret</i>		Drehmoment <i>torque</i>	Drehzahl <i>tool speed</i>	Leistung <i>output</i>	Übersetzung <i>gear ratio</i>	Wkzg.Aufnahme Spannbereich <i>tool holding fixture clamping range</i>	Ausführung <i>version</i>	Bestell-Nr. <i>order N°</i>	
Schaft <i>shank</i>	Kupplung <i>coupling</i>								
d1 mm	l1 mm	M2 max Nm	n2 max 1/min	P max KW	i = n1: n2	Spannbereich d <i>chucking capacity d</i>			
60	91.0	BMT Mori Seiki 60	100.0	6000	5.5	1.00	ISO 15488 - 32 - A 2-20	universal universal	123670

Erforderliche(r) Schlüssel zur Werkzeugspannung / *necessary key(s) for tool clamping*

147843



Typenblatt
Data Sheet

Angetriebenes Werkzeug gerade Spannzangenaufnahme

straight driven tool ; collet chuck

SAUTER
Mit uns dreht die Welt!

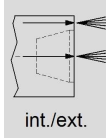
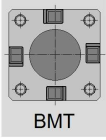

int. 80 bar
ext. 80 bar
- \diamond 50 μ m
- Dry run: 100%

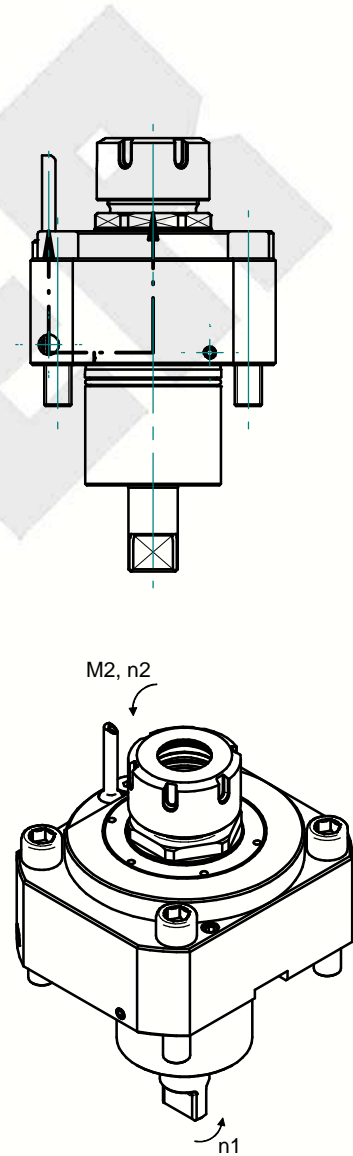
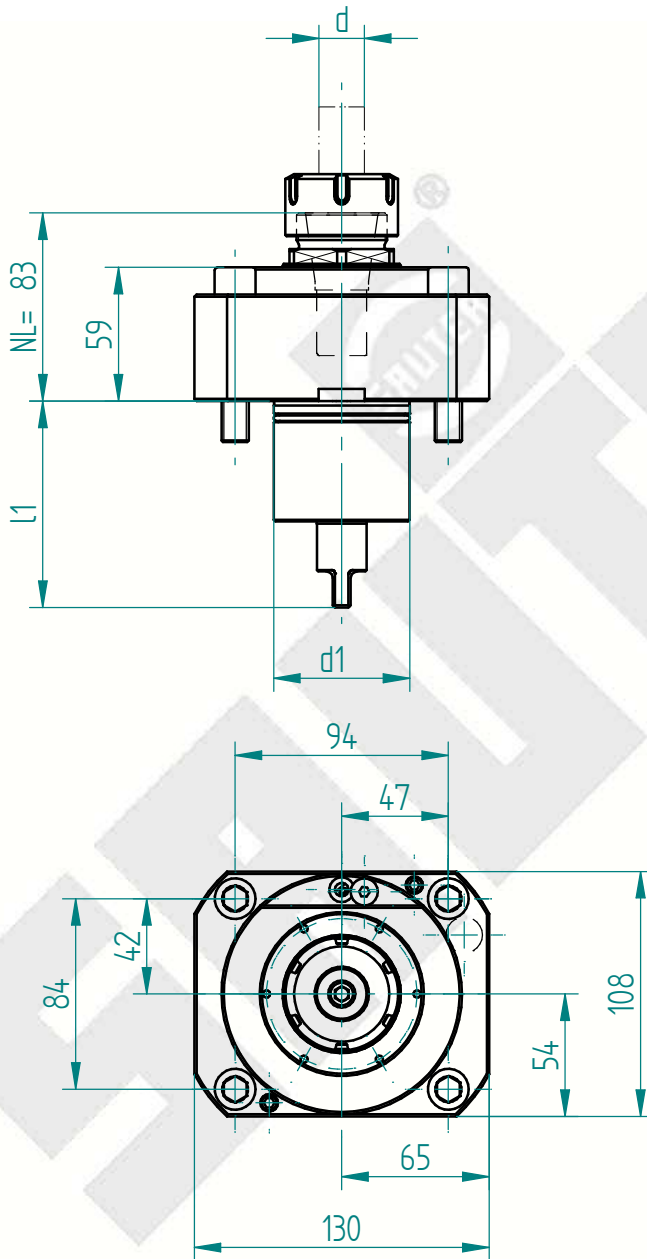

Änderungen vorbehalten. Subject to modification

Schnittstelle Revolver interface tool turret		Drehmoment torque	Drehzahl tool speed	Leistung output	Übersetzung gear ratio	Wkzg.Aufnahme Spannbereich tool holding fixture clamping range	Ausführung version	Bestell-Nr. order N°	
Schaft shank	Kupplung coupling								
d1 mm	l1 mm	M2 max Nm	n2 max 1/min	P max KW	i = n1 : n2	Spannbereich d chucking capacity d			
60	91.0	BMT Mori Seiki 60	100.0	6000	5.5	1.00	ISO 15488 - 32 - A 2-20	gerade straight	123774

Erforderliche(r) Schlüssel zur Werkzeugspannung / necessary key(s) for tool clamping

147843

Sauter Feinmechanik GmbH Carl-Zeiss-Straße 7 72555 Metzingen Germany
Telefon +49 7123 926 0 Telefax +49 7123 926 190 www.sauter-feinmechanik.com

Gewicht in kg:
weight in kg: 6.81



Typenblatt
Data Sheet

Angetriebenes Werkzeug 90°
Spannzangenaufnahme
driven tool 90° ; collet chuck

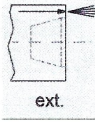
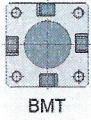

ext. 80 bar

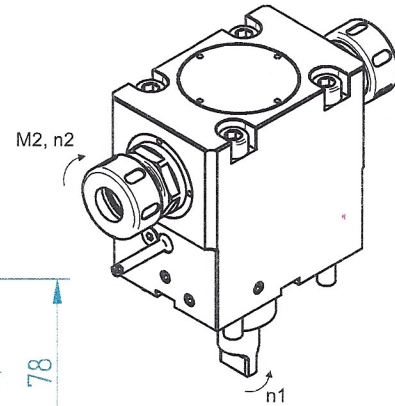
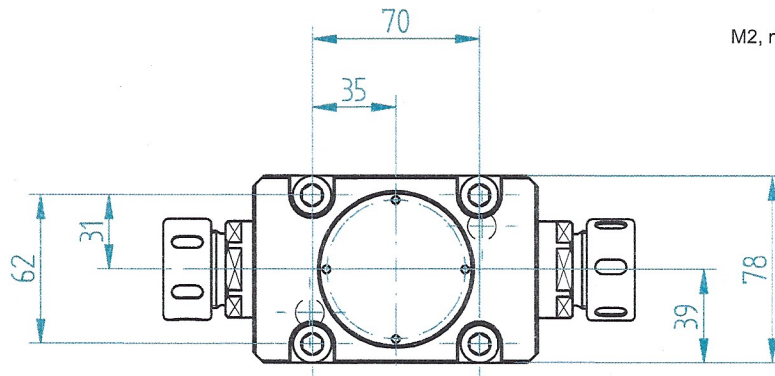
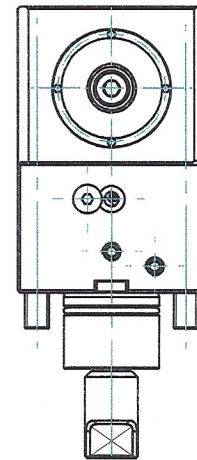
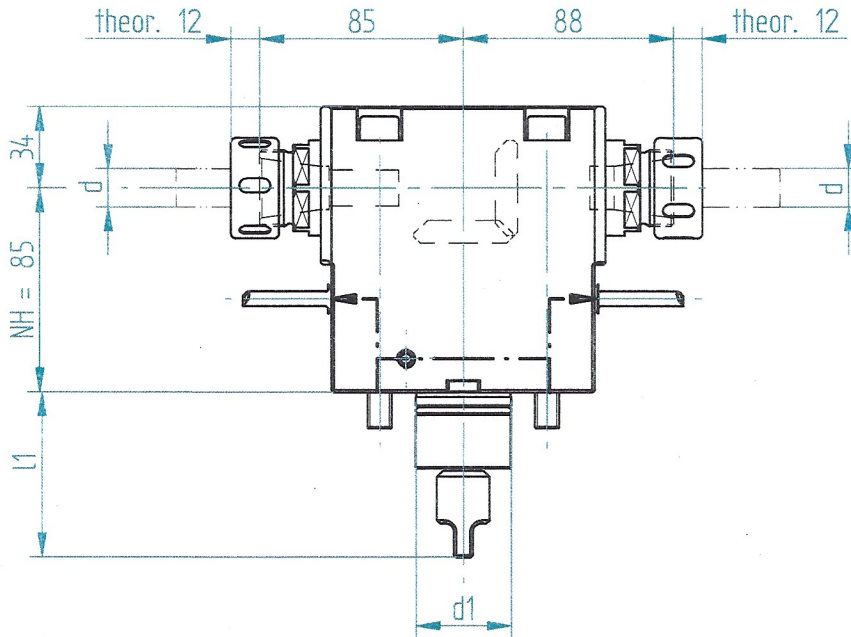

Änderungen vorbehalten. Subject to modification

Schnittstelle Revolver interface tool turret		Drehmoment torque	Drehzahl tool speed	Leistung output	Übersetzung gear ratio	Wkzg.Aufnahme Spannbereich tool holding fixture clamping range	Ausführung version	Bestell-Nr. order N°	
Schaft shank	Kupplung coupling								
d1 mm	l1 mm	M2 max Nm	n2 max 1/min	P max KW	i = n1 : n2	Spannbereich d chucking capacity d			
40	69.0	BMT Mori Seiki 40	32.0	6000	7.5	1.00	ISO 15488 - 25 - A 1-16	universal universal	126308

Erforderliche(r) Schlüssel zur Werkzeugspannung / necessary key(s) for tool clamping

129817



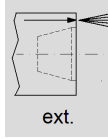
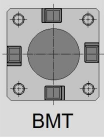

ext. 80 bar

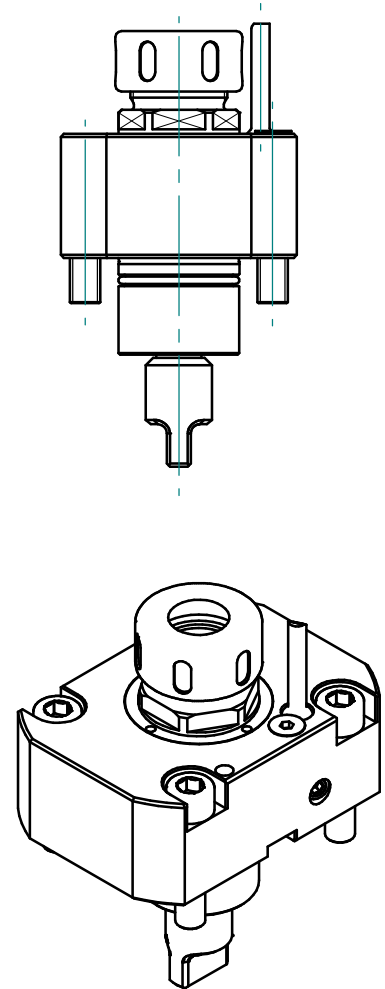
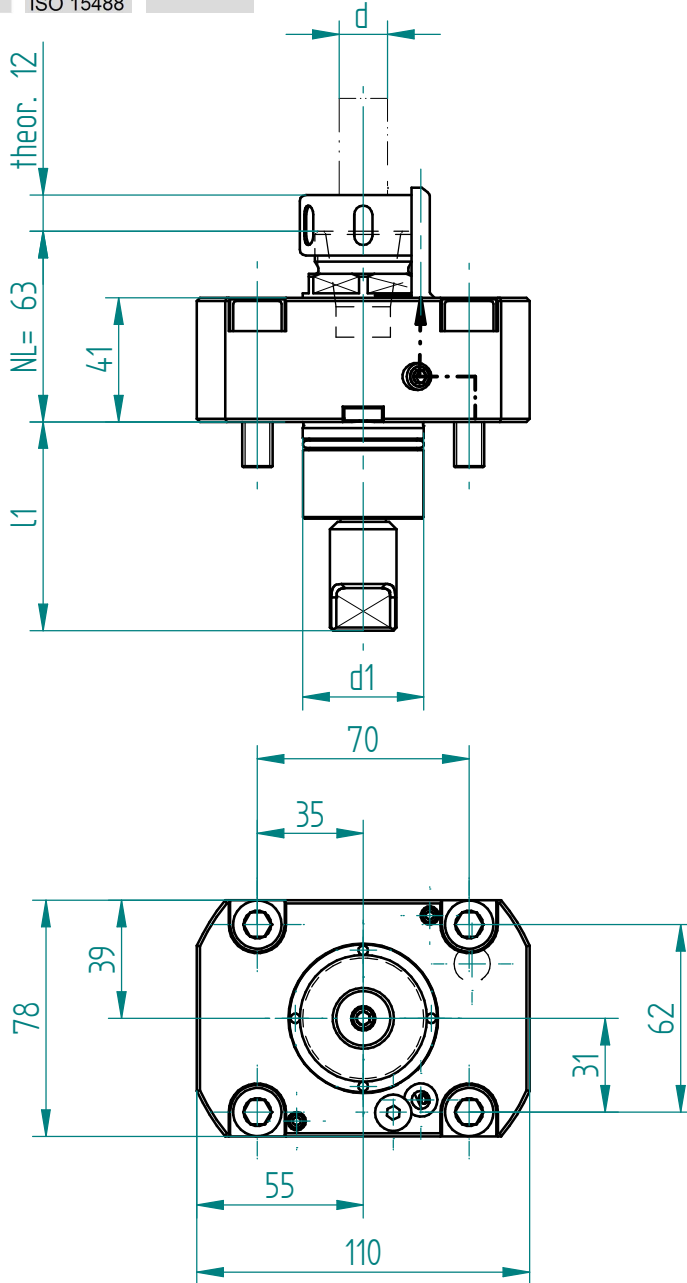

Änderungen vorbehalten. Subject to modification

Schnittstelle Revolver <i>interface tool turret</i>		Drehmoment <i>torque</i>	Drehzahl <i>tool speed</i>	Leistung <i>output</i>	Übersetzung <i>gear ratio</i>	Wkzg.Aufnahme Spannbereich <i>tool holding fixture clamping range</i>	Ausführung <i>version</i>	Bestell-Nr. <i>order N°</i>	
Schaft <i>shank</i>	Kupplung <i>coupling</i>								
d1 mm	l1 mm	M2 max Nm	n2 max 1/min	P max KW	i = n1: n2	Spannbereich d <i>chucking capacity d</i>			
40	69.0	BMT Mori Seiki 40	32.0	6000	7.5	-1.00	ISO 15488 - 25 - A 1-16	gerade <i>straight</i>	126316

Erforderliche(r) Schlüssel zur Werkzeugspannung / *necessary key(s) for tool clamping* 129817

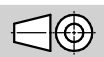

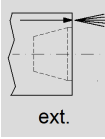
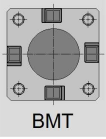

ext. 80 bar

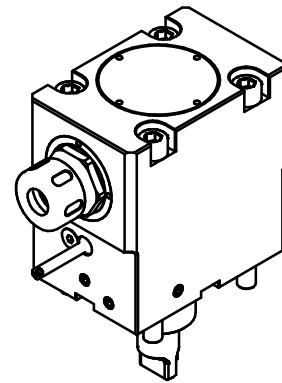
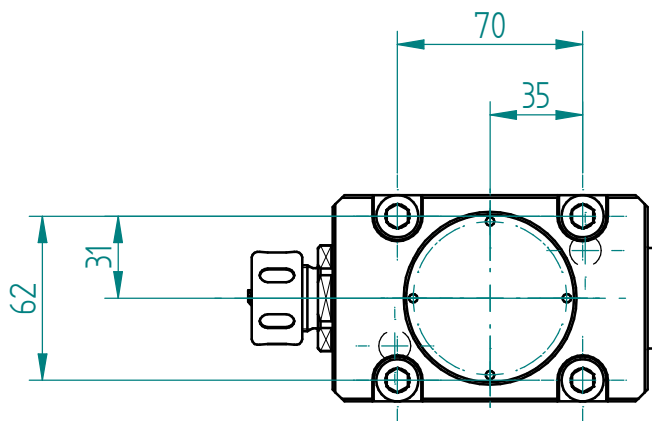
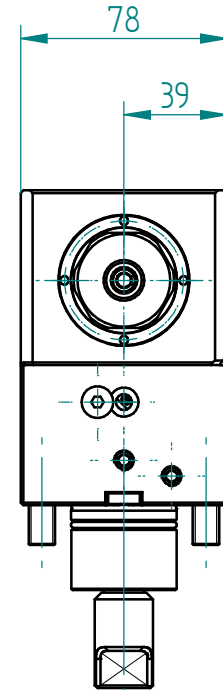
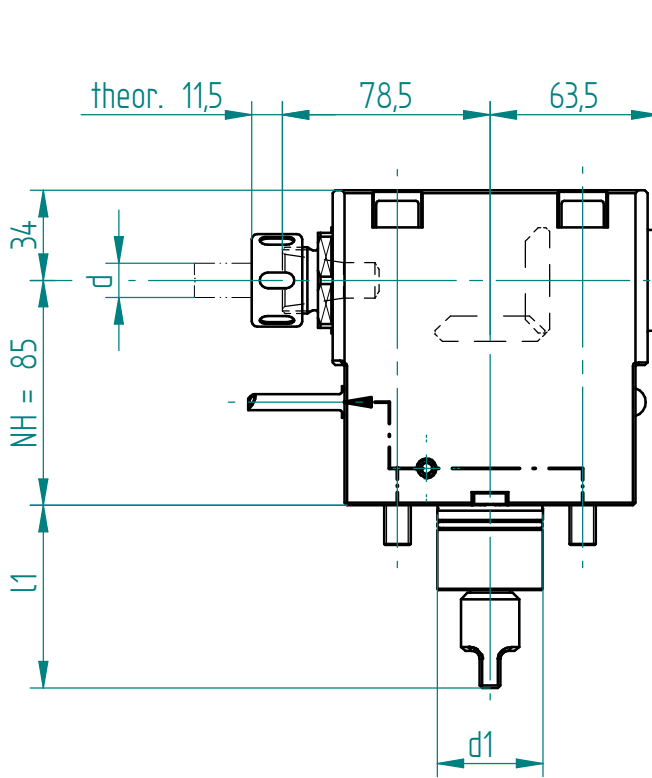

Änderungen vorbehalten. Subject to modification

Schnittstelle Revolver <i>interface tool turret</i>		Drehmoment <i>torque</i>	Drehzahl <i>tool speed</i>	Leistung <i>output</i>	Übersetzung <i>gear ratio</i>	Wkzg.Aufnahme Spannbereich <i>tool holding fixture clamping range</i>	Ausführung <i>version</i>	Bestell-Nr. <i>order N°</i>	
Schaft <i>shank</i>	Kupplung <i>coupling</i>								
d1 mm	l1 mm	M2 max Nm	n2 max 1/min	P max KW	i = n1: n2	Spannbereich d <i>chucking capacity d</i>			
40	69.0	BMT Mori Seiki 40	32.0	6000	7.5	1.00	ISO 15488 - 20 - A 1-13	universal universal	126357

Erforderliche(r) Schlüssel zur Werkzeugspannung / *necessary key(s) for tool clamping*

129816





BMT



DIN 6499
ISO 15488



ext.



ext. 80 bar

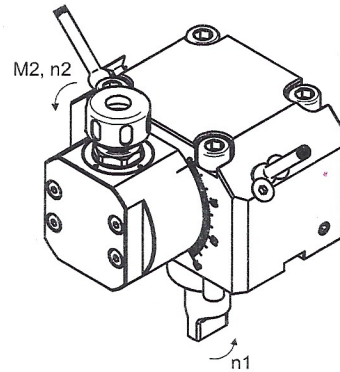
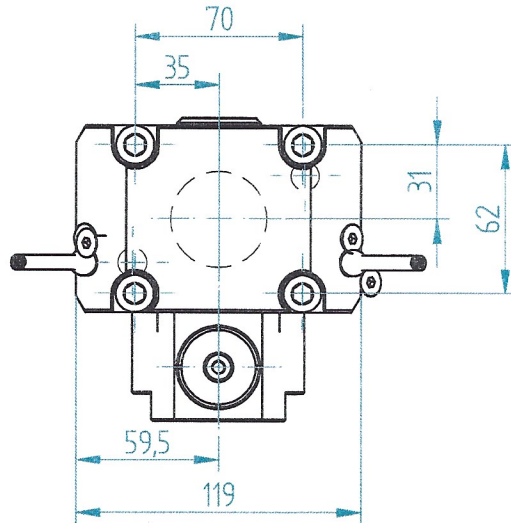
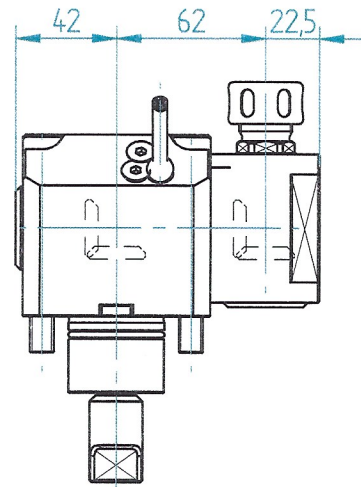
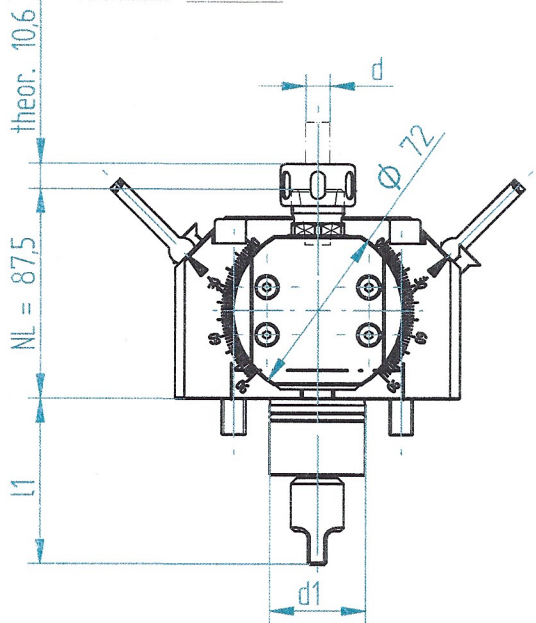

Änderungen vorbehalten, Subject to modification

Schnittstelle Revolver <i>interface tool turret</i>		Kupplung <i>coupling</i>	Drehmoment <i>torque</i>	Drehzahl <i>tool speed</i>	Leistung <i>output</i>	Übersetzung <i>gear ratio</i>	Wkzg.Aufnahme Spannbereich <i>tool holding fixture clamping range</i>	Ausführung <i>version</i>	Bestell-Nr. <i>order N°</i>
Schaft <i>shank</i>									
d1 mm	l1 mm		M2 max Nm	n2 max 1/min	P max KW	i = n1 : n2	Spannbereich d <i>chucking capacity d</i>		
40	69.0	BMT Mori Seiki 40	8.0	6000	3.0	1.00	ISO 15488 - 16 - A 1-10	universal universal	126371

Erforderliche(r) Schlüssel zur Werkzeugspannung / *necessary key(s) for tool clamping*

126657



Typenblatt
Data Sheet

Angetriebenes Werkzeug 90° Spannzangenaufnahme

driven tool 90° ; collet chuck



BMT



DIN 6499
ISO 15488



int./ext.



int. 80 bar
ext. 80 bar
- \diamond 50 μ m
- Dry run: 100%

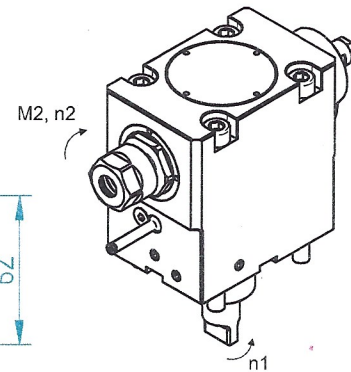
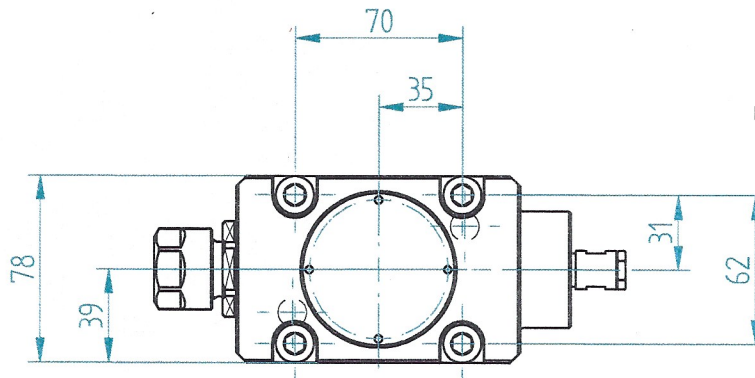
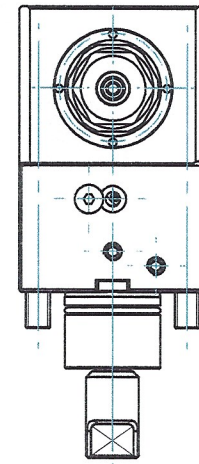
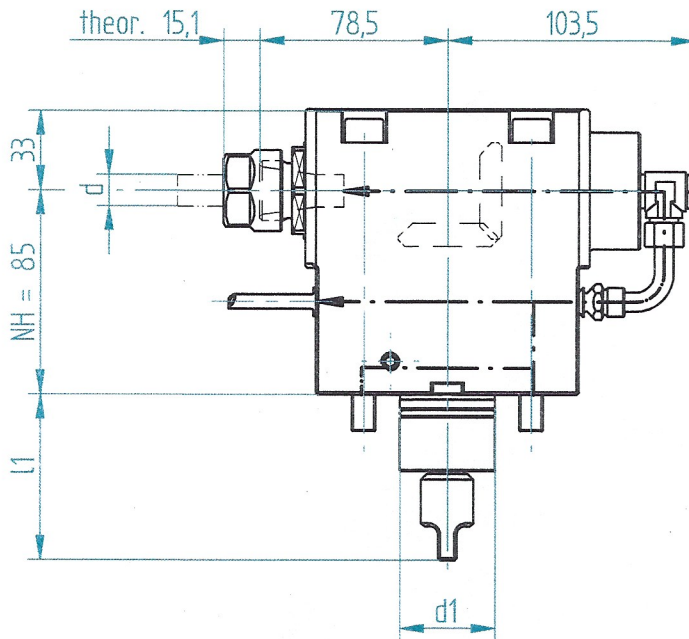

Änderungen vorbehalten, Subject to modification

Schnittstelle Revolver interface tool turret		Drehmoment torque	Drehzahl tool speed	Leistung output	Übersetzung gear ratio	Wkzg.Aufnahme Spannbereich tool holding fixture clamping range	Ausführung version	Bestell-Nr. order N°	
Schaft shank	Kupplung coupling								
d1 mm	l1 mm	M2 max Nm	n2 max 1/min	P max KW	i = n1: n2	Spannbereich d chucking capacity d			
40	69.0	BMT Mori Seiki 40	32.0	6000	7.5	1.00	ISO 15488 - 20 - A 1-13	universal universal	126398

Erforderliche(r) Schlüssel zur Werkzeugspannung / necessary key(s) for tool clamping

080066

Sauter Feinmechanik GmbH Carl-Zeiss-Straße 7 72555 Metzingen Germany
Telefon +49 7123 926 0 Telefax +49 7123 926 190 www.sauter-feinmechanik.com

Gewicht in kg:
weight in kg: 7.64



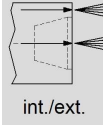
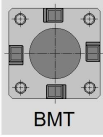

int. 80 bar
ext. 80 bar
- \diamond 50 μ m
- Dry run: 100%

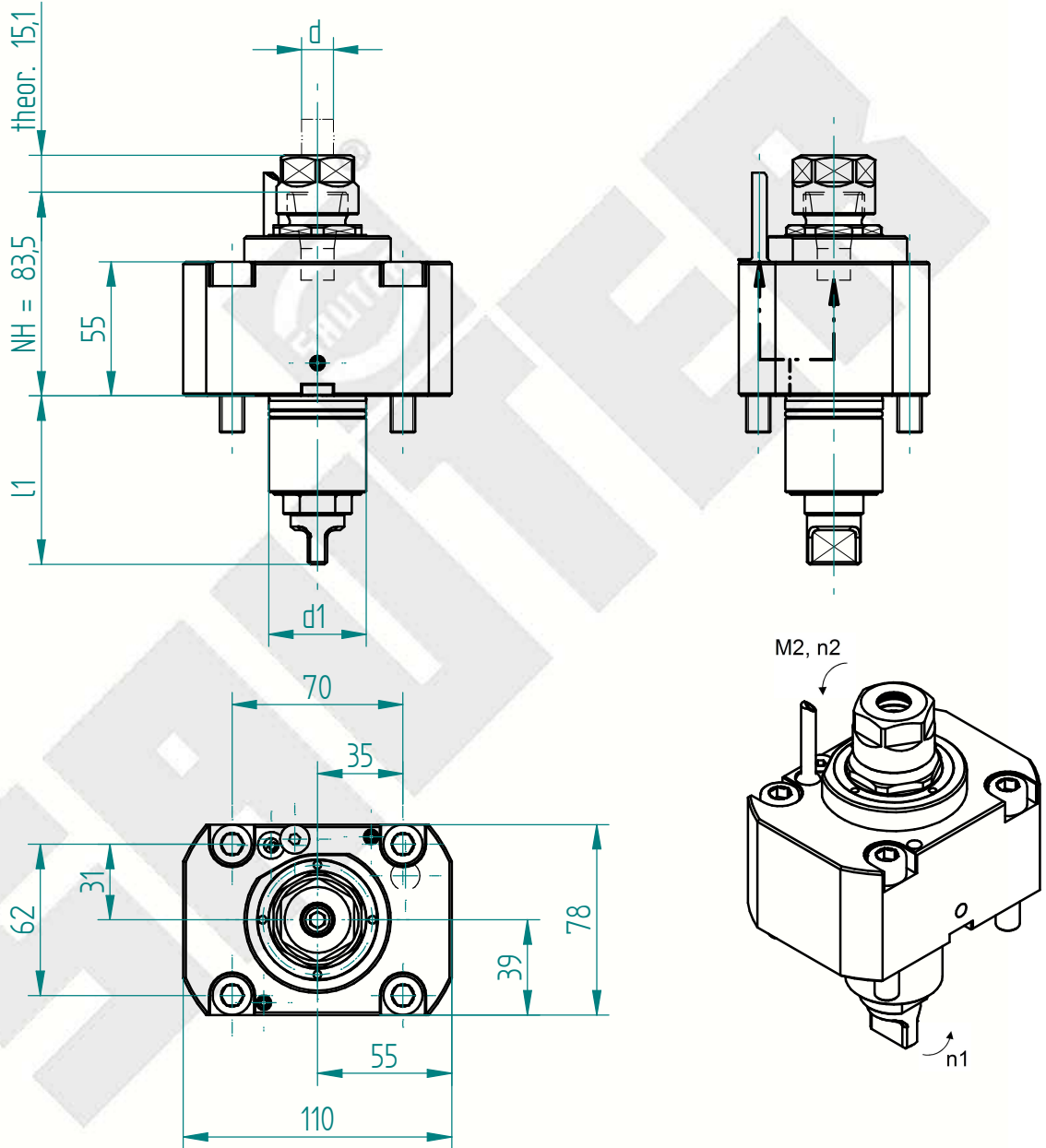

Änderungen vorbehalten. Subject to modification

Schnittstelle Revolver <i>interface tool turret</i>		Drehmoment <i>torque</i>	Drehzahl <i>tool speed</i>	Leistung <i>output</i>	Übersetzung <i>gear ratio</i>	Wkzg.Aufnahme Spannbereich <i>tool holding fixture clamping range</i>	Ausführung <i>version</i>	Bestell-Nr. <i>order N°</i>	
Schaft <i>shank</i>	Kuplung <i>coupling</i>								
d1 mm	l1 mm	M2 max Nm	n2 max 1/min	P max KW	i = n1: n2	Spannbereich d <i>chucking capacity d</i>			
40	69.0	BMT Mori Seiki 40	32.0	6000	7.5	1.000	ISO 15488 - 20 - A 1-13	gerade <i>straight</i>	126423

Erforderliche(r) Schlüssel zur Werkzeugspannung / *necessary key(s) for tool clamping*

080066



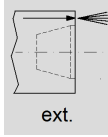
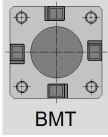

ext. 80 bar

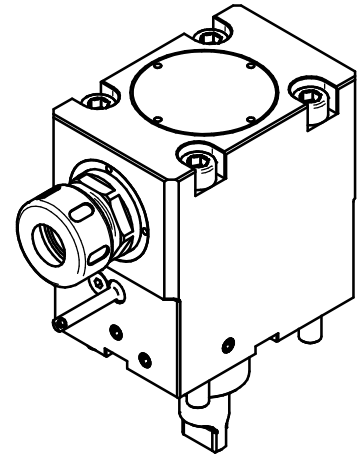
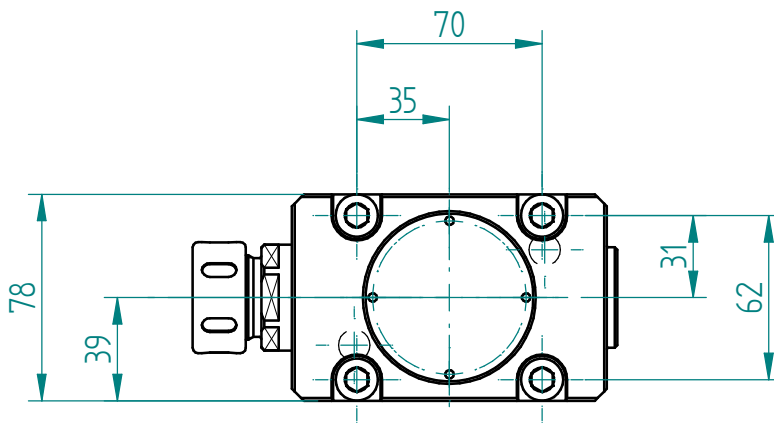
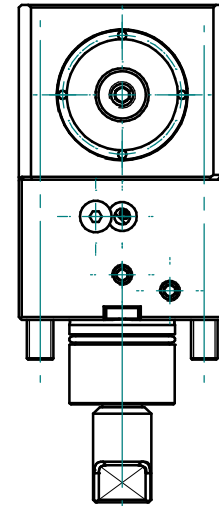
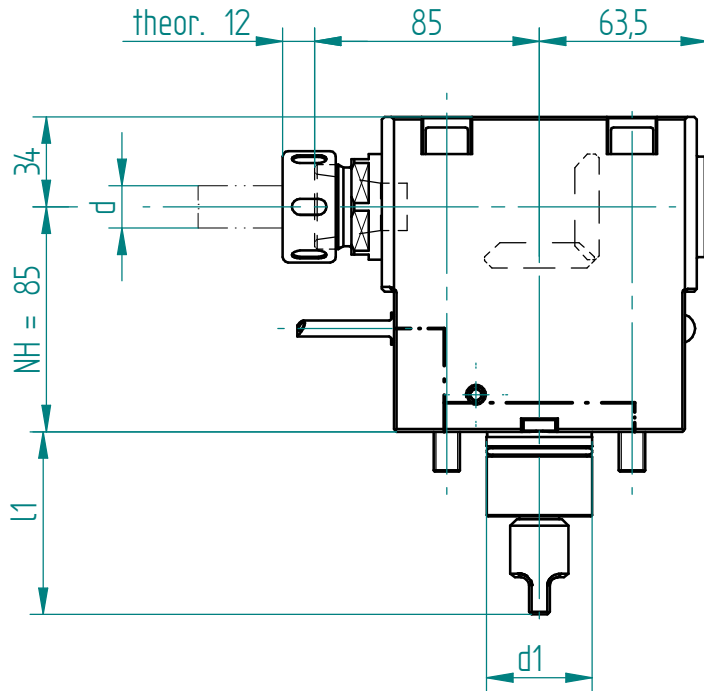

Änderungen vorbehalten. Subject to modification

Schnittstelle Revolver <i>interface tool turret</i>		Drehmoment <i>torque</i>	Drehzahl <i>tool speed</i>	Leistung <i>output</i>	Übersetzung <i>gear ratio</i>	Wkzg.Aufnahme Spannbereich <i>tool holding fixture clamping range</i>	Ausführung <i>version</i>	Bestell-Nr. <i>order N°</i>	
Schaft <i>shank</i>	Kuplung <i>coupling</i>								
d1 mm	l1 mm	M2 max Nm	n2 max 1/min	P max KW	i = n1: n2	Spannbereich d <i>chucking capacity d</i>			
40	69.0	BMT Mori Seiki 40	32.0	6000	7.5	1.00	ISO 15488 - 25 - A 1-16	universal universal	126513

Erforderliche(r) Schlüssel zur Werkzeugspannung / *necessary key(s) for tool clamping*

129817



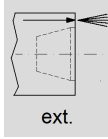
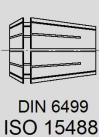
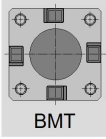

ext. 80 bar

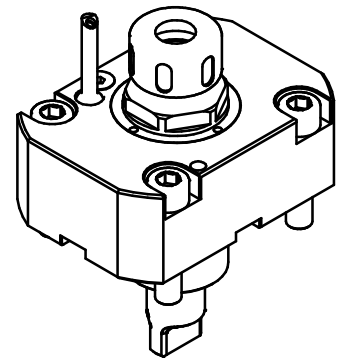
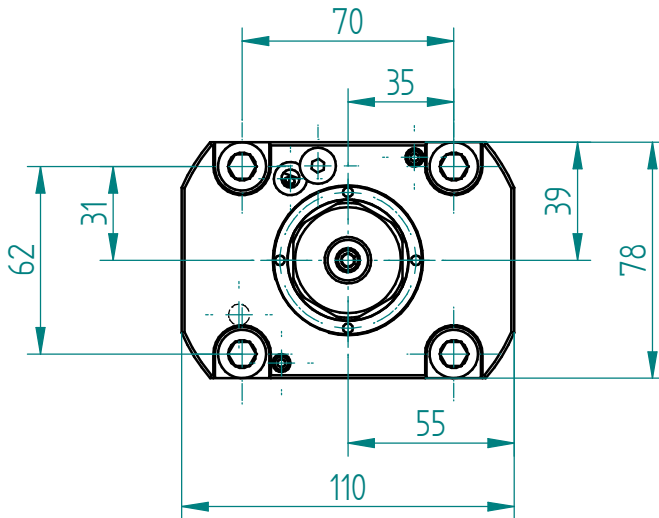
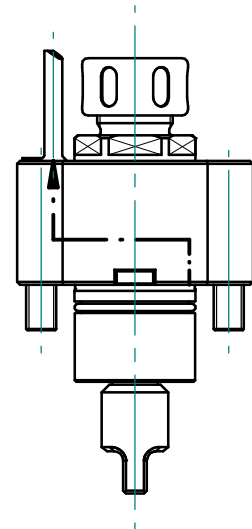
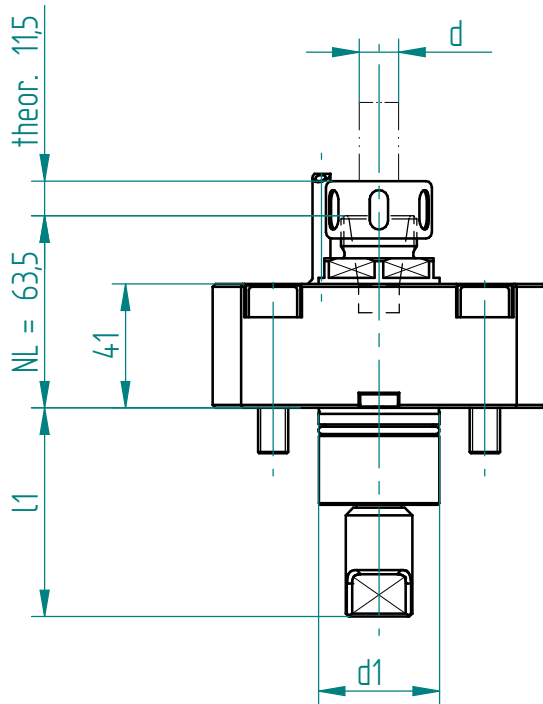

Änderungen vorbehalten. Subject to modification

Schnittstelle Revolver <i>interface tool turret</i>		Drehmoment <i>torque</i>	Drehzahl <i>tool speed</i>	Leistung <i>output</i>	Übersetzung <i>gear ratio</i>	Wkzg.Aufnahme Spannbereich <i>tool holding fixture clamping range</i>	Ausführung <i>version</i>	Bestell-Nr. <i>order N°</i>	
Schaft <i>shank</i>	Kupplung <i>coupling</i>								
d1 mm	l1 mm	M2 max Nm	n2 max 1/min	P max KW	i = n1 : n2	Spannbereich d <i>chucking capacity d</i>			
40	69.0	BMT Mori Seiki 40	32.0	6000	7.5	-1.00	ISO 15488 - 20 - A 1-13	gerade <i>straight</i>	126555

Erforderliche(r) Schlüssel zur Werkzeugspannung / *necessary key(s) for tool clamping*

129816

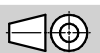

Typenblatt
Data Sheet

Werkzeughalteraufnahme
Werkzeugaufnahme mit Klemmung
tool holding fixture ; tool location with clamping

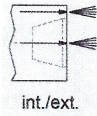
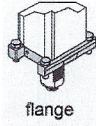

int. 80 bar
ext. 80 bar

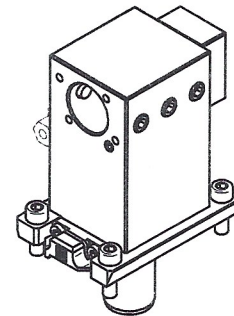
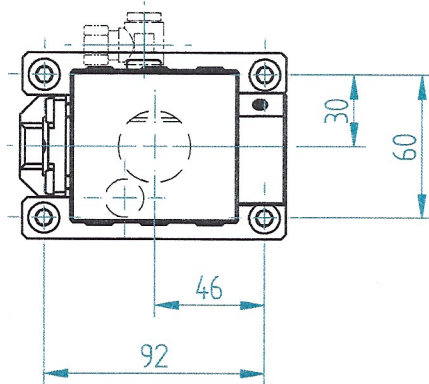
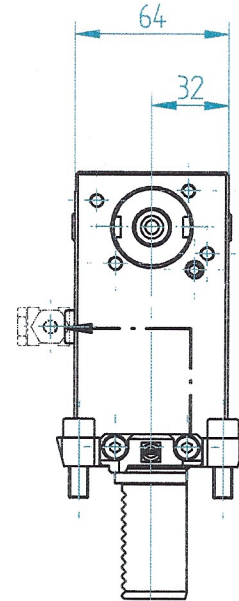
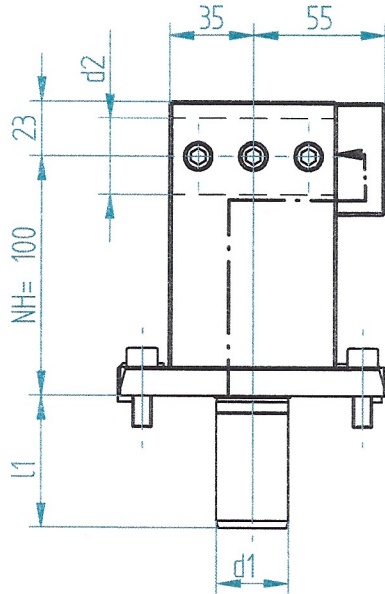

Änderungen vorbehalten, Subject to modification

Schaft shank		Werkzeugaufnahme tool location	Ausführung version	Bestell-Nr. order N°
ISO 10889				
d1 mm	l1 mm	Aufnahme d2 location d2		
30	55	Bohrstangenhalter mit Gewindestift-32	links left	133115

Erforderliche(r) Schlüssel zur Werkzeugspannung / necessary key(s) for tool clamping

Inbusschlüssel / Allen head wrench

Rev 12/2014 // Erst.:iba , erstellt am:2012.09.07 // Prüf.:has , geprüft am:2012.10.17

Typenblatt
Data Sheet

Werkzeughalteraufnahme Werkzeugaufnahme mit VDI-Schaft

tool holding fixture ; tool location with VDI-shaft

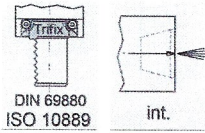

int. 80 bar
ext. bar

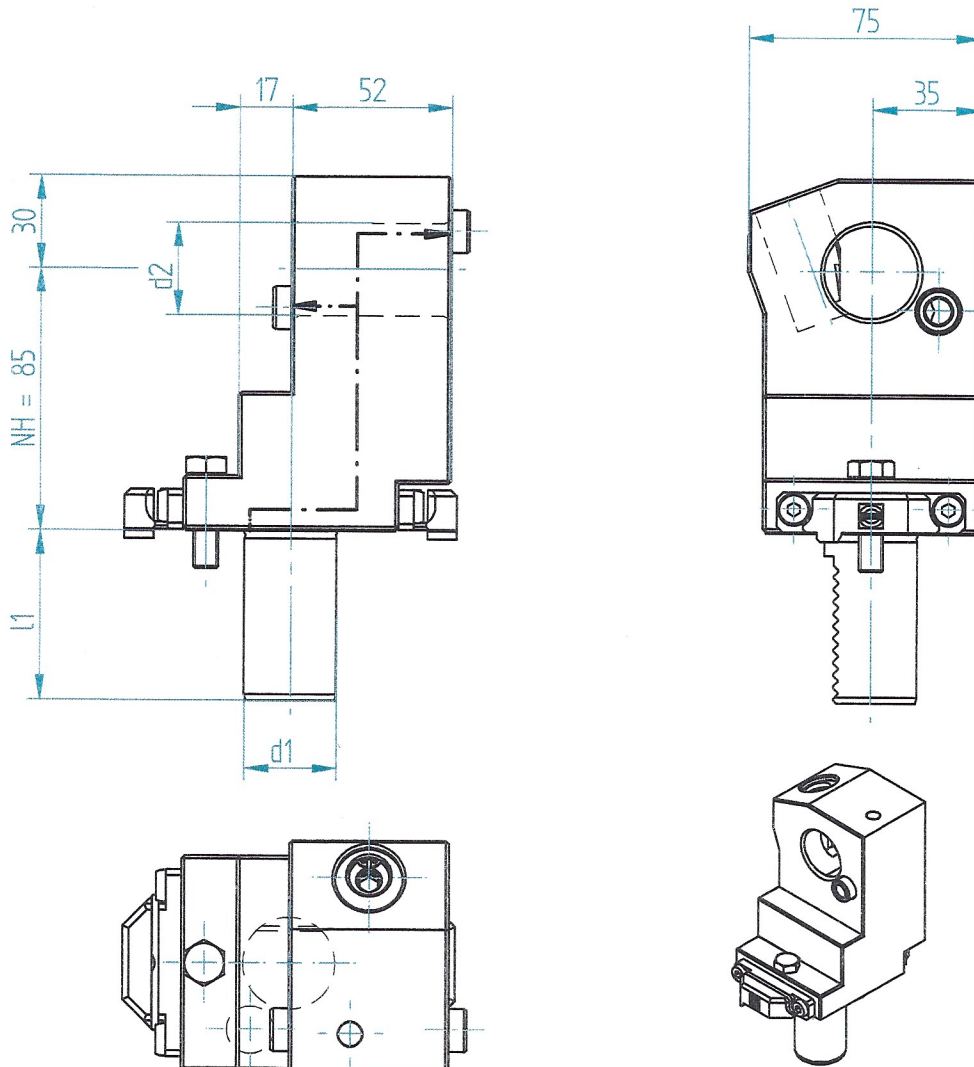

Rev 07/2015 // Erst.:tba , erstellt am 2012.03.02 // Prüf.:sia , geprüft am 2012.05.30

Änderungen vorbehalten. Subject to modification

Schaft shank		Werkzeugaufnahme tool location	Ausführung version	Bestell-Nr. order N°
ISO 10889				
d1 mm	l1 mm	Aufnahme d2 location d2		
30	55	ISO 10889 - 30	links left	133666

Erforderliche(r) Schlüssel zur Werkzeugspannung / necessary key(s) for tool clamping

Inbusschlüssel / Allen head wrench

