



## 1101 CAMBRIDGE SQUARE, SUITE "E" GENERAL INFORMATION

SIZE	AVAILABLE	RENT	MIN. LEASE TERM	ESCALATION
2048 Sq. Ft. Lower level	June 2021	<b>\$1,599.00</b> <b>per month</b>	2 Years	3% annually

**!!!!!!!!!!!!!! JUST RENOVATED !!!!!!!!!!!!!!!**

**Hi Speed Internet available - Comcast Cable / Fiber Optic or T1**

***Landlord pays all routine maintenance, No C.A.M. charge.  
No "pass through" charges to tenant.***

**Professional On-Site Management**

**↓↓↓ CLICK "NEXT" TO SEE FLOOR PLAN ↓↓↓**

**For more information contact Wayne Giglia, 770-475-8035**

The information contained herein is believed to be accurate but is not warranted.  
Prices, terms and availability subject to change without notice.

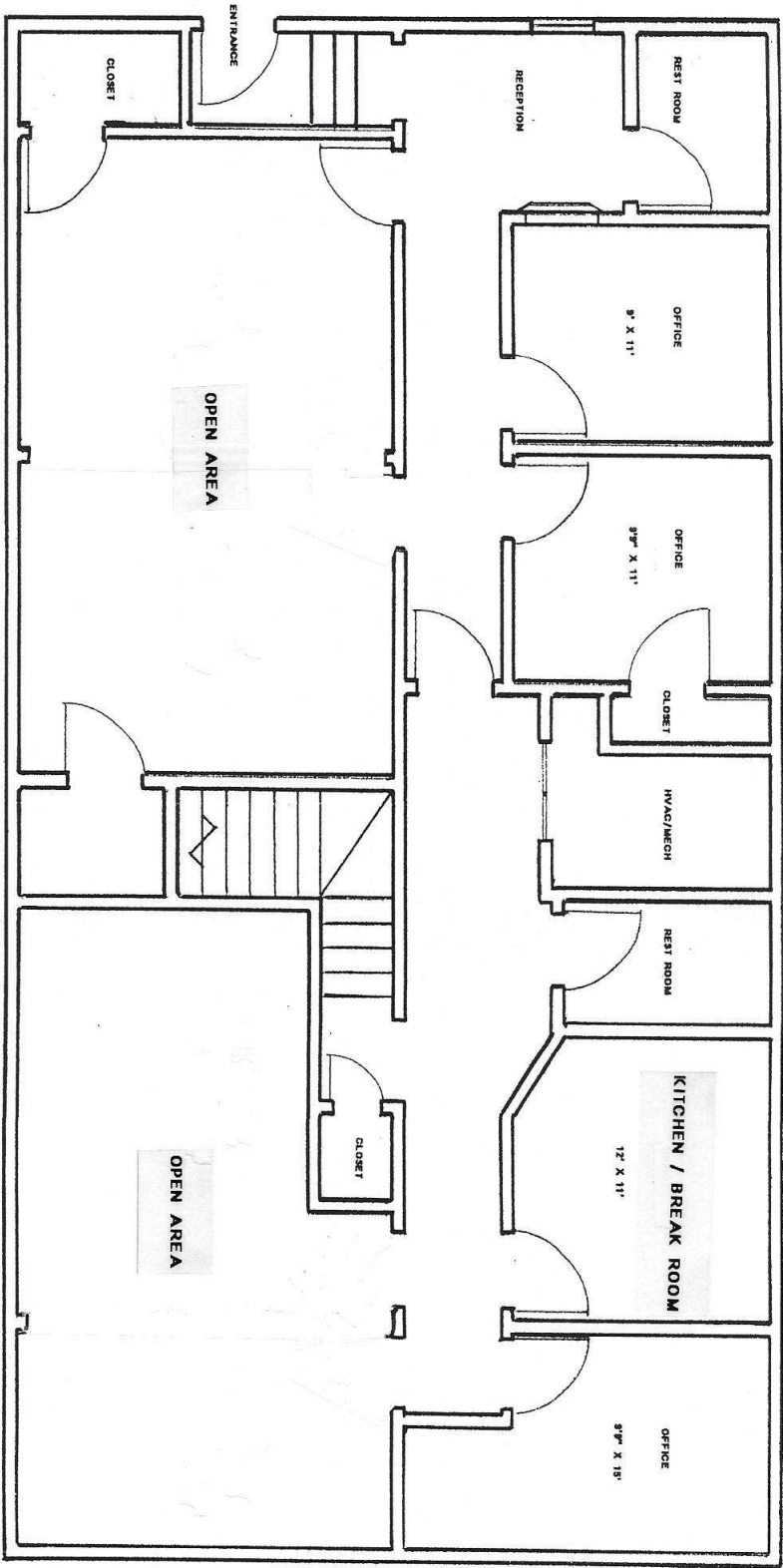

ALL SIZES ARE APPROXIMATE - ACTUAL DIMENSIONS MAY VARY

THIS DRAWING PROPERTY OF "THE CAMBRIDGE GROUP, INC." - ALL RIGHTS RESERVED

**1101 CAMBRIDGE SQUARE, SUITE "E"**  
**2000 SQ. FT.**