



# ERE Members' Concerns

Understanding our Water

## Elbow River Estates Members

- This community is serviced by ERE Cooperative Ltd. to supply water to its members
- The Board of Directors have a fiduciary duty to provide safe drinking water
- Issues have arisen regarding the water quality

A close-up photograph of a person's hand holding a smartphone. The person is wearing a white button-down shirt. The background is blurred. A white text box with a blue top bar is overlaid on the right side of the image.

# About Us

A Group of Concerned Members



# Our Goal

A community is only as good as its leaders

## Ensuring the Value of our Properties

- Safe water supply now and into the future
- Ensuring Provincial guidelines are used
- Transparency and honesty



# Purpose and Objectives

A community is only as good as its leaders

- Present documentation regarding the Water Well locations and the effect of the surface water.
- Ensure the membership understands the operational, legal, and financial risks currently facing the Co-op.



# Issue to be Addressed

Water Wells and Water Quality

# Wells Supplying Water to the Community

The Water Licence DAUT0016030 as per [Alberta Well Locations](#). Well #3 (drilled in 1997) and Well #4 (drilled in 2023) are the active wells providing water. (Well #1 and Well #2 have been decommissioned.)

## The Water Wells as seen on Google maps



## Well Locations as per Official Sketch

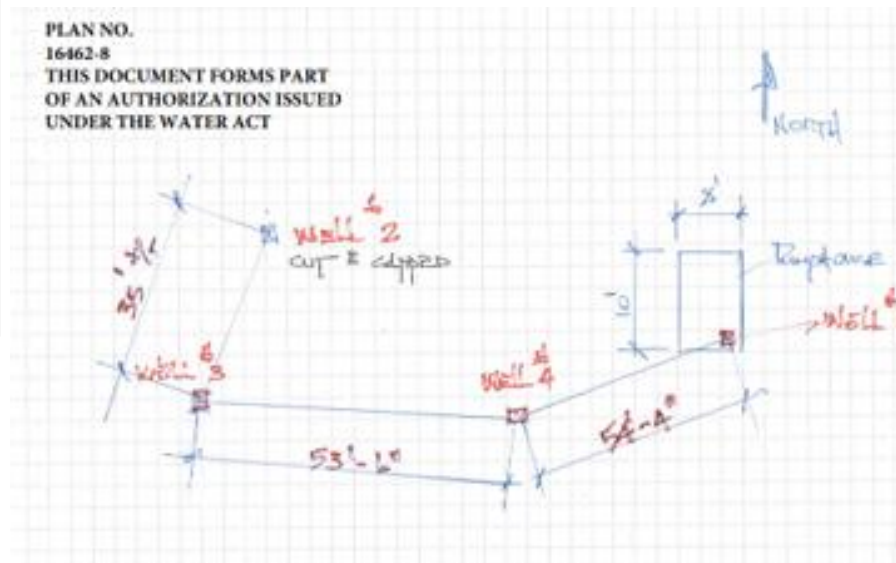

# The Elbow River Alluvial Aquifer

## The Alluvial Aquifer

In the Elbow River watershed, the alluvial aquifer is the bed of river-deposited sand and gravel that lies adjacent to, and typically is hydraulically connected with, the Elbow River. Because of this connection, water is continually exchanged between the aquifer and the river, resulting in water quality that is very similar.

The Elbow River alluvial aquifer is a shallow, unconfined (water table exposed to the atmosphere) sand and gravel aquifer. This aquifer was formed by the deposition of sands and gravels by moving water and is generally very permeable and highly hydraulically connected to the Elbow River. The upper surface of the aquifer is the water table, while the underlying and adjacent surfaces lie on typically less permeable materials. The groundwater in the alluvial aquifer is significantly more connected to the Elbow River than groundwater in the adjacent uplands.

**The aquifer's high permeability means that water flows more readily through it.**



# Well #3 and Well #4

These pictures show the current condition of the wells

---

## Well #3 (1997)



---

## Well #4 (2023)



# Questions and Concerns

---

Considering the 2013 flood event on the Elbow and the permeability of the aquifer, when was the last ground water analysis done?

---

Does the water source continue to qualify for regulation as high quality groundwater?

---

Where are the Hydrogeological studies that determine that the wells are not under the direct influence of surface water?

---

Are the wells protected against floodwater and surface contaminants?

---

Are the casing, cap and annular seals secure?

---

Do the wells comply with current construction and source-protection requirements?

---

# Conclusion – Required Actions



Inform the membership immediately of any circumstances regarding the wells



Hold our BOD accountable in ensuring transparency, accuracy, and responsible oversight



Ensure the BOD follows all applicable water diversion requirements



It was thanks to Concerned Members that the status of the Coop water license was addressed



See something say something



# Thank You

Concerned Members



[elbowriverestates.ca](http://elbowriverestates.ca)

