

# TROPICAL COVE

## Gulfport



**2 BEDROOMS / 2.5 BATHS**  
**TOWNHOMES / FLATS**

Minutes from Cowan-Lorraine Rd. & I-10

1,152 - 1,098 sq. ft. living space

Granite look countertops

Upgrade appliances

Compact washer/dryer

Balconies on townhomes

Garden tubs

Hardwood floors



Floor Plan - Flat

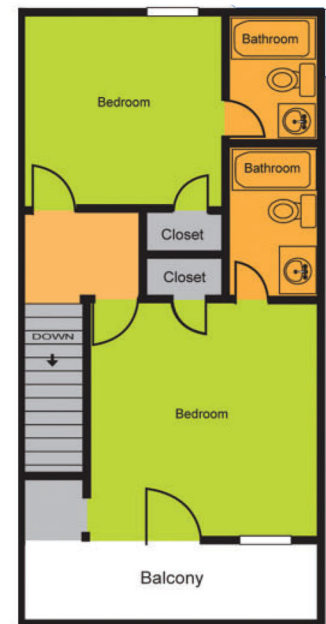
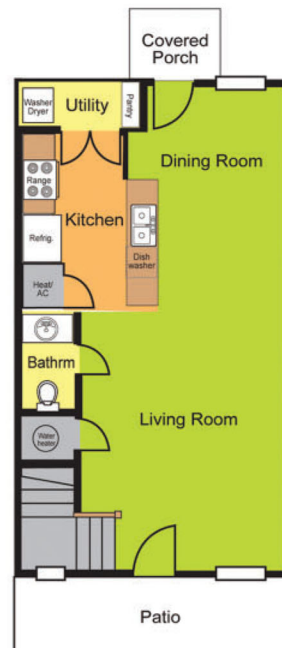

Floor Plan - Townhome



For a personal tour, call

**228-806-5576**

helpme@signaturegulfoast.com