



## ANTAEUS EXCAVATOR MOUNTED VIBRATORY PILE DRIVER/EXTRACTOR

| Antaeus Excavator Mounted Model   | Unit                      | 35E       | 40E        | 50E        | 60E        | 70E        |
|-----------------------------------|---------------------------|-----------|------------|------------|------------|------------|
| Eccentric Moment                  | Inch Pounds/Kg.m          | 424/5     | 521/6      | 668/7.7    | 1128/13    | 1310/15.1  |
| Centrifugal Force                 | Tons/kN                   | 37/370    | 41/410     | 52/527     | 59/598     | 69/698     |
| Frequency                         | Rpm                       | 2600      | 2500       | 2500       | 2050       | 2050       |
| Amplitude Without Clamp           | Inches/Milimeters         | 0.669/17  | 0.814/20.7 | 0.827/21   | 0.854/21.7 | 0.898/22.8 |
| Amplitude With Clamp              | Inches/Milimeters         | 0.433/11  | 0.531/13.5 | 0.606/15.4 | 0.527/13.4 | 0.602/15.3 |
| Clamp Force @ 4,351 Psi/300 Bar   | Tons/kN                   | 53/530    | 53/530     | 53/530     | 104/1038   | 104/1038   |
| Maximum Line Pull Of Suppressor   | Tons/kN                   | 12/120    | 12/120     | 12/120     | 19/192     | 19/192     |
| Maximum Hydraulic Pressure        | PSI/Bar                   | 5076/350  | 4932/340   | 5076/350   | 4932/340   | 4932/350   |
| Maximum Oil Flow                  | Gallons/Liters Per Minute | 41/156    | 52/200     | 52/200     | 60/230     | 60/230     |
| Suspended Weight Without Clamp    | Pounds/Kilogram           | 2615/1186 | 5137/2330  | 6062/2750  | 6283/2850  | 6437/2920  |
| Total Suspended Weight With Clamp | Pounds/Kilogram           | 3452/1566 | 5975/2710  | 6900/3130  | 7605/3450  | 7540/3420  |
| A Length                          | Inches/Milimeters         | 45/1150   | 45/1150    | 47/1200    | 56/1415    | 56/1415    |
| B Width                           | Inches/Milimeters         | 28/700    | 28.3/720   | 28.3/720   | 29/730     | 29/730     |
| C Throat Width                    | Inches/Milimeters         | 12/312    | 13/320     | 13/320     | 13/330     | 13/330     |
| D Height Without Clamp            | Inches/Milimeters         | 45/1150   | 45.5/1154  | 47/1200    | 54/1365    | 54/1365    |
| E Height With Sheet Clamp         | Inches/Milimeters         | 65/1650   | 66/1670    | 67/1700    | 81/2080    | 81/2080    |



*Dimension Layout Of Vibratory Driver/Extractor*

**Features:**

- Converts Excavator To Pile Driver/Extractor**
- Runs Of Excavator Hydraulics**
- Quickly Attaches**
- Light Weight**
- Boom Extensions Available To Extend Reach**

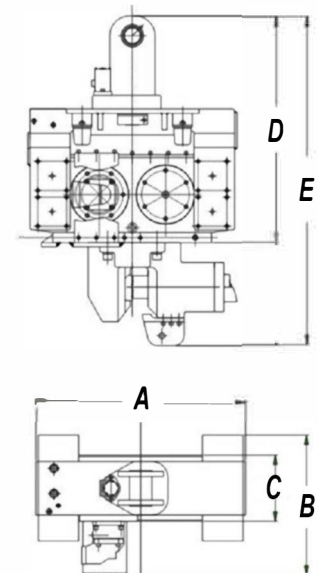

**[www.antaeusfoundationequipment.com](http://www.antaeusfoundationequipment.com) (206) 495-7030**  
**250 S. Webster, Seattle, Washington 98108**