

Antaeus High Pressure Gear Pump

Designed for mobile hydraulic power units exposed to contamination

The Antaeus High Pressure gear pumps are designed for hydraulic power units used to power remote machines such as vibratory pile drivers, hydraulic impact hammers, hydraulic drills, hydraulic powered water pumps or any equipment subject to a high risk of contamination.

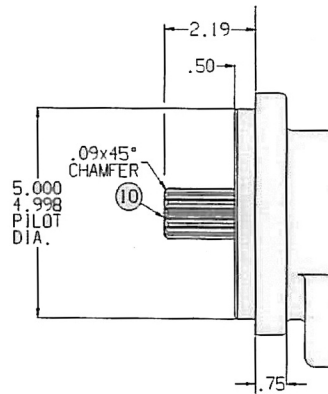
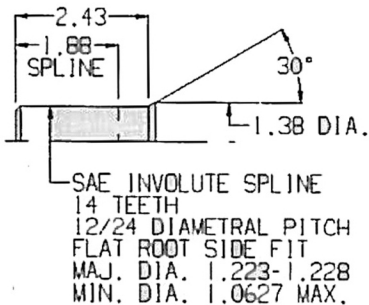
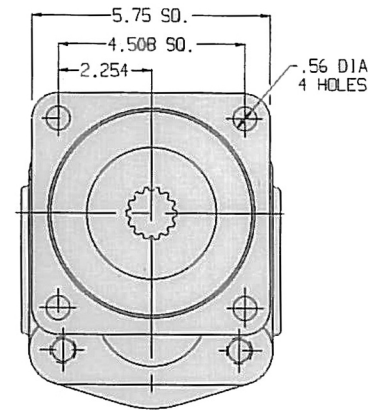
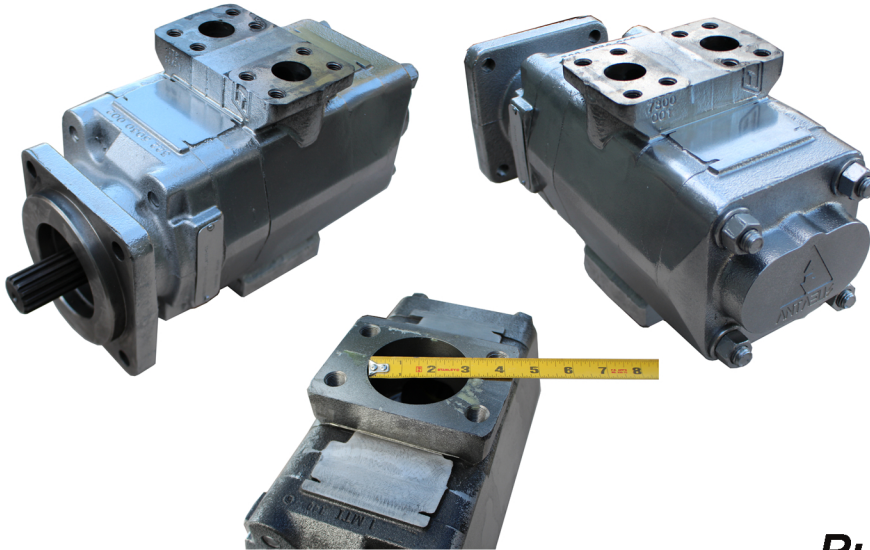

Pump Data:

Maximum rotational speed:	3000 rpm
Displacement per revolution:	10.8 cub-in 177.12 cc
Maximum Pressure:	5000 psi 345 Bar

Unlike expensive piston pumps, the Antaeus High Pressure gear pump can pass much larger sizes of contamination including water without pre-mature failure. Antaeus pumps can operate at up to 3000 RPM's without cavitation because it has a full three inch (75 mm) inlet.

Mobile equipment, especially equipment that incorporates hoses that are disconnected and reconnected during transport are subject to all kinds of contamination. The Antaeus High Pressure Gear Pump can pass much larger particles of contamination than a piston pump and therefore does not require expensive filtration systems.