

TRACTION HOIST

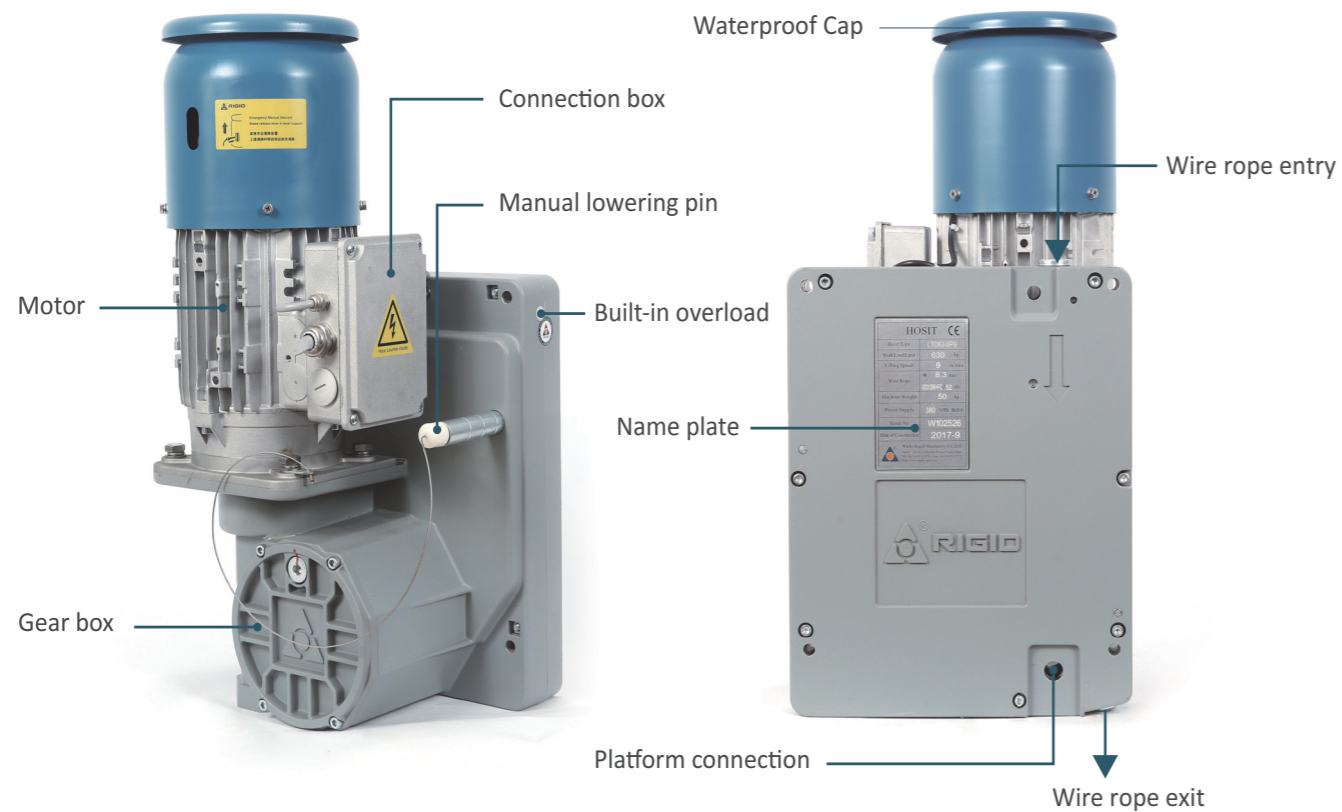

LTD-P Series



LTD-P hoist comes in a lifting capacity ranging from 500 to 2000kg .

Light & heavy duty applications

Product standards & options

LTD-P model	LTD50-P	LTD63-P	LTD80-P	LTD100-P	LTD200-P
Built-in overload device	•	•	•	•	•
Motor thermal overload	•	•	•	•	•
Speed 18m/min	○	○	○	○	-
Dual speed 9/18m/min	-	-	-	○	-
Hoist cables with plug	○	○	○	○	○
Hour counter	•	•	•	•	•
Control system	○	○	○	○	○
Radio remote control	○	○	○	○	○
"Fall arrester device and adaptor (Overspeed and anti-tilt)"	○	○	○	○	-
Top limit switch	•	•	•	•	•
Top limit ultimate	○	○	○	○	○
1P 230V 50Hz (by Capacity)	○	○	-	-	-
1P 230V 50Hz (by inverter)	○	○	○	○	-
3P 230V 50Hz/60Hz	○	○	○	○	○
3P 380-400V 50Hz/60Hz	•	•	•	•	•
3P 690V 50Hz/60Hz	-	○	○	○	○

• Standard features ○ Optional features - Features not possible

RIGID LTD-P Series hoist

The RIGID LTD-P Series hoist is a man-riding, portable, CE approved traction principle hoist. The hoist has a unique traction system, which enables it to transport people and materials up and down to the ideal working height safely and securely via a strong steel wire rope.

The RIGID LTD-P Series hoist is versatile and suitable for all types of suspended working equipment. This includes suspended platforms, service lift cage, false car etc. The wire rope is not stored in the hoist but passes completely through which makes it compact, lightweight and very easy to handle. The unlimited wire rope length capability of RIGID LTD-P hoist makes it possible to utilize unlimited lifting heights and traction lengths.

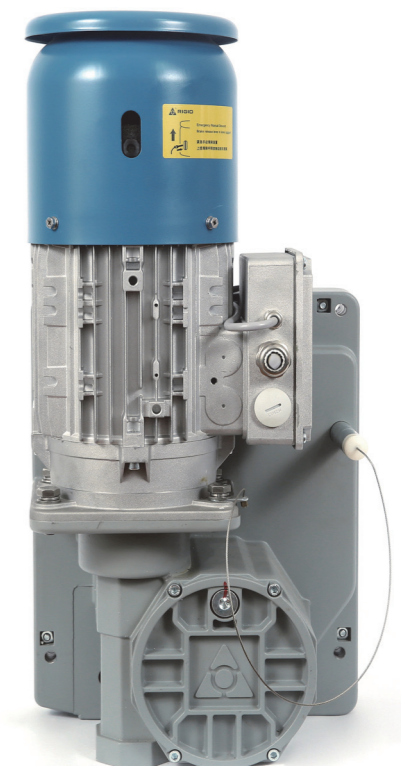

RIGID GmbH

Garnisongasse 7/18, 1090 Wien, Austria

Tel: +43 670 408 2941

E-mail: sales@europe-rigid.com

www.europe-rigid.com



Product data sheet

Model	LTD50-P	LTD63-P	LTD80-P	LTD100-P	LTD200-P
Working load limit	500kg	600kg	800kg	1000kg	2000kg
Speed	A.9m/min B.18m/min		C.Dual speed 9/18m/min	6m/min or 12m/min	
IP class	IP55				
Steel wire rope	8.3mm	8.3mm	9.1mm	10.2mm	14mm
Working temperature range	-20 °C to 55 °C				
Weight	47	48	49	50	113
Overall Dimension (H×W×D)	593x300x263mm				720x400x370mm

*Always use a RIGID hoist in combination with a RIGID safety lock and steel wire rope.

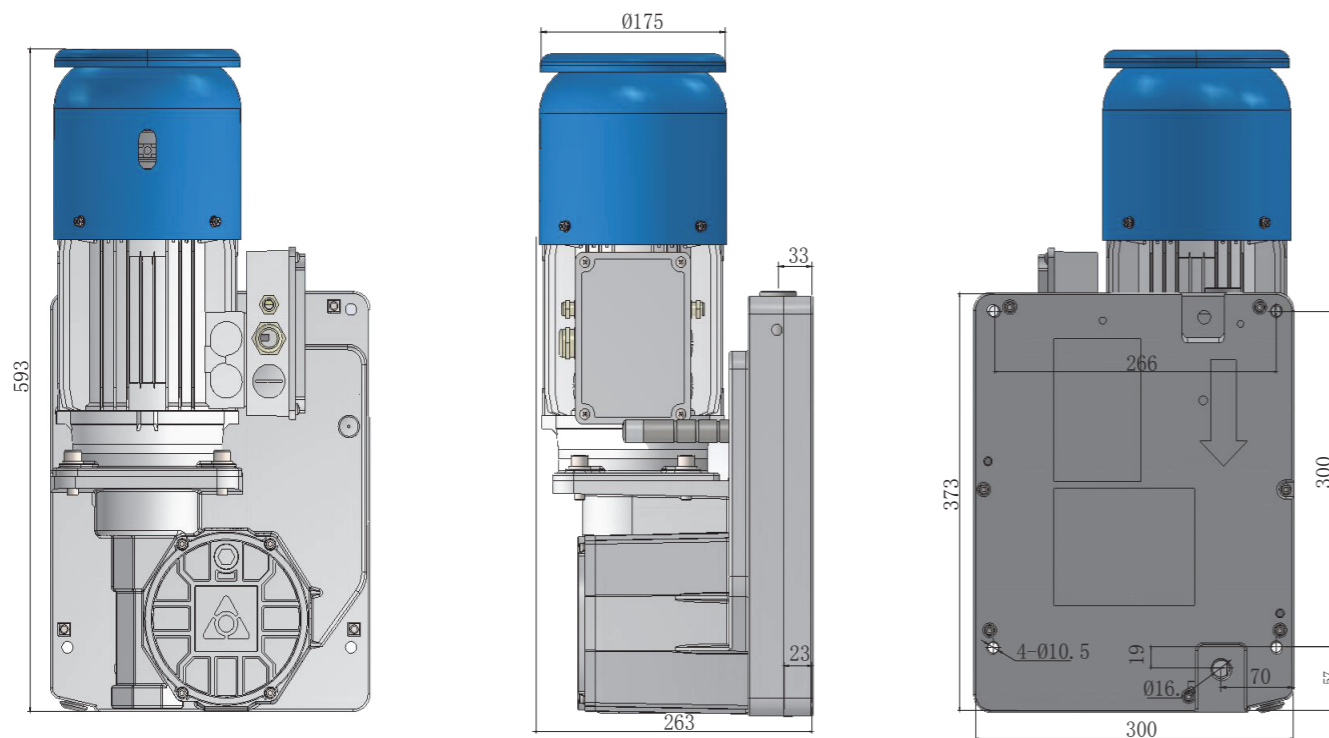

*Only for LTD50-P, LTD63-P, LTD80-P & LTD100-P. If LTD200-P is required, please contact us.



Product main features

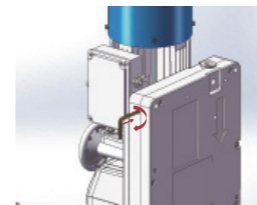

Built-in Mechanism Overload

When the load acting on the hoist reaches or exceeds the load limit, the hoist will stop rising and only descend.

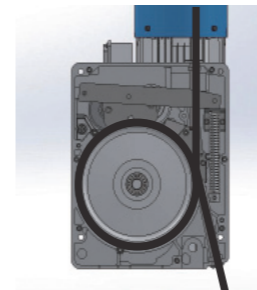

"α" cable-guiding system

The hoist has a single drive pulley. The grip of the wire rope on the pulley is obtained by a set of rollers and operated by a pressure spring unit. Compact in structure, lightweight and easy to operate and maintain.

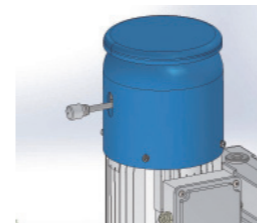

Safety Lowering Mechanism

In the event of a power failure, the electric-mechanical brake can be released manually in order to ensure safe and controlled lowering of the load.

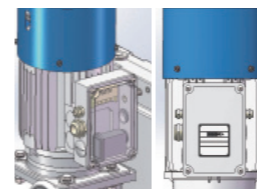

Hour Counters

Mounted in the connection box of traction hoist. Records working operating hours. Outdoor and indoor type.

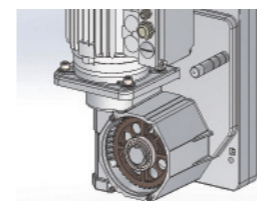

Gear drive

Gearing and drive disc is fabricated from hardened steel, great transmission efficiency and cost-effective

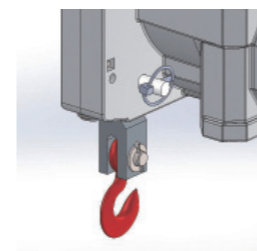

Flexible Attachment Points

The hoist can be suspended from a central suspension point by means of a load pin. Alternatively, attachment points located in the corners of the housing are available for flexible attachment of the hoist with hook, screws or pins.



Features and Benefits

Die-cast aluminum ensures a low dead-weight and outstanding rigidity.

Motor protection: Protected to IP55 as standard.

The hoist motor is fitted with a thermal overload protection device.

The fully-synthetic special oil ensures highest possible efficiency for quiet running characteristics from -20 °C to 55 °C.

Standardized components ensure easy access to all wearing parts.