

COMPONENTS THAT MAKE OUR POLY FURNITURE LAST

A swivel, spinny, or revolving chair is a chair with a single central leg that allows the seat to rotate 360 degrees to the left or right. The first swivel chair was invented by Thomas Jefferson, and is purported to be the chair on which he drafted the United States Declaration of Independence in 1776.

GLIDES



| 405 |
DOUBLE GLIDER WITH
CENTER CONSOLE

SPRINGS

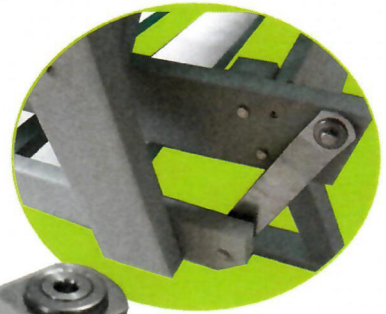

STAINLESS GLIDER ARM



| 610 |
SWIVEL PUB
CAPTAINS CHAI

NEW



STAINLESS SWIVEL
SEALED BEARINGS



SWING SPRINGS (OPTIONAL)

WARRANTY

RJM Design, LLC warrants to the original purchaser that its polyethylene outdoor furniture products will be free of original defects in workmanship and materials for a period of twenty (20) years residential use or five (5) years of commercial use unless otherwise noted in warranty. The warranty is effective starting on the date of purchase. At it's option RJM Design, LLC will repair or replace this product without charge for materials and labor, providing our inspection indicates that an original defect exists. Should RJM Design, LLC choose to replace the product, and the product is no longer available at the time warranty service is required a substitution of similar performance and equal or greater value will be made. Polyethylene is a synthetic product and may scratch, will fade slightly when exposed to sunlight or stain after prolonged contact with other substances. Some expansion and contraction is to be expected during changes in humidity and temperatures. The foregoing shall not be considered defects in materials or workmanship and are not covered under this warranty. Stainless steel may rust in certain extreme conditions (such as coastal areas) if not maintained. This warranty does not cover rusting fasteners or structural failure due to rust fasteners, damage caused by unauthorized service or repairs, alteration of this product abuse or misuse, normal wear and tear on materials, or any attempt to use the product in a manner or for a purpose together that for which it is customarily intended. This warranty does not cover scratching or chipping of polyethylene, however, this warranty shall not limit any warranties made by the manufacturer for such items which may extend to you. The sole remedy provided in this warranty is repair or replacement of this product. Any cost of shipping and handling will be paid by you.