

Make 3x mounting brackets to keep your 110" or 2.8m track out of the way on your garage door or wall! This fits: Festool, Makita, Powertec, and other related track profiles.

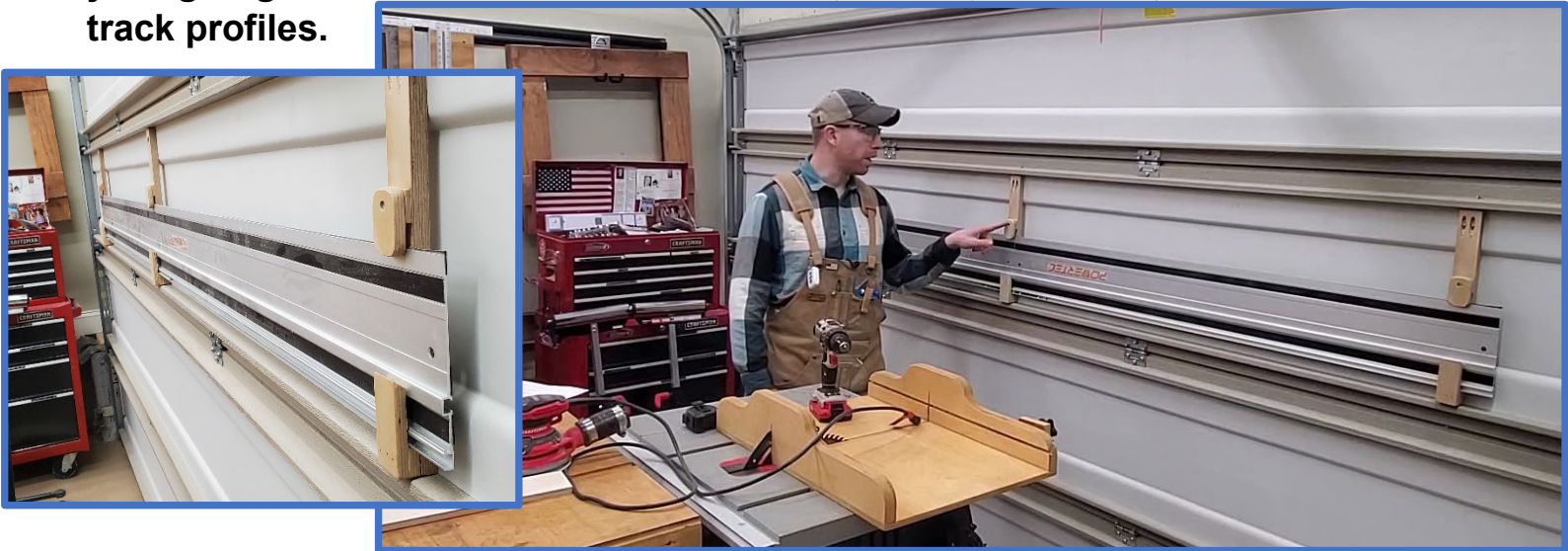

PARTS LIST & CUT SHEET (ALL PARTS 12mm or 1/2" Plywood or Equivalent)

*Adjust part sizes to fit based on your actual material thicknesses & final sizes

Component	QTY	Dimensions	Description
A	3	50mm (W) x 12mm (T) x 350mm	Vertical Mounting Plate
B	3	50mm (W) x 12mm (T) x 25mm (L)	Bottom Spacer
C	3	50mm (W) x 12mm (T) x 90mm (L)	Bottom Holder
D	3	50mm (W) x 5mm (T) x 25mm (L)	Top Spacer
E	3	50mm (W) x 12mm (T) x 60mm (L)	Swivel Latch

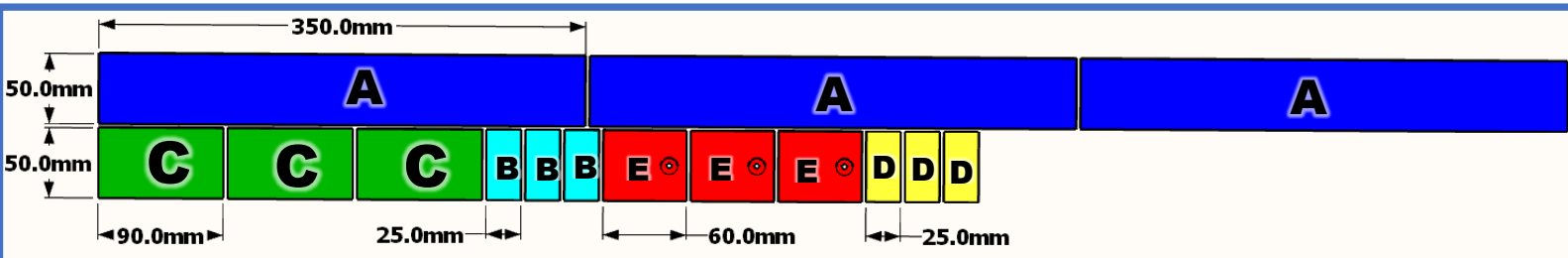

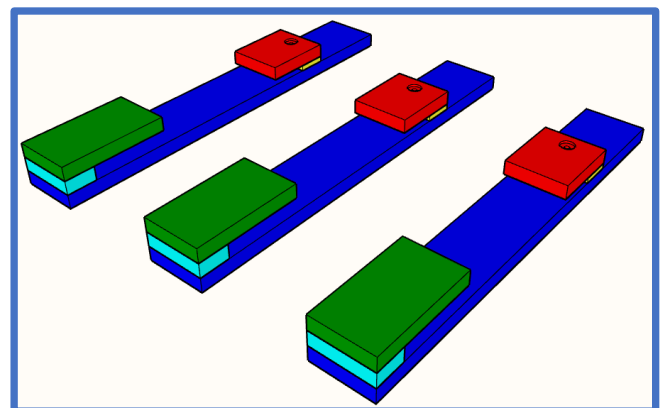
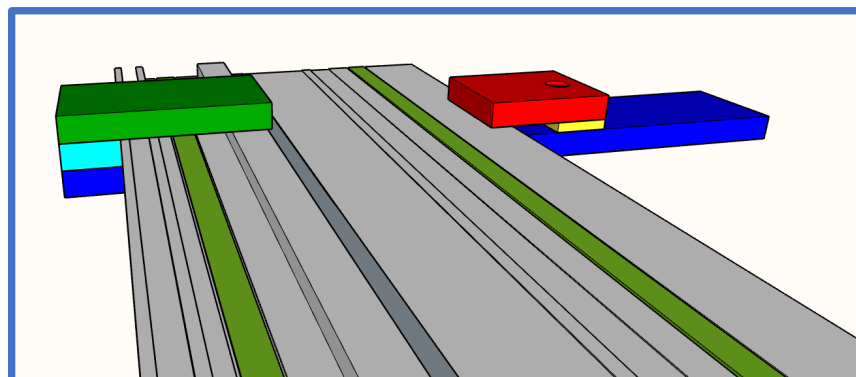
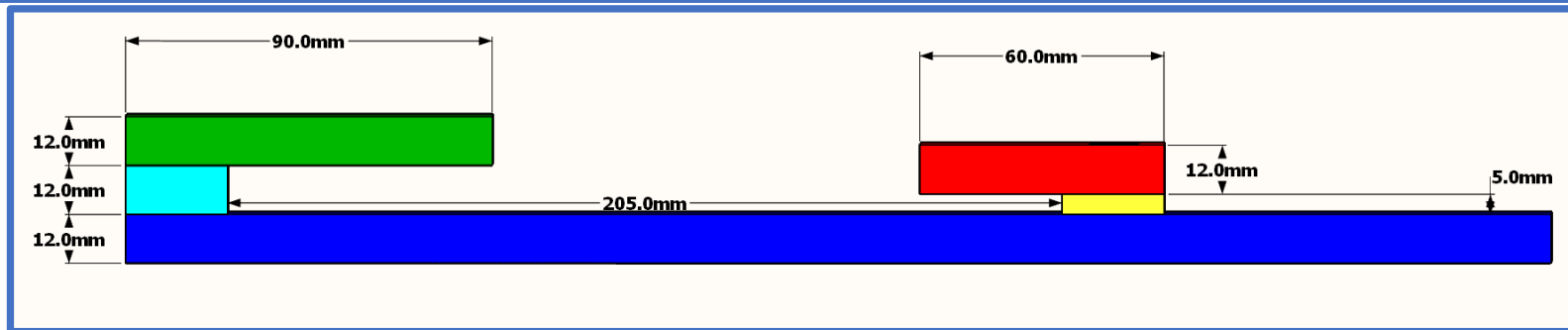
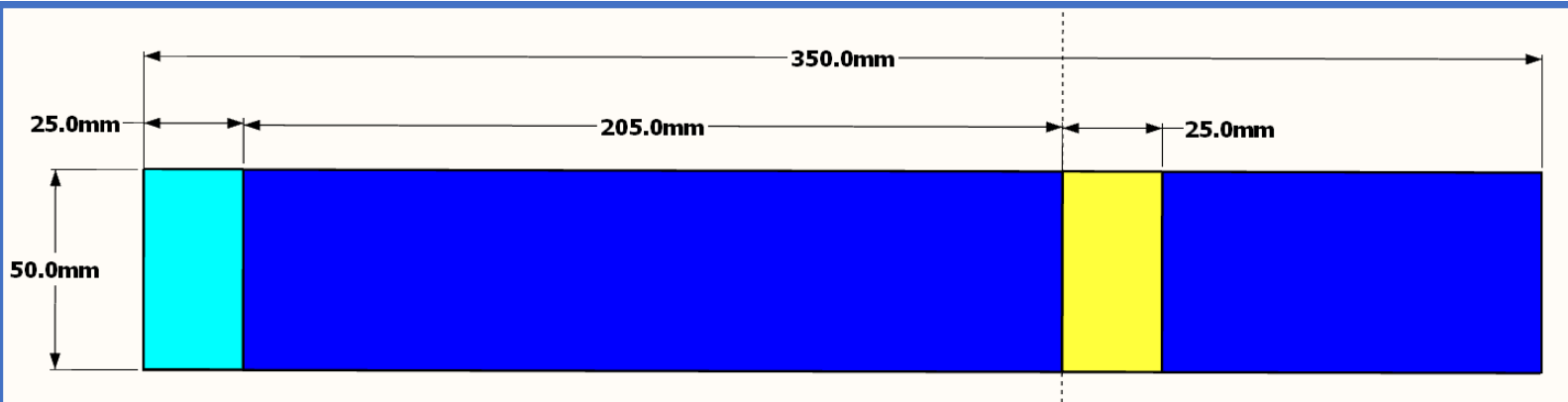
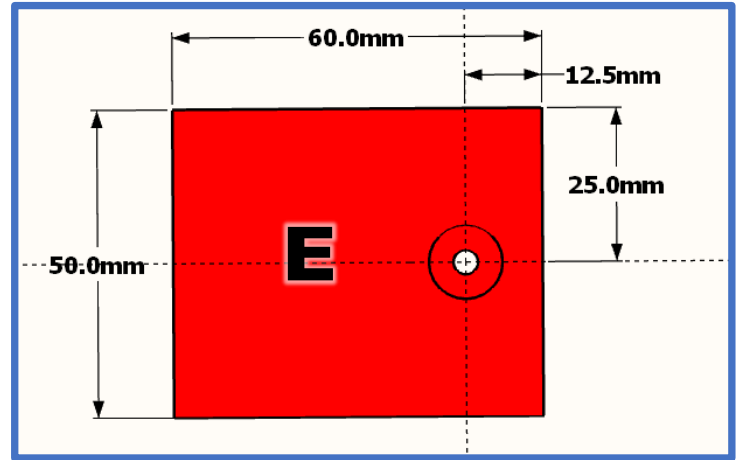
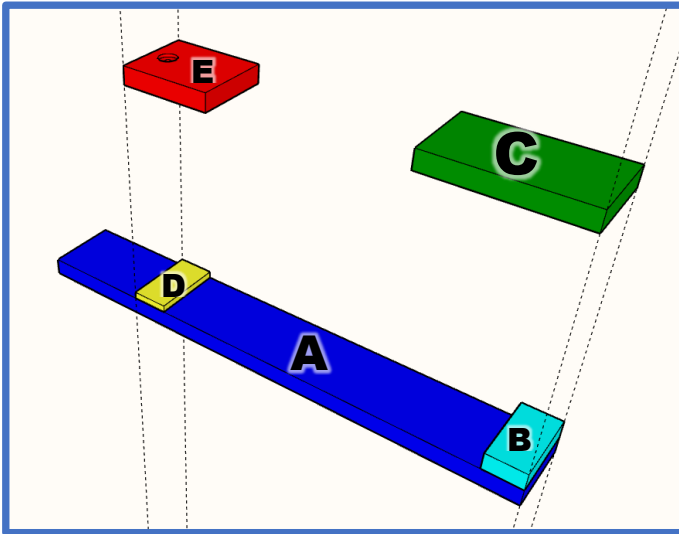

Additional Resources

See the Build video or check out ways to Maximize your Shop space on my Websites:

[My Website](#)

[My Youtube Channel](#)

[My Instagram](#)

[Find out about Unlimited Plans on Patreon](#)

[All of my plans are available on Etsy](#)

Plans for Maximizing Your Shop:

My Shop's Mobile Base:



My Mobile Tool Wall:



My Planer Mount:

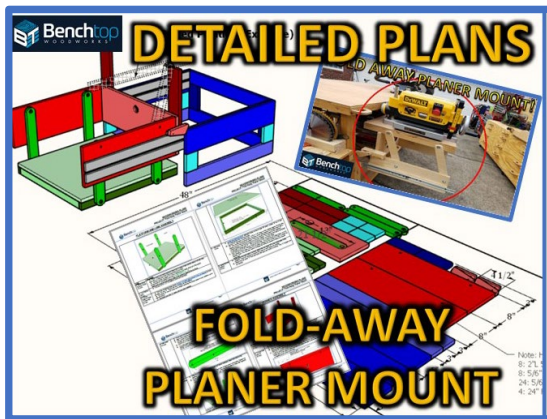

My Dust Collection Set-Up:

