

VSH SERIES SHORT HEIGHT JACK

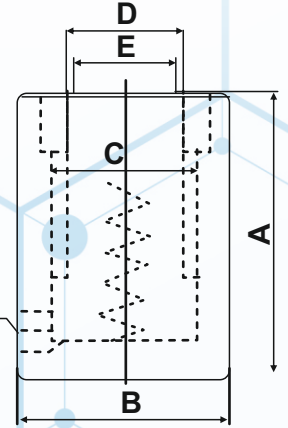
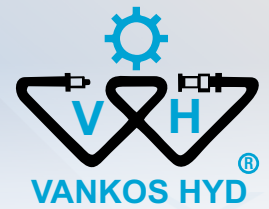

FEATURES / APPLICATION

- Single Acting Spring Return Upto 200 Tons.
- Provided with In-Built Hardened saddle to avoid ram mushrooming
- Best used for applications with low clearance.
- Heavy equipment lifting & alignment.
- Used in horizontal & vertical directions.
- Ideally ensure no gap between jack & load to be lifted, toutilize full stroke
- Spares available through life of Jacks
- Black - Nitrocarbonization available on request
- Compatible with all reputed brands pumping units.
- Refer to anatomy for all VANKOS-HYD jacks.

CAPACITY 10 - 200 TONS L STROKE 30 -60 MM I MAX WORKING PRESSURE 700 BAR

Rated Capacity (Ton)	Capacity @700 bar (KN)	Stroke (mm)	Model	Effective Area (cm ²)	Oil cap (cc)	'A' Closed Height (mm)	'B' Cylinder OD (mm)	'C' Bore Dia (mm)	'D' Ram Dia (mm)	W A/F (mm)	Wt (Approx.) (kg)
10	111	30	RC-VSH-10/30	15.9	48	90	70	45	35	-	2.3
20	218	50	RC-VSH-20/50	31.2	160	115	90	63	50	-	4.9
30	309	50	RC-VSH-30/50	44.2	221	120	100	75	60	-	6
50	550	60	RC-VSH-50/60	78.5	471	125	130	100	80	60	11
75	792	60	RC-VSH-75/60	113.1	679	145	155	120	95	70	18.4
100	1077	60	RC-VSH-100/60	153.9	925	150	180	140	110	80	23.6
150	1589	60	RC-VSH-150/60	227.0	1362	165	220	170	140	100	43
200	2199	60	RC-VSH-200/60	314.2	1885	200	255	200	160	110	66

- Higher capacity and customized solutions on request.
- Specifications are subject to change due to continual improvement.
- Capacity and Stroke specified are maximum safe limits.
- Use at 80% of rating as safe practice. .

SELECT SUITABLE PUMPING UNITS AND ACCESORIES

