

Chameye

Professional Video Conferencing HDMI 4K PTZ CAMERA > > 10x Optical Zoom << User Manual



Technical Support:

E-Mail: Sandy@chameye.net

Website: www.chameye.net

Please Note: Only NDI version cameras have NDI function.

Quick Start

Network Connection:

Please check the classic network connection diagram.

(And the camera supports PoE function, so you can power, control, set up and stream video over only one single Ethernet cable).

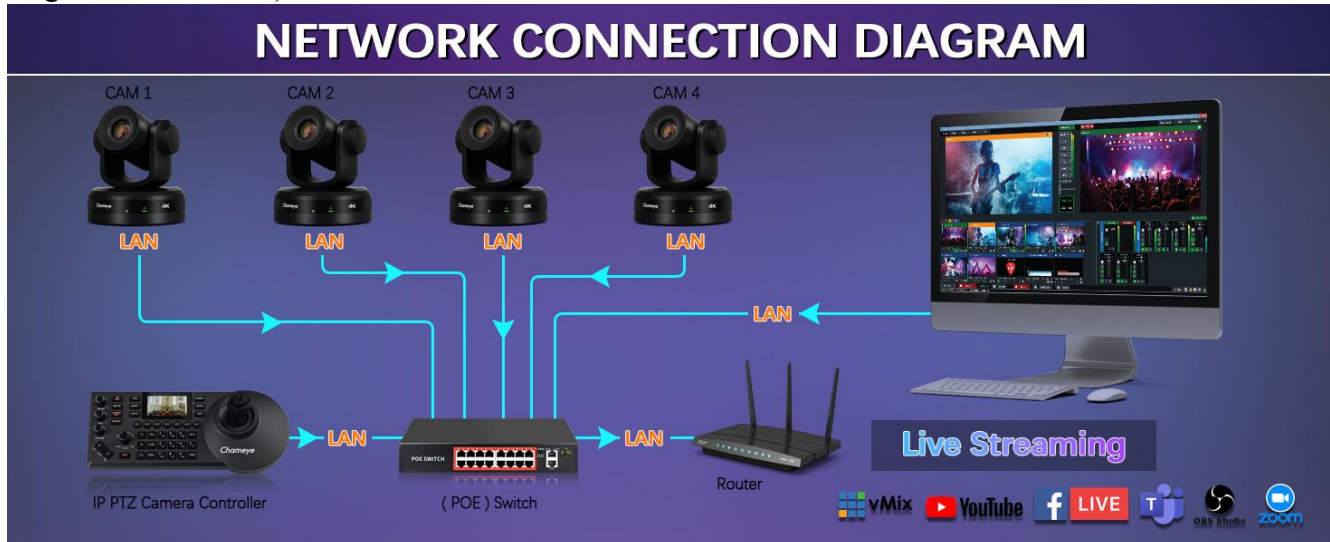

Notes:

(1) **DHCP:** All Chameye cameras are enabled DHCP by default.

(2) **Router:** You'd better have a router in your network, because only router can assign IP addresses for the devices. It will make the setup much easier.

(3) **IP Address:** Use HDMI to connect camera with TV/HDMI monitor, go to Menu-> SETUP, then you can see camera's IP address.

(Please note: If the router does not successfully assign an IP address to the camera, The default IP address of the camera is 192.168.1.123)

(4) **Webpage:** Login camera's webpage by visiting camera's IP address in web browser (recommend Google Chrome or Firefox):

User Name: admin

Password: admin

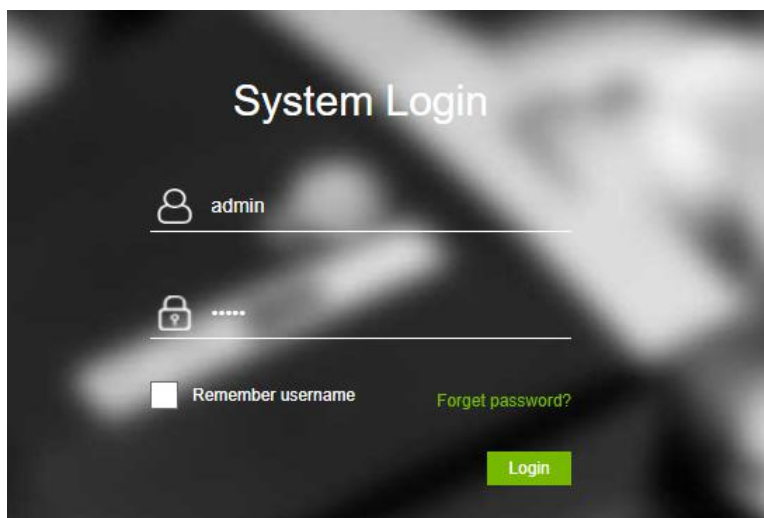

Connect Cameras to Chameye E300 PTZ Controller

Step 1: Please make the network connection as above(Camera and the IP controller must be in the same LAN:connect to the same router/switch by network cable).

Step 2: Press “search” button on E300 PTZ controller, you can see camera’s IP address and control protocol listed on the screen.

Step 3: Recommend choosing Visca over IP(because under this control protocol, you can preview camera’s image on PTZ controller’s LCD screen)

Step 4: Add to shortcut keys and choose CAM 1 ~7 to save, for example choose: CAM 1

Step 5: Press shortcut key CAM 1, now,you can control the camera.

Step 6: if you have more cameras needed to add to the controller, please do step 2-step 4 again, and assign cameras to CAM2~CAM7



Preview Camera Image on PTZ Controller’s LCD screen

Our cameras and PTZ Controller have been updated, When you add the cameras to Chameye E300 PTZ controller with Visca over IP control protocol, you can directly preview the camera’s image on the controller's LCD screen.

How To Setup AI Tracking

F3: Turn on auto tracking

F4: Turn off auto tracking

Set the Tracking Speed:

Enter < **MENU** >-< **PTZ** >-< **Track Speed** >

The adjustable tracking speed range is: 1 ~ 10



IP Streaming to Vmix or OBS

Tips: recommend to use VLC streaming in Vmix or OBS, it has lower latency.

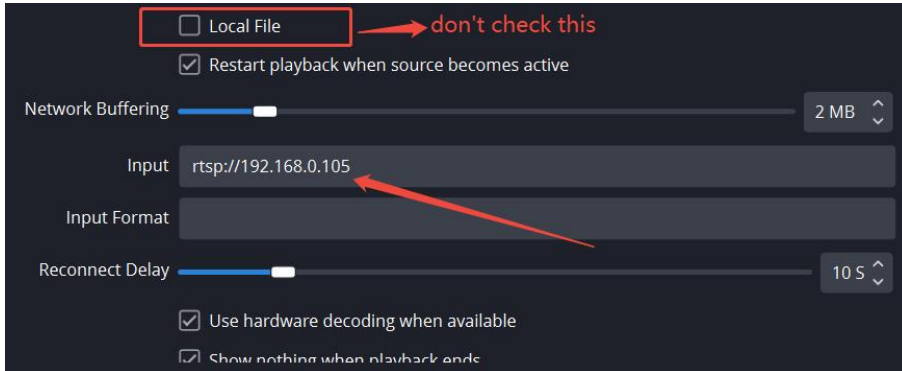
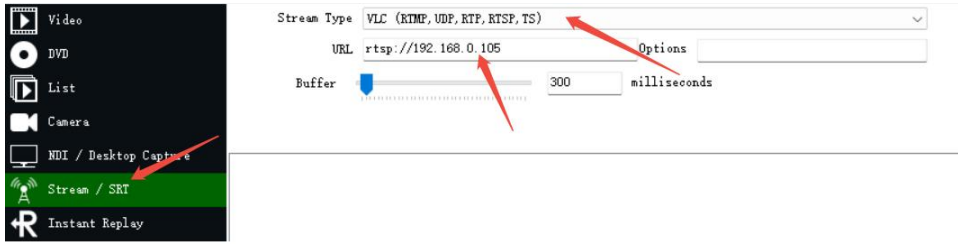

Please note the camera's RTSP URL is: rtsp://192.168.0.105

Please don't forget to change the IP address to your camera's IP address.

IP Steam to YouTube or Facebook

YouTube, Facebook or other live broadcast platforms will supply Stream URL(server URL) and stream key for you.

Example for YouTube:

Stream URL: rtmp://a.rtmp.youtube.com/live2/

Stream Key: 8m8q-0yrp-w95f-spd0-ft55

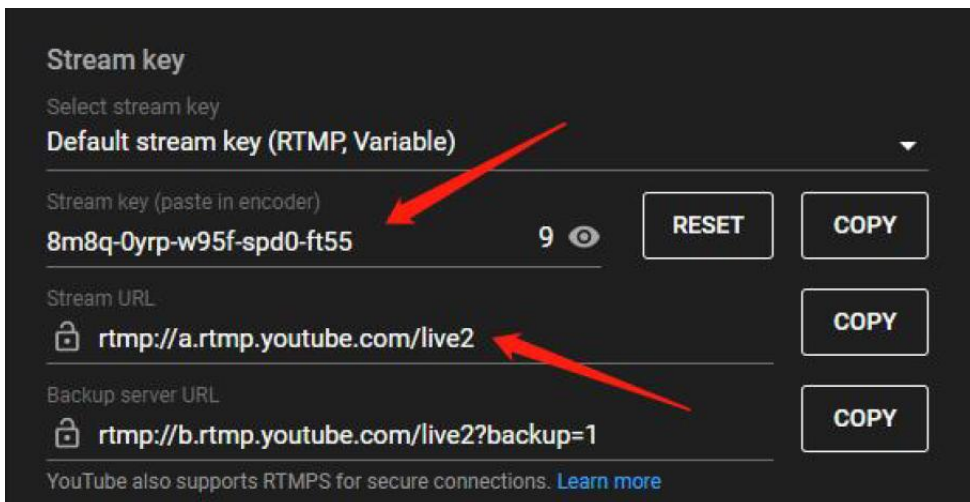

Now go to camera's webpage -> CONFIGURATION-> Network-> RTMP

Select "Enable",

input the RTMP stream URL:

<rtmp://a.rtmp.youtube.com/live2/8m8q-0yrp-w95f-spd0-ft55>

(Format: [Stream URL](#)/[Stream Key](#))

Save and reboot the camera, camera will stream to YouTube.

The screenshot shows the Chameye CONFIGURATION page. On the left, a sidebar menu has 'Network' selected under the 'Camera' section. The main area displays two stream configuration sections. The top section is for the 'Main stream' and is enabled (checkbox checked). Its 'Stream Type' is set to 'Main stream', 'Server URL' is 'rtmps://live-api-s.facebook.com:443/rtmp/', and 'Push Flow Code' is empty. The bottom section is for the 'Sub stream' and is disabled (checkbox unchecked). Its 'Stream Type' is set to 'Sub stream', and both 'Server URL' and 'Push Flow Code' are empty. An 'Apply' button is at the bottom right.

Example for Facebook:

Server URL: <rtmps://live-api-s.facebook.com:443/rtmp/>

Stream Key: [FB-117626344422167-0-AbzhIyyXbQGNT47w](#)

The screenshot shows the 'Streaming software setup' page. It instructs the user to copy and paste the stream key into their streaming software. The 'Stream key' is 'FB-117626344422167-0-AbzhIyyXbQGNT47w', with a red arrow pointing to the 'Copy' button. Below this, the 'Advanced Settings' section is expanded. 'Persistent stream key' is enabled (toggle on). 'Backup stream' is disabled (toggle off). The 'Server URL' is 'rtmps://live-api-s.facebook.com:443', with a red arrow pointing to the 'Copy' button. A note below states: 'This may be referred to as "URL" or "Address" in your streaming software.'

Now go to camera's webpage -> CONFIGURATION-> Network-> RTMP

input the RTMP stream URL:

<rtmps://live-api-s.facebook.com:443/rtmp/FB-117626344422167-0-AbzhIyyXbQGNT47w>

(Format: [Stream URL](#)/[Stream Key](#))

This screenshot is similar to the first one but shows the 'Network' menu item selected in the sidebar. In the main configuration area, the 'Main stream' section is still enabled, but the 'Server URL' is now 'rtmp://a.rtmp.youtube.com/live2/8m8q-0yr'. A red arrow points to this URL. The 'Sub stream' section remains disabled. The 'Apply' button is at the bottom right.

If you need more supports, please contact us at: Sandy@chameye.net, normally, we can reply you within 24 hours.

Chameye Supports Team

Foreword

Thank you for selecting this series of Video Conference Cameras.

Please read and understand this Operations Manual before using the product.

Warning!

To prevent this product or any other products connected from damage, this product can only be used within a predetermined range.

- Avoid raining or moisture environment;
- Do not remove product casing. Use certified personnel for installation and reparation;
- Do not use beyond the limitation of temperature, humidity or power voltage range;
- When cleaning the camera lens, use a soft, dry cloth; when seriously dirty, please use a mild detergent and wipe gently. Do not use strong cleaning agents or corrosive cleaner so as not to scratch the lens and affecting image quality.

Notes

This manual covers the installation and use of a variety of models of our company's products, please distinguish the products' features, parameters, and their installation instructions according to the ordered products model No..

Content

Attentions	8
Packing Listing	9
Product Overview	10
Camera Specifications	11
Camera Interface Function	12
IR Remote Controller Explanation	13
Serial port Communication Control	14
Protocol List(Omitted)	14
MENU SETTING	14
Network settings	18
1、 Connection mode	18
2、 IE entry	19
2.1、 Web client	19
2.2、 Preview	19
2.3、 Entry	19
2.4、 System Settings	20
2.5、 Camera setting	20
2.6、 Network setting	21
2.7、 System managemen	22
3、 Common Parameters:	23
Camera Maintenance and Fault Handling	24
Trouble Shooting	24
Warranty Card	25

Attentions

▼Electric Safety

Installation and operation must accord with electric safety standard.

▼Caution to transport

Avoid stress, vibration and soakage in transport, storage and installation.

▼Polarity of power supply

The power supply of the product is $\pm 12V$, and the polarity of the power plug is shown as following.



▼Careful of installation

Do not move the camera by seizing the camera head. Do not rotate camera head by hand; otherwise, mechanical trouble will occur.

This series item must put on the smooth desk or platform, and it cannot be installed slant ways;

If the camera is installed on TV or computer, the base can be fixed by four double-sided adhesive trays.

The product housing is made up of organic material, it is prohibited to contact any liquid, gas or solid material that may cause shell corrosion, and make sure no obstacle in rotation range during installation.

Do not power on before installation is completed.

▼Don't disassemble discretionarily

We are not responsible for any unauthorized modification or dismantling.

⚠Attention!

Electromagnetic filed under certain rate may affect camera image!

Packing Listing

When you unpack, check that all the supplied accessories are included:

Video Camera.....	1
Power Adapter.....	1
USB3.0 cable.....	1
LAN Cable	1
Control port terminal box.....	1
Wall Mount Bracket.....	1
Ceiling Mount Bracket.....	1
Remote Control.....	1
User Manual.....	1

Video Camera



USB3.0 cable



LAN Cable



Power Adapter



Remote Control



Control port terminal box



Ceiling Mount Bracket



Wall Mount Bracket



User Manual



Product Overview

The C410 is a conference camera and video conferencing camera designed for the conference market, integrating advanced 4K PTZ (Pan-Tilt-Zoom) technology, designed to provide superior image quality and an easy-to-operate experience for modern conference rooms and video conferences.

Please make sure all wiring are correct before power on.

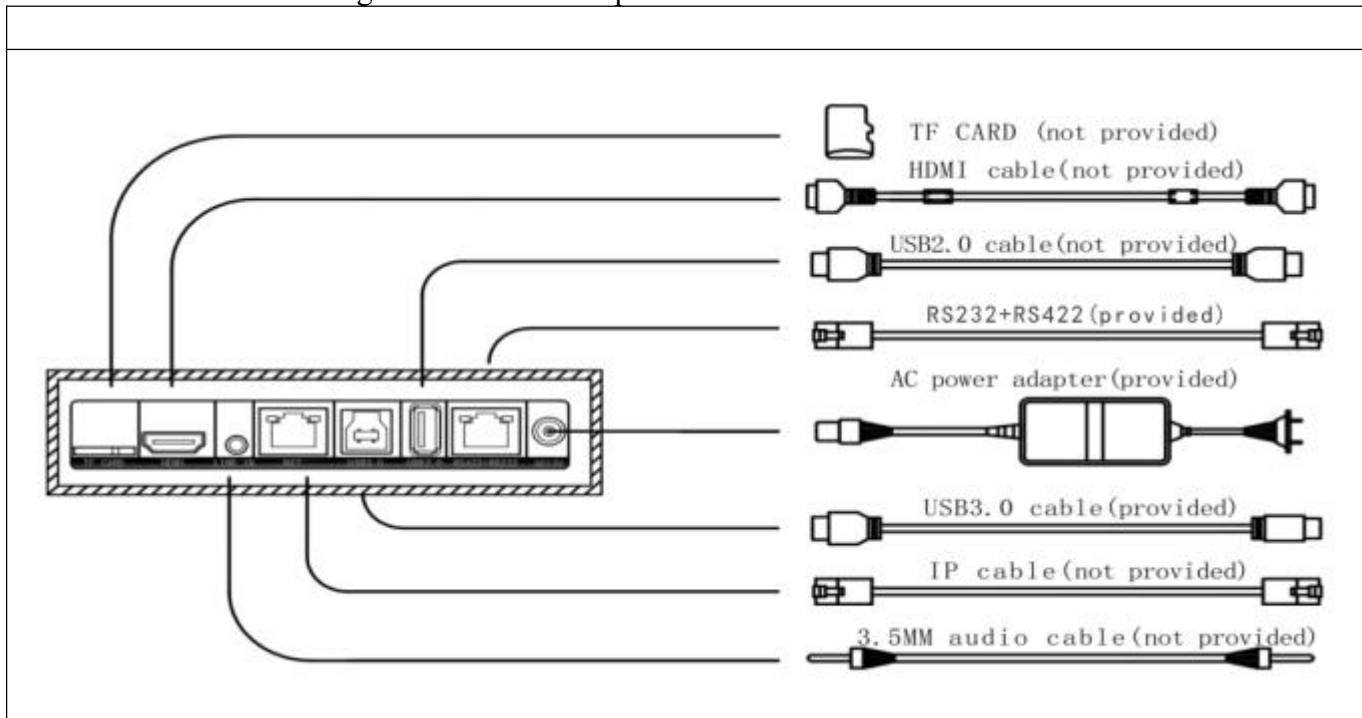

Camera Performance

- **Precise positioning, quiet and smooth PTZ control**

By adopting high accuracy Algorithm for PTZ Control, precise location($\pm 0.1^\circ$), it works extremely quiet and moves smoothly and very quickly to designated position.

- **Real 4K HD image**

Adopt 1/2.5 inch, 8.51 effective megapixels HQ“Exmor R” CMOS Sensor, achieve 3840×2160 high quality image with super high resolution. Focus on meeting the need for picture fluency while ensuring the ultra-high definition.

- **Low noise and high SNR:**

Adopt advanced 2D&3D noise reduce technology and low noise CMOS sensor to reduce the noise.

- **10X optical zoom 12x digital zoom**

- **4KP30 HDMI video output**

Support 4KP30/25, 1080P60/50/30/25, 720P60/50 etc.HD video formats.

- **4KP30 USB3.0 video output**

Support 4KP30/25, 1080P30/25, 720P30/25 etc.HD video formats.

- **4KP30 UHD network video output**

Support 4KP30/25, 1080P30/25, 720P60/50etc.HD video formats.

- **TF card video support (only support UH series)**

Support TF card video function, support a variety of time recording, support audio recording.

- **255 preset positions**

255 positions can be preset through serial port, including level, pitch, zoom to preset, even if the camera is powered off, the preset data can be saved.

- **Multi-functional remote controller**

Equipped with simple remote control, it can not only use for level, pitch and zoom control, but also can

set the parameters through remote control menu.

- **OSD Chinese/English menu function**

Various OSD menu, feasible for remote controller to control Chinese/English OSD menu.

Camera Specifications

Camera		
Signal system		3840×2160P30/25 (supported by 4K model) ,1080P60/50/30/25 , 720P60/50
Sensor		1/2.5inch HQ CMOS Sensor, 8.51 effective megapixels
Scanning mode		progressive
Optical zoom		10X
Minimum illumination		Support ultra-low illumination: 0.1Lux@F1.6(color), 0.01Lux@F1.6 (b&w)
Shutter		1/30s ~ 1/10000s
White balance		Indoor/Outdoor/Auto/Manual
BLC		Yes
DNR		2D&3D DNR
SNR		≥52dB
Focal length		f=5.7 ~ 57mm
Horizontal view angle		52°(wide end) ~ 5.5°(far end)
Pan rotation		±170°
Tilt rotation		-30° ~ +90°
Pan control Speed		1 °/s ~ 100 °/s
Tilt control Speed		1 °/s ~ 60 °/s
Image flip		Yes
Preset number		255
Accuracy of preset		±0.1°
Input/Output Interface		
HD video interface	HDMI	Max 4KP30
	USB3.0	Support USB3.0 video output, max 4KP30
	TF Card	Support TF card video function, support a variety of time recording, support audio recording.
	POE	Support
	IP	Code: H.265/H.264/MJPEG, network protocol: IPv4, TCP, UDP, HTTP,NTP,DNS, DHCP,ARP, RTSP, RTP,RTCP, RTMP, ONVIF,,VISCA OVER IP, PoE(Optional): 802.3af, NDI(NDI license is Optional): NDI HX

Communication interface	1 *, RS-232 IN, Longest distance: 30 m, VISCA/Pelco-D/Pelco-P protocol 1 *, RS-422 , Longest distance: 1200 m, VISCA/Pelco-D/Pelco-P protocol
Power interface	JEITA Type (DC IN 12V) HEC3800
General Specifications	
Input voltage	AC110V-AC220V to DC12V/2A
Input current	DC12V(DC11.5-DC12.5V)
Working temperature	0°C~ +45°C
Storage temperature	-10°C~+60°C
Power consumption	12W(max)
Dimension	Refer to “Dimension”
Package size	355mmX270mmX255mm

Notice： Specifications and information of the camera are for reference only, and the contents are subject to change without prior notice.

Camera Interface Function

1. Interface	1.Camera lens	6.TF card	11.USB2.0 port(preset)
	2.Camera base	7.HDMI port	12.RS232&RS422control port
	3.Remote Controller Receiver light	8.Line IN	13.DC power port
	4.Installation screw hole	9.IP port	
	5.Installation Orientation Hole	10.USB3.0 port	

IR Remote Controller Explanation

1. Power key

After press ,the camera will step into standby mode. Press again, the camera will self-test again and back to HOME position. (Note: If power-on mode is turned on and Preset 0 is set, it will automatically point to the specified preset position.)

2. Camera select key

Choose the camera address ready for control.

3. Position key

Set or run presets.

4. *key #key

5. Focus key: focus control

Auto focus: enter into auto focus mode

Manual focus: the camera focus mode is manual; switch the camera focus mode to manual focus by pressing[focus +] or [focus -] to adjust.

6. Zoom key

Zoom+: lens near, **Zoom-**: lens far

7. Clear preset key

Clear preset key: +0-9 number key

8. Pan-tilt key

Press \wedge key :Up

Press \vee key :Down

Press \leftarrow key :Left

Press \rightarrow key :Right

HOME key: Return to the middle position

9. BLC on/off key

Back light compensation ON/OFF(Reserved)

10. Menu key

Open or close the OSD menu(Reserved)

Enter / exit the OSD menu or return to the previous menu.

11. Camera IR remote control address setting

【*】+【#】+【F1】: Camera Address No. 1

【*】+【#】+【F2】: Camera Address No. 2

【*】+【#】+【F3】: Camera Address No. 3

【*】+【#】+【F4】: Camera Address No. 4

12. Key combination functions

1) 【#】+【#】+【#】: cancel all preset bits	2) 【*】+【#】+【6】: restore factory defaults
3) 【*】+【#】+【9】: flip switch	4) 【*】+【#】+【7】: switch to left/right image
5) 【#】+【#】+【0】: switch to video format1080P60	6) 【#】+【#】+【1】: switch to video format1080P50
7) 【#】+【*】+【4】: TURN ON AI-Ttacking	8) 【#】+【*】+【3】: TURN OFF AI-Ttacking
9) 【#】+【#】+【4】: switch to video format720P60	10) 【#】+【#】+【5】: switch to video format720P50
11) 【#】+【#】+【6】: switch to video format1080P30	12) 【#】+【#】+【7】: switch to video format1080P25
13) 【#】+【#】+【8】: switch to video format4KP30	14) 【#】+【#】+【9】: switch to video format4KP25



Serial port Communication Control

Under normal working condition, the camera can connect one VISCA or Pelco-D, Pelco-P control equipment.

- RS232 communication control
Control the camera through RS232, RS232 serial port parameter shown as following:
Baud rate: 2400/4800/9600 b/s;
Start bit: 1 bit;
Data bit: 8 bit;
Stop bit: 1 bit;
Check bit: none.
- RS485 communication control
Control the camera through RS485, half duplex mode:
Baud rate: 2400/4800/9600 b/s;
Start bit: 1 bit;
Data bit: 8 bit;
Stop bit: 1 bit;
Check bit: none.

After power on, the camera first go left, then back to the middle position. Self-test is finished after the zoom moved to the farthest and then back to the nearest position. If the camera saved 0 preset before, it will be back to that position after initialization. At this point, the user can control the camera by the serial commands.

Protocol List(Omitted)

The camera serial port follows VISCA/Pelco-D/Pelco-P protocol, the camera can be controlled according to the standard protocol if secondary development is needed; please contact the manufacturer to get a detailed list of protocol if needed.

MENU SETTING

Notice: the menu displays only two lines. Please refer to the following for specific items.

- [↑↓]SELECT: press up/down arrow keys to select the menu
- [← →]MODIFY: press left/right arrow keys to modify parameters
- [MENU]BACK: press menu key to return/enter the menu
- [HOME]CONFIRM: press [Home]key to confirm

1. MENU

Press [MENU] button to display the main menu on the normal screen, using arrow button to move the cursor to the item to be set. Press the [HOME] button to enter the corresponding sub-menu.

MENU	
=====	
LANGUAGE	ENGLISH
<SETUP>	
<CAMERA>	
<P/T/Z>	
<VIDEO FORMAT>	
<VERSION>	
<RESTORE DEFAULT>	

LANGUAGE: Language setting, Chinese / English

SETUP: System setting

CAMERA: Camera setting

PTZ: Pan tilt setting

VIDEO FORMAT: video format setting

VERSION: camera version setting

RESTORE DEFAULT: Reset setting

[↑↓] **SELECT:** for selecting menu

[← →] **MODIFY:** for modify parameters

[MENU] **BACK:** Press [MENU] to return

[HOME] **CONFIRM:** Press [Home] to confirm

2. SETUP

Move the pointer to the <SETUP> in the Main Menu, click the **[HOME]** key and enter into the <SETUP> as shown below,

SETUP	
=====	
PROTOCOL	AUTO
VISCA ADDR	1
V-ADDR FIX	OFF
PELCO-P ADDR	1
PELCO-D ADDR	1
BAUDRATE	9600

PROTOCOL: VISCA/Pelco-P/Pelco-D/AUTO

VISCA ADDR: VISCA=1~8 Pelco-P=1~16 Pelco-D=0~15

BAUD RATE: 2400/4800/9600

V-ADDR FIX: On/Off

3. CAMERA PARAMETER SETTING

Move the pointer to the <CAMERA> in the Main Menu, click the **[HOME]** key and enter the <CAMERA> as follow.

CAMERA	
=====	
<EXPOSURE>	
<COLOR>	
<IMAGE>	
<FOCUS>	
<NOISE REDUCTION>	

EXPOSURE: Enter into Exposure setting

COLOR: Enter into Color setting

IMAGE: Enter into Image setting

FOCUS: Enter into Focus setting

NOISE REDUCTION: Enter into Noise reduction

3.1 EXPOSURE

Move the cursor to the <EXPOSURE> item in the main menu and press **[HOME]** button, <EXPOSURE> menu appears, as shown in the following figure.

EXPOSURE	
=====	
BLC	OFF
WDR	OFF

BLC: On/Off

DYNAMIC RANGE: On/Off

3.2 COLOR

Move the cursor to the <COLOR> item in the main menu and press [HOME] button, <COLOR> menu appears, as shown in the following figure.

COLOR	
=====	
WB	AUTO
SAURATION	7

WB: Auto, Indoor, Outdoor, ATW, Manual

SATURATION:1~16

3.3 IMAGE

Move the cursor to the <IMAGE> item in the main menu and press [HOME] button, <IMAGE> menu appears, as shown in the following figure.

IMAGE	
=====	
BRIGHTNESS	4
CONTRAST	9
SHARPNESS	9
FLIP-H	OFF
FLIP-V	OFF
B/W MODE	DAY
DZOOM	OFF

BRIGHTNESS: 0~14

CONTRAST: 0~14

SHARPNESS: 0~15

FLIP-H: ON/OFF

FLIP-V: ON/OFF

B/W-MODE: DAY/NIGHT

DZOOM: Digital zoom options: ON/OFF

3.4 FOCUS

Move the cursor to the <FOCUS> item in the main menu and press [HOME] button, <FOCUS> menu appears, as shown in the following figure.

FOCUS	
=====	
FOCUS MODE	AUTO

FOCUS MODE: AUTO/MANUAL

3.5 NOISE REDUCTION

Move the cursor to the <NOISE REDUCTION> item in the main menu and press [HOME] button, <NOISE REDUCTION> menu appears, as shown in the following figure.

NOISE REDUCTION	
=====	
NR-2D	1
NR-3D	3

NR-2D: OFF, 1~5

NR-3D: OFF, 1~8

4. P/T/Z

Move the cursor to the <P/T/Z> in the Main Menu, click the [HOME] key and enter the <P/T/Z> as follow.

P/T/Z =====	
SPD BY ZOOM	ON
IR SPEED	10

SPD BY ZOOM: The depth of field scale switch for IR Remote, Optional items: ON/OFF

IR SPEED: Set the PTZ speed for remote controller 1~16

5. VIDEO FORMAT

Move the cursor to the < **VIDEO FORMAT** > in the Main Menu, click the **【HOME】** key and enter the < **VIDEO FORMAT** > as follow.

4K model

VIDEO FORMAT =====	
4KP30	
4KP25	
1080P60	
1080P50	
1080P30	
1080P25	
720P60	

Video format: 4KP30、4KP25、1080P60、1080P30、1080P25、720P60、720P50

6. VERSION

Move the cursor to the < **VERSION** > in the Main Menu, click the **【HOME】** key and enter the < **VERSION** > as follow.

VERSION =====	
ARM VERSION	1.1.0.0

ARM Version: Display MCU version information

7. RESTORE DEFAULT

Move the cursor to the < **RESTORE DEFAULT** > in the Main Menu, click the **【HOME】** and enter the < **RESTORE DEFAULT** > as follow.

RESTORE DEFAULT =====	
RESTORE ALL	NO
SET OPRESET	NO

RESTORE ALL: YES/NO

SET OPRESET: YES/NO, Set the preset position 0

Notice: Instructions about the menu above are for reference only, and the contents are subject to change without prior notice.

HDMI USAGE

1. The interface to the backboard is HDMI
2. Requirements for wire rods: recommend HDMI ultra-high-definition, support 4K transmission
3. Receive end: support HDMI.(support 4K resolution ratio)

USB3.0 USAGE

- 1.The interface to the backboard is USB3.0 B port.
- 2.Requirements for wire rods: recommend USB3.0 ultra HD extension cable, support 4K transmission.
- 3.Receive end: support USB3.0 or above.

RS422&RS232 CONNECTING METHODS

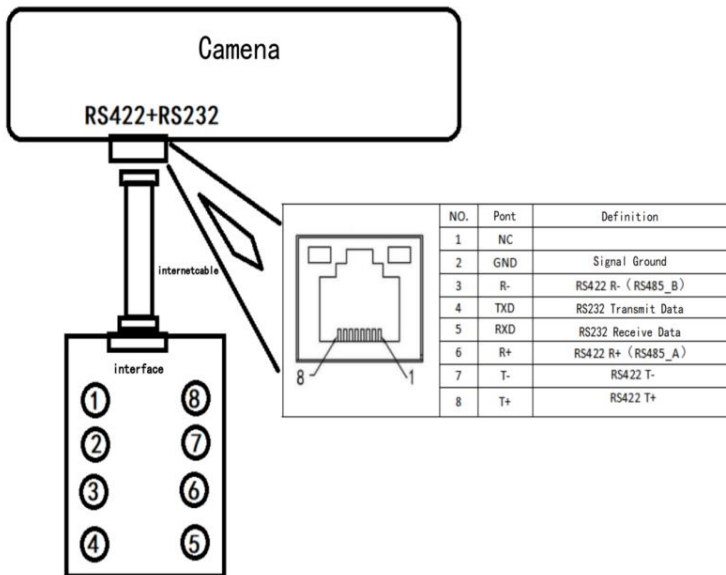

Notice:

- 1.RS232 must be connected to TXD,RXD,GND
- 2.RS422must be connected to T+,T-,R+(A),R-(B)
- 3.RS485must be connected to R+(A),R-(B).

Network settings

1、 Connection mode

Direct connection mode: directly connect the device to the computer with a network cable.

Network connection mode: Connect the device to the Internet network, which can be connected to the network through the router or switch, and users can log in to the device through the browser.

Note: Do not place wires and network cables in vulnerable places, To avoid the unstable signal transmission caused by poor line contact and affect the video quality.

The computer must have the network segment where the device IP is located. If the network segment is not added, it will be unable to log in. If the default IP address is 192.168.1.123, one network segment should be added to the computer.

First open the computer network local connection attribute window, select "Internet Protocol Version 4 (TCP / IPv4)", double click or point attribute "Internet Protocol Version 4 (TCP / IPv4)", enter the Internet Protocol Version 4 (TCP / IPv4) attribute window, select "Advanced" and click "Advanced" to enter the advanced TCP / IP settings, add IP and subnet mask in the IP address bar, add the completion point "OK" to complete the IP network segment. Users can add the corresponding network segment according to the

modified device IP address.

**Note: Adding an IP address must not conflict with any other computer or device IP,
Verify that this IP already exists before adding**

Verify adding the network segment successfully, open "Start" in the computer, select "Run", enter cmd, click "OK", open the computer DOS command window, enter ping 192.168.0.26. Press the entry key. Add the network segment successfully.

After the product self-check, also follow the above steps to verify whether the network connection is normal. If the default IP opens the computer DOS command window, enter ping 192.168.1.123. Press the return key: the network connection is normal.

2、IE entry

2.1、Web client

1) Client login

Enter the device IP address in the browser address bar to 192.168.1.123 by default, and enter the Web client login interface. Login mode is divided into administrator mode and ordinary user mode. In administrator mode (user name and password default admin), preview, playback, setting, login, etc.; Description: General browser supported by Web access function include IE and 360 browser.

Language selection: login interface shows the upper right corner "Chinese | English" click to select the web interface language type.

2.2、Preview

After successful login, you will enter the management interface, and the default entry is the video preview interface. In the preview interface, you can perform cloud head control, zoom, focus, video, capture, sound, zoom, full screen, preset bit setting, operation, delete and other operations.

2.3、Entry

1) Login in administrator mode

User name and password are by default admin

Cloud control, zoom, focus, video, capture, sound, zoom, full screen and preset; can preview, playback, set, and log out.

2.4、System Settings

Click "System Settings" to enter the device parameter setting page.

There are mainly the following options: local settings, audio settings, camera settings, network settings, system management, etc. See the following table for details.

Menu	Explain
Local Setting	Including diary settings, storage settings, etc
Audio Setting	Including audio compression format, input volume and other settings
Camera setting	Including video parameters, character overlay, encoding parameters and other settings
network setting	Including the wired network, network port, RTMP, SRT, NDI (NDI models) parameters
system management	Including equipment information, time setting, user management, maintenance setting, user management and other Settings

1) Local Setting

Log setting: used to record debugging parameters.

Storage Settings: set the storage path for video recording and capture.(IE 10 + browser only)

2) Audio Setting

On: Set whether the audio is enabled

Compression format: Set audio compression format, the device will automatically restart (default AAC,G.726,G.711a, G.711u optional)

Audio bit rate: G711 64kbps, G726 40kbps, and AAC 128kbps

Sample rate: G711 8K, G726 8k, and AAC 32K

Enter the volume: Set to 0-100

Click the "confirm" button to display the "successful operation, effective immediately" prompt information, effective immediately. Displays "Operation succeeded, device is restarting" restart device takes effect

2.5、Camera setting

1) coding parameter

Code stream: Set different video output modes and choose different code streams.(Main code stream, secondary code stream)

Encoding format: set the video compression format, restart the device after changing the save (primary / secondary code stream default H.264, H.265 optional)

Resolution: Set image resolution, restart the device effective after changing save (main code stream default 1920 * 1080,1280 * 720 optional; subcode stream default 640 * 480,352 * 288,960 * 540,704 * 480 optional)

Code rate control: set the code stream control mode, restart the device after changing the saving (main / secondary code flow default code change rate, code change rate is optional).

Code rate (Kb/s): Set the video code rate (the primary default is 2048 Kb/s, 100-8192 Kb/s is optional; the secondary default is 512 Kb/s, 100-4096 Kb/s is optional)

Frame rate (F / S): Set the video frame rate (main / secondary default 30F / S, 1-30F / S optional; 1-30 F / S optional)

I frame interval: set key frame interval (primary / secondary stream default 60F / 30F, primary stream 1-150F optional; secondary stream 1-150 F optional)

Click the "confirm" button to display "Operation is successful, the device is being restarted" and the restart device takes effect

2) Character superposition

Show Time Date: Set whether the time date is displayed

Display title: Set whether the title is checked

Show zoom: Set whether the zoom is checked

Click the "Save" button to display the "parameter saved successfully" prompt information, and the setting will take effect.

3) video parameter

a、 **Image adjustment:** parameters such as brightness, contrast, saturation, tone and sharpness can be set

b、 **Exposure mode:** exposure mode, exposure compensation value, shutter time, gain, aperture, wide dynamic, backlight compensation, strong light inhibition and other parameters can be set.

c、 **White balance setting:** white balance mode, red fine tuning, blue fine tuning, green fine tuning and other parameters can be set.

d、 **Focus setting:** parameters such as focus mode, focus scene, focus area, focus near limit, focus far limit, and focus sensitivity can be set.

e、 **Day and night switching:** the day and night modes can be set

f、 **Image enhancement:** 2D noise reduction, 3D noise reduction, bad point correction, fog transmission, gamma correction and other parameters can be set

g、 **Video adjustment:** can set the horizontal mirror, center mirror and other parameters

h、 **Others:** Digital parameters can be set

2.6、 Network setting

1) Network port

HTTP port: Set the Web port, and restart the device after change and saving (default 80,0-65535 optional)

Rtsp port: Set the Rtsp port to restart the device when changed and saved (default 554,0-65535 optional)

Visca port: Set the Visca port and save (default 3001,0-65535 optional) Click the "confirm" button to display the "successful operation, immediately effective" prompt message.

2) Ethernet parameters

DHCP: Set whether the automatic acquisition IP is enabled. Power restart is effective after change and confirmation (closed by default)

IP address: Set the IP address, restart the device after change and saving (default 192.168.1.123)

Note: The IP address here is the address of the login web page

Subnet mask: Set the subnet mask (default 255.255.255.0)

Default Gateway: Set the default gateway (default 192.168.1.254)

MAC Address: Set the physical address (this parameter is read-only and cannot be modified)

Preferred DNS: Set the Preferred DNS Server (default 192.168.0.7)

Alternative DNS: Set the Alternative DNS server (default 192.168.0.8)

Click the "confirm" button to display the "successful operation, effective immediately" prompt message.

3) RTMP

Switch: can open or close the main code stream, the secondary code stream to select the video code stream mode

Code stream type: you can select the main stream or substream

Server URL: You can fill in the flow address of the RTMP.

Click the "confirm" button to display the "successful operation, effective immediately" prompt message.

2.7、 System managemen

1) Facility information

Device Name: Set device name (default ISP, modify by user)

Click the "confirm" button to display the "successful operation, effective immediately" prompt message.

2) Time setting

Date format: Set date format (default YYYY-MM-DD year-month-day, MM-DD-YYYY month-day-year, DD-MM-YYYY day-month-year optional)

Time zone: Set time zone (default, other time zones are optional)

Time format: Set time type (default 24 hours, 12 hours optional)

Network time synchronization: checked, NTP time can be set

Refresh period: Set the time interval of NTP server automatic update (NTP enable is checked and valid; default 10 minutes, 2-10 days optional)

Server domain name: Set the NTP server address or domain name (NTP enabled is valid; default sl.a.time.edu. Cn, the user can modify itself)

Port: Set NTP server port (NTP enable check is valid; default 123, user can modify itself)

Click the "Save" button to display the "parameter saved successfully" prompt information, and the setting will take effect.

Synchronize PC: display computer time (only time is set to sync with computer time) click "confirm" button

Manual input: the right calendar icon (time setting only is valid for manual input)

3) User management

Select user: Set login user type (default administrator, ordinary user 1, ordinary user 2 optional).

User name: Set user name (select user administrator default admin; select user 1 default root; select user 2 default root2; user can modify)

Password: Set password (select user administrator default admin; select user general 1 default root; select user general 2 default 12345; user can modify by itself)

Click the "confirm" button to display the "successful operation, effective immediately" prompt message.

User name and password, please note the case

Note: If you log in to the web page with the user name and password of ordinary users, you will have no set permission, and you can only preview, replay, and log out operations

4) Maintenance Settings

Upgrade file: Click "Please select the upgrade package..." in the pop-up window, select the upgrade file; click "Upgrade" button to display the upgrade dialog box; successful upgrade (Note: Ensure the power supply and network of the device are connected normally during the upgrade, otherwise the upgrade fails)

Manual restart: restart the camera

Automatic restart: the automatic restart can be set up

Restore default: Camera returns to factory settings

3、Common Parameters:

RTSP flow:

Main code flow 1: rtsp://192.168.1.100

Main code flow2: rtsp://192.168.1.100:554/live/av0

Subcode flow: rtsp://192.168.1.100:554/live/av1

ONVIF port: 2000

Network VISCA protocol port: 52381

Default IP: 192.168.1.123

Default username: admin

Default password: admin

Installation Size Chart

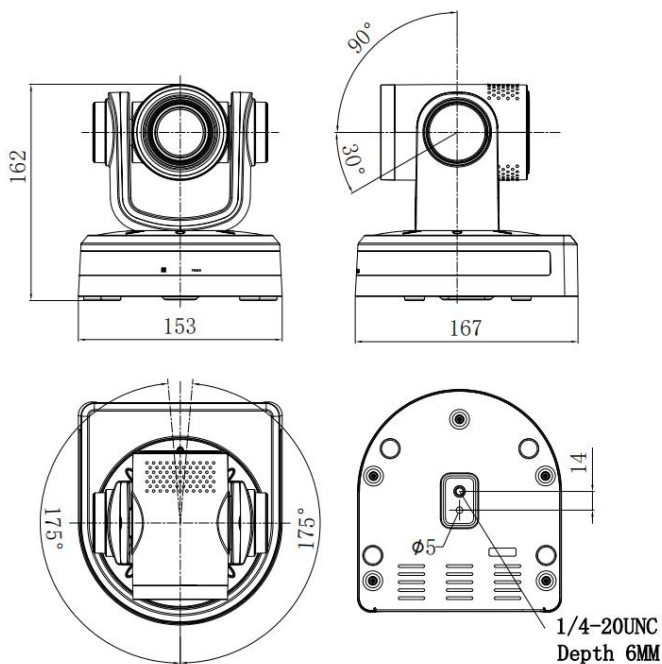

Camera Maintenance and Fault Handling

Camera Maintenance

- If camera is not used for long time, please turn off the power switch and disconnect the AC power adapter from the AC socket after use.
- Use soft cloth or tissue to clean the camera housing.
- Use soft cloth to clean the lens; use neutral cleaner to wipe gently when faced with serious surface dirt. Do not use strong or corrosive cleaner so as not to scratch the lens and affect the image.

Avoid using in the following conditions:

- The camera should avoid shooting extremely bright objects, such as sunlight, lights.
- Avoid working under unstable lighting conditions, otherwise the image will flash.
- Avoid using around facilities that emit high-powered radio waves, such as television stations or radio stations.

Trouble Shooting

If you encounter any issues while using your C410, please follow the troubleshooting steps below. If the problem persists after performing these steps, please contact our customer service for further assistance.

Q: The video from the camera is not displaying on the screen.

A: ①Check whether the camera power supply is connected, the voltage is normal, the power indicator is on.
②Check Whether the camera can self-check after restarted.
③Check whether the DIP switch at the bottom is normal
④Check whether the cable of video platform or television is connected properly.

Q: Why is the video image displayed intermittently?

A: Check whether the video output cable or video display is in a normal state.

Q: Image dithering appears when the camera lens is at the maximum magnification

A:①Check whether the camera is solidly installed.
②Check Whether there are vibrating machinery or objects around the camera.

Q: The remote control does not control the camera.

A: Replace the remote control batteries and check if the remote control is covered or damaged.
Re-code the remote control with the camera. Try using another remote control to troubleshoot the remote control.

Q: Serial port cannot work

A:①Check whether the working mode of the camera is correct.
②Check whether the control cable is connected properly.

Q: The camera cannot be controlled via RS232/RS422 when connected to a PC.

A: Verify that the RS232/RS422 cable is properly connected between the camera and the PC.
Check that the correct serial communication settings are configured on the PC, matching the camera's

settings

Q: Is there a built-in microphone in this camera?

A: No, this model of camera does not include a built-in microphone.

Q: Maintenance and Care

A: Clean the camera lens and sensor regularly to keep images sharp.

Avoid using the camera in extreme temperatures or humidity to avoid damaging sensitive parts.

Check and update the camera firmware regularly to ensure optimal performance.

Q: Contact Technical Support

A: If the above steps do not resolve your issue, please contact our technical support team directly for further assistance.

Warranty Card

Thank you so much for choosing our products.

User Info:

[Name] _____

[Address] _____

[Post Code] _____

[Phone Number] _____

[Email] _____

Product's Info:

[Product Model]: _____

[Product Order Number]: _____

[Fault Description] _____

This product is covered by the following warranty from the date of purchase:

1. Warranty period: 30 days return without reason, 1 year warranty.
2. Warranty scope: product failure or damage under normal use.

Attention:

1. Please be sure to fill in all the information truthfully so that we can provide you with accurate warranty and technical support services.
2. Keep this card as a proof of warranty.

Copyright Notice:

All the contents of this manual shall not be imitated, copied, reproduced or translated arbitrarily without the approval of the company. No warranty, position or other implication is given in this manual. Specifications and information of this manual are for reference only, and the contents are subject to change without prior notice.