

5023 Hazel Jones Road
Bossier City, LA 71111
800.747.8954 Tel
800.877.8746 Fax

Mullion Mate[®] Field Dimension Form - Series 60

www.mullionmate.com

Project Information

Project Name:
Architect/Location:
Jobsite Address:
Delivery Date:

Contractor Information

Name:
Email:
Phone:
Delivery Address:

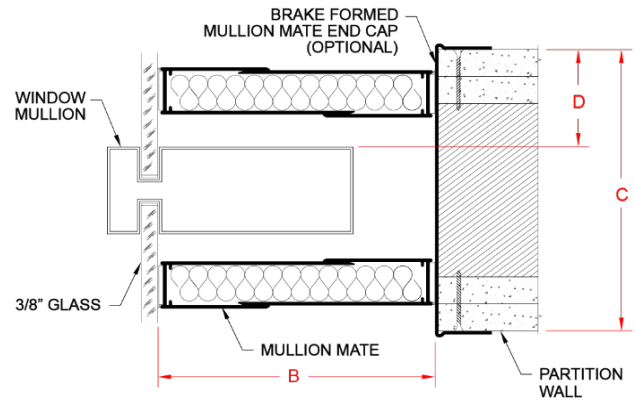
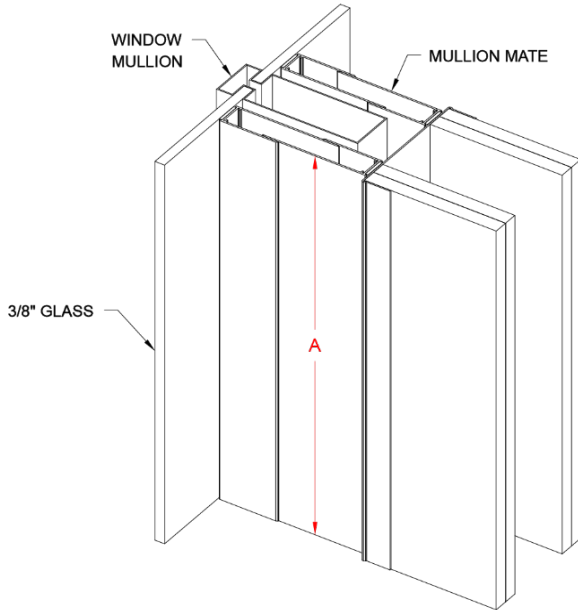

A:	B:	C:	D:
-----------	-----------	-----------	-----------

Length

Gap Size

Partition Width
****Optional****

Mullion to Face of Partition Wall

Performance: Series 60

Readily available End Cap sizes:

Mullion Mate Quantity: _____ **EA** (Typically 2 Units per Location)

Number of Locations: _____ **EA**

Partition End Cap Quantity: _____ **EA** (120" Lengths)

Finish: _____

Dimension A:

Length of Unit. Distance from floor to ceiling or the desired length between window frame. Maximum length of units is 16'.

Dimension B:

Gap size. Distance from partition wall to glass. Must be a minimum of 4" and a maximum of 7".

Dimension C:

Partition wall width. For standard extrusions, wall widths must be a minimum of 3-3/4" to a maximum 7-1/4". Brake Formed options are available for custom-sized partition walls.

Dimension D:

Distance from the Face of Window Mullion to Face of Partition Wall. Must be a minimum of 1-1/4".

EXTRUDED MULLION MATE END CAPS	
PART #	"A"
MMEC-375	3-3/4"
MMEC-487	4-7/8"
MMEC-600	6"
MMEC-725	7-1/4"

BRAKE FORMED MULLION MATE END CAPS	
PART #	"A"
MMECBF-518	5-1/8"
MMECBF-514	5-1/4"
MMECBF-512	5-1/2"
MMECBF-618	6-1/8"
MMECBF-812	8-1/2"